

Thomas M. Kelaher, P.E.
Structural Consultants
Florida Rg. No 40159
1108 S.E. 14th Terrace
Deerfield Beach, FL 33441
Phone (954) 360.9628
Fax (954) 360.0173
tkelaherengr@comcast.net

Dana & Carol (Wendy) Anderson
Residence
SW Meadowlands Drive
Lake City, Florida

No.	Description	Date

Proposed Residence

Structural Wall
Sections

Project number	24-045
Date	12/25/2024
Drawn by	A.O.
Checked by	T.K.

S105

Scale	1/2" = 1'-0"
-------	--------------

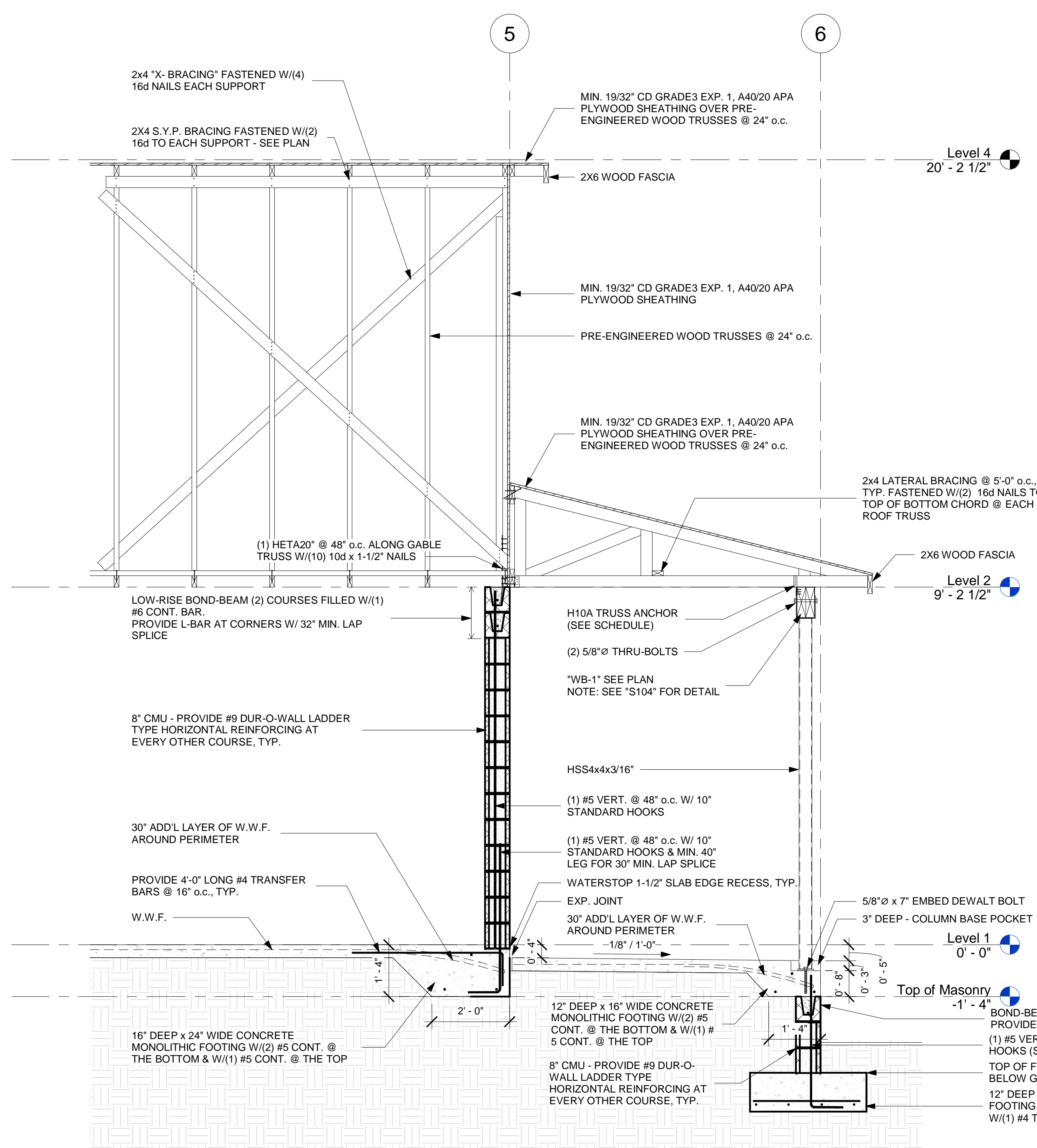

2 Structural Building Section 2
1/2" = 1'-0"

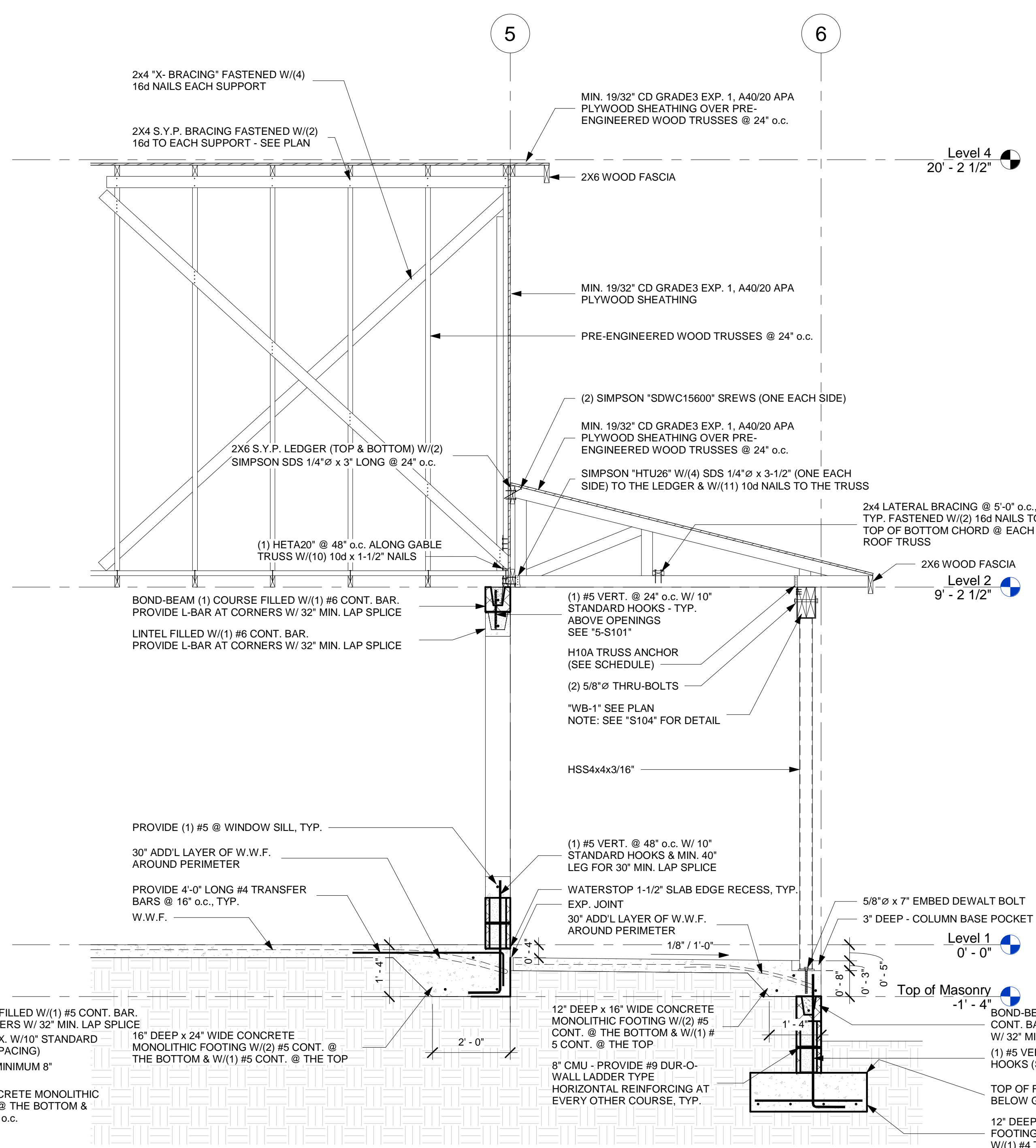

1 Structural Building Section 1
1/2" = 1'-0"