

LEGEND

- Dark brown, silty fine sand (SP-SM), trace of organic, TOPSOIL
- Tan to brown, silty fine sand (SM-SP)
- Reddish tan to yellowish tan, slightly silty fine sand (SP)
- \* Standard Penetration Resistance (Blows/ft.)  
Measured Using a Manual Hammer System
- Groundwater Level Measured at Completion
- T.B.T. Test Boring Terminated
- A.B.T. Auger Boring Terminated
- 15.0' Termination Depth

NOTE: Please refer to text of report for additional information relative to groundwater conditions and potential fluctuations which could occur.

NOT TO SCALE  
NOT FOR CONSTRUCTION

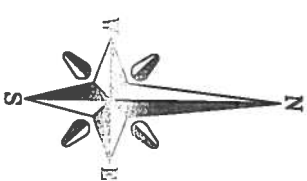
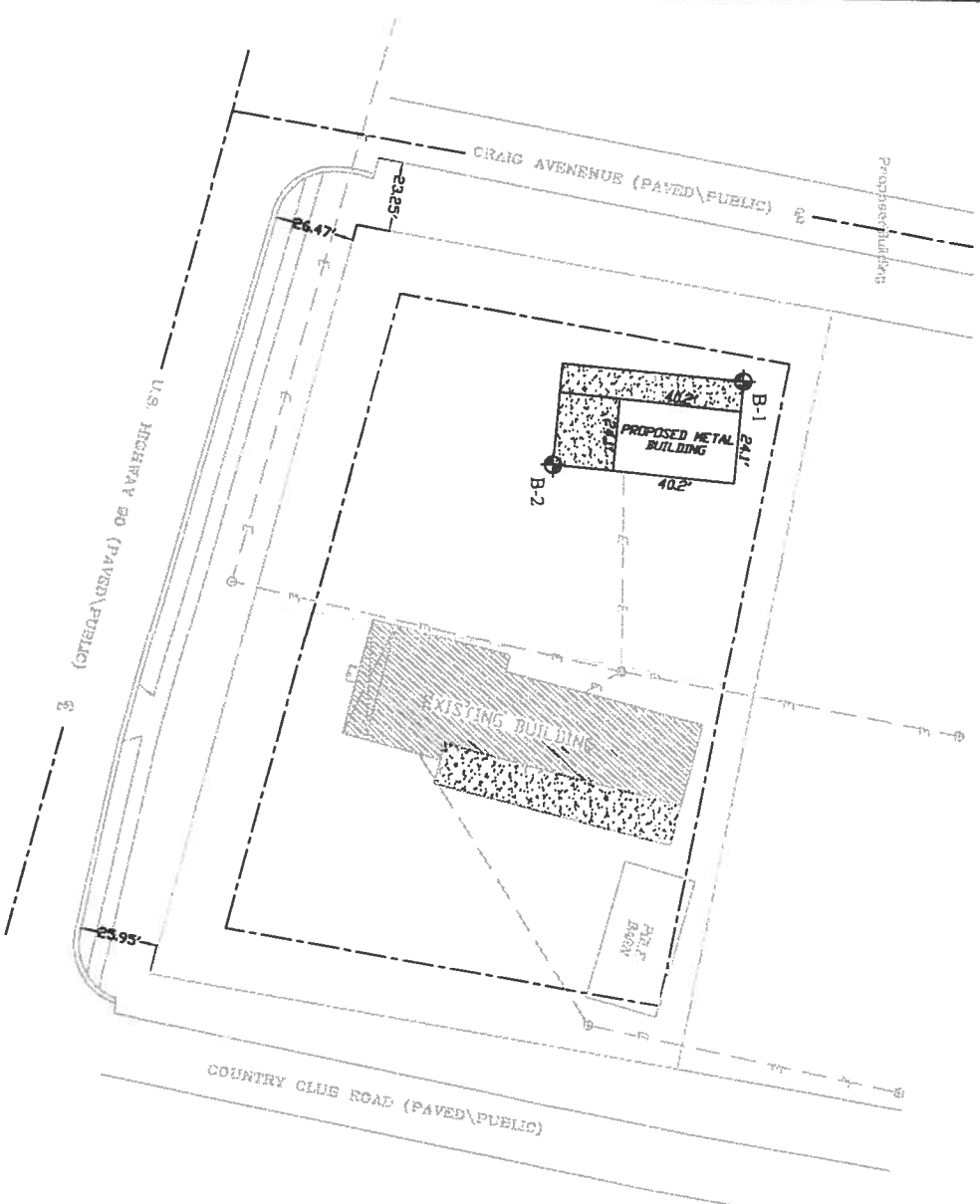

SPT Borings Performed by CTI 11/01/2007

GEOTECHNICAL EXPLORATION  
Riesby CARWASH  
LAKE CITY, COLUMBIA COUNTY, FLORIDA

CAL-TECH TESTING, INC.  
P.O. Box 1625  
Lake City, Florida 32056-1625  
Phone: (386) 755-3633  
Fax: (386) 752-5456

FIELD EXPLORATION PLAN

Project No. 07-00543-01 DATE: 11/05/2007 FIGURE 1/1  
DRAWN APPROVED SCALE