

# LUMBER SIZE & GRADE MINIMUM REQUIREMENTS

RIDGE BOARD	2X6 SYP #2
RAFTER SPANS 20'-0" OR LESS	2X4 SYP #2
PURLINS / LATERAL BRACING	2X4 SPF #2
SLEEPERS	2X (WIDTH OF RAFTER SEAT CUT) SPF #3 OR 2 PARALLEL 2X4 SPF #3
CRIPPLES & BLOCKING	2X4 SPF #2 OR BETTER
TRUSSES BELOW	SEE TRUSS DESIGN - SOUTHERN PINE MATERIAL

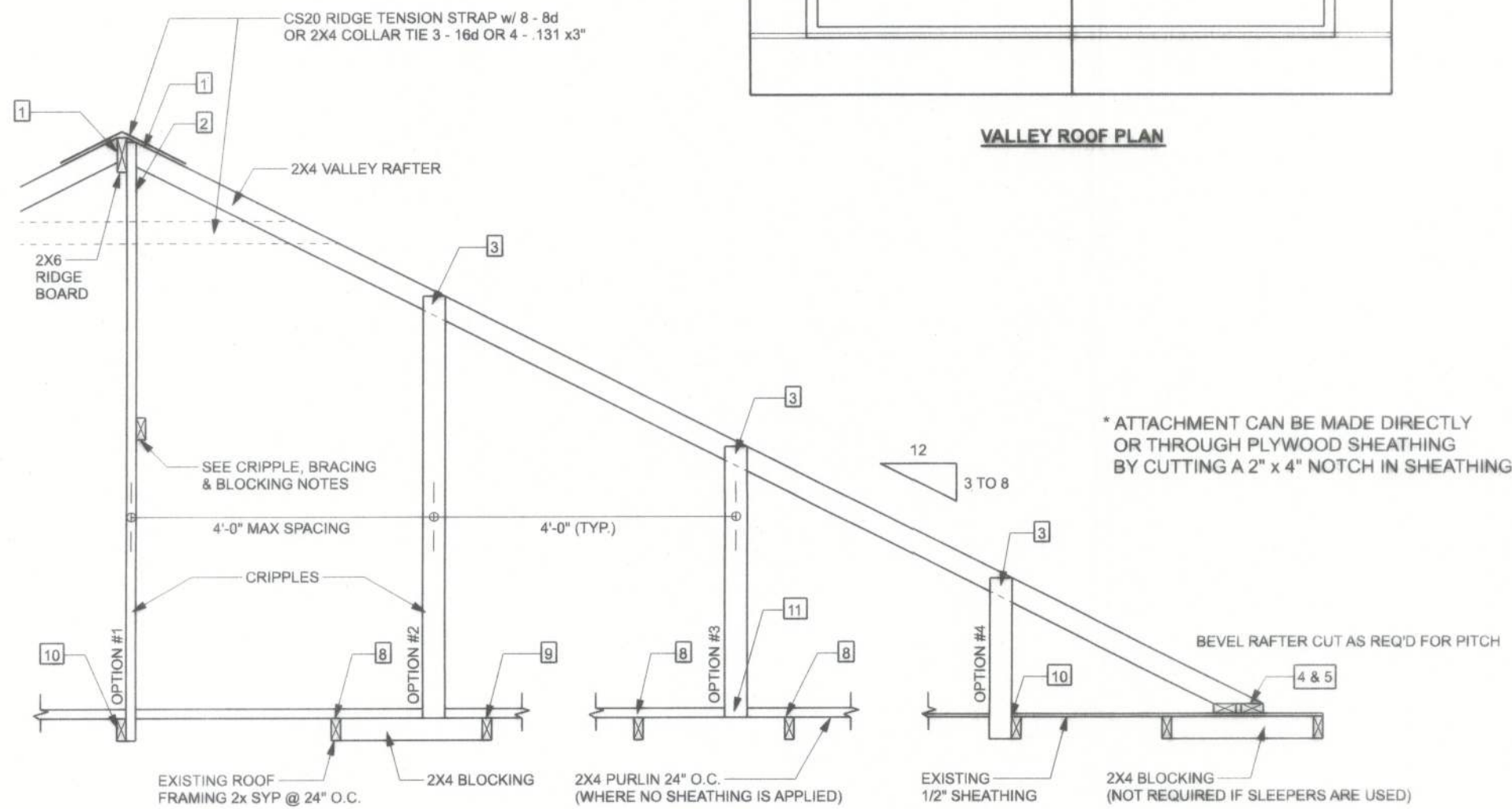

SECTION CUT PARALLEL TO VALLEY RAFTER

## VALLEY ROOF PLAN MEMBER LEGEND

—	TRUSS
- - -	TRUSS UNDER VALLEY FRAMING
- - - - -	VALLEY RAFTER OR RIDGE
■	CRIPPLE

CRIPPLES 4'-0" O.C. FOR 20 psf (TL) AND 10 psf (TD) (TYP. SHINGLE ROOF) MAX

## CONNECTION REQUIREMENT NOTES

1. 2X4 RAFTERS TO RIDGE	3-16d OR 6-131 x 3" TOE NAILS
2. CRIPPLE TO RIDGE	3-16d OR 6-131 x 3" FACE NAILS
3. CRIPPLE TO RAFTERS	3-16d OR 6-131 x 3" FACE NAILS
4. RAFTER TO SLEEPER OR BLOCKING	6-16d OR 12-131 x 3" TOE NAILS
5. SLEEPER TO TRUSS	4-16d OR 8-131 x 3" FACE NAILS EACH TRUSS
6. RIDGE BOARD TO ROOF BLOCK	3-16d OR 6-131 x 3" TOE NAILS
7. RIDGE BOARD TO TRUSS	3-16d OR 6-131 x 3" TOE NAILS
8. PURLIN TO TRUSS (TYP.)	3-16d OR 6-131 x 3" NAILS
9. PURLIN TO TRUSS (IF CRIPPLE IS ATTACHED TO PURLIN)	4-16d OR 8-131 x 3" NAILS
10. TRUSS TO BLOCKING	3-16d OR 6-131 x 3" END NAILS
11. CRIPPLE TO TRUSS	3-16d OR 6-131 x 3" FACE NAILS
12. CRIPPLE TO PURLIN	3-16d OR 6-131 x 3" FACE NAILS

## ROOF OVER FRAMING & BRACING DETAIL

SCALE: N.T.S.

## GENERAL NOTES

MAXIMUM RAFTER SPANS  
6'-0" FOR 2X4, 9'-0" FOR 2X6 SPF #2 OR SYP #2  
MAXIMUM ROOF AREA PER SUPPORT  
1802 IN ZONES 2 & 3, 2402 IN ZONE 1 (EXAMPLE: 4'-0" O.C. X 4'-0" SPAN = 1802 OR 2'-0" X 8'-0" SPAN = 1802)  
PURLINS REQUIRED 2'-0" O.C. IF EXISTING SHEATHING IS REMOVED  
PURLINS SHOULD OVERLAP SHEATHING ONE TRUSS SPACING MINIMUM IN CASES THAT THIS IS IMPRACTICAL, OVERLAP SHEATHING A MINIMUM OF 8" AND NAIL UPWARDS THROUGH SHEATHING INTO PURLIN WITH A MINIMUM OF 8-8d COMMON WIRE NAILS  
THIS DRAWING APPLIES TO VALLEYS WITH THE FOLLOWING CONDITIONS:  
- SPANS (DISTANCES BETWEEN HEELS) 40'-0" OR LESS  
- MAXIMUM VALLEY HEIGHT: 14'-0" OR LESS  
- MAXIMUM WIND SPEED: 130 MPH  
- MAXIMUM MEAN ROOF HEIGHT: 30 FEET  
- MAXIMUM TOTAL LOADING: 40 psf  
- MEETS FBC 2014/ASCE 7-10 WIND REQUIREMENTS  
- EXPOSURE CATEGORY "C", I = 1.0, Kd = 1.0  
- ENCLOSED BUILDING

## CRIPPLE, BRACING, & BLOCKING NOTES

2X4 CONTINUOUS LATERAL BRACE (CLB) MIN. IS REQUIRED FOR CRIPPLES 5'-0" TO 10'-0" LONG  
NAILED w/ 2-10d NAILS OR 2X4 "T" OR SCAB BRACE NAILED TO FLAT EDGE OF CRIPPLE WITH 8d NAILS @ 8" O.C. "T" OR SCAB MUST BE 90% OF CRIPPLE LENGTH. CRIPPLES OVER 10'-0" LONG REQUIRE TWO CLBs OR BOTH FACES w/ "T" OR SCAB. USE STRESS GRADED LUMBER & BOX OR COMMON NAILS  
- NARROW EDGE OF CRIPPLE CAN FACE RIDGE OR RAFTER, AS LONG AS THE PROPER NUMBER OF NAILS ARE INSTALLED INTO RIDGE BOARD  
- INSTALL BLOCKING UNDER RAFTER IF SLEEPERS ARE NOT USED  
- INSTALL BLOCKING UNDER CRIPPLES IF CRIPPLES FALL BETWEEN LOWER TRUSS TOP CHORDS AND LATERAL BRACING IS NOT USED  
- APPLY ALL NAILING IN ACCORDANCE TO NDS-1997 SECTION 12. NAILS ARE COMMON WIRE NAILS UNLESS NOTED OTHERWISE.

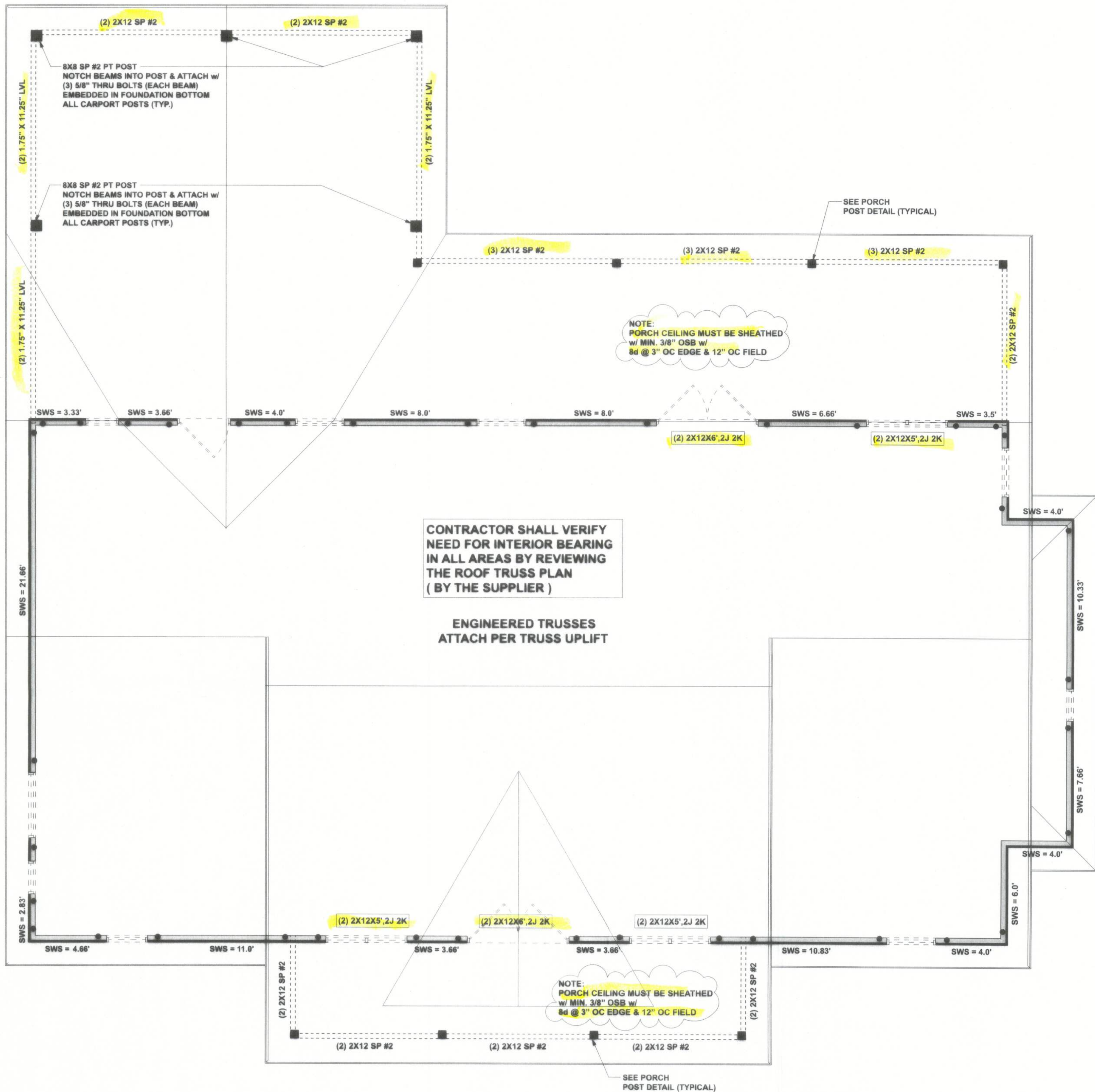

## STRUCTURAL PLAN

SCALE: 1/4" = 1'-0"

## STRUCTURAL PLAN NOTES

- SN-1 ALL LOAD BEARING FRAME WALL & PORCH HEADERS SHALL BE A MINIMUM OF (2) 2X10 SP #2 (U.N.O.)
- SN-2 ALL LOAD BEARING FRAME WALL HEADERS SHALL HAVE (1) JACK STUD & (1) KING STUD EACH SIDE (U.N.O.)
- SN-3 USE ONE JACK STUD GIRDER SUPPORT PER 2500 LB LOAD
- SN-4 DIMENSIONS ON STRUCTURAL SHEETS ARE NOT EXACT. REFER TO ARCHITECTURAL FLOOR PLAN FOR ACTUAL DIMENSIONS
- SN-5 PERMANENT TRUSS BRACING IS TO BE INSTALLED AT LOCATIONS AS SHOWN ON THE SEALED TRUSS DRAWINGS. LATERAL BRACING IS TO BE RESTRAINED PER BCSI-03, BCSI-B1, BCSI-B2, & BCSI-B3. BCSI-B1, BCSI-B2, & BCSI-B3 ARE FURNISHED BY THE TRUSS SUPPLIER, WITH THE SEALED TRUSS PACKAGE

## HEADER LEGEND

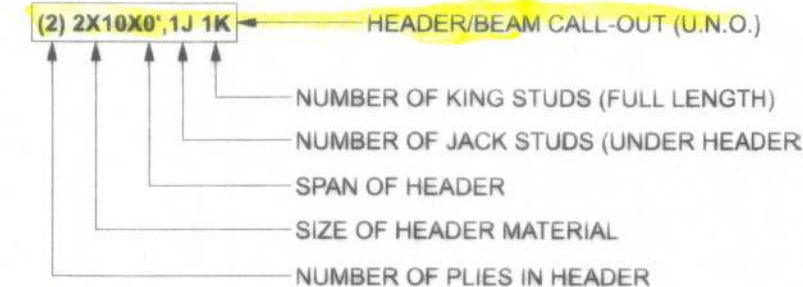

## THREADED ROD LEGEND



## ACTUAL vs REQUIRED SHEARWALL

	TRANSVERSE	LONGITUDINAL
ACTUAL	16968 LBF	19896 LBF
REQUIRED	15601 LBF	12364 LBF

B&B Homes

Josh & Jessica Robinson Res.

PROJECT ADDRESS:  
Columbia County, FL

FL PE 53915



**Mark Disosway P.E.**  
163 SW Midtown Place  
Suite 103  
Lake City, Florida 32025  
386.754.5419  
disoswaydesign@gmail.com

**JOB NUMBER:**  
231112

**S-3**  
OF 3 SHEETS