



COLUMBIA COUNTY BUILDING DEPARTMENT
135 NE Hernando Ave, Suite B-21, Lake City, FL 32055
Phone: 386-758-1008 Fax: 386-758-2160

MOBILE HOME INSTALLERS LETTER OF AUTHORIZATION

I, TERRY L. THRIFT, give this authority for the job address show below
Installer License Holder Name
only, 309 SW Lamboy Cir Lake City FL 32024, and I do certify that
Job Address

the below referenced person(s) listed on this form is/are under my direct supervision and control and is/are authorized to purchase permits, call for inspections and sign on my behalf.

Printed Name of Authorized Person	Signature of Authorized Person	Authorized Person is... (Check one)
<u>TERRI KREPS</u>	<u>[Signature]</u>	Agent <input type="checkbox"/> Officer <input type="checkbox"/> <input checked="" type="checkbox"/> Property Owner
		Agent <input type="checkbox"/> Officer <input type="checkbox"/> Property Owner
		Agent <input type="checkbox"/> Officer <input type="checkbox"/> Property Owner

I, the license holder, realize that I am responsible for all permits purchased, and all work done under my license and I am fully responsible for compliance with all Florida Statutes, Codes, and Local Ordinances.

I understand that the State Licensing Board has the power and authority to discipline a license holder for violations committed by him/her or by his/her authorized person(s) through this document and that I have full responsibility for compliance granted by issuance of such permits.

Terry L. Thrift
License Holders Signature (Notarized)
1H-1025139
License Number
Date

NOTARY INFORMATION:

STATE OF: Florida COUNTY OF: Columbia

The above license holder, whose name is Terry L. Thrift,
personally appeared before me and is known by me or has produced identification
(type of I.D.) _____ on this 25 day of July, 2012.

Rebecca L. Arnan
NOTARY'S SIGNATURE

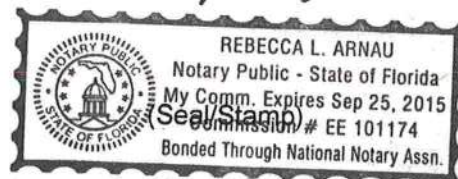

26'-0" WIDE HOME
SIDEWALL HEIGHT 8'-0"

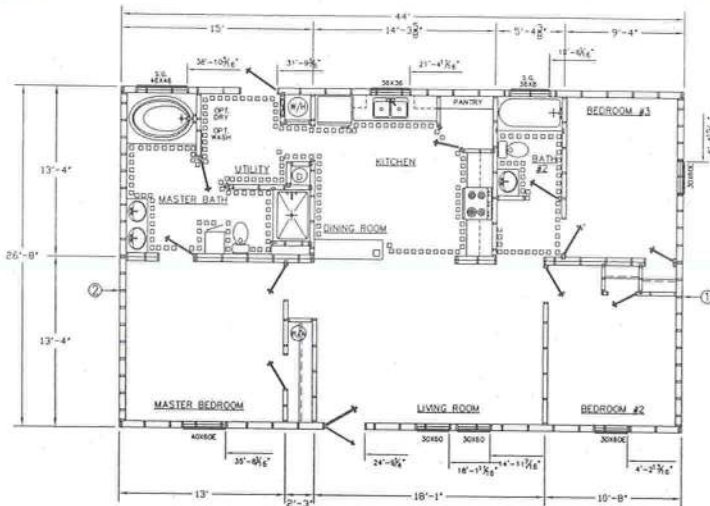

2838-G • 28 x 44 • 3 BR 2 Bath • 1173 Sq. Ft.

26'-0" WIDE HOME
SIDEWALL HEIGHT 8'-0"

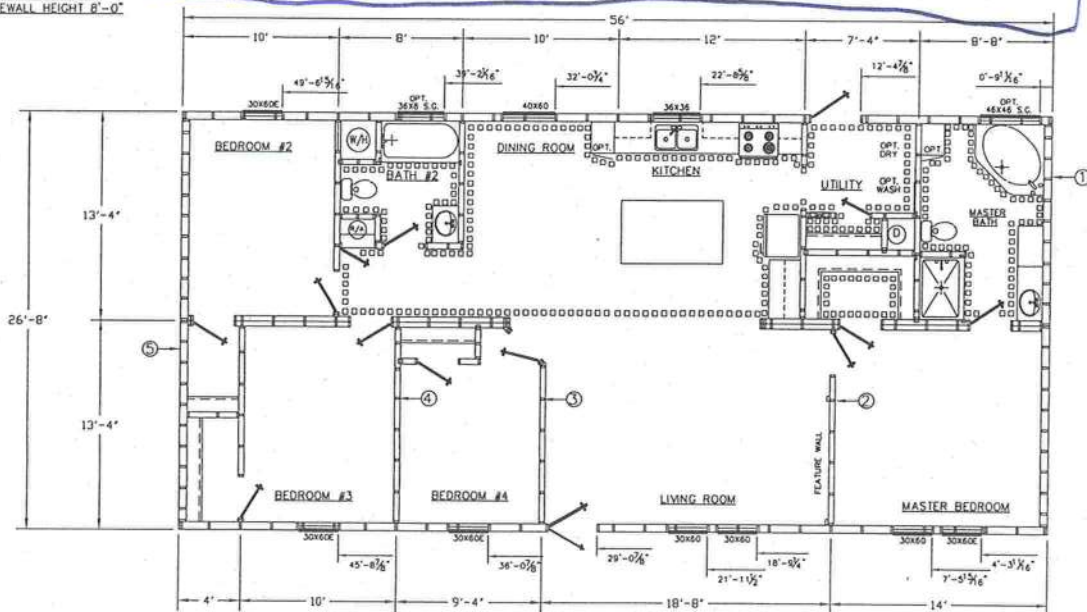

2843-G • 28 x 56 • 3 BR 2 Bath • 1493 Sq. Ft.

26'-0" WIDE HOME
SIDEWALL HEIGHT 8'-0"

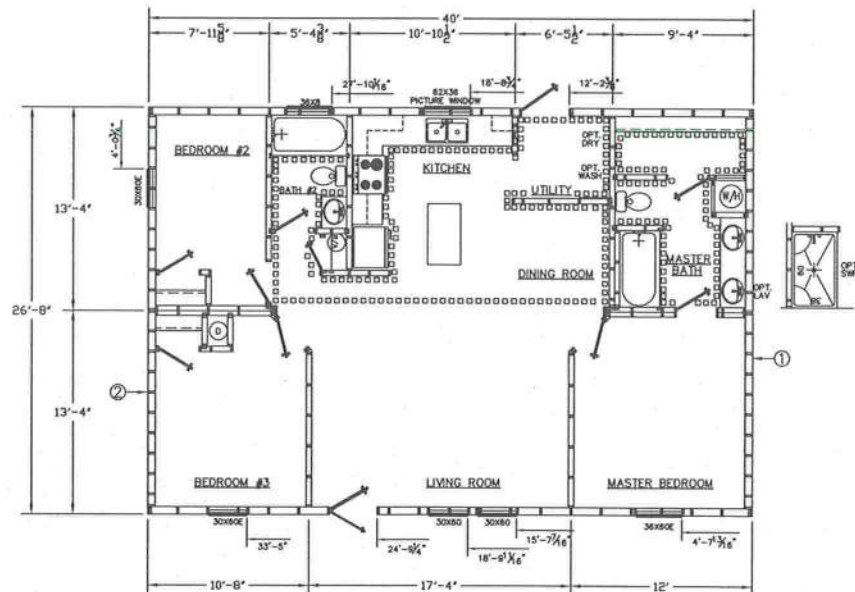

2860-G • 28 x 40 • 3 BR 2 Bath • 1067 Sq. Ft.

APPLICATION #: 1207-58

PARCEL #: 22-4S-16-03086-207

OWNER: TERRI KREPS

CONTRACTOR: TERRY THRIFT

FLOOD ZONE: ZONES X

