



Town of Fort White  
P.O. Box 129 Fort White, FL 32038  
386-497-2321 Fax: 386-4974946

APPLICATION FOR BUILDING PERMIT/COMPLIANCE

\$50.00 FEE

FILE No. \_\_\_\_\_ RECPT No. \_\_\_\_\_

Applicant's Name: John W. Keen Phone: (386) 867-0155  
Address: 293 SW Greenwood Terrace Ft. White, FL 32038  
Owner's Name: John W. Keen Phone: 386 867-0155  
Address: 293 SW Greenwood Terrace Ft. White, FL 32038  
Contractor's Name: K&H Construction/Roofing LLC Roger Whiddon  
Address: 167 SE Comet Court Lake City, FL 32024  
\*\*\*\*\*Location of property: 263 SW Greenwood Terrace Ft. White, FL 32038  
\*\*\*\*\*Type of development: Garage/Mother in law suite  
Land use & zoning: Agriculture/Agriculture  
Minimum set-back: Street-front/side 30' rear 25' side 25'  
Legal Description (acres): 1 1/4 Acre  
04056-106  
Lot 6 Thornwood S/D

I certify that all work will be performed to meet the standards of all laws regulating construction in this jurisdiction and that all the foregoing information is accurate and all work will be done in compliance with all laws regulating construction and zoning.

R Whiddon / MK CRC 1333932 Contractor's  
License Number Applicant/Owner Contractor  
Cornie Brecheen 8-28-24 Date Approved  
by Reviewing Clerk

\*\*\*\*\*IF PROPERTY IS NOT OWNED BY APPLICANT, A STATEMENT FROM THE OWNER AUTHORIZING USE OF PROPERTY FOR THE TYPE OF DEVELOPMENT STATED ON THIS APPLICATION WILL BE REQUIRED.

File No. \_\_\_\_\_

Town of Fort White  
Building Compliance Check List

Name of Applicant John W. Keen

Address 293 SW Greenwood Terrace Ft. White, FL 32038

Phone 386 867-0155

Physical location of site and current zoning 263 SW Greenwood Terrace

Type of Construction ☒ New ( ) remodel/renovation/fire damage

Ft. White, FL 32038

Describe Construction Steel Building / slab

- ( ) Authorized owner or builder signs compliance application.  
(☒) Zoning is appropriate for type of construction.  
( ) Property will ☒ will not require application to SRWMD for water use/runoff permit.  
(☒) Property will require curb cut or access/culvert over road right of way from:  
\_\_\_\_ DOT \_\_\_\_\_ Columbia County ☒ Town of Fort White  
(☒) Property will ( ) will not require Health Dept. Sanitary WasteWater Permit.  
(☒) Property will ( ) will not require potable fresh water supply from:  
\_\_\_\_ private well ☒ Town of Fort White municipal water works.  
(☒) Property will require slab to be at least 1 foot above elevation (crown) of roadway.  
(☒) Property will ( ) will not require approval of solid waste removal facilities. - if occupied or rented out  
( ) Property will (☒) will not require permit for infill or land removal.

- (☒) Applicant understands that a copy of the Town of Fort White Land Use Certification must be taken to Columbia County Building Department for application and issuance of building permit. Certification of land use or zoning by the Town of Fort White is NOT a building permit.

(☒) **Other steps required for Building Compliance:** Property Owner will be responsible for submitting a copy of the Columbia County Building Permit to the Town of Fort White.

The applicant and Town of Fort White Clerk's Office have reviewed the foregoing information and the information is true and correct.

John W. Keen  
Signature of Applicant

Connie Brecheen  
Signature of Reviewing Clerk

Date \_\_\_\_\_

Compliance given to applicant on

Date 8-28-24

## SITE PLAN CHECKLIST

- \_\_\_ 1) Property Dimensions
- \_\_\_ 2) Footprint of proposed and existing structures (including decks), label these with existing addresses
- \_\_\_ 3) Distance from structures to all property lines
- \_\_\_ 4) Location and size of easements
- \_\_\_ 5) Driveway path and distance at the entrance to the nearest property line
- \_\_\_ 6) Location and distance from any waters; sink holes; wetlands; and etc.
- \_\_\_ 7) Show slopes and or drainage paths
- \_\_\_ 8) Arrow showing North direction

### SITE PLAN EXAMPLE

Revised 7/1/15

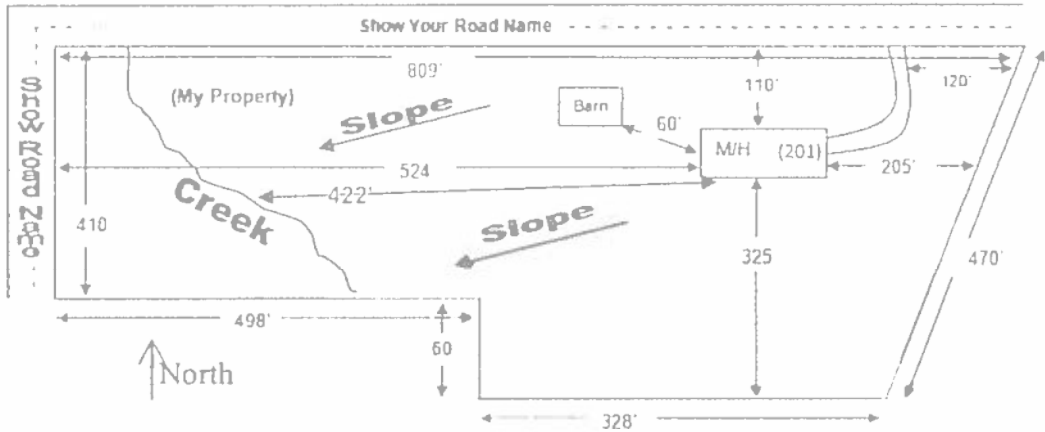

#### NOTE:

This site plan can be copied and used with the 911 Addressing Dept. application forms.

