

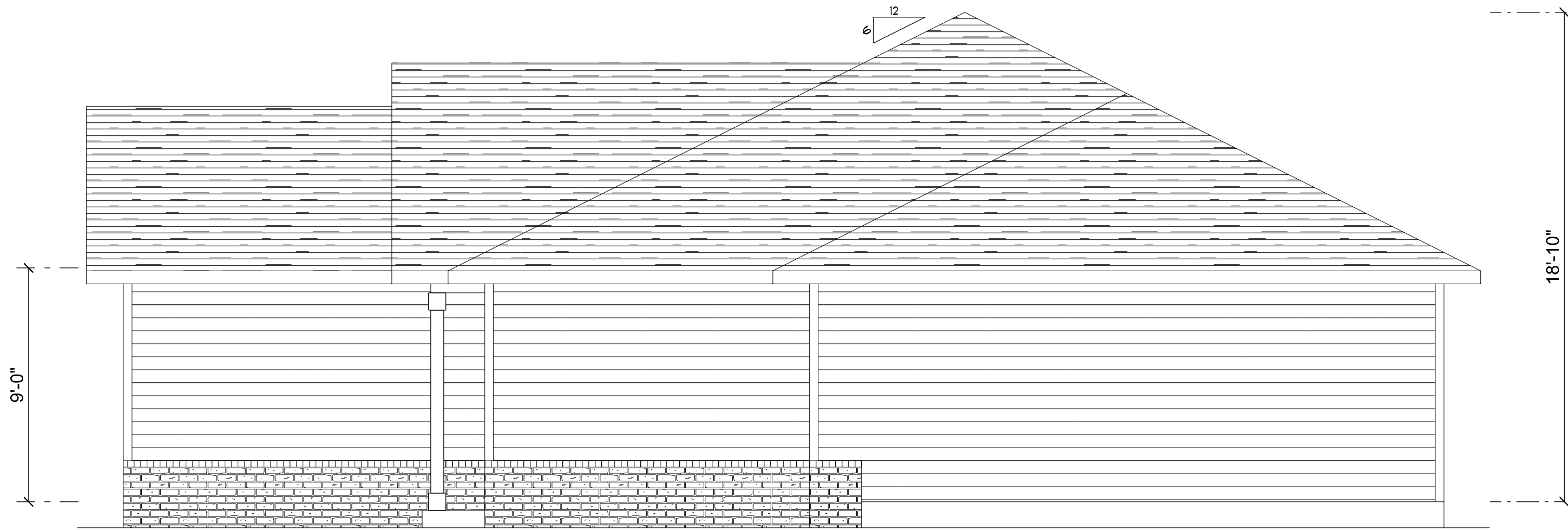

LEFT ELEVATION
SCALE: 1/4" = 1'-0"



RIGHT ELEVATION
SCALE: 1/4" = 1'-0"



REAR ELEVATION
SCALE: 1/4" = 1'-0"

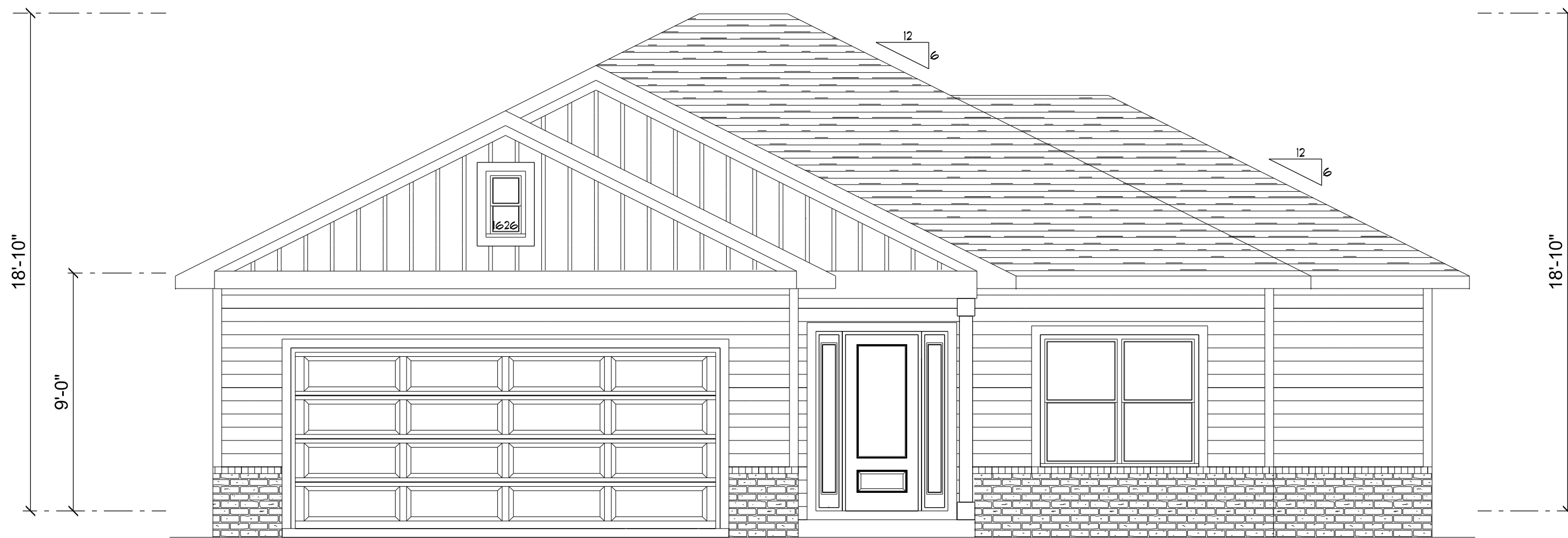

FRONT ELEVATION
SCALE: 1/4" = 1'-0"

REVISIONS SCHEDULE	
May 9th, 2022	PERMIT DRWGS

Lot 27 Rose Pointe

Stanley Crawford Construction

LAKE CITY, FL

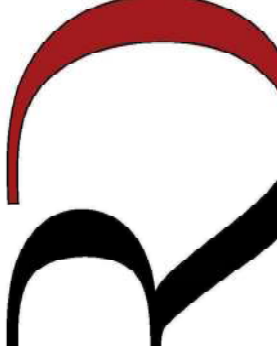
**RIDGEPOINT
DESIGN**

816 WEST DUVAL STREET, LAKE CITY, FLORIDA 32055
P: 386-288-1188
E: RIDGEPOINTDESIGN@GMAIL.COM

SHEET NUMBER

A.1

OF 3 SHEETS

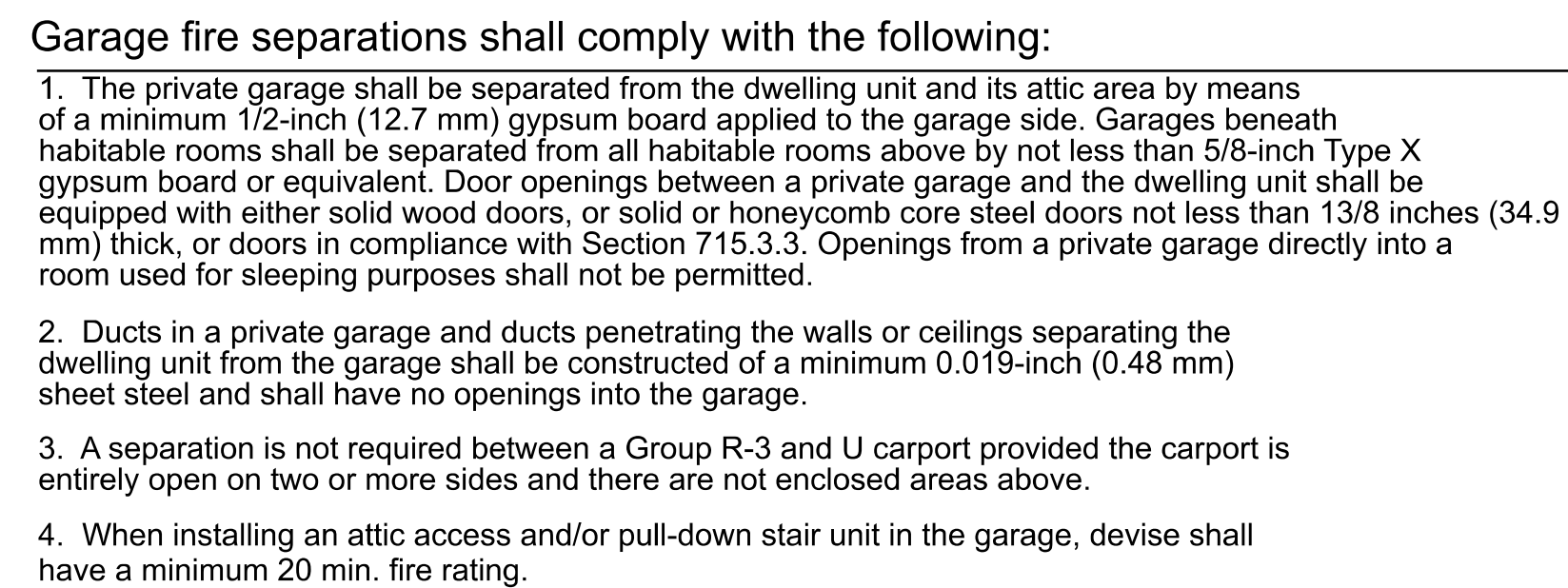

A R E A S U M M A R Y		
HEATED & COOLED	1,320	S.F.
GARAGE	484	S.F.
FRONT PORCH	52	S.F.
BACK PORCH	75	S.F.
TOTAL AREA	1,931	S.F.

REVISIONS SCHEDULE	
May 9th, 2022	PERMIT DRWGS

Lot 27 Rose Pointe
Stanley Crawford Construction
LAKE CITY, FL

SHEET NUMBER









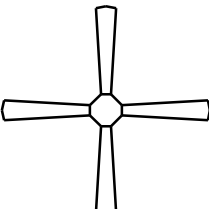

A.2

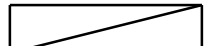
OF 3 SHEETS

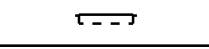

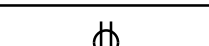
**RIDGEPOINT
DESIGN**

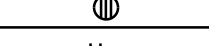
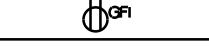
918 WEST DUDAL STREET, LAKE CITY, FLORIDA 32055
P: 386-288-1188
E: RIDGEPOINTDESIGN@GMAIL.COM

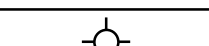
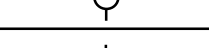
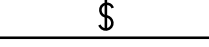
ELECTRICAL LEGEND		
ELECTRICAL	COUNT	SYMBOL
CEILING FAN	4	
CAN LIGHT 6inch	5	
FLUORESCENT LIGHT 1x4	3	
EXTERIOR SCONCE	2	
ELECTRIC PANEL	1	
EXHAUST FAN	2	
OUTLET	30	
OUTLET 220v	5	
OUTLET GFI	12	
OUTLET WP	4	
SMOKE DETECTOR	4	
STANDARD LIGHT	8	
SWITCH	22	
SWITCH 3 WAY	8	
VANITY BAR LIGHT - SMALL	3	
CARBON DETECTOR	1	

ELECTRICAL PLAN NOTES:

INSTALLATION SHALL BE PER 2017 NAT'L ELECTRIC CODE.

WIRE ALL APPLIANCES, HVAC UNITS AND OTHER EQUIPMENT PER MANUF. SPECIFICATIONS

CONSULT WITH THE OWNER FOR THE NUMBER OF SEPERATE TELEPHONE LINES TO BE INSTALLED

ALL SMOKE DETECTORS SHALL BE 120v W/ BATTERY BACKUP OF THE PHOTOELECTRIC TYPE, AND SHALL BE INTERLOCKED TOGETHER. INSTALL INSIDE AND NEAR ALL BEDROOMS

TELEPHONE, TELEVISION AND OTHER LOW VOLTAGE DEVICES OR OUTLETS SHALL BE AS PER THE OWNER'S DIRECTIONS, & IN ACCORDANCE W/ APPLICABLE SECTIONS OF NEC-LATEST EDITION.

ALL RECEPTALS, NOT OTHERWISE NOTED, SHALL BE ARC FAULT INTERRUPTER TYPE, EXCEPT DEDICATED OUTLETS

ALL RECEPTALS IN WET AREAS SHALL BE GROUND FAULT INTERRUPTER TYPE (GFI)

ALL EXTERIOR RECEPTALS SHALL BE WEATHERPROOF GROUD FAULT INTERRUPTER TYPE (WP/GFI)

NOTE:
ELECTRICAL CONTR SHALL PREPARE "AS-BUILT" SHOP DWGS INDICATING ALL ELECTRICAL WORK, INCLUDING ANY CHANGES TO THE ELEC. PLAN, ADDNS TO THE ELEC. PLAN, RISER DIAGRAM, AS-BUILT PANEL SCHEDULE W/ ALL CKTS IDENTIFIED W/ CKT NR, DESCRIPTION & BRKR, SERVICE ENT. & ALL UNDERGROUND WIRE LOCATION/ROUTING / DEPTH. RISER DIA. SHALL INCLUDE WIRE SIZES/TYPE & EQUIPMENT TYPE W/ RATINGS & LOADS.
CONTRACTOR SHALL PROVIDE 1 COPY OF AS-BUILT DWGS TO OWNER & 1 COPY TO THE PERMIT ISSUING AUTHORITY

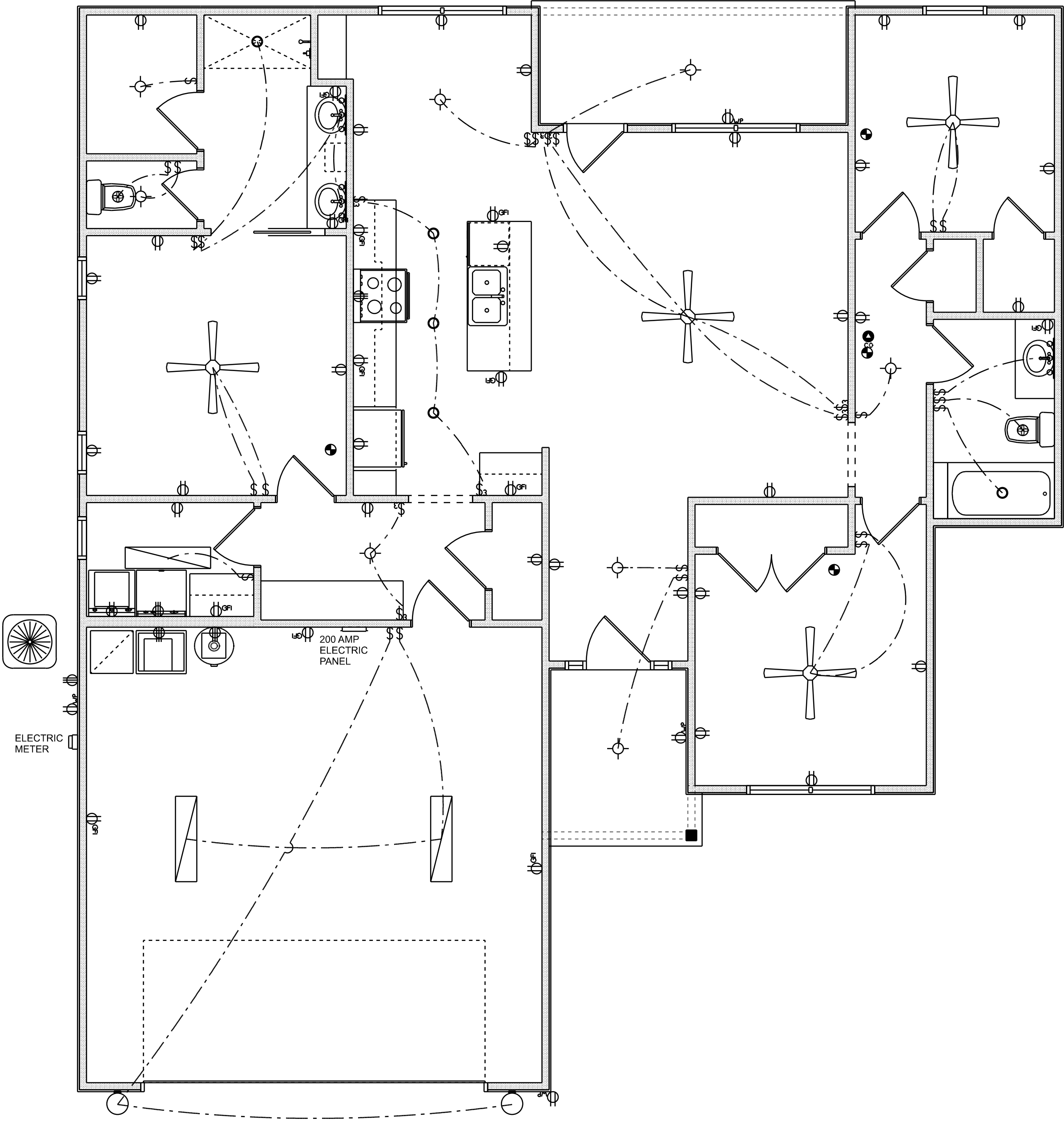

ELECTRICAL PLAN
SCALE: 1/4" = 1'-0"

REVISIONS SCHEDULE	
May 9th, 2022	PERMIT DRWGS

Lot 27 Rose Pointe

Stanley Crawford Construction

LAKE CITY, FL



RIDGEPOINT
DESIGN

316 WEST DUVAL STREET, LAKE CITY, FLORIDA 32055
P: 386-288-1188
E: RIDGEPOINTDESIGN@GMAIL.COM

SHEET NUMBER

A.3

OF 3 SHEETS