

LEGEND

- EXIT LIGHT - ARROW
REPRESENTS DIRECTION
OF EXIT
- WALL HUNG "ABC" FIRE
EXTINGUISHER
- DOOR / CLOSER FOR EXITING
OR RATING REASONS
- PRIMARY EGRESS
W/ EXIT CAPACITY
- SECONDARY EGRESS
- EMERGENCY LIGHT
W/ BATTERY BACKUP

NOTE:
EMERGENCY LIGHTING AND EXIT SIGNS, SHALL BE PROVIDED
AS DIRECTED BY THE FIRE MARSHAL, AND SHALL BE WIRED
PER NEC 100-12F

NOTE:
SMOKE DETECTORS SHALL BE MOUNTED NOT LESS
THAN 90" ABOVE FINISHED FLOOR AND SHALL BE THE
IONIZATION TYPE, INTERLOCKED TOGETHER, POWERED
FROM EACH STORE PANEL W/ BATTERY BACKUP

EXIT ACCESS TRAVEL DISTANCE PER 2023 FBC TABLE 1006.2.1
OCCUPANCY - OFFICE
150 FT. (WITHOUT SPRINKLER SYSTEM)
250 FT. (WITH SPRINKLER SYSTEM)

NOTE:
TRAVEL DISTANCES SHOWN ARE MAXIMUM FOR EMERGENCY EGRESS,
SECONDARY EM. EGRESS AND NON-EMERGENCY EGRESS - ALL OTHER
TRAVEL DISTANCES ARE LESS THAN THAT SHOWN



8" SQ. MALTESE CROSS W/ "F/R" IDENTIFIER
SIGNAGE, MOUNTED @ 60" ABV. WALKWAY
LOCATE AS DIRECTED BY THE FIRE MARSHAL

2023 FBC-BUILDING, TABLE 1004.5 MAXIMUM FLOOR AREA ALLOWABLE PER OCCUPANT

OCCUPANCY CLASSIFICATION	FLOOR AREA	OCCUPANCY BASIS	NUMBER OF OCCUPANTS
CLASSROOMS / COMMON	5,450	# 22/PER CLASSROOM	96
OFFICE	148	# 1/100 SF	1
STORAGE	302	# 1/300 SF	1
BUILDING TOTALS	6,500		104

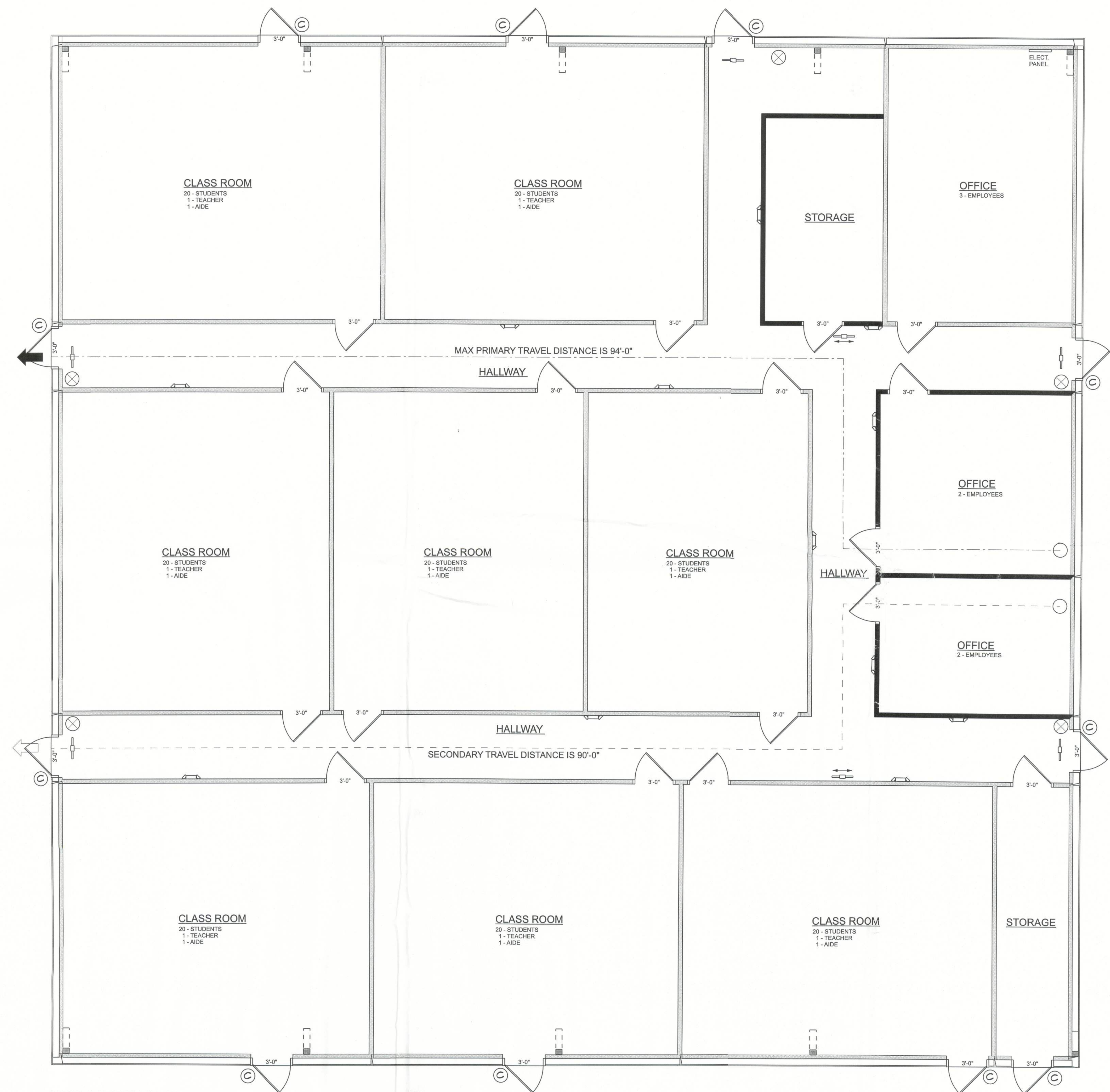

LIFE SAFETY PLAN
SCALE: 1/4" = 1'-0"

EXISTING BUILDING RENOVATIONS FOR:

KINGDOM CULTURE ACADEMY

COLUMBIA COUNTY, FLORIDA



RIDGEPOINT DESIGN
RIDGEPOINTDESIGNARCHITECT.COM | 384-284-1886

JOINT VENTURED WITH



NICHOLAS
PAUL
GEISLER
ARCHITECT
N.C.A.R.S. Certified
1758 NW Brown Rd.
Lake City, FL 32055

SHEET NUMBER

A.1
OF 4 SHEETS



50652