



STATE OF FLORIDA  
DEPARTMENT OF ENVIRONMENTAL PROTECTION  
ON-SITE SEWAGE TREATMENT AND DISPOSAL  
SYSTEM (OSTDS)

PERMIT NO. 23-0525  
DATE PAID: 7/17/23  
FEE PAID: 1000  
RECEIPT #: 1979293

APPLICATION FOR CONSTRUCTION PERMIT

APPLICATION FOR:

☐ New System ☒ Existing System ☐ Holding Tank ☐ Innovative  
☐ Repair ☐ Abandonment ☐ Temporary ☐

APPLICANT: Jeanenne Adams EMAIL: Jsides.tayb@gmail.com

AGENT: Jerry Robinson TELEPHONE: 386-244-4422

MAILING ADDRESS: 374 SW Paddock court Lake city Fl 32024

TO BE COMPLETED BY APPLICANT OR APPLICANT'S AUTHORIZED AGENT. SYSTEMS MUST BE CONSTRUCTED BY A PERSON LICENSED PURSUANT TO 489.105(3)(m) OR 489.552, FLORIDA STATUTES. IT IS THE APPLICANT'S RESPONSIBILITY TO PROVIDE DOCUMENTATION OF THE DATE THE LOT WAS CREATED OR PLATTED (MM/DD/YY) IF REQUESTING CONSIDERATION OF STATUTORY GRANDFATHER PROVISIONS.

PROPERTY INFORMATION

OSTDS REMEDIATION PLAN? [ Y / N ]

LOT: 5 BLOCK:  SUBDIVISION: Briarwood PLATTED:

PROPERTY ID #: 31-45-17-08920-105 ZONING:  I/M OR EQUIVALENT: [ Y / N ]

PROPERTY SIZE: 3.76 ACRES WATER SUPPLY: ☒ PRIVATE PUBLIC ☐ ≤2000GPD ☐ >2000GPD

IS SEWER AVAILABLE AS PER 381.0065, FS? [ Y / N ] DISTANCE TO SEWER:  FT

PROPERTY ADDRESS: 374 SW Paddock court Lake city Fl 32024

DIRECTIONS TO PROPERTY: Head W on NE franklin St, L on NW main Blvd, Slight R on FL-47 S  
L on Wester Rd, R onto SW paddock CT

BUILDING INFORMATION

☒ RESIDENTIAL ☐ COMMERCIAL

Unit No.	Type of Establishment	No. of Bedrooms	Building Area Sqft	Commercial/Institutional System Design Table I, Chapter 62-6, FAC
1	<u>Pool</u>	<u>—</u>	<u></u>	<u>ORIGINAL ATTACHED</u>
2	<u></u>	<u></u>	<u></u>	<u></u>
3	<u></u>	<u></u>	<u></u>	<u></u>
4	<u></u>	<u></u>	<u></u>	<u></u>

☐ Floor/Equipment Drains ☒ Other (Specify) New Pool

SIGNATURE: Jerry Robinson DATE: 7/17/23

DEP 4015, 06-21-2022 (Obsoletes previous editions which may not be used)

Incorporated 62-6.004, FAC



STATE OF FLORIDA  
DEPARTMENT OF ENVIRONMENTAL PROTECTION  
APPLICATION FOR CONSTRUCTION PERMIT

Permit Application Number 23-0525

----- PART II - SITEPLAN -----

Scale: Each block represents 10 feet and 1 inch = 40 feet.

See Attached

Notes: \_\_\_\_\_

Site Plan submitted by: Jerry Robinson

Plan Approved ☒ Not Approved \_\_\_\_\_ Date 7-25-23

By Salli Ind - Env. Health Director County Health Department  
Columbia

ALL CHANGES MUST BE APPROVED BY THE COUNTY HEALTH DEPARTMENT



23-0525

SITE AREA	PROPOSED AREA
162,361.70ft <sup>2</sup>	344,53ft <sup>2</sup>

SITE AREA 162,361.70ft<sup>2</sup>

PROPOSED AREA 344.53ft<sup>2</sup>

04 ft

30.68 ft

362.53 ft

23-0525

- Northwest Paddock Court**

**Site Calculations**

Category	Value
SITE AREA	162,361.70 ft <sup>2</sup>
PROPOSED AREA	344.53 ft <sup>2</sup>

**Notes**

Number	Note
1	JR 6/27/23 6:15 AM Equipment Pad 4'x4'
2	JR 6/27/23 6:18 AM Skimmer
3	JR 6/27/23 11:51 PM Jet/return
4	JR 6/28/23 12:04 AM light 1
5	JR 6/28/23 12:14 AM light 2
6	JR 7/11/23 11:16 PM 14ft from house to pool edge
7	JR 7/11/23 11:44 PM 4ft fence
8	JR 7/12/23 12:01 AM pavers
9	JR 7/14/23 12:31 AM Drain Field
10	JR 7/14/23 12:35 AM Septic tank

Dimensions shown on plan:

  - 331.04 ft
  - 508.66 ft
  - 304.10 ft
  - 362.53 ft
  - 30.68 ft
  - 107.61 ft
  - 102.62 ft
  - 186.06 ft
  - 208.01 ft
  - 04 ft

Handwritten notes: 23-0525 (top right and bottom right)

Scale: 1" = 100'

North arrow pointing towards the top right.

A photograph of a rock surface with a scale bar and a circular inset showing a close-up of a triangular rock feature.

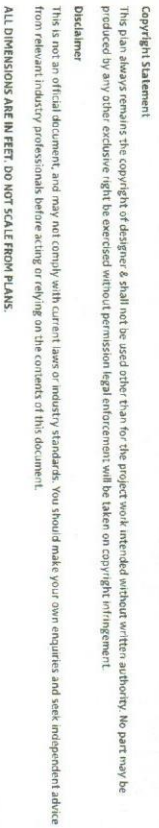

Signature \_\_\_\_\_

This plan always remains the copyright of designer & shall not be used other than for the project work intended without written authority. No part may be reproduced by any other exclusive right be exercised without permission legal enforcement will be taken on copyright infringement.

This is not an official document, and may not comply with current laws or industry standards. You should make your own enquiries and seek independent advice from relevant industry professionals before acting or relying on the contents of this document.

ALL DIMENSIONS ARE IN FEET. DO NOT SCALE FROM PLANS.

**Job no**

10

374 SW Paddock Ct, Lake City, FL 32024, USA  
APN: 31A51708920105

Spiegata 800

40

$$11 \pm 4$$

07/08/2023

04/13/2023

9