

## Columbia County Property Appraiser

Jeff Hampton

2021 Working Values

updated: 4/22/2021

Parcel: &lt;&lt; 29-2S-16-01777-114 (5799) &gt;&gt;

## Owner &amp; Property Info

Result: 1 of 1

Owner	BURCH ANGELA J 500 SE DUANE LN LAKE CITY, FL 32025-7350		
Site	188 CASTLEWOOD CT, LAKE CITY		
Description*	LOT 14 SUWANNEE VALLEY FARMS S/D PHASE 1. WD 1075-7, WD 1095-163, DIV 1207-1107		
Area	10.02 AC	S/T/R	29-2S-16E
Use Code**	SINGLE FAMILY (0100)	Tax District	3

\*The Description above is not to be used as the Legal Description for this parcel in any legal transaction.  
 \*\*The Use Code is a FL Dept. of Revenue (DOR) code and is not maintained by the Property Appraiser's office.  
 Please contact your city or county Planning & Zoning office for specific zoning information.

## Property &amp; Assessment Values

2020 Certified Values		2021 Working Values	
Mkt Land	\$58,450	Mkt Land	\$58,450
Ag Land	\$0	Ag Land	\$0
Building	\$51,268	Building	\$50,745
XFOB	\$12,882	XFOB	\$12,882
Just	\$122,600	Just	\$122,077
Class	\$0	Class	\$0
Appraised	\$122,600	Appraised	\$122,077
SOH Cap [?]	\$0	SOH Cap [?]	\$0
Assessed	\$122,600	Assessed	\$122,077
Exempt	HX H3 \$50,000	Exempt	\$0
Total Taxable	county: \$72,600 city: \$72,600 other: \$72,600 school: \$97,600	Total Taxable	county: \$122,077 city: \$0 other: \$0 school: \$122,077

Aerial Viewer Pictometry Google Maps

☒ 2019 ☐ 2016 ☐ 2013 ☐ 2010 ☐ 2007 ☐ 2005 ☐ Sales

## Sales History

Sale Date	Sale Price	Book/Page	Deed	V/I	Qualification (Codes)	RCode
8/28/2006	\$169,900	1095/0163	WD	V	Q	
2/17/2006	\$145,000	1075/0007	WD	V	Q	

## Building Characteristics

Bldg Sketch	Description*	Year Blt	Base SF	Actual SF	Bldg Value
Sketch	STRG/CONV (0102)	2018	788	1932	\$50,745

\*Bldg Desc determinations are used by the Property Appraisers office solely for the purpose of determining a property's Just Value for ad valorem tax purposes and should not be used for any other purpose.

## Extra Features &amp; Out Buildings (Codes)

Code	Desc	Year Blt	Value	Units	Dims
0166	CONC,PAVMT	2018	\$1,632.00	816.00	0 x 0
0169	FENCE/WOOD	2018	\$11,250.00	1.00	0 x 0

## Land Breakdown

Code	Desc	Units	Adjustments	Eff Rate	Land Value
0100	SFR (MKT)	1.000 LT (10.020 AC)	1.0000/1.0000 1.0000/1.6000000 /	\$55,200 /LT	\$55,200
9945	WELL/SEPT (MKT)	1.000 UT (0.000 AC)	1.0000/1.0000 1.0000/ /	\$3,250 /UT	\$3,250

Search Result: 1 of 1

# Columbia County Property Appraiser

Jeff Hampton | Lake City, Florida | 386-758-1083

## Owner & Property Info

Parcel ID: **29-2S-16-01777-114 (5799)**

Name	BURCH ANGELA J
Site Addr	188 CASTLEWOOD, LAKE CITY
Mailing	500 SE DUANE LN LAKE CITY, FL 32025-7350
Description	LOT 14 SUWANNEE VALLEY FARMS S/D PHASE 1. WD 1075-7,WD 1095 -163,DIV 1207-1107 29-2S-16-01777-114

	Bldg Item	Bldg Desc	Year Blt	Base S.F.	Actual S.F.	Bldg Value
<a href="#">Show Sub-Area Codes</a>	1	STRG/CONV (0102)	2018	788	1932	\$50,745.00

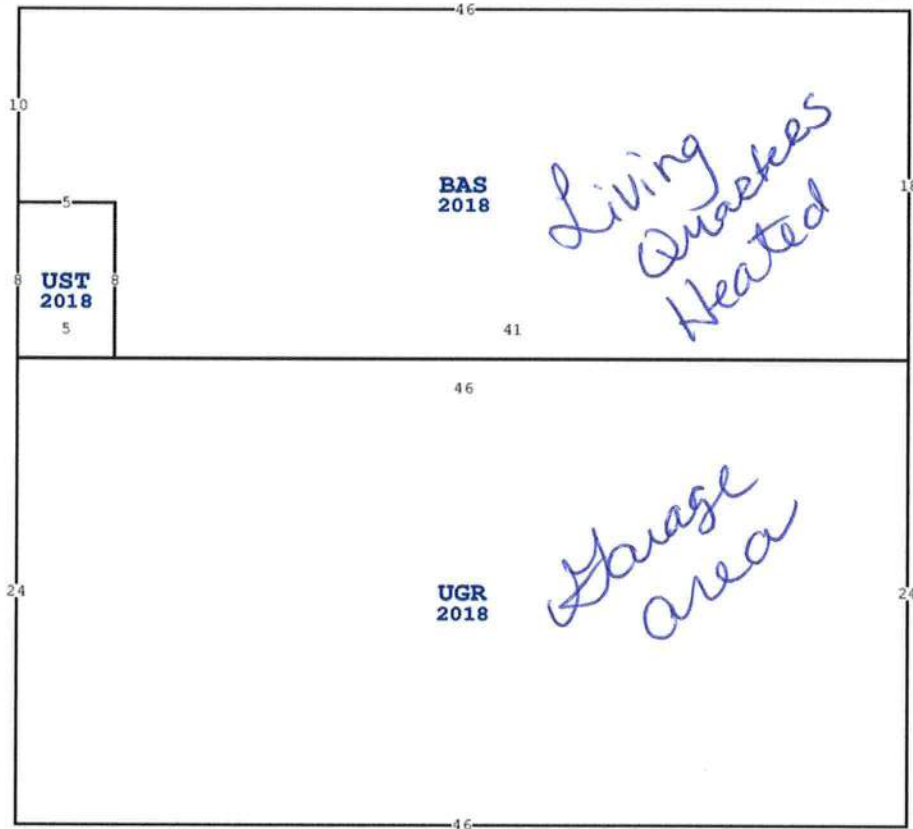

[Show All Buildings](#)



## Legend

2018Aerials



Parcels



Addresses



Roads

Roads

others

Dirt

Interstate

Main

Other

Paved

Private

2018 Flood Zones

0.2 PCT ANNUAL CHANCE

A

AE

AH

OfficialZoningAtlas

others

A-1

A-2

A-3

CG

CHI

CI

CN

CSV

ESA-2

I

ILW

MUD-I

PRD

PRRD

RMF-1

RMF-2

RO

RR

RSF-1

RSF-2

RSF-3

RSF/MH-1

RSF/MH-2

RSF/MH-3

DEFAULT

# Columbia County, FLA - Building & Zoning Property Map

Printed: Thu Apr 29 2021 09:51:11 GMT-0400 (Eastern Daylight Time)

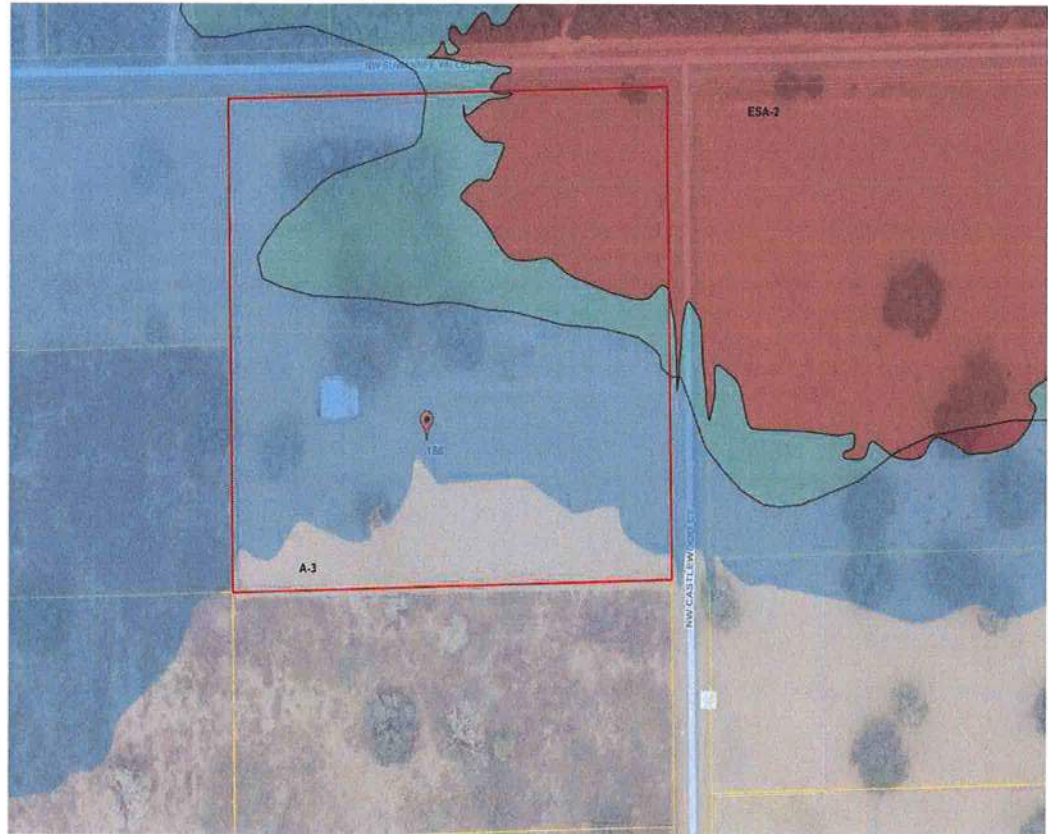

## Parcel Information

Parcel No: 29-2S-16-01777-114

Owner: BURCH ANGELA J

Subdivision: SUWANNEE VALLEY FARMS PHASE 1

Lot: 14

Acres: 10.0514622

Deed Acres: 10.02 Ac

District: District 1 Ronald Williams

Future Land Uses: Agriculture - 3, Environmentally Sensitive Areas -1

Flood Zones: AE, 0.2 PCT ANNUAL CHANCE FLOOD HAZARD,

Official Zoning Atlas: A-3, ESA-2

All data, information, and maps are provided "as is" without warranty or any representation of accuracy, timeliness of completeness. Columbia County, FL makes no warranties, express or implied, as to the use of the information obtained here. There are no implied warranties of merchantability or fitness for a particular purpose. The requester acknowledges and accepts all limitations, including the fact that the data, information, and maps are dynamic and in a constant state of maintenance, and update.