

**TYPICAL DESIGN WALL SECTION
NON - STRUCTURAL DATA**

SCALE: 1" = 1'-0"

ELECTRICAL LEGEND	
	CEILING FAN (PRE-WIRE FOR LIGHT KIT)
	DOUBLE SECURITY LIGHT
	2X4 FLUORESCENT LIGHT FIXTURE
	RECESSED CAN LIGHT
	BATH EXHAUST FAN WITH LIGHT
	BATH EXHAUST FAN
	LIGHT FIXTURE
	DUPLEX OUTLET
	220v OUTLET
	GFI DUPLEX OUTLET
	SMOKE DETECTOR
	WALL SWITCH
	3 WAY WALL SWITCH
	4 WAY WALL SWITCH
	WATER PROOF GFI OUTLET
	PHONE JACK
	TELEVISION JACK
	GARAGE DOOR OPENER
	CARBON MONOXIDE ALARM

ELECTRICAL PLAN NOTES:	
E - 1	WIRE ALL APPLIANCES, HVAC UNITS AND OTHER EQUIPMENT PER MANUF. SPECIFICATIONS
E - 2	CONSULT THE OWNER FOR THE NUMBER OF SEPERATE TELEPHONE LINES TO BE INSTALLED.
E - 3	ALL INSTALLATIONS SHALL BE PER NATL. ELECTRIC CODE.
E - 4	ALL SMOKE DETECTORS SHALL BE 120V W/ BATTERY BACKUP OF THE PHOTOELECTRIC TYPE, AND SHALL BE INTERLOCKED TOGETHER. INSTALL INSIDE AND NEAR ALL BEDROOMS.
E - 5	TELEPHONE, TELEVISION AND OTHER LOW VOLTAGE DEVICES OR OUTLETS SHALL BE AS PER THE OWNER'S DIRECTIONS, & IN ACCORDANCE W/ APPLICABLE SECTIONS OF NEC-LATEST EDITION.
E - 6	ELECTRICAL CONTR SHALL BE RESPONSIBLE FOR THE DESIGN & SIZING OF ELECTRICAL SERVICE AND CIRCUITS.
E - 7	ENTRY OF SERVICE (UNDERGROUND OR OVERHEAD) TO BE DETERMINED BY POWER COMPANY.
E - 8	ALL 120-VOLT, SINGLE-PHASE, 15- AND 20-AMPERE BRANCH CIRCUITS SUPPLYING OUTLETS INSTALLED IN DWELLING UNIT FAMILY ROOMS, DINING ROOMS, LIVING ROOMS, PARLORS, LIBRARIES, DENs, BEDROOMS, SUN ROOMS, RECREATION ROOMS, CLOSETS, HALLWAYS, OR SIMILAR ROOMS OR AREAS SHALL BE PROTECTED BY A LISTED ARC-FAULT CIRCUIT INTERRUPTER, COMBINATION-TYPE INSTALLED TO PROVIDE PROTECTION OF THE BRANCH CIRCUIT.
E - 9	ALL OUTLETS TO BE LOCATED ABOVE BASE FLOOD ELEVATION.
E - 10	A SERVICE DISCONNECT WITH OVER CURRENT PROTECTION SHALL BE INSTALLED OUTSIDE OF THE BUILDING, ON THE LOAD SIDE OF THE METER, AT THE PLACE ELECTRIC CONDUCTORS ENTER THE BUILDING. SERVICE ENTRANCE CONDUCTORS MAY NOT BE LOCATED INSIDE OF THE OF THE BUILDING WITHOUT SPECIAL APPROVAL OF THE BUILDING OFFICIAL.
E - 11	CARBON MONOXIDE ALARMS SHALL BE REQUIRED WITHIN 10' OF ALL ROOMS FOR SLEEPING PURPOSES IN BUILDINGS HAVING A FOSSIL-FUEL-BURNING HEATER OR APPLIANCE, A FIREPLACE, OR ATTACHED GARAGE.
E - 12	ALL OUTLETS LOCATED IN RESIDENTIAL TO BE TAMPER-RESISTANT PER NEC.
E - 13	A MINIMUM OF 75% OF PERMANENTLY INSTALLED LAMPS OR LIGHTING FIXTURES SHALL BE HIGH EFFICACY 2017 FBC EC SEC. R404.1

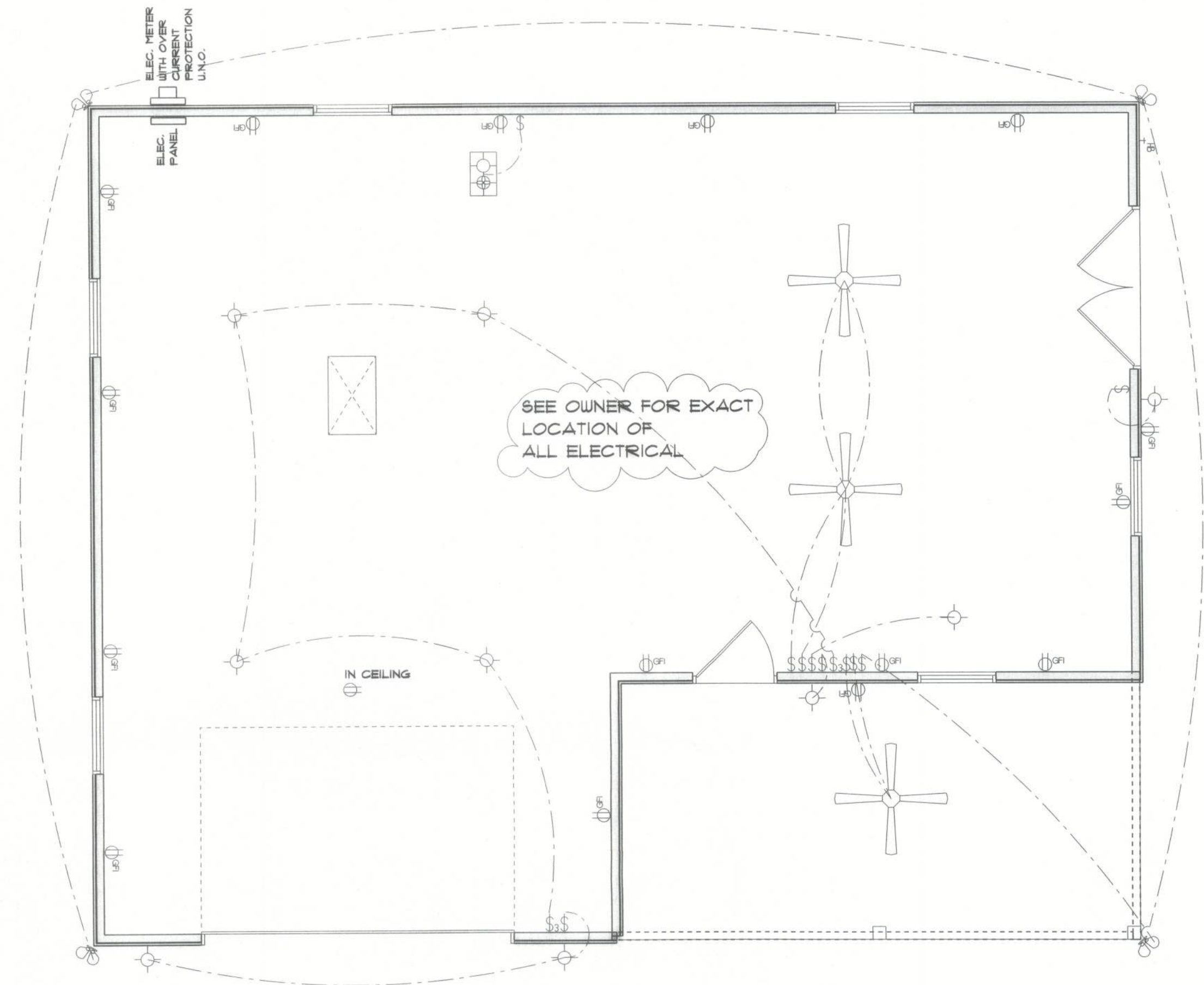

ELECTRICAL PLAN
SCALE: 1/4" = 1'-0"

Bob Nichol Garage / Workshop

PROJECT ADDRESS:

217 SW Dragonfly Ct, Lake City, FL 32024

FL PE 53915

This item has been digitally signed and sealed by Mark Disosway, P.E. on 5/5/2023. Signature date: 5/5/2023. Printed name of the signatory is not considered sufficient and sealing and the signature must be verified on any electronic copy.

5/5/2023

STATE OF FLORIDA

PROFESSIONAL ENGINEER

DIMENSIONS:

Stated dimensions supersede scaled dimensions. Refer all questions to Mark Disosway, P.E. for resolution. Do not proceed without clarification.

COPYRIGHTS AND PROPERTY RIGHTS:

Mark Disosway, P.E. hereby expressly reserves its common law copyrights and property right in these instruments of service. This document is not to be reproduced, altered or copied in any form or manner without first the express written permission and consent of Mark Disosway.

CERTIFICATION:

I hereby certify that I have examined this plan, and that the applicable portions of the plan, relating to wind engineering comply with the 7th Edition Florida Building Code Residential (2020) to the best of my knowledge.

LIMITATION:

This design is valid for one building, at specified location.

Mark Disosway P.E.

163 SW Midtown Place

Suite 103

Lake City, Florida 32025

386.754.5419

disoswaydesign@gmail.com

JOB NUMBER:

230385

2

OF 4 SHEETS