

DATE 09/28/2010

Columbia County Building Permit

PERMIT

This Permit Must Be Prominently Posted on Premises During Construction

000028890

APPLICANT RALPH YATES PHONE 904.635.9313
ADDRESS 107 ZIBRA STREET MIDDLEBURG FL 32068
OWNER HELEN GUETHERMAN PHONE 386.758.5862
ADDRESS 2965 SW MAYO ROAD LAKE CITY FL 32055
CONTRACTOR ALFRED NYMAN PHONE 407.551.6991

LOCATION OF PROPERTY 90-W TO C-252, TL TO MAYO RD, TR HOME ON L CORNER OF
C-252 & MAYO ROAD.

TYPE DEVELOPMENT WINDOWS/DOOR REPL. ESTIMATED COST OF CONSTRUCTION 6285.00

HEATED FLOOR AREA TOTAL AREA HEIGHT STORIES

FOUNDATION WALLS ROOF PITCH FLOOR

LAND USE & ZONING MAX. HEIGHT

Minimum Set Back Requirments: STREET-FRONT REAR SIDE

NO. EX.D.U. 1 FLOOD ZONE DEVELOPMENT PERMIT NO.

PARCEL ID 01-4S-15-00314-007 SUBDIVISION

LOT BLOCK PHASE UNIT TOTAL ACRES

CGC012538

Culvert Permit No. Culvert Waiver Contractor's License Number Applicant/Owner/Contractor Ralph Yates
EXISTING X-10-366 JLW N
Driveway Connection Septic Tank Number LU & Zoning checked by Approved for Issuance New Resident

COMMENTS: NOC ON FILE.

Check # or Cash 3574

FOR BUILDING & ZONING DEPARTMENT ONLY

(footer/Slab)

Temporary Power Foundation Monolithic
date/app. by date/app. by date/app. by

Under slab rough-in plumbing Slab Sheathing/Nailing
date/app. by date/app. by date/app. by

Framing Insulation
date/app. by date/app. by

Rough-in plumbing above slab and below wood floor Electrical rough-in
date/app. by date/app. by

Heat & Air Duct Peri. beam (Lintel) Pool
date/app. by date/app. by date/app. by

Permanent power C.O. Final Culvert
date/app. by date/app. by date/app. by

Pump pole Utility Pole M/H tie downs, blocking, electricity and plumbing
date/app. by date/app. by date/app. by

Reconnection RV Re-roof
date/app. by date/app. by date/app. by

BUILDING PERMIT FEE \$ 35.00 CERTIFICATION FEE \$ 0.00 SURCHARGE FEE \$ 0.00

MISC. FEES \$ 0.00 ZONING/CERT. FEE \$ FIRE FEE \$ 0.00 WASTE FEE \$

FLOOD DEVELOPMENT FEE \$ FLOOD ZONE FEE \$ CULVERT FEE \$ TOTAL FEE 35.00

INSPECTORS OFFICE CLERKS OFFICE

NOTICE: IN ADDITION TO THE REQUIREMENTS OF THIS PERMIT, THERE MAY BE ADDITIONAL RESTRICTIONS APPLICABLE TO THIS PROPERTY THAT MAY BE FOUND IN THE PUBLIC RECORDS OF THIS COUNTY. AND THERE MAY BE ADDITIONAL PERMITS REQUIRED FROM OTHER GOVERNMENTAL ENTITIES SUCH AS WATER MANAGEMENT DISTRICTS, STATE AGENCIES, OR FEDERAL AGENCIES.

"WARNING TO OWNER: YOUR FAILURE TO RECORD A NOTICE OF COMMENCEMENT MAY RESULT IN YOUR PAYING TWICE FOR IMPROVEMENTS TO YOUR PROPERTY. IF YOU INTEND TO OBTAIN FINANCING, CONSULT WITH YOUR LENDER OR AN ATTORNEY BEFORE RECORDING YOUR NOTICE OF COMMENCEMENT."

EVERY PERMIT ISSUED SHALL BECOME INVALID UNLESS THE WORK AUTHORIZED BY SUCH PERMIT IS COMMENCED WITHIN 180 DAYS AFTER ITS ISSUANCE, OR IF THE WORK AUTHORIZED BY SUCH PERMIT IS SUSPENDED OR ABANDONED FOR A PERIOD OF 180 DAYS AFTER THE TIME THE WORK IS COMMENCED. A VALID PERMIT RECIEVES AN APPROVED INSPECTION EVERY 180 DAYS. WORK SHALL BE CONSIDERED NOT SUSPENDED, ABANDONED OR INVALID WHEN THE PERMIT HAS RECIEVED AN APPROVED INSPECTION WITHIN 180 DAYS OT THE PREVIOUS INSPECTION.

The Issuance of this Permit Does Not Waive Compliance by Permittee with Deed Restrictions.

This Instrument Prepared by: Ralph Yates
Name: SEARS HOME IMPROVEMENT PRODUCTS, INC.
1024 Florida Central Parkway
Longwood, FL 32750
Phone: 407-551-6000

Inst:201012015653 Date:9/28/2010 Time:11:11 AM
DC,P.DeWitt Cason,Columbia County Page 1 of 1 B:1202 P:237

NOTICE OF COMMENCEMENT

Permit No. _____

Tax Folio No. 01-45-15-00314-007

THE UNDERSIGNED hereby gives, informs you that the improvement will be made to certain real property, and in accordance with Section 713.13 of the Florida Statutes, the following information is provided in this NOTICE OF COMMENCEMENT.

1. Description of property (legal description): COMM SE COR OF SEC, RUN N 52.91 FT TO N R/W CR-252 W. ALONG R/W 58.48 FT TO C/L OF MURRAY RD FOR POB CONT W 514.39 FT N 575.73 FT E 274.34 FT TO C/L MURRAY RD SE ALONG C/L 422.54 FT, CONT SE ALONG C/L 197.06 FT TO POB 2965 SW MAYO RD.
2. General description of improvements: WINDOW & DOOR Replacement
3. Owner Information
- a) Name and address: HELEN B. GUETHERMAN 2965 SW MAYO RD LAKE CITY, FL. 32055
- b) Name and address of fee simple titleholder (if other than owner) _____
- c) Interest in property: 100%
4. Contractor Information:
- a) Name and address: SEARS HOME IMPROVEMENT PRODUCTS, INC. - ALFRED NYMAN 1024 FLORIDA CENTRAL PARKWAY, LONGWOOD, FL 32750
- b) Telephone No.: 407-551-6000 Fax No. (Opt.) 407-767-8536
5. Surety Information:
- a) Name and address: NA
- b) Amount of Bond: _____
- c) Telephone No.: _____ Fax No. (Opt.) _____
6. Lender
- a) Name and address: _____ Phone No.: _____
7. Identity of person within the State of Florida designated by owner upon who notices or other documents may be served:
- a) Name and address: NA
- b) Telephone No.: _____
8. In addition to himself, owner designates the following person to receive a copy of the Lien or's Notice as provided in Section 713.13 (1) (b), Florida Statutes:
- a) Name and address: NA
- b) Telephone No.: _____ Fax No. (Opt.) _____
9. Expiration date of Notice of Commencement (the expiration date is one year from the date of recording unless a different date is specified): NA

WARNING TO OWNER: ANY PAYMENTS MADE BY THE OWNER AFTER THE EXPIRATION OF THE NOTICE OF COMMENCEMENT ARE CONSIDERED IMPROPER PAYMENTS UNDER CHAPTER 713, PART I, SECTION 713.13, FLORIDA STATUTES, AND CAN RESULT IN YOUR PAYING TWICE FOR IMPROVEMENTS TO YOUR PROPERTY. A NOTICE OF COMMENCEMENT MUST BE RECORDED AND POSTED ON THE JOB SITE BEFORE THE FIRST INSPECTION. IF YOU INTEND TO OBTAIN FINANCING, CONSULT YOUR LENDER OR AN ATTORNEY BEFORE COMMENCING WORK OR RECORDING YOUR NOTICE OF COMMENCEMENT.

STATE OF FLORIDA
COUNTY OF Columbia

NOTARY PUBLIC-STATE OF FLORIDA
Chester J. Winegar
Commission #DD759460
Expires: FEB. 17, 2012
BONDED THRU ATLANTIC BONDING CO., INC.

Helen B. Guetherman
Signature of Owner or Owner's Authorized Officer/Director/Partner/Manager
HELEN B. GUETHERMAN
PRINT NAME

The foregoing instrument was acknowledged before me this 17 day of SEPT, 20 10, by CHESTER J. WINEGAR as OFFICER (type of authority, e.g. officer, trustee, attorney in fact) for HELEN B. GUETHERMAN (name of party on behalf of whom instrument was executed).

Personally Known _____ OR Produced Identification ☒

Type of Identification Produced FDL

Notary Signature Chester J. Winegar
Name (print) CHESTER J. WINEGAR
AND

Verification pursuant to Section 92.525, Florida Statutes. Under penalties of perjury, I declare that I have read the foregoing and that the facts stated in it are true to the best of my knowledge and belief.

Helen B. Guetherman
Signature of Natural Person Signing Above

Columbia County Building Permit Application

| | | | | | |
|--|-----------------|--------------------------------------|---------------------------|--|-----------------------|
| For Office Use Only | | Application # <u>1009-53</u> | Date Received <u>9/28</u> | By <u>JA</u> | Permit # <u>28890</u> |
| Zoning Official _____ | Date _____ | Flood Zone _____ | Land Use _____ | Zoning _____ | |
| FEMA Map # _____ | Elevation _____ | MFE _____ | River _____ | Plans Examiner _____ | Date _____ |
| Comments _____ | | | | | |
| <input checked="" type="checkbox"/> NOC <input checked="" type="checkbox"/> EH <input checked="" type="checkbox"/> Deed or PA <input type="checkbox"/> Site Plan <input type="checkbox"/> State Road Info <input type="checkbox"/> Parent Parcel # _____ | | | | | |
| <input type="checkbox"/> Dev Permit # _____ | | <input type="checkbox"/> In Floodway | | <input checked="" type="checkbox"/> Letter of Auth. from Contractor <u>on 7/16</u> <input type="checkbox"/> F W Comp. letter | |
| IMPACT FEES: EMS _____ | | Fire _____ | Corr _____ | Road/Code _____ | |
| School _____ | | = TOTAL <u>0</u> | | | |

Septic Permit No. X-10-366 Fax _____

Name Authorized Person Signing Permit Ralph YATES Phone 904-635-9313

Address 107 ZIBRA ST. MIDDLEBERG, FL. 32068

Owners Name HELEN B. GUETHERMAN Phone 386-758-5862

911 Address 2965 SW MAYO RD LAKE CITY, FL. 32055

Contractors Name ALFRED NYMAN SEARS HOME IMPROVEMENT PRODUCTS, INC. Phone 407-551-6991

Address 1024 FLORIDA CENTRAL PARKWAY, LONGWOOD, FL. 32750

Fee Simple Owner Name & Address NA

Bonding Co. Name & Address _____

Architect/Engineer Name & Address _____

Mortgage Lenders Name & Address _____

Circle the correct power company - FL Power & Light - Clay Elec. - Suwannee Valley Elec. - Progress Energy

Property ID Number 01-45-15-00314-007 Estimated Cost of Construction 6285.00

Subdivision Name _____ Lot _____ Block _____ Unit _____ Phase _____

Driving Directions TAKE 90 WEST (W. DUVAL ST.) TURN LEFT ON CR 252 (SW PINEMOUNT RD) TURN RIGHT ON MAYO RD, HOME ON LEFT HAND CORNER OF CR 252 + MAYO RD

Construction of REPLACEMENT WINDOWS + Sliding Glass Door (SIZE FOR SIZE) Number of Existing Dwellings on Property _____

Do you need a - Culvert Permit or Culvert Waiver or Have an Existing Drive Total Acreage _____ Lot Size _____

Actual Distance of Structure from Property Lines - Front _____ Side _____ Side _____ Rear _____

Number of Stories _____ Heated Floor Area _____ Total Floor Area _____ Roof Pitch _____

Application is hereby made to obtain a permit to do work and installations as indicated. I certify that no work or installation has commenced prior to the issuance of a permit and that all work be performed to meet the standards of all laws regulating construction in this jurisdiction. **CODE:** Florida Building Code 2007 with 2009 Supplements and the 2008 National Electrical Code.

Page 1 of 2 (Both Pages must be submitted together.) Revised 6-19-09

Columbia County Building Permit Application

TIME LIMITATIONS OF APPLICATION : An application for a permit for any proposed work shall be deemed to have been abandoned 180 days after the date of filing, unless such application has been pursued in good faith or a permit has been issued; except that the building official is authorized to grant one or more extensions of time for additional periods not exceeding 90 days each. The extension shall be requested in writing and justifiable cause demonstrated.

TIME LIMITATIONS OF PERMITS: Every permit issued shall become invalid unless the work authorized by such permit is commenced within 180 days after its issuance, or if the work authorized by such permit is suspended or abandoned for a period of 180 days after the time work is commenced. A valid permit receives an approved inspection every 180 days. Work shall be considered not suspended, abandoned or invalid when the permit has received an approved inspection within 180 days of the previous approved inspection.

FLORIDA'S CONSTRUCTION LIEN LAW: Protect Yourself and Your Investment: According to Florida Law, those who work on your property or provide materials, and are not paid-in-full, have a right to enforce their claim for payment against your property. This claim is known as a construction lien. If your contractor fails to pay subcontractors or material suppliers or neglects to make other legally required payments, the people who are owed money may look to your property for payment, even if you have paid your contractor in full. This means if a lien is filed against your property, it could be sold against your will to pay for labor, materials or other services which your contractor may have failed to pay.

NOTICE OF RESPONSIBILITY TO BUILDING PERMITEE: **YOU ARE HEREBY NOTIFIED** as the recipient of a building permit from Columbia County, Florida, you will be held responsible to the County for any damage to sidewalks and/or road curbs and gutters, concrete features and structures, together with damage to drainage facilities, removal of sod, major changes to lot grades that result in ponding of water, or other damage to roadway and other public infrastructure facilities caused by you or your contractor, subcontractors, agents or representatives in the construction and/or improvement of the building and lot for which this permit is issued. No certificate of occupancy will be issued until all corrective work to these public infrastructures and facilities has been corrected.

WARNING TO OWNER: YOUR FAILURE TO RECORD A NOTICE OF COMMENCEMENT MAY RESULT IN YOU PAYING TWICE FOR IMPROVEMENTS TO YOUR PROPERTY. A NOTICE OF COMMENCEMENT MUST BE RECORDED AND POSTED ON THE JOB SITE BEFORE THE FIRST INSPECTION. IF YOU INTEND TO OBTAIN FINANCING, CONSULT WITH YOUR LENDER OR ATTORNEY BEFORE RECORDING YOUR NOTICE OF COMMENCEMENT.

OWNERS CERTIFICATION: I CERTIFY THAT ALL THE FOREGOING INFORMATION IS ACCURATE AND THAT ALL WORK WILL BE DONE IN COMPLIANCE WITH ALL APPLICABLE LAWS REGULATING CONSTRUCTION AND ZONING.

NOTICE TO OWNER: There are some properties that may have deed restrictions recorded upon them. These restrictions may limit or prohibit the work applied for in your building permit. It may be to your advantage to check and see if your property is encumbered by any restrictions.

(Owners Must Sign All Applications Before Permit Issuance.)

Owners Signature

****OWNER BUILDERS MUST PERSONALLY APPEAR AND SIGN THE BUILDING PERMIT.**

CONTRACTORS AFFIDAVIT: By my signature I understand and agree that I have informed and provided this written statement to the owner of all the above written responsibilities in Columbia County for obtaining this Building Permit including all application and permit time limitations.

 ALFRED NYMAN
Contractor's Signature (Permitee)

Contractor's License Number CGC012538
Columbia County
Competency Card Number _____

Affirmed under penalty of perjury to by the Contractor and subscribed before me this 17th day of Sept 2010.
Personally known _____ or Produced Identification _____

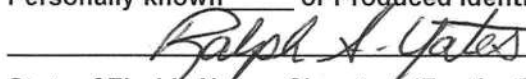
State of Florida Notary Signature (For the Contractor)

SEAL:

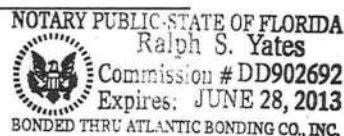

Columbia County Property Appraiser

DB Last Updated: 8/5/2010

2009 Tax Roll Year

Parcel: 01-4S-15-00314-007

<< Next Lower Parcel | Next Higher Parcel >>

Tax Collector

Tax Estimator

Property Card

Parcel List Generator

Interactive GIS Map

Print

Search Result: 1 of 1

Owner & Property Info

| | | | |
|------------------|---|--------------|------|
| Owner's Name | GUETHERMAN RONALD J & HELEN B | | |
| Mailing Address | 2965 SW MAYO RD LAKE CITY, FL 32055 | | |
| Site Address | 2965 SW MAYO RD | | |
| Use Desc. (code) | MOBILE HOM (000200) | | |
| Tax District | 3 (County) | Neighborhood | 1415 |
| Land Area | 5.250 ACRES | Market Area | 01 |
| Description | NOTE: This description is not to be used as the Legal Description for this parcel in any legal transaction. COMM SE COR OF SEC, RUN N 52.91 FT TO N R/W CR-252, W ALONG R/W 58.48 FT TO C/L OF MURRAY RD FOR POB, CONT W 514.39 FT, N 575.73 FT, E 274.34 FT TO C/L MURRAY RD, SE ALONG C/L 422.54 FT, CONT SE ALONG C/L 197.06 FT TO POB. ORB 777-613 | | |

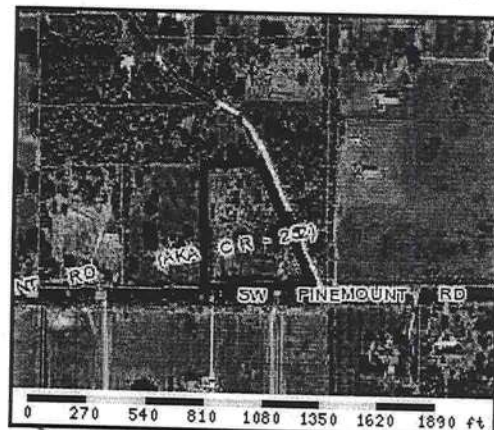

Property & Assessment Values

| 2009 Certified Values | | |
|-----------------------|---|-------------|
| Mkt Land Value | cnt: (0) | \$44,014.00 |
| Ag Land Value | cnt: (2) | \$0.00 |
| Building Value | cnt: (1) | \$31,394.00 |
| XFOB Value | cnt: (1) | \$1,800.00 |
| Total Appraised Value | | \$77,208.00 |
| Just Value | | \$77,208.00 |
| Class Value | | \$0.00 |
| Assessed Value | | \$62,828.00 |
| Exempt Value | (code: HX VX SX) | \$62,828.00 |
| Total Taxable Value | Cnty: \$0 Other: \$20,000 Schl: \$32,828 | |

2010 Working Values

NOTE:

2010 Working Values are NOT certified values and therefore are subject to change before being finalized for ad valorem assessment purposes.

Show Working Values

Sales History

Show Similar Sales within 1/2 mile

| Sale Date | OR Book/Page | OR Code | Vacant / Improved | Qualified Sale | Sale RCode | Sale Price |
|-----------|--------------|---------|-------------------|----------------|------------|-------------|
| 7/1/1993 | 777/613 | WD | I | U | 12 | \$25,000.00 |

Building Characteristics

| Bldg Item | Bldg Desc | Year Blt | Ext. Walls | Heated S.F. | Actual S.F. | Bldg Value |
|--|---------------------|----------|----------------|-------------|-------------|-------------|
| 1 | MOBILE HME (000800) | 1993 | WD ON PLY (08) | 1680 | 1960 | \$28,235.00 |
| Note: All S.F. calculations are based on exterior building dimensions. | | | | | | |

Extra Features & Out Buildings

| Code | Desc | Year Blt | Value | Units | Dims | Condition (% Good) |
|------|------------|----------|------------|-------------|-----------|--------------------|
| 0297 | SHED CONCR | 0 | \$1,800.00 | 0000001.000 | 0 x 0 x 0 | (000.00) |

Land Breakdown

| Lnd Code | Desc | Units | Adjustments | Eff Rate | Lnd Value |
|----------|-----------------|------------------------|---------------------|------------|-------------|
| 000200 | MBL HM (MKT) | 5.25 AC | 1.00/1.00/1.00/1.00 | \$7,202.52 | \$37,813.00 |
| 009945 | WELL/SEPT (MKT) | 1 UT - (0000000.000AC) | 1.00/1.00/1.00/1.00 | \$2,000.00 | \$2,000.00 |

Columbia County Property Appraiser

DB Last Updated: 8/5/2010

DISCLAIMER

This information was derived from data which was compiled by the Columbia County Property Appraiser Office solely for the governmental purpose of property assessment. This information should not be relied upon by anyone as a determination of the ownership of property or market value. No warranties, expressed or

2965 SW MAYO RD.

GUETHERMAN

PRODUCT APPROVAL SPECIFICATION SHEET

As required by Florida Statute 553.842 and Florida Administrative Code 9B-72, please provide the information and approval numbers on the building components listed below if they will be utilized on the construction project for which you are applying for a building permit. We recommend you contact your local product supplier should you not know the product approval number for any of the applicable listed products. Statewide approved products are listed online @ www.floridabuilding.org

| Category/Subcategory | Manufacturer | Product Description | Approval Number(s) |
|--|--------------|-------------------------|--------------------|
| 1. EXTERIOR DOORS | | | |
| A. SWINGING | | | |
| B. <u>SLIDING</u> | WINCORE | 7700 SLIDING GLASS DOOR | 12535.2 |
| C. SECTIONAL/ROLL UP | | | |
| D. OTHER | | | |
| 2. WINDOWS | | | |
| A. SINGLE <u>DOUBLE HUNG</u> | WINCORE | 7700 DH PVC | 10924.3 |
| B. HORIZONTAL SLIDER | | | |
| C. CASEMENT | | | |
| D. FIXED | | | |
| E. MULLION | | | |
| F. SKYLIGHTS | | | |
| G. OTHER | | | |
| 3. PANEL WALL | | | |
| A. SIDING | | | |
| B. SOFFITS | | | |
| C. STOREFRONTS | | | |
| D. GLASS BLOCK | | | |
| E. OTHER | | | |
| 4. ROOFING PRODUCTS | | | |
| A. ASPHALT SHINGLES | | | |
| B. NON-STRUCT METAL | | | |
| C. ROOFING TILES | | | |
| D. SINGLE PLY ROOF | | | |
| E. OTHER | | | |
| 5. STRUCT COMPONENTS | | | |
| A. WOOD CONNECTORS | | | |
| B. WOOD ANCHORS | | | |
| C. TRUSS PLATES | | | |
| D. INSULATION FORMS | | | |
| E. LINTELS | | | |
| F. OTHERS | | | |
| 6. NEW EXTERIOR ENVELOPE PRODUCTS | | | |
| A. | | | |

The products listed below did not demonstrate product approval at plan review. I understand that at the time of inspection of these products, the following information must be available to the inspector on the jobsite; 1) copy of the product approval, 2) performance characteristics which the product was tested and certified to comply with, 3) copy of the applicable manufacturers installation requirements. Further, I understand these products may have to be removed if approval cannot be demonstrated during inspection.

Ralph Yates
APPLICANT SIGNATURE

9-27-10
DATE

Offer Code:



WINDOW PROPOSAL WORKSHEET

Date:

9-21-10

Phone:

386-758-5862

Customer:

Helen Guetherman

City:

LAKA City FL

Office Loc. and #:

JACKSONVILLE

Sales Rep:

CHET WINIEGAR

Job No./Lead No.:

10847463

ENTER WIDTH & HEIGHT
FOR EACH UNIT TO BE
REPLACED AND ENTER
CORRESPONDING NUMBER

| WD | HT | WD | HT | WD | HT |
|----|----|----|----|----|----|
| 34 | 52 | 46 | 52 | X | # |
| 34 | 52 | 54 | 52 | X | # |

| WD | LEFT | HT |
|----|------|----|
| # | X | |
| # | X | |
| # | X | |
| # | X | |
| # | X | |
| # | X | |

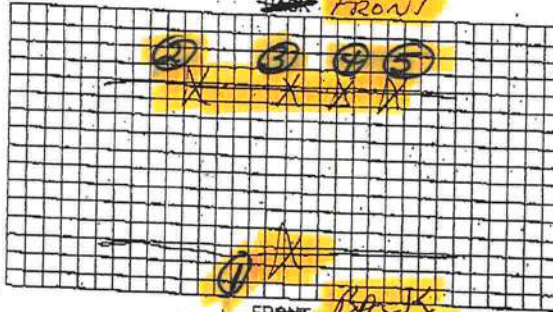

| WD | RIGHT | HT |
|----|-------|----|
| # | X | |
| # | X | |
| # | X | |
| # | X | |
| # | X | |
| # | X | |

Series WeatherBeater
Plus

| WD | HT | WD | HT | WD | HT |
|----|----|----|----|----|----|
| 1 | 72 | 80 | X | # | X |
| # | # | X | # | X | # |

For second story - use additional worksheet

| ITEM | MODEL | COLOR | U.I. | GLASS | SCREEN | GRID | TEMP/OBS | \$ AMOUNT |
|------|-------|-------|-------|-------|--------|------|----------|-----------|
| 1 | PD | WHT | 22x80 | E2 | Full | | | 3107 |
| 2 | DH | | 98 | | | | | 935 |
| 3 | DH | | 98 | | | | | 935 |
| 4 | DH | | 98 | | | | | 935 |
| 5 | DH | | 98 | | | | | 935 |
| 6 | | | | | | | | |
| 7 | | | | | | | | |
| 8 | | | | | | | | |
| 9 | | | | | | | | |
| 10 | | | | | | | | |
| 11 | | | | | | | | |
| 12 | | | | | | | | |
| 13 | | | | | | | | |
| 14 | | | | | | | | |
| 15 | | | | | | | | |
| 16 | | | | | | | | |
| 17 | | | | | | | | |
| 18 | | | | | | | | |

| | |
|--------------------------------------|----------|
| Detail additional labor and charges: | Total \$ |
| ASP 5 C 55 | 275 |
| Build out | 230 |

SPECIAL INSTRUCTIONS:

*Bays/Bows: Specify window type (ie, casement DH, etc.)

VOLUME SAVINGS

| RETAIL PRICE | DISCOUNT |
|---------------------------|----------|
| \$1,500.00 - \$2,499.00 | 5% |
| \$2,500.00 - \$12,999.00 | 10% |
| \$13,000 - \$22,999.00 | 15% |
| \$23,000.00 - \$27,999.00 | 20% |
| \$28,000.00 & Up | 25% |

OFFICE USE ONLY

RATE:

SALES MANAGER APPROVAL

21-B Rev. 03/02

2% Travel

Auditing Manager

Volume Savings

SUB TOTAL

Other

I.V.D. (Coupon)

TOTAL

| MODEL | |
|----------------|-------------------|
| PD | Patio Door |
| DH | Double Hung |
| 2LR | Two-Lite Roller |
| EV | Three-Lite Roller |
| PW | Picture |
| SH | Single Hung |
| 1LR | Single Slider |
| CR | Casement Right |
| CL | Casement Left |
| AWN | Awning |
| HOP | Hopper |
| GW | Garden Window |
| BAY | Bay |
| BOW | Bow |
| COLOR: | |
| White | |
| Tan | |
| LWG | Light Woodgrain |
| DWG | Dark Woodgrain |
| GLASS: | |
| CLE | Clear |
| Hy-Lite | Block |
| E2 | Low E/Square |
| GRAY | Gray Tint |
| BRZ | Bronze |
| OBS | Obscure |
| OBSBOT | Obs. Bottom |
| KEEP | Keepsafe |
| TEMP | Tempered |
| GRIDS: | |
| CF | Colonial Full |
| CT | Colonial Top |
| DF | Diamond Full |
| DT | Diamond Top |
| SCULP | Sculptured |
| PER | Perimeter |
| PRA | Prairie |
| SCREENS: | |
| FULL OR HALF | |
| ALUM. | |
| MISCELLANEOUS: | |
| MULL | Mullions |
| CAP | Cap Facing |





Product Approval

USER: Public User

[Product Approval Menu](#) > [Product or Application Search](#) > [Application List](#) > **Application Detail**

FL # FL12535
Application Type New
Code Version 2007
Application Status Approved
Comments
Archived

Product Manufacturer Wincore Window Company, LLC
Address/Phone/Email 250 Staunton Avenue
Parkersburg, WV 26104
(304) 485-7463 Ext 217
jmliller@wincorewindows.com

Authorized Signature Luis Lomas
rllomas@lrlomaspe.com

Technical Representative
Address/Phone/Email

Quality Assurance Representative
Address/Phone/Email

Category Exterior Doors
Subcategory Sliding Exterior Door Assemblies

Compliance Method Certification Mark or Listing

Certification Agency Keystone Certifications, Inc.
Validated By Keystone Certifications, Inc.

| Referenced Standard and Year (of Standard) | <u>Standard</u> | <u>Year</u> |
|--|------------------------------|-------------|
| | AAMA/WDMA/CSA 101/I.S.2/A440 | 2005 |

Equivalence of Product Standards
Certified By

Product Approval Method Method 1 Option A

Date Submitted 04/30/2009
Date Validated 05/05/2009

- ▶ COMMUNITY PLANNING
- ▶ HOUSING & COMMUNITY DEVELOPMENT
- ▶ EMERGENCY MANAGEMENT
- ▶ OFFICE OF THE SECRETARY

| Summary of Products | | |
|--|--|---|
| FL # | Model, Number or Name | Description |
| 12535.1 | S7500/7700/9900 PVC SLIDING GLASS PATIO DOOR | S7500/7700/9900 PVC SLIDING GLASS PATIO DOOR - OXXO (142x82) |
| Limits of Use Approved for use in HVHZ: No Approved for use outside HVHZ: Yes Impact Resistant: No Design Pressure: +25/-35 Other: Refer to installation instructions for additional ratings. | | Certification Agency Certificate FL12535_R0_C_CAC_456-419CAR.pdf Quality Assurance Contract Expiration Date 12/04/2011 Installation Instructions FL12535_R0_II_08-00738.pdf Verified By: Luis Roberto Lomas 62514 Created by Independent Third Party: Yes Evaluation Reports FL12535_R0_AE_511277.pdf Created by Independent Third Party: Yes |
| 12535.2 | S7500/7700/9900 PVC SLIDING GLASS PATIO DOOR | S7500/7700/9900 PVC SLIDING GLASS PATIO DOOR - OX, XO (71x82) |
| Limits of Use Approved for use in HVHZ: No Approved for use outside HVHZ: Yes Impact Resistant: No Design Pressure: +55/-55 Other: | | Certification Agency Certificate FL12535_R0_C_CAC_456-418CAR.pdf Quality Assurance Contract Expiration Date 03/04/2011 Installation Instructions FL12535_R0_II_08-00739.pdf Verified By: Luis Roberto Lomas 62514 Created by Independent Third Party: Yes Evaluation Reports FL12535_R0_AE_511278.pdf Created by Independent Third Party: Yes |

Back

Next

DCA Administration

Department of Community Affairs
Florida Building Code Online
Codes and Standards
2555 Shumard Oak Boulevard
Tallahassee, Florida 32399-2100
(850) 487-1824, Fax (850) 414-8436

© 2000-2005 The State of Florida. All rights reserved. Copyright and Disclaimer

Product Approval Accepts:



| REVISIONS | | |
|-----------|-------------|------|
| REV | DESCRIPTION | DATE |
| | | |
| | | |
| | | |

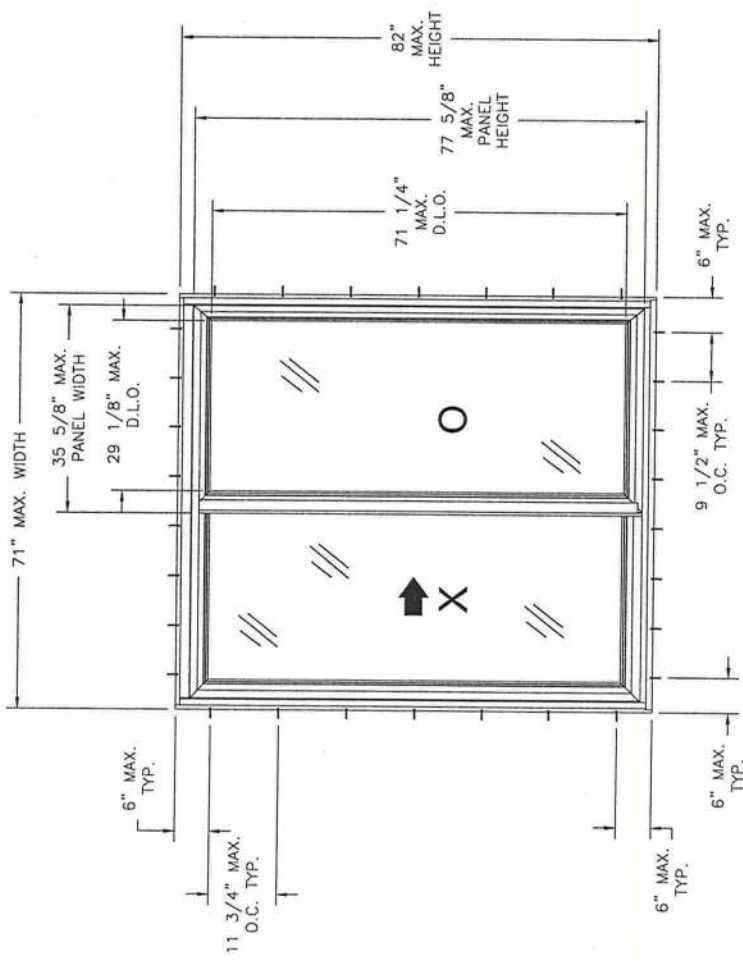

S7500/7700/9900 PVC SLIDING GLASS PATIO DOOR
EXTERIOR VIEW

| DESIGN/PRESSURE RATING | IMPACT RATING |
|------------------------|---------------|
| ±55PSF | NONE |

APPROVED CONFIGURATIONS: OX, XO

- NOTES:
- 1) THE PRODUCT SHOWN HEREIN IS DESIGNED AND MANUFACTURED TO COMPLY WITH REQUIREMENTS OF FLORIDA BUILDING CODE.
 - 2) WOOD FRAMING AND MASONRY OPENING TO BE DESIGNED AND ANCHORED TO PROPERLY TRANSFER ALL LOADS TO STRUCTURE. WOOD FRAMING AND MASONRY OPENING IS THE RESPONSIBILITY OF THE ARCHITECT OR ENGINEER OF RECORD.
 - 3) APPROVED IMPACT PROTECTIVE SYSTEM IS REQUIRED FOR THIS PRODUCT IN WIND BORNE DEBRIS REGIONS.
 - 4) UNITS MUST BE GLAZED PER ASTM E1300.
 - 5) ALLOWABLE STRESS INCREASE OF 1/3 WAS NOT USED IN THE DESIGN OF THE PRODUCT SHOWN HEREIN. WIND LOAD DURATION FACTOR Cd=1.6 WAS USED FOR WOOD ANCHOR CALCULATIONS.
 - 6) SHIM AS REQUIRED AT EACH INSTALLATION ANCHOR WITH LOAD BEARING SHIM. SHIM WHERE SPACE OF 1/16" OR GREATER OCCURS. MAXIMUM ALLOWABLE SHIM STACK TO BE 1/4".
 - 7) FOR ANCHORING INTO 2X BUCK OR WOOD FRAMING USE #10 WOOD SCREW OF SUFFICIENT LENGTH TO ACHIEVE A 1 3/8" MINIMUM EMBEDMENT INTO SUBSTRATE. LOCATE ANCHORS AS SHOWN IN ANCHORING LAYOUT AND INSTALLATION DETAILS.
 - 8) FOR ANCHORING INTO MASONRY/CONCRETE USE 3/16" ITW TAPCON OF SUFFICIENT LENGTH TO ACHIEVE A 1 1/4" MINIMUM EMBEDMENT INTO SUBSTRATE. LOCATE ANCHORS AS SHOWN IN ANCHORING LAYOUT AND INSTALLATION DETAILS.
 - 9) ALL FASTENERS TO BE CORROSION RESISTANT.
 - 10) INSTALLATION ANCHOR CAPACITIES FOR PRODUCTS HEREIN ARE BASED ON SUBSTRATE MATERIAL WITH THE FOLLOWING PROPERTIES:
 A. WOOD - G=0.42 MINIMUM SPECIFIC GRAVITY
 B. CONCRETE - 3,000PSI MINIMUM COMPRESSIVE STRENGTH
 C. MASONRY - STRENGTH CONFORMANCE TO ASTM C-90, GRADE N, TYPE 1 (OR GREATER).
 - 11) FRAME MATERIAL: RIGID PVC .095" THICK.

Digitally signed by Luis R. Lomas P.E.
Location: 1432 Woodford Rd
Lewisville, NC 27023
Date: 2009.04.30 22:34:23 -0400

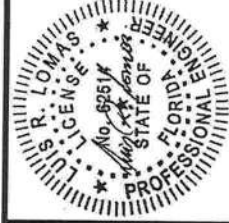

| | |
|--|---------------|
| WINCORE WINDOWS & DOORS | |
| 250 STAUNTON AVE. PARKERSBURG, WV 26102 | |
| S7500/7700/9900 PVC SLIDING GLASS PATIO DOOR | 71" x 82" |
| ELEVATION, ANCHORING AND NOTES | |
| DRAWN: TJH | REV: - |
| SCALE: NTS | DATE: 4/24/09 |
| NTS | SHEET 1 OF 5 |

| TABLE OF CONTENTS | |
|-------------------|--|
| SHEET NO. | DESCRIPTION |
| 1 | ELEVATION, ANCHORING AND NOTES |
| 2 | BILL OF MATERIALS |
| 3 | VERTICAL AND HORIZONTAL CROSS SECTIONS |
| 4 - 5 | INSTALLATION DETAILS |

| PARTS LIST | | | | | REVISIONS | | |
|------------|---------------------|----------------------------------|--------------|------------------|-----------|-------------|------|
| NO. | PART NUMBER | DESCRIPTION | MANUFACTURER | MATERIAL | REV | DESCRIPTION | DATE |
| 1 | 9619 | #BX2 3/4"TH QUADREX WOOD SCREW | P.H. TECH | STAINLESS STEEL | | | |
| 2 | 9853 | INSECT STOP 1" x 1" x 3/4" | P.H. TECH | | | | |
| 3 | 703 | HEAD WEATHERSTRIP | P.H. TECH | | | | |
| 4 | 8940 | SASH STOPPER | P.H. TECH | PVC | | | |
| 5 | 8941 | #BX1 1/4" PH QUADREX SCREW | P.H. TECH | STAINLESS STEEL | | | |
| 6 | 7003 | FIXED SASH ANCHOR BLOCK | P.H. TECH | PVC | | | |
| 7 | 9876 | #BX7/8" PH QUADREX SCREW | P.H. TECH | STAINLESS STEEL | | | |
| 8 | 723 | SILL DUST COVER | P.H. TECH | PVC | | | |
| 9 | 701 | FIXED SASH SUPPORT | P.H. TECH | PVC | | | |
| 10 | PB4B-8445-270 | INSECT STOP | SCHLEGEL | | | | |
| 11 | 9823 | 1/16" X 3/8" GLAZING TAPE | P.H. TECH | | | | |
| 12 | 9991 | OUTSIDE SILL GLAZING | P.H. TECH | ALUMINUM 6063-T5 | | | |
| 13 | 9867 | #BX5/8" PH QUADREX TEK SCREW | P.H. TECH | STAINLESS STEEL | | | |
| 14 | | GLASS | P.H. TECH | | | | |
| 15 | 7002 | HEAD PROFILE | P.H. TECH | PVC | | | |
| 16 | 9867 | SCREW CAP | P.H. TECH | PVC | | | |
| 17 | HF-7522-270 | WEATHERSTRIP | SCHLEGEL | | | | |
| 18 | 7508-F | FIXED HORIZONTAL RAIL | P.H. TECH | PVC | | | |
| 19 | DP4B-1.350X0.437 | WEATHERSTRIP | SCHLEGEL | | | | |
| 20 | 9732 | TANDEM WHEEL | P.H. TECH | | | | |
| 21 | 710-BLM66 | SILL WEATHERSTRIP | P.H. TECH | | | | |
| 22 | 9790 | SLIDING PANEL RAIL | P.H. TECH | ALUMINUM 6063-T5 | | | |
| 23 | 7000 | SILL | P.H. TECH | PVC | | | |
| 24 | 9734 | WEEP HOLE PLUG | P.H. TECH | PVC | | | |
| 25 | 9808 | WEEP HOLE COVER | P.H. TECH | PVC | | | |
| 26 | 9670/9671 | LEFT/RIGHT CAP | P.H. TECH | PVC | | | |
| 27 | 7523 | SASH COVERING CAP | P.H. TECH | PVC | | | |
| 28 | 9950-CAPUC | LOCK PLUG | P.H. TECH | PVC | | | |
| 29 | 9599 | CENTER STILE STEEL REINFORCEMENT | P.H. TECH | G-90 GALV. STEEL | | | |
| 30 | 7506 | CENTER STILE | P.H. TECH | PVC | | | |
| 31 | 7026 | INTERLOCK | P.H. TECH | PVC | | | |
| 32 | 9862/8842 | SLIDING CAP | P.H. TECH | PVC | | | |
| 33 | 9796 | #8 X 5/8" PH QUADREX SCREW | P.H. TECH | STAINLESS STEEL | | | |
| 34 | 8933 | SETTING BLOCK | P.H. TECH | PVC | | | |
| 35 | 5775.5770.5771.5772 | GLAZING BEAD | P.H. TECH | PVC | | | |
| 36 | 7547-F | FIXED SIDE STILE | P.H. TECH | PVC | | | |
| 37 | 7508-M | MOBILE HORIZONTAL RAIL | P.H. TECH | PVC | | | |
| 38 | PB-8320-187 | WEATHERSTRIP | SCHLEGEL | | | | |
| 39 | 7004 | JAMB PROFILE | P.H. TECH | PVC | | | |

PARTS LIST

| NO. | PART NUMBER | DESCRIPTION | MANUFACTURER | MATERIAL |
|-----|-------------|---------------------|--------------|------------------|
| 40 | 9598 | SASH REINFORCEMENT | P.H. TECH | G-90 GALV. STEEL |
| 41 | 7587-M | MOBILE SIDE STILE | P.H. TECH | PVC |
| 42 | PB-8420-270 | WEATHERSTRIP | SCHLEGEL | |
| 43 | 7042 | JAMB COVER (OPTION) | P.H. TECH | PVC |
| 44 | | SCREEN | P.H. TECH | |
| 45 | | HANDLE | P.H. TECH | |
| 46 | | TREMO SILGLAZE | TREMO | |

WINCORE WINDOWS & DOORS

250 STAUNTON AVE.
PARKERSBURG, WV 26102

S7500/7700/9900 PVC SLIDING GLASS PATIO DOOR
71" x 82"

BILL OF MATERIALS

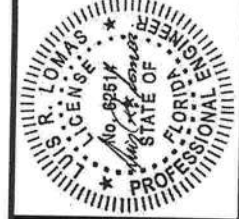

| | | |
|---------------|---------------------|-----------------|
| DRAWN: TJH | DWG NO. 08-00739 | REV 1 |
| SCALE NTS | DATE 4/24/09 | SHEET 2 OF 5 |

| REVISIONS | | | |
|-----------|-------------|------|----------|
| REV | DESCRIPTION | DATE | APPROVED |
| | | | |

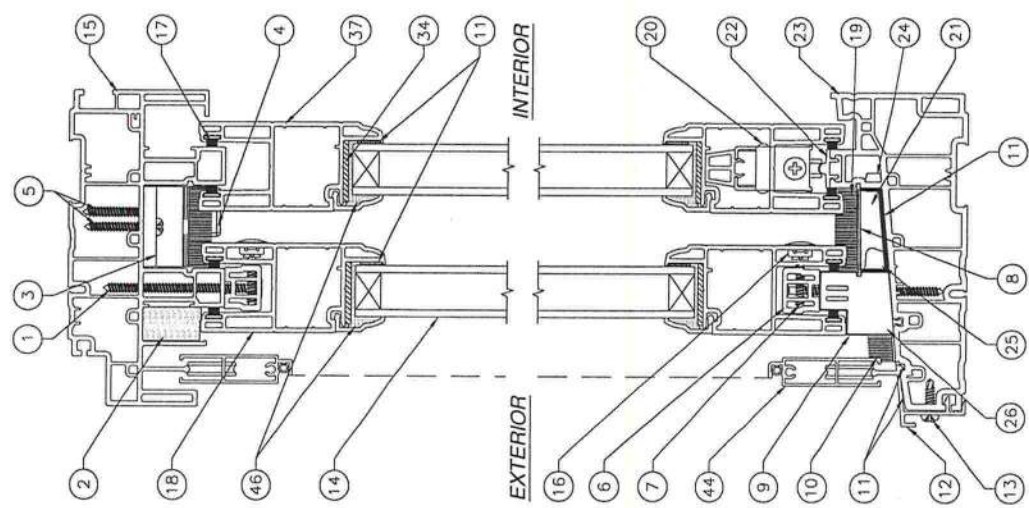

VERTICAL CROSS SECTION

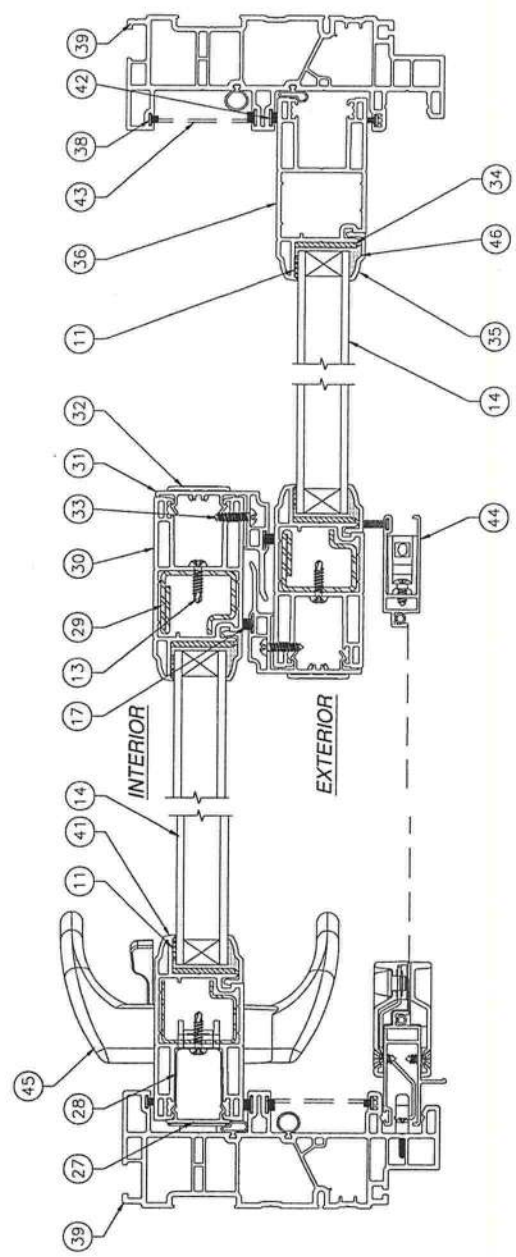

HORIZONTAL CROSS SECTION

WINCORE WINDOWS & DOORS
250 STAUNTON AVE.
PARKERSBURG, WV 26102

S7500/7700/9900 PVC SLIDING GLASS PATIO DOOR
71" x 82"
VERTICAL AND HORIZONTAL CROSS SECTIONS

DRAWN: TJH
SCALE: NTS

DWG NO: 08-00739
DATE: 4/24/09

REV: -
SHEET 3 OF 5

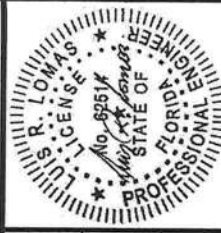

| REV | DESCRIPTION | REVISIONS |
|-----|-------------|-----------|
|-----|-------------|-----------|

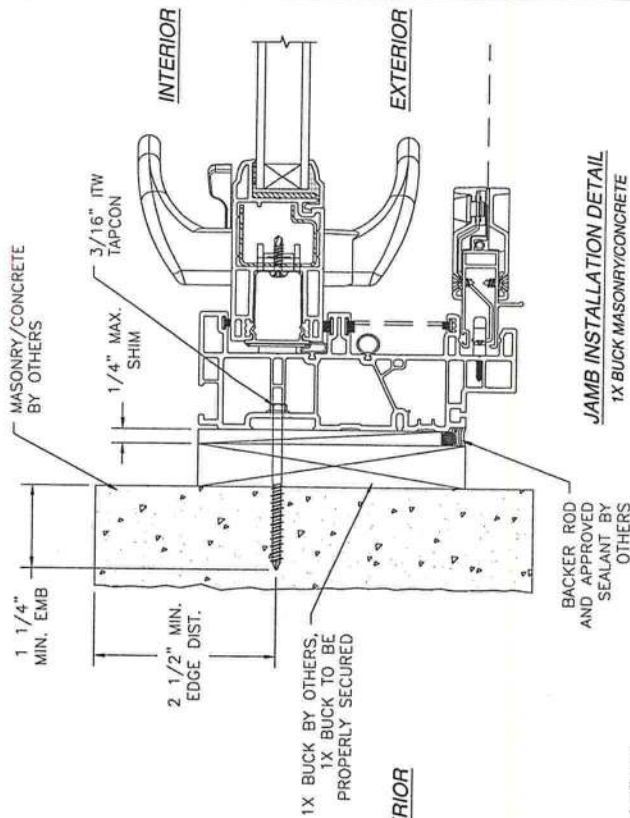
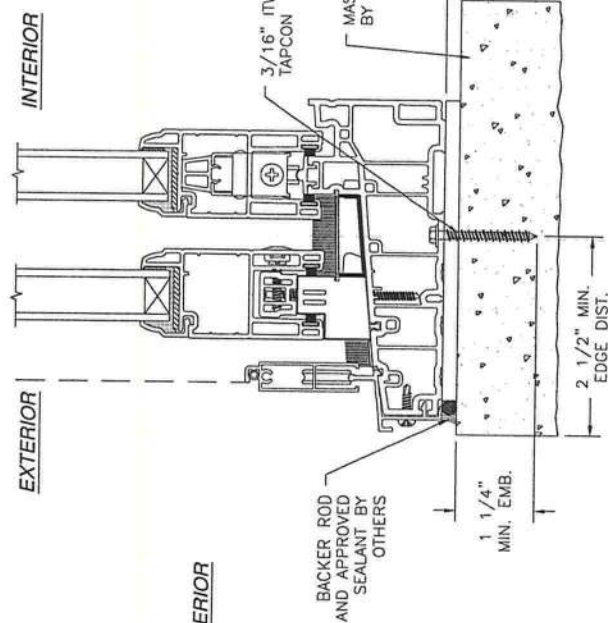
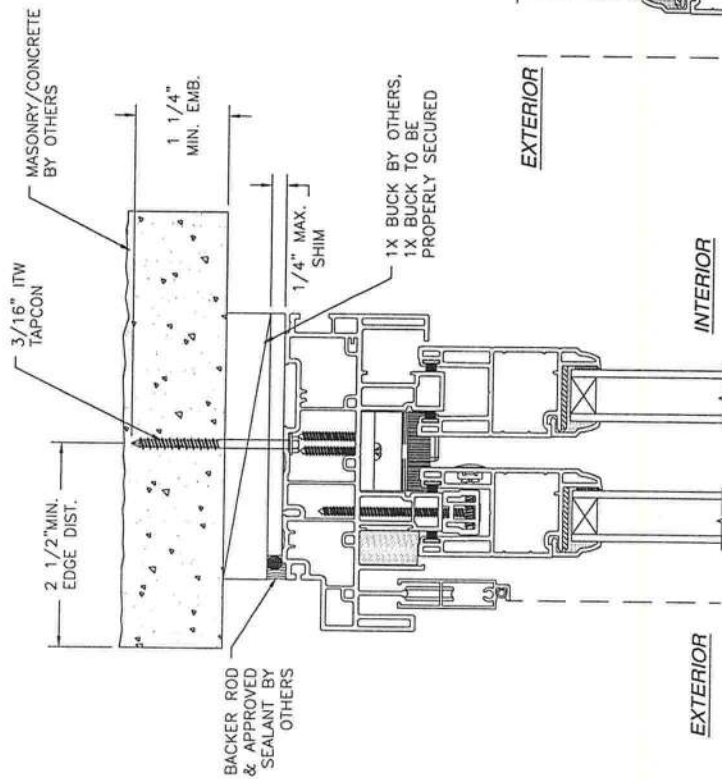

HEAD INSTALLATION DETAIL
1X BUCK MASONRY/CONCRETE

JAMB INSTALLATION DETAIL
1X BUCK MASONRY/CONCRETE

SILL INSTALLATION DETAIL
MASONRY/CONCRETE

WINCORE WINDOWS & DOORS
250 STAUNTON AVE.
PARKERSBURG, WV 26102

S7500/7700/9900 PVC SLIDING GLASS PATIO DOOR
71" x 82"
MASONRY/CONCRETE INSTALLATION DETAILS

| | | |
|---------------|---------------------|--------------|
| DRAWN: TJH | DWG NO. 08-00739 | REV - |
| SCALE NTS | DATE 4/24/09 | SHEET 4 OF 5 |

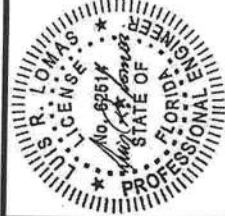

| REVISIONS | | | |
|-----------|-------------|------|----------|
| REV | DESCRIPTION | DATE | APPROVED |

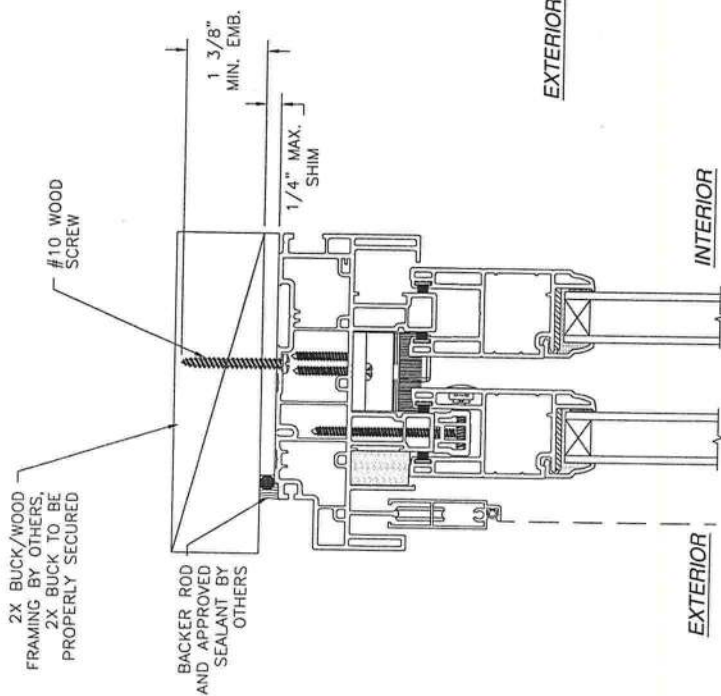

HEAD INSTALLATION DETAIL
2X BUCK/WOOD FRAMING

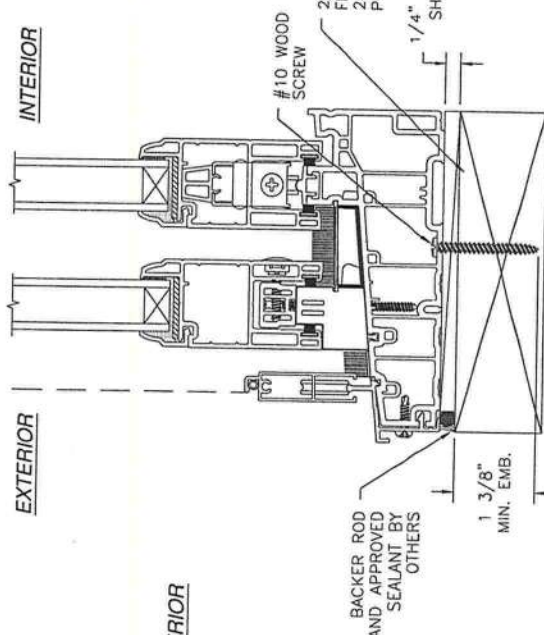

SILL INSTALLATION DETAIL
2X BUCKWOOD FRAMING

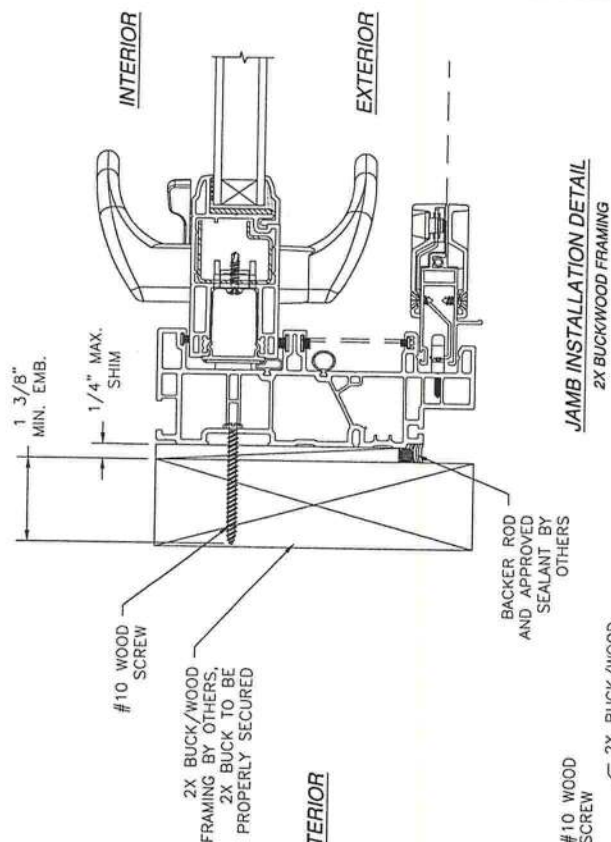

JAMB INSTALLATION DETAIL
2X BUCKWOOD FRAMING

WINCORE WINDOWS & DOORS

250 STAUNTON AVE.

PARKERSBURG, WV 26102

S7500/7700/9900 PVC SLIDING GLASS PATIO DOOR

71" x 82"

2X BUCK/WOOD FRAMING INSTALLATION DETAILS

DRAWN: TJH

DWG NO. 08-00739

REV -

SCALE NTS

DATE 4/24/09

SHEET 5 OF 5

| | | | | |
|---|---|--------------------------|----------------|--------------|
|  | Document Title: Structural Performance Certification Authorization Report | Doc No: FRM B1-02 | | |
| | | Rev No: 6 | Page: 1 | Of: 1 |
| Required By: PRO B1-03 | | | | |

CAR & Product ID Number: 456 - 418.0
Issue Date: 3/18/2009
Revision Date: 3/18/2009
Expiration Date: 3/4/2011
Company Code: 456

This Certification Authorization Report (CAR) is issued by Keystone Certifications, Inc. (KCI) after full validation review of the product qualification documents for the product named below. This report is only valid when signed by an officer of KCI, and indicates the product as manufactured by the company named below has been tested and meets the requirements of the referenced standard and is eligible for the application of Keystone Certification Program certification labels. Licensee stipulates in affixing certification labels to products, that those products are representative of the specimen evaluated and documented for certification authorization. Only products bearing such a certification label shall be considered certified. The information in this report can be verified at www.keystonecerts.com.

| | |
|--|--|
| Licensee Information: | Product Information: |
| WinCore Window Company, LLC 250 Staunton Turnpike Parkersburg WV 26104 | Model: S-7500/7700/9900 Sliding Patio Door Operator Type: SD Config: EM/IM/LS Max Width: 71 Max Height: 82 |

| | |
|-------------------------------|--------------------------|
| Referenced Standard: | Product Rating: |
| AAMA/WDMA/CSA 101/IS2/A440-05 | SD-R55 1800x2080 (71x82) |

| | |
|-------------------------------------|--------------------|
| Qualifying Test Information: | |
| Test Report No: | AI-02822-E1 Rev. 1 |
| Test Report Expiration: | 3/4/2011 |

Authorized Signature:

Marcia P. Falke

Digitally signed by Marcia Falke
DN: cn=Marcia Falke, c=US,
o=Keystone Certifications, Inc.,
ou=President,
email=mfalke@keystonecerts.com
Reason: I am approving this document
Date: 2009.03.18 17:44:28 -04'00'

Keystone Certifications, Inc.
1790 Old Trail Road, Suite D
Etters, Pennsylvania 17319
Phone: 717-932-8500
Fax: 717-932-8501



Product Approval
USER: Public User

[Product Approval Menu](#) > [Product or Application Search](#) > [Application List](#) > [Application Detail](#)

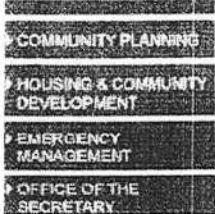

FL # FL10924
Application Type New
Code Version 2007
Application Status Approved
Comments
Archived

Product Manufacturer Wincore Window Company, LLC
Address/Phone/Email 250 Staunton Avenue
Parkersburg, WV 26104
(304) 485-7463 Ext 217
jmiller@wincorewindows.com

Authorized Signature Luis Lomas
rlomas@lrlomaspe.com

Technical Representative
Address/Phone/Email

Quality Assurance Representative
Address/Phone/Email

Category Windows
Subcategory Double Hung

Compliance Method Evaluation Report from a Florida Registered Architect or a Licensed Florida Professional Engineer
■ Evaluation Report - Hardcopy Received

Florida Engineer or Architect Name who developed the Evaluation Report Luis R. Lomas
Florida License PE-62514
Quality Assurance Entity Keystone Certifications, Inc.
Quality Assurance Contract Expiration Date 12/31/2011
Validated By Steven M. Urich, PE
■ Validation Checklist - Hardcopy Received

Certificate of Independence [FL10924_R0_COI_510704.pdf](#)

| | | |
|--|------------------------------|-------------|
| Referenced Standard and Year (of Standard) | Standard | Year |
| | AAMA/WDMA/CSA 101/I.S.2/A440 | 2005 |

Equivalence of Product Standards
Certified By

Sections from the Code

Date Submitted 06/23/2008
 Date Validated 07/02/2008
 Date Pending FBC Approval 07/13/2008
 Date Approved 09/15/2008

Summary of Products

| FL # | Model, Number or Name | Description |
|--|---|---|
| 10924.1 | 7700 DH PVC DOUBLE HUNG WINDOW - REINFORCED | 7700 DH PVC DOUBLE HUNG WINDOW - REINFORCED 56X84 |
| Limits of Use Approved for use in HVHZ: No Approved for use outside HVHZ: Yes Impact Resistant: No Design Pressure: +25.08/-25.08 Other: | | Installation Instructions FL10924_R0_II_FL_00439.pdf Verified By: Luis R. Lomas 62514 Created by Independent Third Party: Yes Evaluation Reports FL10924_R0_AE_07020807.pdf FL10924_R0_AE_510704.pdf Created by Independent Third Party: Yes |
| 10924.2 | 7700 DH PVC DOUBLE HUNG WINDOW - REINFORCED | 7700 DH PVC DOUBLE HUNG WINDOW - REINFORCED 37x76 |
| Limits of Use Approved for use in HVHZ: No Approved for use outside HVHZ: Yes Impact Resistant: No Design Pressure: +50.16/-50.16 Other: | | Installation Instructions FL10924_R0_II_FL_00440.pdf Verified By: Luis R. Lomas 62514 Created by Independent Third Party: Yes Evaluation Reports FL10924_R0_AE_07020807.pdf FL10924_R0_AE_510706.pdf Created by Independent Third Party: Yes |
| 10924.3 | 7700 DH PVC DOUBLE HUNG WINDOW - REINFORCED | 7700 DH PVC DOUBLE HUNG WINDOW - REINFORCED 52x72 |
| Limits of Use Approved for use in HVHZ: No Approved for use outside HVHZ: Yes Impact Resistant: No Design Pressure: +40.13/-45.14 Other: | | Installation Instructions FL10924_R0_II_FL_00442.pdf Verified By: Luis R. Lomas 62514 Created by Independent Third Party: Yes Evaluation Reports FL10924_R0_AE_07020807.pdf FL10924_R0_AE_510710.pdf Created by Independent Third Party: Yes |
| 10924.4 | 7700 DH PVC DOUBLE HUNG WINDOW NON-REINFORCED | 7700 DH PVC DOUBLE HUNG WINDOW NON-REINFORCED 52x72 |
| Limits of Use Approved for use in HVHZ: No Approved for use outside HVHZ: Yes Impact Resistant: No Design Pressure: +25.08/-30.09 Other: | | Installation Instructions FL10924_R0_II_FL_00441.pdf Verified By: Luis R. Lomas 62514 Created by Independent Third Party: Yes Evaluation Reports FL10924_R0_AE_07020807.pdf FL10924_R0_AE_510708.pdf Created by Independent Third Party: Yes |

Back

Next

DCA Administration

Department of Community Affairs
 Florida Building Code Online
 Codes and Standards
 2555 Shumard Oak Boulevard
 Tallahassee, Florida 32399-2100
 (850) 487-1824, Fax (850) 414-8436

© 2000-2005 The State of Florida. All rights reserved. Copyright and Disclaimer

Product Approval Accepts:





| TABLE OF CONTENTS | |
|-------------------|--|
| SHEET NO. | DESCRIPTION |
| 1 | ELEVATION, ANCHORING AND GENERAL NOTES |
| 2 - 3 | INSTALLATION DETAILS |

| | | | |
|----------------|---------------|--------------|----------|
| DRAWN: A.M. | DWG NO. | FL 00442 | REV — |
| SCALE NTS | DATE 05/12/08 | SHEET 1 OF 3 | |



- 1) THE PRODUCT SHOWN HERE IN IS DESIGNED AND MANUFACTURED TO COMPLY WITH THE 2007 FLORIDA BUILDING CODE.
- 2) WOOD FRAMING AND MASONRY OPENING TO BE DESIGNED AND ANCHORED TO PROPERLY TRANSFER ALL LOADS TO STRUCTURE, FRAMING AND MASONRY OPENING IS THE RESPONSIBILITY OF THE ARCHITECT OR ENGINEER OF RECORD.
- 3) CONTRACTOR IS RESPONSIBLE FOR MAINTAINING STRUCTURAL INTEGRITY OF WINDOW OPENING AND ALL WOOD FRAMING AROUND WINDOW.
- 4) UNITS MUST BE GLAZED PER ASTM E1300.
- 5) APPROVED IMPACT PROTECTIVE SYSTEM IS REQUIRED FOR THIS PRODUCT IN WIND BORNE DEBRIS REGIONS.
- 6) SHIM AS REQUIRED AT EACH INSTALLATION ANCHOR WITH LOAD BEARING SHIM. SHIM WHERE SPACE OF 1/16" OR GREATER OCCURS. MAXIMUM ALLOWABLE SHIM STACK TO BE 1/4".
- 7) FOR INSTALLATION INTO WOOD FRAMING OR 2X BUCK USE #10 WOOD SCREW WITH SUFFICIENT LENGTH TO ACHIEVE A 1 3/8" MINIMUM EMBEDMENT INTO SUBSTRATE. LOCATE ANCHORS AS SHOWN IN ELEVATIONS AND INSTALLATION DETAILS.
- 8) FOR INSTALLATION INTO CONCRETE/MASONRY USE 3/16" ELCO TAPCON WITH SUFFICIENT LENGTH TO ACHIEVE A 1 1/4" MINIMUM EMBEDMENT INTO SUBSTRATE. LOCATE ANCHORS AS SHOWN IN ELEVATIONS AND INSTALLATION DETAILS.
- 9) ALL FASTENERS TO BE CORROSION RESISTANT.
- 10) INSTALLATION ANCHORS SHALL BE INSTALLED IN ACCORDANCE WITH ANCHOR MANUFACTURER'S INSTALLATION INSTRUCTIONS, AND ANCHORS SHALL NOT BE USED IN SUBSTRATES WITH STRENGTHS LESS THAN THE MINIMUM STRENGTH SPECIFIED BELOW:
 - A. WOOD -- MINIMUM SPECIFIC GRAVITY OF G=0.42
 - B. CONCRETE -- MINIMUM COMPRESSIVE STRENGTH OF 3,200 PSI.
 - C. MASONRY -- STRENGTH CONFORMANCE TO ASTM C-90, GRADE N, TYPE 1 (OR GREATER).
- 11) ALLOWABLE STRESS INCREASE OF 1/3 WAS NOT USED IN THE DESIGN OF THE PRODUCT SHOWN HEREIN. WIND LOAD DURATION FACTOR $C_d=1.6$ WAS USED FOR WOOD ANCHOR CALCULATIONS.
- 12) FRAME MATERIAL: RIGID PVC

EMISSIONS

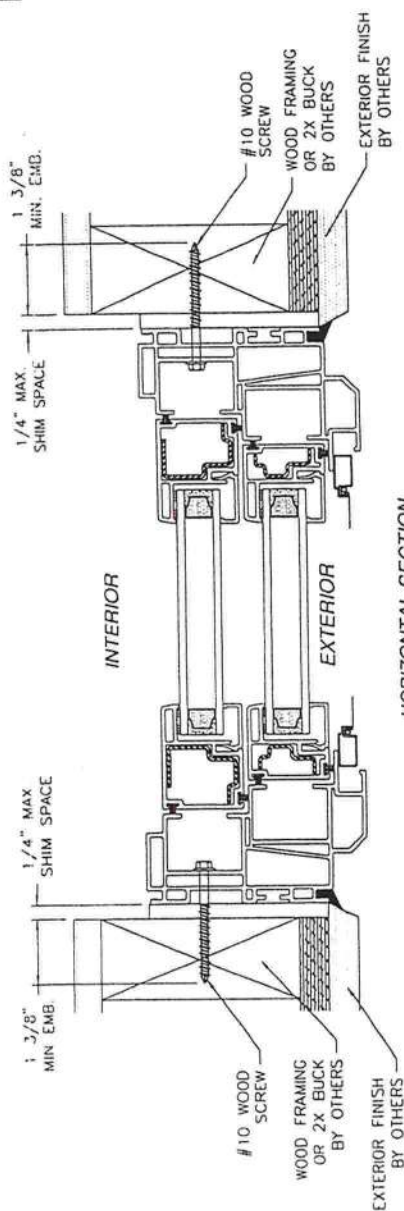

HORIZONTAL SECTION
WOOD FRAMING OR 2X BUCK INSTALLATION

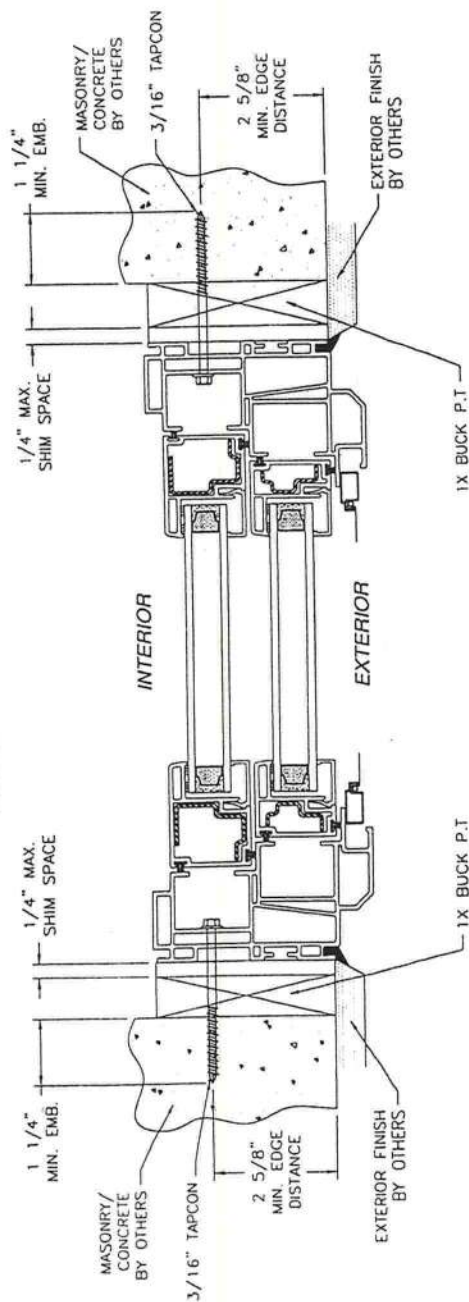

HORIZONTAL SECTION
1X BUCK INSTALLATION

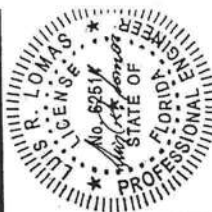

WINCORE WINDOWS
250 STAUTON AVE
PARKERSBURG, WV 26104

7700 DH PVC DOUBLE HUNG WINDOW
REINFORCED - 52 X 72
INSTALLATION DETAILS

| | | | |
|--------------|----------|----------|-----|
| SCALE | DATE | DWG NO. | REV |
| NTS | 05/12/08 | FL 00442 | — |
| SHEET 2 OF 3 | | | |



BUILDING CODE COMPLIANCE OFFICE (BCCO)
PRODUCT CONTROL DIVISION

MIAMI-DADE COUNTY, FLORIDA

METRO-DADE FLAGLER BUILDING
140 WEST FLAGLER STREET, SUITE 1603
MIAMI, FLORIDA 33130-1563
(305) 375-2901 FAX (305) 375-2908
www.buildingcodeonline.com

NOTICE OF ACCEPTANCE (NOA)

VEKA Inc.
100 Veka Drive
Fombell, PA 16123

SCOPE:

This NOA is being issued under the applicable rules and regulations governing the use of construction materials. The documentation submitted has been reviewed by Miami-Dade County Product Control Division and accepted by the Board of Rules and Appeals (BORA) to be used in Miami Dade County and other areas where allowed by the Authority Having Jurisdiction (AHJ).

This NOA shall not be valid after the expiration date stated below. The Miami-Dade County Product Control Division (In Miami Dade County) and/or the AHJ (in areas other than Miami Dade County) reserve the right to have this product or material tested for quality assurance purposes. If this product or material fails to perform in the accepted manner, the manufacturer will incur the expense of such testing and the AHJ may immediately revoke, modify, or suspend the use of such product or material within their jurisdiction. BORA reserves the right to revoke this acceptance, if it is determined by Miami-Dade County Product Control Division that this product or material fails to meet the requirements of the applicable building code.

This product is approved as described herein, and has been designed to comply with the Florida Building Code, including the High Velocity Hurricane Zone.

DESCRIPTION: The approved **White Rigid PVC Exterior Extrusions for Windows and Doors** are to be produced by Extruders Licensees in "AAMA Certification Programs for rigid PVC Extrusions". The extrusions shall meet ASTM D 4726, classification (ASTM D 4216) 1-10154-33-0000, 1-20131-13-0000 or 1-40131-13 and the following properties.

| Description | Test | Properties |
|---|-------------|-------------|
| Rate of Burning | ASTM D-635 | Class C1 |
| Self Ignition temperature | ASTM D-1929 | 925°F > 650 |
| Average Smoke Density Rating | ASTM D-2843 | 43% < 75 |
| Flame Spread Index | ASTM E-84 | 26.2 < 75 |
| Tensile Strength (Difference: *Exposed & Unexposed) | ASTM D-638 | 4.98% < 10 |

*Exposed per Section 2605.2 of The Florida Building Code.

MISSILE IMPACT RATING: None

Limitation: This approval does not include an evaluation of structural performance of this component. Test reports and other required documents shall be submitted to Dade County Product Control; showing that the systems using this interlayer sheet will resist the loads according to Chapter 16 of the F.B.C., in order to issue an specific product approval for the system.

LABELING: Each unit shall bear a permanent label with the manufacturer's name or logo, city, state and following statement: "Miami-Dade County Product Control Approved".

RENEWAL of this NOA shall be considered after a renewal application has been filed and there has been no change in the applicable building code negatively affecting the performance of this product.



Carlos M. Utrera, P.E.
Product Control Examiner
NOA No 07-0208.07
Expiration Date: March 04, 2012
Approval Date: May 25, 2007
Page: 1



BUILDING CODE COMPLIANCE OFFICE (BCCO)
PRODUCT CONTROL DIVISION

MIAMI-DADE COUNTY, FLORIDA

METRO-DADE FLAGLER BUILDING
140 WEST FLAGLER STREET, SUITE 1603
MIAMI, FLORIDA 33130-1563
(305) 375-2901 FAX (305) 375-2908
www.buildingcodeonline.com

NOTICE OF ACCEPTANCE (NOA)

VEKA Inc.
100 Veka Drive
Fombell, PA 16123

TERMINATION of this NOA will occur after the expiration date or if there has been a revision or change in the materials, use, and/or manufacture of the product or process. Misuse of this NOA as an endorsement of any product, for sales, advertising or any other purposes shall automatically terminate this NOA. Failure to comply with any section of this NOA shall be cause for termination and removal of NOA.

ADVERTISEMENT: The NOA number preceded by the words Miami-Dade County, Florida, and followed by the expiration date may be displayed in advertising literature. If any portion of the NOA is displayed, then it shall be done in its entirety.

INSPECTION: A copy of this entire NOA shall be provided to the user by the manufacturer or its distributors and shall be available for inspection at the job site at the request of the Building Official.

This NOA renews NOA 02-0927.02 and consists of pages 1, 2 and evidence page E-1.
The submitted documentation was reviewed by **Carlos M. Utrera, P. E.**



Carlos M. Utrera, P.E.
Product Control Examiner
NOA No 07-0208.07
Expiration Date: March 04, 2012
Approval Date: May 25, 2007
Page: 2

NOTICE OF ACCEPTANCE: EVIDENCE SUBMITTED

- A. **DRAWINGS**
1. Not applicable
- B. **TESTS**
1 Test report on Rate of Burning, Ignition Temperature, Density of Smoke, Surface Burning Characteristics, Accelerated Weathering and Tensile Properties Test of "PVC Extrusions from 5 different manufacturer" selected by AAMA", prepared by ETC Laboratories, report # ETC 97-264-40910, dated 04/21/98, signed and sealed by J. L. Doldan, PE.
- C. **CALCULATIONS:**
1. Not applicable
- D. **QUALITY ASSURANCE**
1. Miami Dade Building Code Compliance Office (BCCO)
- E. **MATERIAL CERTIFICATIONS**
1. AAMA Publication No. 109-04.
2. AAMA Publication No. 303-05.
3. AAMA Certified PVC Extrusion Listing (Dated 11/29/06).
- F. **STATEMENTS (submitted under NOA # 02-0927.02)**
1. Certification letter, dated August 01, 2002, issued by AAMA (American Architectural Manufacturers Association), signed by Dean Lewis, Manager Product Certification.
2. Acknowledgement letter, dated December 08, 1998, issued by Veka, Inc., applying under AAMA master file # 98-0036, signed by C. Lawrence Irwin, President.
3. Release Letter, dated November 24, 1998, issued by AAMA, signed by Steve Sullivan, Executive Vice President.
4. Acknowledgement Letter, dated January 20, 1990, issued by AAMA, confirming Veka Inc., as a member, signed by Steve Sullivan, Executive Vice President.
5. No Change Statement, dated January 18, 2007, issued by Veka, Inc., signed by Kevin A. Seiling.
- G. **OTHER:**
1. This NOA renews NOA # 02-0927.02, issued to Veka Inc., and expired on March 04, 2007.

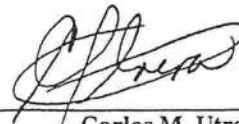

Carlos M. Utrera, P.E.
Product Control Examiner
NOA No 07-0208.07
Expiration Date: March 04, 2012
Approval Date: May 25, 2007

L. Roberto Lomas P.E.

1432 Woodford Rd.
Clemmons, NC 27012
336-945-9695

Engineering Evaluation Report

Report No.: 510710

Manufacturer: Wincore Windows & Doors
250 Staunton Avenue
Parkersburg, West Virginia 26102

Product Line: Series 7700 DH PVC Double Hung Window - Reinforced

Compliance:

The above mentioned product has been evaluated for compliance with the requirements of the Florida Department of Community Affairs for Statewide Acceptance per Rule 9B-72.070 method 1(d). The product listed herein complies with the 2007 Florida Building Code.

Product description: 7700 DH PVC Double Hung Window. PVC frame is mitered and welded corner construction.

Supporting Technical Documentation:

1. Approval document: drawing number FL 00442, dated 05/12/08 sheet 1 of 3 titled 7700 DH PVC Double Hung Window Reinforced, prepared, signed and sealed by L. Roberto Lomas P.E.
2. Test Report No.: 77368.02-501-47 signed by Joseph E. Allison and Lynn George
Architectural Testing, Inc.
AAMA/WDMA/CSA 101/I.S.2/A440-05
Design pressure: +40.13/-45.14 psf
Water penetration resistance: 7.52 psf
3. Anchor calculations, report number 510711, prepared, signed and sealed by L. Roberto Lomas P.E.

Limitations and Conditions of use:

- Maximum design pressure: +40.13/-45.14psf
- Maximum overall size: 52" x 72"
- Maximum D.L.O.: 45" x 31 1/4"
- Units must be glazed per ASTM E1300.
- This product is not rated to be used in the HVHZ.
- This product is non-impact resistant and requires impact protection in wind-borne debris regions.
- Main frame material to be PVC per NOA 07-0208.07
- Reinforcement material: Steel

Installation:

- Units must be installed in accordance with approval document, FL 00442

Certification of Independence:

Please note that I don't have nor will acquire a financial interest in any company manufacturing or distributing the product(s) for which this report is being issued. Also, I don't have nor will acquire a financial interest in any other entity involved in the approval process of the listed product(s).

