

**Columbia County Building Department
Culvert Permit**

Culvert Permit No.

000002257

(No Permit)

DATE 01/11/2016 PARCEL ID # 04-6S-17-09600-004
APPLICANT WILLIAM SMITH PHONE 352-317-5767
ADDRESS 1024 SW HOWELL ST LAKE CITY FL 32024
OWNER ALL-TECH RACEWAY LLC PHONE 386-623-4746
ADDRESS 1024 SW HOWELL RD LAKE CITY FL 32024
CONTRACTOR ALL-TECH RACEWAY PHONE 352-317-5767
LOCATION OF PROPERTY 441 S. R HOWELL RD. ON LEFT AT ALL-TECH RACEWAY LLC



SUBDIVISION/LOT/BLOCK/PHASE/UNIT _____

INSTALLATION INFORMATION

SIGNATURE

[Handwritten Signature]

- (A) A culvert shall be required to be installed as part of any newly constructed private driveway or road, or public road, which connects to a county road in Columbia County. Culvert installation for residential use shall require a permit issued by the Building and Zoning Department. Prior to any culvert permit being issued, an inspection by the Public Works Department shall be required to determine the proper size, length, and location for installation. Culvert installation for commercial, industrial, and other uses shall conform to the approved site plan or to the specifications of a registered engineer. Joint use culverts will comply with Florida Department of Transportation specifications.
- (B) The culvert shall comply and be installed in accordance with Columbia County Land Development Regulation, Access Control: Section 4.2.3 standards. Proper installation of the culvert shall be verified by a final inspection performed by the Public Works Department.
- (C) All culverts required by this policy shall be installed prior to the Building Department granting permission to connect permanent electrical service to the facility or facilities being serviced by newly constructed private driveway or road. In cases where no electrical service exists, installation shall be completed prior to final inspection approval.
- (D) Mitered-end culverts shall be used in the following applications:
(1) When the culvert is to be placed giving access to a paved street; (2) When the road is contained within a subdivision (recorded or unrecorded) that has not reached a "build out" of fifty percent (50%) or more; (3) In all new subdivisions for residential use. New subdivisions shall be required as part of the final plat to specify culvert diameter and length; (4) When the predominant use already established by the use of mitered-end culverts period.

☒

Culvert installation shall conform to the approved site plan standards.

☐

Department of Transportation Permit installation approved standards.

☐

Shall conform to Public Works Determinations as Stated Below:

INSTALL 24"X60' CORR METAL CULVERT WITH CONCRETE MITERED ENDS
w/ 6X6 W W, REBAR + ANCHOR BELTS

P W Inspectors Name: JUSTIN SIKES Date: 1-13-16

Final Inspection Date: _____ P W Inspectors Name: _____ Signature: _____

CONTACT FOR REQUIREMENTS AND INSPECTIONS:

PUBLIC WORKS DEPARTMENT

Phone: 386-758-1019

Amount Paid 25.00

Check No. 1060

All Proper Safety Requirements Should Be Followed During The Installation Of The Culvert

2257

Columbia County Property Appraiser

updated: 12/15/2015

2015 Tax Year

352-317-5767

Tax Collector

Tax Estimator

Property Card

Parcel List Generator

Parcel: 04-6S-17-09600-004

<< Next Lower Parcel Next Higher Parcel >>

Interactive GIS Map

Print

Owner & Property Info

<< Prev

Search Result: 2 of 2

Owner's Name	ALL-TECH RACEWAY LLC		
Mailing Address	1024 SW HOWELL RD LAKE CITY, FL 32024		
Site Address	1024 SW HOWELL ST		
Use Desc. (code)	RACE TRACK (003700)		
Tax District	3 (County)	Neighborhood	4617
Land Area	40.000 ACRES	Market Area	02
Description	NOTE: This description is not to be used as the Legal Description for this parcel in any legal transaction.		
NE1/4 OF SE1/4, EX ANY RD R/W LYING WITHIN SW HOWELL RD & SW FARNELL RD. ORB 701-624, 713-74, WD 1024-1146, CWD 1295 -1790, WD 1295-1792.			

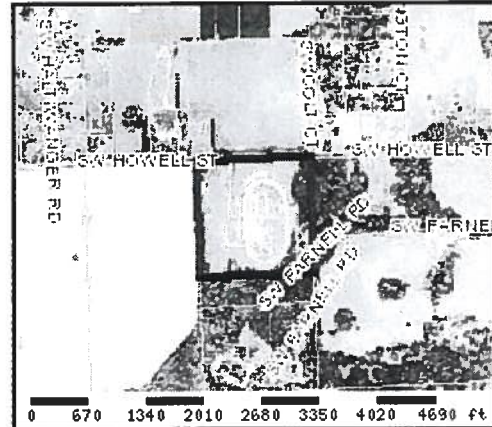

Property & Assessment Values

2015 Certified Values		
Mkt Land Value	cnt: (0)	\$166,776.00
Ag Land Value	cnt: (2)	\$0.00
Building Value	cnt: (2)	\$86,164.00
XFOB Value	cnt: (11)	\$147,260.00
Total Appraised Value		\$400,200.00
Just Value		\$400,200.00
Class Value		\$0.00
Assessed Value		\$400,200.00
Exempt Value		\$0.00
Total Taxable Value	Cnty: \$400,200 Other: \$400,200 Schl: \$400,200	

2016 Working Values <small>(...Hide Values)</small>		
Mkt Land Value	cnt: (0)	\$166,776.00
Ag Land Value	cnt: (2)	\$0.00
Building Value	cnt: (2)	\$87,990.00
XFOB Value	cnt: (11)	\$147,260.00
Total Appraised Value		\$402,026.00
Just Value		\$402,026.00
Class Value		\$0.00
Assessed Value		\$402,026.00
Exempt Value		\$0.00
Total Taxable Value	Cnty: \$402,026 Other: \$402,026 Schl: \$402,026	

NOTE: 2016 Working Values are NOT certified values and therefore are subject to change before being finalized for ad valorem assessment purposes.

Sales History

Show Similar Sales within 1/2 mile

Sale Date	OR Book/Page	OR Code	Vacant / Improved	Qualified Sale	Sale RCode	Sale Price
5/27/2015	1295/1792	WD	I	Q	05	\$650,000.00
5/12/2015	1295/1790	WD	I	U	11	\$100.00
8/9/2004	1024/1146	WD	I	U	03	\$555,000.00
3/9/1990	713/74	WD	I	U		\$187,500.00
11/13/1989	701/624	CT	I	U		\$25,000.00

Building Characteristics

Bldg Item	Bldg Desc	Year Blt	Ext. Walls	Heated S.F.	Actual S.F.	Bldg Value
1	PREF M B A (008700)	1993	PREFIN MTL (27)	4000	4000	\$83,173.00
2	MOBILE HME (000800)	1989	BELOW AVG. (03)	784	784	\$4,817.00
Note: All S.F. calculations are based on <u>exterior</u> building dimensions.						

Laurie Hodson

From: LESLIE FLAGE [leslieflage@gmail.com]
Sent: Monday, January 11, 2016 3:04 PM
To: Laurie Hodson
Subject: Fwd: [FWD: Permit Authorization for All-Tech Raceway LLC]

----- Forwarded message -----

From: <lanier@alltechraceway.com>
Date: Mon, Jan 11, 2016 at 3:02 PM
Subject: [FWD: Permit Authorization for All-Tech Raceway LLC]
To: LESLIE FLAGE <leslieflage@gmail.com>

----- Original Message -----

Subject: [FWD: Permit Authorization for All-Tech Raceway LLC]
From: <lanier@alltechraceway.com>
Date: Sat, January 09, 2016 8:20 am
To: laurie_hodson@columbiacountyfla.com

----- Original Message -----

Subject: [FWD: Permit Authorization for All-Tech Raceway LLC]
From: <dsmith@alltechcomm.net>
Date: Sat, January 09, 2016 8:08 am
To: lanier@alltechraceway.com

----- Original Message -----

Subject: Permit Authorization for All-Tech Raceway LLC
From: <dsmith@alltechcomm.net>
Date: Tue, January 05, 2016 1:05 pm
To: bstubbs@columbiacountyfla.com

To whom it may concern,

I am authorizing Mr. William Smith to pull any necessary permits for the All-Tech Raceway property at 1024 SW Howell Street Lake City FL. 32024. I can be reached at any time for further questioning if needed.

Thanks for your time,

Dean L. Smith - owner
[386-623-4746](tel:386-623-4746)