

A BOUNDARY SURVEY IN SECTION 5, TOWNSHIP 6 SOUTH,
RANGE 16 EAST, COLUMBIA COUNTY, FLORIDA.

SYMBOL LEGEND:

■	4"x4" CONCRETE MONUMENT FOUND
□	4"x4" CONCRETE MONUMENT SET
○	IRON PIPE FOUND
●	IRON PIN AND CAP SET
×	"X" CUT IN PAVEMENT
+	CALCULATED PROPERTY CORNER
⊙	MAIL & DISK
⊕	POWER POLE
⊗	SIGN POST
▲	WATER METER
⊕	UTILITY BOX
⊗	WELL
⊕	SANITARY MANHOLE
⊕	CENTERLINE
---	SECTION LINE
---	ELECTRIC LINES
---	WIRE FENCE
---	CHAIN LINK FENCE
---	WOODEN FENCE
(PLAT)	AS PER A PLAT OF RECORD
(DEED)	AS PER A DEED OF RECORD
(CALC.)	AS PER CALCULATIONS
(FIELD)	AS PER FIELD MEASUREMENTS
P.R.M.	PERMANENT REFERENCE MARKER
P.C.P.	PERMANENT CONTROL POINT

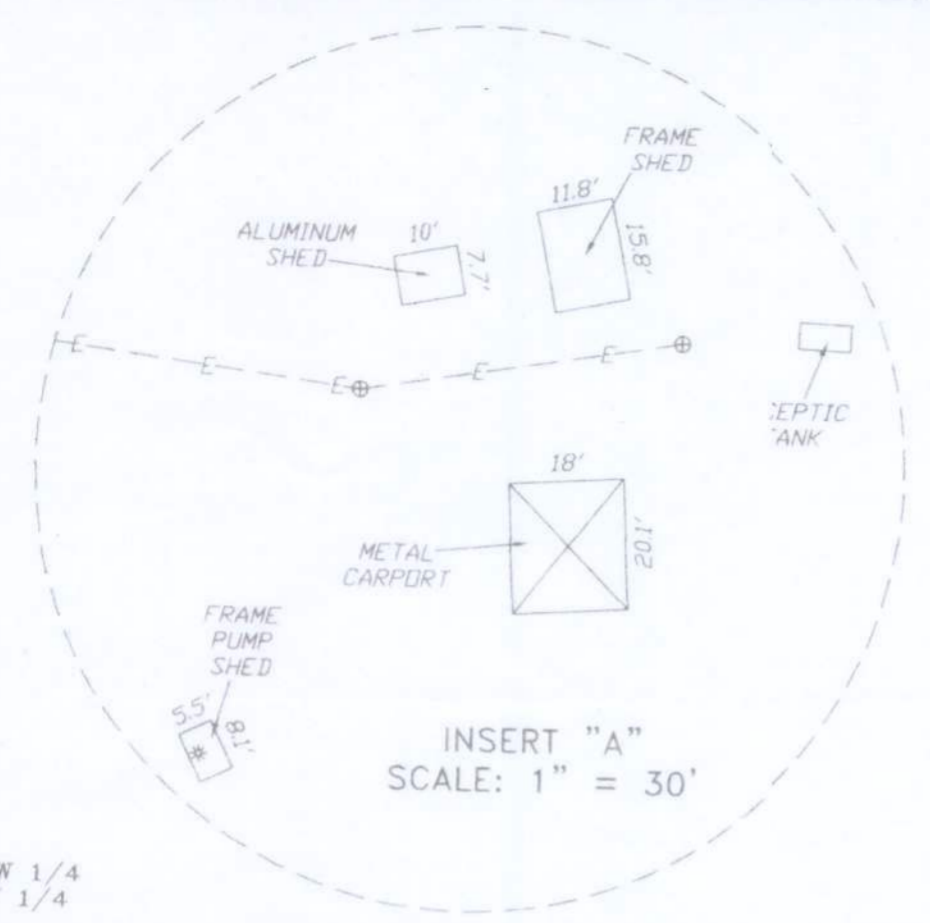
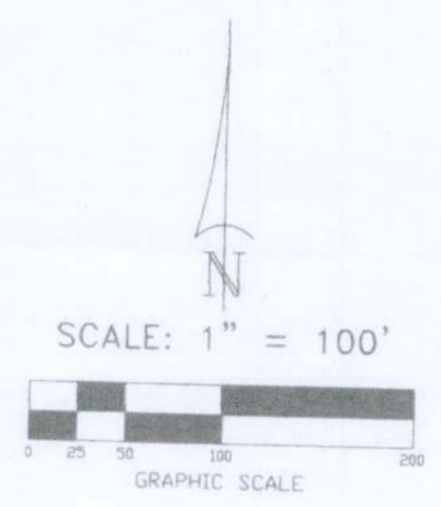

NW CORNER OF NW 1/4
OF NW 1/4 OF SW 1/4
OF SECTION 5,
TOWNSHIP 6 SOUTH,
RANGE 16 EAST
PLAIN CONCRETE MONUMENT

SW DREW FRAGLE AVENUE
(DIRT/PUBLIC)

NW CORNER OF N 1/2
OF NE 1/4 OF NW 1/4
OF SW 1/4, SECTION 5,
TOWNSHIP 6 SOUTH,
RANGE 16 EAST
L.B. 6685

NE CORNER OF N 1/2
OF NE 1/4 OF NW 1/4
OF SW 1/4, SECTION 5,
TOWNSHIP 6 SOUTH,
RANGE 16 EAST

PARCEL # 03773-000
KAREN MAGGARD

FENCE CORNER
IS 1.26' SOUTH
& 2.14' EAST

FENCE CORNER
IS 1.08' NORTH
& 1.53' EAST

FENCE CORNER
IS 0.88' NORTH
& 1.33' EAST

L.E. BRITT
P.L.S. 1079

DESCRIPTION:
THE NORTH 1/2 OF THE NE 1/4 OF THE NW 1/4 OF THE SW 1/4 OF SECTION 5, TOWNSHIP 6 SOUTH, RANGE 16 EAST, COLUMBIA COUNTY, FLORIDA, CONTAINING 5 ACRES, MORE OR LESS, SUBJECT TO POWER LINE EASEMENT.

SUBJECT TO AND TOGETHER WITH:
A 30.00 FOOT EASEMENT ON NORTHERN BOUNDARY OF THE NORTH 1/2 OF NW 1/4 OF SW 1/4 OF SECTION 5, TOWNSHIP 6 SOUTH, RANGE 16 EAST, COLUMBIA COUNTY, FLORIDA.

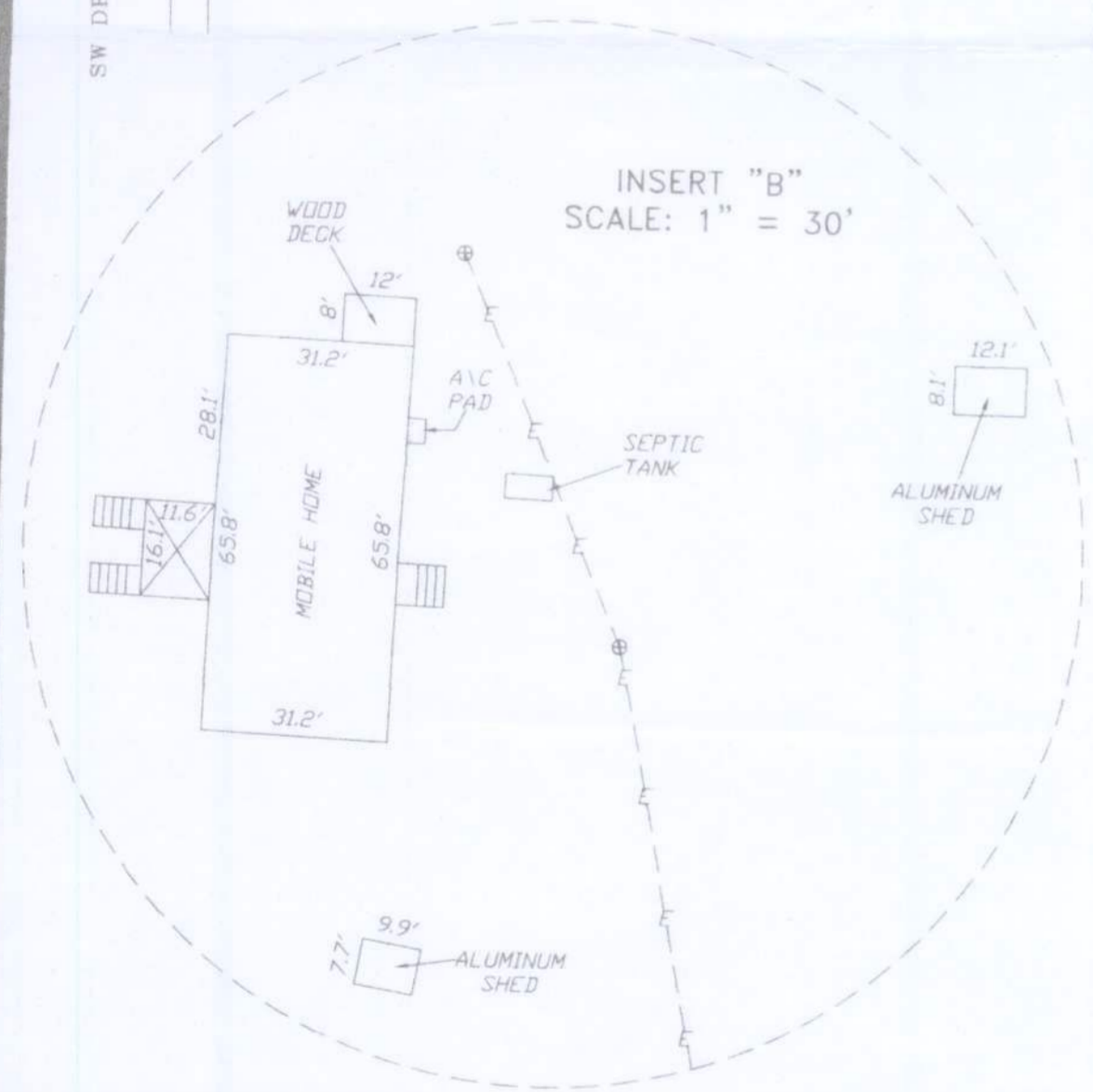

N.01°51'12"W. 334.42' (FIELD)

(BEARING BASIS)
N.87°16'49"E. 663.43' (FIELD)

FENCE CORNER
IS 1.85' SOUTH
& 3.38' WEST

35.565' (FIELD)

PARCEL # 03774-001
ROBERT SCOTT

PARCEL # 03778-002
WAYNE SR. & JOYCE HANCOCK

L.E. BRITT
P.L.S. 1079

S.01°54'36"E.
28.18' (FIELD)

- SURVEYOR'S NOTES:**
- BOUNDARY BASED ON MONUMENTATION FOUND.
 - BEARINGS ARE BASED ON AN ASSUMED BEARING OF N.87°16'49"E. FOR THE NORTH LINE OF SAID N 1/2 OF NE 1/4 OF NW 1/4 OF SW 1/4.
 - IT IS APPARENT THAT THIS PARCEL IS IN ZONE "X" AND IS DETERMINED TO BE OUTSIDE THE 500 YEAR FLOOD PLAIN AS PER FLOOD RATE MAP, DATED 4 FEBRUARY, 2009 FIRM PANEL NUMBER 12023C0480C. HOWEVER, THE FLOOD INSURANCE RATE MAPS ARE SUBJECT TO CHANGE.
 - THE IMPROVEMENTS, IF ANY, INDICATED ON THIS SURVEY DRAWING ARE AS LOCATED ON DATE OF FIELD SURVEY AS SHOWN HEREON.
 - IF THEY EXIST, NO UNDERGROUND ENCROACHMENTS AND/OR UTILITIES WERE LOCATED FOR THIS SURVEY EXCEPT AS SHOWN HEREON.
 - THIS SURVEY WAS COMPLETED WITHOUT THE BENEFIT OF A TITLE COMMITMENT OR A TITLE POLICY.
 - DIMENSIONS SHOWN HEREON ARE IN FEET AND DECIMAL PARTS THEREOF.
 - THIS SURVEY DOES NOT REFLECT OR DETERMINE OWNERSHIP.
 - THE ADJACENT OWNERSHIP INFORMATION AS SHOWN HEREON IS BASED ON THE COUNTY PROPERTY APPRAISERS GIS SYSTEM, UNLESS OTHERWISE DENOTED.

CERTIFIED TO:
GREG ROSKISKY
MARY McDERMOTT

FIELD BOOK: 341 PAGE(S): 58

SURVEYOR'S CERTIFICATION:

I HEREBY CERTIFY THAT THIS SURVEY WAS MADE UNDER MY RESPONSIBLE CHARGE AND MEETS THE MINIMUM TECHNICAL STANDARDS AS SET FORTH BY THE FLORIDA BOARD OF PROFESSIONAL SURVEYORS AND MAPPERS IN CHAPTER 5J-17, FLORIDA ADMINISTRATIVE CODE, PURSUANT TO SECTION 472.027, FLORIDA STATUTES.

05/14/14 FIELD SURVEY DATE 05/19/14 DRAWING DATE

Robert Britt
ROBERT BRITT, P.S.M.
CERTIFICATION # 5757

NOTE: UNLESS IT BEARS THE SIGNATURE AND THE ORIGINAL RAISED SEAL OF A FLORIDA LICENSED SURVEYOR AND MAPPER THIS DRAWING, SKETCH, PLAT OR MAP IS FOR INFORMATIONAL PURPOSES ONLY AND IS NOT VALID.



BRITT SURVEYING & MAPPING, LLC

LAND SURVEYORS AND MAPPERS, L.B. # 8016
2086 SW MAIN BLVD, SUITE 112
LAKE CITY, FLORIDA 32025

www.brittsurvey.com
TELEPHONE: (386) 752-7163 FAX: (386) 752-5573

WORK ORDER # L-23096