

REVISIONS

SOFTPLAN
ARCHITECTURAL DESIGN SOFTWARE

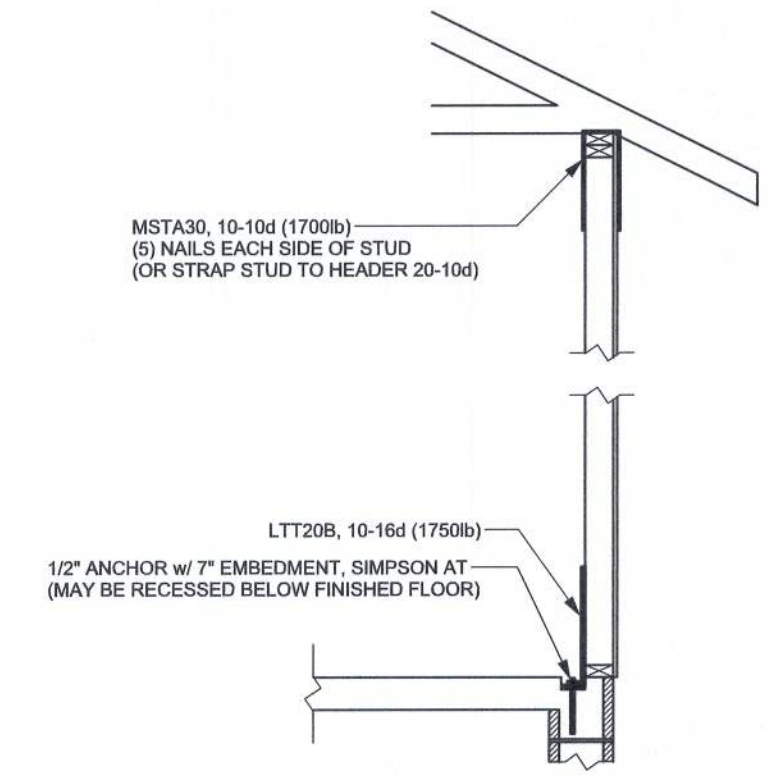

**ALTERNATE WALL TIE CONNECTION WHERE
THREADED ROD CANNOT BE PLACED IN WALL**
SCALE: 1/2" = 1'-0"

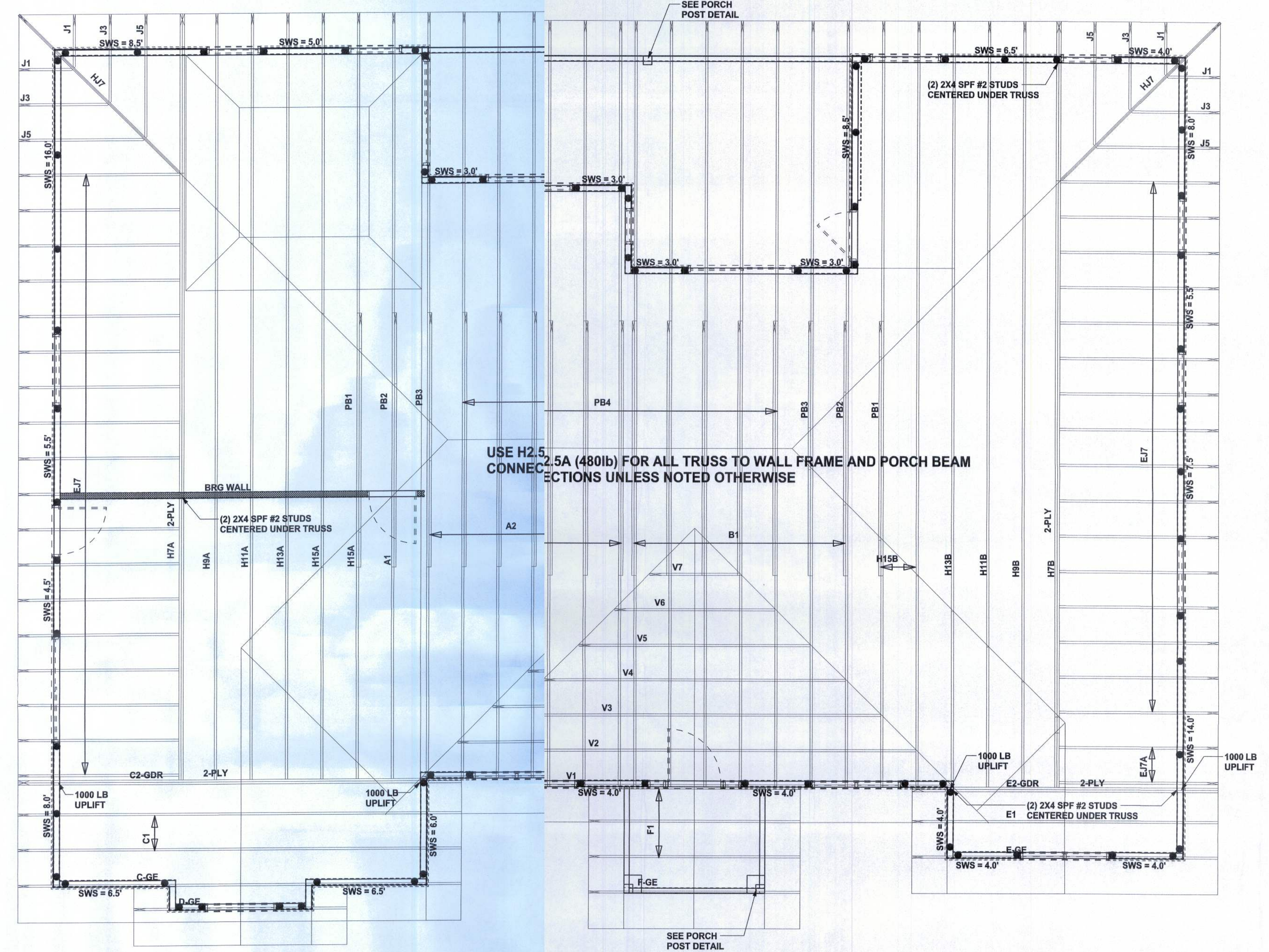

STRUCTURAL PLAN
SCALE: 1/4" = 1'-0"

TOTAL SHEAR WALL SEGMENTS
SWS = 0.0' INDICATES SHEAR WALL SEGMENTS

	REQUIRED	ACTUAL
TRANSVERSE	50.5'	87.5'
LONGITUDINAL	19.0'	65.0'

STRUCTURAL PLAN NOTES

- SN-1 ALL LOAD BEARING FRAME WALL & PORCH HEADERS SHALL BE A MINIMUM OF (2) 2X12 SYP#2 (U.N.O.)
- SN-2 ALL LOAD BEARING FRAME WALL HEADERS SHALL HAVE (1) JACK STUD & (1) KING STUD EACH SIDE (U.N.O.)
- SN-3 DIMENSIONS ON STRUCTURAL SHEETS ARE NOT EXACT. REFER TO ARCHITECTURAL FLOOR PLAN FOR ACTUAL DIMENSIONS
- SN-4 PERMANENT TRUSS BRACING IS TO BE INSTALLED AT LOCATIONS AS SHOWN ON THE SEALED TRUSS DRAWINGS. LATERAL BRACING IS TO BE RESTRAINED PER BCSI-43, BCSI-B1, BCSI-B2, & BCSI-B3. BCSI-B1, BCSI-B2, & BCSI-B3 ARE FURNISHED BY THE TRUSS SUPPLIER, WITH THE SEALED TRUSS PACKAGE

WALL LEGEND

SWS = 0.0'	1ST FLOOR EXTERIOR WALL
SWS = 0.0'	2ND FLOOR EXTERIOR
IBW	1ST FLOOR INTERIOR BEARING WALLS SEE DETAILS ON SHEET S-1
IBW	2ND FLOOR INTERIOR BEARING WALLS SEE DETAILS ON SHEET S-1

THREADED ROD LEGEND

- INDICATES LOCATION OF:
1ST FLOOR 1/2" A307 ALL THREADED ROD
- ⊗ INDICATES LOCATION OF:
2ND FLOOR 1/2" A307 ALL THREADED ROD

HEADER LEGEND

- (2) 2X12X0', 1J 1K ← HEADER/BEAM CALL-OUT (U.N.O.)
- ↑ NUMBER OF KING STUDS (FULL LENGTH)
- ↑ NUMBER OF JACK STUDS (UNDER HEADER)
- ↑ SPAN OF HEADER
- ↑ SIZE OF HEADER MATERIAL
- ↑ NUMBER OF PLYS IN HEADER

WJLOAD ENGINEER: Mark Disosway,
P.E. 53915, POB 868, Lake City, FL
32056, 386-754-5419

DIENSIONS:
Stud dimensions supersede scaled dimensions. Refer all questions to Mark Disosway, P.E. for resolution. Do not proceed without clarification.

COPYRIGHTS AND PROPERTY RIGHTS:
Mark Disosway, P.E. hereby expressly reserves its entire law copyright and property right in these instruments of service. This document is not to be reproduced, altered or copied in any form or manner without first the express written permission and consent of Mark Disosway.

CERTIFICATION: I hereby certify that I have examined this plan, and that the applicable portions of the plan, relating to wind engineering comply with section 6301.2.1, Florida building code residential 2004, to the best of my knowledge.

LITIGATION: This design is valid for one building, at specified location.

MARK DISOSWAY
P.E. 53915
Mark Disosway
06/06/2008
SEAL

Sparks Construction Inc

Bryant Residence

ADDRESS:
SW Birley Ave.
Columbia Co. FL

Mark Disosway P.E.
P.O. Box 868
Lake City, Florida 32056
Phone: (386) 754 - 5419
Fax: (386) 269 - 4871

PRINTED DATE:
March 06, 2008

DRAWN BY: Ben Sparks STRUCTURAL BY: Ben Sparks

ISSUALS DATE:
7 / Feb / 08

JOB NUMBER:
707261

DRAWING NUMBER
S-3
OF 6 SHEETS

CONNECTIONS, WALL, & HEADER DESIGN IS BASED ON REACTIONS & UPLIFTS FROM TRUSS ENGINEERING FURNISHED BY BUILDER, ANDERSON TRUSS CO. (JOB #8-068)