

ROOF PLAN

SCALE: 1/8" = 1'-0"

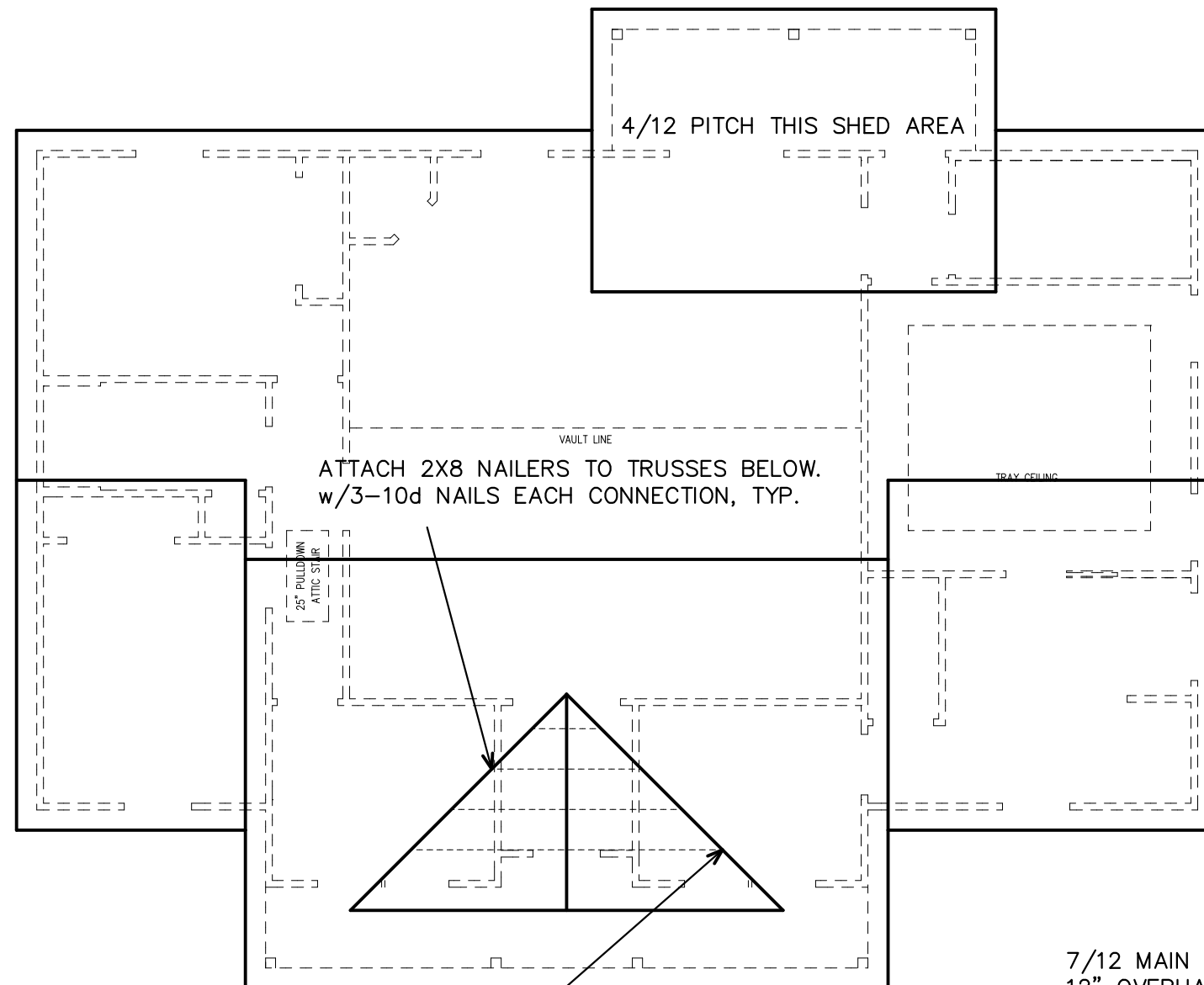

4/12 PITCH THIS SHED AREA

ATTACH 2X8 NAILERS TO TRUSSES BELOW.
w/3-10d NAILS EACH CONNECTION, TYP.

25' PULLDOWN
ATTIC STAIR

VAULT LINE

TRAY CEILING

ATTACH 2X6 RAFTERS TO NAILER
w/SIMPSON H2.5A CLIP AND 10d
TOE NAILS EACH CONNECTION, TYP.

7/12 MAIN ROOF PITCH, 4/12 SHED OVER REAR PORCH AREA ONLY
12" OVERHANGS
ARCHITECTURAL SHINGLES OVER SYNTHETIC UNDERLAYMENT
CONTINUOUS RIDGE VENTS
15/32" OSB ROOF DECKING - SEE PAGE 8 FOR NAILING PATTERNS
ENGINEERED TRUSSES 24" O.C.
SEE MANUFACTURER PROVIDED TRUSS DRAWINGS FOR BRACING DETAILS
TRUSSES TO BE MANUFACTURED PER TPI-95 AND CHAPTER 16 OF SBC

These plans comply with 2023 Florida Building Code, 120 mph wind speed (3 sec. gust)

John K. Gentry, P.E.#16990
P.O. Box 1034
Perry, FL 32348
(850) 672-0145

DATE: 01-08-2026
PAGE 5 OF 8

SQUARE FOOTAGE	
HEATED	1983 S.F.
PORCH	237 S.F.
TOTAL	2220 S.F.

Josh Wilson & Nicole Dempsey
White Springs, Florida

