

Columbia County Property Appraiser

CAMA updated: 5/3/2013

2012 Tax Year

Parcel: 25-4S-16-03152-017

Search Result: 1 of 1

Owner & Property Info

Owner's Name	WEST DIANE A		
Mailing Address	689 SW COUNTY RD 242 LAKE CITY, FL 32024-8922		
Site Address	689 SW COUNTY ROAD 242		
Use Desc. (code)	MOBILE HOM (000200)		
Tax District	2 (County)	Neighborhood	25416
Land Area	1.040 ACRES	Market Area	06
Description	NOTE: This description is not to be used as the Legal Description for this parcel in any legal transaction.		
COMM NE COR, RUN W 1426.38 FT, S 608.4 FT, W 430 FT, S 404.60 FT FOR POB, CONT S 200 FT TO N R/W CR-242, RUN W 225.40 FT, N 200 FT, E 227.3 FT TO POB. ORB 693-284, 792-371. DC ROBERT SEEVER 945-2095, 969-1461, QCD 994-945. DC 1129-892			

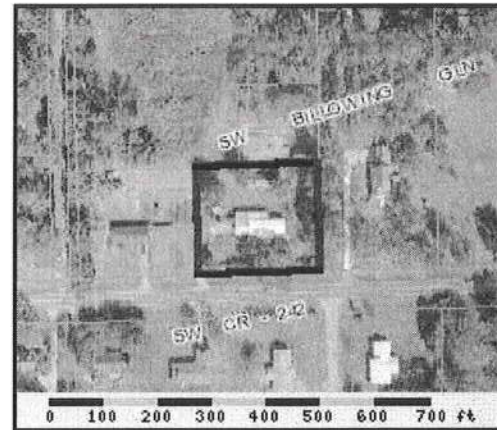

Property & Assessment Values

2012 Certified Values		
Mkt Land Value	cnt: (0)	\$12,921.00
Ag Land Value	cnt: (2)	\$0.00
Building Value	cnt: (1)	\$17,163.00
XFOB Value	cnt: (4)	\$5,200.00
Total Appraised Value		\$35,284.00
Just Value		\$35,284.00
Class Value		\$0.00
Assessed Value		\$35,284.00
Exempt Value	(code: HX H3 SX WX)	\$35,284.00
Total Taxable Value	Cnty: \$0 Other: \$9,784 Schl: \$9,784	

2013 Working Values

NOTE:
2013 Working Values are NOT certified values and therefore are subject to change before being finalized for ad valorem assessment purposes.

Sales History

Sale Date	OR Book/Page	OR Code	Vacant / Improved	Qualified Sale	Sale RCode	Sale Price
6/20/1994	792/371	WD	I	Q		\$53,900.00
8/3/1989	693/284	WD	I	Q		\$54,000.00
4/1/1985	561/333	WD	V	U	01	\$3,000.00

Building Characteristics

Bldg Item	Bldg Desc	Year Blt	Ext. Walls	Heated S.F.	Actual S.F.	Bldg Value
1	MOBILE HME (000800)	1985	(31)	1848	3486	\$16,952.00
Note: All S.F. calculations are based on exterior building dimensions.						

Extra Features & Out Buildings

Code	Desc	Year Blt	Value	Units	Dims	Condition (% Good)
0210	GARAGE U	0	\$2,424.00	0000001.000	20 x 20 x 0	(000.00)
0261	PRCH, UOP	0	\$576.00	0000001.000	12 x 16 x 0	(000.00)