



Scott E. Wyssling, PE
Coleman D. Larsen, SE, PE
Gregory T. Elvestad, PE

76 North Meadowbrook Drive
Alpine, UT 84004
office (201) 874-3483
swyssling@wysslingconsulting.com

January 13, 2023

Lumio Solar
12600 Challenger Parkway, Suite 200
Orlando, FL 32826

Scott
Wyssling, PE

Digitally signed by Scott Wyssling, PE
DN: C=US, S=Utah, L=Alpine,
O=Wyssling Consulting, OU=Engineering,
CN="Scott Wyssling, PE",
E=swyssling@wysslingconsulting.com
Reason: I am the author of this document
Location: your signing location here
Date: 2023.01.13 14:47:23-07'00'
Foxit PDF Editor Version: 11.1.0

Re: Engineering Services
Waite Residence
175 Northeast Fronie Street, Lake City FL
5.200 kW System

To Whom It May Concern:

We have received information regarding solar panel installation on the roof of the above referenced structure. Our evaluation of the structure is to verify the existing capacity of the roof system and its ability to support the additional loads imposed by the proposed solar system.

A. Site Assessment Information

1. Site visit documentation identifying attic information including size and spacing of framing for the existing roof structure.
2. Design drawings of the proposed system including a site plan, roof plan and connection details for the solar panels. This information will be utilized for approval and construction of the proposed system.

B. Description of Structure:

Roof Framing: Prefabricated wood trusses at 24" on center. All truss members are constructed of 2 x 4 dimensional lumber.
Roof Material: Metal Roofing
Roof Slopes: 27 +/- degrees
Attic Access: Accessible
Foundation: Permanent

C. Loading Criteria Used

- **Dead Load**
 - Existing Roofing and framing = 7 psf
 - New Solar Panels and Racking = 3 psf
 - TOTAL = 10 PSF
- **Live Load** = 20 psf (reducible) – 0 psf at locations of solar panels
- **Ground Snow Load** = 0 psf
- **Wind Load** based on ASCE 7-16
 - Ultimate Wind Speed = 120 mph (based on Risk Category II)
 - Exposure Category B

Analysis performed of the existing roof structure utilizing the above loading criteria is in accordance with the FBC 2020 7th Edition, including provisions allowing existing structures to not require strengthening if the new loads do not exceed existing design loads by 105% for gravity elements and 110% for seismic elements. This analysis indicates that the existing framing will support the additional panel loading without damage, if installed correctly.

D. Solar Panel Anchorage

1. The solar panels shall be mounted in accordance with the most recent S-5! Installation manual. If during solar panel installation, the roof framing members appear unstable or deflect non-uniformly, our office should be notified before proceeding with the installation.
2. System will be attached to the metal roofing material utilizing the patented S-5! Connection. Installation of the connections shall be in accordance with the manufacturer's recommendations..
3. Considering the wind speed, roof slopes, size and spacing of framing members, and condition of the roof, the panel supports shall be placed no greater than 48" on center.
4. Panel supports connections shall be staggered to distribute load to adjacent framing members.

Based on the above evaluation, this office certifies that with the racking and mounting specified, the existing roof system will adequately support the additional loading imposed by the solar system. This evaluation is in conformance with the *FBC 2020 7th Edition*, current industry standards and practice, and is based on information supplied to us at the time of this report.

Should you have any questions regarding the above or if you require further information do not hesitate to contact me.

Very truly yours,

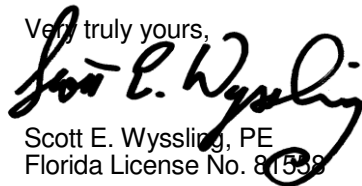

Scott E. Wyssling, PE
Florida License No. 81558

THIS PLAN HAS BEEN ELECTRONICALLY SIGNED AND SEALED BY SCOTT WYSSLING, PE USING A DIGITAL SIGNATURE AND DATE. PRINTED COPIES OF THIS DOCUMENT ARE NOT CONSIDERED SIGNED AND SEALED AND THE SIGNATURE MUST BE VERIFIED ON ANY ELECTRONIC COPIES



Wyssling Consulting, PLLC
76 N Meadowbrook Drive Alpine UT 84004
Florida License # RY34912

Date Signed 1/13/2023



SCOPE OF WORK:

TO INSTALL A ROOF MOUNTED SOLAR PHOTOVOLTAIC SYSTEM AT THE OWNER RESIDENCE LOCATED AT 175 NORTHEAST FRONIE STREET, LAKE CITY, FL 32055.

SYSTEM DC RATING: 5.20 KWDC
 SYSTEM AC RATING: 3.78 KWAC

GENERAL NOTES:

- THESE CONSTRUCTION DOCUMENTS HAVE BEEN BASED ON FIELD INSPECTIONS AND OTHER INFORMATION AVAILABLE AT THE TIME. ACTUAL FIELD CONDITIONS MAY REQUIRE MODIFICATIONS IN CONSTRUCTION DETAILS.
- CONTRACTOR HAS THE FULL RESPONSIBILITY TO CHECK AND VERIFY ALL DIMENSIONS AND EXISTING CONDITIONS. ANY DISCREPANCIES SHALL BE REPORTED TO THE ENGINEER BEFORE PROCEEDING WITH THE WORK. ANY WORK STARTED BEFORE CONSULTATION AND ACCEPTANCE BY THE ENGINEER SHALL BE THE SOLE RESPONSIBILITY OF THE CONTRACTOR AND SHALL BE SUBJECT TO CORRECTION BY THEM WITHOUT ADDITIONAL COMPENSATION.
- THE CONTRACTOR SHALL BE HELD RESPONSIBLE FOR THE PROPER INSTALLATION AND COMPLETION OF THE WORK WITH APPROVED MATERIALS.
- THE EQUIPMENT AND ALL ASSOCIATED WIRING AND INTERCONNECTION SHALL BE INSTALLED ONLY BY QUALIFIED PEOPLE. A QUALIFIED PERSON IS ONE WHO HAS SKILLS AND KNOWLEDGE RELATED TO THE CONSTRUCTION AND OPERATION OF THE ELECTRICAL EQUIPMENT AND INSTALLATIONS AND HAS RECEIVED SAFETY TRAINING TO RECOGNIZE AND AVOID THE HAZARDS INVOLVED. (NEC 690.4(C), NEC 2017).
- NEW CONDUIT ROUTING SHOWN IS ESSENTIALLY SCHEMATIC. CONTRACTOR SHALL LAY OUT RUNS TO SUIT FIELD CONDITIONS AND THE COORDINATION REQUIREMENTS OF OTHER TRADES.
- ARRAY WIRING SHOULD NOT BE READILY ACCESSIBLE EXCEPT TO QUALIFIED PERSONNEL.
- THE AC DISCONNECT MUST BE ACCESSIBLE TO QUALIFIED UTILITY PERSONNEL, BE LOCKABLE, AND BE A VISIBLE-BREAK SWITCH.

SHEET INDEX

CS-0	COVER SHEET & BOM
E-1	STRING LAYOUT & SIGNAGE
E-2	ELECTRICAL DIAGRAM & CALCS.
E-3+	EQUIPMENT SPECIFICATIONS

GOVERNING CODES

2018 NFPA 1 (FIRE CODE) 2020 FFPC (7TH EDITION)
 2017 NATIONAL ELECTRICAL CODE
 2020 FLORIDA BUILDING CODE (7TH EDITION)
 AUTHORITY HAVING JURISDICTION (AHJ): CITY OF LAKE CITY

BILL OF MATERIALS

EQUIPMENT	QTY	DESCRIPTION
SOLAR PV MODULE	13	Q.PEAK DUO BLK ML-G10+ 400
MICROINVERTER	13	ENPHASE IQ8PLUS-72-2-US
JUNCTION BOX	1	JUNCTION BOX, NEMA 3R, UL LISTED
COMBINER BOX	1	ENPHASE IQ COMBINER 4/4C W/ IQ ENVOY (X-IQ-AM1-240-4)
AC DISCONNECT	1	60A NON-FUSED AC DISCONNECT, 240V, NEMA 3R, UL LISTED



ATLANTIC KEY ENERGY LLC
 12600 CHALLENGER PARKWAY
 SUITE 200
 ORLANDO, FL 32826
 1 (407) 988-0273



PROJECT NAME & ADDRESS

GARY WAITE
 RESIDENCE
 PROJECT # P-0065497
 175 NORTHEAST FRONIE STREET
 LAKE CITY, FL 32055

SIGNATURE WITH SEAL

THIS PLAN HAS BEEN ELECTRONICALLY SIGNED AND SEALED BY SCOTT WYSSLING, PE USING A DIGITAL SIGNATURE AND DATE. PRINTED COPIES OF THIS DOCUMENT ARE NOT CONSIDERED SIGNED AND SEALED AND THE SIGNATURE MUST BE VERIFIED ON ANY ELECTRONIC COPIES.



Wyssling Consulting, PLLC
 76 N Meadowbrook Drive Alpine UT 84004
 Florida License # RY34912

Date Signed 1/13/2023

REVISIONS

DESCRIPTION	DATE	REV

Drawn by: CM
 Date: 01/12/2023

SHEET NAME

COVER SHEET & BOM

SHEET NUMBER

CS-0

THIS ITEM HAS BEEN DIGITALLY SIGNED AND SEALED BY SCOTT WYSSLING ON THE DATE ADJACENT TO THE SEAL. PRINTED COPIES OF THIS DOCUMENT ARE NOT CONSIDERED SIGNED AND SEAL, AND THE SIGNATURE MUST BE VERIFIED ON ANY ELECTRONIC COPIES

LEGEND	
X	- MODULE STRING ID
(E)	- EXISTING
(N)	- NEW
(M)	- UTILITY METER
(MSP)	- MAIN SERVICE PANEL
(ACD)	- AC DISCONNECT
(CB)	- COMBINER BOX
LC	- LOAD CENTER
SP	- SUBPANEL
JB	- JUNCTION BOX
SCT	- STRING CENTER TAP
---	- CONDUIT
BAT	- ENERGY STORAGE
ICD	- INTERCONNECTION DEVICE
BUL	- BACK UP LOADS PANEL

- ADHESIVE FASTENED SIGNS:**
- ANSI Z535.4-2011 PRODUCT SAFETY SIGNS AND LABELS, PROVIDES GUIDELINES FOR SUITABLE FONT SIZES, WORDS, COLORS, SYMBOLS, AND LOCATION REQUIREMENTS FOR LABELS. NEC 110.21(B)(1).
 - THE LABEL SHALL BE OF SUFFICIENT DURABILITY TO WITHSTAND THE ENVIRONMENT INVOLVED. NEC 110.21(B)(3).
 - ADHESIVE FASTENED SIGNS MAY BE ACCEPTABLE IF PROPERLY ADHERED. VINYL SIGNS SHALL BE WEATHER RESISTANT.
 - ALL LABELS AND MARKINGS FOR PHOTOVOLTAIC SYSTEMS WILL BE REFLECTIVE AND MEET ALL REQUIREMENTS.

WARNING
ELECTRIC SHOCK HAZARD
DO NOT TOUCH TERMINALS
TERMINALS ON BOTH THE LINE AND
LOAD SIDES MAY BE ENERGIZED
IN THE OPEN POSITION

LABEL LOCATION:
COMBINER BOX/ EMT
ENCLOSURES/ AC DISCONNECT/
MAIN SERVICE PANEL
PER CODE: NEC 2017, 690.13(B)

EMERGENCY RESPONDER
SOLAR PV SYSTEM EQUIPPED
WITH RAPID SHUTDOWN

TURN RAPID SHUTDOWN
SWITCH TO THE "OFF"
POSITION TO SHUT
DOWN THE ENTIRE PV
SYSTEM

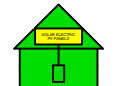

LABEL LOCATION:
RAPID SHUTDOWN (AC DISCONNECT)
PER CODE: NEC 690.56 (C)(1) &
NFPA1 11.12.2.1.1.1.1, 11.12.2.1.4
SHALL BE REFLECTIVE, WITH ALL
LETTERS CAPITALIZED AND HAVING A
MINIMUM HEIGHT OF 3/8 IN. (9.5 MM), IN
WHITE ON RED BACKGROUND.

**WARNING: PHOTOVOLTAIC
POWER SOURCE**

LABEL LOCATION:
CONDUIT/ RACEWAY/ ENCLOSURES/
COMBINER BOX/ AC DISCONNECT
PER CODE: NEC2017, 690.31(G)(3)(4)

**PHOTOVOLTAIC
AC DISCONNECT**

LABEL LOCATION:
AC DISCONNECT/ BREAKER/
POINTS OF CONNECTION
PER CODE: NEC2017, 690.13(B)

PHOTOVOLTAIC AC DISCONNECT
RATED AC OUTPUT CURRENT 15.7 A
NOMINAL OPERATING AC VOLTAGE 240 V

LABEL LOCATION:
AC DISCONNECT
PER CODE: NEC2017, 690.54

**RAPID SHUTDOWN
SWITCH FOR
SOLAR PV SYSTEM**

LABEL LOCATION:
RAPID SHUTDOWN
(AC DISCONNECT)
PER CODE: NEC 690.58 (C)(3)

WARNING
DUAL POWER SOURCE
SOURCES: UTILITY GRID AND
PV SOLAR ELECTRIC SYSTEM

LABEL LOCATION:
POINT OF INTERCONNECTION
PER CODE: NEC 2017, 705.12(B)

! WARNING !
INVERTER OUTPUT CONNECTION. DO NOT
RELOCATE THIS OVERCURRENT DEVICE.

LABEL LOCATION:
POINT-OF-INTERCONNECTION OR AT
MAIN SERVICE DISCONNECT (MSP)
PER CODE: NEC 705.12(B)(2)(3)(b)

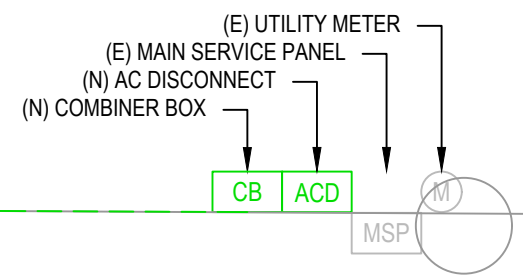
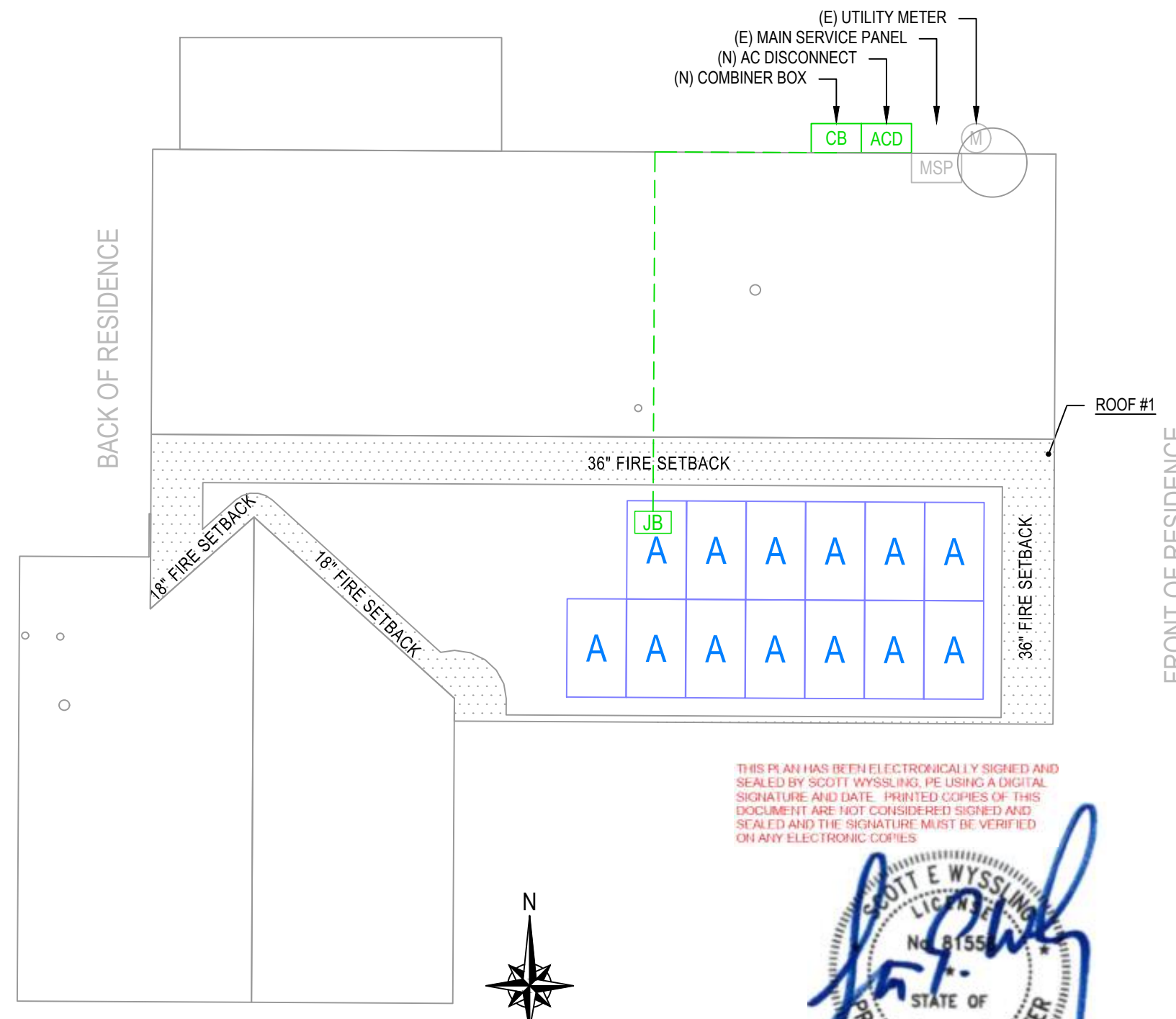

THIS PLAN HAS BEEN ELECTRONICALLY SIGNED AND SEALED BY SCOTT WYSSLING, PE USING A DIGITAL SIGNATURE AND DATE. PRINTED COPIES OF THIS DOCUMENT ARE NOT CONSIDERED SIGNED AND SEALED AND THE SIGNATURE MUST BE VERIFIED ON ANY ELECTRONIC COPIES



Wyssling Consulting, PLLC
76 N Meadowbrook Drive Alpine UT 84004
Florida License # RY34912
Date Signed 1/13/2023

THIS ITEM HAS BEEN DIGITALLY SIGNED AND SEALED BY SCOTT WYSSLING ON THE DATE ADJACENT TO THE SEAL. PRINTED COPIES OF THIS DOCUMENT ARE NOT CONSIDERED SIGNED AND SEAL, AND THE SIGNATURE MUST BE VERIFIED ON ANY ELECTRONIC COPIES

1 | ROOF PLAN WITH STRING LAYOUT
E-1 | SCALE: NTS

AKE SOLAR
ATLANTIC KEY ENERGY LLC
12600 CHALLENGER PARKWAY
SUITE 200
ORLANDO, FL 32826
1 (407) 988-0273

Lumio iX
PROJECT NAME & ADDRESS

GARY WAITE
RESIDENCE
PROJECT # P-0065497
175 NORTHEAST FRONIE STREET
LAKE CITY, FL 32055

SIGNATURE WITH SEAL

REVISIONS		
DESCRIPTION	DATE	REV

Drawn by: CM
Date: 01/12/2023

SHEET NAME
STRING LAYOUT & SIGNAGE
SHEET NUMBER
E-1

ID	INITIAL CONDUCTOR LOCATION	FINAL CONDUCTOR LOCATION	MIN. CONDUCTOR SIZE (AWG)		MIN. DIA CONDUIT SIZE (IN.)	# OF PARALLEL CIRCUITS	CURRENT-CARRYING CONDUCTORS IN CONDUIT	OCPD (A)	MIN. EGC SIZE (AWG)		TEMP. CORR. FACTOR		CONDUIT FILL FACTOR	CONT. CURRENT (A)	MAX. CURRENT (A)	BASE AMP. (A)	DERATED AMP. (A)	TERM. AMP. RATING (A)	LENGTH (FT)	VOLTAGE DROP (%)
1	STRING A	JUNCTION BOX	12	Q CABLE	N/A	1	2	N/A	6	BARE COPPER	0.76	55°C	N/A	15.73	19.66	30	N/A	N/A	45.00	0.47
2	JUNCTION BOX	COMBINER BOX	10	THWN-2 COPPER	0.75 LTNM	1	2	20	10	THWN-2 COPPER	0.76	55°C	1	15.73	19.66	40	30.4	35	67.00	1.09
3	COMBINER BOX	AC DISCONNECT	10	THWN-2 COPPER	0.75 LTNM	1	3	N/A	10	THWN-2 COPPER	0.96	34°C	1	15.73	19.66	40	38.4	35	5.00	0.08
4	AC DISCONNECT	MSP	10	THWN-2 COPPER	0.75 LTNM	1	3	20	10	THWN-2 COPPER	0.96	34°C	1	15.73	19.66	40	38.4	35	5.00	0.08



ATLANTIC KEY ENERGY LLC
 12600 CHALLENGER PARKWAY
 SUITE 200
 ORLANDO, FL 32826
 1 (407) 988-0273

Lumio
 PROJECT NAME & ADDRESS

GARY WAITE
 RESIDENCE
 PROJECT # P-0065497
 175 NORTHEAST FRONIE STREET
 LAKE CITY, FL 32055

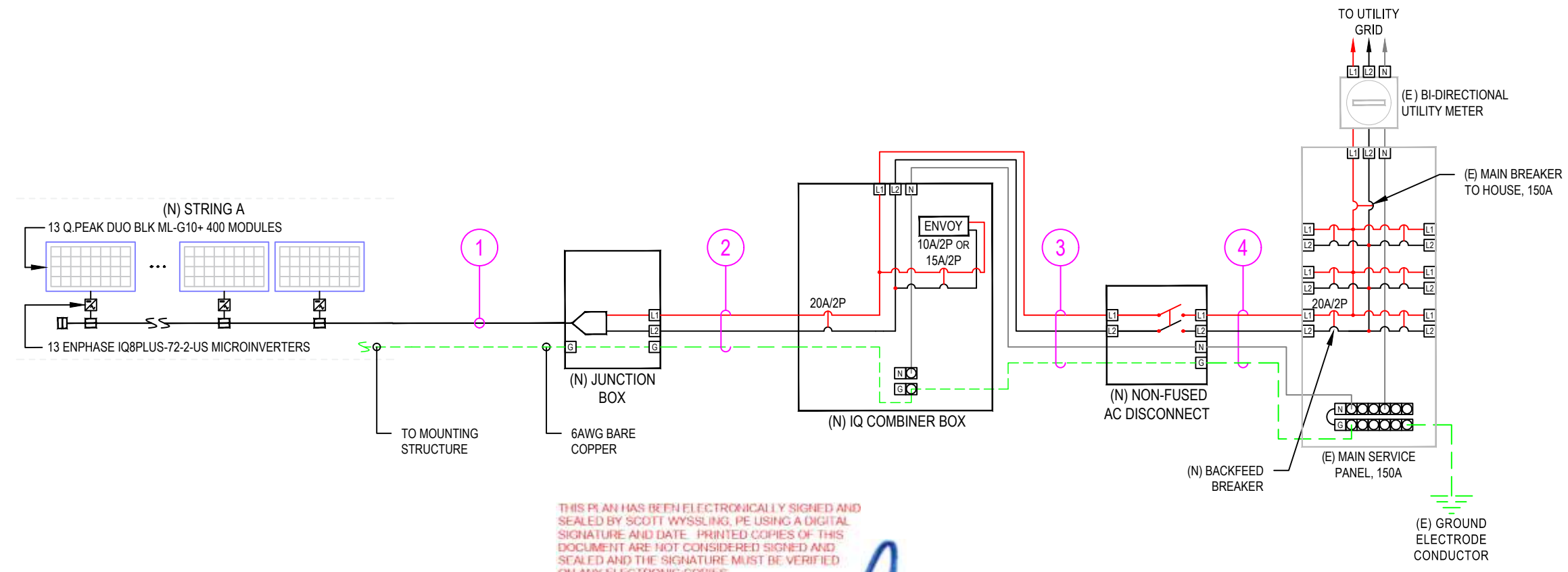

THIS PLAN HAS BEEN ELECTRONICALLY SIGNED AND SEALED BY SCOTT WYSSLING, PE USING A DIGITAL SIGNATURE AND DATE. PRINTED COPIES OF THIS DOCUMENT ARE NOT CONSIDERED SIGNED AND SEALED AND THE SIGNATURE MUST BE VERIFIED ON ANY ELECTRONIC COPIES.



Wyssling Consulting, PLLC
 76 N Meadowbrook Drive Alpine UT 84004
 Florida License # RY34912
 Date Signed 1/13/2023

NOTE:
 1. LTNM OR EQUIVALENT TYPE CONDUIT

LEGEND
 (E) - EXISTING
 (N) - NEW

DESIGN TEMPERATURE SPECIFICATIONS	
RECORD LOW TEMP	1°C
AMBIENT TEMP. (HIGH TEMP. 2%)	34°C
CONDUIT HEIGHT	1.0"
CONDUCTOR TEMP. RATE (ROOF)	55°C

SIGNATURE WITH SEAL

REVISIONS		
DESCRIPTION	DATE	REV

Drawn by: CM
 Date: 01/12/2023

SHEET NAME
ELECTRICAL LINE DIAGRAM & CALCS.
 SHEET NUMBER
E-2

THIS ITEM HAS BEEN DIGITALLY SIGNED AND SEALED BY SCOTT WYSSLING ON THE DATE ADJACENT TO THE SEAL. PRINTED COPIES OF THIS DOCUMENT ARE NOT CONSIDERED SIGNED AND SEALED, AND THE SIGNATURE MUST BE VERIFIED ON ANY ELECTRONIC COPIES.

1 | ELECTRICAL LINE DIAGRAM
 E-2 | SCALE: NTS

MECHANICAL SPECIFICATION

Format	74.0 in x 41.1 in x 1.26 in (including frame) (1879 mm x 1045 mm x 32 mm)
Weight	48.5 lbs (22.0 kg)
Front Cover	0.13 in (3.2 mm) thermally pre-stressed glass with anti-reflection technology
Back Cover	Composite film
Frame	Black anodized aluminum
Cell	6 x 22 monocrystalline Q-ANTUM solar half cells
Junction Box	2.08-3.98 in x 1.26-2.35 in x 0.59-0.71 in (53-101 mm x 32-60 mm x 15-18 mm), IP67, with bypass diodes
Cable	4 mm ² Solar cable; (+) ≥ 49.2 in (1250 mm), (-) ≥ 49.2 in (1250 mm)
Connector	Stäubli MC4; IP68

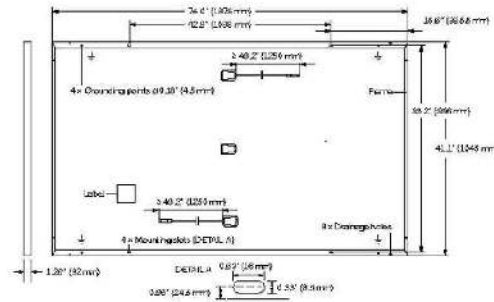

ELECTRICAL CHARACTERISTICS

POWER CLASS		385	390	395	400	405	
MINIMUM PERFORMANCE AT STANDARD TEST CONDITIONS, STC ¹ (POWER TOLERANCE ±5 W / -0 W)							
Minimum	Power at MPP ¹	P _{MPP} [W]	385	390	395	400	405
	Short Circuit Current ¹	I _{SC} [A]	11.04	11.07	11.10	11.14	11.17
	Open Circuit Voltage ¹	V _{OC} [V]	45.19	45.23	45.27	45.30	45.34
	Current at MPP	I _{MPP} [A]	10.59	10.65	10.71	10.77	10.83
	Voltage at MPP	V _{MPP} [V]	36.38	36.62	36.88	37.13	37.39
	Efficiency ¹	η [%]	≥19.6	≥19.9	≥20.1	≥20.4	≥20.6
MINIMUM PERFORMANCE AT NORMAL OPERATING CONDITIONS, NMOT ²							
Minimum	Power at MPP	P _{MPP} [W]	288.8	292.6	296.3	300.1	303.8
	Short Circuit Current	I _{SC} [A]	8.90	8.92	8.95	8.97	9.00
	Open Circuit Voltage	V _{OC} [V]	42.62	42.65	42.69	42.72	42.76
	Current at MPP	I _{MPP} [A]	8.35	8.41	8.46	8.51	8.57
	Voltage at MPP	V _{MPP} [V]	34.59	34.81	35.03	35.25	35.46

¹Measurement tolerances P_{MPP} ± 3%; I_{SC} V_{OC} ± 5% at STC: 1000 W/m², 25 ± 2 °C, AM 1.5 according to IEC 60904-3: 2000 W/m², NMOT, spectrum AM 1.5

Q CELLS PERFORMANCE WARRANTY

PERFORMANCE AT LOW IRRADIANCE

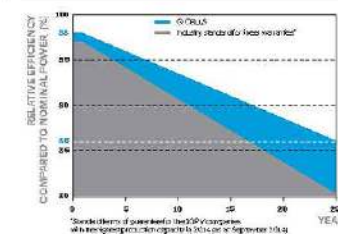

At least 98% of nominal power during first year. Thereafter max. 0.5% degradation per year. At least 98.5% of nominal power up to 10 years. At least 86% of nominal power up to 25 years.

All data within measurement tolerances. Full warranties in accordance with the warranty terms of the Q CELLS sales organization of your respective country.

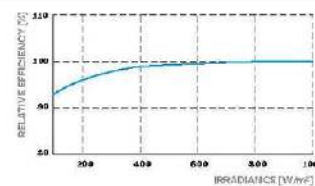

Typical module performance under low irradiance conditions in comparison to STC conditions (25 °C, 1000 W/m²)

TEMPERATURE COEFFICIENTS

Temperature Coefficient of I _{SC}	α	[%/K]	+0.04	Temperature Coefficient of V _{OC}	β	[%/K]	-0.27
Temperature Coefficient of P _{MPP}	γ	[%/K]	-0.34	Nominal Module Operating Temperature	NMOT	[°C]	109 ± 5.4 (43 ± 3 °C)

PROPERTIES FOR SYSTEM DESIGN

Maximum System Voltage V _{sys}	[V]	1000 (IEC)/1000 (UL)	PV module classification	Class II
Maximum Series Fuse Rating	[A DC]	20	Fire Rating based on ANSI/UL 61730	TYPE 2
Max. Design Load, Push / Pull ¹	[lbs/ft ²]	75 (3500 Pa) / 85 (2650 Pa)	Permitted Module Temperature on Continuous Duty	-40 °F up to +185 °F (-40 °C up to +85 °C)
Max. Test Load, Push / Pull ²	[lbs/ft ²]	113 (5400 Pa) / 84 (4000 Pa)		

¹ See Installation Manual

QUALIFICATIONS AND CERTIFICATES

UL 61730, CE compliant
Quality Controlled PV - 10Y (rheinstad)
IEC 61215/2016, IEC 61730/2016,
US Patent No. 8,083,215 (solar cells),
GCPV Certification ongoing.



PACKAGING INFORMATION

Horizontal packaging	78.4 in 1940 mm	43.3 in 1100 mm	48.0 in 1220 mm	1856 lbs 751 kg	24 pellets	24 pellets	32 modules
----------------------	--------------------	--------------------	--------------------	--------------------	---------------	---------------	---------------

Specifications subject to technical change © Q CELLS Q-CELLS DUO BULK INK-GLO™, 385-405, 2021-CE, Rev01.1A

IQ8 and IQ8+ Microinverters

INPUT DATA (DC)		IQ8-60-2-US	IQ8PLUS-72-2-US
Commonly used module pairings ¹	W	235 - 350	235 - 440
Module compatibility		60-cell/120 half-cell	60-cell/120 half-cell and 72-cell/144 half-cell
MPPT voltage range	V	27 - 37	29 - 45
Operating range	V	25 - 48	25 - 58
Min/max start voltage	V	30 / 48	30 / 58
Max input DC voltage	V	50	60
Max DC current ² (module I _{sc})	A		15
Overvoltage class DC port			II
DC port backfeed current	mA		0
PV array configuration		1x1 Ungrounded array; No additional DC side protection required; AC side protection requires max 20A per branch circuit	
OUTPUT DATA (AC)		IQ8-60-2-US	IQ8PLUS-72-2-US
Peak output power	VA	245	300
Max continuous output power	VA	240	290
Nominal (L-L) voltage/range ³	V		240 / 211 - 264
Max continuous output current	A	10	1.21
Nominal frequency	Hz		60
Extended frequency range	Hz		50 - 68
Max units per 20 A (L-L) branch circuit ⁴		16	13
Total harmonic distortion			<5%
Overvoltage class AC port			III
AC port backfeed current	mA		30
Power factor setting			1.0
Grid-tied power factor (adjustable)			0.85 leading - 0.85 lagging
Peak efficiency	%	97.5	97.6
CEC weighted efficiency	%	97	97
Night-time power consumption	mW		60
MECHANICAL DATA			
Ambient temperature range		-40 °C to +60 °C (-40 °F to +140 °F)	
Relative humidity range		4% to 100% (condensing)	
DC Connector type		MC4	
Dimensions (HxWxD)		212 mm (8.3") x 175 mm (6.9") x 30.2 mm (1.2")	
Weight		108 kg (2.38 lbs)	
Cooling		Natural convection - no fans	
Approved for wet locations		Yes	
Acoustic noise at 1 m		<60 dBA	
Pollution degree		PD3	
Enclosure		Class II double-insulated, corrosion resistant polymeric enclosure	
Environ. category / UV exposure rating		NEMA Type 6 / outdoor	
COMPLIANCE			
Certifications		CA Rule 21 (UL 1741-SA), UL 62109-1, UL1741/IEEE1547, FCC Part 15 Class B, ICES-0003 Class B, CAN/CSA-C22.2 NO. 1071-01	

(1) No enforced DC/AC ratio. See the compatibility calculator at <https://link.enphase.com/> module-compatibility (2) Maximum continuous input DC current is 10.6A (3) Nominal voltage range can be extended beyond nominal if required by the utility. (4) Limits may vary. Refer to local requirements to define the number of microinverters per branch in your area.

IQ8SP-DS-0002-01-EN-US-2021-10-19



ATLANTIC KEY ENERGY LLC
12600 CHALLENGER PARKWAY
SUITE 200
ORLANDO, FL 32826
1 (407) 988-0273



PROJECT NAME & ADDRESS

GARY WAITE
RESIDENCE
PROJECT # P-0065497
175 NORTHEAST FRONIE STREET
LAKE CITY, FL 32055

SIGNATURE WITH SEAL

REVISIONS

DESCRIPTION	DATE	REV

Drawn by: CM

Date: 01/12/2023

SHEET NAME

EQUIPMENT
SPECIFICATIONS

SHEET NUMBER

E-3



ATLANTIC KEY ENERGY LLC
12600 CHALLENGER PARKWAY
SUITE 200
ORLANDO, FL 32826
1 (407) 988-0273



PROJECT NAME & ADDRESS

GARY WAITE
RESIDENCE
PROJECT # P-0065497
175 NORTHEAST FRONIE STREET
LAKE CITY, FL 32055

SIGNATURE WITH SEAL

REVISIONS

DESCRIPTION	DATE	REV

Drawn by: CM

Date: 01/12/2023

SHEET NAME

EQUIPMENT
SPECIFICATIONS

SHEET NUMBER

E-4

Enphase IQ Combiner 4/4C

MODEL NUMBER

IQ Combiner 4 (X-IQ-AM1-240-4)	IQ Combiner 4 with Enphase IQ Gateway printed circuit board for integrated revenue grade PV production metering (ANSI C12.20 +/- 0.5%) and consumption monitoring (+/- 2.5%). Includes a silver solar shield to match the IQ Battery system and IQ System Controller 2 and to deflect heat.
IQ Combiner 4C (X-IQ-AM1-240-4C)	IQ Combiner 4C with Enphase IQ Gateway printed circuit board for integrated revenue grade PV production metering (ANSI C12.20 +/- 0.5%) and consumption monitoring (+/- 2.5%). Includes Enphase Mobile Connect cellular modem (CELLMODEM-M1-06-SP-05), a plug-and-play industrial-grade cell modem for systems up to 60 microinverters. (Available in the US, Canada, Mexico, Puerto Rico, and the US Virgin Islands, where there is adequate cellular service in the installation area.) Includes a silver solar shield to match the IQ Battery and IQ System Controller and to deflect heat.

ACCESSORIES AND REPLACEMENT PARTS (not included, order separately)

Ensemble Communications Kit COMMS-CELLMODEM-M1-06 CELLMODEM-M1-06-SP-05 CELLMODEM-M1-06-AT-05	- Includes COMMS-KIT-01 and CELLMODEM-M1-06-SP-05 with 5-year Sprint data plan for Ensemble sites - 4G based LTE-M1 cellular modem with 5-year Sprint data plan - 4G based LTE-M1 cellular modem with 5-year AT&T data plan
Circuit Breakers BRK-10A-2-240V BRK-15A-2-240V BRK-20A-2P-240V BRK-15A-2P-240V-B BRK-20A-2P-240V-B	Supports Eaton BR210, BR215, BR220, BR230, BR240, BR250, and BR260 circuit breakers. Circuit breaker, 2 pole, 10A, Eaton BR210 Circuit breaker, 2 pole, 15A, Eaton BR215 Circuit breaker, 2 pole, 20A, Eaton BR220 Circuit breaker, 2 pole, 15A, Eaton BR215B with hold down kit support Circuit breaker, 2 pole, 20A, Eaton BR220B with hold down kit support
EPLC-01	Power line carrier (communication bridge pair), quantity - one pair
XA-SOLARSHIELD-ES	Replacement solar shield for IQ Combiner 4/4C
XA-PLUG-120-3	Accessory receptacle for Power Line Carrier in IQ Combiner 4/4C (required for EPLC-01)
XA-ENV-PCBA-3	Replacement IQ Gateway printed circuit board (PCB) for Combiner 4/4C
X-IQ-NA-HD-125A	Hold down kit for Eaton circuit breaker with screws.

ELECTRICAL SPECIFICATIONS

Rating	Continuous duty
System voltage	120/240 VAC, 60 Hz
Eaton BR series busbar rating	125 A
Max. continuous current rating	65 A
Max. continuous current rating (input from PV/storage)	64 A
Max. fuse/circuit rating (output)	90 A
Branch circuits (solar and/or storage)	Up to four 2-pole Eaton BR series Distributed Generation (DG) breakers only (not included)
Max. total branch circuit breaker rating (input)	80A of distributed generation / 95A with IQ Gateway breaker included
Production metering CT	200 A solid core pre-installed and wired to IQ Gateway
Consumption monitoring CT (CT-200-SPLIT)	A pair of 200 A split core current transformers

MECHANICAL DATA

Dimensions (WxHxD)	37.5 x 49.5 x 16.8 cm (14.75" x 19.5" x 6.63"). Height is 21.06" (53.5 cm) with mounting brackets.
Weight	7.5 kg (16.5 lbs)
Ambient temperature range	-40° C to +46° C (-40° to 115° F)
Cooling	Natural convection, plus heat shield
Enclosure environmental rating	Outdoor, NRTL-certified, NEMA type 3R, polycarbonate construction
Wire sizes	- 20 A to 50 A breaker inputs: 14 to 4 AWG copper conductors - 60 A breaker branch input: 4 to 1/0 AWG copper conductors - Main lug combined output: 10 to 2/0 AWG copper conductors - Neutral and ground: 14 to 1/0 copper conductors Always follow local code requirements for conductor sizing.
Altitude	To 2000 meters (6,560 feet)

INTERNET CONNECTION OPTIONS

Integrated Wi-Fi	802.11b/g/n
Cellular	CELLMODEM-M1-06-SP-05, CELLMODEM-M1-06-AT-05 (4G based LTE-M1 cellular modem). Note that an Enphase Mobile Connect cellular modem is required for all Ensemble installations.
Ethernet	Optional, 802.3, Cat5E (or Cat 6) UTP Ethernet cable (not included)

COMPLIANCE

Compliance, IQ Combiner	UL 1741, CAN/CSA C22.2 No. 107.1, 47 CFR, Part 15, Class B, ICES 003 Production metering: ANSI C12.20 accuracy class 0.5 (PV production) Consumption metering: accuracy class 2.5
Compliance, IQ Gateway	UL 60601-1/CANCSA 22.2 No. 61010-1

To learn more about Enphase offerings, visit enphase.com

© 2021 Enphase Energy. All rights reserved. Enphase, the Enphase logo, IQ Combiner 4/4C, and other names are trademarks of Enphase Energy, Inc. Data subject to change. 10-21-2021

