

# Columbia County, FLA - Building & Zoning Property Map

Printed: Tue Mar 25 2025 23:33:57 GMT-0400 (Eastern Daylight Time)

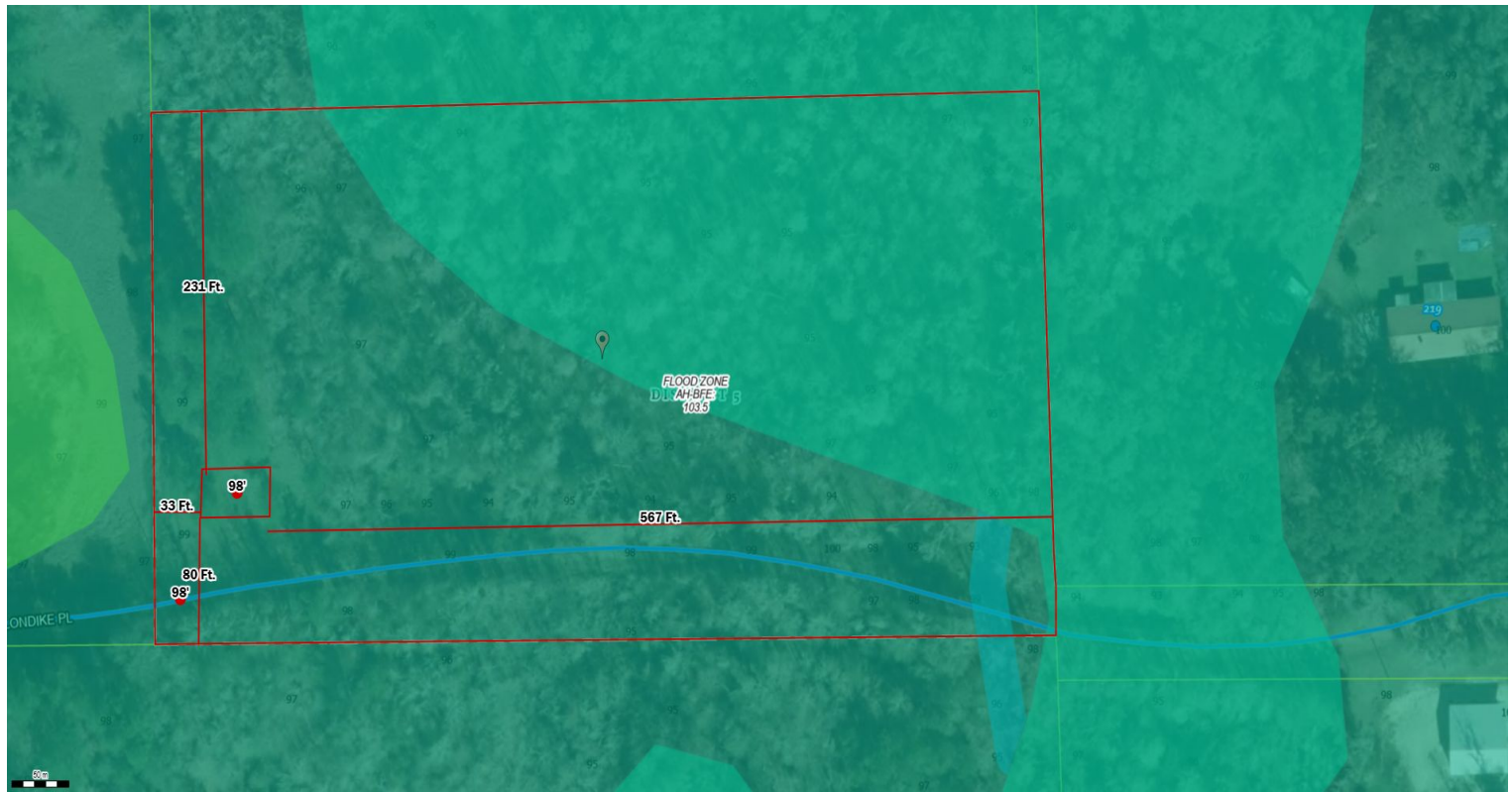

Parcel No: 09-4S-17-08301-017  
Owner: MCCLAIN JOHN R IV,  
Subdivision:  
Lot:  
Acres: 5.09294653  
Deed Acres: 5 Ac  
District: District 5 Tim Murphy  
Future Land Uses: Residential - Low  
Flood Zones: AH  
Official Zoning Atlas: RSF-2

All data, information, and maps are provided "as is" without warranty or any representation of accuracy, timeliness of completeness. Columbia County, FL makes no warranties, express or implied, as to the use of the information obtained here. There are no implied warranties of merchantability or fitness for a particular purpose. The requester acknowledges and accepts all limitations, including the fact that the data, information, and maps are dynamic and in a constant state of maintenance, and update.