



Load Short Form
Entire House
WebReps LLC.

Job: 555 SW Rolling Meadows ...
Date: March 21th 2024
By: Kenneth D. Puzinas
Plan: 555 SW Rolling Meadows

1880 82nd Avenue Suite # 203, Vero Beach, FL 32966 Phone: 800-810-3280 Fax: 888 971 2999 Email: manualj@webrepshvac.com Web: www.webrepswholesale.com

Project Information

For: Andres Velo, Owner
 15820 SW 280th Street, Homestead, FL 33031
 Phone: 305-726-8002
 Email: veloandres@yahoo.com

Design Information

	Htg	Clg	Method	Infiltration
Outside db (°F)	33	92		Simplified
Inside db (°F)	70	75	Construction quality	Semi-tight
Design TD (°F)	37	17	Fireplaces	0
Daily range	-	M		
Inside humidity (%)	30	50		
Moisture difference (gr/lb)	10	43		

HEATING EQUIPMENT

Make Goodman Mfg.
 Trade GOODMAN
 Model GSZB406010A*
 AHRI ref 212587720

Efficiency 7.5 HSPF2

Heating input
 Heating output 55000 Btuh @ 47°F
 Temperature rise 28 °F
 Actual air flow 1800 cfm
 Air flow factor 0.052 cfm/Btuh
 Static pressure 0.60 in H2O
 Space thermostat
 Capacity balance point = 27 °F

COOLING EQUIPMENT

Make Goodman Mfg.
 Trade GOODMAN
 Cond GSZB406010A*
 Coil L(E,G)M60B4
 AHRI ref 212587720

Efficiency 11.2 EER2, 14.3 SEER2

Sensible cooling 37800 Btuh
 Latent cooling 16200 Btuh
 Total cooling 54000 Btuh
 Actual air flow 1800 cfm
 Air flow factor 0.053 cfm/Btuh
 Static pressure 0.60 in H2O
 Load sensible heat ratio 0.70

Backup:
 Input = 12 kW, Output = 40766 Btuh, 100 AFUE

ROOM NAME	Area (ft²)	Htg load (Btuh)	Clg load (Btuh)	Htg AVF (cfm)	Clg AVF (cfm)
MASTER BEDROOM	259	3199	2786	167	147
PWDR	34	437	100	23	5
AC	19	0	0	0	0
MASTER BATH	125	940	284	49	15
M WIC	75	1469	337	76	18
ENTRY AREA	180	1346	522	70	28
UP	58	0	0	0	0
DINING ROOM	195	3035	3023	158	160
KITCHEN	220	1320	2291	69	121
LIVING ROOM	272	1991	2033	104	108
LAUNDRY	113	3722	2132	194	113
BEDROOM 3	196	2981	3911	155	207
CL3	19	0	0	0	0
CH	3	0	0	0	0

Calculations approved by ACCA to meet all requirements of Manual J 8th Ed.

LOFT BALCONY	684	8393	9259	437	490
CL2	17	0	0	0	0
BEDROOM 2	183	2897	3789	151	201
BATH 2	56	486	573	25	30
OPEN TO BELOW	222	2362	2958	123	157
DWN	58	0	0	0	0
Entire House	2988	34578	33997	1800	1800
Other equip loads		7182	3986		
Equip. @ 1.00 RSM			37983		
Latent cooling			16082		
TOTALS	2988	41760	54066	1800	1800

Calculations approved by ACCA to meet all requirements of Manual J 8th Ed.





Project Summary
Entire House
WebReps LLC.

Job: 555 SW Rolling Meadows ...
Date: March 21th 2024
By: Kenneth D. Puzinas
Plan: 555 SW Rolling Meadows

1880 82nd Avenue Suite # 203, Vero Beach, FL 32966 Phone: 800-810-3280 Fax: 888 971 2999 Email: manualj@webrepshvac.com Web: www.webrepswholesale.com

Project Information

For: Andres Velo, Owner
 15820 SW 280th Street, Homestead, FL 33031
 Phone: 305-726-8002
 Email: veloandres@yahoo.com
Notes: 555 SW Rolling Meadows Glen, Fort White, FL 32038

Design Information

Weather: Gainesville, FL, US

Winter Design Conditions

Outside db 33 °F
 Inside db 70 °F
 Design TD 37 °F

Summer Design Conditions

Outside db 92 °F
 Inside db 75 °F
 Design TD 17 °F
 Daily range M
 Relative humidity 50 %
 Moisture difference 43 gr/lb

Heating Summary

Structure 28689 Btuh
 Ducts (R-8.0) 5889 Btuh
 Central vent (120 cfm) 4808 Btuh
 Outside air
 Humidification 2374 Btuh
 Piping 0 Btuh
 Equipment load 41760 Btuh

Sensible Cooling Equipment Load Sizing

Structure 26122 Btuh
 Ducts (R-8.0) 7876 Btuh
 Central vent (120 cfm) 2280 Btuh
 Outside air
 Blower 1707 Btuh
 Use manufacturer's data y
 Rate/swing multiplier 1.00
 Equipment sensible load 37983 Btuh

Infiltration

Method Simplified
 Construction quality Semi-tight
 Fireplaces 0

Latent Cooling Equipment Load Sizing

Structure 10892 Btuh
 Ducts 1670 Btuh
 Central vent (120 cfm) 3521 Btuh
 Outside air
 Equipment latent load 16082 Btuh
Equipment Total Load (Sen+Lat) 54066 Btuh
 Req. total capacity at 0.70 SHR 4.5 ton

	Heating	Cooling
Area (ft ²)	2988	2988
Volume (ft ³)	31150	31150
Air changes/hour	0.28	0.15
Equiv. AVF (cfm)	145	78

Heating Equipment Summary

Make Goodman Mfg.
 Trade GOODMAN
 Model GSZB406010A*
 AHRI ref 212587720
 Efficiency 7.5 HSPF2
 Heating input
 Heating output 55000 Btuh @ 47°F
 Temperature rise 28 °F
 Actual air flow 1800 cfm
 Air flow factor 0.052 cfm/Btuh
 Static pressure 0.60 in H2O
 Space thermostat
 Capacity balance point = 27 °F

Cooling Equipment Summary

Make Goodman Mfg.
 Trade GOODMAN
 Cond GSZB406010A*
 Coil L(E,G)M60B4
 AHRI ref 212587720
 Efficiency 11.2 EER2, 14.3 SEER2
 Sensible cooling 37800 Btuh
 Latent cooling 16200 Btuh
 Total cooling 54000 Btuh
 Actual air flow 1800 cfm
 Air flow factor 0.053 cfm/Btuh
 Static pressure 0.60 in H2O
 Load sensible heat ratio 0.70

Backup:
 Input = 12 kW, Output = 40766 Btuh, 100 AFUE

Calculations approved by ACCA to meet all requirements of Manual J 8th Ed.

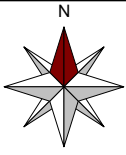

Main Floor

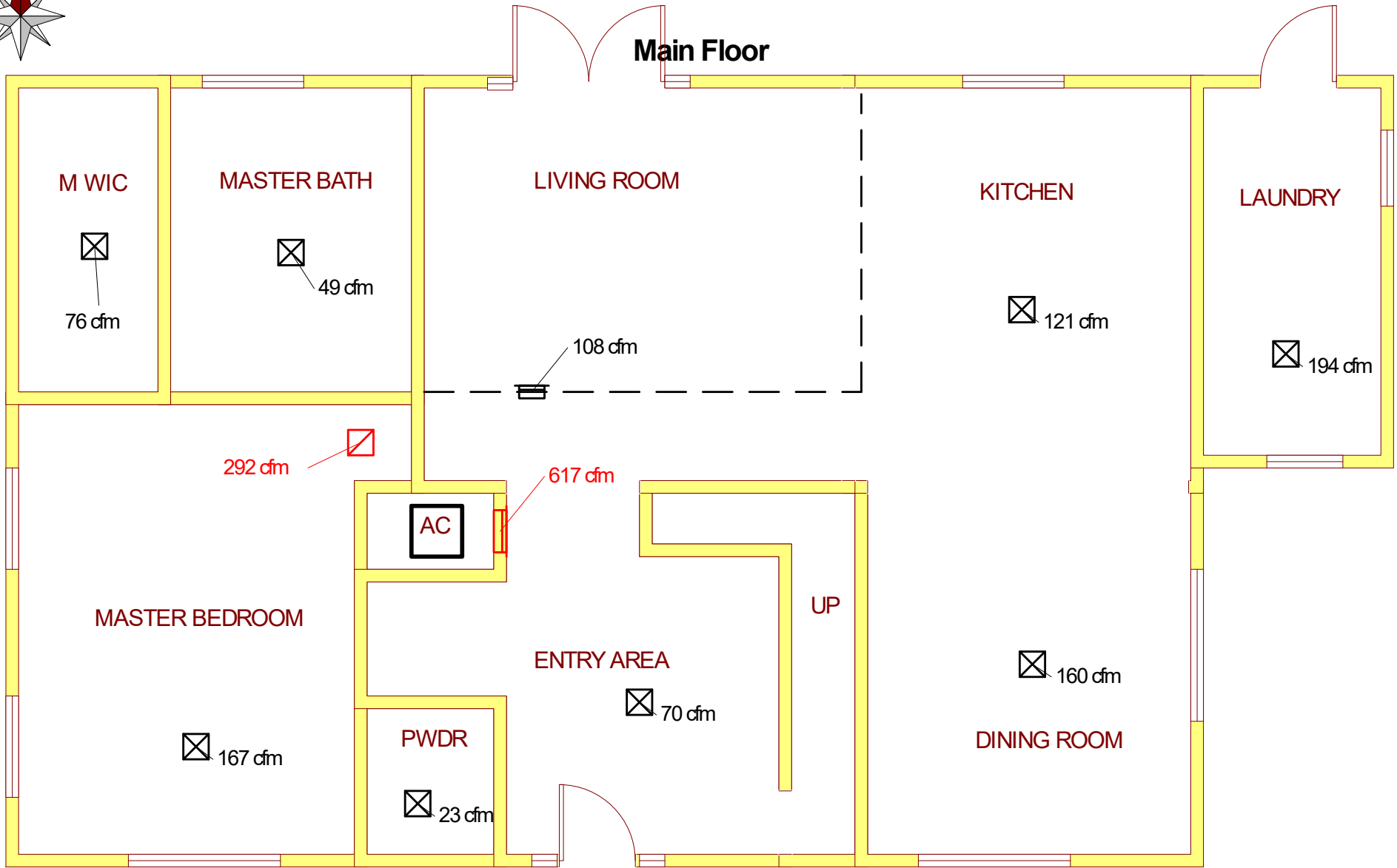

Job #: 555 SW Rolling Meadows Glen
Performed by Kenneth D. Puzinas for:

Andres Velo
15820 SW 280th Street
Homestead, FL 33031
Phone: 305-726-8002
veloandres@yahoo.com

WebReps LLC.

1880 82nd Avenue Suite # 203
Vero Beach, FL 32966
Phone: 800-810-3280 Fax: 888 971 2999
www.webrepswholesale.com manualj@webrepshvac.com

Scale: 1 : 67

Page 1
Right-Suite® Universal 2023
23.0.05 RSU 16998
2024-Mar-25 17:07:27
...Rolling Meadows Glen (Velo).rup



Second Floor

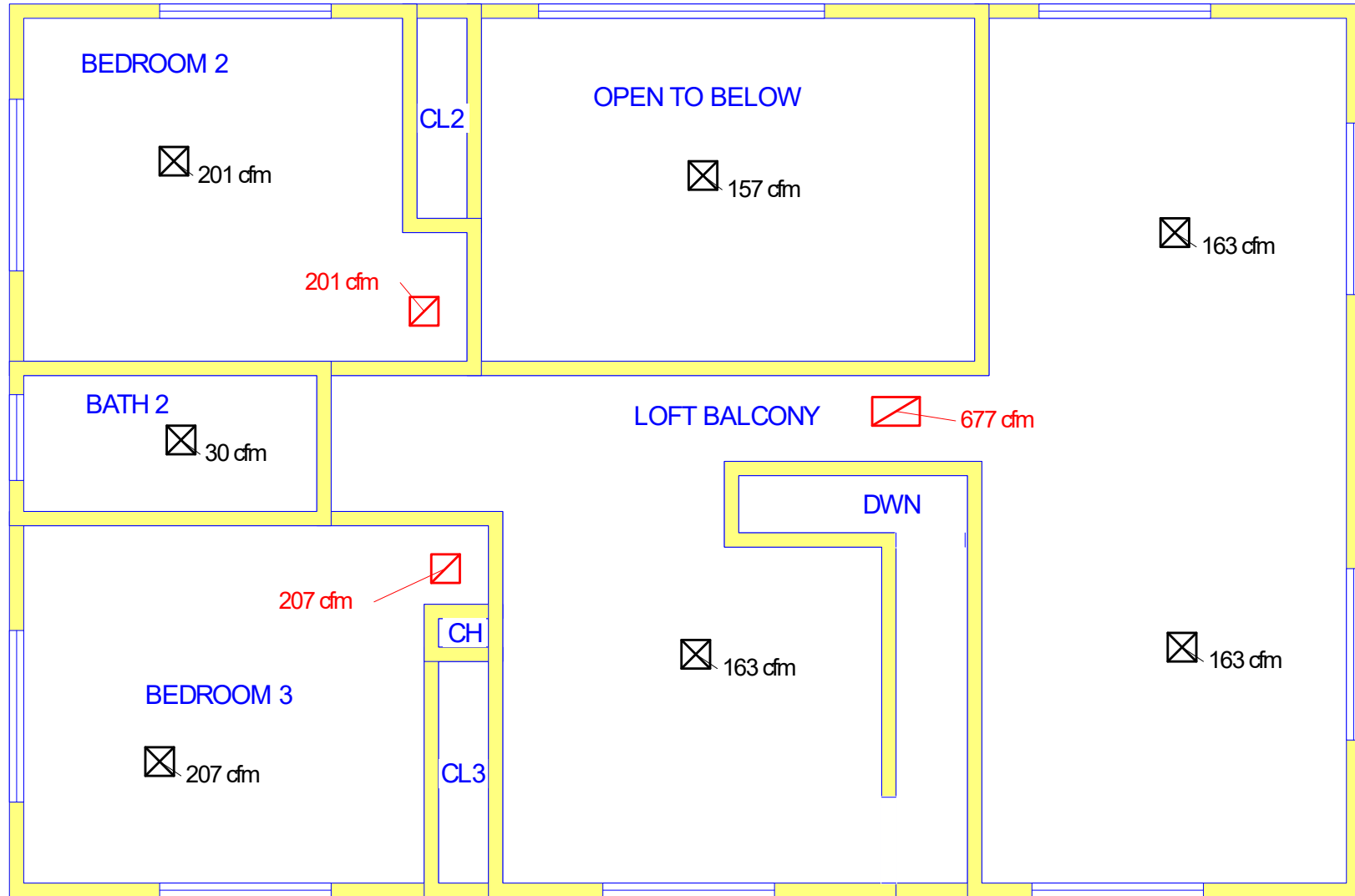

Job #: 555 SW Rolling Meadows Glen
Performed by Kenneth D. Puzinas for:

Andres Velo
15820 SW 280th Street
Homestead, FL 33031
Phone: 305-726-8002
veloandres@yahoo.com

WebReps LLC.

1880 82nd Avenue Suite # 203
Vero Beach, FL 32966
Phone: 800-810-3280 Fax: 888 971 2999
www.webrepswholesale.com manualj@webrepshvac.com

Scale: 1 : 67

Page 2
Right-Suite® Universal 2023
23.005RSU16998
2024-Mar-25 17:07:28
...Rolling Meadows Glen (Velo).rup