

# Mobile Home Permit Worksheet

Installer: Jacob Trowell License # IH/1148380  
 Address of home being installed: 225 NW Sugar Glade Ln, Lake City, FL 32055  
 Manufacturer: Town Home Length x width: 64 x 45

Application Number: \_\_\_\_\_ Date: \_\_\_\_\_

New Home  Used Home   
 Home installed to the Manufacturer's Installation Manual   
 Home is installed in accordance with Rule 15-C   
 Single wide  Wind Zone II  Wind Zone III   
 Double wide  Installation Decal # 127849  
 Triple/Quad  Serial # FLTHCT3226T-4650ABC

**NOTE:** if home is a single wide fill out one half of the blocking plan  
 if home is a triple or quad wide sketch in remainder of home  
 I understand Lateral Arm Systems cannot be used on any home (new or used)  
 where the sidewall ties exceed 5 ft 4 in.

Installer's initials JT

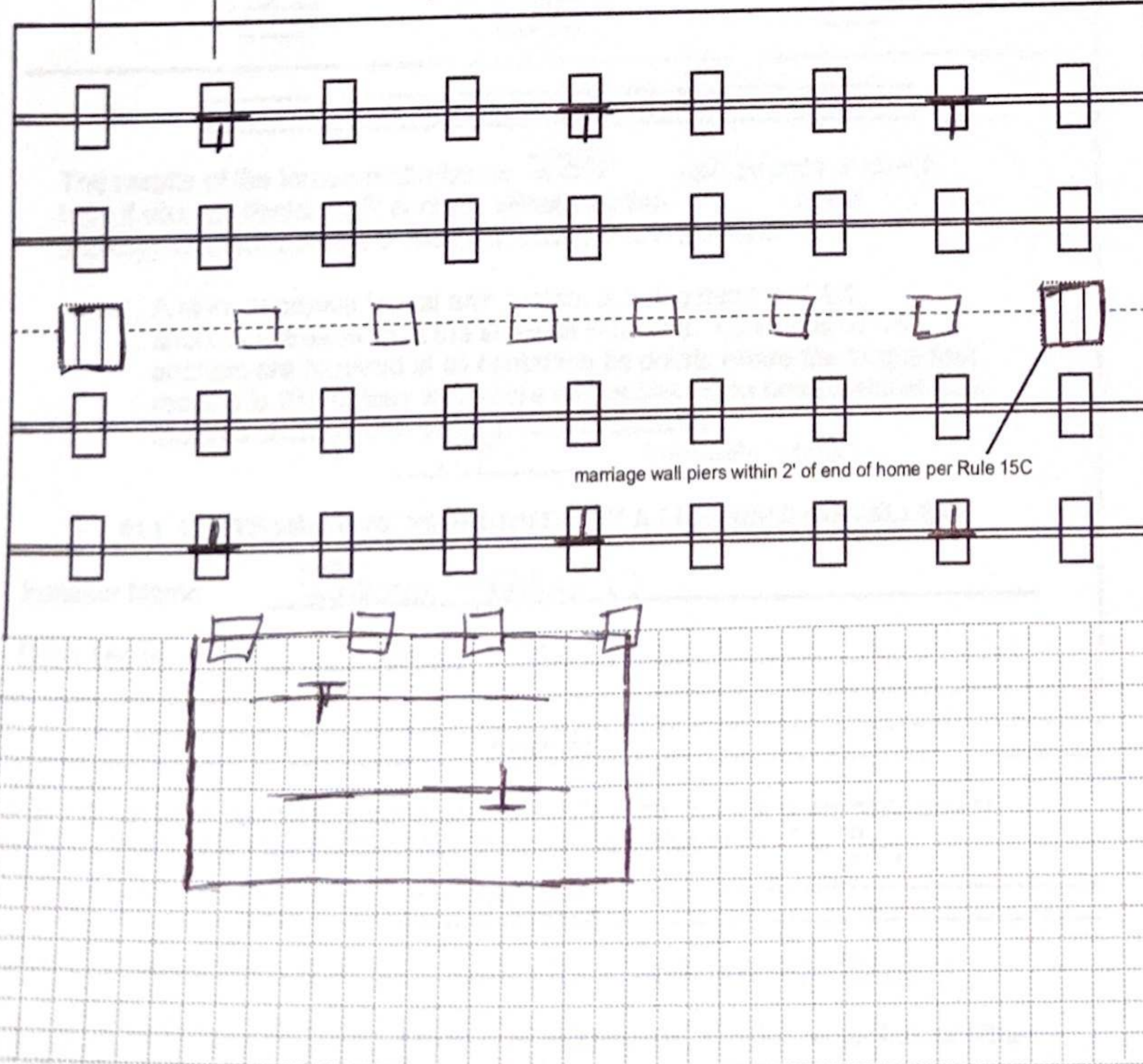
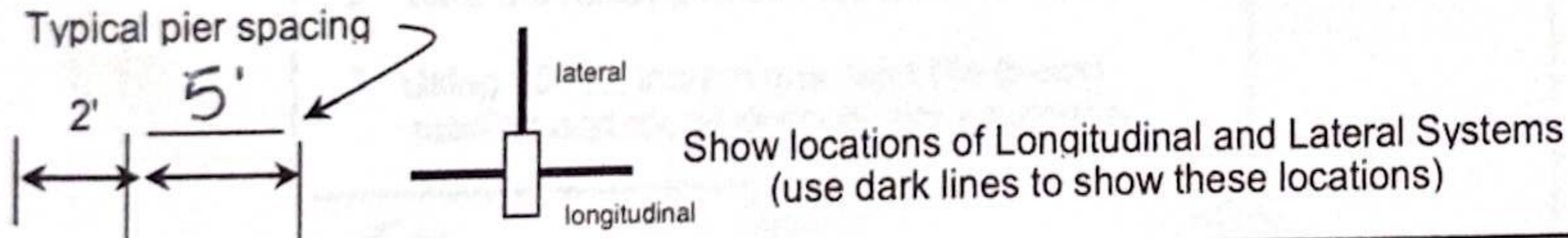

## PIER SPACING TABLE FOR USED HOMES

Load bearing capacity	Footer size (sq in)	16" x 16" (256)	18 1/2" x 18 1/2" (342)	20" x 20" (400)	22" x 22" (484)*	24" x 24" (576)*	26" x 26" (676)
1000 psf		3'	4'	5'	6'	7'	8'
1500 psf		4' 6"	6'	7'	8'	8'	8'
2000 psf		6'	8'	8'	8'	8'	8'
2500 psf		7' 6"	8'	8'	8'	8'	8'
3000 psf		8'	8'	8'	8'	8'	8'
3500 psf		8'	8'	8'	8'	8'	8'

\* interpolated from Rule 15C-1 pier spacing table.

### PIER PAD SIZES

I-beam pier pad size 17x25  
 Perimeter pier pad size 16x16  
 Other pier pad sizes (required by the mfg.) \_\_\_\_\_

Draw the approximate locations of marriage wall openings 4 foot or greater. Use this symbol to show the piers.

List all marriage wall openings greater than 4 foot and their pier pad sizes below.

Opening	Pier pad size
_____	_____
_____	_____
_____	_____

### TIEDOWN COMPONENTS

**Longitudinal Stabilizing Device (LSD)**  
 Manufacturer \_\_\_\_\_  
**Longitudinal Stabilizing Device w/ Lateral Arms**  
 Manufacturer O.T.I (8)

### POPULAR PAD SIZES

Pad Size	Sq In
16 x 16	256
16 x 18	288
18.5 x 18.5	342
16 x 22.5	360
17 x 22	374
13 1/4 x 26 1/4	348
20 x 20	400
17 3/16 x 25 3/16	441
17 1/2 x 25 1/2	446
24 x 24	576
26 x 26	676

### ANCHORS

4 ft  5 ft

### FRAME TIES

within 2' of end of home spaced at 5' 4" oc

### OTHER TIES

	Number
Sidewall	<u>TBD</u>
Longitudinal	<u>N/A</u>
Marriage wall	<u>TBD</u>
Shearwall	<u>TBD</u>

# Mobile Home Permit Worksheet

Application Number: \_\_\_\_\_ Date: \_\_\_\_\_

## POCKET PENETROMETER TEST

The pocket penetrometer tests are rounded down to 1500 psf or check here to declare 1000 lb. soil without testing.

x 1500      x 2000      x 1500

### POCKET PENETROMETER TESTING METHOD

1. Test the perimeter of the home at 6 locations.
2. Take the reading at the depth of the footer.
3. Using 500 lb. increments, take the lowest reading and round down to that increment.

x 1500      x 2000      x 1500

## TORQUE PROBE TEST

The results of the torque probe test is 285 inch pounds or check here if you are declaring 5' anchors without testing. A test showing 275 inch pounds or less will require 5 foot anchors.

**Note:** A state approved lateral arm system is being used and 4 ft. anchors are allowed at the sidewall locations. I understand 5 ft anchors are required at all centerline tie points where the torque test reading is 275 or less and where the mobile home manufacturer may require anchors with 4000 lb holding capacity.

JT Installer's initials

### ALL TESTS MUST BE PERFORMED BY A LICENSED INSTALLER

Installer Name Jacob Tronell  
Date Tested 3-2-26

## Electrical

Connect electrical conductors between multi-wide units, but not to the main power source. This includes the bonding wire between multi-wide units. Pg. 34

## Plumbing

Connect all sewer drains to an existing sewer tap or septic tank. Pg. 36

Connect all potable water supply piping to an existing water meter, water tap, or other independent water supply systems. Pg. 36

## Site Preparation

Debris and organic material removed \_\_\_\_\_  
Water drainage: Natural \_\_\_\_\_ Swale \_\_\_\_\_ Pad  Other \_\_\_\_\_

## Fastening multi wide units

Floor: Type Fastener: Lag Length: 6" Spacing: 18"  
Walls: Type Fastener: Screw Length: 4" Spacing: 18"  
Roof: Type Fastener: Strap Length: 10" Spacing: 32"  
For used homes a min. 30 gauge, 8" wide, galvanized metal strip will be centered over the peak of the roof and fastened with galv. roofing nails at 2" on center on both sides of the centerline.

## Gasket (weatherproofing requirement)

I understand a properly installed gasket is a requirement of all new and used homes and that condensation, mold, mildew and buckled marriage walls are a result of a poorly installed or no gasket being installed. I understand a strip of tape will not serve as a gasket.

Installer's initials \_\_\_\_\_

Type gasket Pg. 113

Installed:  
Between Floors Yes   
Between Walls Yes   
Bottom of ridgebeam Yes

## Weatherproofing

The bottomboard will be repaired and/or taped. Yes  Pg. 39  
Siding on units is installed to manufacturer's specifications. Yes   
Fireplace chimney installed so as not to allow intrusion of rain water. Yes

## Miscellaneous

Skirting to be installed. Yes  No \_\_\_\_\_  
Dryer vent installed outside of skirting. Yes  N/A \_\_\_\_\_  
Range downflow vent installed outside of skirting. Yes \_\_\_\_\_ N/A   
Drain lines supported at 4 foot intervals. Yes   
Electrical crossovers protected. Yes   
Other: \_\_\_\_\_

Installer verifies all information given with this permit worksheet is accurate and true based on the manufacturer's installation instructions and or Rule 15C-1 & 2

Installer Signature Jacob Tronell

Date 3-2-26

**MOBILE HOME INSTALLATION SUBCONTRACTOR VERIFICATION FORM**

APPLICATION NUMBER \_\_\_\_\_ CONTRACTOR \_\_\_\_\_ PHONE \_\_\_\_\_

**THIS FORM MUST BE SUBMITTED PRIOR TO THE ISSUANCE OF A PERMIT**

In Columbia County one permit will cover all trades doing work at the permitted site. It is REQUIRED that we have records of the subcontractors who actually did the trade specific work under the permit. Per Florida Statute 440 and Ordinance 89-6, a contractor shall require all subcontractors to provide evidence of workers' compensation or exemption, general liability insurance and a valid Certificate of Competency license in Columbia County.

*Any changes, the permitted contractor is responsible for the corrected form being submitted to this office prior to the start of that subcontractor beginning any work. Violations will result in stop work orders and/or fines.*

<b>ELECTRICAL</b>	Print Name <u>Owner</u> Signature _____ License #: _____ Phone #: _____ Qualifier Form Attached <input type="checkbox"/>
<b>MECHANICAL/ A/C _____</b>	Print Name <u>Owner</u> Signature _____ License #: _____ Phone #: _____ Qualifier Form Attached <input type="checkbox"/>



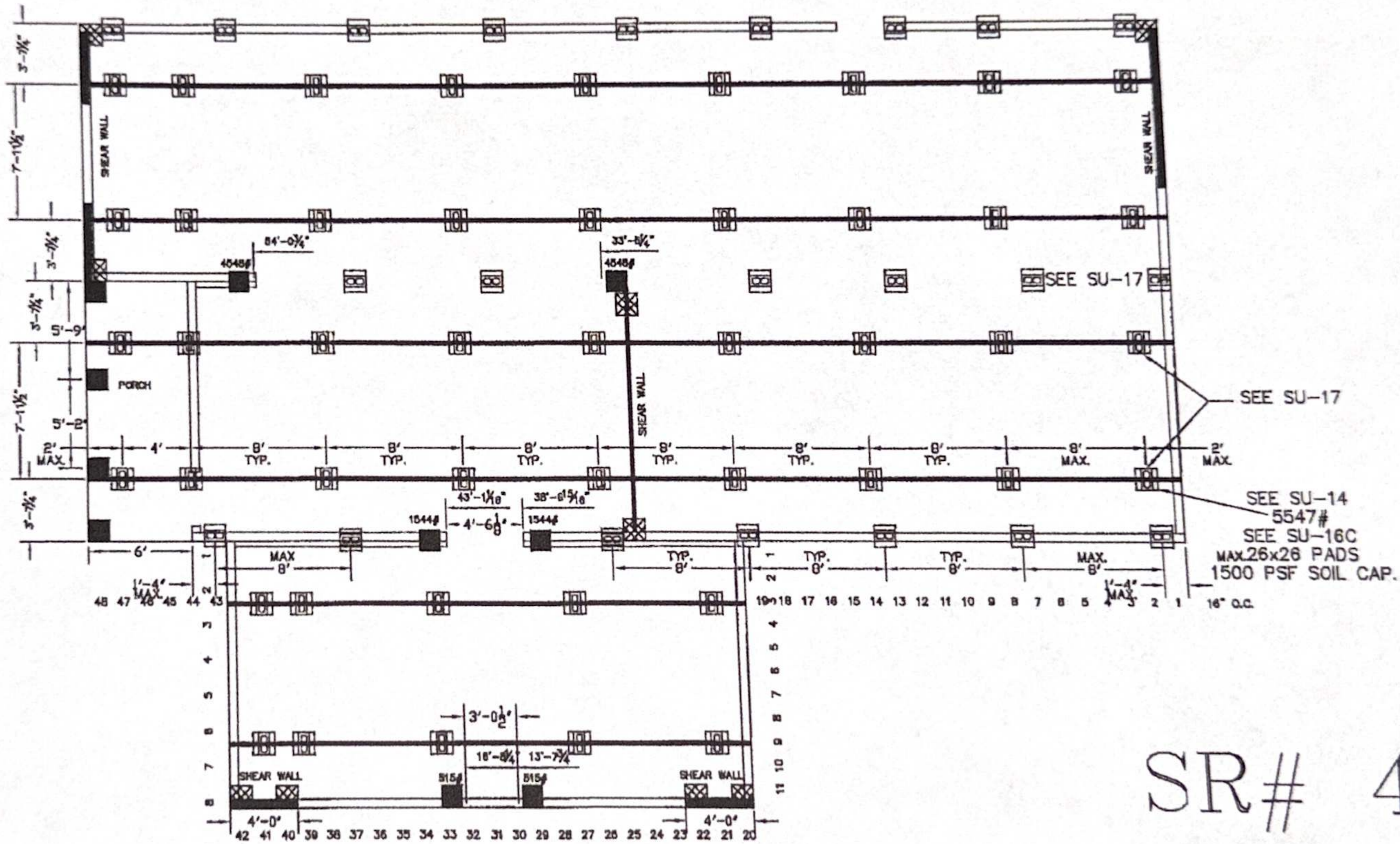

**F. S. 440.103 Building permits; identification of minimum premium policy.**--Every employer shall, as a condition to applying for and receiving a building permit, show proof and certify to the permit issuer that it has secured compensation for its employees under this chapter as provided in ss. 440.10 and 440.38, and shall be presented each time the employer applies for a building permit.

32 31 30 29 28 27 26 25 24 23 22 21 20 19 18 17 16 15 14 13 12 11 10 9 8 7 6 5 4 3 2 1 24" O.C.



SR# 4658

**BLOCKING LEGEND:**

-  I-BEAM BLOCKING  
SEE SOIL BEARING CAPACITY CHARTS FOR SPACING
-  COLUMN BLOCKING  
SEE SOIL BEARING CAPACITY CHARTS FOR PAD SIZE
-  SHEARWALL BLOCKING
-  SIDEWALL BLOCKING/MARRIAGE WALL BLOCKING  
SEE SOIL BEARING CAPACITY CHARTS FOR SPACING

- 1) ALL EXTERIOR DOORS, BAY WINDOWS, RECESSED SIDEWALLS AND EXTERIOR WALL OPENINGS 48" OR GREATER. WILL REQUIRE BLOCKING ON EACH SIDE.
- 2) ALL BLOCKING PADS BASED ON 1500 PSF SOIL CAP.

REFERENCE THE FOLLOWING PAGES IN THE TOWNHOMES SET-UP-MANUAL: SU-5.1, SU-14, SU-15, SU-16C AND SU-17

		TownHomes P.O. BOX 1059 LAKE CITY, FLORIDA 32058
Date: 10-14-22	Revisions	Code: 32248A
Dr'n: HEB	2-8-24 hb	
Parent: NEW	8-10-24 hb	
Code: T (23)		
<b>2</b>	Model: 32248-637	Print: FLORIDA BLOCKING PLAN

License Number: IH / 1148380 / 1 Name: JACOB T. TROWELL

Order #: 6942	Label #: 127849	Manufacturer:	(Check Size of Home)
Homeowner: <i>Trowell</i>		Year Model:	Single _____
Address:		Length & Width:	Double _____
City/State/Zip:		Type Longitudinal System:	Triple _____
Phone #:		Type Lateral Arm System:	HUD Label #:
Date Installed:		New Home: _____ Used Home: _____	Soil Bearing / PSF:
Installed Wind Zone:		Data Plate Wind Zone:	Torque Probe / in-lbs:
Permit #:			
Note:			

STATE OF FLORIDA  
INSTALLATION CERTIFICATION LABEL

127849

LABEL #

DATE OF INSTALLATION

JACOB T. TROWELL

NAME

IH / 1148380 / 1

6942

LICENSE #

ORDER #

CERTIFIES THAT THE INSTALLATION OF THIS MOBILE HOME IS  
IN ACCORDANCE WITH FLORIDA STATUTES 320.8249, 320.8325  
AND RULES OF THE HIGHWAY SAFETY AND MOTOR VEHICLES.

INSTRUCTIONS

PLEASE WRITE DATE OF  
INSTALLATION AND AFFIX  
LABEL NEXT TO HUD LABEL.  
USE PERMANENT INK PEN  
OR MARKER ONLY.  
COMPLETE INFORMATION  
ABOVE AND KEEP ON FILE  
FOR A MINIMUM OF 2 YEARS.  
YOU ARE REQUIRED TO  
PROVIDE COPIES WHEN  
REQUESTED.