



STATE OF FLORIDA
DEPARTMENT OF ENVIRONMENTAL PROTECTION
ONSITE SEWAGE TREATMENT AND DISPOSAL
SYSTEM (OSTDS)

PERMIT NO. 26-0125
DATE PAID: 2/25/26
FEE PAID: 50.00
RECEIPT #: 2088118

APPLICATION FOR CONSTRUCTION PERMIT

APPLICATION FOR:

New System Existing System Holding Tank Innovative
 Repair Abandonment Temporary _____

APPLICANT: Deuces Wild Holdings LLC EMAIL: deuceswildholdings@gmail.com

AGENT: Lodisca Beichner, Owner TELEPHONE: 386-222-1323

MAILING ADDRESS: PO Box 3814, Lake City, FL 32056

TO BE COMPLETED BY APPLICANT OR APPLICANT'S AUTHORIZED AGENT. SYSTEMS MUST BE CONSTRUCTED BY A PERSON LICENSED PURSUANT TO 489.105(3)(m) OR 489.552, FLORIDA STATUTES. IT IS THE APPLICANT'S RESPONSIBILITY TO PROVIDE DOCUMENTATION OF THE DATE THE LOT WAS CREATED OR PLATTED (MM/DD/YY) IF REQUESTING CONSIDERATION OF STATUTORY GRANDFATHER PROVISIONS.

PROPERTY INFORMATION

OSTDS REMEDIATION PLAN? Y / N

LOT: 8 BLOCK: F SUBDIVISION: Parnell Hills Unit 2 PLATTED: 5/18/1976

PROPERTY ID #: 10-3S-16-02058-041 ZONING: RSF/MH-1 I/M OR EQUIVALENT: Y / N

PROPERTY SIZE: 1.01 ACRES WATER SUPPLY: PRIVATE PUBLIC]<=2000GPD]>2000GPD

IS SEWER AVAILABLE AS PER 381.0065, FS? Y / N DISTANCE TO SEWER: 110 FT

PROPERTY ADDRESS: 445 NW Pillsbury Dr, Lake City, FL 32055

DIRECTIONS TO PROPERTY: From US 90 to NW Lake Jeffery Rd, continue NW for 5.0 miles and turn right on Moore Road, continue E for 325 feet and turn left on NW Pillsbury Drive, continue N for 0.3 miles, 445 will be on the right.

BUILDING INFORMATION

RESIDENTIAL COMMERCIAL

Unit No.	Type of Establishment	No. of Bedrooms	Building Area Sqft	Commercial/Institutional System Design Table I, Chapter 62-6, FAC
1	Old Mobile Home	3	1104	
2	New Mobile Home	3	936	
3				
4				

Floor/Equipment Drains Other (Specify) _____

SIGNATURE: Lodisca Beichner DATE: 1/30/2026

DEP 4015, 06-21-2022 (Obsoletes previous editions which may not be used)

Incorporated 62-6.004, FAC

STATE OF FLORIDA
 DEPARTMENT OF ENVIRONMENTAL PROTECTION
 APPLICATION FOR CONSTRUCTION PERMIT

Permit Application Number 26-0125

----- PART II - SITEPLAN -----

Scale: Each block represents 10 feet and 1 inch = 40 feet.

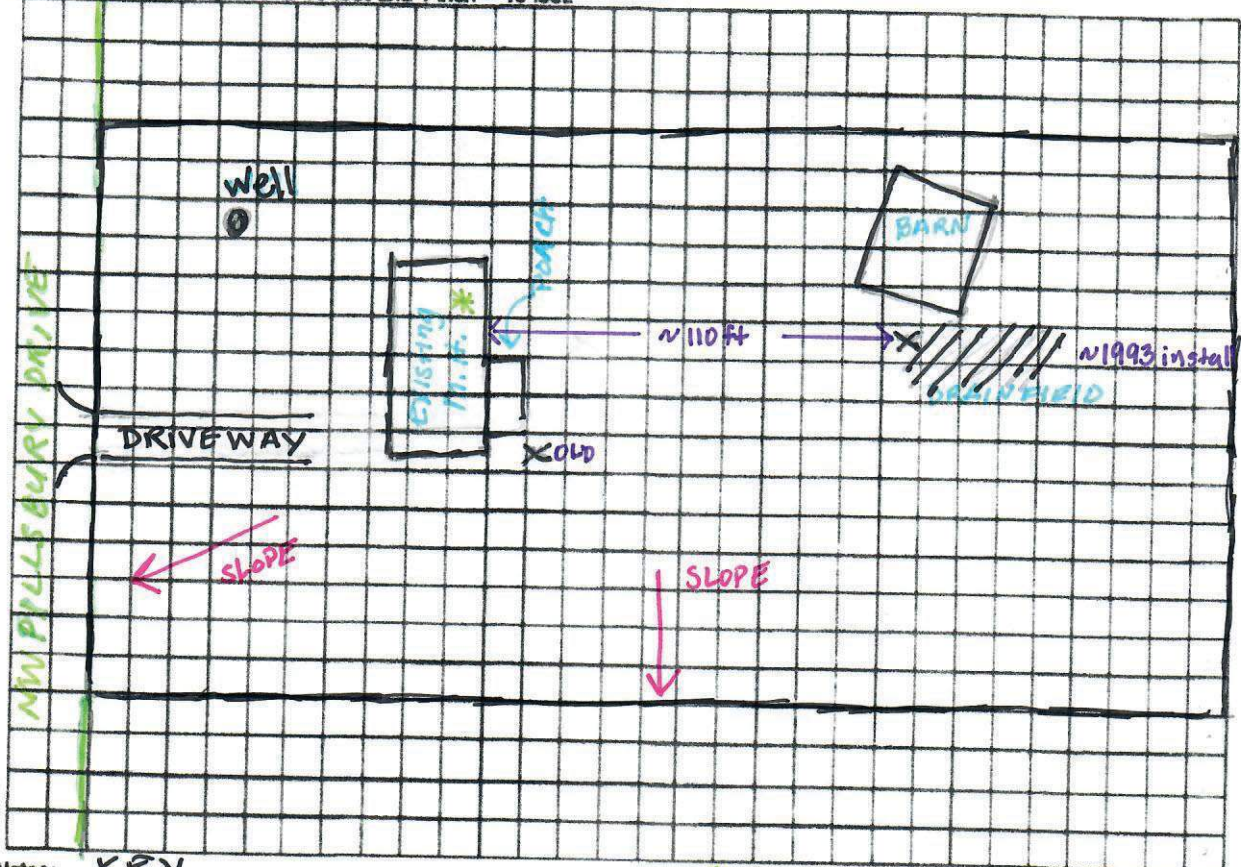

- Notes: **KEY**
- Well
 - X = Existing septic systems
 - /// = Drainfield ~1993
 - * New house to use the same footprint as existing house

Site Plan submitted by: Jodan Berchner 1/30/2026

Plan Approved Not Approved Date 2/5/26
 By [Signature] Columbia County Health Department

ALL CHANGES MUST BE APPROVED BY THE COUNTY HEALTH DEPARTMENT

DEP 4015, 06-21-2022 (Obsoletes previous editions which may not be used)
 Incorporated: 62-6.004, F.A.C.