

Mobile Home Permit Worksheet DW

Application Number: #65398 Date: 5/16/2024

Installer: DAVID AIBRIGHT License # 1H-1129420

Address of home being installed 251 NW Sugarcane Place Lake City FL 32055

Manufacturer Live Oak Length x width 45x76/80

NOTE: if home is a single wide fill out one half of the blocking plan if home is a triple or quad wide sketch in remainder of home I understand Lateral Arm Systems cannot be used on any home (new or used) where the sidewall ties exceed 5 ft 4 in.

Installer's initials DA

New Home Used Home
 Home installed to the Manufacturer's Installation Manual Home is installed in accordance with Rule 15-C
 Single wide Wind Zone II Wind Zone III
 Double wide Installation Decal # _____
 Triple/Quad Serial # LOHGA10023713ABC

PIER SPACING TABLE FOR USED HOMES

Load bearing capacity	Footer size (sq in)	16" x 16" (256)	18 1/2" x 18 1/2" (342)	20" x 20" (400)	22" x 22" (484)*	24" x 24" (576)*	26" x 26" (676)
1000 psf	3'	4'	5'	6'	7'	8'	
1500 psf	4' 6"	6'	7'	8'	8'	8'	
2000 psf	6'	8'	8'	8'	8'	8'	
2500 psf	7' 6"	8'	8'	8'	8'	8'	
3000 psf	8'	8'	8'	8'	8'	8'	
3500 psf	8'	8'	8'	8'	8'	8'	

* interpolated from Rule 15C-1 pier spacing table.

PIER PAD SIZES

I-beam pier pad size 17x25
 Perimeter pier pad size 16x16
 Other pier pad sizes (required by the mfg.) 24x24

POPULAR PAD SIZES

Pad Size	Sq In
16 x 16	256
16 x 18	288
18.5 x 18.5	342
16 x 22.5	360
17 x 22	374
13 1/4 x 26 1/4	348
20 x 20	400
17 3/16 x 25 3/16	441
17 1/2 x 25 1/2	446
24 x 24	576
26 x 26	676

Draw the approximate locations of marriage wall openings 4 foot or greater. Use this symbol to show the piers.

List all marriage wall openings greater than 4 foot and their pier pad sizes below.

Opening	Pier pad size
<u>FACTORY</u>	<u>DIAGRAM</u>
_____	_____
_____	_____

ANCHORS

4 ft _____ 5 ft _____

FRAME TIES

within 2' of end of home spaced at 5' 4" oc

TIEDOWN COMPONENTS

Longitudinal Stabilizing Device (LSD) Manufacturer OLIVER TECHNOLOGIES
 Longitudinal Stabilizing Device w/ Lateral Arms Manufacturer OLIVER TECHNOLOGIES

OTHER TIES

	Number
Sidewall	<u>38</u>
Longitudinal	<u>8</u>
Marriage wall	<u>19-5' 10-4'</u>
Shearwall	<u>13</u>

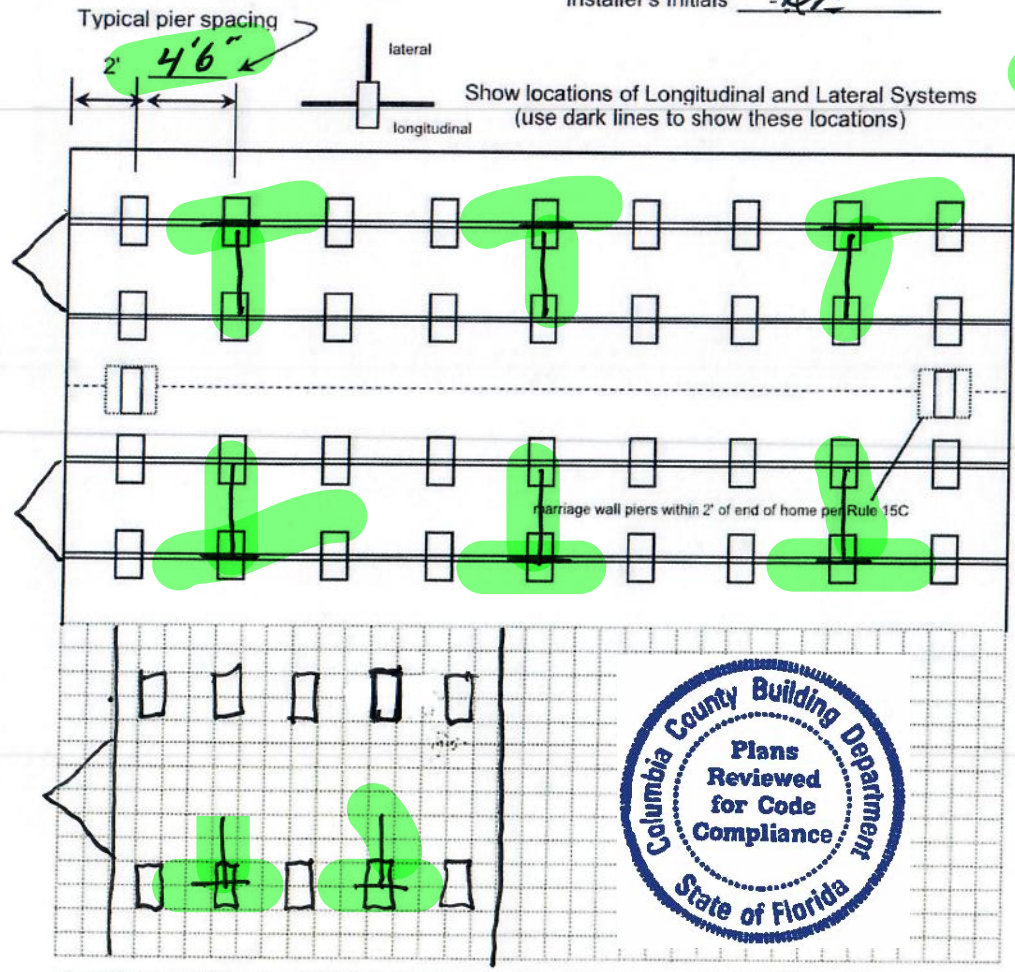

Mobile Home Permit Worksheet

Application Number: _____ Date: _____

POCKET PENETROMETER TEST

The pocket penetrometer tests are rounded down to _____ psf or check here to declare 1000 lb. soil without testing.

X _____ X _____ X _____

POCKET PENETROMETER TESTING METHOD

1. Test the perimeter of the home at 6 locations.
2. Take the reading at the depth of the footer.
3. Using 500 lb. increments, take the lowest reading and round down to that increment.

X _____ X _____ X _____

TORQUE PROBE TEST

The results of the torque probe test is 250 inch pounds or check here if you are declaring 5' anchors without testing _____. A test showing 275 inch pounds or less will require 5 foot anchors.

Note: A state approved lateral arm system is being used and 4 ft. anchors are allowed at the sidewall locations. I understand 5 ft anchors are required at all centerline tie points where the torque test reading is 275 or less and where the mobile home manufacturer may require anchors with 4000 lb. holding capacity.

DAV Installer's initials

ALL TESTS MUST BE PERFORMED BY A LICENSED INSTALLER

Installer Name DAVID AIBRIGHT MOBILE HOME SVC

Date Tested _____

Electrical

Connect electrical conductors between multi-wide units, but not to the main power source. This includes the bonding wire between multi-wide units. Pg. 64-68

Plumbing

Connect all sewer drains to an existing sewer tap or septic tank. Pg. 70

Connect all potable water supply piping to an existing water meter, water tap, or other independent water supply systems. Pg. 107



Site Preparation

Debris and organic material removed
Water drainage: Natural Swale Pad Other _____

Fastening multi wide units

Floor: Type Fastener: LAG Length: 6" Spacing: 2'
Walls: Type Fastener: SCREW Length: 4" Spacing: 18"
Roof: Type Fastener: LAG Length: 6" Spacing: 2'
For used homes a min. 30 gauge, 8" wide, galvanized metal strip will be centered over the peak of the roof and fastened with galv. roofing nails at 2" on center on both sides of the centerline.

Gasket (weatherproofing requirement)

I understand a properly installed gasket is a requirement of all new and used homes and that condensation, mold, mildew and buckled marriage walls are a result of a poorly installed or no gasket being installed. I understand a strip of tape will not serve as a gasket.

Installer's initials _____

Type gasket Pg. 36

Installed:
Between Floors Yes
Between Walls Yes END WALLS
Bottom of ridgebeam Yes

Weatherproofing

The bottomboard will be repaired and/or taped. Yes Pg. 119
Siding on units is installed to manufacturer's specifications. Yes
Fireplace chimney installed so as not to allow intrusion of rain water. Yes

Miscellaneous

Skirting to be installed. Yes _____ No
Dryer vent installed outside of skirting. Yes _____ N/A
Range downflow vent installed outside of skirting. Yes _____ N/A
Drain lines supported at 4 foot intervals. Yes
Electrical crossovers protected. Yes
Other : _____

Installer verifies all information given with this permit worksheet is accurate and true based on the manufacturer's installation instructions and or Rule 15C-1 & 2

Installer Signature David Aibright Date _____

License Number: IH / 1129420 / 1 Name: DAVID E ALBRIGHT

Order #: 6223	Label #: 110727	Manufacturer: LIVE OAK	(Check Size of Home)
Homeowner: HILL		Year Model: 2024	Single _____
Address: 251 NW SUGARCANE FL.		Length & Width: 76/80 X 45	Double <input checked="" type="checkbox"/>
City/State/Zip: LAKE CITY FL. 32055		Type Longitudinal System: OTI ()	Triple X
Phone #:		Type Lateral Arm System: OTI ()	HUD Label #:
Date Installed:		New Home: <input checked="" type="checkbox"/> Used Home: _____	Soil Bearing / PSF:
Installed Wind Zone: #		Data Plate Wind Zone: #	Torque Probe / in-lbs:
Note:			Permit #:



**STATE OF FLORIDA
INSTALLATION CERTIFICATION LABEL**
110727

LABEL #	DATE OF INSTALLATION
DAVID E ALBRIGHT	
NAME	
IH / 1129420 / 1	6223
LICENSE #	ORDER #

CERTIFIES THAT THE INSTALLATION OF THIS MOBILE HOME IS
IN ACCORDANCE WITH FLORIDA STATUTES 320.8249, 320.8325
AND RULES OF THE HIGHWAY SAFETY AND MOTOR VEHICLES.

INSTRUCTIONS

PLEASE WRITE DATE OF
INSTALLATION AND AFFIX
LABEL NEXT TO HUD LABEL.
USE PERMANENT INK PEN
OR MARKER ONLY.
COMPLETE INFORMATION
ABOVE AND KEEP ON FILE
FOR A MINIMUM OF 2 YEARS.
YOU ARE REQUIRED TO
PROVIDE COPIES WHEN
REQUESTED.

ARLINGTON

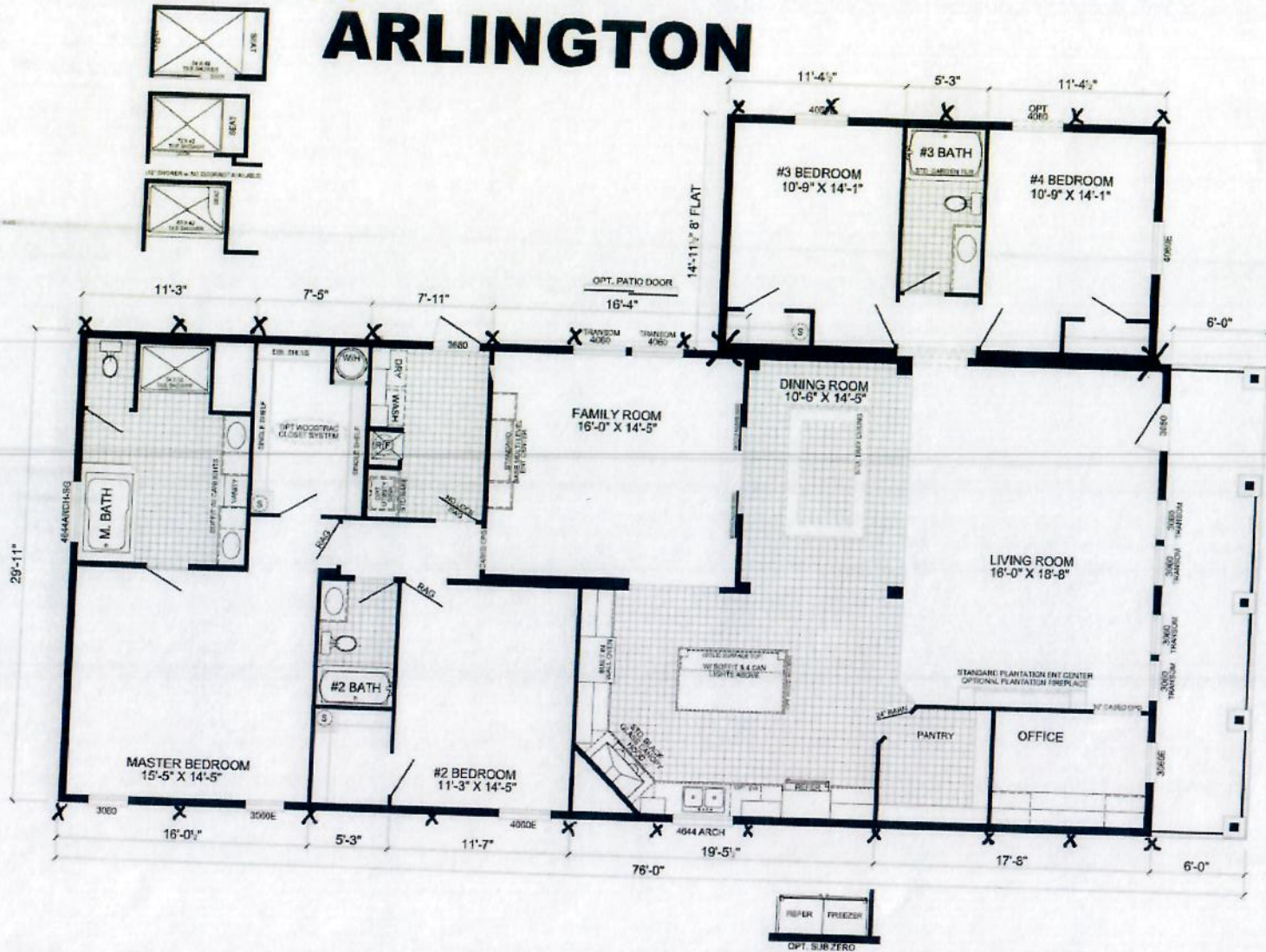

23-16x16

P-7764A

4-BEDROOM / 3-BATH

45 X 76 w/ Tag - Approx. 2,514 Sq. Ft.

45 X 76 w/ Tag - Approx. 2,692 Sq. Ft. w/ porch

Date: 05/12/22

* All room dimensions include closets and square footage figures are approximate.

* Transom windows are available on optional 9'-0" sidewall houses only.

* Standard Board and Batten Hardi @ Tower Dormer Location.

* Standard Hardi Base Columns w/ Hardi Columns on Top.

* Live Oak Homes reserves the right to modify product offering at any time.



FRONT ELEVATION