

# COLUMBIA COUNTY Property Appraiser

## Parcel 19-4S-17-08540-010

### Owners

MORRISON ROY L  
MORRISON LINDA L  
137 SW TULIP PL  
LAKE CITY, FL 32025

### Parcel Summary

Location	137 SW TULIP PL
Use Code	0100: SINGLE FAMILY
Tax District	2: COUNTY
Acreage	0.302
Township	4S
Range	17
Subdivision	AZALEA PK
Exemptions	01: HOMESTEAD (196.031a&b) (100%)

### Legal Description

LOT 10 BLOCK A AZALEA PARK S/D UNREC.  
COMM NW COR OF SW1/4 OF NE1/4, RUN E 682.68 FT  
FOR POB, CONT E 105 FT, S 125 FT, W 105 FT,  
N 125 FT TO POB.

### Working Values

	2026
Total Building	\$145,475
Total Extra Features	\$3,000
Total Market Land	\$18,500
Total Ag Land	\$0



	2026
Total Market	\$166,975
Total Assessed	\$82,563
Total Exempt	\$82,563
Total Taxable	\$0
SOH Diff	\$84,412

## Value History

	2025	2024	2023	2022	2021	2020
Total Building	\$145,475	\$136,376	\$124,688	\$107,808	\$90,197	\$82,464
Total Extra Features	\$3,000	\$3,000	\$3,000	\$3,000	\$3,000	\$3,000
Total Market Land	\$18,500	\$18,500	\$18,500	\$15,000	\$12,700	\$12,664
Total Ag Land	\$0	\$0	\$0	\$0	\$0	\$0
Total Market	\$166,975	\$157,876	\$146,188	\$125,808	\$105,897	\$98,128
Total Assessed	\$80,392	\$78,126	\$75,850	\$73,641	\$71,496	\$70,509
Total Exempt	\$80,392	\$78,126	\$75,850	\$73,641	\$71,496	\$70,509
Total Taxable	\$0	\$0	\$0	\$0	\$0	\$0
SOH Diff	\$86,583	\$79,750	\$70,338	\$52,167	\$34,401	\$27,619

## Document/Transfer/Sales History

None

## Buildings

### Building # 1, Section # 1, 82464, SFR

Type	Style	Heated Sq Ft	Repl Cost New	YrBlt	Year Eff	Gross Area	Other % Dpr	Normal % Dpr	% Cond	Value
<u>0100</u>	<u>01</u>	1066	\$223,807	1977	1977	2,228	0.00%	35.00%	65.00%	\$145,475

## Structural Elements

Type	Description	Code	Details
EW	Exterior Wall	19	COMMON BRK
EW	Exterior Wall	04	SINGLE SID
RS	Roof Structure	03	GABLE/HIP
RC	Roof Cover	14	PREFIN MT
IW	Interior Wall	05	DRYWALL
IF	Interior Flooring	14	CARPET
IF	Interior Flooring	06	VINYL ASB

## Sub Areas

Type	Gross Area	Percent of Base	Adjusted Area
<u>BAS</u>	1,066	100%	1,066
<u>FCP</u>	190	25%	48
<u>FCP</u>	209	25%	52
<u>FEP</u>	120	80%	96
<u>FEP</u>	168	80%	134
<u>FOP</u>	96	30%	29
<u>FST</u>	77	55%	42

Type	Description	Code	Details
AC	Air Conditioning	03	CENTRAL
HT	Heating Type	04	AIR DUCTED
BDR	Bedrooms	3.00	
BTH	Bathrooms	2.00	
FR	Frame	01	NONE
STR	Stories	1.	1.
AR	Architectural Type	05	CONV
COND	Condition Adjustment	03	03
KTCH	Kitchen Adjustment	01	01

Type	Gross Area	Percent of Base	Adjusted Area
<u>UDU</u>	170	55%	94
<u>USP</u>	132	35%	46

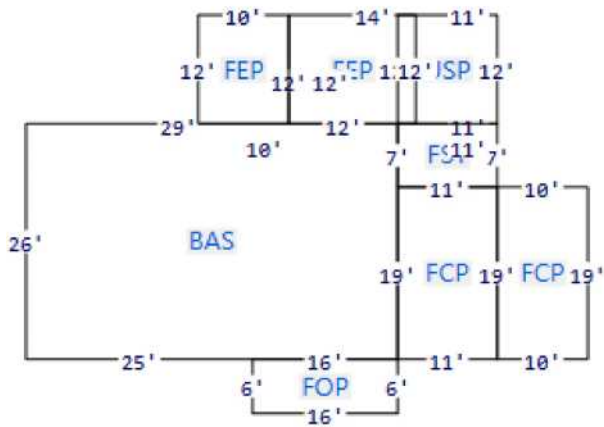

## Extra Features

Code	Description	Length	Width	Units	Unit Price	<u>AYB</u>	% Good Condition	Final Value
0166	CONC,PAVMT			1.00	\$0.00	0	100%	\$600
0294	SHED WOOD/VINYL	12	20	240.00	\$7.50	1993	100%	\$1,800
0296	SHED METAL			1.00	\$0.00	2017	100%	\$100
0166	CONC,PAVMT			1.00	\$0.00	2017	100%	\$500

## Land Lines

Code	Description	Zone	Front	Depth	Units	Rate/Unit	Acreage	Total Adj	Value
0100	SFR	00	.00	.00	1.00	\$18,500.00/ <u>LT</u>	0.30	1.00	\$18,500

## Personal Property

None

## Permits

None

## TRIM Notices

2025

2024

2023

## Disclaimer

All parcel data on this page is for use by the Columbia County Assessor for assessment purposes only. The summary data on this page may not be a complete representation of the parcel or of the improvements thereon. Building information, including unit counts and number of permitted units, should be verified with the appropriate building and planning agencies. Zoning information should be verified with the appropriate planning agency. All parcels are reappraised each year. This is a true and accurate copy of the records of the Columbia County Assessor's Office as of June 03, 2026.