

FLOOR PLAN  
SCALE: 1/4" = 1'

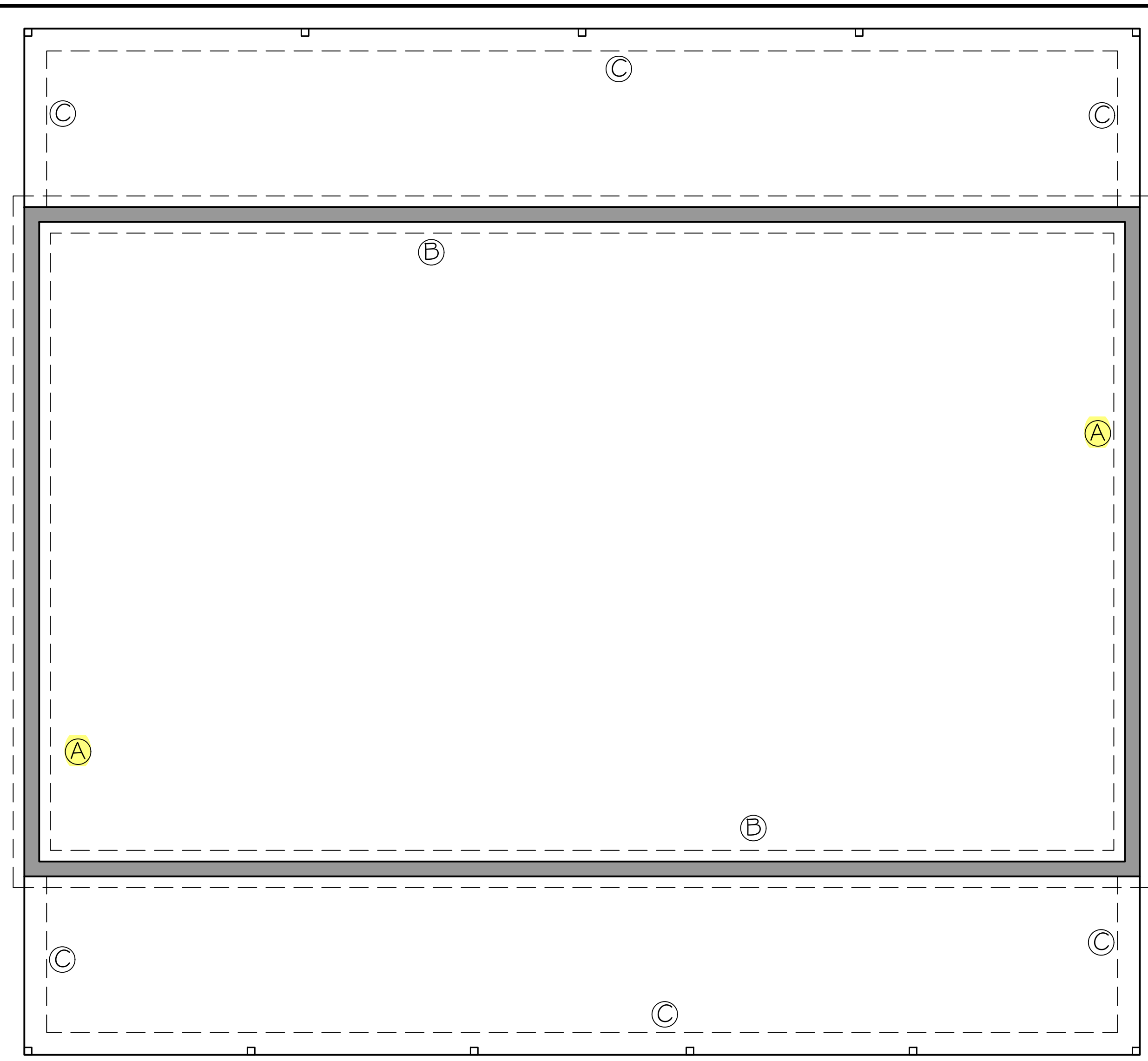

FOUNDATION PLAN  
SCALE: 1/4" = 1'

DESIGN SPECIFICATIONS

- DESIGN CODES:
  - 2020 FLORIDA BUILDING CODE (FBC) - RESIDENTIAL ASCE 7-10, 2005
  - NDS, ACI, ATIC, AWP, APA, ICC 600-08
- OCCUPANCY: RESIDENTIAL GROUP R-3 (ONE- AND TWO-FAMILY DWELLINGS)
- DESIGN LOADS:
  - ROOF CONVENTIONAL FRAMING:
    - LL 20 PSF RAFTERS
    - LL 20 PSF CEILING JOISTS
    - DL 10 PSF RAFTERS
    - DL 10 PSF CEILING JOISTS
    - DL 30 PSF ATTICS WITH STORAGE
    - DL 10 PSF ATTICS W/O STORAGE
  - FLOORS:
    - LL 40 PSF TOP CHORD
    - LL 0 PSF BOTTOM CHORD
    - DL 10 PSF TOP CHORD
    - DL 5 PSF BOTTOM CHORD
- NUMBER OF STORIES: 1
- TYPE OF CONSTRUCTION: TYPE V-G, UNPROTECTED, UNSPRINKLERED
- WIND ZONE INFORMATION
- BUILDING: ENCLOSED STRUCTURE
- ULTIMATE DESIGN WIND SPEED: 130 MPH
- NOMINAL DESIGN WIND SPEED: 110 MPH
- BUILDING RISK CATEGORY: II
- WIND EXPOSURE CATEGORY: C
- INTERNAL PRESSURE COEFFICIENT: 0.18 CG<sub>p1</sub> ±

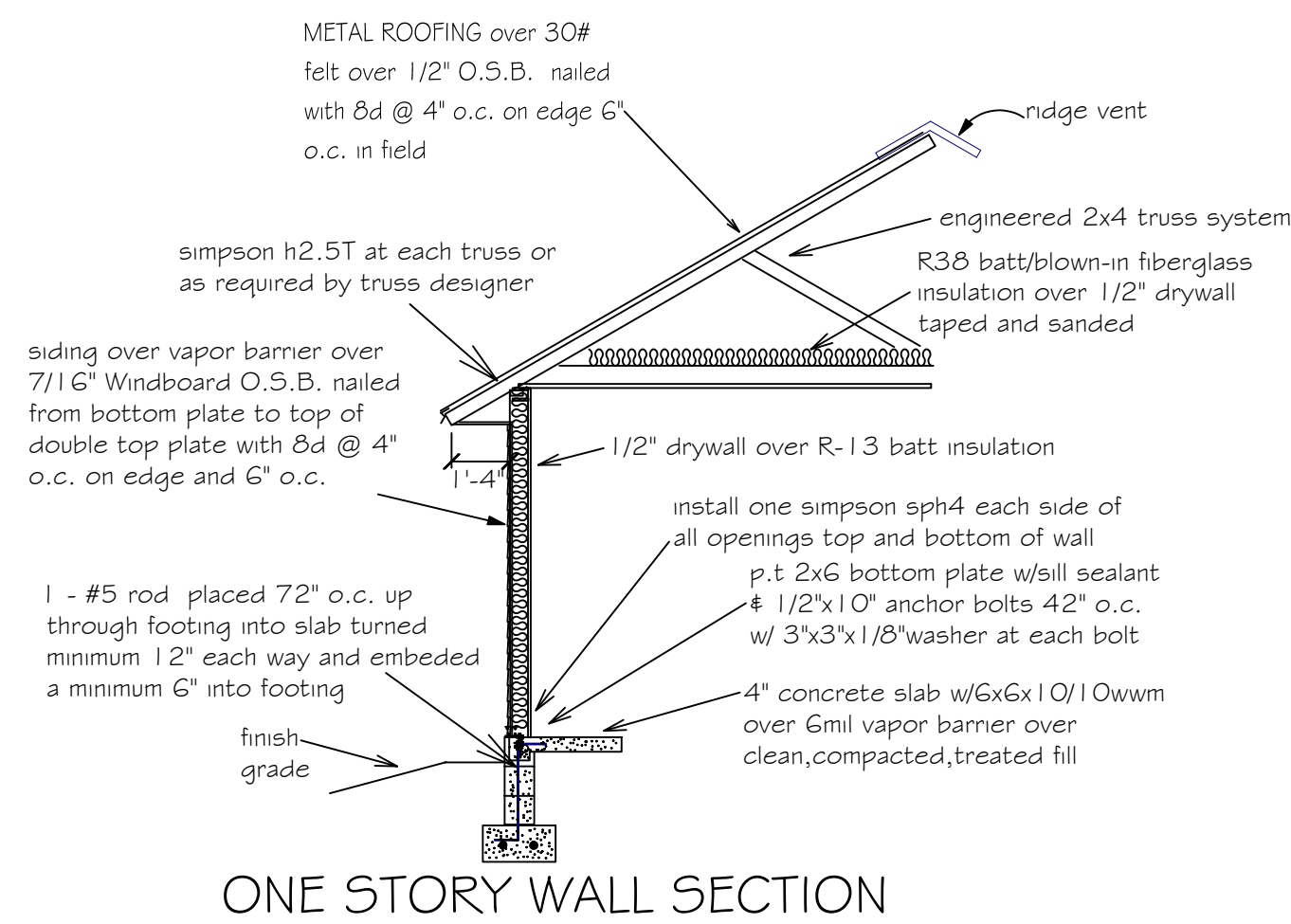

ONE STORY WALL SECTION

FOUNDATION NOTES

- REFER TO ARCHITECTURAL PLANS FOR ACTUAL DIMENSIONS, RECESSES IN SLAB, STEP DOWNS, ETC. CONTRACTOR SHALL VERIFY ALL ROUGH PLUMBING LOCATIONS WITH ARCHITECTURAL PLANS PRIOR TO POURING SLAB.
- THE SLAB SHALL BE 4" CONCRETE SLAB REINFORCED W/ 6X6-1/4" WELDED WIRE MESH PLACED ON CHAIRS 1 1/2" DEPTH OR FIBER MESH CONCRETE, 6-MIL POLY VAPOR BARRIER W/ 6" LAPS SEALED W/ POLY TAPE OVER TERMITE-TREATED & COMPACTED FILL. BOTTOM OF EXTERIOR FOOTINGS SHALL BE A MINIMUM OF 12" BELOW UNDISTURBED SOIL OR ENGINEERED FILL PER FBC-RES. SECTION R403.1.4

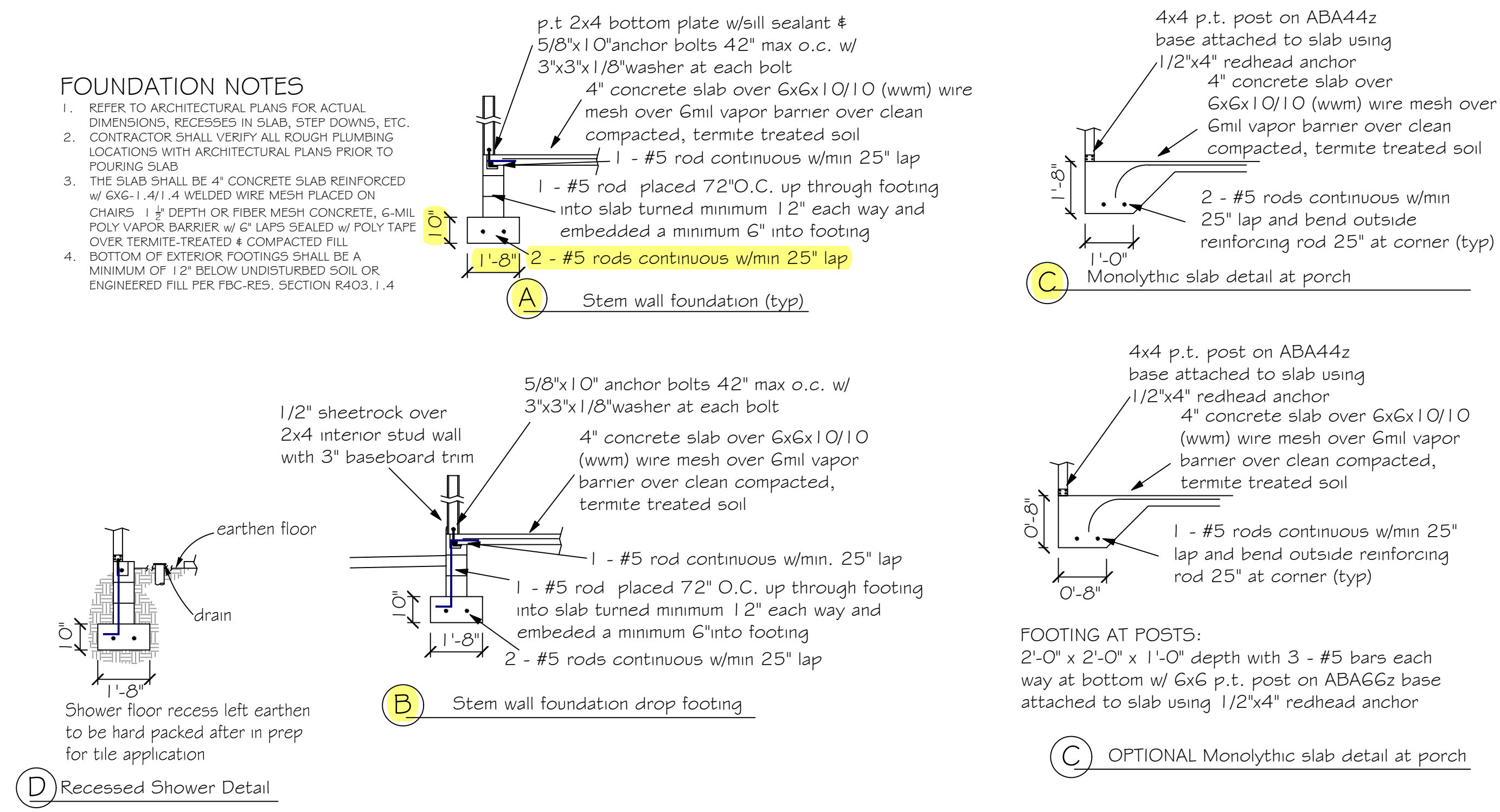

Digitally signed by Carol Chadwick  
DN: cn=Carol Chadwick, o=Florida, dnQualifier=A014, 1800000176860, email=carol@carolchadwick.com, c=US  
Date: 2022.02.15 09:08:32 -0500

WINDHAM RESIDENCE  
FLOOR PLAN  
FOUNDATION PLAN

DATE: 02/15/2022  
SCALE: 1/4" = 1'



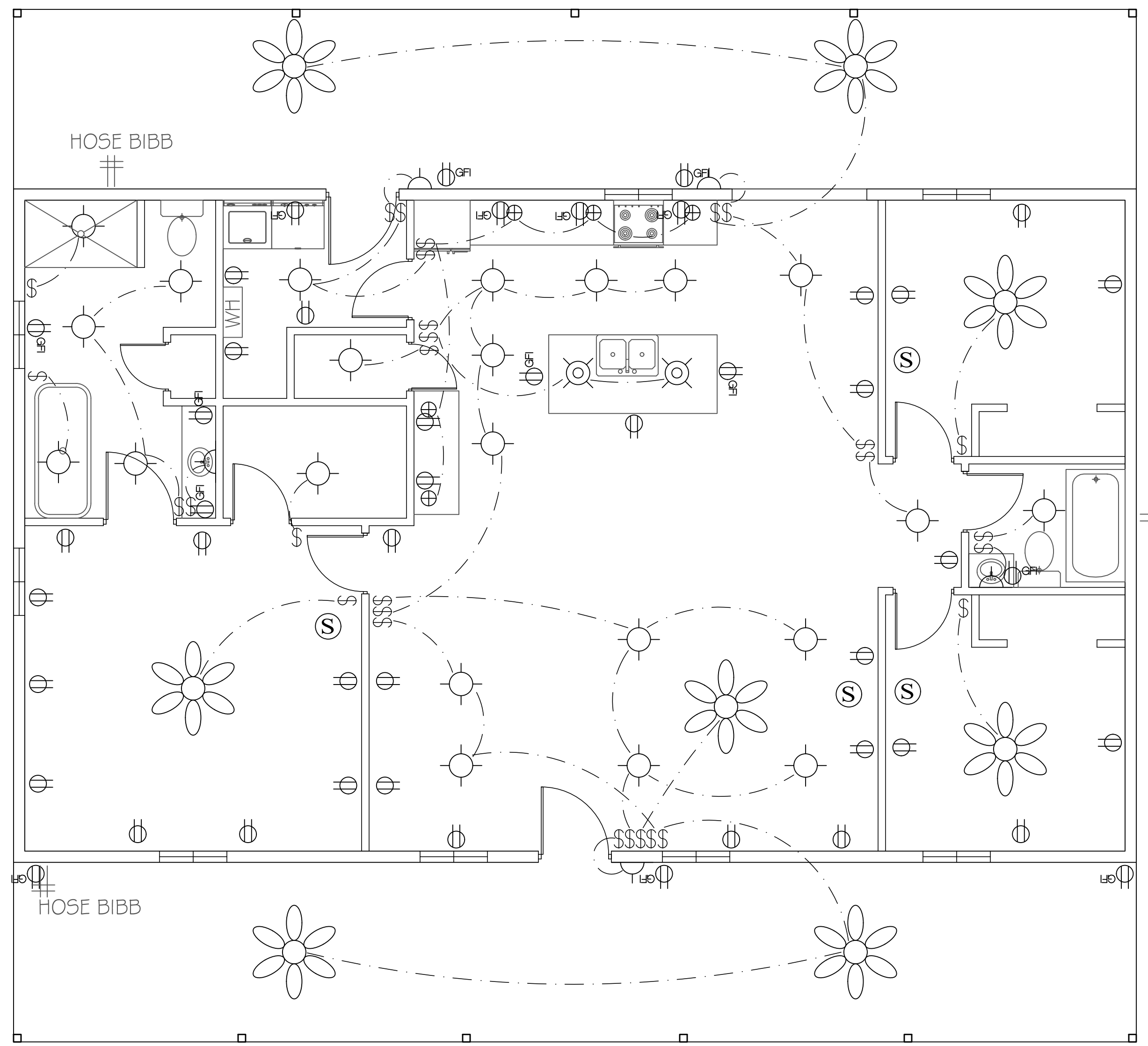

ELECTRIC PLAN  
SCALE: 1/4" = 1'

LEGEND

- ⊕ DUPLEX WALL RECEPTACLE
- ⊕GFI GFI DUPLEX WALL RECEPTACLE
- \$ SPST WALL SWITCH
- △ LIGHT
- PENDENT LIGHT
- ⊕ UNDER-CABINET LIGHT
- Ⓢ 120V SMOKE DETECTOR
- ☼ CEILING FAN

ALL ELECTRICAL TO BE INSTALLED CURRENT NEC CODE.

1. PROVIDE INTERIOR SWITCH AND EXTERIOR LIGHT IN THE VICINITY OF DOORS.
2. PROVIDE RECEPTACLE OUTLET 6' FROM OPENINGS, ENDS OF WALL, AND 6' ON CENTER
3. PROVIDE AN OUTSIDE GFI, WATER PROTECTED RECEPTACLE OUTLET NEAR EGRESS DOORS AT AIR CONDENSER UNIT, AND NEAR GARAGE DOOR OPENING.
4. BATHROOM OUTLETS TO BE GFCI WITH A SEPARATE 20 AMPERE CIRCUIT.
5. PROVIDE SMOKE DETECTOR AS BY BLDG CODE, IN THE BEDROOMS AND HALLWAYS WITHIN 10' SERVING SUCH ROOMS.
6. ALL BRANCH CIRCUITS THAT SUPPLY 125-VOLT, SINGLE PHASE 15 AND 20 AMPERE OUTLETS INSTALLED IN DWELLING UNIT SHALL BE PROTECTED BY AN ARC-FAULT CIRCUIT INTERRUPTER LISTED TO PROVIDE PROTECTION OF THE ENTIRE BRANCH CIRCUIT.
7. LIGHT FIXTURE IN CLOTHES CLOSET SHALL BE SURFACE-MOUNTED INCANDESCENT FIXTURE WITH COMPLETELY ENCLOSED LAMP ON THE WALL ABOVE DOOR OR ON CEILING WITH MIN 12" CLEAR TO STORAGE AREA.
8. FLUORESCENT GENERAL LIGHTING IS REQUIRED IN BATHROOM AND KITCHEN A 40 LUMENS PER WATT EFFICIENCY LAMP IS REQUIRED
9. LIGHT FIXTURES IN TUB OR SHOWER ENCLOSURES MUST HAVE LABEL STATING "SUITABLE FOR DAMP LOCATIONS"
10. RECESSED CEILING FIXTURES MUST BE IC RATED
11. ALL RECEPTABLES AT KITCHEN COUNTER SHALL BE GFCI. PROVIDE TWO MINIMUM SEPARATE 20-AMP CIRCUITS TO KITCHEN APPLIANCES
12. EACH SEPARATE KITCHEN COUNTER SPACE 12" OR WIDER SHALL HAVE A RECEPTACLE OUTLET
13. KITCHEN RECEPTACLE OUTLET SHALL BE INSTALLED SO THAT NO POINT ALONG THE WALL IS MORE THAN 24" FROM A RECEPTACLE OUTLET
14. ISLAND AND PENINSULA COUNTER TOPS 12" OR WIDER SHALL HAVE AT LEAST ONE RECEPTACLE OUTLET FOR EACH 4' OF COUNTER TOP.
15. NOT LESS THAN 75% OF THE LAMPS IN PERMANENTLY INSTALLED LIGHTING FIXTURES SHALL BE HIGH-EFFICACY LAMPS OR NOT LESS THAN 75% OF THE PERMANENTLY INSTALLED LIGHTING FIXTURES SHALL CONTAIN ONLY HIGH-EFFICACY LAMPS.
16. ALL CIRCUITS IN GARAGE AREA TO BE GFI RATED 125 VOLT SINGLE PHASE 20 AMPERE

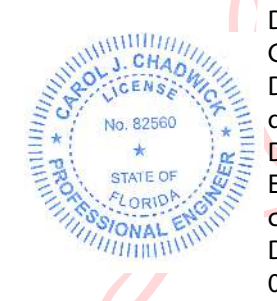

Digitally signed by Carol Chadwick  
DN: c=US, o=Florida, dnQualifier=A01410  
D0000017E86D924C  
E0005954C,  
cn=Carol Chadwick  
Date: 2022.02.15 09:09:10 -05'00'

WINDHAM RESIDENCE  
ELECTRIC PLAN

DATE: 02/15/2022

SCALE: 1/4" = 1'

5-3