

COLUMBIA COUNTY Property Appraiser

Parcel 19-4S-17-08572-006

Owners

ADAMS JOHNNY
ADAMS WENDY
283 SW VENTURA LN
LAKE CITY, FL 32024

Parcel Summary

Location	283 SW VENTURA LN
Use Code	0100: SINGLE FAMILY
Tax District	2: COUNTY
Acreage	1.960
Township	4S
Range	17
Subdivision	PINE KNOLL
Exemptions	01: HOMESTEAD (196.031a&b) (100%)

Legal Description

LOTS 14 & 15 BLOCK 1 PINE KNOLL S/D.

ORB 694-454, WD 1443-2631

Working Values

	2026
Total Building	\$283,189
Total Extra Features	\$12,976
Total Market Land	\$37,000
Total Ag Land	\$0



30° 07' 51" N 82° 38' 55" W //

	2026
Total Market	\$333,165
Total Assessed	\$283,463
Total Exempt	\$101,411
Total Taxable	\$182,052
SOH Diff	\$49,702

Value History

	2025	2024	2023	2022	2021	2020
Total Building	\$283,189	\$265,481	\$242,728	\$209,858	\$171,176	\$156,549
Total Extra Features	\$12,976	\$12,976	\$12,976	\$12,976	\$12,976	\$12,976
Total Market Land	\$37,000	\$37,000	\$37,000	\$30,000	\$24,140	\$24,006
Total Ag Land	\$0	\$0	\$0	\$0	\$0	\$0
Total Market	\$333,165	\$315,457	\$292,704	\$252,834	\$208,292	\$193,531
Total Assessed	\$276,011	\$268,232	\$260,419	\$252,834	\$208,292	\$192,328
Total Exempt	\$100,722	\$100,000	\$50,000	\$50,000	\$0	\$0
Total Taxable	\$175,289	\$168,232	\$210,419	\$202,834	\$208,292	\$192,328
SOH Diff	\$57,154	\$47,225	\$32,285	\$0	\$0	\$1,203

Document/Transfer/Sales History

Instrument / Official Record	Date	Q/U	Reason	Type	V/I	Sale Price	Ownership
<u>WD</u> 1443/2631	2021-07-30	<u>Q</u>	<u>01</u>	WARRANTY DEED	Improved	\$280,000	Grantor: HUNTER GLENN J & LAURA K Grantee: ADAMS JOHNNY
<u>WD</u> 0574/0508	1985-09-01	<u>Q</u>		WARRANTY DEED	Improved	\$79,500	
<u>03</u> 0420/0078	1978-12-01	<u>Q</u>			Improved	\$37,000	

Buildings

Building # 1, Section # 1, 156549, SFR

Type	Style	Heated Sq Ft	Repl Cost New	YrBlt	Year Eff	Gross Area	Other % Dpr	Normal % Dpr	% Cond	Value
<u>0100</u>	<u>01</u>	2830	\$435,676	1978	1978	4,390	0.00%	35.00%	65.00%	\$283,189

Structural Elements

Sub Areas

Type	Description	Code	Details
EW	Exterior Wall	19	COMMON BRK
EW	Exterior Wall	05	AVERAGE
RS	Roof Structure	03	GABLE/HIP
RC	Roof Cover	03	COMP SHNGL
IW	Interior Wall	05	DRYWALL
IF	Interior Flooring	14	CARPET
IF	Interior Flooring	15	HARDTILE
AC	Air Conditioning	03	CENTRAL
HT	Heating Type	04	AIR DUCTED
BDR	Bedrooms	4.00	
BTH	Bathrooms	2.50	
FR	Frame	01	NONE
STR	Stories	1.	1.
AR	Architectual Type	05	CONV
COND	Condition Adjustment	03	03
KTCH	Kitchen Adjustment	01	01

Type	Gross Area	Percent of Base	Adjusted Area
<u>BAS</u>	192	100%	192
<u>BAS</u>	448	100%	448
<u>BAS</u>	2,190	100%	2,190
<u>FAT</u>	480	20%	96
<u>FGR</u>	550	55%	302
<u>FOP</u>	20	30%	6
<u>FOP</u>	50	30%	15
<u>FSP</u>	240	40%	96
<u>FST</u>	220	55%	121

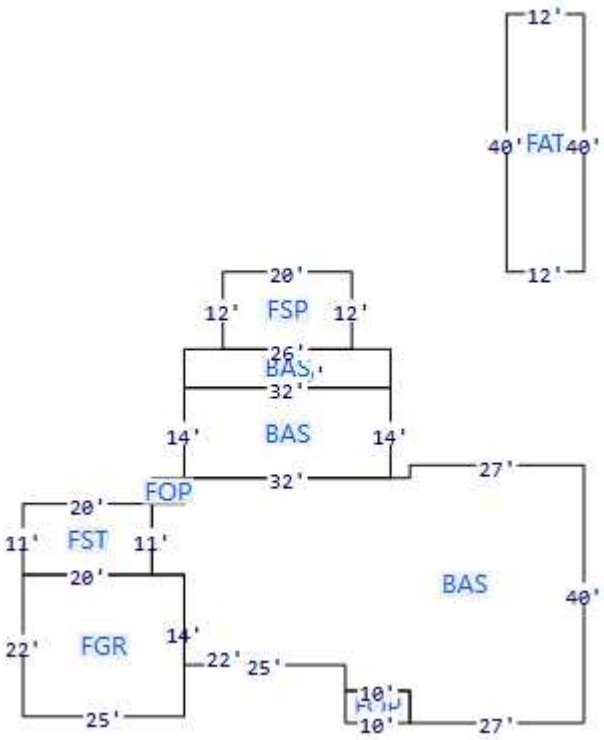

Extra Features

Code	Description	Length	Width	Units	Unit Price	<u>AYB</u>	% Good Condition	Final Value
0166	CONC,PAVMT			1.00	\$0.00	1993	100%	\$2,400
0190	FPLC PF			1.00	\$1,200.00	0	100%	\$1,200
0020	BARN,FR	24	40	960.00	\$5.00	2012	100%	\$4,800

Code	Description	Length	Width	Units	Unit Price	AYB	% Good Condition	Final Value
0261	PRCH, UOP	16	50	800.00	\$2.00	2012	100%	\$1,600
0251	LEAN TO W/FLOOR	16	50	800.00	\$2.00	2012	100%	\$1,600
0251	LEAN TO W/FLOOR	12	24	288.00	\$2.00	2012	100%	\$576
0258	PATIO			1.00	\$0.00	2017	100%	\$800

Land Lines

Code	Description	Zone	Front	Depth	Units	Rate/Unit	Acreage	Total Adj	Value
0100	SFR	<u>RSF-1</u>	.00	.00	1.00	\$18,500.00/ <u>LT</u>	0.98	1.00	\$18,500
0100	SFR	<u>RSF-1</u>	.00	.00	1.00	\$18,500.00/ <u>LT</u>	0.98	1.00	\$18,500

Personal Property

None

Permits

Date	Permit	Type	Status	Description
Oct 18, 2021	000042901	REROOF SFR	IMPORTED	Roof Replacement or Repair
Sep 14, 2021	000042720	REROOF SFR	IMPORTED	Roof Replacement or Repair
	10396	ADDN SFR	COMPLETED	ADDN SFR

TRIM Notices

2025
2024
2023

Disclaimer

All parcel data on this page is for use by the Columbia County Assessor for assessment purposes only. The summary data on this page may not be a complete representation of the parcel or of the improvements thereon. Building information, including unit counts and number of permitted units, should be verified with the appropriate building and planning agencies. Zoning information should be verified with the appropriate planning agency. All parcels are reappraised each year. This is a true and accurate copy of the records of the Columbia County Assessor's Office as of June 05, 2026.