



STATE OF FLORIDA
DEPARTMENT OF ENVIRONMENTAL PROTECTION
ONSITE SEWAGE TREATMENT AND DISPOSAL
SYSTEM (OSTDS)

FW

CR # 24-00712

PERMIT NO. 25-0759
DATE PAID: 9/20/25
FEE PAID: 318/25
RECEIPT #: 2258783

APPLICATION FOR CONSTRUCTION PERMIT

APPLICATION FOR:

New System Existing System Holding Tank Innovative
 Repair Abandonment Temporary

APPLICANT: CHRISTOPHER & JENNIFER MUSTONEN EMAIL: kdkpermitting@gmail.com

AGENT: KDK PERMITTING LLC TELEPHONE: (386) 688-2345

MAILING ADDRESS: 1154 NW NOEGEI RD. LAK CITY FL 32055

TO BE COMPLETED BY APPLICANT OR APPLICANT'S AUTHORIZED AGENT. SYSTEMS MUST BE CONSTRUCTED BY A PERSON LICENSED PURSUANT TO 489.105(3) (m) OR 489.552, FLORIDA STATUTES. IT IS THE APPLICANT'S RESPONSIBILITY TO PROVIDE DOCUMENTATION OF THE DATE THE LOT WAS CREATED OR PLATTED (MM/DD/YY) IF REQUESTING CONSIDERATION OF STATUTORY GRANDFATHER PROVISIONS.

PROPERTY INFORMATION

OSTDS REMEDIATION PLAN? Y / N

LOT: 1 BLOCK: N/A SUBDIVISION: PINE ACERS URSD PLATTED: _____

PROPERTY ID #: 31-5S-16-03744-301 ZONING: AG I/M OR EQUIVALENT: NO

PROPERTY SIZE: 15.000 ACRES WATER SUPPLY: PRIVATE PUBLIC ≤2000GPD >2000GPD

IS SEWER AVAILABLE AS PER 381.0065, FS? NO DISTANCE TO SEWER: N/A FT

PROPERTY ADDRESS: 848 SW FAULKNER DR. FT. WHITE

DIRECTIONS TO PROPERTY:

TAKE SR 47 SOUTH PAST I-75 . TURN RIGHT ON CR 240. TURN LEFT ON ITCHETUCKNEE AVE. TURN LEFT ON FAULKNER DR. AT CORNER ON RIGHT.

BUILDING INFORMATION RESIDENTIAL COMMERCIAL

Unit No.	Type of Establishment	No. of Bedrooms	Building Area Sqft	Commercial/Institutional System Design Table 1, Chapter 62-6, FAC
1	MOBILE HOME	3	1,173	
2				
3				
4				

RECEIVED

SEP 29 2025

Floor/Equipment Drains Other (Specify)

BY: EH

SIGNATURE: Christopher Mustonen

DATE: 9/23/25

Application for Onsite Sewage Disposal System Construction Permit. Part II Site Plan
 Permit Application Number: 25-0759

ALL CHANGES MUST BE APPROVED BY THE COUNTY HEALTH UNIT

CR# 24-00712

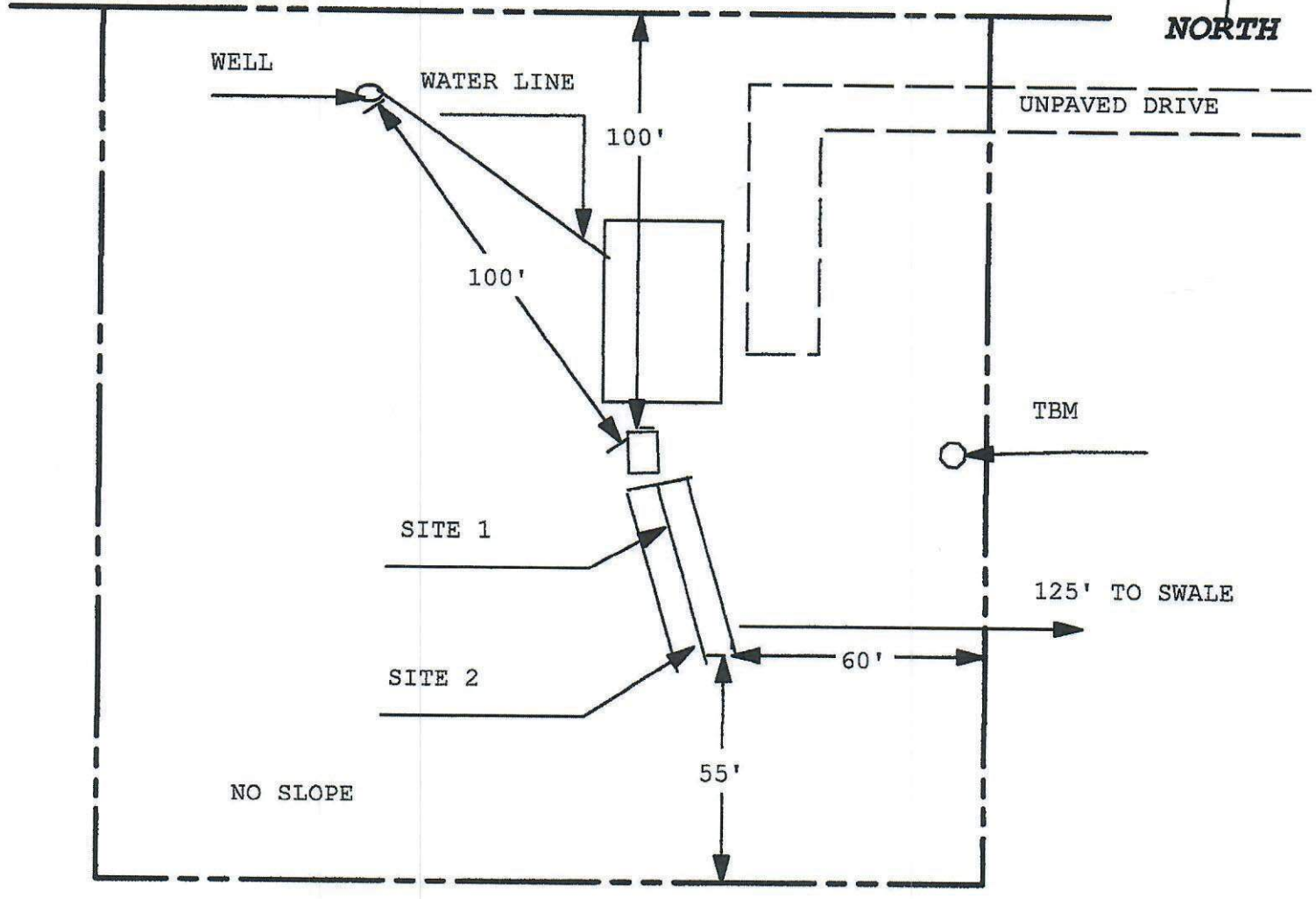

1 INCH = 40 FEET

NO WELLS WITHIN 100'

Site Plan Submitted By Paul R. [Signature] Date 9/22/25
 Plan Approved Not Approved Date 10/2/25
 By [Signature] Columbia CPHU

Notes: _____