



STATE OF FLORIDA
DEPARTMENT OF ENVIRONMENTAL PROTECTION
ONSITE SEWAGE TREATMENT AND DISPOSAL
SYSTEM (OSTDS)

PERMIT NO. 26-0083
DATE PAID: 1-28-26
FEE PAID: 460.00
RECEIPT #: 2287290

APPLICATION FOR CONSTRUCTION PERMIT

APPLICATION FOR:

- New System Existing System Holding Tank Innovative
 Repair Abandonment Temporary

APPLICANT: Adam Schwartz EMAIL: permits@snsmh.com

AGENT: James Warren TELEPHONE: 863-206-5370

MAILING ADDRESS: 219 SE BENNIE LN, LAKE CITY

TO BE COMPLETED BY APPLICANT OR APPLICANT'S AUTHORIZED AGENT. SYSTEMS MUST BE CONSTRUCTED BY A PERSON LICENSED PURSUANT TO 489.105(3) (m) OR 489.552, FLORIDA STATUTES. IT IS THE APPLICANT'S RESPONSIBILITY TO PROVIDE DOCUMENTATION OF THE DATE THE LOT WAS CREATED OR PLATTED (MM/DD/YY) IF REQUESTING CONSIDERATION OF STATUTORY GRANDFATHER PROVISIONS.

PROPERTY INFORMATION

OSTDS REMEDIATION PLAN? [Y / N]

LOT: 5 BLOCK: B SUBDIVISION: Hidden Acres PLATTED: _____

PROPERTY ID #: 15-4S-17-08355-305 ZONING: _____ I/M OR EQUIVALENT: [Y / N]

PROPERTY SIZE: 1.0 ACRES WATER SUPPLY: PRIVATE PUBLIC [] < 2000GPD [] > 2000GPD

IS SEWER AVAILABLE AS PER 381.0065, FS? [Y / N] DISTANCE TO SEWER: _____ FT

PROPERTY ADDRESS: 219 SE Bennie LN, Lake City

DIRECTIONS TO PROPERTY: GPS is Accurate

BUILDING INFORMATION

RESIDENTIAL COMMERCIAL

Unit No.	Type of Establishment	No. of Bedrooms	Building Area Sqft	Commercial/Institutional System Design Table I, Chapter 62-6, FAC
1	Mobile Home	3	1352	ORIGINAL ATTACHED
2	Ex MH	3	2128	
3				
4				

Floor/Equipment Drains Other (Specify) _____

SIGNATURE: James Warren DATE: 1-26-26

STATE OF FLORIDA
DEPARTMENT OF ENVIRONMENTAL PROTECTION
APPLICATION FOR CONSTRUCTION PERMIT

26-0083

Permit Application Number

PART II - SITEPLAN

Scale: Each block represents 10 feet and 1 inch = 40 feet.



Notes:

Site Plan submitted by:

James Wann

F26-26

Plan Approved

Not Approved

Date 1/29/26

By

[Signature]

Columbia

County Health Department

ALL CHANGES MUST BE APPROVED BY THE COUNTY HEALTH DEPARTMENT

DEP 4015, 09-21-2022 (Obsoletes previous editions which may not be used)

Incorporated: 62-9 004, F.A.C.

26-0083

150'

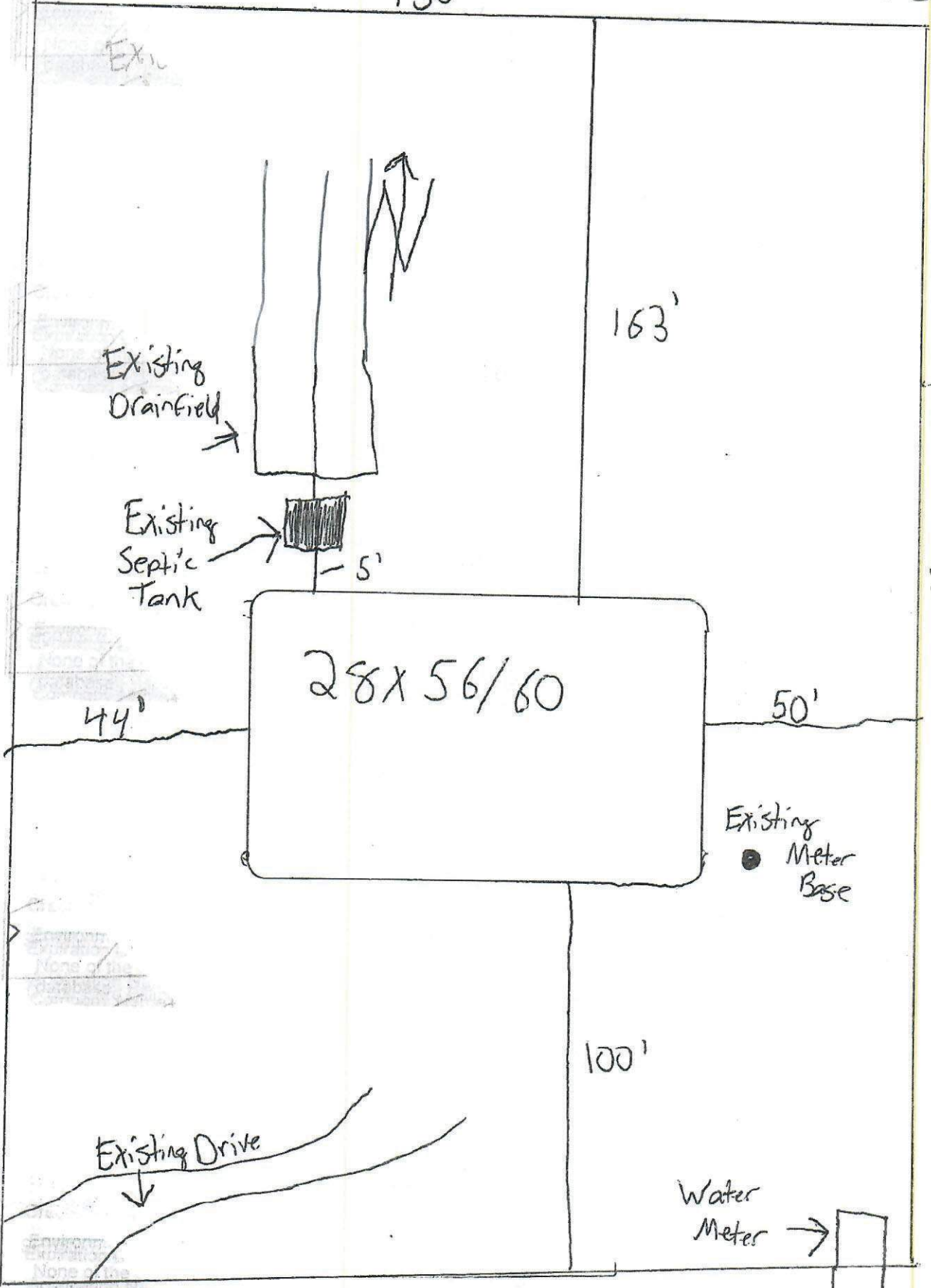

SE Bennie Ln

Existing Drainfield →

Existing Septic Tank →

28x56/60

Existing Meter Base ●

Existing Drive ↓

Water Meter →

163'

291'

44'

50'

100'