

DIMENSION PLAN

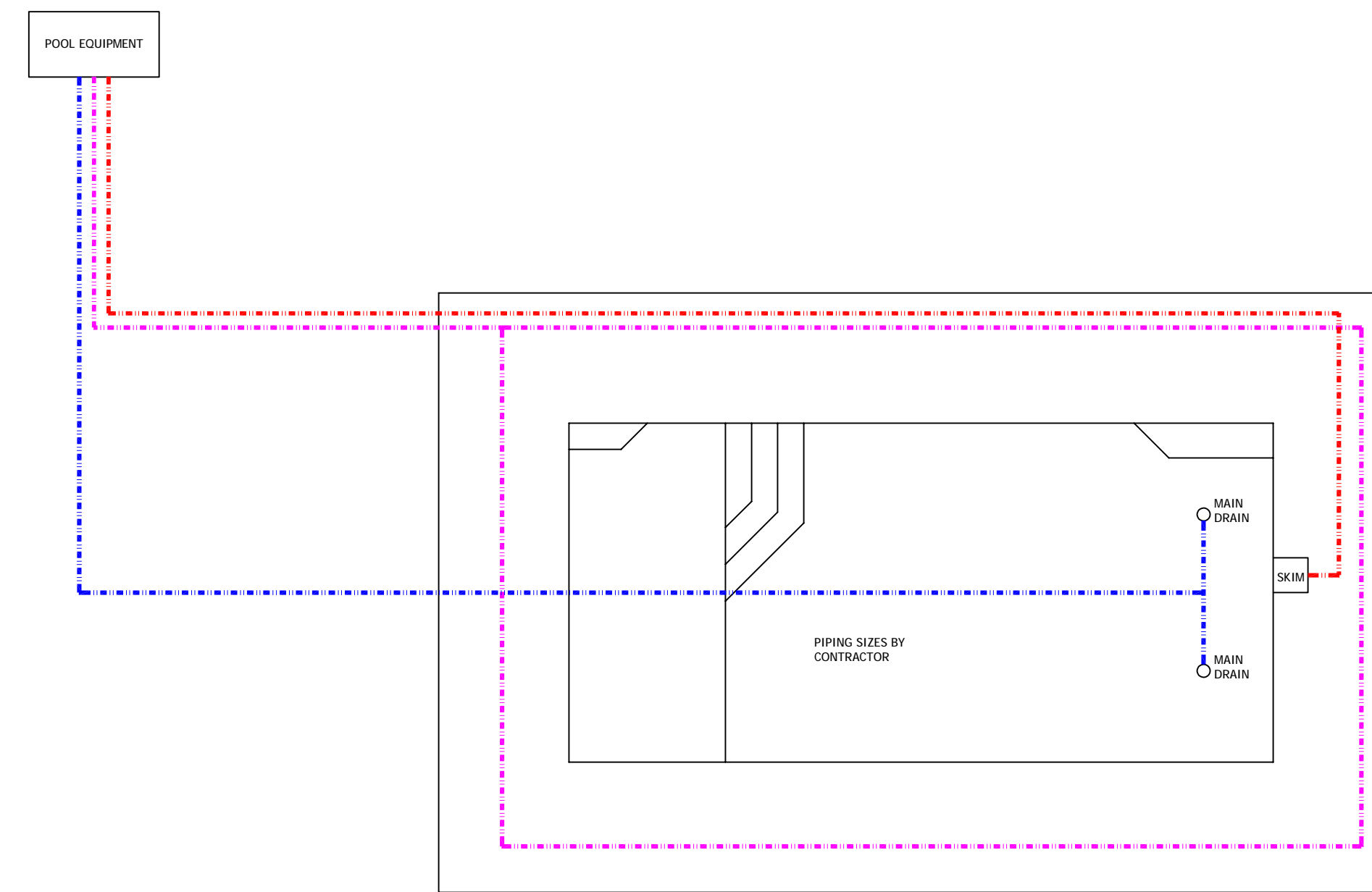

PIPING PLAN

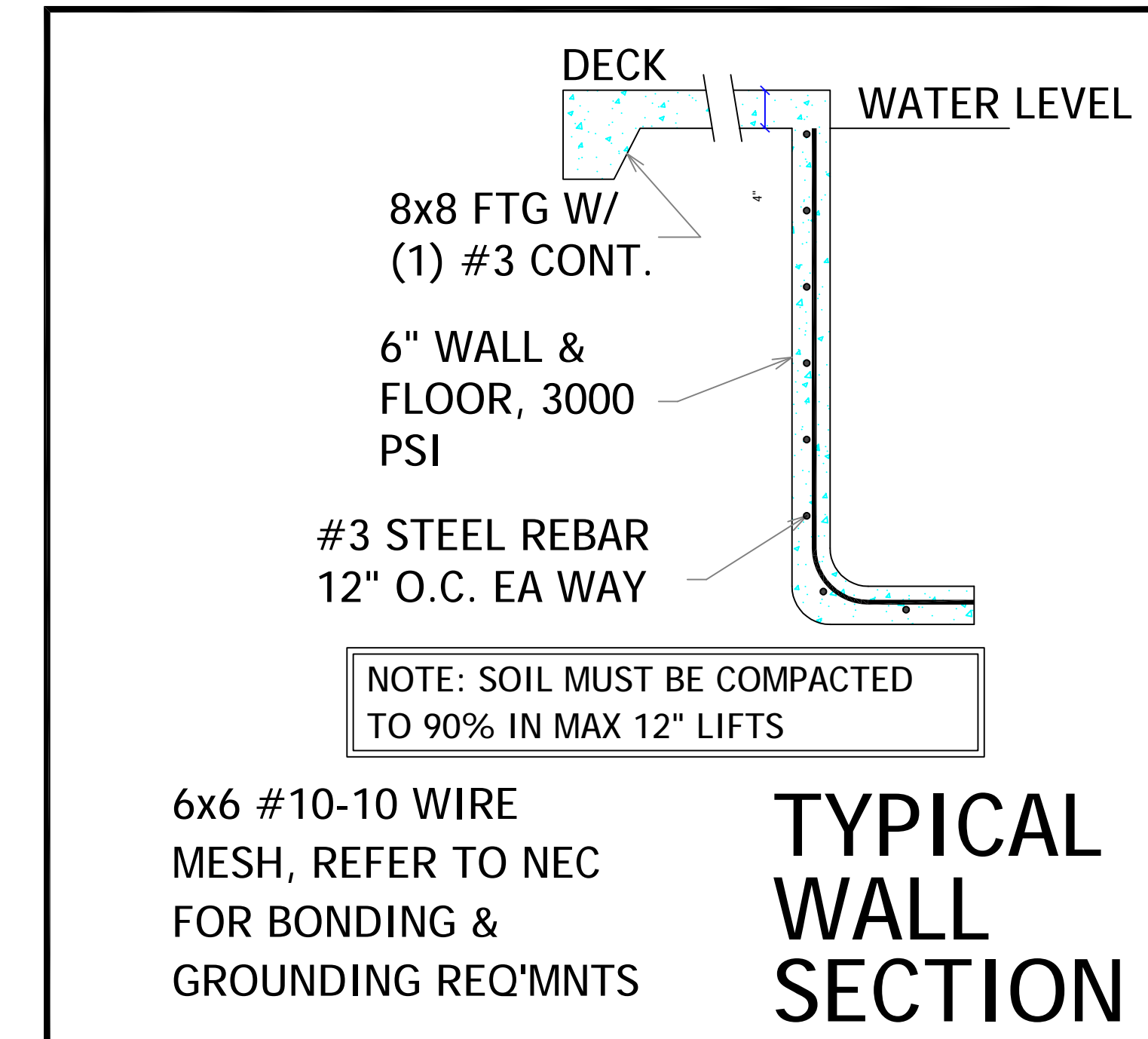

NOTE: SOIL MUST BE COMPACTED TO 90% IN MAX 12\"/>

6x6 #10-10 WIRE MESH, REFER TO NEC FOR BONDING & GROUNDING REQ'MNTS

TYPICAL WALL SECTION

- ENGINEERING NOTES:**
- ALL WORK IS TO COMPLY WITH ALL APPLICABLE CODES & ORDINANCES.
 - CONSTRUCTED OF 3000 PSI CONCRETE OR EQUAL WITH #3 REBAR 12\"/>
 - N/A
 - ASSUMED SOIL BEARING = 2 KSF
 - CIRCULATION SYSTEMS, COMPONENTS, & EQUIPMENT SHALL COMPLY W/ NSF 50.
 - INSTALL CONTROL JOINTS @ 20'-0\"/>
 - PLANS TO CONFORM TO NEC 2017
 - 2020 FBC RESIDENTIAL 7th EDITION APSP13
 - CONCRETE STAIRS ARE 12\"/>
 - ALL CONSTRUCTION SHALL COMPLY WITH ANSI 5-03, 2017 NEC ARTICLE 680, & ANSI-NSPI 3-99 IN-GROUND SPA CONSTR.
 - ENGINEERS DESIGN IS FOR STRUCTURAL ONLY. DESIGN OF PIPING/EQUIPMENT ETC.

- BY POOL CONTRACTOR**
- FENCE REQUIREMENTS:**
- MINIMUM 48\"/>
 - 2\"/>
 - MAX OPENING SHALL NOT ALLOW PASSAGE OF 4\"/>
 - FENCE POSTS WILL BE LOCATED ON POOL-SIDE OF FENCE.
 - GATE WILL BE SELF-LOCKING WITH APPROVED LOCKING DEVICE.

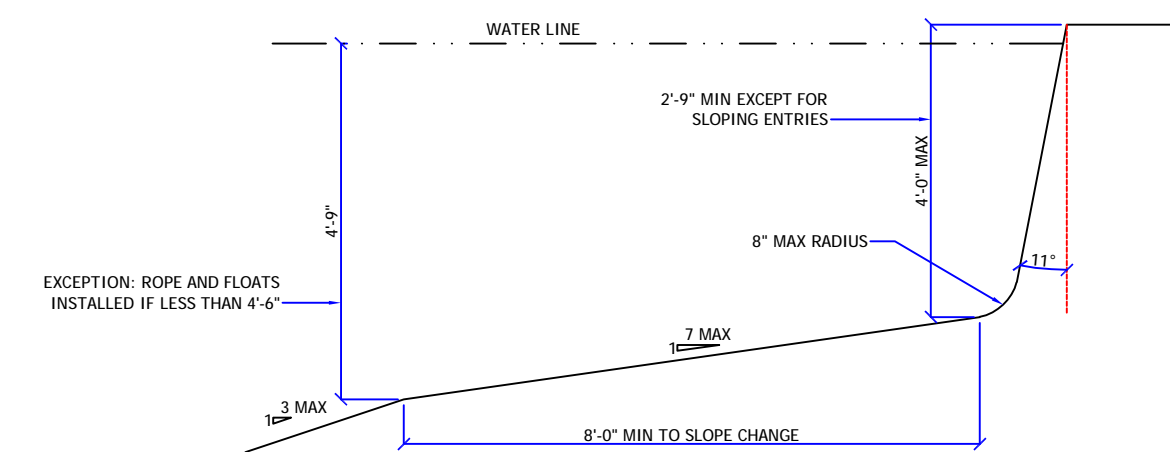

FLOOR SLOPE DETAIL NTS



STEPS: MIN. TREAD 10\"/>

- GENERAL NOTES:**
- Per UL listing, pool motors require GFCI protection
 - FSPA requires the motor controller to be capable of 2 speeds, a time clock will not satisfy this unless it has 2 trip settings.
 - If heater installed (other than solar), it must comply with FBC-EC403.9.1 & have a cover per 403.9.3 (this applies to mechanical (not solar) heaters---cover required)
 - Outdoor swimming pools shall be provided with a barrier complying with Sections R4501.17.1.1 through R4501.17.1.14.
 - NEC 680.26(C) requires a conductive metal part of 9 sq., in. in direct contact with the pool water.
 - R4501.17.1.9 All doors and windows providing direct access from the home to the pool shall be equipped with an exit alarm complying with UL 2017 that has a minimum sound pressure rating of 85 dB at 10 feet.

NOTE: IF ANY PART OF THE POOL ENCLOSED UPON THE ANGLE OF REPOSE, PLACE STEEL @ 6\"/>

EQUIPOTENTIAL BONDING GRID:

ALL METAL PARTS SPECIFIED IN 680.26(B) MUST BE BONDED TO AN EQUIPOTENTIAL BONDING GRID WITH A SOLID COPPER CONDUCTOR NOT SMALLER THAN 8 AWG. THE TERMINATION OF THE BONDING CONDUCTOR MUST BE MADE BY EXOTHERMIC WELDING, LISTED PRESSURE CONNECTORS, OR LISTED CLAMPS THAT ARE LABELED AS SUITABLE FOR THE PURPOSE. THE EQUIPOTENTIAL BONDING GRID MUST EXTEND UNDER PAVED WALKING SURFACES FOR 3 FEET HORIZONTALLY FROM THE WATER (680.26(C)).

THE EQUIPOTENTIAL BONDING GRID MUST BE FORMED FROM EITHER OR BOTH OF:

- THE STRUCTURAL REINFORCING STEEL OF A CONCRETE PERMANENTLY INSTALLED POOL, OUTDOOR SPA, OR OUTDOOR HOT TUB, TIED TOGETHER BY THE USUAL STEEL TIE WIRES.
- THE METAL WALLS OF A PERMANENTLY INSTALLED POOL, OUTDOOR SPA, OR OUTDOOR HOT TUB

THE EQUIPOTENTIAL BONDING GRID CAN BE CONSTRUCTED WITH 8 AWG BARE SOLID COPPER CONDUCTORS BONDED TO EA OTHER AT ALL POINTS OF CROSSING BY EXOTHERMIC WELDING, LISTED PRESSURE CONNECTORS OF THE SET SCREW OR COMPRESSION TYPE, LISTED CLAMPS, OR OTHER LISTED FITTINGS (250.8).

THE EQUIPOTENTIAL BONDING GRID MUST COVER THE CONTOUR OF THE PERMANENTLY INSTALLED POOL, OUTDOOR SPA OR HOT TUB AND DECK EXTENDING 3 FEET HORIZONTALLY FROM THE WATER. THE EQUIPOTENTIAL BONDING GRID MUST BE ARRANGED IN A 1-FOOT BY 1-FOOT NETWORK OF 8 AWG CONDUCTORS, WITH A TOLERANCE OF 4 INCHES.

EXCEPTION: THE EQUIPOTENTIAL BONDING GRID SHALL NOT BE REQ'D TO BE INSTALLED UNDER THE BOTTOM OR VERTICALLY ALONG THE WALLS OF VINYL LINED POLYMER WALL, FIBERGLASS COMPOSITE, OR OTHER POOLS CONSTRUCTED OF NON-CONDUCTIVE MATERIALS.

ANY METAL PARTS OF THE POOL, INCLUDING METAL STRUCTURAL SUPPORTS, SHALL BE BONDED IN ACCORDANCE WITH 680.26(B). POURED CONCRETE, PNEUMATICALLY-APPLIED CONCRETE, AND CONCRETE BLOCK SHALL BE CONSIDERED CONDUCTIVE MATERIAL.

<p>Riddle Consulting Engineers, Inc.</p> <p>structural civil mechanical</p> <p>Paul D. Riddle, P.E. Senior Engineer COA: 00004759</p> <p>Paul A. Riddle, Jr. Structural Engineer</p> <p>EMAIL: RIDDLEENG@AOL.COM ADDRESS: 1720 SE CTV HWY 484, BELLEVUE, FL 34420 PHONE: (850) 245-7041 FAX: (850) 245-5458 WEBSITE: WWW.RIDDLEENGINEERING.COM</p>	ENGINEER'S SEAL
	<p>PAUL D. RIDDLE, P.E. P.E. 36989</p>

<p>A CUSTOM DESIGN FOR</p> <p>THE KALB RESIDENCE</p> <p>AQUATIC ART</p>	DRAWN: JASON R. RIDDLE
	DATE: 6.16.2021
<p>REVISIONS, NOTES</p>	<p>COPYRIGHT © 2021 THESE PLANS ARE PROTECTED BY COPYRIGHT LAWS. ANY UNAUTHORIZED USES MAY RESULT IN LEGAL ACTION.</p> <p>SCALE: 3/16" = 1'-0"</p> <p>1 OF 1</p> <p>JOB NUMBER: 2210555</p>