

COMM NE COR, RUN S 2658.81 FT, W  
S 640.08 FT TO POB, CONT S 648.3  
FT, N 648.28 FT, E 673.69 FT TO

SHOCKLEY MATTHEW C/SHOCKLEY JILLIAN M  
631 SW UNITY CT  
FT WHITE, FL 32038

**2026**

24-7S-16-04317-131  

| BUILDING CHARACTERISTICS |                  | CONSTRUCTION  |      |
|--------------------------|------------------|---------------|------|
| ELEMENT                  | CD               |               |      |
| Exterior Wall            | 10               | ABOVE AVG.    | 100  |
| Roof Structur            | 03               | GABLE/HIP     | 100  |
| Roof Cover               | 03               | COMP SHNGL    | 100  |
| Interior Wall            | 05               | DRYWALL       | 100  |
| Interior Floor           | 14               | CARPET        | 80   |
| Interior Floor           | 15               | HARDTILE      | 20   |
| Air Condition            | 03               | CENTRAL       | 100  |
| Heating Type             | 04               | AIR DUCTED    | 100  |
| Bedrooms                 |                  | 3             | 100  |
| Bathrooms                |                  | 2             | 100  |
| Frame                    | 01               | NONE          | 100  |
| Stories                  | 1.               | 1.            | 100  |
| Architectual             | 05               | CONV          | 100  |
| Units                    |                  | 0             | 100  |
| Condition Adj            | 03               | 03            | 100  |
| Kitchen Adjus            | 01               | 01            | 100  |
| Quality                  | 05               | 05            |      |
| DOR CODE                 | 0100             | SINGLE FAMILY |      |
| MAP NUM                  |                  | MKT AREA      | 02   |
| NEIGHBORHOOD/LOC         | 24716.020        | 1.00/         |      |
| AREA TYPE                | TOTAL GROSS AREA | PCT OF BASE   | YEAR |
| BAS                      | 1,512            | 100           |      |
| FOP                      | 144              | 30            |      |
| FOP                      | 384              | 30            |      |
| TOTALS                   | 2,040            |               |      |

| MARKET ADJUSTMENTS                                  |     |           |             |                |                |      |      |      |      |       |        |  |  |
|---|-----|-----------|-------------|----------------|----------------|------|------|------|------|-------|--------|--|--|
| TYPE  | MDL | EFF. AREA | TOT ADJ PTS | EFF. BASE RATE | REPL. COST NEW | AYB  | EYB  | ECON | FNCT | NORM  | % COND |  |  |
| 0100  | 01  | 1,670     | 111.5240    | 124.91         | 208,600        | 1999 | 2005 | 0    | 0    | 20.00 | 80.00  |  |  |
| 3 SINGLE FAM 0% - 2026 Heated Area: 1512 HX Base Yr |     |           |             |                |                |      |      |      |      |       |        |  |  |

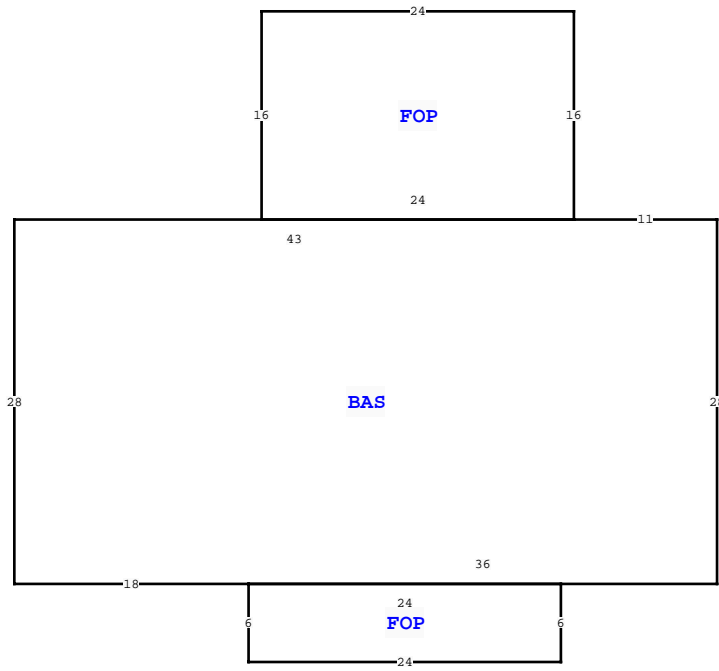

| COLUMBIA COUNTY PROPERTY     |                   |          |             |
|------------------------------|-------------------|----------|-------------|
| VALUATION SUMMARY            |                   |          | PAGE 1 of 1 |
| VALUATION BY                 |                   | STANDARD |             |
| Tax Group: 3                 | Tax Dist:         |          |             |
| BUILDING MARKET VALUE        |                   |          | 166,880     |
| TOTAL MARKET OB/XF VALUE     |                   |          | 8,840       |
| TOTAL LAND VALUE - MARKET    |                   |          | 111,100     |
| TOTAL MARKET VALUE           |                   |          | 286,820     |
| SOH/AGL Deduction            |                   |          | 0           |
| ASSESSED VALUE               |                   |          | 286,820     |
| TOTAL EXEMPTION VALUE        |                   |          | 0           |
| BASE TAXABLE VALUE           |                   |          | 286,820     |
| TOTAL JUST VALUE             |                   |          | 286,820     |
| NCON VALUE                   |                   |          | 0           |
| INCOME VALUE                 |                   |          |             |
| PREVIOUS YEAR MKT VALUE      |                   |          | 261,240     |
| SALE:1:1: INCLUDED 04317-134 |                   |          |             |
| PERMIT NUM                   | DESCRIPTION       | AMT      | ISSUED      |
| 000055528                    | Additions         | 353,804  | 04/21/2026  |
| 000054113                    | Electrical Servic |          | 09/22/2025  |
| 000053718                    | Roof Replacement  | 16,000   | 07/31/2025  |
| 14852                        | SFR               | 475      | 12/15/1998  |
| 10830                        | M H               | 125      | 03/01/1996  |

| SALES DATA                   |            |           |       |       |        |            |
|------------------------------|------------|-----------|-------|-------|--------|------------|
| OFF RECORD Number            | DATE       | TYPE INST | Q / U | V / I | RSN CD | SALE PRICE |
| 1543/1894                    | 6/30/2025  | WD        | Q     | I     | 01     | 360,000    |
| GRANTOR: BRAINARD CHERYL E   |            |           |       |       |        |            |
| GRANTEE: SHOCKLEY MATTHEW C  |            |           |       |       |        |            |
| 1286/0627                    | 12/12/2014 | QC        | U     | I     | 11     | 100        |
| GRANTOR: BETTY DZIEDZIC      |            |           |       |       |        |            |
| GRANTEE: ALFRED R & CHERYL E |            |           |       |       |        |            |

| EXTRA FEATURES |            |             |         |   |    |       |    |       |                |       |
|----------------|------------|-------------|---------|---|----|-------|----|-------|----------------|-------|
| L N            | OB/XF CODE | DESCRIPTION | BLD CAP | L | W  | UNITS | UT | Adj R | ADJ UNIT PRICE | NOTES |
| 1              | 0294       | SHED WOOD/  | 0       | 0 | 10 | 16    | UT | 3.50  | 3.50           | 560   |
| 2              | 0040       | BARN, POLE  | 0       | 0 | 36 | 46    | UT | 5.00  | 5.00           | 8,280 |

| TOTAL OB/XF                 |  |           |  |            |  |     |  |  |  |
|-----------------------------|--|-----------|--|------------|--|-----|--|--|--|
| 8,840                       |  |           |  |            |  |     |  |  |  |
| 631 SW UNITY CT, FORT WHITE |  |           |  |            |  |     |  |  |  |
| BLD DATE                    |  | LGL DATE  |  | 05/06/2026 |  | MLU |  |  |  |
| XF DATE                     |  | LAND DATE |  |            |  |     |  |  |  |
| INC DATE                    |  | AG DATE   |  |            |  |     |  |  |  |

| BUILDING NOTES |  |  |  |  |  |  |  |  |  |
|----------------|--|--|--|--|--|--|--|--|--|
|                |  |  |  |  |  |  |  |  |  |

| BUILDING DIMENSIONS   |  |  |  |  |  |  |  |  |  |
|---|--|--|--|--|--|--|--|--|--|
| BAS= W11 FOP= N16 W24 S16 E24\$ W43 S28 E18 FOP= S6 E24 N6 W24\$ E36 N28\$. |  |  |  |  |  |  |  |  |  |

| LAND DESCRIPTION |          |     |                      |     |     |          |       |       |             | TOTAL OB/XF |     |          |        |         |            |                |            |                             |      |         |      |     |    |        |
|------------------|----------|-----|----------------------|-----|-----|----------|-------|-------|-------------|-------------|-----|----------|--------|---------|------------|----------------|------------|-----------------------------|------|---------|------|-----|----|--------|
| L N              | USE CODE | CLS | LAND USE DESCRIPTION | CAP | R D | LOC ZONE | FRONT | DEPTH | TOT LND UTS | UNIT TYPE   | D T | DPH FACT | % COND | TOT ADJ | UNIT PRICE | ADJ UNIT PRICE | LAND VALUE | OTHER ADJUSTMENTS AND NOTES | YEAR | DENSITY | DECL | FRZ | YR | CONSRV |
| 1                | 0100     | C   | SFR                  | 0   |     | A-1      | 0.00  | 0.00  | 1.00        | AC          |     | 1.00     | 1.00   | 1.00    | 11,000.00  | 11,000.00      | 11,000     |                             |      |         |      |     |    |        |
| 2                | 0000     | C   | VAC RES              | 0   |     | 00       | 0.00  | 0.00  | 9.10        | AC          |     | 1.00     | 1.00   | 1.00    | 11,000.00  | 11,000.00      | 100,100    |                             |      |         |      |     |    |        |