

# Columbia County Property Appraiser

DB Last Updated: 2/17/2011

**2010 Tax Year**

Parcel: 09-4S-16-02819-003

Search Result: 1 of 2 [Next >>](#)

### Owner & Property Info

<b>Owner's Name</b>	WILLIAMS DALE M & PEGGY		
<b>Mailing Address</b>	1121 SW MOUNT CARMEL AVE LAKE CITY, FL 32024		
<b>Site Address</b>	1121 SW MOUNT CARMEL AVE		
<b>Use Desc. (code)</b>	SINGLE FAM (000100)		
<b>Tax District</b>	3 (County)	<b>Neighborhood</b>	9416
<b>Land Area</b>	7.650 ACRES	<b>Market Area</b>	06
<b>Description</b>	NOTE: This description is not to be used as the Legal Description for this parcel in any legal transaction.		
SW1/4 OF SW1/4 OF NE1/4 EX BEG AT SE COR RUN W 208 FT, N 208 FT, E 208 FT, S 208 FT TO POB & EX BEG AT SE COR RUN N 208 FT, E 208 FT, S 208 FT, W 208 FT TO POB ORB 589-428 & 778-1761 & 814-887			

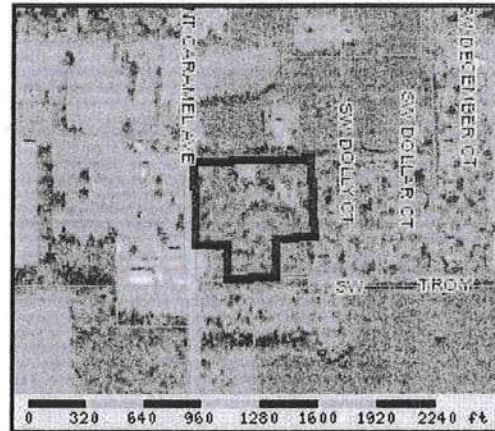

### Property & Assessment Values

2010 Certified Values		
Mkt Land Value	cnt: (0)	\$50,860.00
Ag Land Value	cnt: (2)	\$0.00
Building Value	cnt: (2)	\$88,427.00
XFOB Value	cnt: (4)	\$1,751.00
<b>Total Appraised Value</b>		<b>\$141,038.00</b>
Just Value		\$141,038.00
Class Value		\$0.00
Assessed Value		\$128,048.00
Exempt Value	(code: HX)	\$50,000.00
<b>Total Taxable Value</b>		<b>Cnty: \$78,048</b>
		<b>Other: \$78,048   Schl: \$103,048</b>

2011 Working Values
<p><b>NOTE:</b></p> <p>2011 Working Values are NOT certified values and therefore are subject to change before being finalized for ad valorem assessment purposes.</p>
<input type="button" value="Show Working Values"/>

### Sales History

Sale Date	OR Book/Page	OR Code	Vacant / Improved	Qualified Sale	Sale RCode	Sale Price
4/1/1986	589/428	WD	V	Q		\$8,700.00

### Building Characteristics *NO Record Found*

Bldg Item	Bldg Desc	Year Blt	Ext. Walls	Heated S.F.	Actual S.F.	Bldg Value
1	SINGLE FAM (000100)	1988	COMMON BRK (19)	1728	2304	\$74,377.00
2	PREF M B A (008700)	2003	PREFIN MTL (27)	832	1638	\$12,871.00
<b>Note:</b> All S.F. calculations are based on exterior building dimensions.						

### Extra Features & Out Buildings

Code	Desc	Year Blt	Value	Units	Dims	Condition (% Good)
0166	CONC,PAVMT	1993	\$437.00	0000312.000	13 x 24 x 0	AP (030.00)
0294	SHED WOOD/	1993	\$840.00	0000240.000	12 x 20 x 0	(000.00)
0252	LEAN-TO W/	1993	\$144.00	0000096.000	8 x 12 x 0	(000.00)
0252	LEAN-TO W/	1993	\$330.00	0000220.000	11 x 20 x 0	(000.00)

### Land Breakdown

Lnd Code	Desc	Units	Adjustments	Eff Rate	Lnd Value

45



0 130 260 390 520 650 780 910 1040 1170 1300 ft

**Columbia County Property Appraiser** Jeff Hampton | Lake City, Florida | 386-758-1083

**PARCEL: 09-4S-16-02819-003 (12352) | SINGLE FAMILY (0100) | 8.65 AC**  
 SW1/4 OF SW1/4 OF NE1/4 & BEG AT SE COR OF SW1/4 OF NE1/4, W 208 FT, N 208 FT, E 208 FT, S 208 FT TO POB EX BEG AT SW COR OF SW1/4 OF SW1/4

**Owner:** WILLIAMS DALE M & PEGGY  
 1121 SW MOUNT CARMEL AVE  
 LAKE CITY, FL 32024  
**Site:** 1121 MOUNT CARMEL AVE  
**Sales Info:** 6/9/2014 \$20,000 V(U)  
 4/1/1986 \$8,700 V(Q)

2021 Working Values			
Mkt Lnd	\$49,400	Appraised	\$156,802
Ag Lnd	\$0	Assessed	\$151,718
Bldg	\$101,651	Exempt	\$50,000
XFOB	\$5,751	county:	\$101,718
Just	\$156,802	Total	city:\$0
		Taxable	other:\$0
			school:\$126,718

**NOTES:**



This information was derived from data which was compiled by the Columbia County Property Appraiser Office solely for the governmental purpose of property assessment. This information should not be relied upon by anyone as a determination of the ownership of property or market value. No warranties, expressed or implied, are provided for the accuracy of the data herein, its use, or its interpretation. Although it is periodically updated, this information may not reflect the data currently on file in the Property Appraiser's office. [GrizzlyLogic.com](http://GrizzlyLogic.com)

45