

COLUMBIA COUNTY

Property Appraiser

Parcel 05-3S-17-04847-000

Owners

E L HOLDINGS LAKE CITY LLC
4743 N US HIGHWAY 441
LAKE CITY, FL 32055

GSA GIS

Pictometry



Parcel Summary

Location	4743 N US HIGHWAY 441
Use Code	3611: CAMPGROUND/STORE
Tax District	3: COUNTY
Acreage	26.5000
Section	05
Township	3S
Range	17
Subdivision	DIST 3

Additional Site Addresses

111 NE BUD CT
116 NE BUD CT
143 NE BUD CT
166 NE BUD CT
116 NE CHESHIRE LN

Legal Description

BEG SE COR OF NE1/4 OF SW1/4, RUN W 588.48 FT,
N 256.27 FT, W 420 FT TO E R/W US-441, N
ALONG R/W 1062.90 FT TO S R/W OF CHESHIRE RD,
E ALONG R/W 833.52 FT, SE 1163 FT, CONT S
155 FT TO POB. (LAKE CITY KOA CAMPGROUND-441 N).

856-2038, WD 1018-1552, WD 1284-2414,



Working Values

	2026
Total Building	\$295,790
Total Extra Features	\$266,421
Total Market Land	\$165,625
Total Ag Land	\$0
Total Market	\$727,836
Total Assessed	\$714,700
Total Exempt	\$0
Total Taxable	\$714,700
SOH Diff	\$13,136

Value History

	2025	2024	2023	2022	2021	2020	2019
Total Building	\$295,790	\$263,315	\$243,468	\$211,269	\$187,958	\$173,210	\$164,435
Total Extra Features	\$266,421	\$188,221	\$188,221	\$184,471	\$181,221	\$181,221	\$181,221
Total Market Land	\$165,625	\$139,125	\$139,125	\$139,125	\$142,375	\$139,489	\$139,489
Total Ag Land	\$0	\$0	\$0	\$0	\$0	\$0	\$0
Total Market	\$727,836	\$590,661	\$570,814	\$534,865	\$511,554	\$493,920	\$485,145
Total Assessed	\$649,727	\$590,661	\$570,814	\$534,865	\$511,554	\$493,920	\$485,145
Total Exempt	\$0	\$0	\$0	\$0	\$0	\$0	\$0
Total Taxable	\$649,727	\$590,661	\$570,814	\$534,865	\$511,554	\$493,920	\$485,145
SOH Diff	\$78,109	\$0	\$0	\$0	\$0	\$0	\$0

Document/Transfer/Sales History

Instrument / Official Record	Date	Q/U	Reason	Type	V/I	Sale Price	Ownership
<u>WD</u> 1284/2414	2014-10-31	<u>Q</u>	<u>01</u>	WARRANTY DEED	Improved	\$1,200,000	Grantor: DKLZ LLC Grantee: E L HOLDINGS LAKE CITY LLC
<u>WD</u> 1018/1552	2004-06-17	<u>U</u>	<u>09</u>	WARRANTY DEED	Improved	\$700,000	Grantor: ELLENBURG FAMILY LTD PARTNERSHIP Grantee: DKLZ LLC
<u>WD</u> 0856/2037	1998-04-16	<u>Q</u>		WARRANTY DEED	Improved	\$400,000	Grantor: CROCKETT Grantee: ELLENBURG FAMILY LTD PARTNERSHIP

Building # 2, Section # 1, 72923, SFR

Type	Model	Heated Area	Gross Area	Repl Cost New	YrBlt	Year Eff	Other % Dpr	Normal % Dpr	% Cond	Value
0100	01	1812	2028	\$196,333	1976	1976	0.00%	35.00%	65.00%	\$127,616

Structural Elements

Type	Description	Code	Details
EW	Exterior Wall	05	AVERAGE
RS	Roof Structure	03	GABLE/HIP
RC	Roof Cover	03	COMP SHNGL
IW	Interior Wall	05	DRYWALL
IF	Interior Flooring	14	CARPET
IF	Interior Flooring	06	VINYL ASB
AC	Air Conditioning	03	CENTRAL
HT	Heating Type	04	AIR DUCTED
BDR	Bedrooms	0.00	
BTH	Bathrooms	0.00	
FR	Frame	01	NONE
STR	Stories	0	0
AR	Architectual Type	05	CONV
COND	Condition Adjustment	03	03
KTCH	Kitchen Adjustment	01	01

Sub Areas

Type	Gross Area	Percent of Base	Adjusted Area
BAS	1,812	100%	1,812
UOP	72	20%	14
UOP	144	20%	29

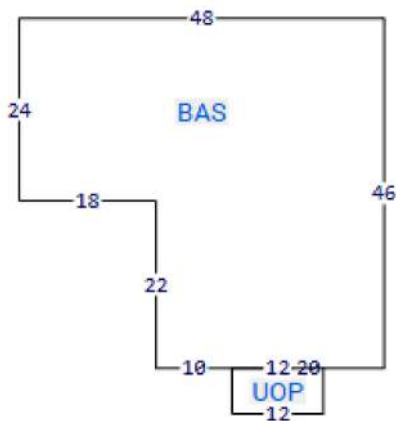
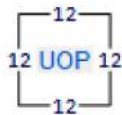

Building # 3, Section # 1, 4779, MOBILE HOME

Type	Model	Heated Area	Gross Area	Repl Cost New	YrBlt	Year Eff	Other % Dpr	Normal % Dpr	% Cond	Value
<u>0800</u>	<u>02</u>	644	644	\$29,875	1992	1992	0.00%	60.00%	40.00%	\$11,950

Structural Elements

Type	Description	Code	Details
EW	Exterior Wall	03	BELOW AVG.
RS	Roof Structure	03	GABLE/HIP
RC	Roof Cover	01	MINIMUM
IW	Interior Wall	05	DRYWALL
IF	Interior Flooring	14	CARPET
IF	Interior Flooring	08	SHT VINYL
AC	Air Conditioning	02	WINDOW
HT	Heating Type	04	AIR DUCTED
BDR	Bedrooms	3.00	
BTH	Bathrooms	1.00	
STR	Stories	1.	1.
AR	Architectual Type	01	CONV
COND	Condition Adjustment	03	03
KTCH	Kitchen Adjustment	01	01

Sub Areas

Type	Gross Area	Percent of Base	Adjusted Area
<u>BAS</u>	644	100%	644

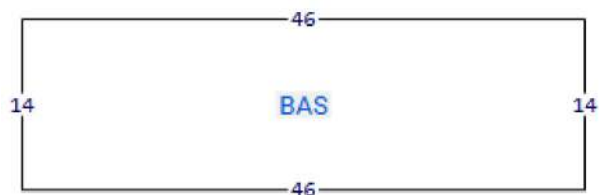

Building # 4, Section # 1, 7822, MOBILE HOME

Type	Model	Heated Area	Gross Area	Repl Cost New	YrBlt	Year Eff	Other % Dpr	Normal % Dpr	% Cond	Value
<u>0800</u>	<u>02</u>	864	1104	\$48,894	1988	1988	0.00%	60.00%	40.00%	\$19,558

Structural Elements

Type	Description	Code	Details
EW	Exterior Wall	03	BELOW AVG.
RS	Roof Structure	03	GABLE/HIP
RC	Roof Cover	01	MINIMUM
IW	Interior Wall	05	DRYWALL
IF	Interior Flooring	14	CARPET
IF	Interior Flooring	08	SHT VINYL
AC	Air Conditioning	03	CENTRAL
HT	Heating Type	04	AIR DUCTED
BDR	Bedrooms	2.00	
BTH	Bathrooms	1.00	
STR	Stories	1.	1.
AR	Architectural Type	01	CONV
COND	Condition Adjustment	03	03
KTCH	Kitchen Adjustment	01	01

Sub Areas

Type	Gross Area	Percent of Base	Adjusted Area
<u>BAS</u>	864	100%	864
<u>FEP</u>	80	85%	68
<u>FSP</u>	160	40%	64

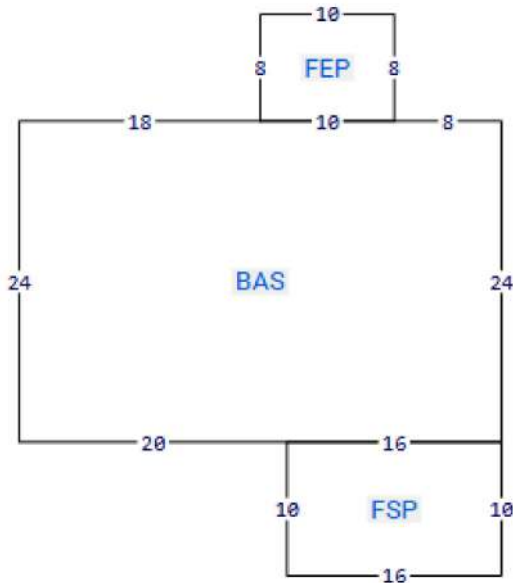

Building # 17, Section # 1, 12023, MOBILE HOME

Type	Model	Heated Area	Gross Area	Repl Cost New	YrBlt	Year Eff	Other % Dpr	Normal % Dpr	% Cond	Value
<u>0800</u>	<u>02</u>	1458	1618	\$75,155	1979	1979	0.00%	60.00%	40.00%	\$30,062

Structural Elements

Type	Description	Code	Details
EW	Exterior Wall	03	BELOW AVG.

Sub Areas

Type	Gross Area	Percent of Base	Adjusted Area
<u>BAS</u>	1,458	100%	1,458

Type	Description	Code	Details
RS	Roof Structure	03	GABLE/HIP
RC	Roof Cover	01	MINIMUM
IW	Interior Wall	04	PLYWOOD
IF	Interior Flooring	14	CARPET
IF	Interior Flooring	08	SHT VINYL
AC	Air Conditioning	03	CENTRAL
HT	Heating Type	04	AIR DUCTED
BDR	Bedrooms	3.00	
BTH	Bathrooms	2.00	
STR	Stories	1.	1.
AR	Architectual Type	01	CONV
COND	Condition Adjustment	03	03
KTCH	Kitchen Adjustment	01	01

Type	Gross Area	Percent of Base	Adjusted Area
<u>UOP</u>	160	25%	40

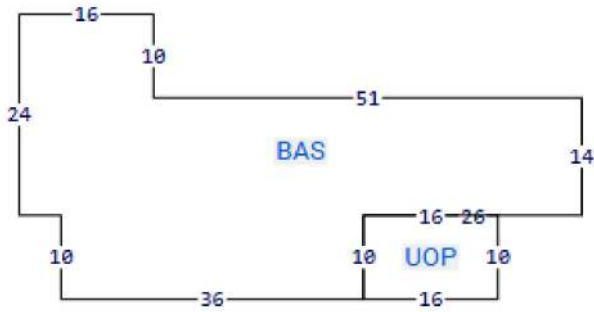

Building # 18, Section # 1, 3470, MOBILE HOME

Type	Model	Heated Area	Gross Area	Repl Cost New	YrBltt	Year Eff	Other % Dpr	Normal % Dpr	% Cond	Value
<u>0800</u>	<u>02</u>	401	561	\$21,941	1985	1985	0.00%	60.00%	40.00%	\$8,776

Structural Elements

Type	Description	Code	Details
EW	Exterior Wall	03	BELOW AVG.
RS	Roof Structure	01	FLAT
RC	Roof Cover	12	MODULAR MT
IW	Interior Wall	04	PLYWOOD

Sub Areas

Type	Gross Area	Percent of Base	Adjusted Area
<u>BAS</u>	401	100%	401
<u>FOP</u>	160	35%	56

Type	Description	Code	Details
IF	Interior Flooring	14	CARPET
IF	Interior Flooring	08	SHT VINYL
AC	Air Conditioning	02	WINDOW
HT	Heating Type	03	FORCED AIR
BDR	Bedrooms	2.00	
BTH	Bathrooms	1.00	
STR	Stories	1.	1.
AR	Architectual Type	01	CONV
COND	Condition Adjustment	03	03
KTCH	Kitchen Adjustment	01	01

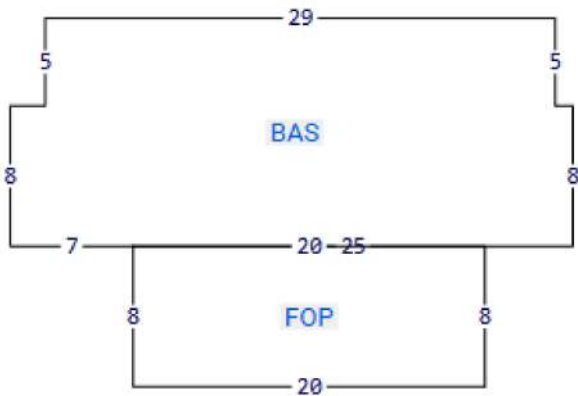

Building # 19, Section # 1, 3524, MOBILE HOME

Type	Model	Heated Area	Gross Area	Repl Cost New	YrBlt	Year Eff	Other % Dpr	Normal % Dpr	% Cond	Value
0800	02	396	492	\$22,030	1990	1990	0.00%	60.00%	40.00%	\$8,812

Structural Elements

Type	Description	Code	Details
EW	Exterior Wall	03	BELOW AVG.
RS	Roof Structure	03	GABLE/HIP
RC	Roof Cover	03	COMP SHNGL
IW	Interior Wall	04	PLYWOOD
IF	Interior Flooring	08	SHT VINYL
AC	Air Conditioning	03	CENTRAL
HT	Heating Type	04	AIR DUCTED

Sub Areas

Type	Gross Area	Percent of Base	Adjusted Area
BAS	396	100%	396
FSP	96	40%	38

Type	Description	Code	Details
BDR	Bedrooms	1.00	
BTH	Bathrooms	1.00	
STR	Stories	1.	1.
AR	Architectual Type	01	CONV
COND	Condition Adjustment	03	03
KTCH	Kitchen Adjustment	01	01

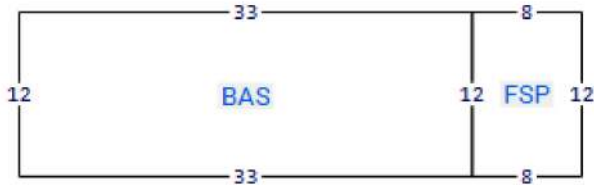

Building # 20, Section # 1, 3524, MOBILE HOME

Type	Model	Heated Area	Gross Area	Repl Cost New	YrBlit	Year Eff	Other % Dpr	Normal % Dpr	% Cond	Value
<u>0800</u>	<u>02</u>	396	492	\$22,030	1990	1990	0.00%	60.00%	40.00%	\$8,812

Structural Elements

Type	Description	Code	Details
EW	Exterior Wall	03	BELOW AVG.
RS	Roof Structure	03	GABLE/HIP
RC	Roof Cover	03	COMP SHNGL
IW	Interior Wall	04	PLYWOOD
IF	Interior Flooring	08	SHT VINYL
AC	Air Conditioning	03	CENTRAL
HT	Heating Type	04	AIR DUCTED
BDR	Bedrooms	1.00	
BTH	Bathrooms	1.00	
STR	Stories	1.	1.
AR	Architectual Type	01	CONV

Sub Areas

Type	Gross Area	Percent of Base	Adjusted Area
<u>BAS</u>	396	100%	396
<u>FSP</u>	96	40%	38

Type	Description	Code	Details
COND	Condition Adjustment	03	03
KTCH	Kitchen Adjustment	01	01

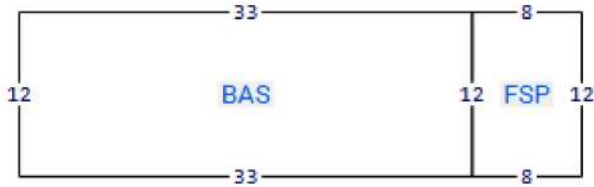

Building # 21, Section # 1, 1709, MOBILE HOME

Type	Model	Heated Area	Gross Area	Repl Cost New	YrBlit	Year Eff	Other % Dpr	Normal % Dpr	% Cond	Value
0800	02	192	288	\$10,681	1990	1990	0.00%	60.00%	40.00%	\$4,272

Structural Elements

Type	Description	Code	Details
EW	Exterior Wall	03	BELOW AVG.
RS	Roof Structure	03	GABLE/HIP
RC	Roof Cover	03	COMP SHNGL
IW	Interior Wall	04	PLYWOOD
IF	Interior Flooring	08	SHT VINYL
AC	Air Conditioning	02	WINDOW
HT	Heating Type	02	CONVECTION
BDR	Bedrooms	1.00	
BTH	Bathrooms	1.00	
STR	Stories	1.	1.
AR	Architectual Type	01	CONV
COND	Condition Adjustment	03	03
KTCH	Kitchen Adjustment	01	01

Sub Areas

Type	Gross Area	Percent of Base	Adjusted Area
BAS	192	100%	192
FSP	96	40%	38

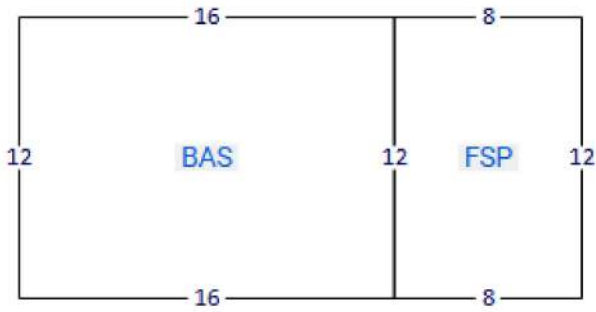

Building # 22, Section # 1, 1709, MOBILE HOME

Type	Model	Heated Area	Gross Area	Repl Cost New	YrBlt	Year Eff	Other % Dpr	Normal % Dpr	% Cond	Value
<u>0800</u>	<u>02</u>	192	288	\$10,681	1990	1990	0.00%	60.00%	40.00%	\$4,272

Structural Elements

Type	Description	Code	Details
EW	Exterior Wall	03	BELOW AVG.
RS	Roof Structure	03	GABLE/HIP
RC	Roof Cover	03	COMP SHNGL
IW	Interior Wall	04	PLYWOOD
IF	Interior Flooring	08	SHT VINYL
AC	Air Conditioning	02	WINDOW
HT	Heating Type	02	CONVECTION
BDR	Bedrooms	1.00	
BTH	Bathrooms	1.00	
STR	Stories	1.	1.
AR	Architectual Type	01	CONV
COND	Condition Adjustment	03	03
KTCH	Kitchen Adjustment	01	01

Sub Areas

Type	Gross Area	Percent of Base	Adjusted Area
<u>BAS</u>	192	100%	192
<u>FSP</u>	96	40%	38

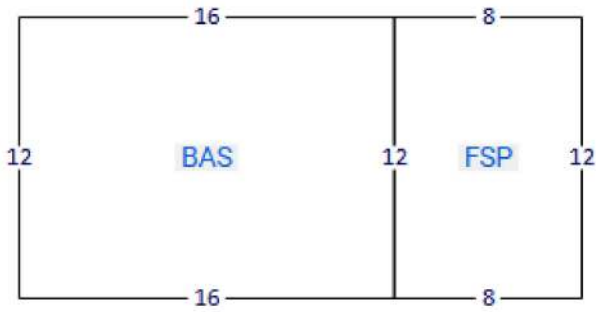

Extra Features

Code	Description	Length	Width	Units	Unit Price	AYB	% Good Condition	Final Value
0297	SHED CONCRETE BLOCK	12	12	1.00	\$0.00	1992	100%	\$500
0297	SHED CONCRETE BLOCK	12	12	1.00	\$0.00	1992	100%	\$500
9945	Well/Sept			1.00	\$7,000.00		100%	\$7,000
0294	SHED WOOD/VINYL	10	10	1.00	\$0.00	1997	100%	\$750
0270	POOL COMM	18	35	630.00	\$35.00	1987	80%	\$17,640
0130	CLFENCE 5			1.00	\$0.00	1987	100%	\$1,125
9915	RV SITE			40.00	\$3,000.00	1991	100%	\$120,000
9905	CAMPSITE/NO SEPTIC			12.00	\$1,500.00	1991	100%	\$18,000
0070	CARPORT UF	20	14	1.00	\$0.00	1999	100%	\$250
0294	SHED WOOD/VINYL	10	10	1.00	\$0.00	1999	100%	\$750
0259	MHP HOOKUP			20.00	\$4,300.00	1999	100%	\$86,000
0310	SEWER TRMT SYST			2000.00	\$3.00	0	25%	\$1,500
0260	PAVEMENT-ASPHALT	2500	16	40000.00	\$1.10	0	25%	\$11,000
0169	FENCE/WOOD			750.00	\$7.50	0	25%	\$1,406

Land Lines

Code	Description	Zone	Front	Depth	Units	Rate/Unit	Acreage	Total Adj	Value
3600	RV PARKS/CAMPS	A-1	.00	.00	26.50	\$5,000.00/AC	26.50	1.25	\$165,625

Personal Property

Account	Secured/ Unsecured	Owner	Description
04640-125	Unsecured	E L HOLDINGS LAKE CITY LLC	B - BUSINESS

Permits

Date	Permit	Type	Status	Description
Aug 11, 2025	000053773	REMODEL	PENDING	Remodel
Jun 16, 2025	000053361	REROOF COMM	COMPLETED	Roof Replacement or Repair
Jun 16, 2025	000053363	REROOF SFR	COMPLETED	Roof Replacement or Repair
Jun 16, 2025	000053360	REROOF SFR	COMPLETED	Roof Replacement or Repair
Jun 16, 2025	000053349	REROOF SFR	COMPLETED	Roof Replacement or Repair
May 19, 2025	000053106	REROOF COMM	COMPLETED	Roof Replacement or Repair
Oct 7, 2024	000050952	ELECTRICAL	COMPLETED	Electrical Service
Jun 5, 2023	000047351	ELECTRICAL	COMPLETED	Electrical Service
Sep 12, 2022	000045389	REROOF COMM	COMPLETED	Roof Replacement or Repair
Jul 7, 2005	23216	M H	COMPLETED	M H
	23158	M H	COMPLETED	M H
	22148	M H	COMPLETED	M H
	13731	M H	COMPLETED	M H
	13398	M H	COMPLETED	M H
	12682	M H	COMPLETED	M H
	10884	M H	COMPLETED	M H
	7055	M H	COMPLETED	M H

TRIM Notices

2025

2024

2023

Disclaimer

All parcel data on this page is for use by the Columbia County Assessor for assessment purposes only. The summary data on this page may not be a complete representation of the parcel or of the improvements thereon. Building information, including unit counts and number of permitted units, should be verified with the appropriate building and planning agencies. Zoning information should be verified with the appropriate planning agency. All parcels are reappraised each year. This is a true and accurate copy of the records of the Columbia County Assessor's Office as of November 07, 2025.