

Columbia County New Building Permit Application

For Office Use Only Application # 44225 Date Received 12-20-19 By mg Permit # 39089
Zoning Official LW / LH Date 12-20-19 Mod Zone X Land Use Ag Zoning A-3
FEMA Map # _____ Elevation _____ MFE _____ River _____ Plans Examiner T.C Date 12-27-19

Comments
 NOC EH Deed or PA Site Plan State Road Info Well letter 911 Sheet Parent Parcel #
 Dev Permit # _____ In Floodway Letter of Auth. from Contractor F W Comp. letter
 Owner Builder Disclosure Statement Land Owner Affidavit Ellisville Water App Fee Paid Sub VF Form

Septic Permit No. X19-108 OR City Water Fax _____

Applicant (Who will sign/pickup the permit) Edel or Sherrie Ojeda Phone (352)988-4870

Address 11116 SW County Rd 240, Lake City, FL 32084

Owners Name Edel & Sherrie Ojeda Phone (352)988-4870

911 Address 11116 SW County Rd 240, Lake City, FL 32084

Contractors Name Edel Ojeda Phone (352)988-4870

Address 295 NW Commons Loop, Ste 115-323, Lake City, FL 32055

Contractor Email psif12007@gmail.com ***Include to get updates on this job.

Fee Simple Owner Name & Address _____

Bonding Co. Name & Address _____

Architect/Engineer Name & Address _____

Mortgage Lenders Name & Address _____

Circle the correct power company FL Power & Light Clay Elec. Suwannee Valley Elec. Duke Energy

Property ID Number 13-55-15-00455-003 Estimated Construction Cost \$23,500

Subdivision Name n/a Lot _____ Block _____ Unit _____ Phase _____

Driving Directions from a Major Road US-90 W, turn Left on FL-2475, turn left on Rough Rd, turn Left on CR 240

Construction of Barn Commercial OR Residential

Proposed Use/Occupancy Barn for Equipment Number of Existing Dwellings on Property 0

Is the Building Fire Sprinkled? No If Yes, blueprints included _____ Or Explain _____

Circle Proposed Culvert Permit or Culvert Waiver or D.O.T. Permit or Have an Existing Drive

Actual Distance of Structure from Property Lines - Front 585ft Side _____ Side _____ Rear 85ft

Number of Stories 1 Heated Floor Area _____ Total Floor Area 205ft 65ft Acreage 5 85ft

Zoning Applications applied for (Site & Development Plan, Special Exception, etc.) _____

Columbia County Property Appraiser

Jeff Hampton

2020 Working Values
updated 11/27/2019

Parcel: << 13-5S-15-00455-003 >>

Aerial Viewer Picometry Google Maps

Owner & Property Info Result: 1 of 4

Owner	OJEDA EDEL & SHERRIE JOHNSON OJEDA 30705 KUMQUAT AVE EUSTIS, FL 32736		
Site			
Description*	COMM NW COR OF SEC. S 40 FT TO S R/W OF CR 240 AND POB, E 300 FT, S 726.50 FT, W 300 FT, N 726.50 FT TO POB. WD 1085-1251, WD 1168-2088, WD 1395-1637,		
Area	5 AC	S/T/R	13-5S-15
Use Code**	VACANT (000000)	Tax District	3

*The Description above is not to be used as the Legal Description for this parcel in any legal transaction.
**The Use Code is a FL Dept. of Revenue (DOR) code and is not maintained by the Property Appraiser's office. Please contact your city or county Planning & Zoning office for specific zoning information.

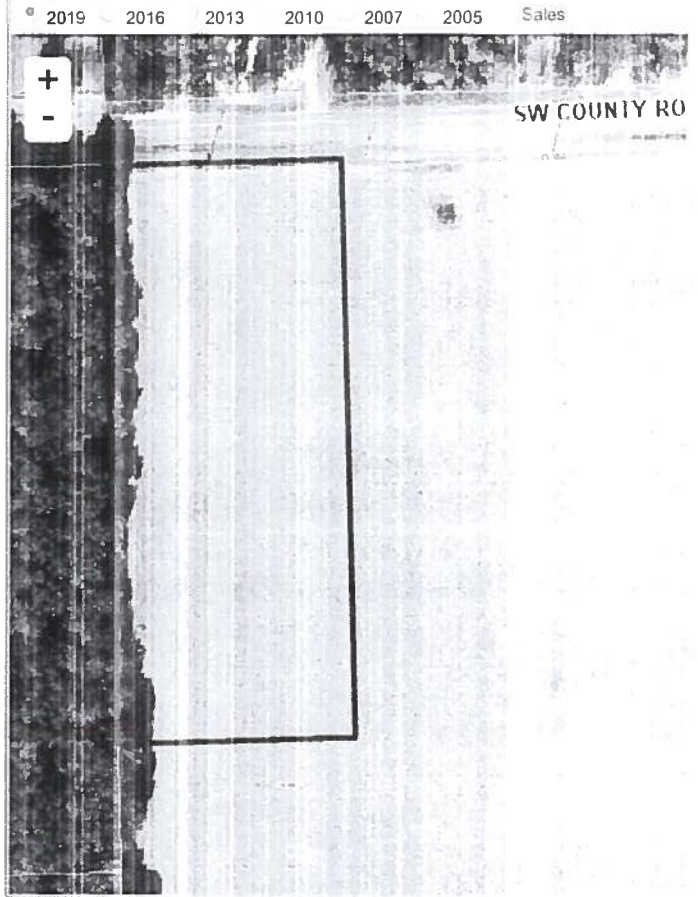

Property & Assessment Values

2019 Certified Values		2020 Working Values	
Mkt Land (0)	\$0	Mkt Land (1)	\$29,690
Ag Land (1)	\$1,200	Ag Land (0)	\$0
Building (0)	\$0	Building (0)	\$0
XFOB (0)	\$0	XFOB (0)	\$0
Just	\$29,693	Just	\$29,690
Class	\$1,200	Class	\$0
Appraised	\$1,200	Appraised	\$29,690
SOH Cap [?]	\$0	SOH Cap [?]	\$0
Assessed	\$1,200	Assessed	\$29,690
Exempt	\$0	Exempt	\$0
Total Taxable	county:\$1,200 city:\$1,200 other:\$1,200 school:\$1,200	Total Taxable	county:\$29,690 city:\$29,690 other:\$29,690 school:\$29,690

Sales History

Sale Date	Sale Price	Book/Page	Deed	V/I	Quality (Codes)	RCode
9/25/2019	\$47,500	1395/1637	WD	V	Q	01
3/5/2009	\$40,000	1168/2088	WD	V	Q	01

Building Characteristics

Bldg Sketch	Bldg Item	Bldg Desc*	Year Blt	Base SF	Actual SF	Bldg Value
NONE						

Extra Features & Out Buildings (Codes)

Code	Desc	Year Blt	Value	Units	Dims	Condition (% Good)
NONE						

Land Breakdown

Land Code	Desc	Units	Adjustments	Eff Rate	Land Value
000000	VAC RES (MKT)	5.000 AC	1.00/1.00 1.00/1.00	\$5.938	\$29,690

Search Result 1 of 4

Columbia County Building Permit Application

CODE: Florida Building Code 2017 and the 2014 National Electrical Code.

Application is hereby made to obtain a permit to do work and installations as indicated. I certify that no work or installation has commenced prior to the issuance of a permit and that all work be performed to meet the standards of all laws regulating construction in this jurisdiction.

TIME LIMITATIONS OF APPLICATION : An application for a permit for any proposed work shall be deemed to have been abandoned 180 days after the date of filing, unless pursued in good faith or a permit has been issued.

TIME LIMITATIONS OF PERMITS: Every permit issued shall become invalid unless the work authorized by such permit is commenced within 180 days after its issuance, or if the work authorized by such permit is suspended or abandoned for a period of 180 days after the time work is commenced. A valid permit receives an approved inspection every 180 days. Work shall be considered not suspended, abandoned or invalid when the permit has received an approved inspection within 180 days of the previous approved inspection.

FLORIDA'S CONSTRUCTION LIEN LAW: Protect Yourself and Your Investment: According to Florida Law, those who work on your property or provide materials, and are not paid-in-full, have a right to enforce their claim for payment against your property. This claim is known as a construction lien. If your contractor fails to pay subcontractors or material suppliers or neglects to make other legally required payments, the people who are owed money may look to your property for payment, even if you have paid your contractor in full. This means if a lien is filed against your property, it could be sold against your will to pay for labor, materials or other services which your contractor may have failed to pay.

NOTICE OF RESPONSIBILITY TO CONTRACTOR AND AGENT: YOU ARE HEREBY NOTIFIED as the recipient of a building permit from Columbia County, Florida, you will be held responsible to the County for any damage to sidewalks and/or road curbs and gutters, concrete features and structures, together with damage to drainage facilities, removal of sod, major changes to lot grades that result in ponding of water, or other damage to roadway and other public infrastructure facilities caused by you or your contractor, subcontractors, agents or representatives in the construction and/or improvement of the building and lot for which this permit is issued. No certificate of occupancy will be issued until all corrective work to these public infrastructures and facilities has been corrected.

WARNING TO OWNER: YOUR FAILURE TO RECORD A NOTICE OF COMMENCEMENT MAY RESULT IN YOU PAYING TWICE FOR IMPROVEMENTS TO YOUR PROPERTY. A NOTICE OF COMMENCEMENT MUST BE RECORDED AND POSTED ON THE JOB SITE BEFORE THE FIRST INSPECTION. IF YOU INTEND TO OBTAIN FINANCING, CONSULT WITH YOUR LENDER OR ATTORNEY BEFORE RECORDING YOUR NOTICE OF COMMENCEMENT.

OWNERS CERTIFICATION: I CERTIFY THAT ALL THE FOREGOING INFORMATION IS ACCURATE AND THAT ALL WORK WILL BE DONE IN COMPLIANCE WITH ALL APPLICABLE LAWS REGULATING CONSTRUCTION AND ZONING.

NOTICE TO OWNER: There are some properties that may have deed restrictions recorded upon them. These restrictions may limit or prohibit the work applied for in your building permit. You must verify if your property is encumbered by any restrictions or face possible litigation and or fines.

Edel Ojeda
Print Owners Name

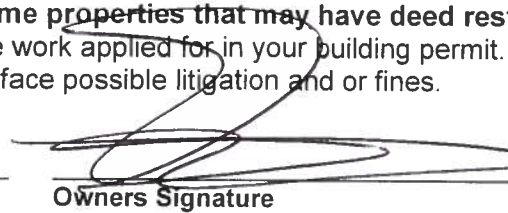
Owners Signature

****Property owners must sign here before any permit will be issued.**

****If this is an Owner Builder Permit Application then, ONLY the owner can sign the building permit when it is issued.**

CONTRACTORS AFFIDAVIT: By my signature I understand and agree that I have informed and provided this written statement to the owner of all the above written responsibilities in Columbia County for obtaining this Building Permit including all application and permit time limitations.

Contractor's Signature _____ Contractor's License Number _____
Columbia County _____
Competency Card Number _____

Affirmed under penalty of perjury to by the Contractor and subscribed before me this _____ day of _____ 20____.
Personally known or Produced Identification _____

SEAL: _____
State of Florida Notary Signature (For the Contractor)

SUBCONTRACTOR VERIFICATION

APPLICATION PERMIT # _____

IDB NAME

Ojeda

THIS FORM MUST BE SUBMITTED BEFORE A PERMIT WILL BE ISSUED

Columbia County issues combination permits. One permit will cover all trades doing work at the permitted site. It is **REQUIRED** that we have records of the subcontractors who actually did the trade specific work under the general contractors permit.

NOTE: It shall be the responsibility of the general contractor to make sure that all of the subcontractors are licensed with the Columbia County Building Department.

Use website to confirm licenses: <http://www.columbiacountyfla.com/PermitSearch/ContractorSearch.aspx>

NOTE: If this should change prior to completion of the project, it is your responsibility to have a corrected form submitted to our office, before that work has begun.

Violations will result in stop work orders and/or fines.

<p>ELECTRICAL</p> <input checked="" type="checkbox"/>	<p>Print Name <u>TERRY W MUELLER</u> Signature <u>[Signature]</u> Company Name <u>BI-US ELECTRICAL SERVICES, INC.</u> License # <u>EC13002671</u> Phone # <u>754 393 8272</u></p>	<p>None A W E DE</p>
<p>MECHANICAL/ A/C</p> <input type="checkbox"/>	<p>Print Name _____ Signature _____ Company Name _____ License # _____ Phone # _____</p>	<p>None A W E DE</p>
<p>PLUMBING/ GAS</p> <input type="checkbox"/>	<p>Print Name _____ Signature _____ Company Name _____ License # _____ Phone # _____</p>	<p>None A W E DE</p>
<p>ROOFING</p> <input type="checkbox"/>	<p>Print Name _____ Signature _____ Company Name _____ License # _____ Phone # _____</p>	<p>None A W E DE</p>
<p>SHEET METAL</p> <input type="checkbox"/>	<p>Print Name _____ Signature _____ Company Name _____ License # _____ Phone # _____</p>	<p>None A W E DE</p>
<p>FIRE SYSTEM/ SPRINKLER</p> <input type="checkbox"/>	<p>Print Name _____ Signature _____ Company Name _____ License #: _____ Phone # _____</p>	<p>None A W E DE</p>
<p>SOLAR</p> <input type="checkbox"/>	<p>Print Name _____ Signature _____ Company Name: _____ License #: _____ Phone #: _____</p>	<p>None A W E DE</p>
<p>STATE SPECIALTY</p> <input type="checkbox"/>	<p>Print Name _____ Signature _____ Company Name: _____ License #: _____ Phone #: _____</p>	<p>None A W E DE</p>

Ref: F.S. 440.103; ORD 2016-30

NOTICE OF COMMENCEMENT

Clerk's Office Stamp

Inst: 201912029474 Date: 12/18/2019 Time: 9:59AM
Page 1 of 1 B: 1401 P: 1124, P.DeWitt Cason, Clerk of Court
Columbia, County, By: BD
Deputy Clerk

Tax Parcel Identification Number

13-5S-15-00455-003

The UNDERSIGNED hereby gives notice that improvements will be made to certain real property, and in accordance with Section 713.13 of the Florida Statutes, the following information is provided in this NOTICE OF COMMENCEMENT

- 1 Description of property (legal description)
a) Street (job) Address: 11116 SW CR 240, Lake City, FL 32024
2 General description of improvements: Barn
3 Owner information or Lessee information if the Lessee contracted for the improvements
a) Name and address: Edel & Sheme Ojeda, 295 NW Commons Loop, 115-323, Lake City, FL 32055
b) Name and address of fee simple titleholder (if other than owner)
c) Interest in property: Owner
4 Contractor Information
a) Name and address: Owner Builder
b) Telephone No: (352) 988-4870
5 Surety Information (if applicable, a copy of the payment bond is attached)
a) Name and address:
b) Amount of Bond:
c) Telephone No:
6 Lender
a) Name and address:
c) Phone No:
7 Person within the State of Florida designated by Owner upon whom notices or other documents may be served as provided by Section 713.13(1)(a)7, Florida Statutes
a) Name and address:
b) Telephone No:
8 In addition to himself or herself, Owner designates the following person to receive a copy of the Lienor's Notice as provided in Section 713.13(1)(b), Florida Statutes:
a) Name: OF
b) Telephone No:
9 Expiration date of Notice of Commencement (the expiration date will be 1 year from the date of recording unless a different date is specified):

WARNING TO OWNER: ANY PAYMENTS MADE BY THE OWNER AFTER THE EXPIRATION OF THE NOTICE OF COMMENCEMENT ARE CONSIDERED IMPROPER PAYMENTS UNDER CHAPTER 713, PART I, SECTION 713.13, FLORIDA STATUTES, AND CAN RESULT IN YOUR PAYING TWICE FOR IMPROVEMENTS TO YOUR PROPERTY; A NOTICE OF COMMENCEMENT MUST BE RECORDED AND POSTED ON THE JOB SITE BEFORE THE FIRST INSPECTION. IF YOU INTEND TO OBTAIN FINANCING, CONSULT YOUR LENDER OR AN ATTORNEY BEFORE COMMENCING WORK OR RECORDING YOUR NOTICE OF COMMENCEMENT.

STATE OF FLORIDA
COUNTY OF COLUMBIA

Signature of Owner or Lessee, or Owner's or Lessee's Authorized Officer, Director/Partner/Manager

Edel Ojeda

Printed Name and Signatory's Title/Office

The foregoing instrument was acknowledged before me a Florida Notary, this 18th day of December 2019, by Edel Ojeda as self for (Name of Person) (Type of Authority) (name of party on behalf of whom instrument was executed)

Personally Known OR Produced Identification Type FDL

Notary Signature

Notary Stamp or Seal

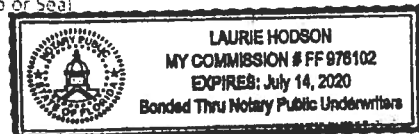

INVOICE

Bi-Us Electrical Services, Inc.

2231 N.E. 40th Court • Lighthouse Point, FL 33064 • (954) 782-7351

DATE

INVOICE

JOB NO.

CONTRACT NO.

TERMS:

TO:

*Bi-Us Electrical
EC13002071
J. Mueller*

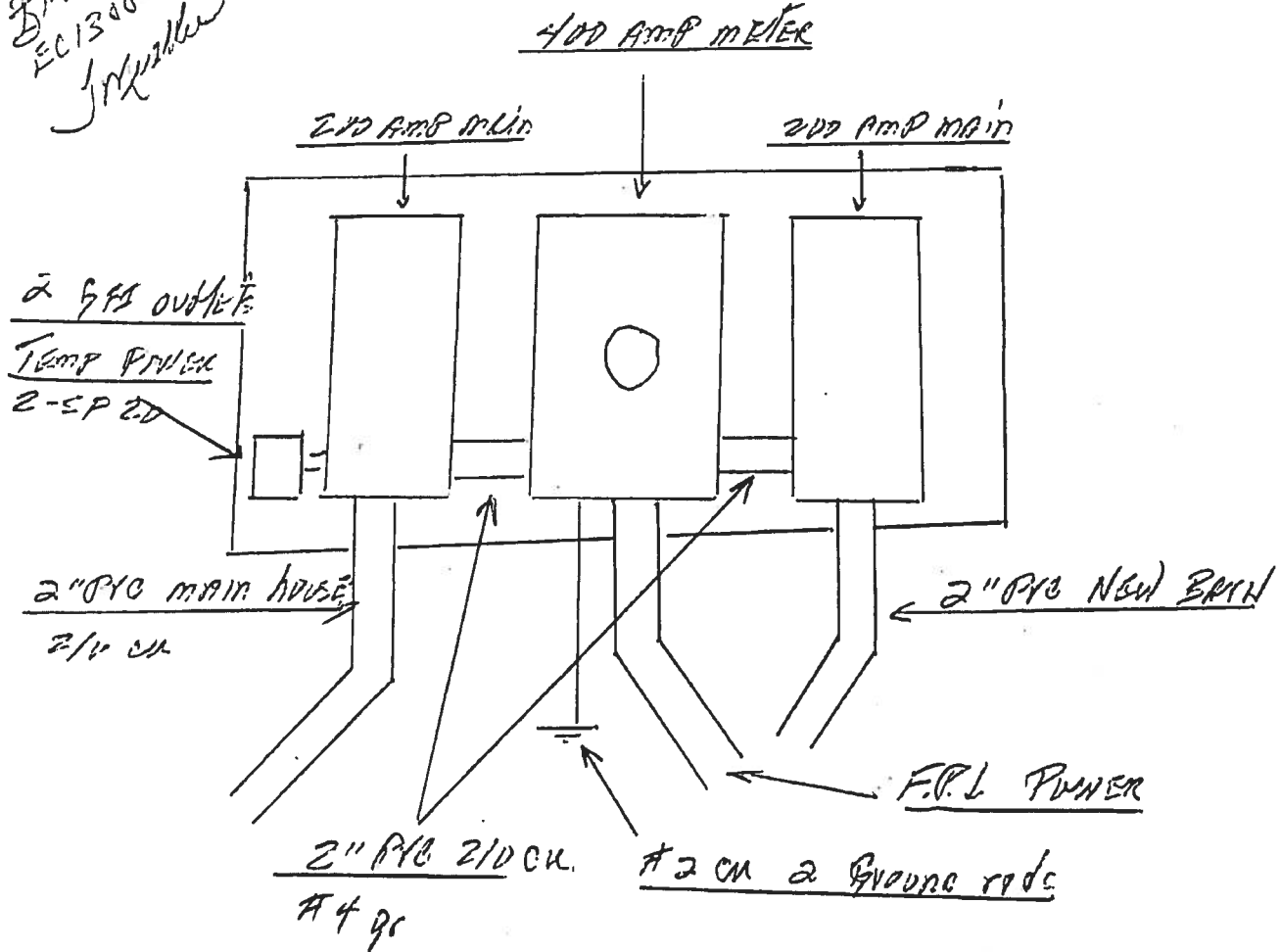



COLUMBIA COUNTY BUILDING DEPARTMENT

135 NE Hernando Ave., Suite B-21

Lake City, FL 32055

Office: 386-758-1008 Fax: 386-758-2160

OWNER BUILDER DISCLOSURE STATEMENT

Florida Statutes Chapter 489.103:

1. I understand that state law requires construction to be done by a licensed contractor and have applied for an owner-builder permit under an exemption from the law. The exemption specifies that I, as the owner of the property listed, may act as my own contractor with certain restrictions even though I do not have a license.
2. I understand that building permits are not required to be signed by a property owner unless he or she is responsible for the construction and is not hiring a licensed contractor to assume responsibility.
3. I understand that, as an owner-builder, I am the responsible party of record on a permit. I understand that I may protect myself from potential financial risk by hiring a licensed contractor and having the permit filed in his or her name instead of my own name. I also understand that a contractor is required by law to be licensed in Florida and to list his or her license numbers on permits and contracts.
4. I understand that I may build or improve a one-family or two-family residence or a farm outbuilding. I may also build or improve a commercial building if the costs do not exceed \$75,000. The building or residence must be for my own use or occupancy. It may not be built or substantially improved for sale or lease, unless I am completing the requirements of a building permit where the contractor listed on the permit substantially completed the project. If a building or residence that I have built or substantially improved myself is sold or leased within 1 year after the construction is complete, the law will presume that I built or substantially improved it for sale or lease, which violates the exemption.
5. I understand that, as the owner-builder, I must provide direct, onsite supervision of the construction.
6. I understand that I may not hire an unlicensed person to act as my contractor or to supervise persons working on my building or residence. It is my responsibility to ensure that the persons whom I employ have the licenses required by law and by county or municipal ordinance.

7. I understand that it is a frequent practice of unlicensed persons to have the property owner obtain an owner-builder permit that erroneously implies that the property owner is providing his or her own labor and materials. I, as an owner-builder, may be held liable and subjected to serious financial risk for any injuries sustained by an unlicensed person or his or her employees while working on my property. My homeowner's insurance may not provide coverage for those injuries. I am willfully acting as an owner-builder and am aware of the limits of my insurance coverage for injuries to workers on my property.

8. I understand that I may not delegate the responsibility for supervising work to a licensed contractor who is not licensed to perform the work being done. Any person working on my building who is not licensed must work under my direct supervision and must be employed by me, which means that I must comply with laws requiring the withholding of federal income tax and social security contributions under the Federal Insurance Contributions Act (FICA) and must provide workers' compensation for the employee. I understand that my failure to follow these laws may subject me to serious financial risk.

9. I agree that, as the party legally and financially responsible for this proposed construction activity, I will abide by all applicable laws and requirements that govern owner-builders as well as employers. I also understand that the construction must comply with all applicable laws, ordinances, building codes, and zoning regulations.

10. I understand that I may obtain more information regarding my obligations as an employer from the Internal Revenue Service, the United States Small Business Administration, the Florida Department of Financial Services, and the Florida Department of Revenue. I also understand that I may contact the Florida Construction Industry Licensing Board at **850-487-1395** or <http://www.myfloridalicense.com/> for more information about licensed contractors.

11. I am aware of, and consent to, an owner-builder building permit applied for in my name and understand that I am the party legally and financially responsible for the proposed construction activity at the following address:

11116 SW County Rd 240, Lake City, FL 32024

(Write in the address of jobsite property)

12. I agree to notify Columbia County Building Department immediately of any additions, deletions, or changes to any of the information that I have provided on this disclosure. Licensed contractors are regulated by laws designed to protect the public. If you contract with a person who does not have a license, the Construction Industry Licensing Board and Department of Business and Professional Regulation may be unable to assist you with any financial loss that you sustain as a result of a complaint. Your only remedy against an unlicensed contractor may be in civil court. It is also important for you to understand that, if an unlicensed contractor or employee of an individual or firm is injured while working on your property, you may be held liable for damages. If you obtain an owner-builder permit and wish to hire a licensed contractor, you will be responsible for verifying whether the contractor is properly licensed and the status of the contractor's workers' compensation coverage.

Florida Statutes Chapter 489.503:

State law requires electrical contracting to be done by licensed electrical contractors. You have applied for a permit under an exemption to that law. The exemption allows you, as the owner of your property, to act as your own electrical contractor even though you do not have a license. You may install electrical wiring for a farm outbuilding or a single-family or duplex residence. You may install electrical wiring in a commercial building the aggregate construction costs of which are under \$75,000. The home or building must be for your own use and occupancy. It may not be built for sale or lease, unless you are completing the requirements of a building permit where the contractor listed on the permit substantially completed the project. If you sell or lease more than one building you have wired yourself within 1 year after the construction is complete, the law will presume that you built it for sale or lease, which is a violation of this exemption. You may not hire an unlicensed person as your electrical contractor. Your construction shall be done according to building codes and zoning regulations. It is your responsibility to make sure that people employed by you have licenses required by state law and by county or municipal licensing ordinances.

An owner of property completing the requirements of a building permit, where the contractor listed on the permit substantially completed the project as determined by the local permitting agency, for a one-family or two family residence, townhome, accessory structure of a one-family or two-family residence or townhome or individual residential condominium unit or cooperative unit. Prior to the owner qualifying for the exemption, the owner must receive approval from the local permitting agency, and the local permitting agency must determine that the contractor substantially completed the project. An owner who qualifies for the exemption under this paragraph is not required to occupy the dwelling or unit for at least 1 year after the completion of the project.

Before a building permit shall be issued, this notarized disclosure statement must be completed and signed by the property owner and returned to the local permitting agency responsible for issuing the permit.

TYPE OF CONSTRUCTION

Single Family Dwelling *Two-Family Residence* *Farm Outbuilding*

Addition, Alteration, Modification or other Improvement *Electrical*

Other Barn

Contractor substantially completed project, of a _____

Commercial, Cost of Construction _____ *for construction of* _____

I Edel Ojeda, have been advised of the above disclosure
(Print Property Owners Name)

statement for exemption from contractor licensing as an owner/builder. I agree to comply with all requirements provided for in Florida Statutes allowing this exception for the construction permitted by Columbia County Building Permit.

Signature: [Signature] Date: 12/18/19
(Signature of property owner)

NOTARY OF OWNER BUILDER SIGNATURE

The above signer is personally known to me or produced identification FIDL

Notary Signature [Signature] Date 12/18/19 (Seal)



SITE PLAN CHECKLIST

- ___ 1) Property Dimensions
- ___ 2) Footprint of proposed and existing structures (including decks), label these with existing addresses
- ___ 3) Distance from structures to all property lines
- ___ 4) Location and size of easements
- ___ 5) Driveway path and distance at the entrance to the nearest property line
- ___ 6) Location and distance from any waters sink holes wetlands, and etc
- ___ 7) Show slopes and or drainage paths
- ___ 8) Arrow showing North direction

SITE PLAN EXAMPLE

Revised 7/1/15

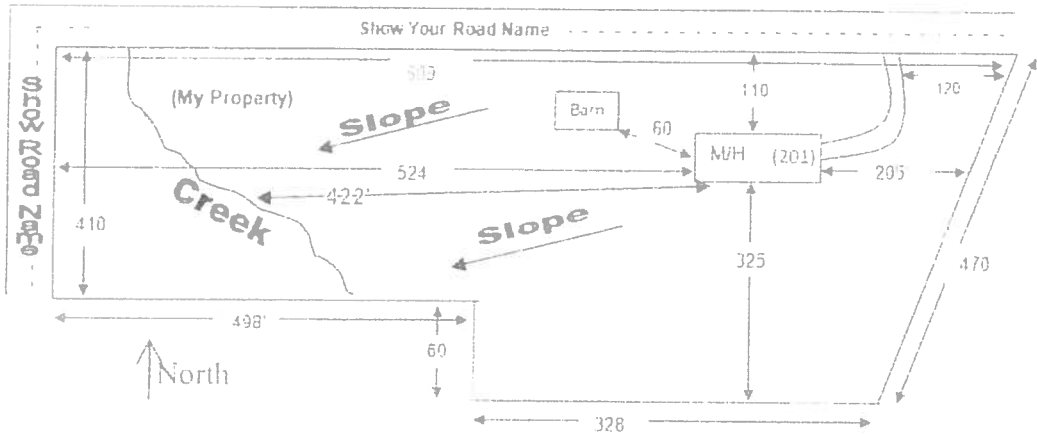

NOTE:
This site plan can be copied and used with the 911 Addressing Dept. application forms.

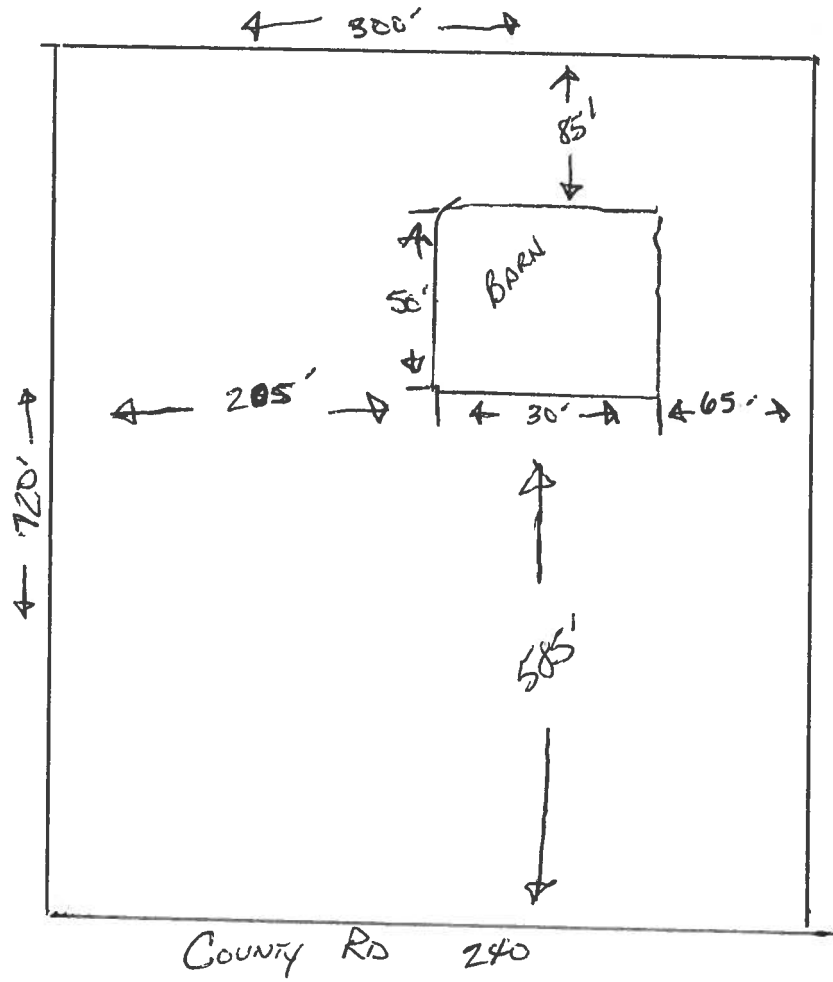

District No. 1 - Ronald Williams
District No. 2 - Rocky Ford
District No. 3 - Bucky Nash
District No. 4 - Toby Witt
District No. 5 - Tim Murphy

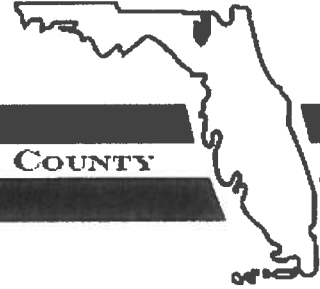

BOARD OF COUNTY COMMISSIONERS • COLUMBIA COUNTY

Address Assignment and Maintenance Document

To maintain the county wide Addressing Policy you must make application for a 9-1-1 Address at the time you apply for a building permit. The established standards for addressing and posting numbers to all principal buildings, dwellings, businesses and industries are contained in Columbia County Ordinance 2001-9. The addressing system is to enable Emergency Services Agencies to locate you in an emergency, and to assist the United States Postal Service and the public in the timely and efficient provision of services to residents and businesses of Columbia County

Date/Time Issued: **12/5/2019 6:19:46 PM**
Address: **11116 SW COUNTY ROAD 240**
City: **LAKE CITY**
State: **FL**
Zip Code: **32024**

Parcel ID: **00455-003**

REMARKS: Address for proposed structure on parcel.

NOTICE: THIS ADDRESS WAS ISSUED BASED ON LOCATION AND ACCESS INFORMATION RECEIVED FROM THE REQUESTER. SHOULD, AT A LATER DATE, THE LOCATION AND/OR ACCESS INFORMATION BE FOUND TO BE IN ERROR OR CHANGED, THIS ADDRESS IS SUBJECT TO CHANGE.

Address Issued By: **Signed:/ Matt Crews**

Columbia County GIS/911 Addressing Coordinator

**COLUMBIA COUNTY
911 ADDRESSING / GIS DEPARTMENT**

263 NW Lake City Ave., Lake City, FL 32055 Telephone: (386) 758-1125
Email: gis@columbiacountyfla.com

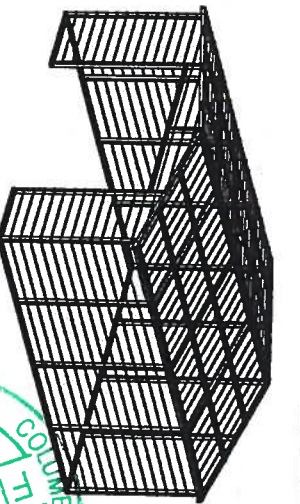
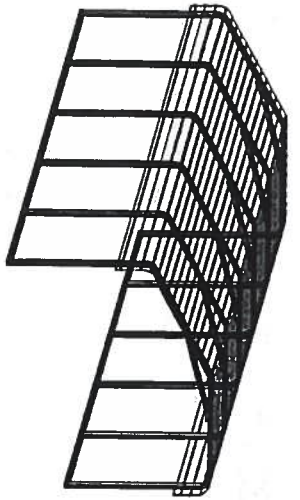

REGULAR / A-FRAME 30'-0" WIDE

CARPORT STYLE BUILDINGS



DESIGN NOTES

1. ALL CONSTRUCTION SHALL BE PROVIDED IN ACCORDANCE WITH IBC 2015, OSHA, AISC 360, AISI 100, ASCE 7-10, AWS D1.3 CODES AND ALL APPLICABLE LOCAL REQUIREMENTS.
2. BASE CONNECTIONS SHALL BE PROVIDED AS SHOWN ON FOUNDATION DETAILS SHEET.
3. ALL MATERIALS IDENTIFIED BY MANUFACTURER NAME MAY BE SUBSTITUTED WITH MATERIAL EQUAL OR EXCEEDING ORIGINAL.
4. ALL SHOP CONNECTIONS SHALL BE WELDED CONNECTIONS.
5. ALL FIELD CONNECTIONS SHALL BE #12XT 5DS (ESR-2196 OR EQ).
6. STEEL SHEATHING SHALL BE 29GA. CORRUGATED GALV. OR PAINTED STEEL - MAIN RIB HT. 3/4" (FY=90KSI) OR EQ.
7. ALL STRUCTURAL LIGHT GAUGE TUBING AND CHANNELS SHALL BE GRADE 50 STEEL.
8. STRUCTURAL TUBE T52 1/2"x2 1/2" - 14GA. IS EQUIVALENT TO T52 1/4"x2 1/4" - 12GA AND EITHER ONE MAY BE USED IN LIEU OF THE OTHER.
9. ALL DESIGN CRITERIA MUST BE INCREASED TO THE NEXT HIGHER INCREMENT BASED ON THE TABLES ON PAGE 4. NO INTERPOLATION IS ALLOWED.

DESIGN CRITERIA

PREVAILING CODE:

FBC 2017 - 6TH EDITION
(IBC 2015)

COVER SHEET

SCHEDULES & MEMBER -

1

USE GROUP:
RISK CATEGORY:

U (CARPORTS, BARN)

SECTIONS

2

1. DEAD LOAD (D)
2. ROOF LIVE/SNOW LOAD (Lr)

D = 4 PSF
Lr = 20 - 61 PSF
(AS PER SNOW LOAD SEE TABLE 4)

FRAME SECTIONS & DETAILS
SPACING SCHEDULES -
& ENCLOSURE NOTES

3

3. SNOW LOAD (S)
GROUND SNOW LOAD
IMPORTANCE FACTOR
THERMAL FACTOR
EXPOSURE FACTOR
ROOF SLOPE FACTOR

S_g = 20 - 90 PSF
I_s = 0.5
C_t = 12
C_e = 10
C_s = 10

PURLIN & GIRT SCHEDULES
SHEATHING OPTIONS
SIDE WALL FRAMING
& OPENINGS

4

4. BASIC WIND SPEED
EXPOSURE
SEISMIC LOAD (E)
DESIGN CATEGORY
IMPORTANCE FACTOR

V_w = 105 - 180 MPH
C
D

END WALL FRAMING
& OPENINGS
CORNER BRACING DETAILS
OPTIONAL LEAN-TO ADDITION
FOUNDATION OPTIONS

5

LOAD COMBINATIONS:

1. D + (Lr OR S)
2. D + (0.6W OR ±0.7E)
3. D + 0.75 (0.6W OR ±0.7E) + 0.75 (Lr OR S)
4. 0.6D + (0.6W OR ±0.7E)

6

7-A, 7-B

6-A, 6-B

9

10

11-A TO 11-D

10

10

10

LEGAL INFORMATION
ANY DUPLICATION OF THIS DRAWING IN WHOLE OR IN PART WITHOUT THE WRITTEN PERMISSION OF THE ENGINEER IS PROHIBITED. ALL PORTIONS OF THE DRAWING SHALL BE CONSIDERED VALID UP TO THE DATE OF ISSUE.

SEAL:

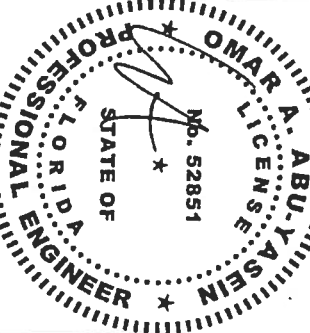

CUSTOMER INFORMATION

OWNER: _____
ADDRESS: _____

DESIGN LOADS

GROUND SNOW: _____
ROOF LIVE LOAD: _____
BASIC WIND SPEED: _____

BUILDING INFORMATION

WIDTH: _____
LENGTH: _____
HEIGHT: _____

FRAME TYPE:
 A-FRAME
 REGULAR
 FULL
 PARTIAL
 OPEN

CERTIFICATION VALIDITY NOTICE

DATE OF EXPIRATION: **JAN 31 2020**
CERTIFICATION ON THESE DRAWINGS IS VALID FOR ONE YEAR FROM DATE OF ISSUE

DRAWING INFORMATION

PROJECT: 30'-0" WIDE BUILDINGS
LOCATION: STATE OF FLORIDA
PROJECT NO.: 356-19-0049
SHEET TITLE: COVER SHEET

SHEET NO.: 1 / 11
DRAWN BY: LAK DATE: 1/21/19
CHECKED BY: OAA DATE: 1/21/19

MANUFACTURED BY:

Real Steel Metal Buildings



A&A ENGINEERING
CIVIL - STRUCTURAL
5911 Renaissance Pkwy, Suite B • Tallahassee, FL 32322
Tel: (904) 999-0955 • Fax: (904) 999-0955
www.aandengineering.com

TABLE 21: MEMBER PROPERTIES

NO.	LABEL	PROPERTY	DETAIL NO.
1	COLUMN POST	2.5" X 2.5" X 14GA TUBE W/ 2.25" X 2.25" X 12GA TUBE INSERT	11
2	ROOF BEAM	2.5" X 2.5" X 14GA TUBE	1
3	BASE RAIL	2.5" X 2.5" X 14GA TUBE	1
4	PEAK BRACE	2.5" X 2.5" X 14GA TUBE	4
5	KNEE BRACES	2.5" X 1.5" 14GA CHANNEL	4
6	CONNECTOR SLEEVE	2.25" X 2.25" X 12GA TUBE	2
7	BASE ANGLE	2.5" X 2.5" X 3" LG. 1/4" ANGLE	10
8	PURLIN	4.25" X 1.5" X 18GA / 14GA HAT CHANNEL	5
9	GIRT	4.25" X 1.5" X 18GA / 14GA HAT CHANNEL	5
10	SHEATHING	29 GA CORRUGATED SHEET	8
11	END WALL POST	2.5" X 2.5" X 14GA TUBE	1
12	DOOR POST	2.5" X 2.5" X 14GA TUBE	1
13	SINGLE HEADER	2.5" X 2.5" X 14GA TUBE	1
14	DOUBLE HEADER	DBL 2.5" X 2.5" X 14GA TUBE	1
15	SERVICE DOOR / WINDOW FRAMING	2.5" X 2.5" X 14GA TUBE	1
16	ANGLE BRACKET	2" X 2" X 2" LG. 14GA ANGLE	7
17	STRAIGHT BRACKET	2" X 2" X 4" LG. 14GA PLATE	6
18	PB SUPPORT	2.5" X 2.5" X 14GA TUBE	1
19	DIAGONAL BRACE	2" X 2" X 14 GA TUBE	3
20	GABLE BRACE	2" X 2" X 14 GA TUBE	3
21	DB BRACKET	6" X 6" X 14GA PLATE	9
22	TRUSS SPACER	2.5" X 2.5" X 14GA TUBE	1
23	ALL FASTENERS	#12 X 1" SELF-DRILL SCREWS (ESR 2196G OR EQ) W/ NEOPRENE/STEEL WASHER	1

TABLE 22: SHEATHING FASTENER SCHEDULE

LOCATION	CORNER PANELS	SIDE LAPS	EDGE LAPS	ELSEWHERE
SPACING	6" C/C	MIN 1	4" C/C	9" C/C

FASTENER TYPE: #12X1" SELF-DRILL SCREWS (ESR 2196G OR EQ) W/ NEOPRENE/STEEL WASHER
 *SEE TYP. SHEATHING FASTENER SCHEDULE DIAGRAM ON PAGE 6.

TABLE 2.3: GAUGE THICKNESS

GAUGE	29	18	14	12
THICKNESS (IN)	0.0735	0.049	0.083	0.109

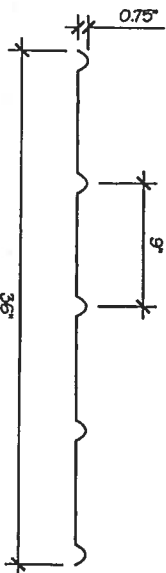

29 GA CORRUGATED SHEATHING
 SCALE: NTS

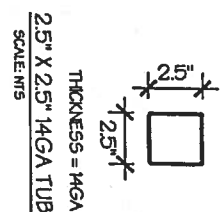

2.5" X 2.5" 14GA TUBE
 THICKNESS = 14GA
 SCALE: NTS

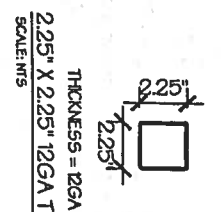

2.25" X 2.25" 12GA TUBE
 THICKNESS = 12GA
 SCALE: NTS

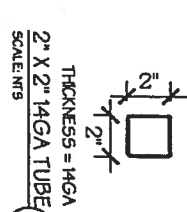

2" X 2" 14GA TUBE
 THICKNESS = 14GA
 SCALE: NTS

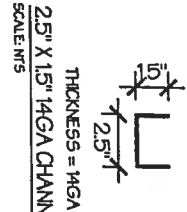

2.5" X 1.5" 14GA CHANNEL
 THICKNESS = 14GA
 SCALE: NTS

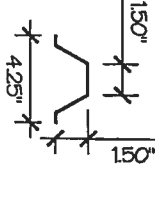

4.25" X 1.5" X 18GA / 14GA HAT CHANNEL
 THICKNESS = 18GA / 14GA
 SCALE: NTS

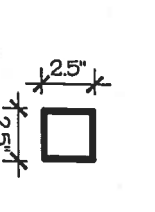

2.5" X 2.5" X 14GA TUBE W/ 2.25" X 2.25" X 12GA TUBE INSERT
 SCALE: NTS
 NOTE: "S" INSERT FULL LENGTH & FIELD BOLT W/ (#23) FASTENERS @ 12" C/C STAGGERED OPPOSITE FACE

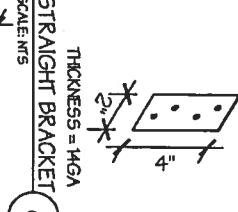

THICKNESS = 14GA
 STRAIGHT BRACKET
 SCALE: NTS

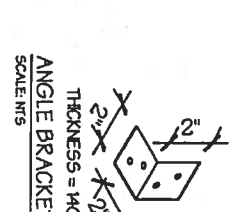

THICKNESS = 14GA
 ANGLE BRACKET
 SCALE: NTS

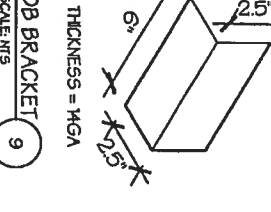

THICKNESS = 14GA
 DB BRACKET
 SCALE: NTS

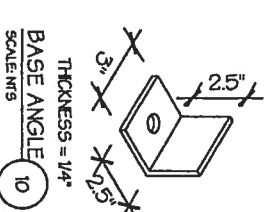

THICKNESS = 1/4"
 BASE ANGLE
 SCALE: NTS

MANUFACTURED BY:

Real Steel Metal
 Buildings



ENGINEERED BY:
A&A ENGINEERING
 CIVIL - STRUCTURAL
 9111 Southwood Place, Suite B • Tallahassee, FL 32303
 Tel: (904) 991-1863 • Fax: (904) 991-0055
 www.aandae.com

DRAWING INFORMATION

PROJECT: 30'-0" WIDE BUILDINGS
 LOCATION: STATE OF FLORIDA
 PROJECT NO.: 356-19-0049
 SHEET TITLE:
 SCHEDULES &
 MEMBER SECTIONS

SHEET NO.: 2 / 11

DRAWN BY: LAK DATE: 1/21/19

CHECKED BY: OVA DATE: 1/21/19

LEGAL INFORMATION

* ANY DUPLICATION OF THIS DRAWING IN WHOLE OR PART IS STRICTLY FORBIDDEN, ANYONE DOING SO WILL BE PROSECUTED UNDER THE FULL ENFORCEMENT OF THE LAW. - DRAWINGS VALID UP TO 1 YEAR FROM DATE OF ISSUE.

SCALE:

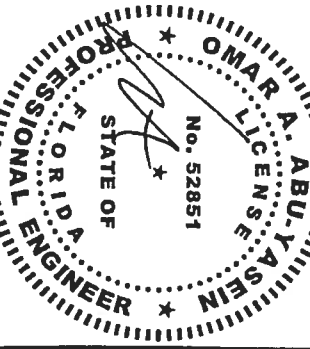

DATE EXPIRES: 02/28/2021
 DATE SIGNED: JAN 22 2019

MANUFACTURED BY:

Real Steel Metal Buildings



A&A ENGINEERING
 CIVIL - STRUCTURAL
 5911 Resoundance Place, Suite B, Ft. Toledo, OH 43083
 TEL: 419-297-1983 • FAX: 419-297-0555
 WWW.A&AENGINEERING.COM

ENGINEERED BY:

DRAWING INFORMATION
 PROJECT: 30'-0" WIDE BUILDINGS
 LOCATION: STATE OF FLORIDA
 PROJECT NO.: 356-19-0049
 SHEET TITLE: FRAME SECTIONS & DETAILS
 SHEET NO.: 3 / 11

DRAWN BY: LAK DATE: 1/21/19
 CHECKED BY: OAA DATE: 1/21/19

LEGAL INFORMATION

* ANY DUPLICATION OF THIS DRAWING IN WHOLE OR PART IS STRICTLY FORBIDDEN, AND NOE DOWNSHIFT OR REPRODUCTION OF ANY PART OF THIS DRAWING WITHOUT THE WRITTEN PERMISSION OF THE ENGINEER IS STRICTLY FORBIDDEN.
 DRAWINGS VOID UP TO 1 YEAR FROM DATE OF ISSUE.

SEAL:

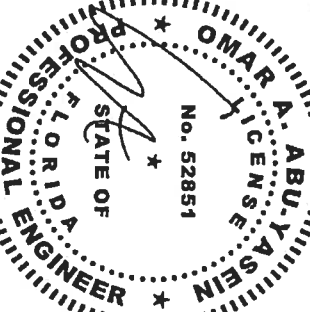

DATE EXPIRES: 02/28/2021
 DATE SIGNED: JAN 22 2019

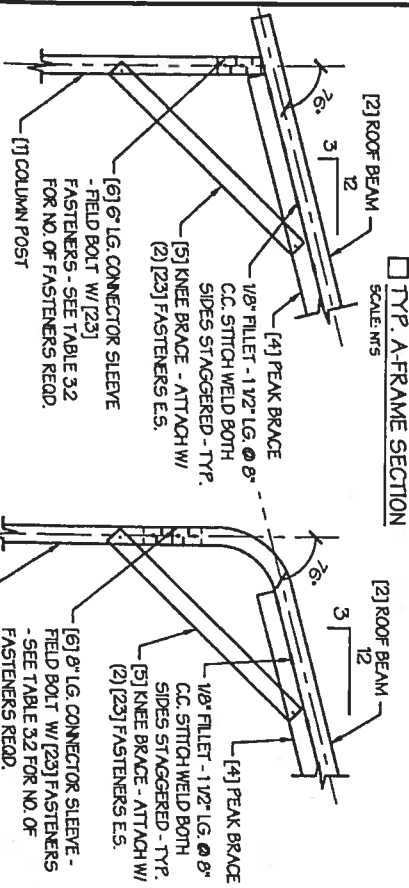
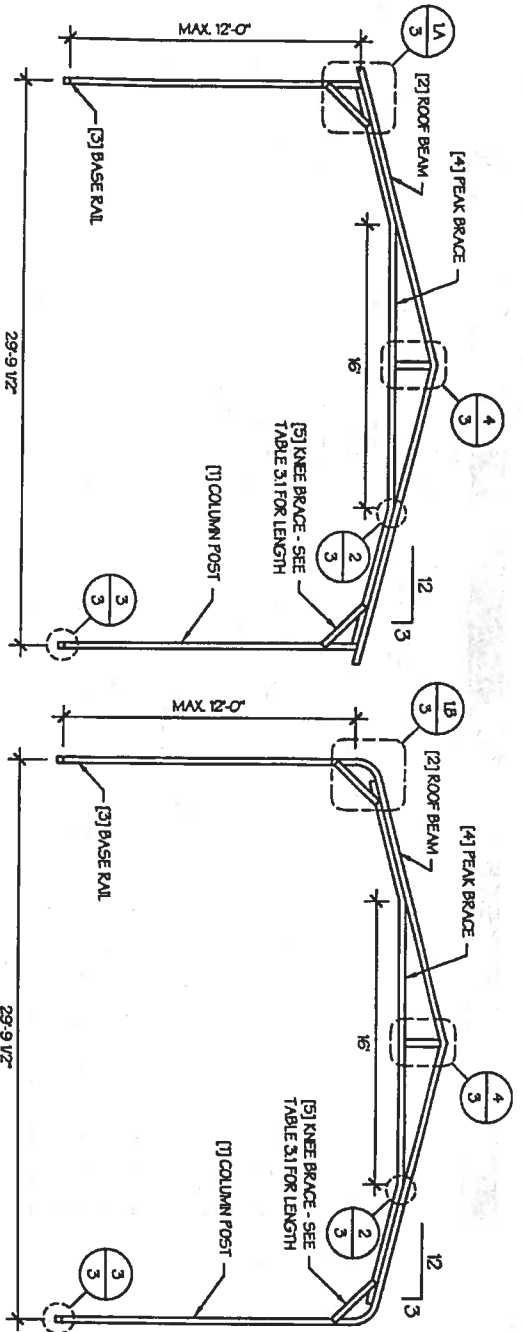
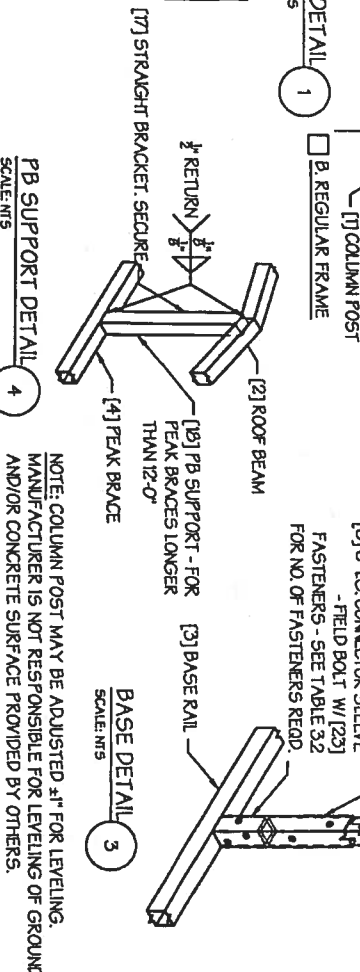

TABLE 3.1: KNEE BRACE SCHEDULE

EAVE HEIGHT	KNEE BRACE LENGTH
□ UP TO 8'	24"
□ 9 TO 12'	36"

TABLE 3.2 FASTENER SCHEDULE

WIND SPEED (MPH)	NO. OF FASTENERS
□ 105 TO 125	4
□ 130 TO 155	6
□ 160 TO 180	8



NOTE: COLUMN POST MAY BE ADJUSTED ±1" FOR LEVELING. MANUFACTURER IS NOT RESPONSIBLE FOR LEVELING OF GROUND AND/OR CONCRETE SURFACE PROVIDED BY OTHERS.

TABLE 5.1: PURLIN SPACING SCHEDULE

GROUND / ROOF LINE LOAD (PSF)	14GA HAT CHANNEL PURLIN										18GA HAT CHANNEL PURLIN									
	105	115	130	140	155	165	180	105	115	130	140	155	165	180						
30/20	54	48	42	36	30	24	24	36	30	24	18	18	12	12						
40/27	42	42	36	30	24	24	24	30	30	24	18	18	12	12						
50/34	40	40	36	30	24	24	24	30	24	24	18	18	12	12						
60/41	36	36	36	36	30	24	24	18	18	18	18	12	12	12						
70/47	32	32	32	32	30	24	24	18	18	18	18	12	12	12						
80/54	30	30	30	30	30	24	24	18	18	18	18	12	12	12						
90/61	24	24	24	24	24	24	24	12	12	12	12	12	12	12						
30/20	54	48	42	36	30	24	24	48	36	30	24	18	18	12						
40/27	42	42	36	30	24	24	24	42	36	30	24	18	18	12						
50/34	40	40	36	30	24	24	24	42	36	30	24	18	18	12						
60/41	36	36	36	36	30	24	24	30	30	24	18	18	12	12						
70/47	32	32	32	32	30	24	24	24	24	24	18	18	12	12						
80/54	30	30	30	30	30	24	24	18	18	18	18	12	12	12						
90/61	30	30	30	30	30	30	30	18	18	18	18	12	12	12						
30/20	54	48	42	36	30	24	24	54	48	36	30	24	18	12						
40/27	42	42	36	30	24	24	24	42	36	30	24	18	18	12						
50/34	40	40	36	30	24	24	24	40	36	30	24	18	18	12						
60/41	36	36	36	36	30	24	24	36	36	30	24	18	18	12						
70/47	32	32	32	32	30	24	24	30	30	24	18	18	12	12						
80/54	30	30	30	30	30	24	24	24	24	24	18	18	12	12						
90/61	30	30	30	30	30	30	30	24	24	24	18	18	12	12						
30/20	54	48	42	36	30	24	24	54	48	42	36	30	24	18						
40/27	42	42	36	30	24	24	24	42	42	36	30	24	18	12						
50/34	40	40	36	30	24	24	24	40	40	36	30	24	18	12						
60/41	36	36	36	36	30	24	24	36	36	36	30	24	18	12						
70/47	32	32	32	32	30	24	24	32	32	32	24	18	18	12						
80/54	32	32	32	32	30	24	24	32	32	32	24	18	18	12						
90/61	30	30	30	30	30	24	24	32	32	32	24	18	18	12						
30/20	54	48	42	36	30	24	24	54	48	42	36	30	24	18						
40/27	42	42	36	30	24	24	24	42	42	36	30	24	18	12						
50/34	40	40	36	30	24	24	24	40	40	36	30	24	18	12						
60/41	36	36	36	36	30	24	24	36	36	36	30	24	18	12						
70/47	32	32	32	32	30	24	24	32	32	32	24	18	18	12						
80/54	32	32	32	32	30	24	24	32	32	32	24	18	18	12						
90/61	30	30	30	30	30	24	24	32	32	32	24	18	18	12						
30/20	54	48	42	36	30	24	24	54	48	42	36	30	24	18						
40/27	42	42	36	30	24	24	24	42	42	36	30	24	18	12						
50/34	40	40	36	30	24	24	24	40	40	36	30	24	18	12						
60/41	36	36	36	36	30	24	24	36	36	36	30	24	18	12						
70/47	32	32	32	32	30	24	24	32	32	32	24	18	18	12						
80/54	32	32	32	32	30	24	24	32	32	32	24	18	18	12						
90/61	30	30	30	30	30	24	24	32	32	32	24	18	18	12						

- NOTES:
 1. PURLIN SPACING UNITS ARE IN INCHES.
 2. FRAME SPACING NEEDS TO BE DETERMINED FROM TABLE 4.

TABLE 5.2: GIRT SPACING SCHEDULE

FRAME SPACING	WIND SPEED (MPH)									
	105	115	130	140	155	165	180			
05'-0"	60	48	36	30	24	24	18			
04'-6"	60	60	48	42	36	30	24			
04'-0"	60	60	54	54	42	36	30			
03'-6"	60	60	54	54	48	42	42			
02'-0" TO 3'-0"	60	60	54	54	48	42	42			

- NOTES:
 1. GIRT SPACING UNITS ARE IN INCHES.
 2. THIS SCHEDULE IS TO BE USED FOR BOTH 14GA AND 18 GA PURLINS.
 3. FRAME SPACING NEEDS TO BE DETERMINED FROM TABLE 4.

MANUFACTURED BY:

Real Steel Metal Buildings



A&A ENGINEERING
 CIVIL - STRUCTURAL
 9111 Resounders Pkwy, Suite B • Toledo, OH 43625
 Tel: 419-592-1983 • Fax: 419-592-0455
 www.aandae.com

DRAWING INFORMATION

PROJECT: 30'-0" WIDE BUILDINGS
 LOCATION: STATE OF FLORIDA
 PROJECT NO.: 356-19-0049
 SHEET TITLE: PURLIN & GIRT SPACING SCHEDULES
 SHEET NO.: 5 / 11
 DRAWN BY: LAK DATE: 1/21/19
 CHECKED BY: OAA DATE: 1/21/19

LEGAL INFORMATION

- ANY REPLICATION OF THIS DRAWING IN WHOLE OR PART IS STRICTLY PROHIBITED. ANYONE DOING SO WILL BE PROSECUTED UNDER THE FULL EXTENT OF THE LAW. DRAWINGS VALID UP TO 1 YEAR FROM DATE OF ISSUE.

SEAL:

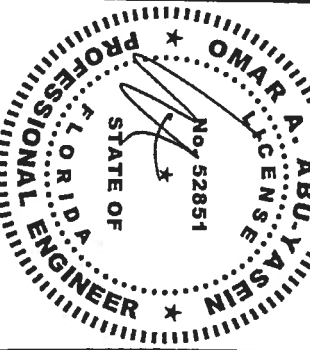

DATE EXPIRES: 02/28/2021
 DATE SIGNED: JAN 22 2019

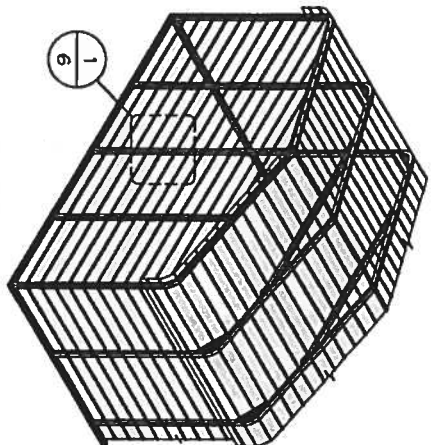

TYP. HORIZONTAL SHEATHING
SCALE: NTS

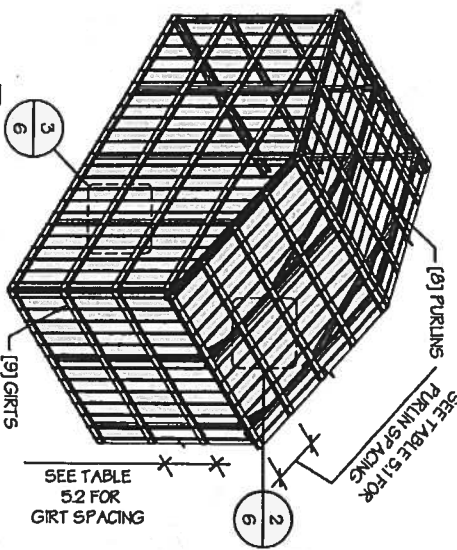

TYP. VERTICAL SHEATHING
SCALE: NTS

- GENERAL SHEATHING NOTES:**
1. REGULAR STYLE BUILDINGS CAN ONLY HAVE HORIZONTAL SHEATHING ON ROOF AND WALLS. A-FRAME STYLE BUILDINGS CAN HAVE ANY COMBINATION OF HORIZONTAL OR VERTICAL SHEATHING ON ROOFS AND WALLS.
 2. BOTH HORIZONTAL AND VERTICAL ROOF SHEATHING CAN HAVE MAX 6" OVERHANG.
 3. USING VERTICAL SHEATHING MAY ALLOW FOR GREATER FRAME SPACING. SEE NOTE 2 UNDER TABLE 4.

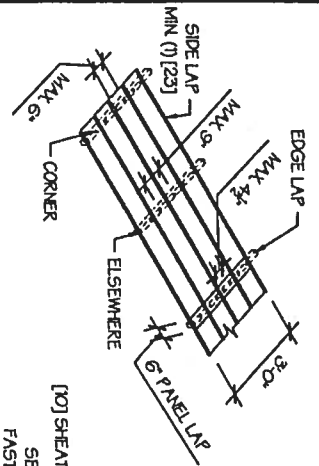

TYP. SHEATHING FASTENER SCHEDULE
SCALE: NTS

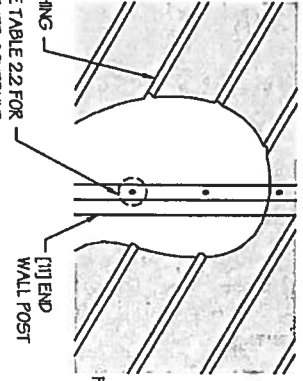

TYP. HORIZONTAL SHEATHING DETAIL
SCALE: NTS

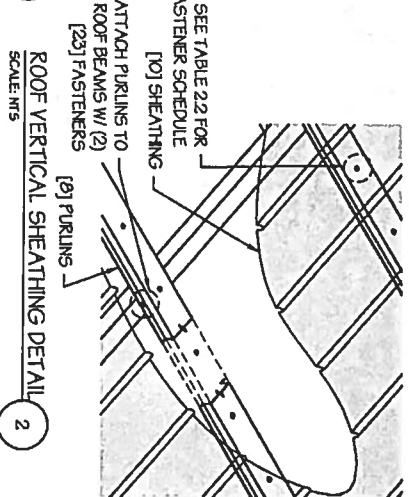

ROOF VERTICAL SHEATHING DETAIL
SCALE: NTS

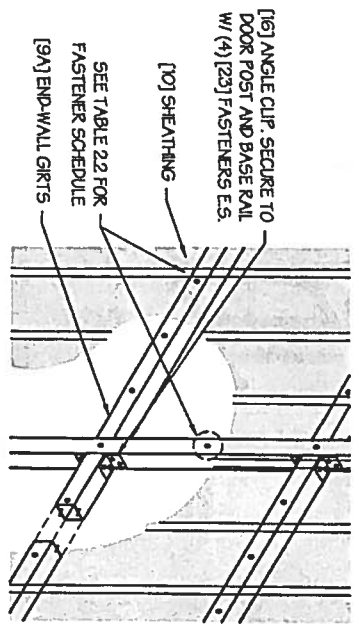

WALL VERTICAL SHEATHING - TUBE DETAIL
SCALE: NTS

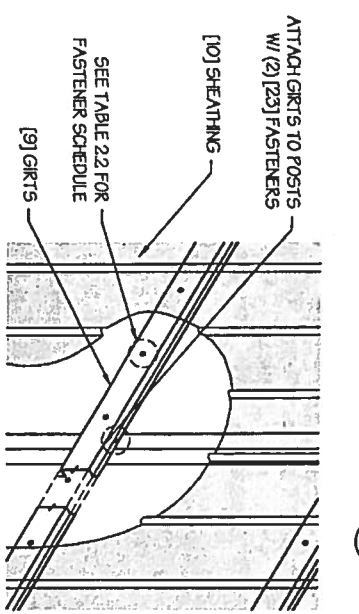

WALL VERTICAL SHEATHING - HAT CHANNEL DETAIL
SCALE: NTS

MANUFACTURED BY:

Real Steel Metal Buildings



A&A ENGINEERING
CIVIL - STRUCTURAL
5911 Beardslee Road, Suite B • Trask, OH 43083
Tel: 419.991.1933 • Fax: 419.997.9855
www.aandae.com

ENGINEERED BY:

DRAWING INFORMATION

PROJECT: 30'-0" WIDE BUILDINGS
LOCATION: STATE OF FLORIDA
PROJECT NO.: 356-19-0049
SHEET TITLE: SHEATHING OPTIONS & DETAILS
SHEET NO.: 6 / 11
DRAWN BY: LAK DATE: 1/21/19
CHECKED BY: OAA DATE: 1/21/19

LEGAL INFORMATION

* ANY DUPLICATION OF THIS DRAWING IN WHOLE OR PART IS STRICTLY PROHIBITED, AND ONE DOING SO WILL BE PROSECUTED TO THE FULL EXTENT OF THE LAW. DRAWINGS VALID UP TO 1 YEAR FROM DATE OF ISSUE.

SEAL:

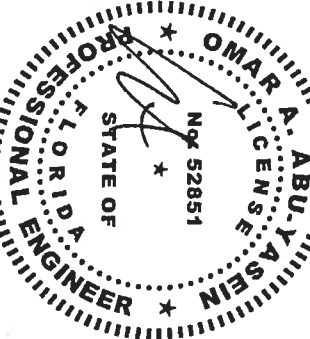

DATE EXPRES: 02/28/2021
DATE SIGNED: JAN 22 2019

MANUFACTURED BY:

Real Steel Metal Buildings



AAA ENGINEERING
CIVIL - STRUCTURAL
5911 Renaissance Pkwy, Suite B • Tallahassee, FL 32309
Tel. 904.999.1983 • Fax. 904.999.0655
www.aaa-engineering.com

ENGINEERED BY:

DRAWING INFORMATION

PROJECT: 30'-0" WIDE BUILDINGS

LOCATION: STATE OF FLORIDA

PROJECT NO.: 356-19-0049

SHEET TITLE:

SIDE WALL FRAMING & OPENINGS

SHEET NO.: 7-A / 11

DRAWN BY: LAK DATE: 1/21/19

CHECKED BY: OMA DATE: 1/21/19

LEGAL INFORMATION

- ANY DUPLICATION OF THIS DRAWING IN WHOLE OR PART IS STRICTLY PROHIBITED. ANYONE DOING SO WILL BE PROSECUTED UNDER THE FULL EXTENT OF THE LAW. - DRAWINGS VALID UP TO 1 YEAR FROM DATE OF ISSUE.

SEAL:

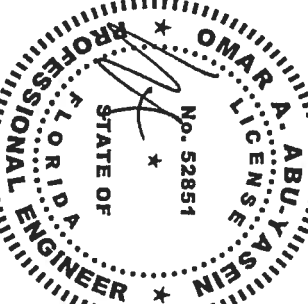

DATE EXPIRES: 02/28/2021

DATE SIGNED: JAN 22 2019

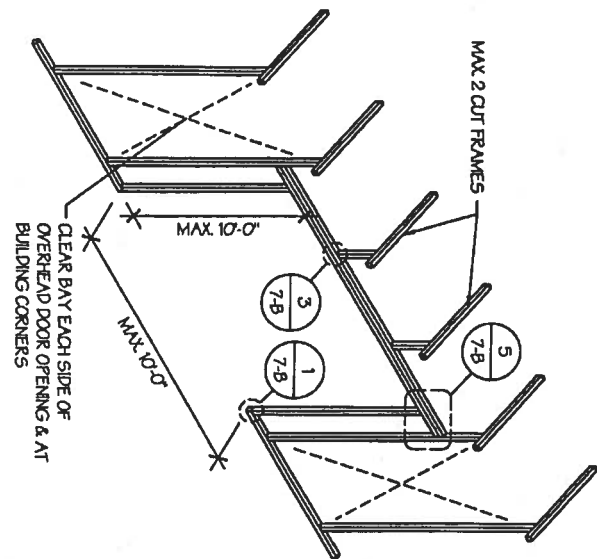

SIDE WALL OVERHEAD DOOR OPENINGS
SCALE: NTS

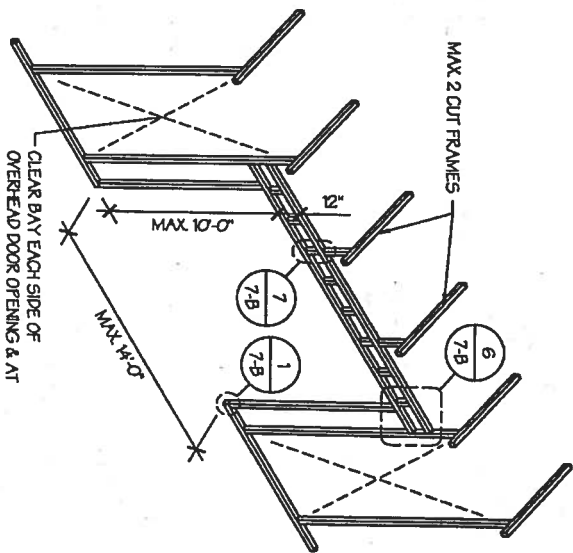

SIDE WALL OVERHEAD DOOR OPENINGS WITH TRUSS STYLE HEADER
SCALE: NTS

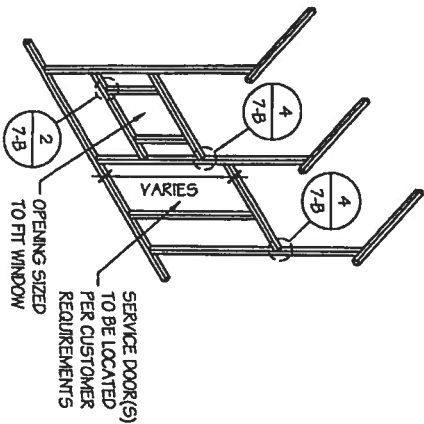

SIDE WALL SERVICE DOOR / WINDOW OPENINGS
SCALE: NTS

SIDE WALL FRAMING NOTES:

1. TRUSS-STYLE HEADERS ARE REQUIRED FOR WHERE THE GROUND SNOW LOAD IS 40 PSF OR GREATER.
2. DESIGN AND DETAILS SHOWN HERE ARE APPLICABLE TO BOTH REGULAR AND A-FRAME STYLE BUILDINGS.
3. MAX. HEIGHT OF SIDE WALL OVERHEAD DOOR OPENINGS IS 2 FT LESS THAN THE EAVE HEIGHT.
4. OVERHEAD DOOR OPENINGS CANNOT CUT THROUGH MORE THAN 2 FULL FRAMES.
5. MIN. 1 CLEAR BAY MUST BE MAINTAINED BETWEEN ANY 2 OVERHEAD DOOR OPENINGS. A CLEAR BAY IS A SPACE BETWEEN TWO FRAMES THAT HAS NO OVERHEAD DOOR OPENINGS.
6. MIN. 1 CLEAR BAY MUST ALSO BE MAINTAINED FROM THE BUILDING CORNERS.
7. SERVICE DOORS AND WINDOWS CAN BE PLACED IN CLEAR BAYS OR ANY WHERE ELSE AS NEEDED.

MANUFACTURED BY:

Real Steel Metal
Buildings



A&A ENGINEERING
CIVIL - STRUCTURAL
5911 Rembrandt Place, Suite B • Toledo, OH 43623
Tel: 419-591-1983 • Fax: 419-592-0955
www.aandaeengineering.com

DRAWING INFORMATION

PROJECT: 30'-0" WIDE BUILDINGS
LOCATION: STATE OF FLORIDA
PROJECT NO.: 356-19-0049
SHEET TITLE:
SIDE WALL FRAMING
DETAILS

SHEET NO.: 7-B / 11

DRAWN BY: LAK DATE: 1/21/19

CHECKED BY: OAA DATE: 1/21/19

LEGAL INFORMATION

- ANY DUPLICATION OF THIS DRAWING IN WHOLE OR PART IS STRICTLY FORBIDDEN. ANYONE DOING SO WILL BE PROSECUTED UNDER THE FULL EXTENT OF THE LAW. DRAWINGS VALID UP TO 1 YEAR FROM DATE OF ISSUE.

SEAL:

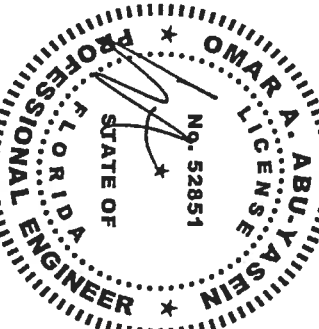

DATE EXPIRES: 02/28/2021
DATE SIGNED: JAN 22 2019

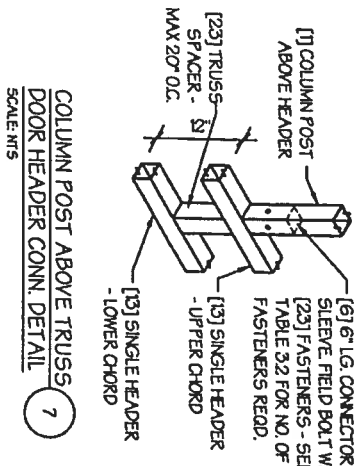
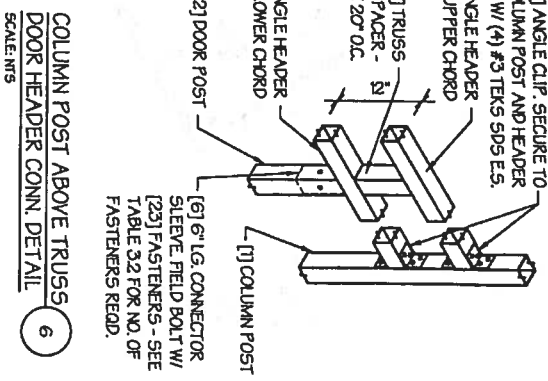
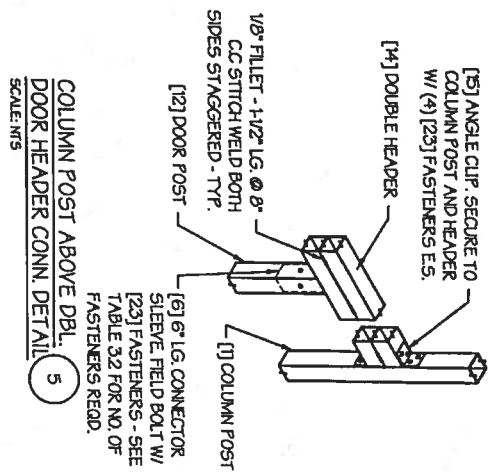
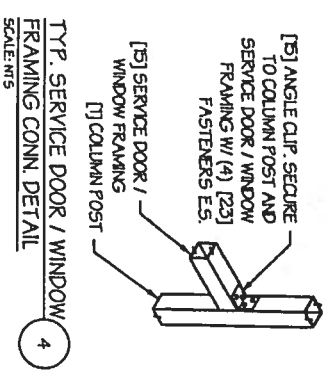
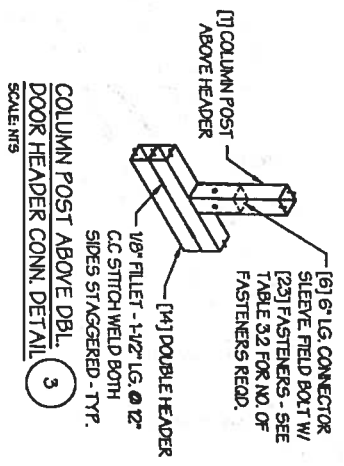
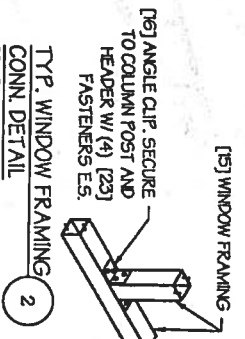
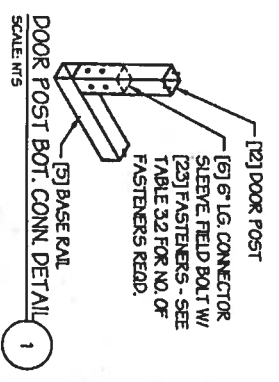

MANUFACTURED BY:

Real Steel Metal Buildings



A&A ENGINEERING
CIVIL - STRUCTURAL
3911 Resoundance Park, Suite B • Toledo, OH 43623
Tel: 419-292-1983 • Fax: 419-292-8855
www.aandengineering.com

DRAWING INFORMATION

PROJECT: 30'-0" WIDE BUILDINGS
LOCATION: STATE OF FLORIDA
PROJECT NO.: 356-19-0049
SHEET TITLE:
END WALL FRAMING DETAILS

SHEET NO.: 8-B / 11

DRAWN BY: LAK DATE: 1/21/19
CHECKED BY: OAA DATE: 1/21/19

LEGAL INFORMATION

- ANY DUPLICATION OF THIS DRAWING IN WHOLE OR PART IS STRICTLY PROHIBITED. ANYONE DOING SO WILL BE PROSECUTED UNDER THE FULL EXTENT OF THE LAW. DRAWINGS VALID UP TO 1 YEAR FROM DATE OF ISSUE.

SCALE:

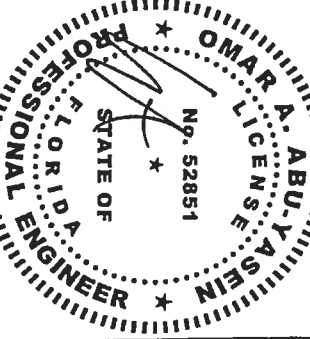

DATE EXPIRES: 02/28/2021
DATE SIGNED: JAN 22 2019

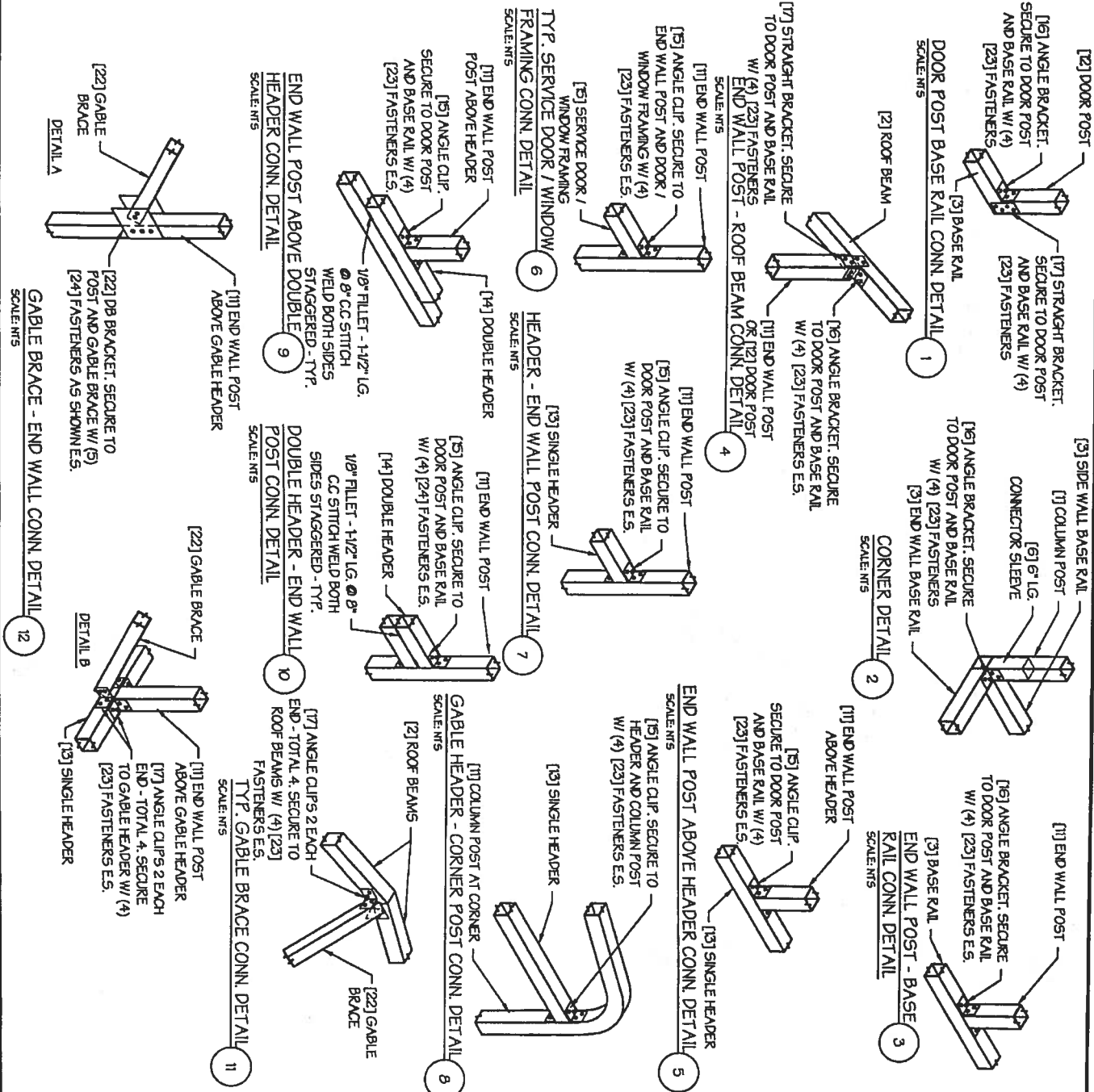

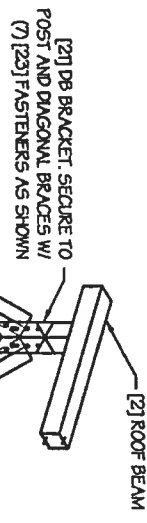

DIAGONAL BRACE TOP CORNER CONN. DETAIL. 1
SCALE: NTS

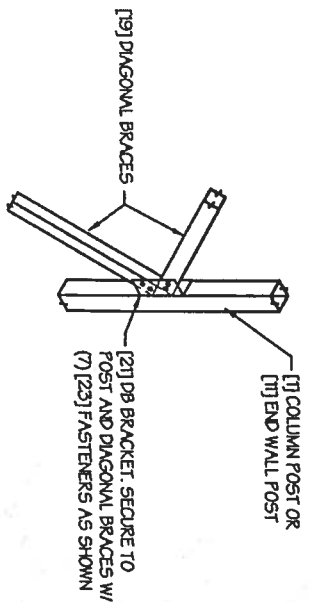

DIAGONAL BRACE - POST CONN. DETAIL. 2
SCALE: NTS

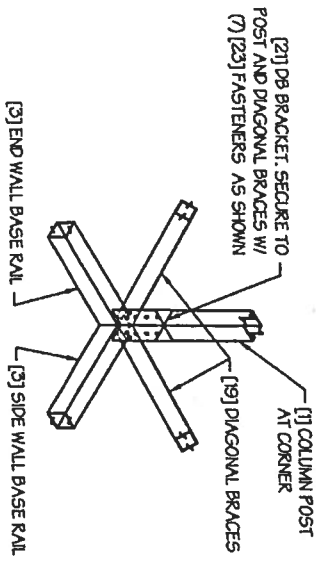

DIAGONAL BRACE BOT. CORNER CONN. DETAIL. 3
SCALE: NTS

* INSIDE VIEW SHOWN FOR CLARITY

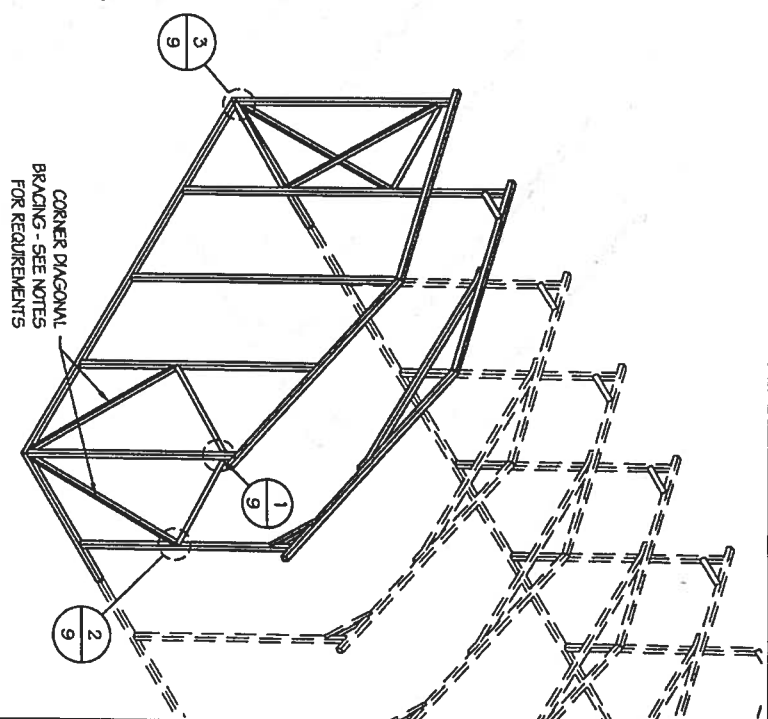

DIAGONAL BRACING AT CORNERS
SCALE: NTS

CORNER BRACING NOTES:

1. DIAGONAL BRACING AT BUILDING CORNERS IS REQUIRED FOR ALL BUILDINGS IN LOCATIONS WHERE WIND SPEED IS 140 MPH OR GREATER.
2. IF CORNER BRACING IS REQUIRED BUT THE BUILDING IS MISSING ONE OR MORE END WALLS THEN THE BUILDING MUST BE DESIGNED AS AN OPEN BUILDING AND SIDE WALL DIAGONAL BRACING IS REQUIRED (USE SPACING FOR OPEN BUILDING IN TABLE 4.1).
3. DIAGONAL BRACING IS ALSO REQUIRED ON THE CORNERS ON THE SIDE WALLS WHEN THE ADJACENT END WALL IS PARTIALLY ENCLOSED.

MANUFACTURED BY:
Real Steel Metal Buildings



A&A ENGINEERING
CIVIL & STRUCTURAL
5911 Redwood Dr., Suite B, Trilake, OH 43023
Tel: 419-929-1868 • Fax: 419-929-0855
www.aandae.com

DRAWING INFORMATION
PROJECT: 30'-0" WIDE BUILDINGS
LOCATION: STATE OF FLORIDA
PROJECT NO.: 356-19-0049
SHEET TITLE: CORNER BRACING DETAILS
SHEET NO.: 9 / 11

DRAWN BY: LAK DATE: 1/21/19
CHECKED BY: OMA DATE: 1/21/19

LEGAL INFORMATION

ANY DUPLICATION OF THIS DRAWING IN WHOLE OR PART IS STRICTLY PROHIBITED. ANYONE DOING SO WILL BE PROSECUTED UNDER THE FULL STRIKE OF THE LAW. DRAWINGS VALID UP TO 1 YEAR FROM DATE OF ISSUE.

SEAL:

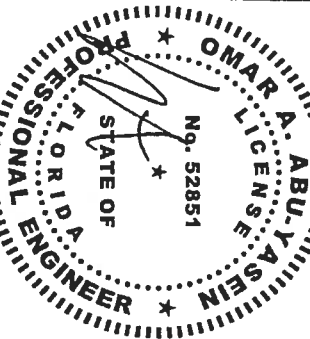

DATE EXPIRES: 02/28/2021
DATE SIGNED: JAN 22 2019

MANUFACTURED BY:

Real Steel Metal Buildings



A & A ENGINEERING
CIVIL - STRUCTURAL
3911 Redwood Place, Suite B • Toledo, OH 43623
Tel. 419-592-1983 • Fax. 419-592-9535
www.a-a-engineering.com

ENGINEERED BY:

DRAWING INFORMATION

PROJECT: 30'-0" WIDE BUILDINGS

LOCATION: STATE OF FLORIDA

PROJECT NO.: 356-19-0049

OPTIONAL LEAN-TO ADDITION

SHEET TITLE:

SHEET NO.: 10 / 11

DRAWN BY: LAK DATE: 1/21/19

CHECKED BY: OAA DATE: 1/21/19

LEGAL INFORMATION

- ANY DUPLICATION OF THIS DRAWING IN WHOLE OR PART IS STRICTLY FORBIDDEN. ANYONE DOING SO WILL BE PROSECUTED UNDER THE FULL EXTENT OF THE LAW. - DRAWINGS VALID UP TO 1 YEAR FROM DATE OF ISSUE.

SEAL:

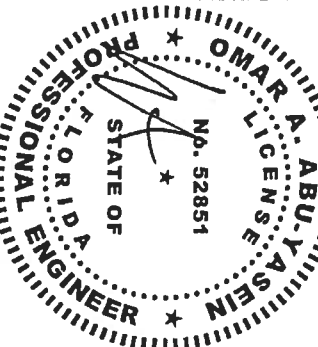

DATE EXPIRES: 02/28/2021

DATE SIGNED: JAN 22 2019

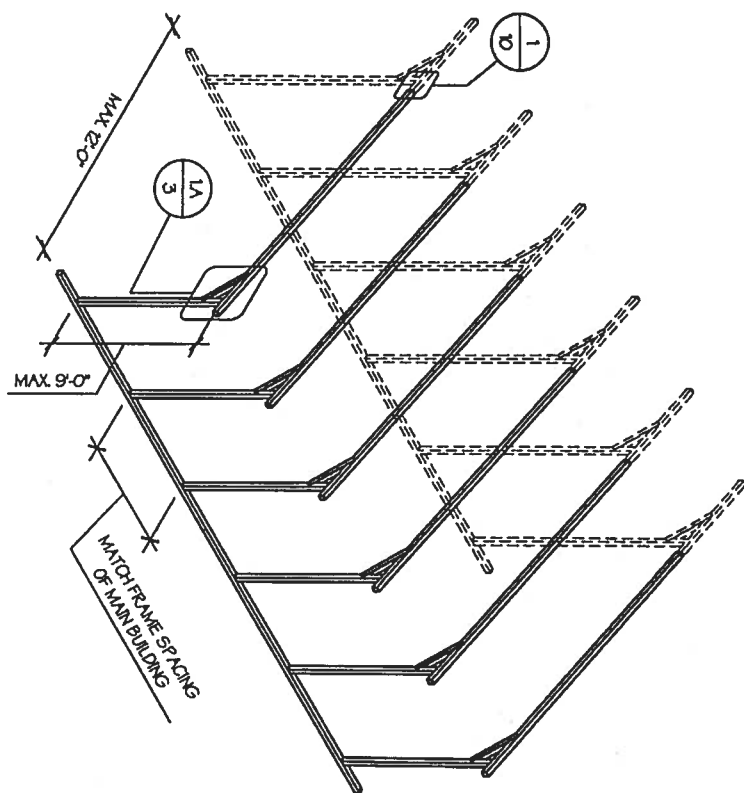

OPTIONAL LEAN-TO ADDITION
SCALE: NTS

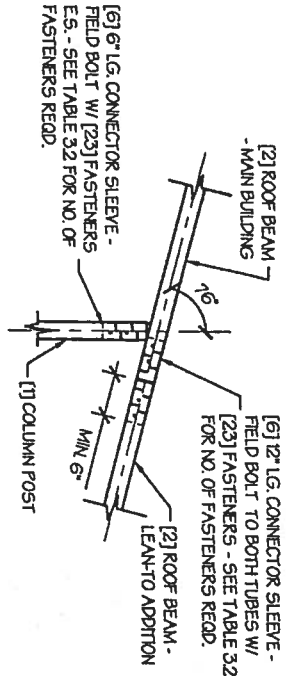

LEAN-TO ATTACHMENT DETAIL
SCALE: NTS
1

- LEAN-TO ADDITION NOTES:**
- LEAN-TO ADDITIONS CAN BE ADDED ON EITHER OR BOTH SIDES OF THE BUILDING.
 - ROOF SLOPE, PURLIN, GIRT AND FRAME SPACING OF THE ADDITION HAVE TO MATCH THAT OF THE MAIN STRUCTURE.
 - IF THE LEAN-TO ADDITION IS "OPEN" (BOTH END WALLS OR SIDE WALL IS NOT ENCLOSED), THE DESIGN OF THE MAIN BUILDING HAS TO USE THE FRAME SPACING OF AN OPEN BUILDING FROM TABLE 4.

CONCRETE SLAB FOUNDATION NOTES:

- DESIGNS SHOWN ON THIS SHEET ARE FOR CONCRETE SLAB FOUNDATION. ANY OF THE FOUNDATIONS SHOWN ON SHEETS 11-A THRU D CAN BE USED. CONCRETE ANCHORS SHALL BE LOCATED NEXT TO EVERY POST AND ON EITHER SIDE OF OPENINGS. TWO ANCHORS SHALL BE INSTALLED AT CORNERS OF ENCLOSED BUILDINGS WITH END WALLS - ONE ON EACH BASE RAIL IN LOCATIONS REQUIRING TWO ANCHORS DUE TO WIND. ONE ANCHOR IS TO BE ON EACH SIDE OF THE COLUMN POST.
- ANCHORS IN CLOSE PROXIMITY TO EACH OTHER MUST HAVE A MIN. 4" SPACING.
- MIN. NUMBER OF CONCRETE ANCHORS PER POST SHALL BE AS SHOWN IN TABLE 11-A2.
- THE SIZE OF THE SLAB SHALL BE THE SIZE (WIDTH AND LENGTH) OF THE BUILDING PLUS 5" FOR HGA MATERIAL AND 5" FOR I2GA MATERIAL. DEPTH OF SLAB TURN DOWN FOOTING SHALL BE GREATER THAN FROST DEPTH SPECIFIED PER LOCAL CODE.
- CONTROL JOINTS SHALL BE PLACED 50 AS TO LIMIT MAX. SLAB SPANS TO 20' IN EACH DIRECTION.
- ASSUMED SOIL BEARING CAPACITY IS TO BE A MIN. OF 1500 PSF.
- CONCRETE STRENGTH TO BE A MIN. OF 2500 PSI @ 28 DAYS.

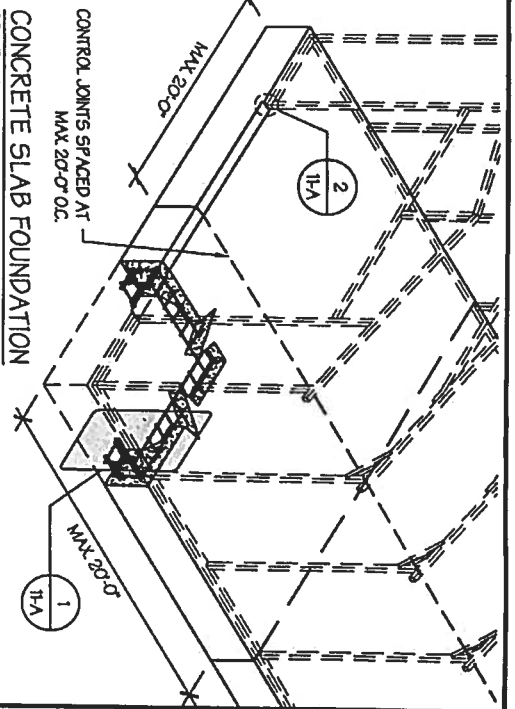
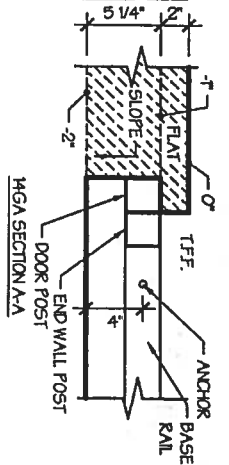

TABLE 11-A2: CONCRETE SLAB ANCHOR SCHEDULE

ENCLOSURE	WIND SPEED (MPH)	ANCHOR SIZE/NUMBER
ENCLOSED	D105 TO 130	(1) 1/2"Ø X 7"
ENCLOSED	D140 TO 190	(2) 1/2"Ø X 7"
OPEN	D 105	(1) 1/2"Ø X 7"
OPEN	D115 TO 190	(2) 1/2"Ø X 7"

NOTES:

- ANCHORS ARE TO BE CONCRETE WEDGE OR EXP ANCHOR ANCHORS.
- MIN. EMBEDMENT DEPTH TO BE 2x.
- ANCHORS TO BE SPACED NO MORE THAN 6" FROM POSTS.



PROJECT: 30'-0" WIDE BUILDINGS
 LOCATION: STATE OF FLORIDA
 PROJECT NO.: 356-19-0049
 SHEET TITLE: FOUNDATION OPTION 1: CONCRETE SLAB
 SHEET NO.: 11-A / 11
 DRAWN BY: LAK DATE: 1/21/19
 CHECKED BY: OVA DATE: 1/21/19

SCALE: NTS

TABLE 11-A1: NOTCH WIDTH

HORIZONTAL/OPEN	VERTICAL	HGA	I2GA
□ HGA	□ I2GA	□ HGA	□ I2GA
2.3/4"	2.7/8"	1.3/4"	1.7/8"

NOTE: DEPTH IS TO BE 1 1/2"

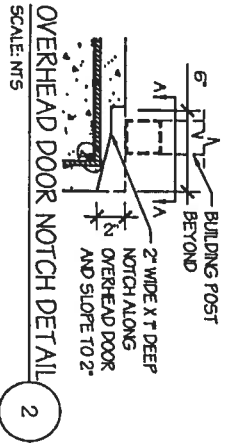
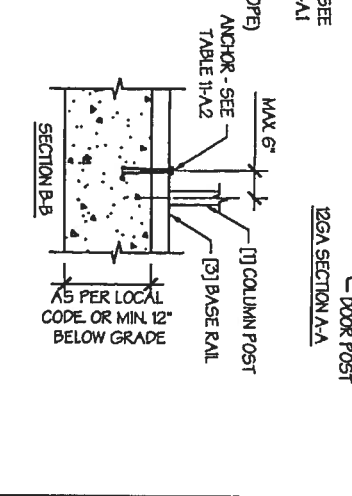
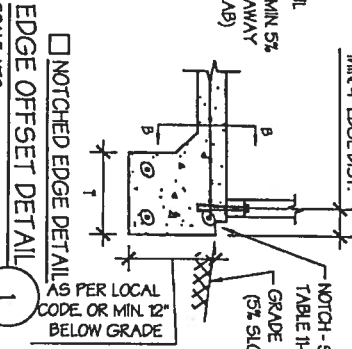
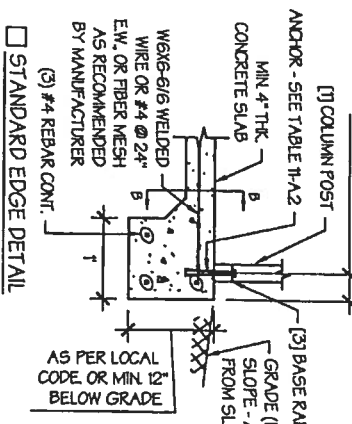

TABLE 11-A1: NOTCH WIDTH



LEGAL INFORMATION
 ANY REVISION OF THIS DRAWING IN WHOLE OR PART IS STRICTLY PROHIBITED. ANYONE DOING SO WILL BE PROSECUTED UNDER THE FULL EXTENT OF THE LAW. DRAWINGS VALID UP TO 1 YEAR FROM DATE OF ISSUE.

SEAL:

OMAR ABU-YASEIN
 No. 52851
 STATE OF FLORIDA
 PROFESSIONAL ENGINEER

DATE PREPARED: 02/28/2021
 DATE SIGNED: JAN 22 2019

MANUFACTURED BY:

Real Steel Metal Buildings

ENGINEERED BY:

AAA ENGINEERING
 CTE - STRUCTURAL
 3911 Renaissance Pkwy, Suite B • Tallahassee, FL 32303
 TEL: 904-292-1983 • FAX: 904-292-0855
 WWW.AAAENGINEERING.COM

DRAWING INFORMATION
 PROJECT: 30'-0" WIDE BUILDINGS
 LOCATION: STATE OF FLORIDA
 PROJECT NO.: 356-19-0049
 SHEET TITLE: FOUNDATION OPTION 1: CONCRETE SLAB
 SHEET NO.: 11-A / 11
 DRAWN BY: LAK DATE: 1/21/19
 CHECKED BY: OVA DATE: 1/21/19

CONCRETE SLAB FOUNDATION NOTES:

- DESIGNS SHOWN ON THIS SHEET ARE FOR CONCRETE SLAB FOUNDATION. ANY OF THE FOUNDATIONS SHOWN ON SHEETS 11-A THRU D CAN BE USED.
- CONCRETE ANCHORS SHALL BE LOCATED NEXT TO EVERY POST AND ON EITHER SIDE OF OPENINGS. TWO ANCHORS SHALL BE INSTALLED AT CORNERS OF ENCLOSED BUILDINGS WITH END WALLS - ONE ON EACH BASE RAIL. IN LOCATIONS REQUIRING TWO ANCHORS DUE TO WIND, ONE ANCHOR IS TO BE ON EACH SIDE OF THE COLUMN POST.
- ANCHORS IN CLOSE PROXIMITY TO EACH OTHER MUST HAVE A MIN. 4" SPACING.
- MIN. NUMBER OF CONCRETE ANCHORS PER POST SHALL BE AS SHOWN IN TABLE 11-A1.
- THE SIZE OF THE SLAB SHALL BE THE SIZE (WIDTH AND LENGTH) OF THE BUILDING PLUS 1/2" FOR WGA MATERIAL AND 1" FOR 12GA MATERIAL.
- DEPTH OF SLAB TURN DOWN FOOTING SHALL BE GREATER THAN FROST DEPTH SPECIFIED PER LOCAL CODE.
- CONTROL JOINTS SHALL BE PLACED SO AS TO LIMIT MAX. SLAB SPANS TO 20' IN EACH DIRECTION.
- ASSUMED SOIL BEARING CAPACITY IS TO BE A MIN. OF 1500 PSF.
- CONCRETE STRENGTH TO BE A MIN. OF 2500 PSI @ 28 DAYS.

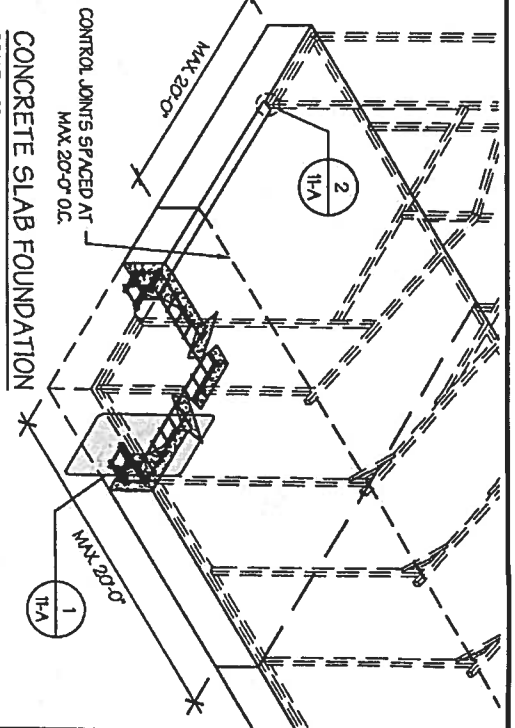

CONCRETE SLAB FOUNDATION
SCALE: NTS

TABLE 11-A1: CONCRETE SLAB ANCHOR SCHEDULE

ENCLOSURE	WIND SPEED (MPH)	ANCHOR SIZE/NUMBER
ENCLOSED	105 TO 130	(1) 1/2" Ø X 7"
	140 TO 160	(2) 1/2" Ø X 7"
OPEN	105	(1) 1/2" Ø X 7"
	115 TO 190	(2) 1/2" Ø X 7"

- NOTES:
- ANCHORS ARE TO BE CONCRETE WEDGE OR EXPANSION ANCHORS.
 - MIN. EMBEDMENT DEPTH TO BE 2Ø.
 - ANCHORS TO BE SPACED NO MORE THAN 6" FROM POSTS.

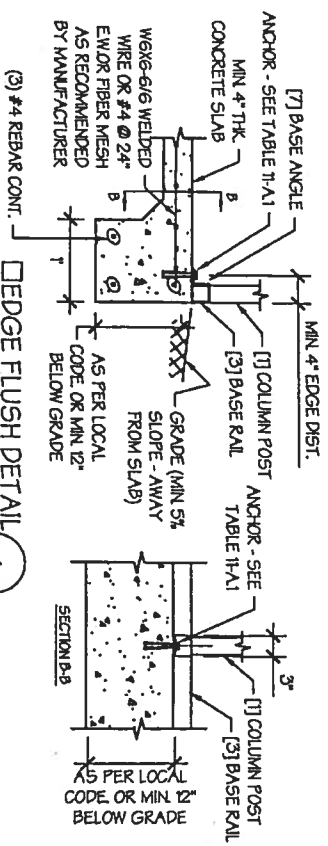
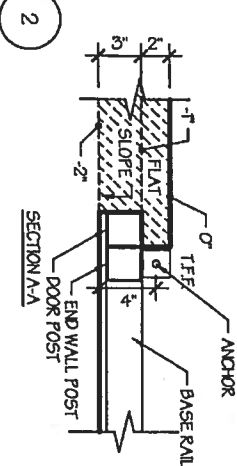
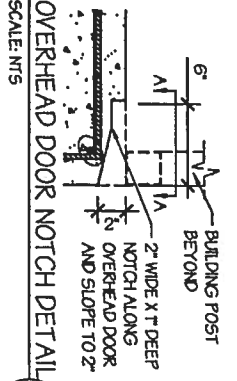

EDGE FLUSH DETAIL
SCALE: NTS

MANUFACTURED BY:

Real Steel Metal Buildings



A&A ENGINEERING
CIVIL - STRUCTURAL
9811 Renaissance Pkwy, Suite B • Toledo, OH 43623
Tel: 419-529-1933 • Fax: 419-529-9553
www.aandae.com

DRAWING INFORMATION

PROJECT: 30'-0" WIDE BUILDINGS
LOCATION: STATE OF FLORIDA
PROJECT NO.: 356-19-0049
SHEET TITLE: FOUNDATION OPTION 1: CONCRETE SLAB

SHEET NO.: 11-A / 11
DRAWN BY: LAK DATE: 1/21/19
CHECKED BY: OVA DATE: 1/21/19

LEGAL INFORMATION

- ANY DUPLICATION OF THIS DRAWING IN WHOLE OR PART IS STRICTLY PROHIBITED. ANYONE DOING SO WILL BE PROSECUTED UNDER THE FULL EXTENT OF THE LAW. - DRAWINGS VALID UP TO 1 YEAR FROM DATE OF ISSUE

SEAL:

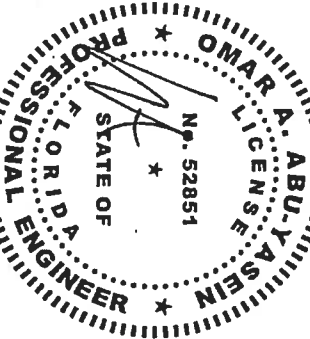

DATE EXPIRES: 02/28/2024
DATE SIGNED: JAN 22 2019

TABLE 11-B1: ANCHOR SCHEDULE

ENCLOSURE	WIND SPEED (MPH)	ANCHOR SIZE/NUMBER
ENCLOSED	D105 TO 130	(1) 1/2" Ø X 7"
	D140 TO 180	(2) 1/2" Ø X 7"
	D105	(1) 1/2" Ø X 7"
OPEN	D115 TO 180	(2) 1/2" Ø X 7"

NOTES:

1. ANCHORS ARE TO BE CONCRETE WEDGE OR EXPANSION ANCHORS.
2. MIN. EMBEDMENT DEPTH TO BE 2 ϕ .
3. ANCHORS TO BE SPACED NO MORE THAN 6" FROM POSTS.

TABLE 11-B2: CONC. STRIP SCHEDULE

WIND SPEED (MPH)	MIN. SIZE REQ'D.
D105 TO 130	5" X 12"
D140 TO 155	24" X 12"
D165 TO 180	30" X 12" 24" X 15" 20" X 18"

- NOTES:
1. WIDTH AND DEPTH DIMENSIONS CAN BE INTERCHANGED.

CONCRETE STRIP FOUNDATION NOTES:

1. DESIGNS SHOWN ON THIS SHEET ARE FOR CONCRETE STRIP FOUNDATION. ANY OF THE FOUNDATIONS SHOWN ON SHEETS 11-A THRU D CAN BE USED.
2. CONCRETE ANCHORS SHALL BE LOCATED NEXT TO EVERY POST AND ON EITHER SIDE OF OPENINGS. TWO ANCHORS SHALL BE INSTALLED AT CORNERS OF ENCLOSED BUILDINGS WITH END WALLS - ONE ON EACH BASE RAIL. IN LOCATIONS REQUIRING TWO ANCHORS DUE TO WIND, ONE ANCHOR IS TO BE ON EACH SIDE OF THE COLUMN POST.
3. MIN. NUMBER OF CONCRETE ANCHORS PER POST SHALL BE AS SHOWN IN TABLE 11-B1.
4. DEPTH OF CONCRETE STRIP FOOTING SHALL BE GREATER THAN FROST DEPTH SPECIFIED PER LOCAL CODE.
5. ASSUMED SOIL BEARING CAPACITY IS TO BE A MIN. OF 1500 PSF.
6. CONCRETE STRENGTH TO BE A MIN. OF 2500 PSI @ 28 DAYS.
7. BUILDING IS TO BE MOUNTED ON THE CENTER OF THE STRIP FOUNDATION.

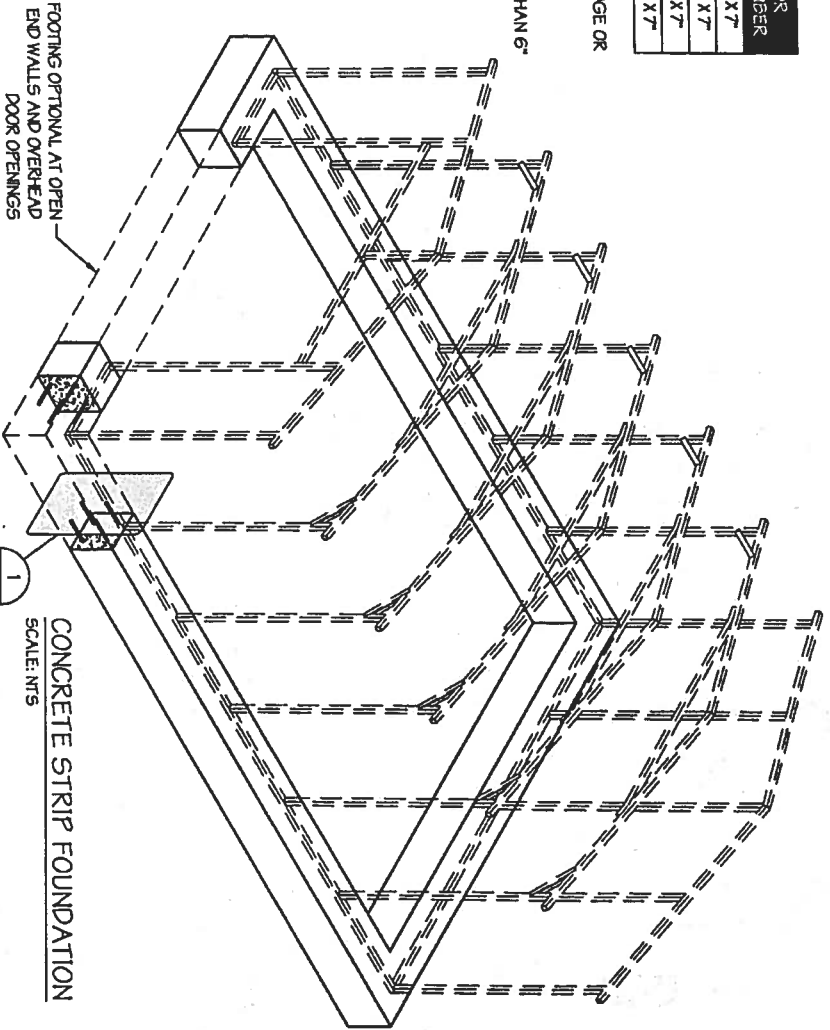

CONCRETE STRIP FOUNDATION

SCALE: NTS

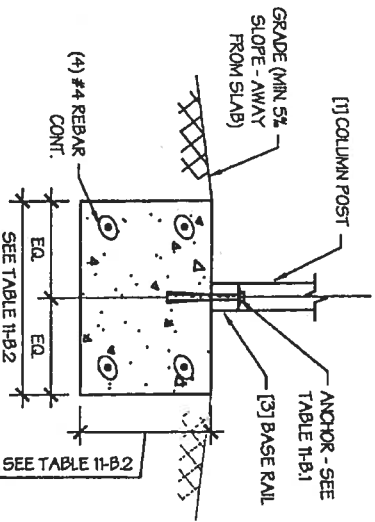

CONCRETE STRIP FOUNDATION DETAIL

SCALE: NTS

MANUFACTURED BY:

Real Steel Metal
Buildings



A&A ENGINEERING
CIVIL - STRUCTURAL
5911 Renaissance Place, Suite B • Toledo, OH 43623
TEL: 419-592-1583 • Fax: 419-592-0935
WWW.A&A-ENGINEERING.COM

ENGINEERED BY:

DRAWING INFORMATION

PROJECT: 30'-0" WIDE BUILDINGS

LOCATION: STATE OF FLORIDA

PROJECT NO.: 356-19-0049

FOUNDATION OPTION 2:

CONCRETE STRIP

SHEET NO.: 11-B / 11

DRAWN BY: LAK DATE: 1/21/19

CHECKED BY: OAM DATE: 1/21/19

LEGAL INFORMATION

* ANY DUPLICATION OF THIS DRAWING IN WHOLE OR IN PART WITHOUT THE WRITTEN PERMISSION OF THE ENGINEER IS PROHIBITED UNDER THE FULL PROVISIONS OF THE LAW. DRAWINGS VOID UP TO 1 YEAR FROM DATE OF ISSUE.

SEAL:

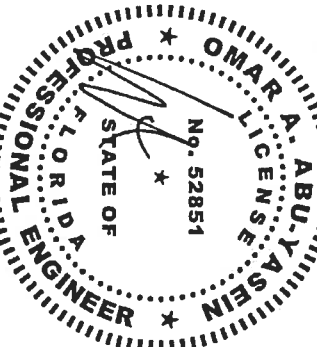

DATE EXPIRES: 02/28/2021

DATE SIGNED: JAN 22 2019

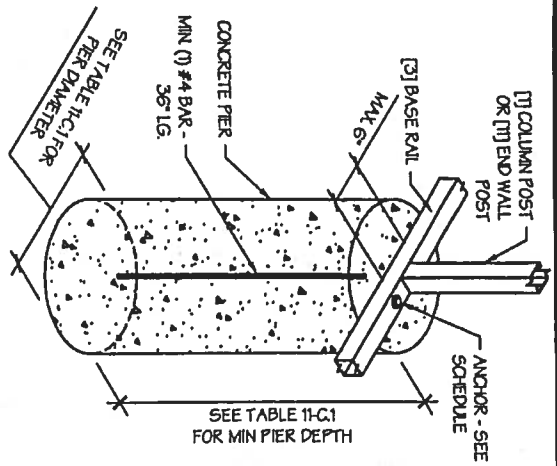

CONCRETE PIER DETAIL 1
SCALE: NTS

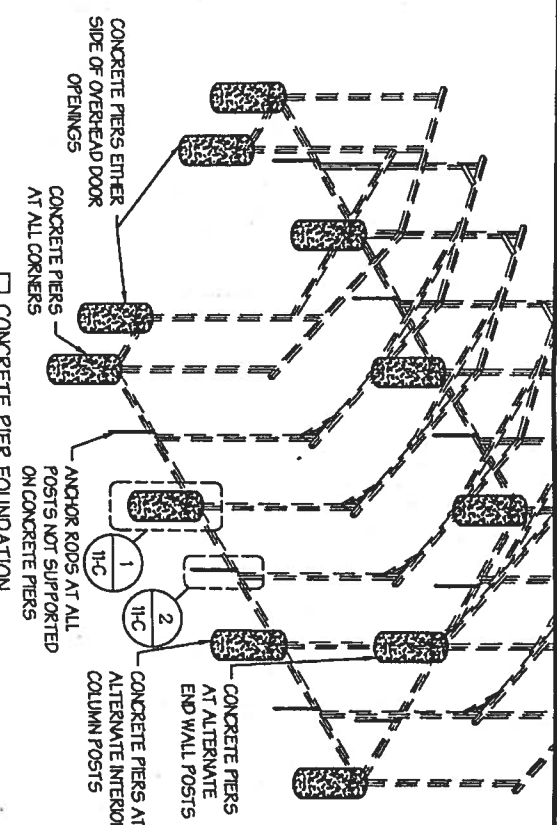

SCALE: NTS

CONCRETE PIER FOUNDATION NOTES:

- DESIGNS SHOWN ON THIS SHEET ARE FOR CONCRETE PIER FOUNDATION. ANY OF THE FOUNDATIONS SHOWN ON SHEETS 11-A THRU D CAN BE USED.
- CONCRETE PIERS SHALL BE LOCATED AT ALL 4 CORNERS, ON EACH SIDE OF OVERHEAD DOOR OPENINGS AND ON ALTERNATE INTERIOR COLUMN POSTS AND END WALLS POSTS.
- TWO ANCHORS SHALL BE INSTALLED AT CORNERS OF ENCLOSED BUILDINGS WITH END WALLS - ONE ON EACH BASE RAIL. IN LOCATIONS REQUIRING TWO ANCHORS DUE TO WIND, ONE ANCHOR IS TO BE ON EACH SIDE OF THE COLUMN POST WITH A PIER.
- ANCHORS IN CLOSE PROXIMITY TO EACH OTHER MUST HAVE A MIN. 4" SPACING.
- MIN. NUMBER OF CONCRETE ANCHORS PER POST WITH A PIER SHALL BE AS SHOWN IN TABLE 11-A.2.
- TWO ANCHORS AND A PIER ARE REQUIRED AT DIAGONAL BRACING.
- ALL POSTS NOT SUPPORTED ON CONCRETE PIERS SHALL BE ANCHORED TO THE GROUND WITH A 1/2" X 30" LG. THREADED ROD. RODS WILL HAVE A PRE-FORMED HEAD AT THE TOP AND ONE COAT OF RUST PROOF MATERIAL.
- PIERS SHALL BE FORMED BY DIGGING A HOLE OF THE SAME SIZE AS THE PIER ON LEVEL GRADE AND FILLING IT WITH CONCRETE. THRD. ROD ANCHORS SHOULD BE DROPPED INTO THE PIERS PRIOR TO POURING THE CONCRETE.
- ASSUMED SOIL BEARING CAPACITY IS TO BE A MIN OF 1500 PSF.
- CONCRETE STRENGTH TO BE A MIN OF 2500 PSI @ 28 DAYS.

TABLE 11-B.1: ANCHOR SCHEDULE

ENCLOSURE	WIND SPEED (MPH)	ANCHOR SIZE/NUMBER
ENCLOSED	D105 TO 130	(1) 1/2" Ø X 7"
	D140 TO 160	(2) 1/2" Ø X 7"
OPEN	D105	(1) 1/2" Ø X 7"
	D165 TO 180	(2) 1/2" Ø X 7"

NOTES:
1. ANCHORS ARE TO BE CONCRETE WEDGE OR EXPANSION ANCHORS.
2. MIN. EMBEDMENT DEPTH TO BE 2g".
3. ANCHORS TO BE SPACED NO MORE THAN 6" FROM POSTS.

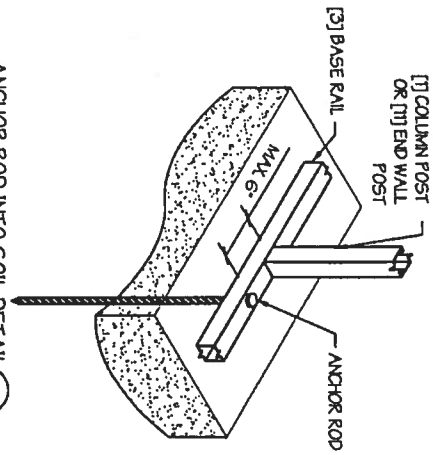

ANCHOR ROD INTO SOIL DETAIL 2
SCALE: NTS

TABLE 11-C.1: CONC. PIER SCHEDULE

WIND SPEED (MPH)	MIN. SIZE RECD.
D105 TO 130	24" Ø X 36"
D140 TO 165	24" Ø X 42"
D165 TO 180	24" Ø X 48"

MANUFACTURED BY:

Real Steel Metal Buildings



ENGINEERED BY:
A&A ENGINEERING
CIVIL - STRUCTURAL
5911 Renaissance Place, Suite B • Tallahassee, FL 32303
T: 419-291-1983 • Fax: 419-291-0555
www.aandae.com

DRAWING INFORMATION

PROJECT: 30'-0" WIDE BUILDINGS
LOCATION: STATE OF FLORIDA
PROJECT NO.: 356-19-0049
SHEET NO.: 11C / 11
FOUNDATION OPTION 3:
CONCRETE PIERS
DRAWN BY: LAK DATE: 1/21/19
CHECKED BY: OAA DATE: 1/21/19

LEGAL INFORMATION

- ANY DUPLICATION OF THIS DRAWING IN WHOLE OR PART IS STRICTLY PROHIBITED. ANYONE DOING SO WILL BE PROSECUTED TO THE FULL EXTENT OF THE LAW.
- DRAWINGS VALID UP TO 1 YEAR FROM DATE OF ISSUE.

SEAL:

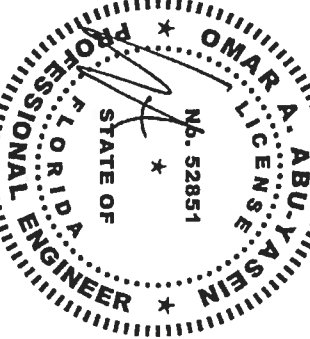

DATE EXPIRES: 02/28/2021
DATE SIGNED: JAN 22 2019

MANUFACTURED BY:

Real Steel Metal Buildings



ENGINEERED BY:
A&A ENGINEERING
CIVIL - STRUCTURAL
9911 Renaissance Pkwy, Suite B & Tallahassee, FL 32310
TEL: 904-292-1983 • Fax: 904-292-0955
www.aandengineering.com

DRAWING INFORMATION
PROJECT: 30'-0" WIDE BUILDINGS
LOCATION: STATE OF FLORIDA
PROJECT NO.: 356-19-0049
SHEET TITLE: FOUNDATION OPTION 4:
SOIL ANCHORS

SHEET NO.: 1-H / 11
DRAWN BY: LAK DATE: 1/21/19
CHECKED BY: OVA DATE: 1/21/19

LEGAL INFORMATION
-ANY REPLICATION OF THIS DRAWING IN WHOLE OR PART IS STRICTLY PROHIBITED. ANYONE DOING SO WILL BE PROSECUTED UNDER THE FULL EXTENT OF THE LAW.
-DRAWINGS VALID UP TO 1 YEAR FROM DATE OF ISSUE.
SEAL:



DATE EXPIRES: 02/28/2021
DATE SIGNED: JAN 22 2019

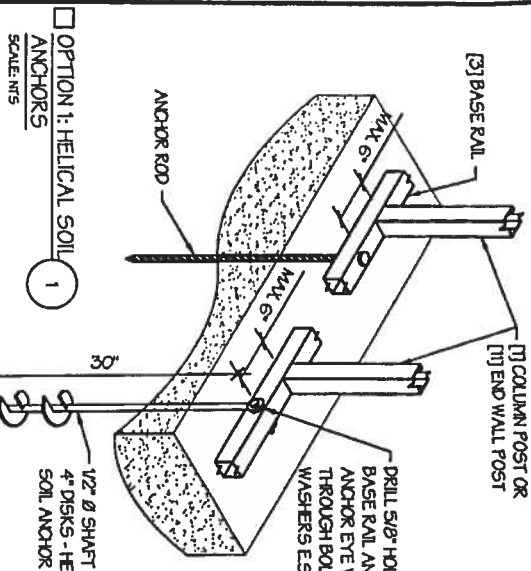
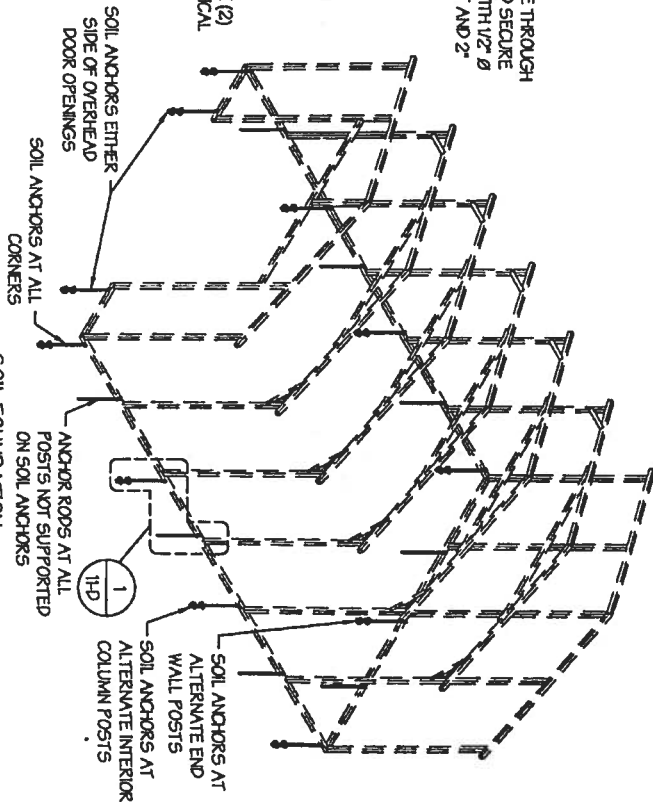

SOIL FOUNDATION NOTES:

- DESIGNS SHOWN ON THIS SHEET ARE FOR SOIL ANCHOR FOUNDATION, ANY OF THE FOUNDATIONS SHOWN ON SHEETS 1-A THRU D CAN BE USED.
- SOIL ANCHORS (HELICAL OR ROCK/ASPHALT) SHALL BE LOCATED AT ALL 4 CORNERS, ON EACH SIDE OF OVERHEAD DOOR OPENINGS, ON POSTS WITH DIAGONAL BRACING IF REQUIRED, AND ON ALTERNATE INTERIOR COLUMN POSTS AND END WALLS POSTS.
- HELICAL ANCHORS ARE TO BE USED ONLY IF THE DRIVING TORQUE INTO THE GROUND IS 150 FT-LBS OR GREATER. MANUFACTURER IS NOT RESPONSIBLE FOR SOIL QUALITY AT SITE.
- HELICAL ANCHORS CAN ONLY BE USED FOR CLASS 2, 3 & 4 SOILS (SEE SOIL CLASSIFICATIONS THIS PAGE).
- ALL POSTS WITH NO ANCHORS ADJACENT SHALL BE ANCHORED TO THE GROUND WITH A 1/2" X 30" LG. ROD. RODS WILL HAVE A PRE-FORMED HEAD AT THE TOP AND ONE COAT OF RUST PROOF MATERIAL.
- ASSUMED SOIL BEARING CAPACITY IS TO BE A MIN. OF 1500 PSF.

SOIL CLASSIFICATIONS:

SOIL CLASS	DESCRIPTION
2	SANDY GRAVEL AND GRAVEL, VERY THIN DENSE AND/OR CEMENTED SANDS, COARSE GRAVEL/COBBLES, PRELOADED SILTS, CLAYS AND CORAL.
3	SAND, SILTY SAND, CLAYEY SAND, SILTY GRAVEL, MEDIUM DENSE COARSE SANDS, SANDY GRAVEL, VERY STIFF SILT AND SANDY CLAYS.
4	LOOSE TO MEDIUM DENSE SANDS, FIRM TO STIFF CLAYS AND SILTS AND ALLUVIAL FILLS.

FROM HUD MODEL MANUFACTURED HOME INSTALLATION STANDARDS

