



# Mobile Home Permit Worksheet

Installer: Ernest S Johnson License # JH-1025249

Address of home being installed \_\_\_\_\_

Manufacturer Town Home Length x width 44x28

**NOTE:** If home is a single wide fill out one half of the blocking plan  
 if home is a triple or quad wide sketch in remainder of home  
 I understand Lateral Arm Systems cannot be used on any home (new or used)  
 where the sidewall ties exceed 5 ft 4 in.

installer's initials [Signature]

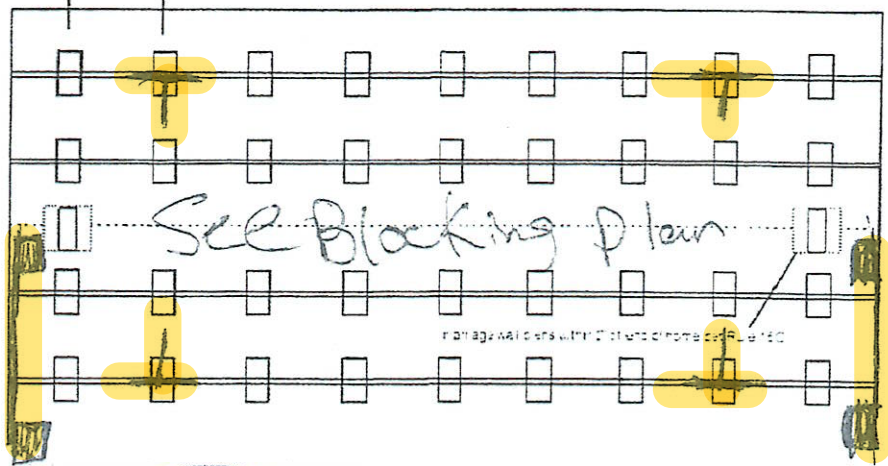
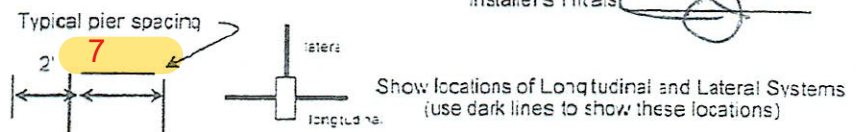

Anthony Islan

04/09/2021

Application Number: \_\_\_\_\_ Date: \_\_\_\_\_

New Home  Used Home

Home installed to the Manufacturer's Installation Manual   
 Home is installed in accordance with Rule 15-C

Single wide  Wind Zone II  Wind Zone III

Double wide  Install on Decal # 77948

Triple/Quad  Serial # \_\_\_\_\_

### PIER SPACING TABLE FOR USED HOMES

| Load bearing capacity | Footer size (sq in) | 16' x 16' (256) | 18 1/2" x 18 1/2" (342) | 20" x 20" (400) | 22" x 22" (484) | 24" x 24" (576) | 26" x 26" (676) |
|-----------------------|---------------------|-----------------|-------------------------|-----------------|-----------------|-----------------|-----------------|
| 1000 psf              |                     | 3'              | 4'                      | 5'              | 5'              | 7'              | 8'              |
| 1500 psf              |                     | 4' 6"           | 6'                      | 7'              | 8'              | 8'              | 8'              |
| 2000 psf              |                     | 6'              | 8'                      | 8'              | 8'              | 8'              | 8'              |
| 2500 psf              |                     | 7' 6"           | 8'                      | 8'              | 8'              | 8'              | 8'              |
| 3000 psf              |                     | 8'              | 8'                      | 8'              | 8'              | 8'              | 8'              |
| 3500 psf              |                     | 8'              | 8'                      | 8'              | 8'              | 8'              | 8'              |

\* interpolated from Rule 15C-1 pier spacing table.

#### PIER PAD SIZES

I-beam pier pad size 23x31 70c  
 Perimeter pier pad size Oliver 10511 OR 16x18

Other pier pad sizes (required by the mfg.) \_\_\_\_\_

Draw the approximate locations of marriage wall openings 4 foot or greater. Use this symbol to show the piers.

List all marriage wall openings greater than 4 foot and their pier pad sizes below

Opening \_\_\_\_\_ Pier pad size \_\_\_\_\_  
SEE Blocking Plan

#### TIEDOWN COMPONENTS

Longitudinal Stabilizing Device (LSD) Manufacturer \_\_\_\_\_  
 Longitudinal Stabilizing Device w/ Lateral Arms Manufacturer Oliver 1101 V

#### POPULAR PAD SIZES

| Pad Size          | Sq In |
|-------------------|-------|
| 16 x 16           | 256   |
| 16 x 18           | 288   |
| 18.5 x 18.5       | 342   |
| 16 x 22.5         | 360   |
| 17 x 22           | 374   |
| 13 1/4 x 26 1/2   | 348   |
| 20 x 20           | 400   |
| 17 3/16 x 25 3/16 | 441   |
| 17 1/2 x 25 1/2   | 446   |
| 24 x 24           | 576   |
| 26 x 26           | 676   |

#### ANCHORS



#### FRAME TIES

within 2' of end of home spaced at 5' 4" oc

#### OTHER TIES

|               |  |
|---------------|--|
| Sidewall      | Number <u>20</u>   |
| Longitudinal  | <u>6</u> <span style="background-color: yellow; border: 1px solid black; padding: 2px;">4</span> |
| Marriage wall | <u>26</u>  |
| Shearwall     | <u>26</u>  |

# Mobile Home Permit Worksheet

Application Number: \_\_\_\_\_ Date: \_\_\_\_\_

## POCKET PENETROMETER TEST

The pocket penetrometer tests are rounded down to \_\_\_\_\_ psi or check here to declare 1000 b. soil without testing

x 1000      x 1000      x 1000

### POCKET PENETROMETER TESTING METHOD

1. Test the perimeter of the home at 6 locations
2. Take the reading at the depth of the footer
3. Using 500 lb. increments, take the lowest reading and round down to that increment

x 1000      x 1000      x 1000

## TORQUE PROBE TEST

The results of the torque probe test is \_\_\_\_\_ inch pounds or check here if you are declaring 5" anchors without testing. A test showing 275 inch pounds or less will require 5 foot anchors.

Note: A state approved lateral arm system is being used and 4 ft anchors are allowed at the sidewall locations. I understand 5 ft anchors are required at all centerline tie points where the torque test reading is 275 or less and where the mobile home manufacturer may require anchors with 4000 lb holding capacity.

Installer's initials

ALL TESTS MUST BE PERFORMED BY A LICENSED INSTALLER

Installer Name Ernest S. Johnson  
Date Tested Assumed Oliver 10/1/14 uses 4' 5" Foot Anchors

### Electrical

Connect electrical conductors between multi-wide units, but not to the main power source. This includes the bonding wire between multi-wide units. Pq. Both

### Plumbing

Connect all sewer drains to an existing sewer tap or septic tank. Pq.

Connect all potable water supply piping to an existing water meter, water tap, or other independent water supply systems. Pq.

### Site Preparation

Debris and organic material removed \_\_\_\_\_  
Water drainage: Natural \_\_\_\_\_ Swale \_\_\_\_\_ Pad    Other \_\_\_\_\_

### Fastening multi-wide units

|       |                            |                      |                    |
|-------|----------------------------|----------------------|--------------------|
| Floor | Type Fastener: <u>1495</u> | Length: <u>7 1/4</u> | Spacing: <u>24</u> |
| Walls | Type Fastener: <u>1495</u> | Length: <u>7 1/4</u> | Spacing: <u>12</u> |
| Roof  | Type Fastener: <u>1495</u> | Length: <u>7</u>     | Spacing: <u>24</u> |

For used homes a min. 30 gauge, 8" wide, galvanized metal strip will be centered over the peak of the roof and fastened with galv. roofing nails at 2" on center on both sides of the centerline.

### Gasket (weatherproofing requirement)

I understand a properly installed gasket is a requirement of all new and used homes and that condensation, mold, mildew and buckled marriage walls are a result of a poorly installed or no gasket being installed. I understand a strip of tape will not serve as a gasket.

Installer's initials

Type gasket: Pq. R11  
Installed:  
Between Floors: Yes     
Between Walls: Yes     
Bottom of ridgebeam: Yes   

### Weatherproofing

The bottomboard will be repaired and/or taped. Yes    Pq.     
Siding on units is installed to manufacturer's specifications. Yes     
Fireplace chimney installed so as not to allow intrusion of rain water. Yes   

### Miscellaneous

Skirting to be installed. Yes    No     
Dryer vent installed outside of skirting. Yes    N/A     
Range downflow vent installed outside of skirting. Yes    N/A     
Drain lines supported at 4 foot intervals? Yes     
Electrical crossovers protected. Yes     
Other: \_\_\_\_\_

Installer verifies all information given with this permit worksheet is accurate and true based on the manufacturer's installation instructions and or Rule 15C-1 & 2

Installer Signature Ernest S. Johnson Date \_\_\_\_\_



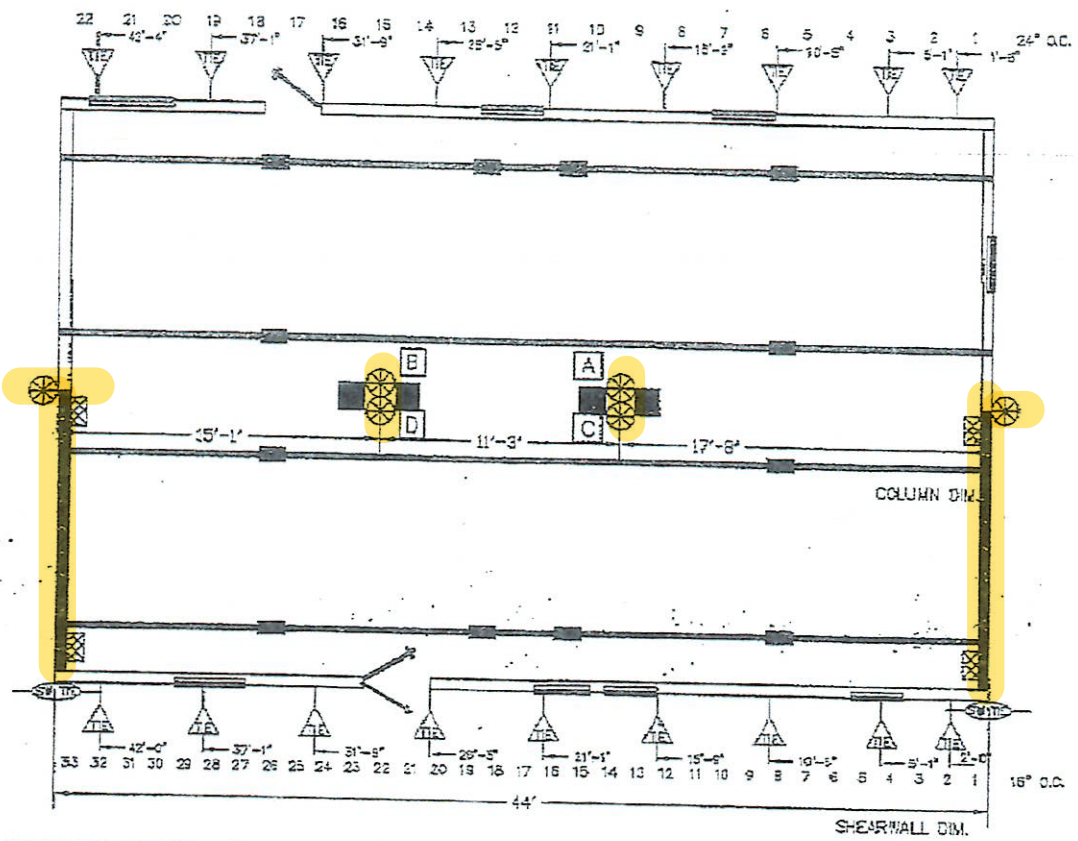
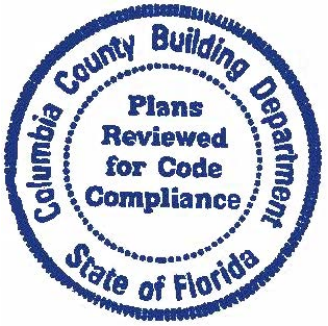

|  |  |   |
|--|--|---|
|  | I-BEAM BLOCKING<br>SEE SOIL BEARING CAPACITY CHARTS FOR SPACING  | <b>BLOCKING LEGEND:</b>   |
|  | COLUMN BLOCKING<br>SEE SOIL BEARING CAPACITY CHARTS FOR PAD SIZE |   |
|  | SHEARWALL BLOCKING   | <p>1) ALL EXTERIOR DOORS, BAY WINDOWS, RECESSED SIDEWALLS AND EXTERIOR WALL OPENINGS 48" OR GREATER, WILL REQUIRE BLOCKING ON EACH SIDE.</p> <p>2) 32" WIDE HOLES REQUIRED TO BE BLOCKED MIN 5'-0" ON CENTER BETWEEN COLUMNS.</p> |
|  | SHEARWALL FRAME TIE  |   |
|  | CENTER LINE TIES   |   |
|  | VERTICAL TIE<br>MAX. SPACING 9'-9" CENTER TO CENTER              |   |
|  | LONGITUDINAL TIES  |   |
|  | SHEARWALL TIE  |   |

|   |                |               |
|---|----------------|---------------|
| <b>TOWNHOMES</b><br>P.O. BOX 1668<br>LAKE CITY, FLORIDA 32056 |                |               |
| Date: 8-4-14  | Revisions:     | Doc# 2638A15  |
| Dr'n: ROE   |                |               |
| Parent: NEW   |                |               |
| Code: 7 (15)  | CHS ALTB R/BTH |               |
| Model: 2638-215   | Print:         | BLOCKING PLAN |