

NOTES:

1. BOUNDARY LINES HAVE BEEN DERIVED FROM THE FLORIDA GEOGRAPHIC INFORMATION OFFICE STATEWIDE PARCEL DATA.
2. TOTAL BUILDABLE AREA IS APPROXIMATELY 13,354.927 SQFT OR 0.307± ACRES.
3. TOTAL WETLAND AREA IS APPROXIMATELY 0.000 SQFT OR 0.000± ACRES.
4. TOTAL SEPTIC AREA IS APPROXIMATELY 22,709.560 SQFT OR 0.521± ACRES.

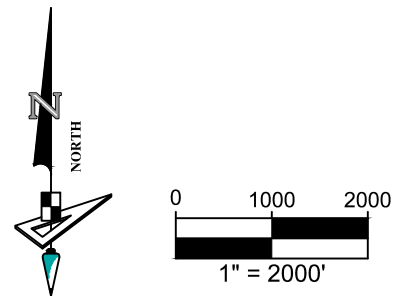

FIELD DATE	12-12-2025
PARCEL ID	00-00-00-00566-000
COUNTY	COLUMBIA COUNTY, FL
CLIENT	AMIRA CUSTOM HOMES - CARUTHERS
PROJECT #	25121207
DRAWN BY:	VLD

**MASTODON
 ENVIRONMENTAL
 WETLAND
 DELINEATION
 SERVICES**



LEGEND

BUILDABLE AREA	SEPTIC AREA	WETLAND LINE	SEPTIC SETBACK
WETLAND AREA	PARCEL BOUNDARY	WETLAND SETBACK	PARCEL SETBACK

FIELD DATE	12-12-2025
PARCEL ID	00-00-00-00566-000
COUNTY	COLUMBIA COUNTY, FL
CLIENT	AMIRA CUSTOM HOMES - CARUTHERS
PROJECT #	25121207
DRAWN BY:	VLD

MASTODON ENVIRONMENTAL
WETLAND DELINEATION SERVICES

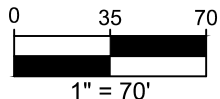

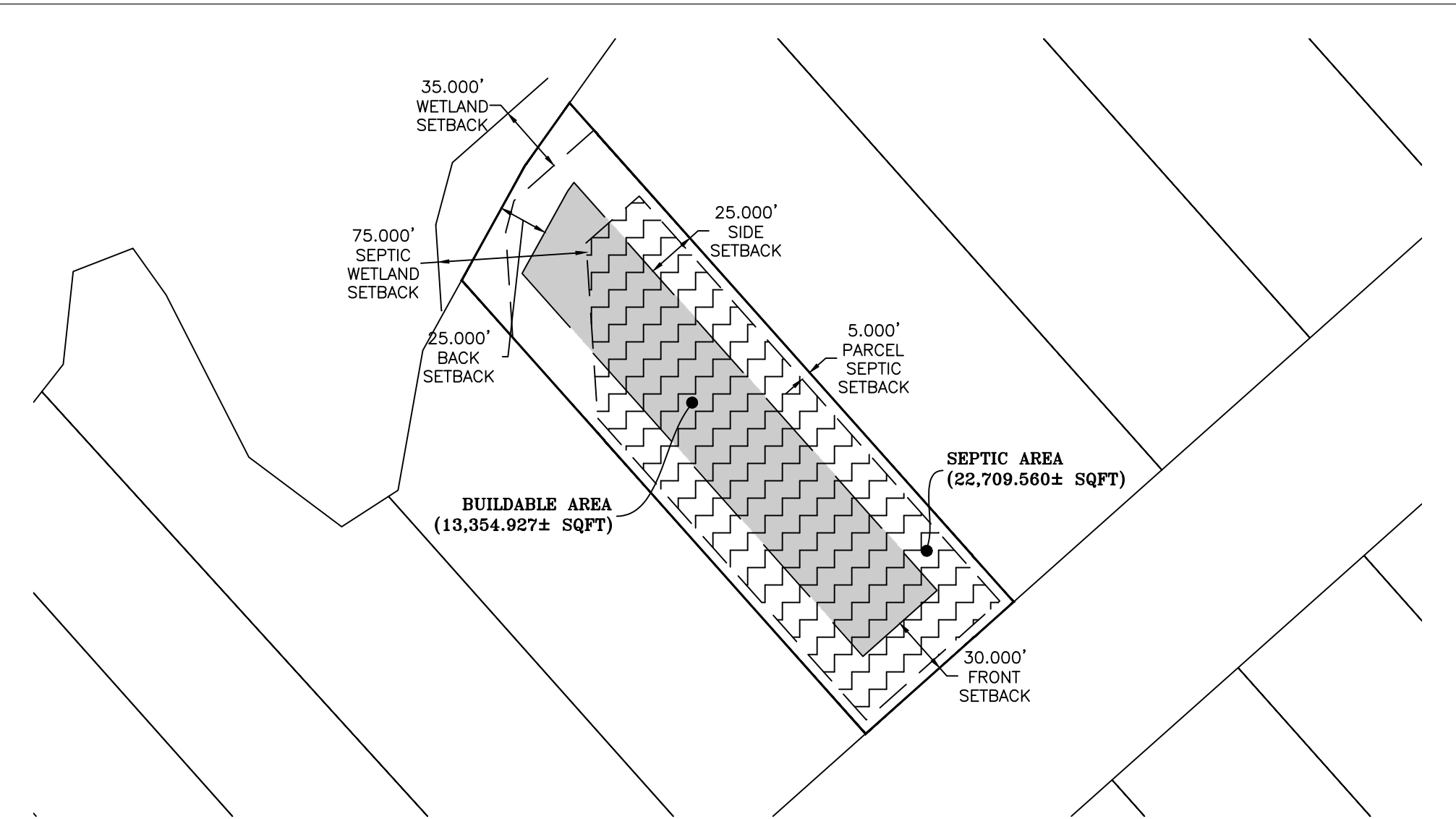

LEGEND

■ BUILDABLE AREA	▨ SEPTIC AREA	— WETLAND LINE	--- SEPTIC SETBACK
∇ WETLAND AREA	□ PARCEL BOUNDARY	--- WETLAND SETBACK	--- PARCEL SETBACK

FIELD DATE	12-12-2025
PARCEL ID	00-00-00-00566-000
COUNTY	COLUMBIA COUNTY, FL
CLIENT	AMIRA CUSTOM HOMES - CARUTHERS
PROJECT #	25121207
DRAWN BY:	VLD

**MASTODON
 ENVIRONMENTAL
 WETLAND
 DELINEATION
 SERVICES**