

STRUCTURAL PLAN
SCALE: 1/4" = 1'-0"

STRUCTURAL PLAN NOTES

SN-1 DIMENSIONS ON STRUCTURAL SHEETS ARE NOT EXACT. REFER TO ARCHITECTURAL FLOOR PLAN FOR ACTUAL DIMENSIONS

SN-2 PERMANENT TRUSS BRACING IS TO BE INSTALLED AT LOCATIONS AS SHOWN ON THE SEALED TRUSS DRAWINGS. LATERAL BRACING IS TO BE RESTRAINED PER BCSI-1-03, BCSI-B1, BCSI-B2 & BCSI-B3, BCSI-B1, BCSI-B2, & BCSI-B3 ARE FURNISHED BY THE TRUSS SUPPLIER, WITH THE SEALED TRUSS PACKAGE

HEADER LEGEND

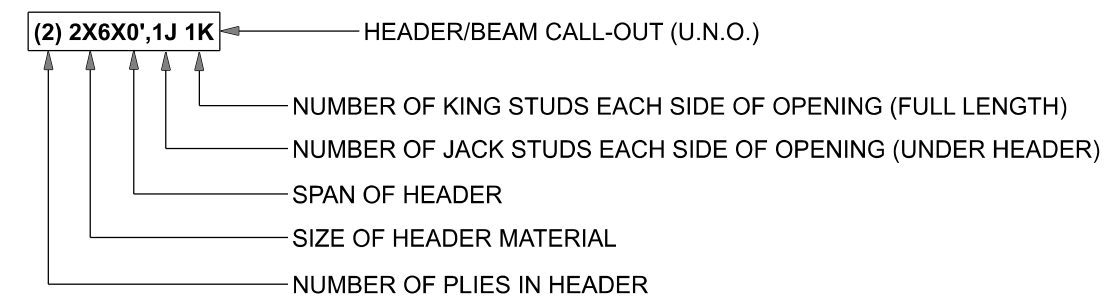

ACTUAL vs REQUIRED SHEARWALL

	TRANSVERSE	LONGITUDINAL
ACTUAL	27456 LBF	20730 LBF
REQUIRED	16052 LBF	17890 LBF

UNLESS NOTED OTHERWISE (MINIMUM REQUIERMENTS) **SEE STRUCTURAL PLAN FOR ANY SPECIFIC CALL OUTS**

BEAM / HEADERS (SIZE)	ALL LOAD BEARING FRAME WALL & PORCH HEADERS SHALL BE A MINIMUM OF (2) 2X6 SP #2 (UNO)
HEADERS (JACK & KING STUDS)	ALL LOAD BEARING FRAME WALL HEADERS SHALL HAVE (1) JACK STUD & (1) KING STUD EACH SIDE (UNO)
HEADERS (STRAPING)	ALL HEADERS w/ UPLIFT TO BE STRAPPED OR SCREWED DOWN w/ MIN. OPTION #1 OR OPTION #3 (SEE DETAIL ON SHEET S-1) (U.N.O.) 1/2" X 10" ANCHOR BOLT w/ 3" X 3" X 1/4" WASHER MUST BE LOCATED WITHIN 6" OF KING STUD @ ALL DOOR LOCATIONS (U.N.O.)
JACK STUDS UNDER GIRDER TRUSS	USE ONE JACK STUD GIRDER SUPPORT PER 2000 LB LOAD

CONNECTIONS, WALL, & HEADER DESIGN IS BASED ON REACTIONS & UPLIFTS FROM TRUSS ENGINEERING FURNISHED BY BUILDER, HOWLAND, JOB #25-2898

MASONRY NOTE:
MASONRY CONSTRUCTION AND MATERIALS FOR THIS PROJECT SHALL CONFORM TO ALL REQUIREMENTS OF "SPECIFICATION FOR MASONRY STRUCTURES" (ACI 530.1/ASCE 6/TMS 602). THE CONTRACTOR AND MASON MUST IMMEDIATELY, BEFORE PROCEEDING, NOTIFY THE ENGINEER OF ANY CONFLICTS BETWEEN ACI 530.1-02 AND THESE DESIGN DRAWINGS. ANY EXCEPTIONS TO ACI 530.1-02 MUST BE APPROVED BY THE ENGINEER IN WRITING.

ACI/ASCE Section	Specific Requirements
1.4A	Compressive strength 8" block bearing walls Fm = 1500 psi
2.1	Mortar ASTM C 270, Type N, UNO
2.2	Grout ASTM C 476, admixtures require approval
2.3	CMU standard ASTM C 90-02, Normal weight, Hollow, medium surface finish, 8"x8"x16" running bond and 12"x12" or 16"x16" column block
2.3	Clay brick standard ASTM C 216-02, Grade SW, Type FBS, 5.5"x2.75"x11.5"
2.4	Reinforcing bars, #3 - #11 ASTM 615, Grade 40, Fy = 40 ksi, Lap splices min 40 bar dia. (25" for #8)
2.4F	Coating for corrosion protection Anchors, sheet metal ties completely embedded in mortar or grout, ASTM A525, Class G60, 0.60 oz/lb or 304SS
2.4F	Coating for corrosion protection Joint reinforcement in walls exposed to moisture or wire ties, anchors, sheet metal ties not completely embedded in mortar or grout, ASTM A153, Class B2, 1.50 oz/lb or 304SS
3.3.E.2	Pipes, conduits, and accessories Any not shown on the project drawings require engineering approval
3.3.E.7	Movement joints Contractor assumes responsibility for type and location of movement joints. If not detailed on project drawings.

FULL STEM WALL TABLE:
The table assumes 40 ksi for #5 rebar and 60 ksi for #7 & #8 rebar with 6" hook in the footing and bent 24" into the reinforced slab at the top. The vertical steel is to be placed toward the tension side of the CMU wall (away from the soil pressure, within 2" of the exterior side of the wall).

STEM WALL HEIGHT (FEET)	UNBALANCED BACKFILL HEIGHT	VERTICAL REINFORCEMENT FOR 8" CMU STEM WALL (INCHES O.C.)			VERTICAL REINFORCEMENT FOR 12" CMU STEM WALL (INCHES O.C.)		
		#5	#7	#8	#5	#7	#8
3.3	3.0	96	96	96	96	96	96
4.0	3.7	96	96	96	96	96	96
4.7	4.3	88	96	96	96	96	96
5.3	5.0	56	96	96	96	96	96
6.0	5.7	40	80	96	80	96	96
6.7	6.3	32	56	80	56	96	96

THIS FOUNDATION DESIGN IS FOR RELATIVELY FLAT GRADE ONLY. IF FOUNDATION IS ON A STEEP SLOPE THAT EXCEEDS 1' IN 12'. CONTACT ENGINEER BEFORE CONSTRUCTION FOR ADDITIONAL ENGINEERING

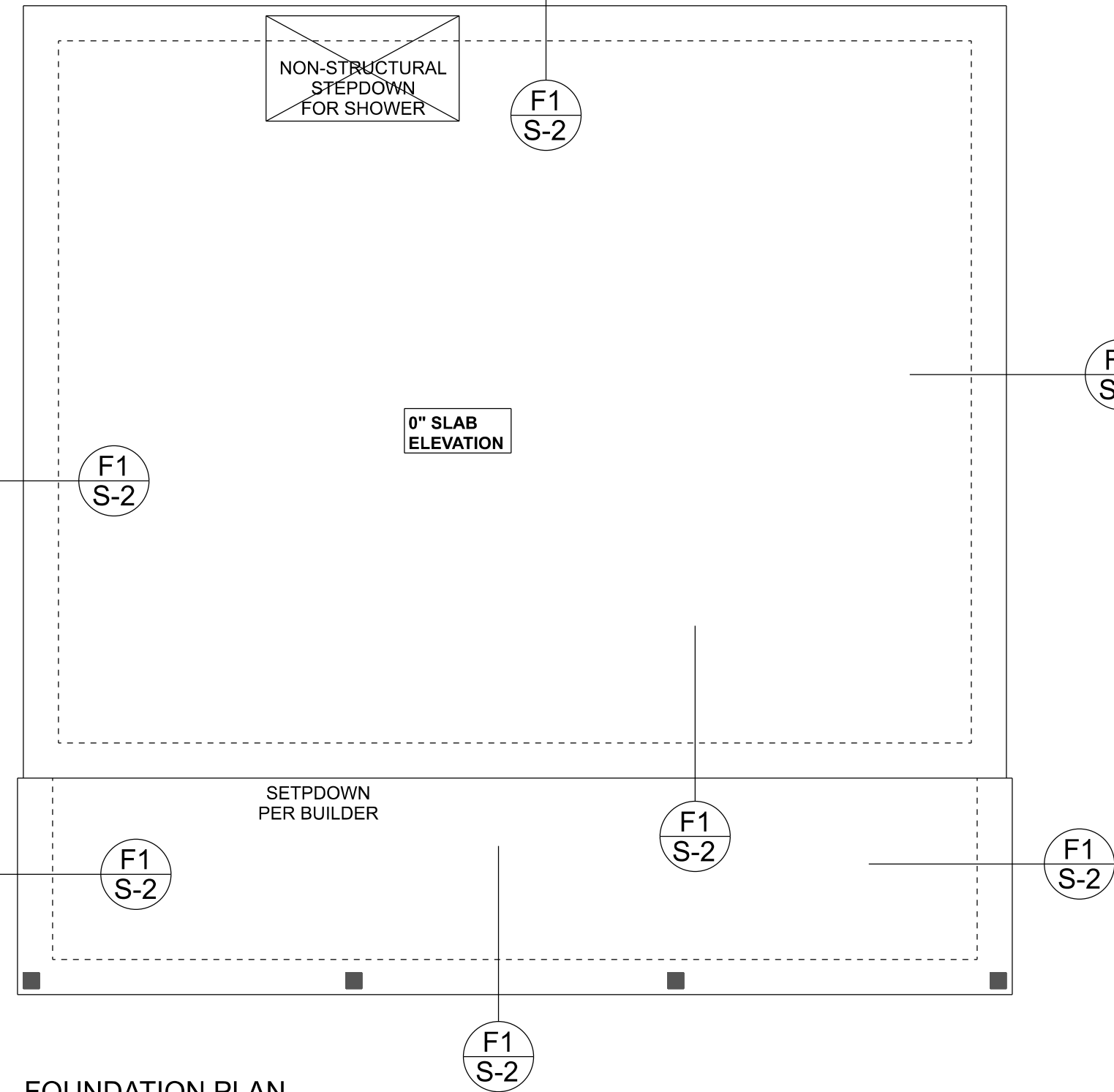

FOUNDATION PLAN

SCALE: 1/4" = 1'-0"

FOUNDATION NOTES

- FN - 1** DIMENSIONS ON FOUNDATION & STRUCTURAL SHEETS ARE NOT EXACT. REFER TO ARCHITECTURAL PLANS FOR ACTUAL DIMENSIONS, RECESSES IN SLAB, STEP DOWNS, ETC. DISOSWAY DESIGN GROUP OR MARK DISOSWAY, PE IS NOT RESPONSIBLE FOR DIMENSION ERRORS ON THIS PLAN.
- FN - 2** CONTRACTOR SHALL VERIFY NEED FOR INTERIOR BEARING IN ALL AREAS BY REVIEWING THE ROOF TRUSS PLAN (BY THE SUPPLIER) BEFORE FINALIZING FOUNDATION PLAN
- FN - 3** THE SLAB SHALL BE 4" CONCRETE SLAB REINFORCED w/ 6X6-1.41.4 WELDED WIRE MESH PLACED ON CHAIRS @ 1 1/2" DEPTH OR FIBER MESH CONCRETE, 6-MIL POLY VAPOR BARRIER w/ 6" LAPS SEALED w/ POLY TAPE OVER TERMITES-TREATED & COMPACTED FILL (ALSO, ANY OTHER CODE APPROVED TERMITES-TREATMENT METHOD CAN BE USED INSTEAD)

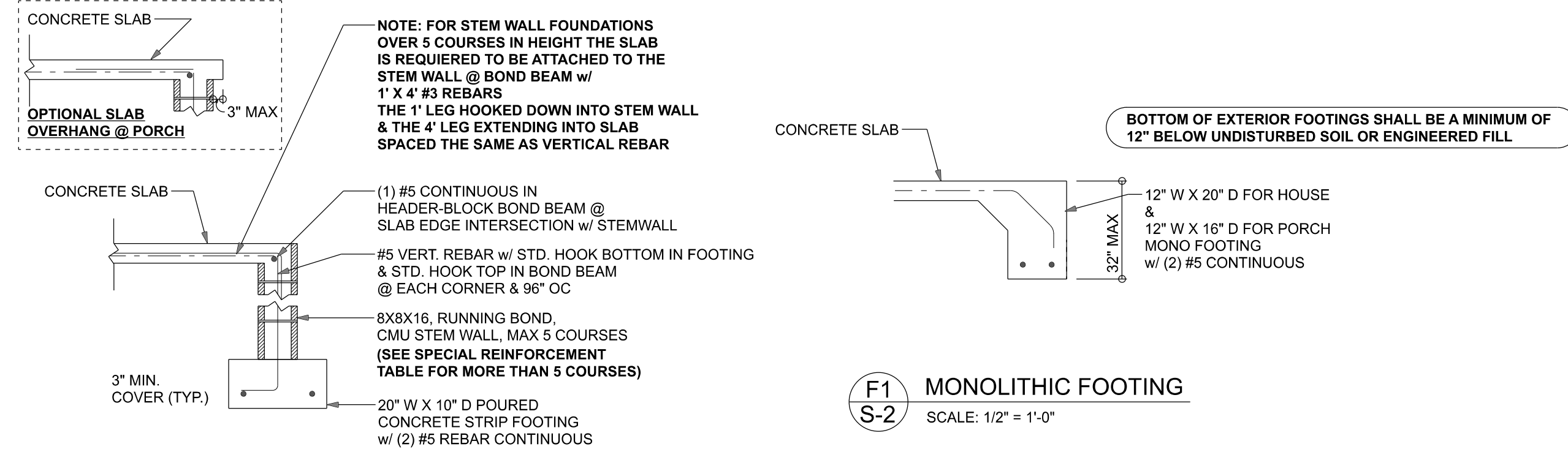

F1 S-2 OPTIONAL STEM WALL FOOTING
SCALE: 1/2" = 1'-0"

Bryan Zecher Homes, Inc.
IN-LAW SUITE FOR
BEN & CAMMY SCOTT
PROJECT ADDRESS:
430 NW Country Lake Dr. Lake City
Columbia County, FL

FL PE 53915
This item has been digitally signed and sealed by Mark Disosway, P.E. on digital signature date. Printed copies of this document are not considered signed and sealed and the signature must be verified on any electronic copies.

DIMENSIONS:
Slated dimensions supersede scaled dimensions. Refer all questions to Mark Disosway, P.E. for resolution. Do not proceed without clarification.

COPYRIGHTS AND PROPERTY RIGHTS:
Mark Disosway, P.E. hereby expressly reserves its common law copyrights and property right in these instruments of service. This document is not to be reproduced, altered or copied in any form or manner without first the express written permission and consent of Mark Disosway.

CERTIFICATION: I hereby certify that I have examined this plan, and that the applicable portions of the plan, relating to wind engineering comply with the 8th Edition Florida Building Code Residential (2023) to the best of my knowledge.

LIMITATION: This design is valid for one building, at specified location.

Mark Disosway P.E.
163 SW Midtown Place
Suite 103
Lake City, Florida 32025
386.754.5419
disoswaydesign@gmail.com

JOB NUMBER:
250773

S-2
OF 2 SHEETS