

46692



INSURED : DAVID MCKINZEY
 LOCATION : 399 SW County Road 138
 : Fort White, FL 32038-2447
 COMPANY : Florida Farm Bureau
 : P.O. Box 147033
 : Gainesville, FL 32614-7033

DATE OF REPORT : 5/29/2020
 DATE OF LOSS : 5/22/2020
 POLICY NUMBER : [REDACTED]
 CLAIM NUMBER : 09P01196508
 OUR FILE NUMBER : 09P01196508
 ADJUSTER NAME : Geoffrey Patterson

Main Grouping: Emergency Services
 Estimate Section: Emergency Services

Quantity	Description	Unit Cost	RCV	DEP	ACV
1.0 EA	Tree Removal	[REDACTED]	[REDACTED]		[REDACTED]
1.0 EA	Tree Debris Removal from Premises	[REDACTED]	[REDACTED]		[REDACTED]
1.0 EA	Emergency Tarp	[REDACTED]	[REDACTED]		[REDACTED]
Totals For Emergency Services				\$0.00	[REDACTED]

Main Grouping: Roof
 Estimate Section: Roof

Square/Rectangle: 1.96 SQ (Rectangle: 12' 9.0" x 15' 4.0")
 Square/Rectangle: 1.61 SQ (Rectangle: 10' 6.0" x 15' 4.0")
 Total Squares: 3.57 SQ (3.57 with 0.00% waste)

Quantity	Description	Unit Cost	RCV	DEP	ACV
357.0 SF	Remove and Replace Roof - Sheathing	[REDACTED]	[REDACTED]		[REDACTED]
2.0 LF	Install From Roof Up Chimney	[REDACTED]	[REDACTED]		[REDACTED]
4.0 SQ	R&R Metal Roofing Complete job including tax	[REDACTED]	\$2,000.00		[REDACTED]
Totals For Roof				\$0.00	[REDACTED]

Main Grouping: Roof
 Estimate Section: Roof Structure

Quantity	Description	Unit Cost	RCV	DEP	ACV
357.0 SF	Remove and Replace 24" O.C. Roof Framing System Roof Framing	[REDACTED]	\$2,200.00		[REDACTED]
36.0 LF	Remove and Replace 2" x 6" Outriggers	[REDACTED]	[REDACTED]		[REDACTED]
22.0 LF	Remove and Replace 2" x 6" Lookout Rafter	[REDACTED]	[REDACTED]		[REDACTED]
31.0 LF	Remove and Replace 2" x 6" Fly Rafter	[REDACTED]	[REDACTED]		[REDACTED]
Totals For Roof Structure				\$0.00	[REDACTED]

Main Grouping: Exterior
 Estimate Section: South Elevation

Square/Rectangle: 200.00 SF (Rectangle: 25' x 8')
 Triangle: 50.00 SF (Triangle: 25' x 4' High)
 Window (DEDUCT): -12.00 SF
 Total Wall SQFT: 238.00 SF

Quantity	Description	Unit Cost	RCV	DEP	ACV
50.0 SF	Remove and Replace 2" x 4" Per SF Wall Framing System	[REDACTED]	[REDACTED]		[REDACTED]

*** This is an estimate of recorded damages and is subject to review and final approval by the insurance carrier. ***



INSURED : DAVID MCKINZEY
 LOCATION : 399 SW County Road 138
 : Fort White, FL 32038-2447
 COMPANY : Florida Farm Bureau
 : P.O. Box 147033
 : Gainesville, FL 32614-7033

DATE OF REPORT : 5/29/2020
 DATE OF LOSS : 5/22/2020
 POLICY NUMBER : HO 8553803
 CLAIM NUMBER : 09P01196508
 OUR FILE NUMBER : 09P01196508
 ADJUSTER NAME : Geoffrey Patterson

Estimate Section: Exterior : South Elevation - Continued...

Quantity	Description	Unit Cost	RCV	DEP	ACV
50.0 SF	Remove and Replace Rigid Polysocyanurate Sheathing - Exterior Wall - Insulation	\$2.00			\$1,000.00
238.0 SF	Remove and Replace Tyvek (House Wrap) Exterior Wall - Insulation	\$2.00			\$476.00
238.0 SF	Remove and Replace Vinyl Exterior Wall - Siding	\$2.00			\$476.00
54.0 LF	Remove and Replace Vinyl Exterior Fascia	\$2.00			\$108.00
23.0 LF	Remove and Replace 2" x 6" Pine Exterior Fascia	\$2.00			\$46.00
108.0 SF	Remove and Replace Vinyl Exterior Soffit	\$2.00			\$216.00
1.0 PR	Remove and Reinstall Exterior Shutters	\$11.22			\$11.22
25.0 LF	Remove and Replace Gutter/Downspout 5"	\$4.50			\$112.50
Totals For South Elevation				\$0.00	\$1,268.72

Main Grouping: Interior
Estimate Section: Kitchen

Kitchen 10' x 10' x 8'
 Window 4' x 3' (Sill @ 4')
 Window 4' x 3' (Sill @ 4')
 Opening 10' x 8'

Lower Perimeter: 30.00 LF Floor SF: 100.00 SF Wall SF: 216.00 SF
 Upper Perimeter: 40.00 LF Floor SY: 11.11 SY Ceiling SF: 100.00 SF

Quantity	Description	Unit Cost	RCV	DEP	ACV
100.0 SF	Mildewcide Ceiling Treatment				
25.0 SF	Remove and Replace Ceiling Insulation				
25.0 SF	Remove and Replace Ceiling Drywall on Wood Framing				
100.0 SF	Texture Ceiling				
75.0 SF	Scrape Texture Ceiling				
100.0 SF	Seal and Paint Ceiling (2 coat)				
1.0 EA	Remove and Reinstall Ceiling Fan				
6.0 EA	Remove and Reinstall Ceiling / Wall Light Fixture				
1.0 EA	Remove and Reinstall Supply Grille				
100.0 SF	Open Floor Area Move and Reset Contents				
100.0 SF	Cover and Protect Floors				
216.0 SF	Cover and Protect Walls				
Totals For Kitchen				\$0.00	\$500.00

*** This is an estimate of recorded damages and is subject to review and final approval by the insurance carrier. ***



INSURED : DAVID MCKINZEY
 LOCATION : 399 SW County Road 138
 : Fort White, FL 32038-2447
 COMPANY : Florida Farm Bureau
 : P.O. Box 147033
 : Gainesville, FL 32614-7033

DATE OF REPORT : 5/29/2020
 DATE OF LOSS : 5/22/2020
 POLICY NUMBER : HO 8553803
 CLAIM NUMBER : 09P01196508
 OUR FILE NUMBER : 09P01196508
 ADJUSTER NAME : Geoffrey Patterson

Main Grouping: Interior
Estimate Section: Living Room

Living Room 18' 10.0" x 23' 11.0" x 8'
 (14' High at 9' 5.0")
 Opening 10' x 8'
 Opening 11' 2.0" x 7'
 Door 2' 6.0" x 6' 8.0"
 Door 2' 6.0" x 6' 8.0"
 Opening 3' x 7'
 Opening 8' 1.0" x 8'

Lower Perimeter: 48.30 LF Floor SF: 450.40 SF Wall SF: 519.80 SF
 Upper Perimeter: 92.50 LF Floor SY: 50.04 SY Ceiling SF: 534.10 SF

Quantity	Description	Unit Cost	RCV	DEP	ACV
130.0 SF	Texture Walls	\$21.50	\$2,795.00		\$2,795.00
389.9 SF	Seal and Paint Walls (2 coats)	\$5.70	\$2,222.43		\$2,222.43
1.0 EA	Remove and Reinstall Ceiling Fan	\$2,000.00	\$2,000.00		\$2,000.00
1.0 EA	Remove and Reinstall Chandelier	\$200.00	\$200.00		\$200.00
4.0 EA	Remove and Reinstall Supply Grille	\$54.38	\$217.52		\$217.52
450.4 SF	Open Floor Area Move and Reset Contents	\$250.00	\$112,600.00		\$112,600.00
450.4 SF	Cover and Protect Floors	\$5.70	\$2,567.28		\$2,567.28
Totals For Living Room			\$118,382.23	\$0.00	\$118,382.23

Main Grouping: General
Estimate Section: General

Quantity	Description	Unit Cost	RCV	DEP	ACV
1.0 EA	Dumpster Rental	\$2,000.00	\$2,000.00		\$2,000.00
1.0 EA	Engineering Fees	\$1,000.00	\$1,000.00		\$1,000.00
1.0 EA	Permit	\$2,000.00	\$2,000.00		\$2,000.00
Totals For General			\$5,000.00	\$0.00	\$5,000.00

Repair Item Totals	\$118,382.23	\$118,382.23
Less Non-OHP Trades	(1,850.00)	(\$1,850.00)
SubTotal For OHP	\$116,532.23	\$116,532.23
General Contractor's Overhead (10.0%)	\$11,653.22	\$11,653.22
General Contractor's Profit (10.0%)	\$11,653.22	\$11,653.22
Plus Non-OHP Trades	\$2,850.00	\$2,850.00
Estimate Totals With OHP	\$142,651.77	\$142,651.77
Applicable Sales Tax	\$1,753.37	\$1,753.37
Estimate Grand Totals	\$144,405.14	\$144,405.14
Policy Deductible	(1,000.00)	\$1,000.00
BUILDING FINAL TOTALS	\$143,405.14	\$143,405.14

*** This is an estimate of recorded damages and is subject to review and final approval by the insurance carrier. ***



INSURED : DAVID MCKINZEY
LOCATION : 399 SW County Road 138
Fort White, FL 32038-2447
COMPANY : Florida Farm Bureau
P.O. Box 147033
Gainesville, FL 32614-7033

DATE OF REPORT : 5/29/2020
DATE OF LOSS : 5/22/2020
POLICY NUMBER : ██████████
CLAIM NUMBER : 09P01196508
OUR FILE NUMBER : 09P01196508
ADJUSTER NAME : Geoffrey Patterson

ROOF

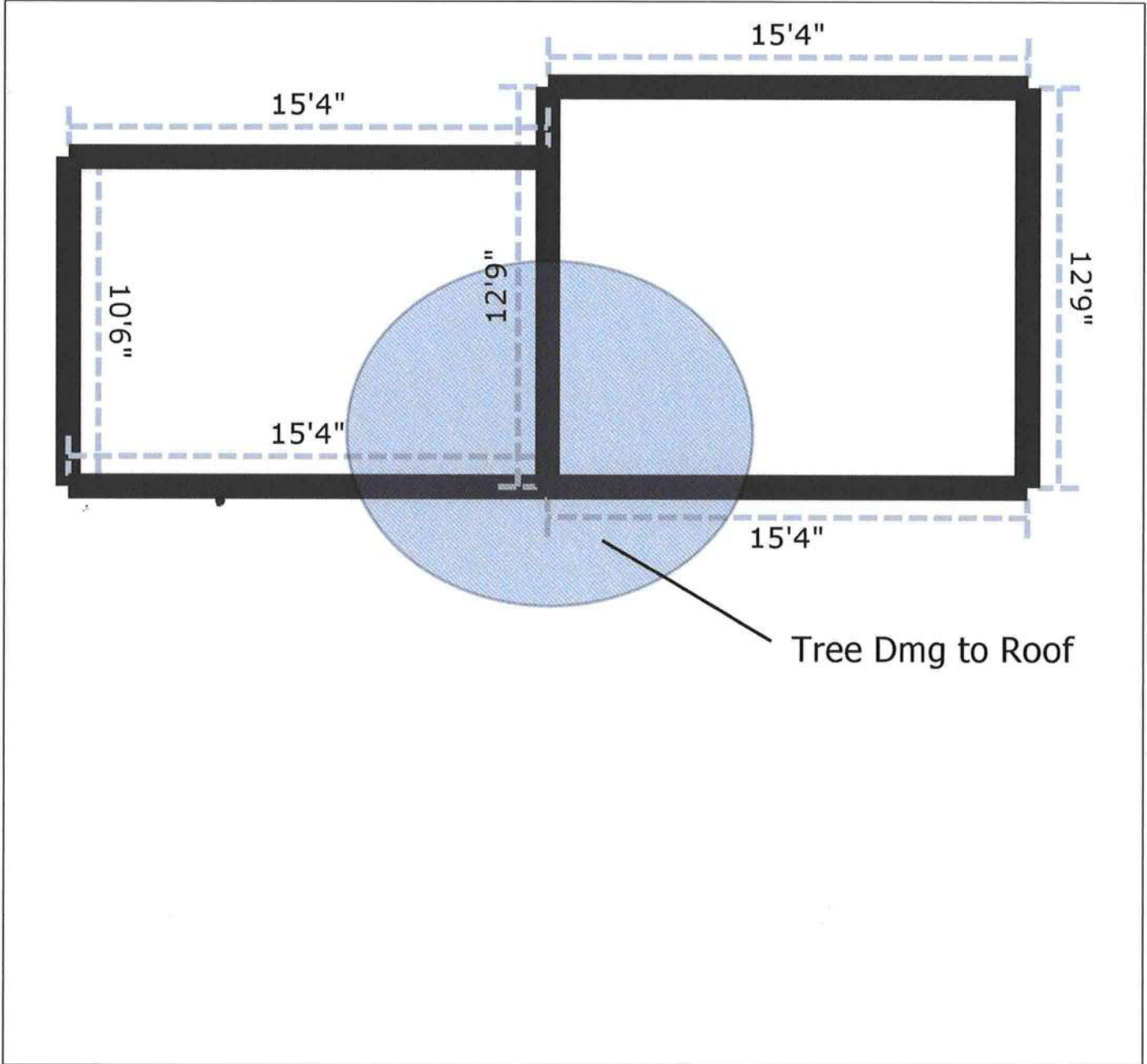

--



INSURED : DAVID MCKINZEY
LOCATION : 399 SW County Road 138
Fort White, FL 32038-2447
COMPANY : Florida Farm Bureau
P.O. Box 147033
Gainesville, FL 32614-7033

DATE OF REPORT : 5/29/2020
DATE OF LOSS : 5/22/2020
POLICY NUMBER : ██████████
CLAIM NUMBER : 09P01196508
OUR FILE NUMBER : 09P01196508
ADJUSTER NAME : Geoffrey Patterson

INTERIOR

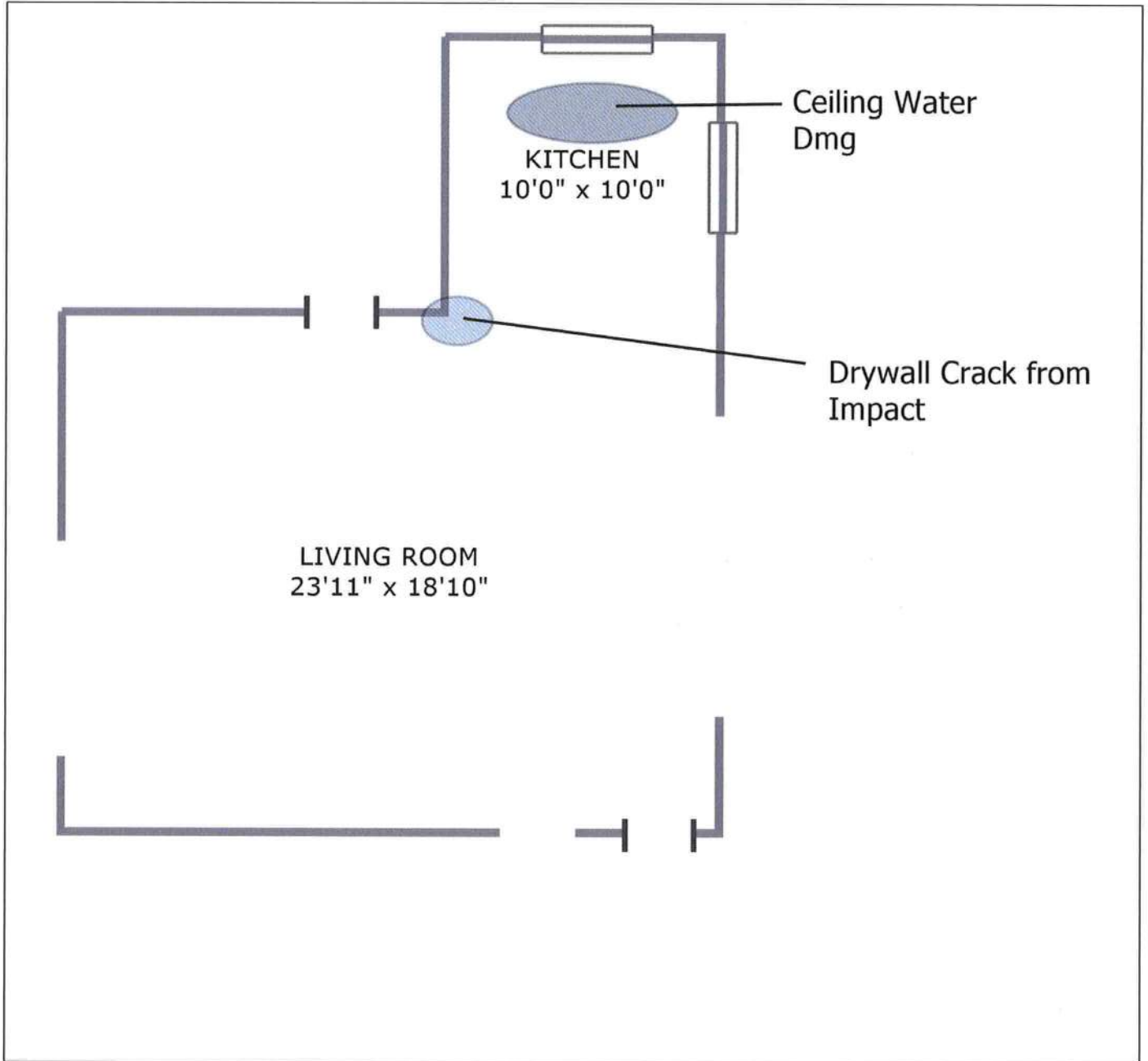

--