

*Jessie Payne*

**PRODUCT APPROVAL SPECIFICATION SHEET**

As required by Florida Statute 553.842 and Florida Administrative Code 9B-72, please provide the information and approval numbers on the building components listed below if they will be utilized on the construction project for which you are applying for a building permit. We recommend you contact your local product supplier should you not know the product approval number for any of the applicable listed products. Statewide approved products are listed online at [www.floridabuilding.org](http://www.floridabuilding.org)

CATEGORY/SUBCATEGORY	MANUFACTURER	PRODUCT DESCRIPTION	APPROVAL NUMBERS(S)
<b>1. EXTERIOR DOORS</b>			
A. SWINGING			
B. SLIDING			
C. SECTIONAL/ROLL UP			
D. OTHER			
<b>2. WINDOWS</b>			
A. SINGLE/DOUBLE HUNG	<i>MI</i>	<i>Single Hung/Dual Pane</i>	<i>PL# 47886-R4</i>
B. HORIZONTAL SLIDER			
C. CASEMENT			
D. FIXED			
E. MULLION			
F. SKYLIGHTS			
G. OTHER			
<b>3. PANEL WALL</b>			
A. SIDING			
B. SOFFITS			
C. STOREFRONTS			
D. GLASS BLOCK			
E. OTHER			
<b>4. ROOFING PRODUCTS</b>			
A. ASPHALT SHINGLES			
B. NON-STRUCT METAL			
C. ROFFING TILES			
D. SINGLE PLY ROOF			
E. OTHER			
<b>5. STRUCT COMPONENTS</b>			
A. WOOD CONNECTORS			
B. WOOD ANCHORS			
C. TRUSS PLATES			
D. INSULATION FORMS			
E. LINTELS			
F. OTHERS			
<b>6. NEW EXTERIOR</b>			
A. ENVELOPE PRODUCTS			

The products listed below did not demonstrate product approval at plan review. I understand that at the time of inspection of these products, the following information must be available to the inspector on the jobsite; (1) copy of the product approval (2) performance characteristics which the product was tested and certified to comply with (3) copy of the applicable manufacturer's installation requirements. Further, I understand these products may have to be removed if approval cannot be demonstrated during inspection.

*Charlette Johnson*  
 Applicant Signature

*April 29 2025*  
 Date

REVISIONS		DATE	APPROVED
REV	DESCRIPTION	10/17/2023	R.L.
D	REVISED PER NEW CODE		

**NOTES:**

1. THE PRODUCT SHOWN HEREIN IS DESIGNED AND MANUFACTURED TO COMPLY WITH REQUIREMENTS OF THE FORDA BUILDING CODE INCLUDING THE HVHZ.
2. WOOD FRAMING AND MASONRY OPENING TO BE DESIGNED AND ANCHORED TO PROPERLY TRANSFER ALL LOADS TO STRUCTURE. FRAMING AND MASONRY OPENING IS THE RESPONSIBILITY OF THE ARCHITECT OR ENGINEER OF RECORD.
3. WHERE SHIM OR BUCK THICKNESS IS LESS THAN 1-1/2" UNITS MUST BE ANCHORED THROUGH THE FRAME IN ACCORDANCE WITH MANUFACTURER'S PUBLISHED INSTALLATION INSTRUCTIONS. ANCHORS SHALL BE SECURELY FASTENED DIRECTLY INTO MASONRY, CONCRETE OR OTHER STRUCTURAL SUBSTRATE MATERIAL.
4. WHERE WOOD BUCK THICKNESS IS 1-1/2" OR GREATER, BUCK SHALL BE SECURELY ANCHORED THROUGH FRAME TO SECURED WOOD BUCK IN ACCORDANCE WITH MANUFACTURER'S PUBLISHED INSTALLATION INSTRUCTIONS.
5. WHERE 1X BUCK IS NOT BE DISSIMILAR MATERIALS MUST BE SEPARATED WITH APPROVED COATING OR MEMBRANE. SELECTION OF COATING OR MEMBRANE IS THE RESPONSIBILITY OF THE ARCHITECT OR ENGINEER OF RECORD.
6. BUCKS SHALL EXTEND BEYOND UNIT FRAME INTERIOR FACE, SO THAT FULL FRAME SUPPORT IS PROVIDED.
7. SHIM AS REQUIRED AT EACH ANCHOR LOCATION WITH LOAD BEARING SHIM. SHIM WHERE SPACE OF 1/16" OR GREATER OCCURS. MAXIMUM ALLOWABLE SHIM STACK TO BE 1/4".
8. SHIMS SHALL BE LOCATED, IMPELLED AND MADE FROM MATERIALS AND THICKNESS CAPABLE OF SUSTAINING APPLICABLE LOADS.
9. WIND LOAD DURATION FACTOR  $C_d=1.6$  WAS USED FOR WOOD ANCHOR CALCULATIONS.
10. FRAME MATERIAL: EXTRUDED RIB P.V.C.
11. UNITS MUST BE GLAZED PER ASTM E1300.
12. APPROVED IMPACT PROTECTIVE SYSTEM IS REQUIRED FOR THIS PRODUCT IN WIND BORNE DIBRIS REGIONS.

13. FOR ANCHORING THROUGH FRAME INTO WOOD FRAMING OR 2X BUCK USE #8 WOOD SCREWS WITH SUFFICIENT LENGTH TO ACHIEVE A 1 1/4" MINIMUM EMBEDMENT INTO SUBSTRATE. LOCATE ANCHORS AS SHOWN IN ELEVATIONS AND INSTALLATION DETAILS.
14. FOR ANCHORING THROUGH FRAME INTO MASONRY/CONCRETE USE 3/16" TAPCONS WITH SUFFICIENT LENGTH TO ACHIEVE A 1 1/4" MINIMUM EMBEDMENT INTO SUBSTRATE WITH 2" MINIMUM EDGE DISTANCE. LOCATE ANCHORS AS SHOWN IN ELEVATIONS AND INSTALLATION DETAILS.
15. FOR ANCHORING THROUGH FRAME INTO METAL STRUCTURE USE #8 SMS OR SELF DRILLING SCREWS WITH SUFFICIENT LENGTH TO ACHIEVE 3 THREADS MINIMUM BEYOND STRUCTURE INTERIOR WALL. LOCATE ANCHORS AS SHOWN IN ELEVATIONS AND INSTALLATION DETAILS.
16. ALL FASTENERS TO BE CORROSION RESISTANT.
17. INSTALLATION ANCHORS SHALL BE INSTALLED IN ACCORDANCE WITH ANCHOR MANUFACTURER'S INSTALLATION INSTRUCTIONS AND ANCHORS SHALL NOT BE USED IN SUBSTRATES WITH STRENGTHS LESS THAN THE MINIMUM STRENGTH SPECIFIED BELOW
  - 17.1. WOOD: MINIMUM SPECIFIC GRAVITY OF G=0.42
  - 17.2. CONCRETE: MINIMUM COMPRESSIVE STRENGTH OF 2,000 PSI.
  - 17.3. MASONRY: HOLLOW/FILLED BLOCK PER ASTM C90 WITH  $F_m=2,000$  PSI MINIMUM.
  - 17.4. METAL STRUCTURE: STEEL 18GA (.046")  $F_y=33$  KSI/FU=62 KSI OR ALUMINUM 6061-T5 FU=30 KSI 1/8" THICK MINIMUM

PL # 47886-R4

SGND: 10/17/2023



Luis R. Lomaspe P.E.  
L. No.: 62514

**MI WINDOWS AND DOORS, LLC**  
650 WEST MARKET STREET  
GRATZ, PA 17030-0370

SERIES 3240/3540 FLANGE OVC SINGLE HUNG  
STEEL REINFORCED WINDOW NON-IMPACT 36"x74"

NOTES

DRWING: T.J.H.  
SCALE: NTS  
DATE: 05/23/11  
REV: D  
DWG NO: 08-01252  
SHEET 1 OF 9

L. ROBERTO LOMASPE  
208 7th Ave. NW, ATLANTA, GA 30309  
404-699-0909  
rlomaspe@miwdp.com

TABLE OF CONTENTS	
SHEET NO.	DESCRIPTION
1	NOTES
2	ELEVATION
3 - 8	INSTALLATION DETAILS
9	COMPONENTS

REVISIONS

REV	DESCRIPTION	DATE	APPROVED
D	REVISED PER NEW CODE	10/17/2023	R.L.

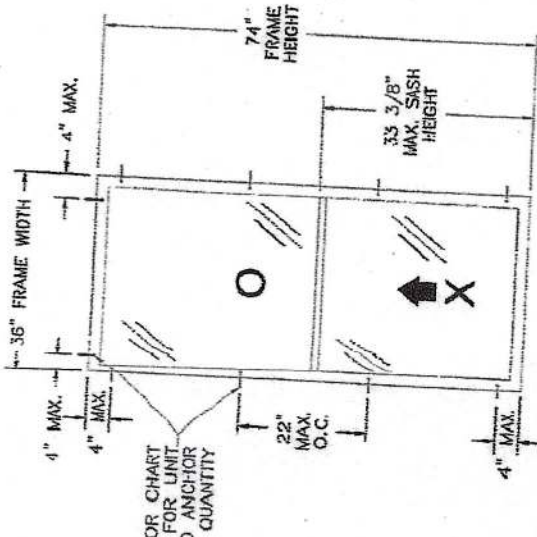

SEE ANCHOR CHART  
THIS SHEET FOR UNIT  
SIZE AND ANCHOR  
QUANTITY

**SERIES 3240/3540 FLANGE PVC SINGLE HUNG WINDOW**  
EXTERIOR VIEW

DESIGN PRESSURE RATING	IMPACT RATING
+35.0/-60.0 PSF	NONE

36" X 74" UNIT SHOWN. OTHER SIZES APPROVED AS LONG AS  
FRAME AREA DOES NOT EXCEED 18.5 FT<sup>2</sup>

Frame Height (in)	NUMBER OF ANCHOR LOCATIONS REQUIRED							
	18.00		24.00		30.00		36.00	
	Head	Jamb	Head	Jamb	Head	Jamb	Head	Jamb
24.00	2	2	2	2	2	2	2	2
30.00	2	2	2	2	2	2	2	2
36.00	2	2	2	2	2	2	2	2
42.00	2	3	2	3	2	3	2	3
48.00	2	3	2	3	2	3	2	3
54.00	2	3	2	3	2	3	2	3
60.00	2	3	2	3	2	3	2	3
66.00	2	3	2	3	2	3	2	3
72.00	2	3	2	3	2	3	2	3
74.00	2	3	2	3	2	3	2	3

SIGNED: 10/17/2023

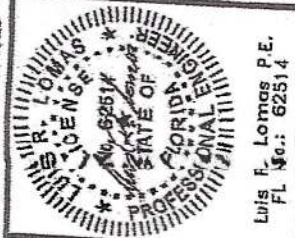

Luis F. Lomas P.E.  
FL No.: 62514

**MI WINDOWS AND DOORS, LLC**  
650 WEST MARKET STREET  
GRATZ, PA 17030-0370

SERIES 3240/3540 FLANGE PVC SINGLE HUNG  
STEEL REINFORCED WINDOW NON-IMPACT 36" X 74"  
ELEVATION

DRW/RT: T.J.H. DWG. NO.: 08-01252 REV: D  
SCALE: NTS DATE: 05/23/11 SHEET: 2 OF 9

L. ROBERTO LOMAS, P.E.  
808 7th Ave. NW  
ALBUQUERQUE, NM 87102  
404-488-6809 rlomas@miwindows.com

REVISIONS			
REV	DESCRIPTION	DATE	APPROVED
D	REVISED PER NEW CODE	10/17/2023	R.L.

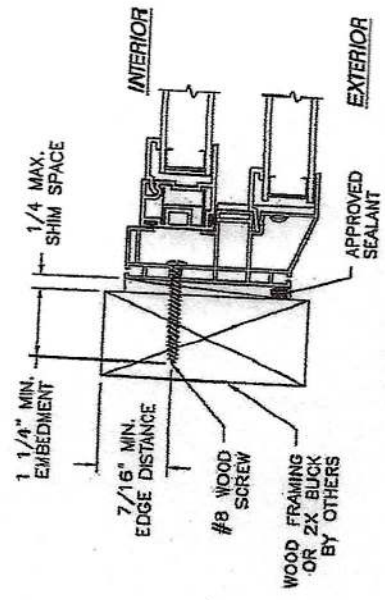
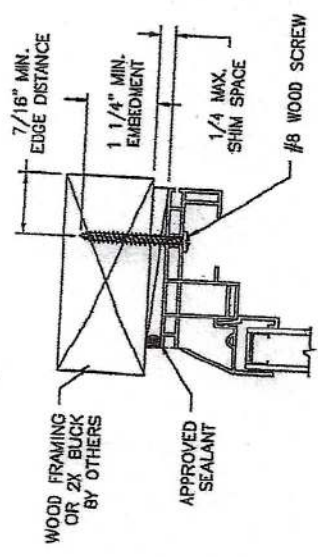

**JAMB INSTALLATION DETAIL**  
WOOD FRAMING OR 2X BUCK INSTALLATION

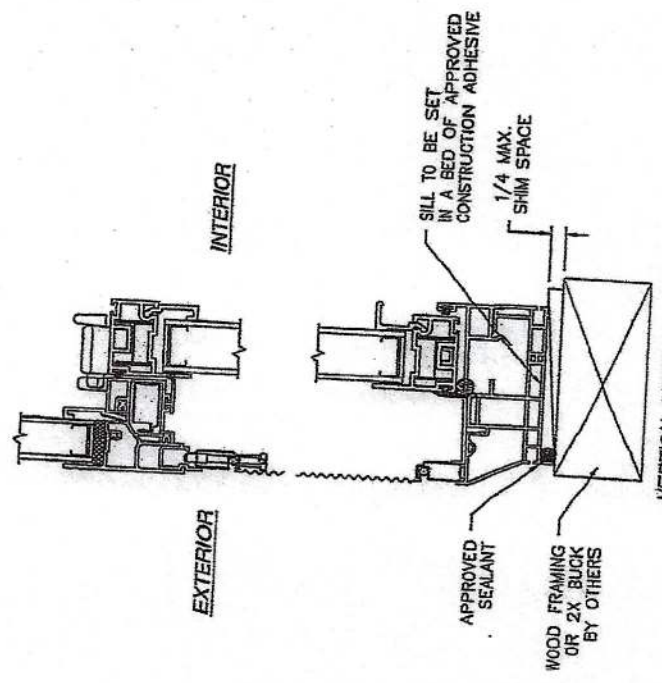

**VERTICAL CROSS SECTION**  
WOOD FRAMING OR 2X BUCK INSTALLATION

- NOTES:**
1. INTERIOR AND EXTERIOR FINISHES, BY OTHERS. NOT SHOWN FOR CLARITY.
  2. PERIMETER AND JOINT SEALANT BY OTHERS TO BE DESIGNED IN ACCORDANCE WITH ASTM E212

SIGNED: 10/17/2023

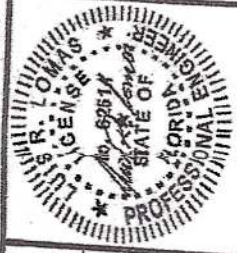

Luis R. Lomas P.E.  
FL No.: 62514

**MI WINDOWS AND DOORS, LLC**  
650 WEST MARKET STREET  
GRATZ, PA 17030-0870

SERIES 3240/3540 FLANGE OIG SINGLE HUNG  
STEEL REINFORCED WINDOW NON-IMPACT 36" X 74"  
INSTALLATION DETAILS

DRWING: T.J.H.  
SCALE: NTS  
DATE: 05/23/11  
REV: D  
DWG NO.: 08-01252  
SHEET 3 OF 9

L. ROBERTO LOMAS PE  
808 7th Ave, INDIANLAND, FL 33069  
404-688-0609 rllomas@miwindows.com

REVISIONS			
REV	DESCRIPTION	DATE	APPROVED
D	REVISED PER NEW CODE	10/17/2023	R.L.

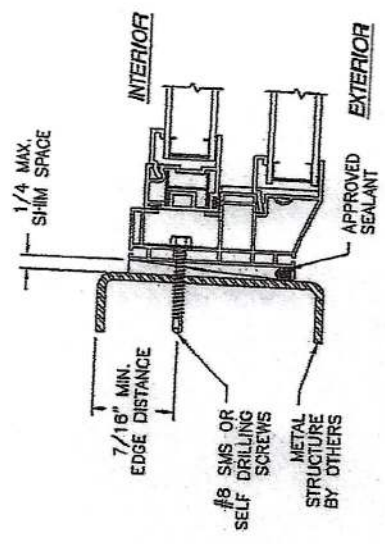
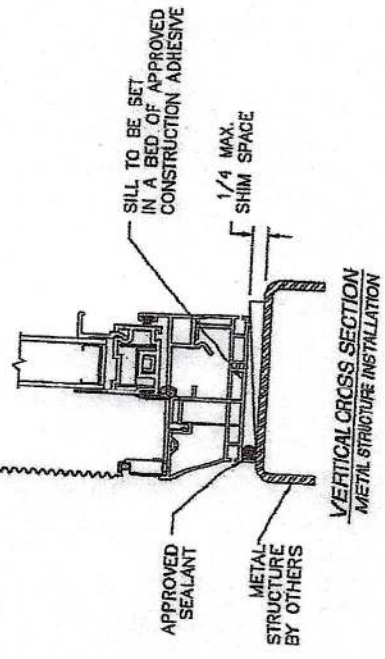
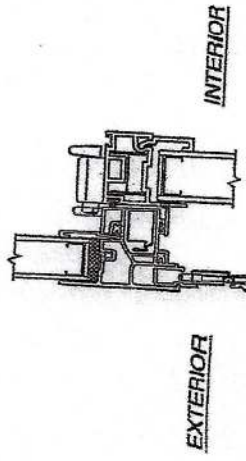
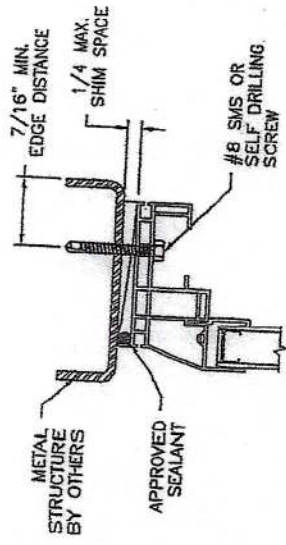

JAMB INSTALLATION DETAIL  
METAL STRUCTURE INSTALLATION

- NOTES:  
 1. INTERIOR AND EXTERIOR FINISHES, BY OTHERS, NOT SHOWN FOR CLARITY.  
 2. PERFORMER AND JOINT SEALANT BY OTHERS TO BE DESIGNED IN ACCORDANCE WITH ASTM E212

SIGNER: 10/17/2023

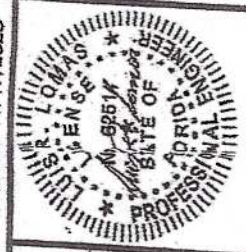

Luis R. Lomas P.E.  
FL No.: 62514

MI WINDOWS AND DOORS, LLC  
 650 WEST MARKET STREET  
 GRATZ, PA 17030-0370

SERIES 3240/3540 FLANGE OVC SINGLE HUNG  
 STEEL REINFORCED WINDOW NON-IMPACT 36"x74"  
 INSTALLATION DETAILS

DRAWN: TJH  
 DATE: 05/23/11  
 SCALE: NTS  
 DIMO NO.: 08-01252  
 SHEET 4 OF 9

L. ROBERTO LOMAS P.E.  
 688 7th Ave, INDIALANTIC, FL 33009  
 434-668-0609 rlomas@miwindows.com

REVISIONS			
REV	DESCRIPTION	DATE	APPROVED
D	REVISED PER NEW CODE	10/11/2023	R.L.

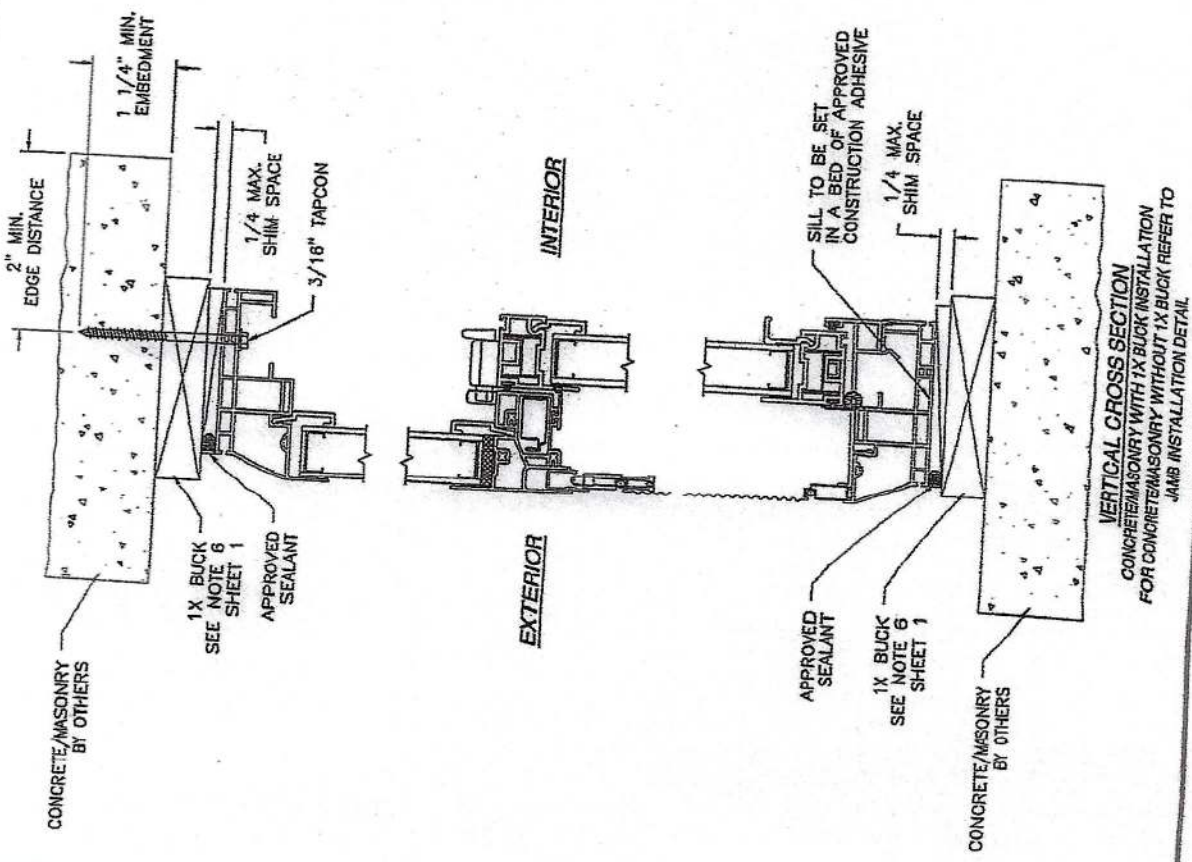

**JAMB INSTALLATION DETAIL**  
 CONCRETE/MASONRY WITHOUT 1X BUCK INSTALLATION  
 FOR CONCRETE/MASONRY INSTALLATION WITH 1X BUCK REFER TO  
 HEAD AND SILL INSTALLATION DETAILS

**NOTES:**  
 1. INTERIOR AND EXTERIOR FINISHES, BY OTHERS,  
 NOT SHOWN FOR CLARITY.  
 2. PERIMETER AND JOINT SEALANT BY OTHERS TO BE  
 DESIGNED IN ACCORDANCE WITH ASTM E2112

**MI WINDOWS AND DOORS, LLC**  
 650 WEST MARKET STREET  
 GRATZ, PA 17030-0370

SERIES 3240/3540 FLANGE OVC SINGLE HUNG  
 STEEL REINFORCED WINDOW NON-IMPACT 36" X 74"  
 INSTALLATION DETAILS

DRAWN: TJH	DWG NO. 08-01252	REV D
SCALE: NTS	DATE: 05/23/11	SHEET 5 OF 9

L. ROBERTO LOMAS P.E.  
 209 7th Ave, INDIANLANTIC, FL 32909  
 404-688-0009 rlomas@lromaspe.com



Luis R. Lomas P.E.  
 FL No.: 62514

SIGNED: 10/17/2023

REVISIONS			
REV	DESCRIPTION	DATE	APPROVED
D	REVISED PER NEW CODE	10/11/2023	R.L.

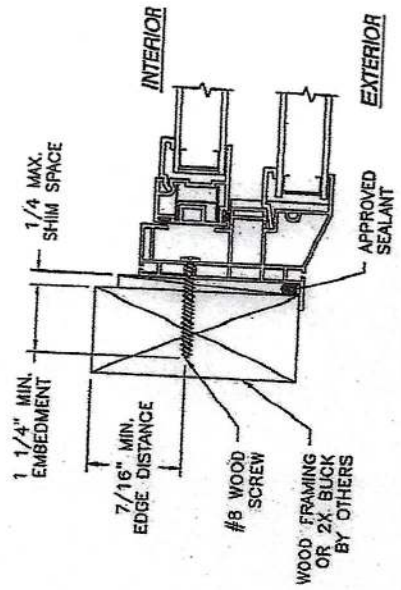
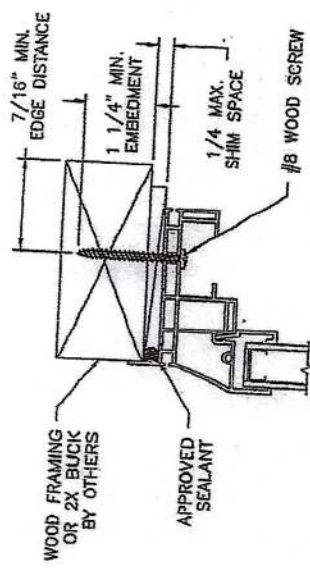

JAMB INSTALLATION DETAIL  
WOOD FRAMING OR 2X BUCK INSTALLATION

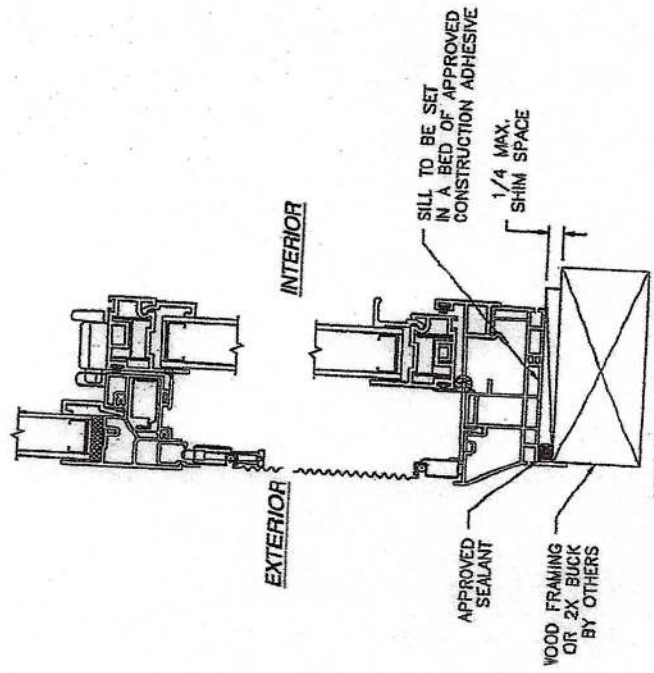

VERTICAL CROSS SECTION  
WOOD FRAMING OR 2X BUCK INSTALLATION

- NOTES:  
1. INTERIOR AND EXTERIOR FINISHES, BY OTHERS. NOT SHOWN FOR CLARITY.  
2. PERIMETER AND JOINT SEALANT BY OTHERS TO BE DESIGNED IN ACCORDANCE WITH ASTM E2112

SIGNED: 10/17/2023



Luis R. Lomas P.E.  
FL No.: 62514

MI WINDOWS AND DOORS, LLC  
650 WEST MARKET STREET  
GRATZ, PA 17030-0370

SERIES 3240/3540 FLANGE OVC SINGLE HUNG  
STEEL REINFORCED WINDOW NON-IMPACT 36"x74"  
FLANGE INSTALLATION DETAILS

DRAWN: T.J.H.  
SCALE: NTS  
DATE: 05/23/11  
SHEET: 6 OF 9

REV: D  
JOB NO.: 08-01252

L. ROBERTO LOMAS PE  
209 7th Ave, INDIANAPOLIS, IN 46203  
414-689-0303 rlomas@miwindows.com

REVISIONS			
REV	DESCRIPTION	DWG	APPROVED
D	REVISED PER NEW CODE	10/11/2023	R.L.

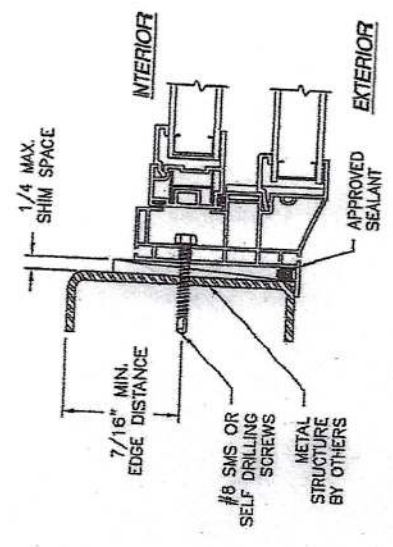
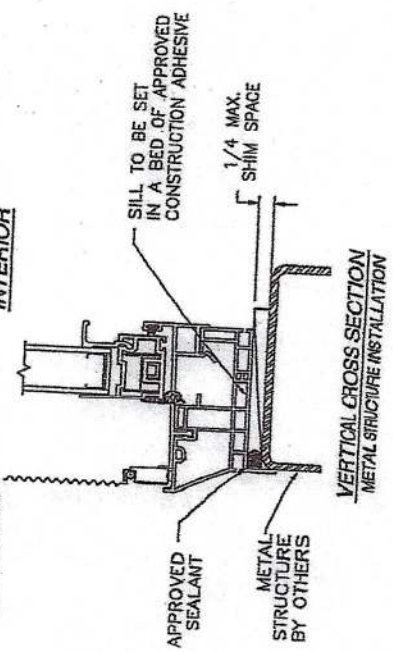
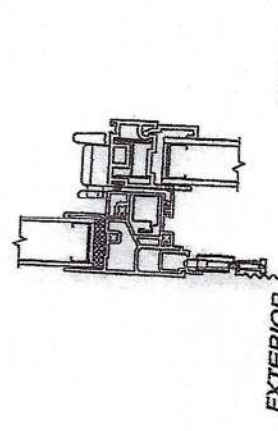
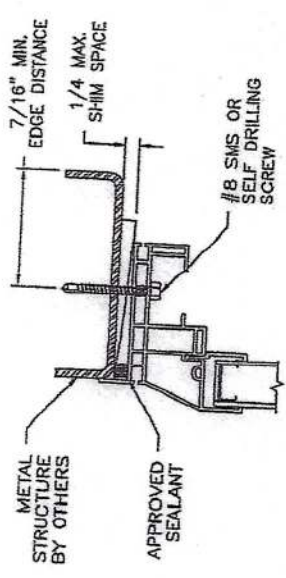

JAMB INSTALLATION DETAIL  
METAL STRUCTURE INSTALLATION

- NOTES:  
1. INTERIOR AND EXTERIOR FINISHES, BY OTHERS NOT SHOWN FOR CLARITY.  
2. PERIMETER AND JOINT SEALANT BY OTHERS TO BE DESIGNED IN ACCORDANCE WITH ASTM E212

SIGNED: 10/17/2023

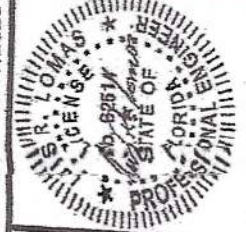

Luis R. Lomas P.E.  
FL No.: 62514

MI WINDOWS AND DOORS, LLC  
650 WEST MARKET STREET  
GRATZ, PA 17030-0370

SERIES 3240/3540 FLANGE OVC SINGLE HUNG  
STEEL REINFORCED WINDOW NON-IMPACT 36" x 74"  
FLANGE INSTALLATION DETAILS

DRAWN: T.J.H.  
SCALE: NTS  
DATE: 05/23/11  
REV: D  
DWG NO.: 08-01252  
SHEET 7 OF 9

L. ROBERTO LOMAS PE  
200 7th Ave. #1044-4070C, R 09093  
434-698-0009  
lrlomas@miwindows.com

REVISIONS			
REV	DESCRIPTION	DATE	APPROVED
D	REVISED PER NEW CODE	10/17/2023	R.L.

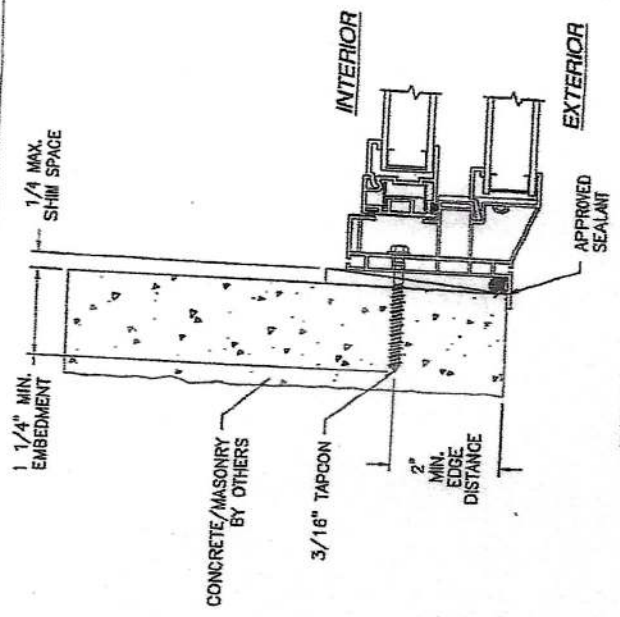
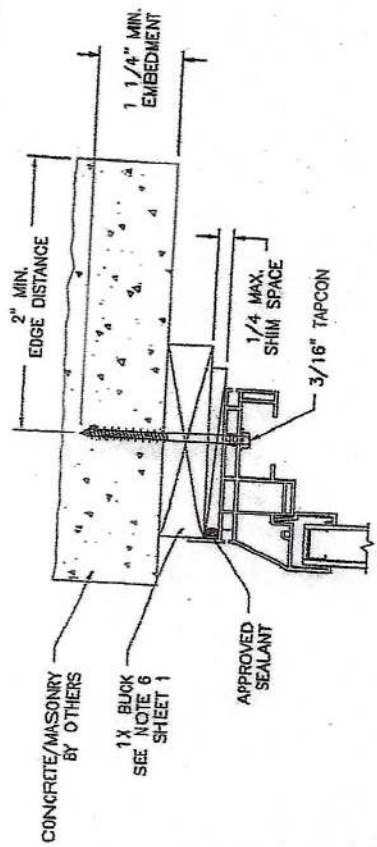

**JAMB INSTALLATION DETAIL**  
 CONCRETE/MASONRY WITHOUT 1X BUCK INSTALLATION  
 FOR CONCRETE/MASONRY INSTALLATION WITH 1X BUCK REFER TO  
 HEAD AND SILL INSTALLATION DETAILS

- NOTES:**
1. INTERIOR AND EXTERIOR FINISHES, BY OTHERS, NOT SHOWN FOR CLARITY.
  2. PERIMETER AND JOINT SEALANT BY OTHERS TO BE DESIGNED IN ACCORDANCE WITH ASTM E2112

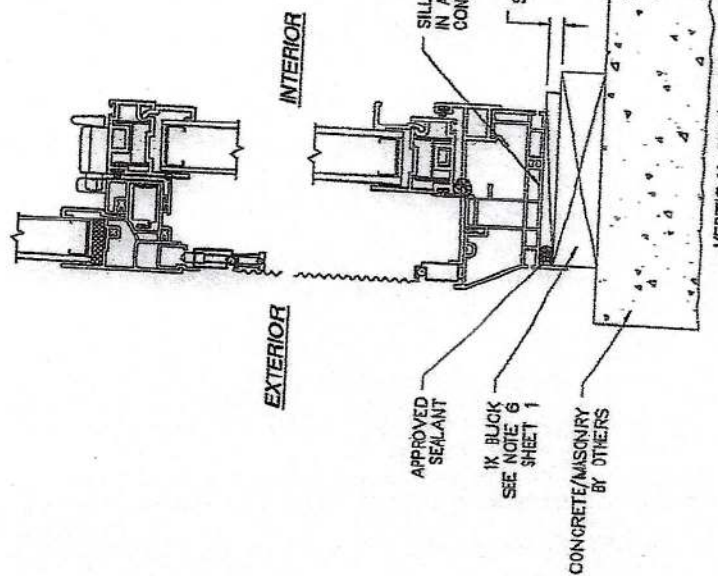

**VERTICAL CROSS SECTION**  
 CONCRETE/MASONRY WITH 1X BUCK INSTALLATION  
 FOR CONCRETE/MASONRY WITHOUT 1X BUCK REFER TO  
 JAMB INSTALLATION DETAIL

SIGNED: 10/17/2023

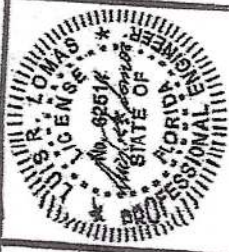

L. Roberto Lomas P.E.  
 FL No.: 62514

**MI WINDOWS AND DOORS, LLC**  
 650 WEST MARKET STREET  
 GRATZ, PA 17030-0370

SERIES 3240/3540 FLANGE OVC SINGLE HUNG  
 STEEL REINFORCED WINDOW NON-IMPACT 36"x74"  
 FLANGE INSTALLATION DETAILS

DRAWN: T.J.H. DATE: 05/23/11 SHEET: OF 9  
 SCALE: NTS. REV: D  
 BING NO. 08-01252

L. ROBERTO LOMAS P.E.  
 204 7th Ave. NW PALM BEACH, FL 33406  
 404-888-0800 /rlomas@miwindows.com

REVISIONS		
REV	DESCRIPTION	DATE
D	REVISED PER NEW CODE	10/17/2023
		R.L.

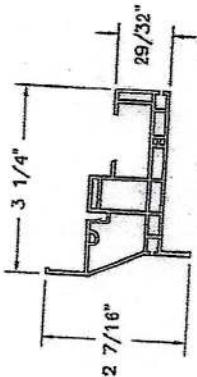

**MAIN FRAME**  
PVC (V-634NF)

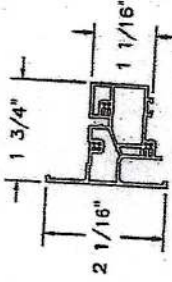

**FIXED MEETING RAIL**  
PVC (V-321)

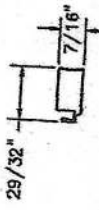

**MEETING RAIL REINFORCEMENT**  
STEEL .016" THICK (RF-104S-020)



**SASH REINFORCEMENT**  
STEEL .020" THICK (SAL-451-020)

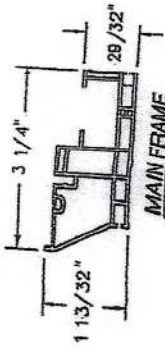

**MAIN FRAME**  
PVC (V-634NF)



**SASH RAIL**  
PVC (V-461)

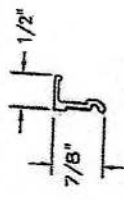

**LIFT BEAD**  
PVC

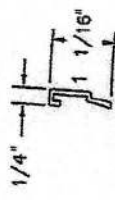

**GLAZING BEAD**  
PVC

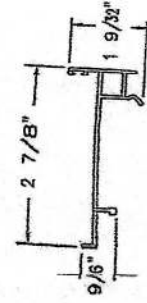

**SNAP IN SILL**  
PVC (V-661)

SIGNED: 10/17/2023



Luis R. Lomas P.E.  
FL No.: 62514

**MI WINDOWS AND DOORS, LLC**  
650 WEST MARKET STREET  
GRATZ, PA 17030-0370

SERIES 3240/3540 FLANGE PVC SINGLE HUNG  
STEEL REINFORCED WINDOW NON-IMPACT 36" x 74"  
COMPONENTS

DRAWN: TJH  
SCALE: NTS  
DATE: 05/23/11  
SHEET: 9 OF 9

REV: D

L. ROBERTO LOMAS PE  
208 7th Ave, MIAMI BEACH, FL 33139  
404-688-0608 rlomas@miwindows.com