

Virginia Bing  
524 SW Jordan Street  
Fort White, FL 32038

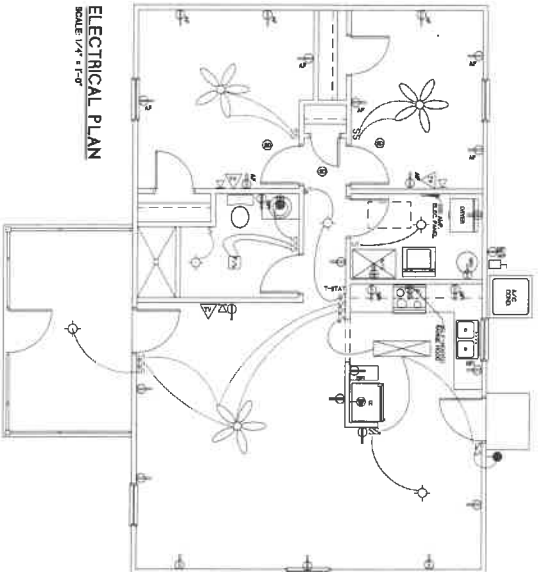
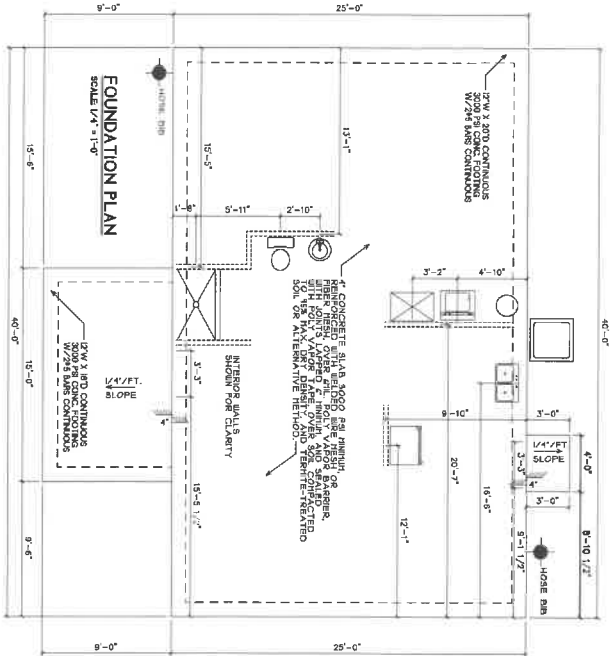
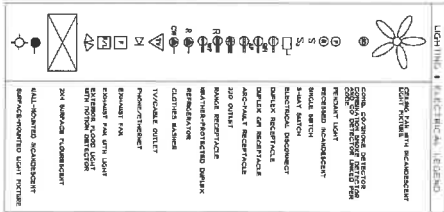
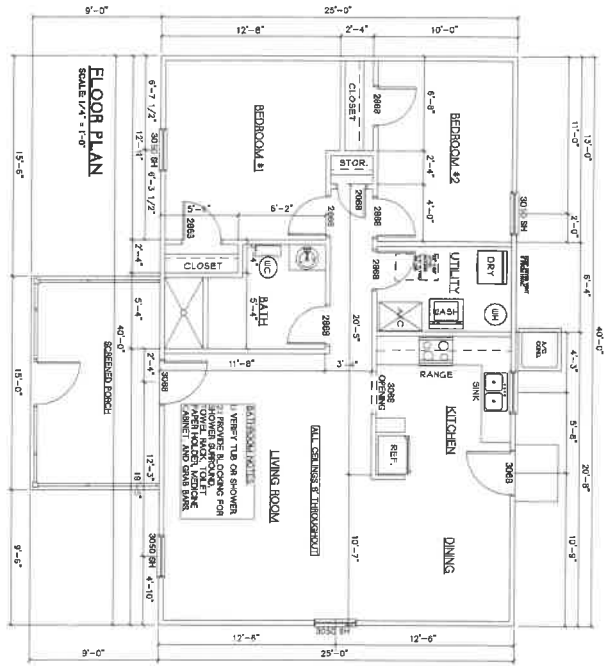

This item has been digitally signed and sealed by FRANK J SAPIENZA JR PE using Digital Signature.  
Printed copies of this document are not considered signed and sealed and the signature must be verified on any electronic copies.

CUSTOMER NAME:

**FLA HOMES, INC. R/C**

13919 NW 145TH AVENUE, ALACHUA, FLORIDA 32615  
(850)418-4863 [flahomes@windstream.net](mailto:flahomes@windstream.net) LICENSE #: CGC 052062

<b>1</b> of <b>2</b> SHEET NUMBER	PLAN NAME: <b>Bay V Model</b>	AREA SUMMARY H/C: 1000 FRONT PORCH: 135 TOTAL: 1195	ALL WORK SHALL COMPLY WITH CURRENT FLORIDA BUILDING AND ELECTRICAL CODE. THESE PLANS AND NOTES ARE THE PROPERTY AND SOLE RESPONSIBILITY OF FLA HOMES, INC. USE OF THESE PLANS WITHOUT THE WRITTEN CONSENT OF FLA HOMES, INC. IS PROHIBITED. THESE PLANS ARE SUBJECT TO AMENDMENT AS NECESSARY TO MEET CODE REQUIREMENTS OR TO FACILITATE THE INSTALLATION OF EQUIPMENT. ANY CHANGES TO THESE PLANS SHALL BE THE RESPONSIBILITY OF THE SUBCONTRACTOR. THE SUBCONTRACTOR SHALL COMPARE AND COORDINATE ALL DRAWINGS, MAKE A SEPARATE CHECK ON GARDEN CISTS, THE SUBCONTRACTOR SHALL COMPLY WITH APPLICABLE LOCAL CODES AND CONTACT THE BLDG DEPT BY WRITING FOR PERMITS.	REVISION DATE JUNE 28, 2025	SUBDIVISION: LOT #	PAGE CONTENT: <b>FLOOR PLAN ELECTRICAL PLAN FOUNDATION PLAN KITCHEN CABINET LAYOUT</b>
	SCALE: <b>1/4" = 1'-0"</b> UNLESS OTHERWISE NOTED	DRAWN BY: FRANK J. SAPIENZA JR. PE No. 48566 STATE OF FLORIDA				

