

THERMA TRU[®] DOORS

Fiber-Classic[®] & Smooth-Star[®]

COMPOSITE EDGE OPAQUE FIBERGLASS SINGLE DOOR w/ SIDELITE(S) IN SWING/OUT SWING "NON-IMPACT"

GENERAL NOTES

1. This product has been evaluated and is in compliance with the 7th Edition (2020) Florida Building Code (FBC) structural requirements excluding the "High Velocity Hurricane Zone" (HVHZ).
2. Product anchors shall be as listed and spaced as shown on details. Anchor embedment to base material shall be beyond wall dressing or stucco.
3. When used in areas requiring wind borne debris protection, this product is required to be protected with an impact resistant covering that complies with FBC Sections 1609.1.2 & R301.2.1.2 as follows: Wind Zones 1, 2 & 3: Glazed Sidelites only; Wind Zone 4: Entire System.
4. For 2x stud framing construction, anchoring of these units shall be the same as that shown for 2x buck masonry construction.
5. Site conditions that deviate from the details of this drawing require further engineering analysis by a licensed engineer or registered architect.
6. Fiber-Classic & Smooth-Star Door and Sidelite panels require the use of "J" part numbers and must be stained or painted within six months of installation.

TABLE OF CONTENTS	
SHEET #	DESCRIPTION
1	Typical Elevations, Design Pressures & General Notes
2	Door Panel Details
3	Sidelite Panel Details
4	Elevations
5	Horizontal & Vertical Cross Sections (2X Buck)
6	Horizontal & Vertical Cross Sections (1X Buck)
7	Horizontal & Vertical Cross Sections (Direct to Masonry)
8	Vertical Cross Sections (Thresholds)
9	Buck Anchoring
10	Frame Anchoring
11	Hardware Details
12	Glazing Details
13	Components
14	Bill of Materials

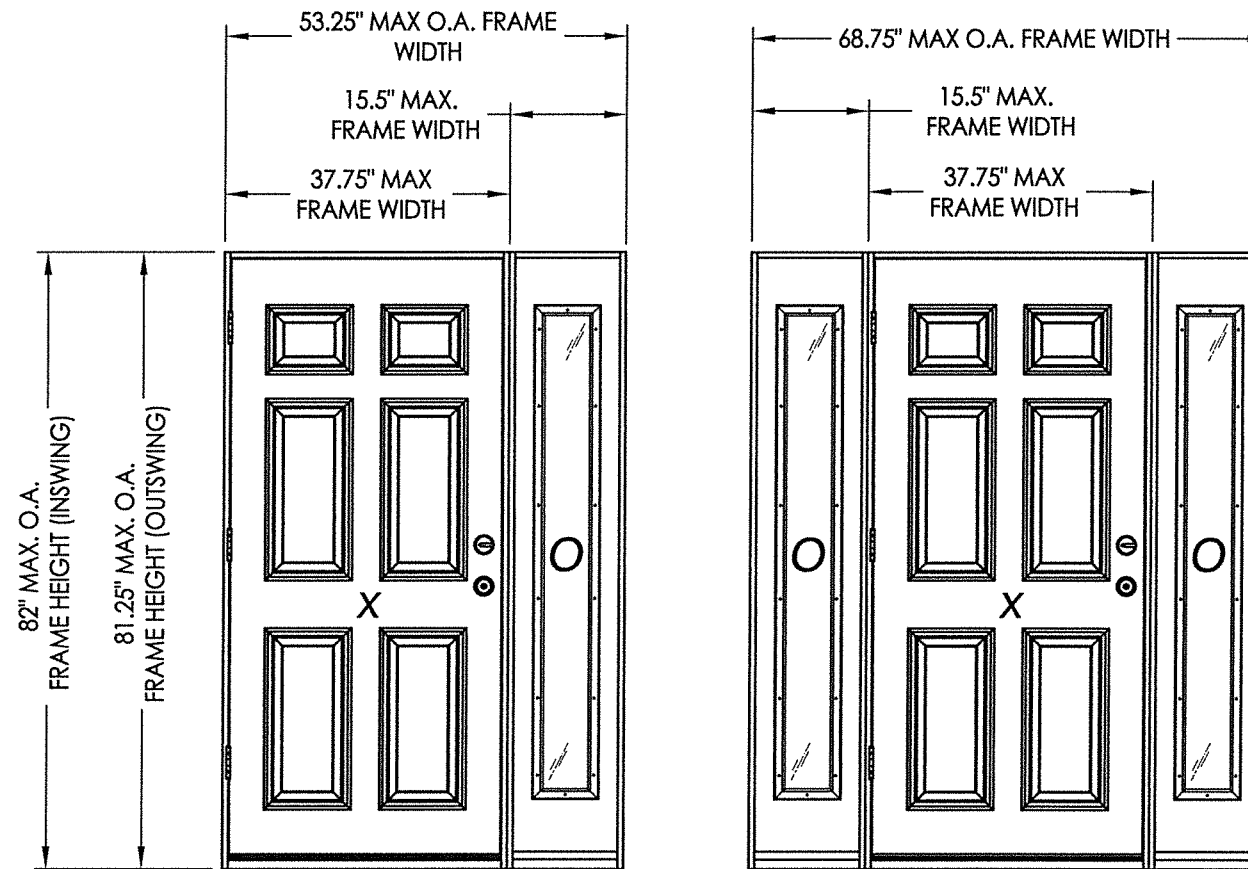

CONFIGURATION	DESIGN PRESSURE (PSF) IN SWING		DESIGN PRESSURE (PSF) OUT SWING	
	POSITIVE	NEGATIVE	POSITIVE	NEGATIVE
XO, OX, OXO	+45.0	-50.0	+45.0	-45.0

See Sheet 4 for Hardware Specifications

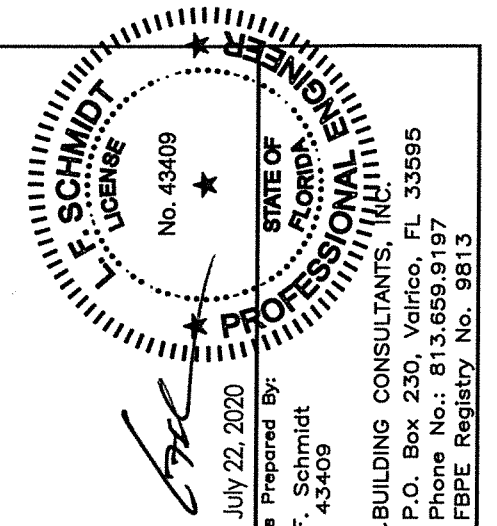

July 22, 2020
Documents Prepared By:
Lyndon F. Schmidt
P.E. No. 43409

R.W. BUILDING CONSULTANTS, INC.
P.O. Box 230, Vairico, FL 33595
Phone No.: 813.659.9197
FBPE Registry No. 9813

PRODUCT:		THERMA-TRU FIBERGLASS DOOR	
PART OR ASSEMBLY:		TYPICAL ELEVATION, DESIGN PRESSURES & GENERAL NOTES	
NO.	DATE	BY	REVISIONS
4	7/21/20	LFS	UPDATE TO 7th ED (2020) FBC
3	10/09/18	MT	REV. DOOR PANEL OPTION NOTE
2	11/15/17	JK	RECESSED PANEL NOTATION
1	7/7/17	JK	UPDATE TO 6th ED (2017) FBC
DATE: 8/10/16			
SCALE: N.T.S.			
DWG. BY: JK			
CHK. BY: LFS			
DRAWING NO.: FL-20461.2			
SHEET 1 OF 14			

R:\Clients\Therma Tru PERMANENTVA - Florida Product Approvals\FL-20461 Structural TT SSC - Drawings\FL 20461 (2020)\FL-20461.1-5.dwg, 2.2

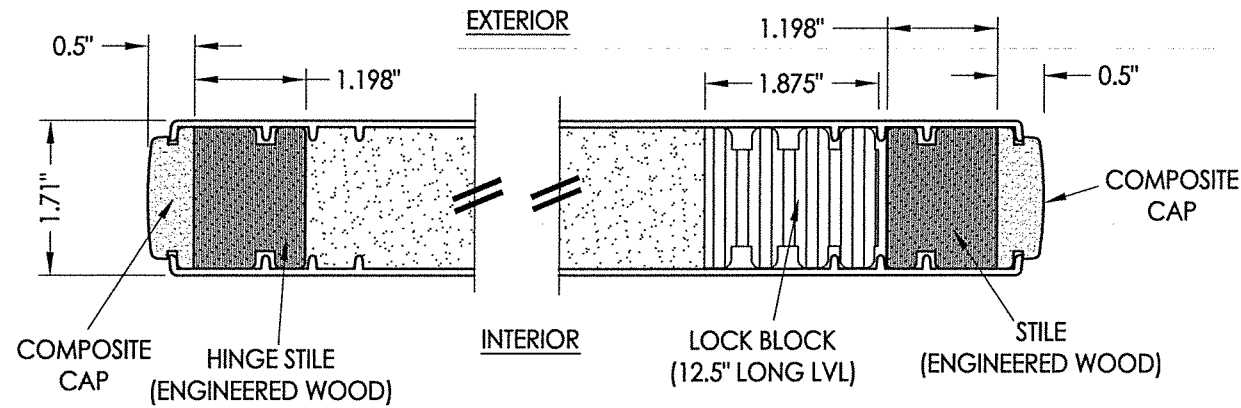

1
2 HORIZONTAL CROSS SECTION

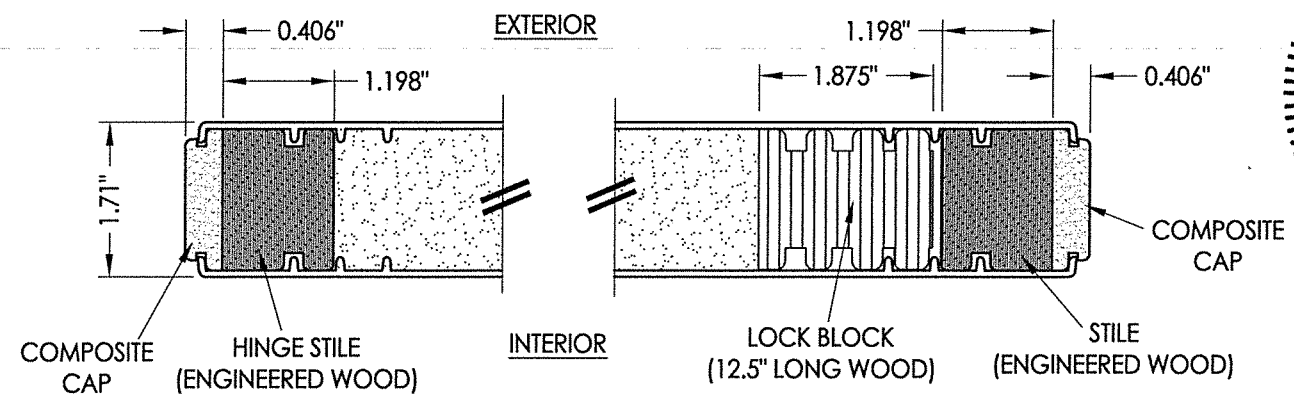

2
2 HORIZONTAL CROSS SECTION

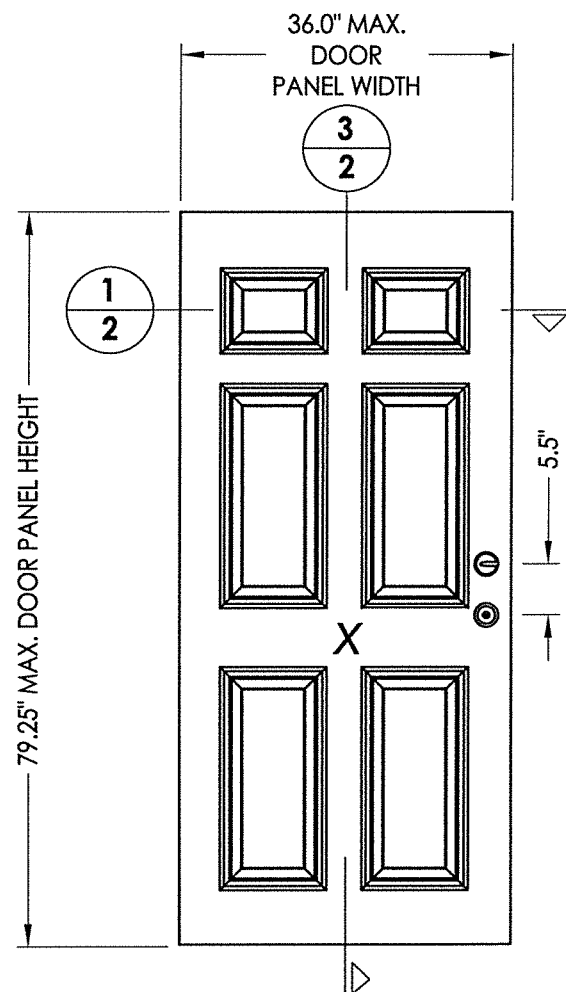

40 DOOR PANEL BOOK

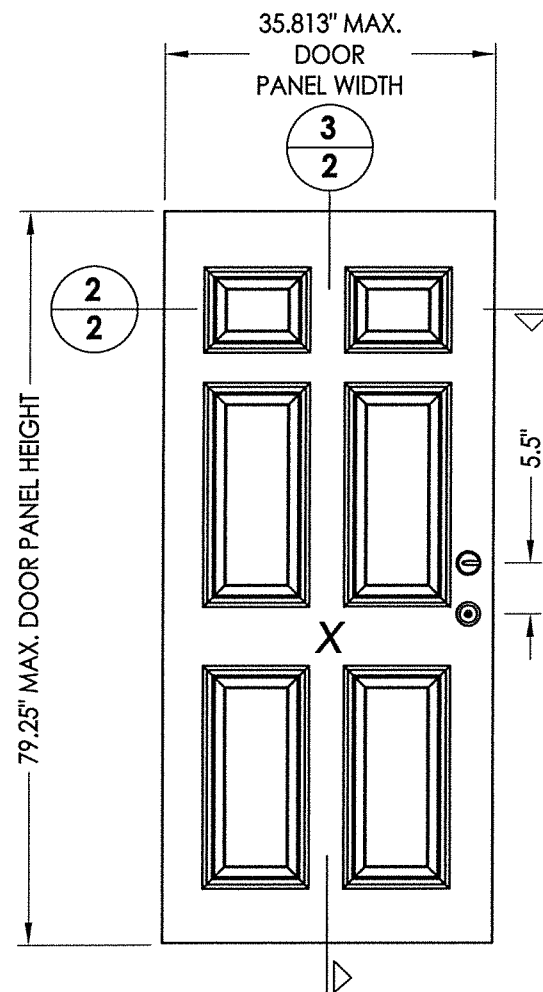

41 DOOR PANEL Hybrid Door

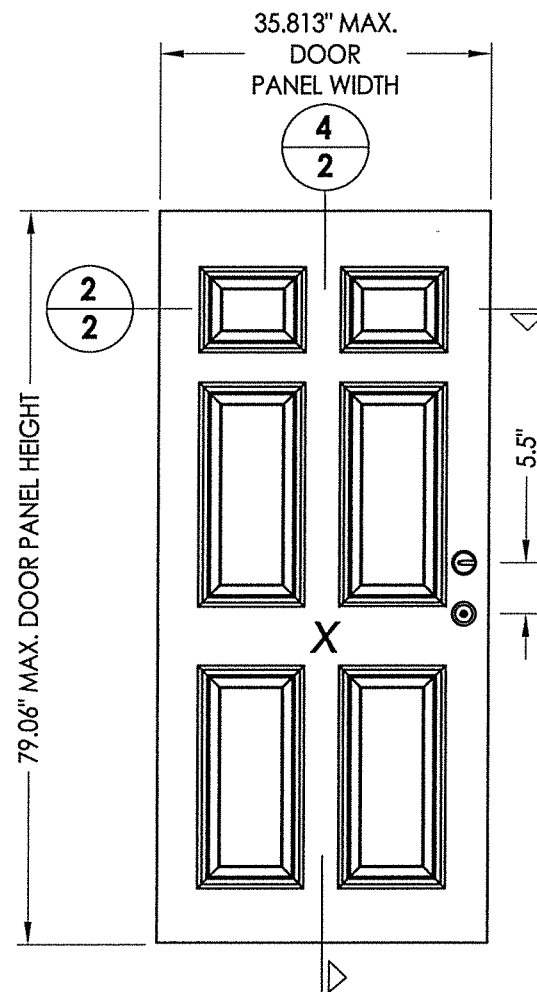

42 DOOR PANEL U1 Door

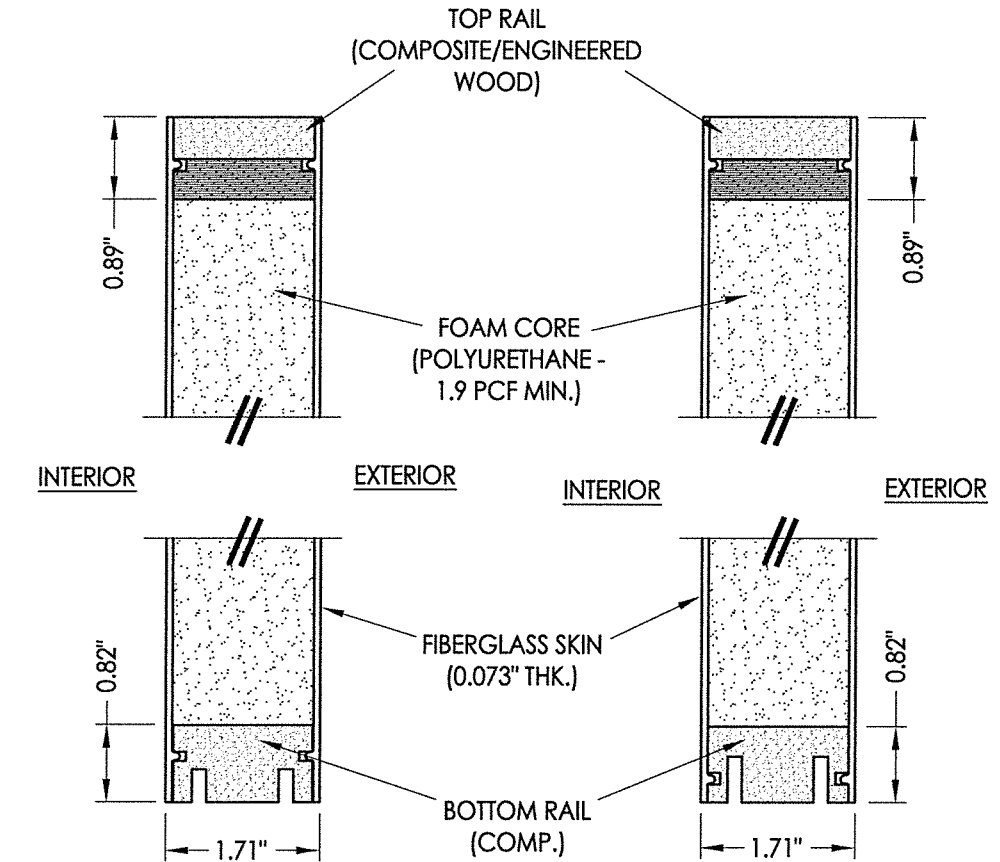

3
2 VERTICAL CROSS SECTION

4
2 VERTICAL CROSS SECTION

E. SCHMIDT
LICENSE
No. 43409
STATE OF FLORIDA
PROFESSIONAL ENGINEER

July 22, 2020
Documents Prepared By:
Lyndon F. Schmidt
P.E. No. 43409

R.W. BUILDING CONSULTANTS, INC.
P.O. Box 230, Valrico, FL 33595
Phone No.: 813.659.9197
FBPE Registry No. 9813

PRODUCT:		THERMA-TRU FIBERGLASS DOOR	
PART OR ASSEMBLY:		DOOR PANEL DETAILS	
NO.	DATE	BY	REVISIONS
4	7/21/20	LFS	UPDATE TO 7th ED (2020) FBC
3	10/09/18	MT	REV. DOOR PANEL OPTION NOTE
2	11/15/17	JK	RECESSED PANEL NOTATION
1	7/7/17	JK	UPDATE TO 6th ED (2017) FBC
DATE: 8/10/16			
SCALE: N.T.S.			
DWG. BY: JK			
CHK. BY: LFS			
DRAWING NO.: FL-20461.2			
SHEET 2 OF 14			

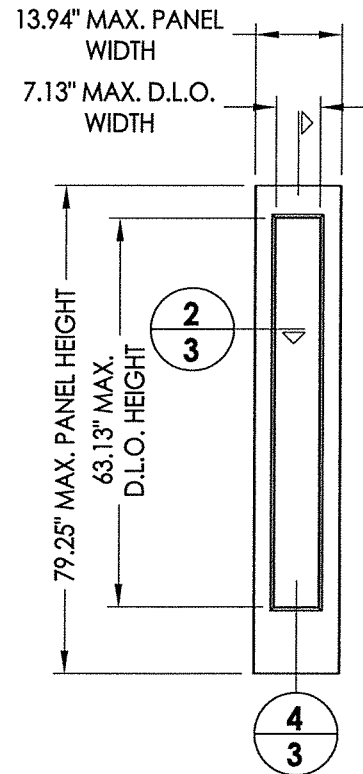

4
3

60 SIDELITE PANEL
Full Lite
Flush Glazed

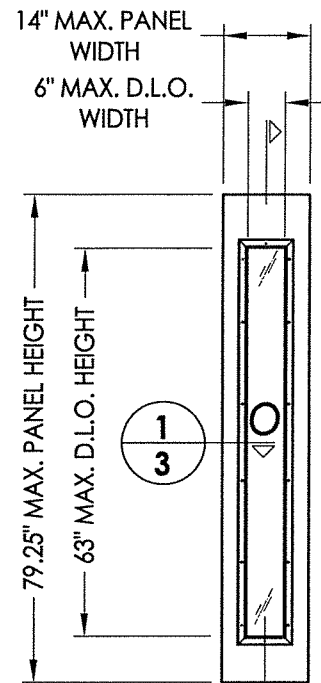

3
3

50 SIDELITE PANEL
Full Lite
Lip Lite

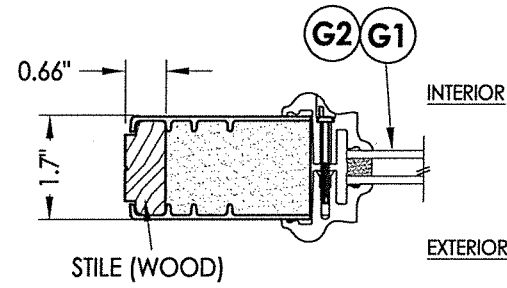
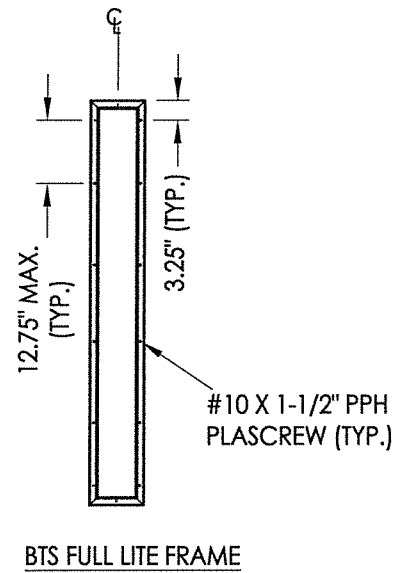

1 HORIZONTAL CROSS SECTION
3 Lip Lite Glazing

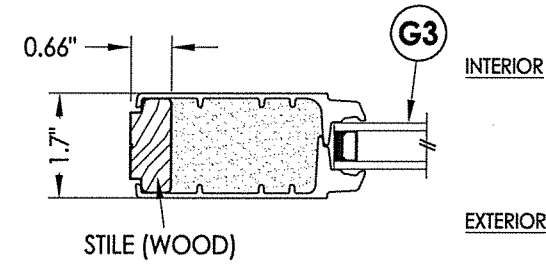

2 HORIZONTAL CROSS SECTION
3 Flush Glazing

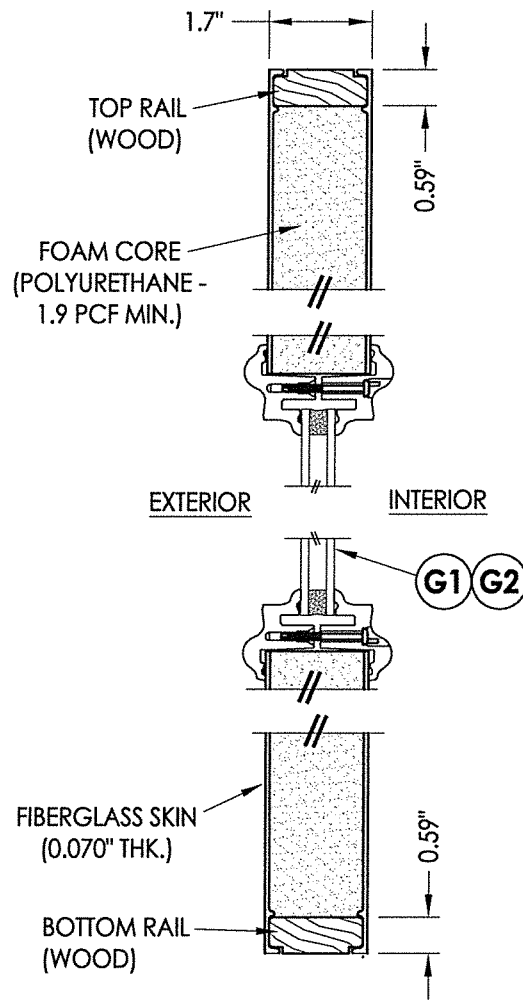

3 VERTICAL CROSS SECTION
3 Lip Lite Glazing Shown

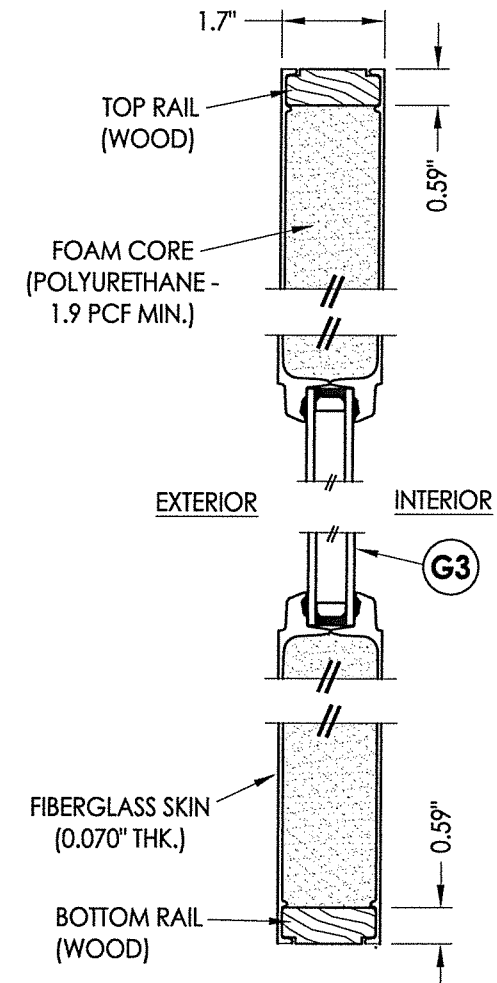

4 VERTICAL CROSS SECTION
3 Flush Glazing Shown

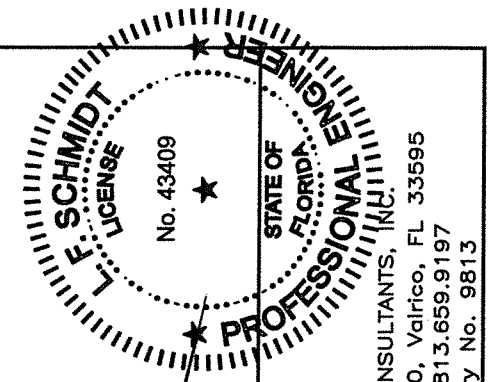

July 22, 2020
Documents Prepared By:
Lyndon F. Schmidt
P.E. No. 43409
RW BUILDING CONSULTANTS, INC.
P.O. Box 230, Valrico, FL 33595
Phone No.: 813.659.9197
FBPE Registry No. 9813

PRODUCT:		THERMA TRU FIBERGLASS DOOR	
PART OR ASSEMBLY:		SIDELITE PANEL DETAILS	
NO.	DATE	BY	REVISIONS
4	7/21/20	LFS	UPDATE TO 7th ED (2020) FBC
3	10/09/18	MT	REV. DOOR PANEL OPTION NOTE
2	11/15/17	JK	RECESSED PANEL NOTATION
1	7/7/17	JK	UPDATE TO 6th ED (2017) FBC
DATE: 8/10/16			
SCALE: N.T.S.			
DWG. BY: JK			
CHK. BY: LFS			
DRAWING NO.: FL-20461.2			
SHEET 3 OF 14			

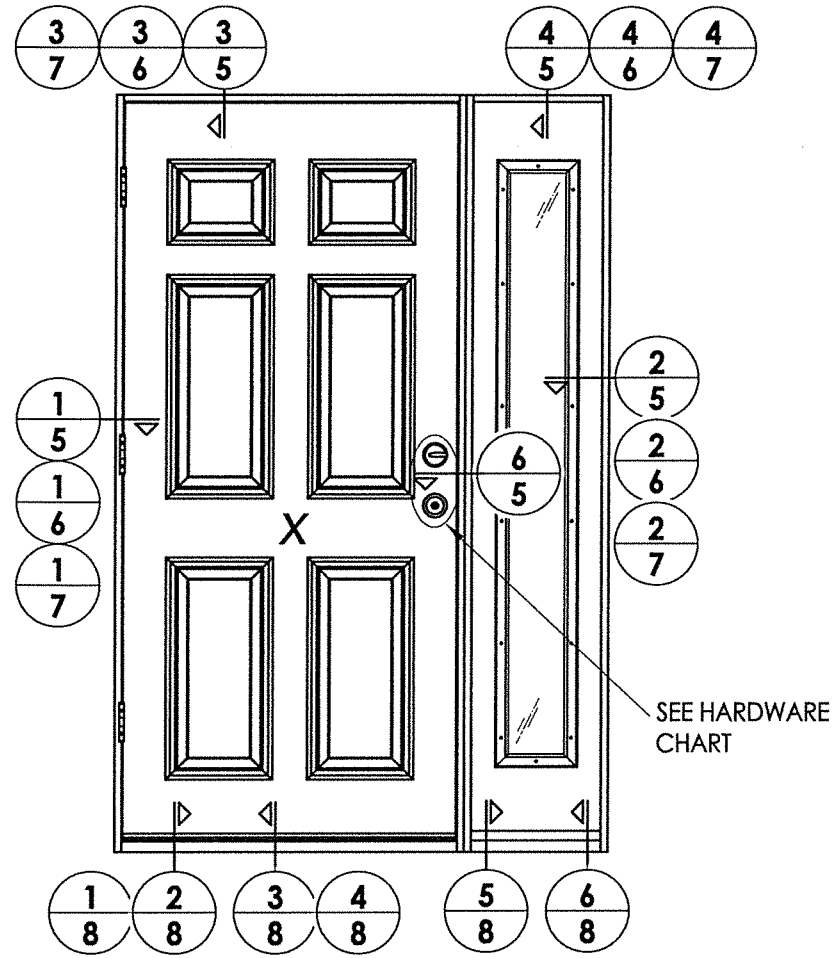

ELEVATION
XO

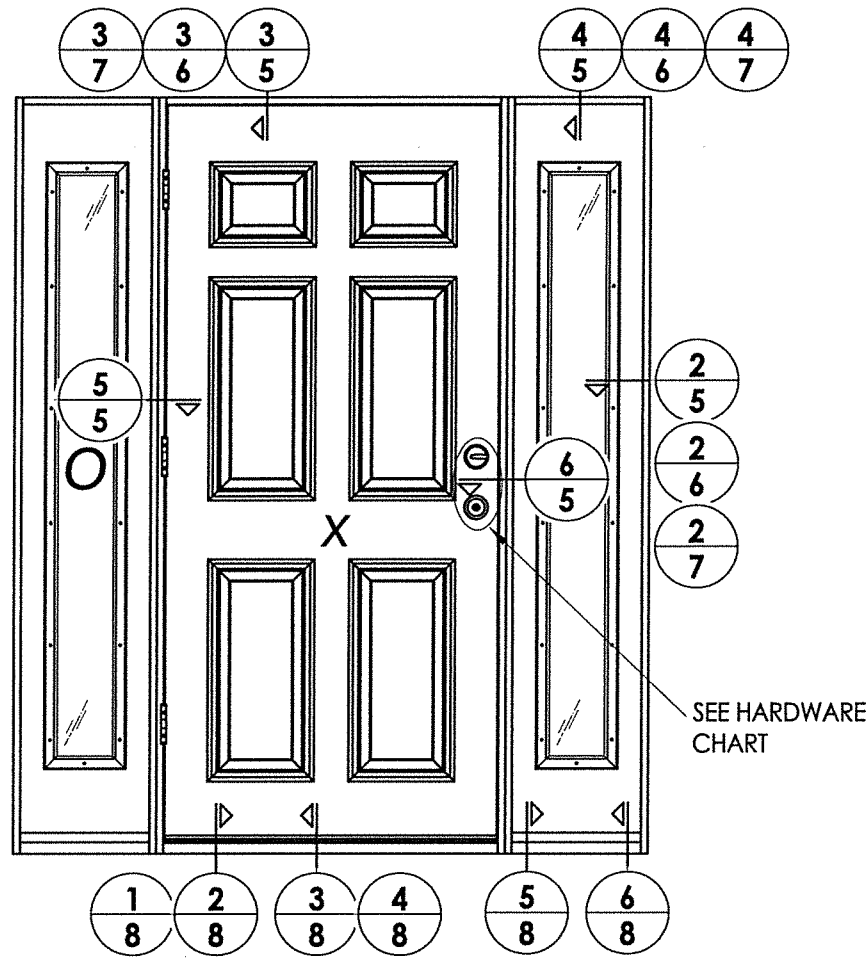

ELEVATION
OXO

SEE HARDWARE
CHART

SEE HARDWARE
CHART

HARDWARE TABLE	
MANUFACTURER	MODEL
SCHLAGE	KNOB: F51 DEADBOLT: B60
KWIKSET	KNOB: SIGNATURE SERIES DEADBOLT: SIGNATURE SERIES (980)
HOPPE (THERMA-TRU)	MULTIPOINT : MPDGART (3 pt. Manual Tongue)

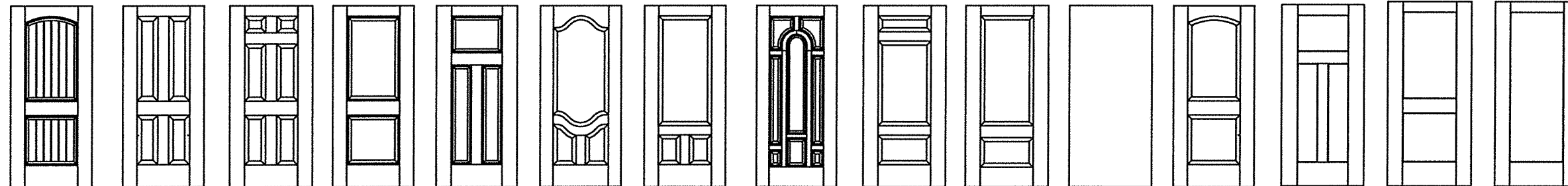

Fiber-Classic/Smooth-Star Door Panel Options

Products approved include all embossed and recessed panel doors.
 Similar glazed panel configurations are allowed.
 Panels shown are for illustration and are representative only.

L.F. SCHMIDT
 LICENSE No. 43409
 STATE OF FLORIDA
 PROFESSIONAL ENGINEER

July 22, 2020
 Documents Prepared By:
 Lyndon F. Schmidt
 P.E. No. 43409

R.W. BUILDING CONSULTANTS, INC.
 P.O. Box 230, Valrico, FL 33595
 Phone No.: 813.659.9197
 FBPE Registry No. 9813

PRODUCT:	THERMA-TRU FIBERGLASS DOOR	
PART OR ASSEMBLY:	ELEVATIONS	
NO.	DATE	REVISIONS
4	7/21/20	UPDATE TO 7th ED (2020) FBC
3	10/09/18	REV. DOOR PANEL OPTION NOTE
2	11/15/17	RECESSED PANEL NOTATION
1	7/7/17	UPDATE TO 6th ED (2017) FBC

DATE: 8/10/16
 SCALE: N.T.S.
 DWG. BY: JK
 CHK. BY: LFS
 DRAWING NO.: FL-20461.2
 SHEET 4 OF 14

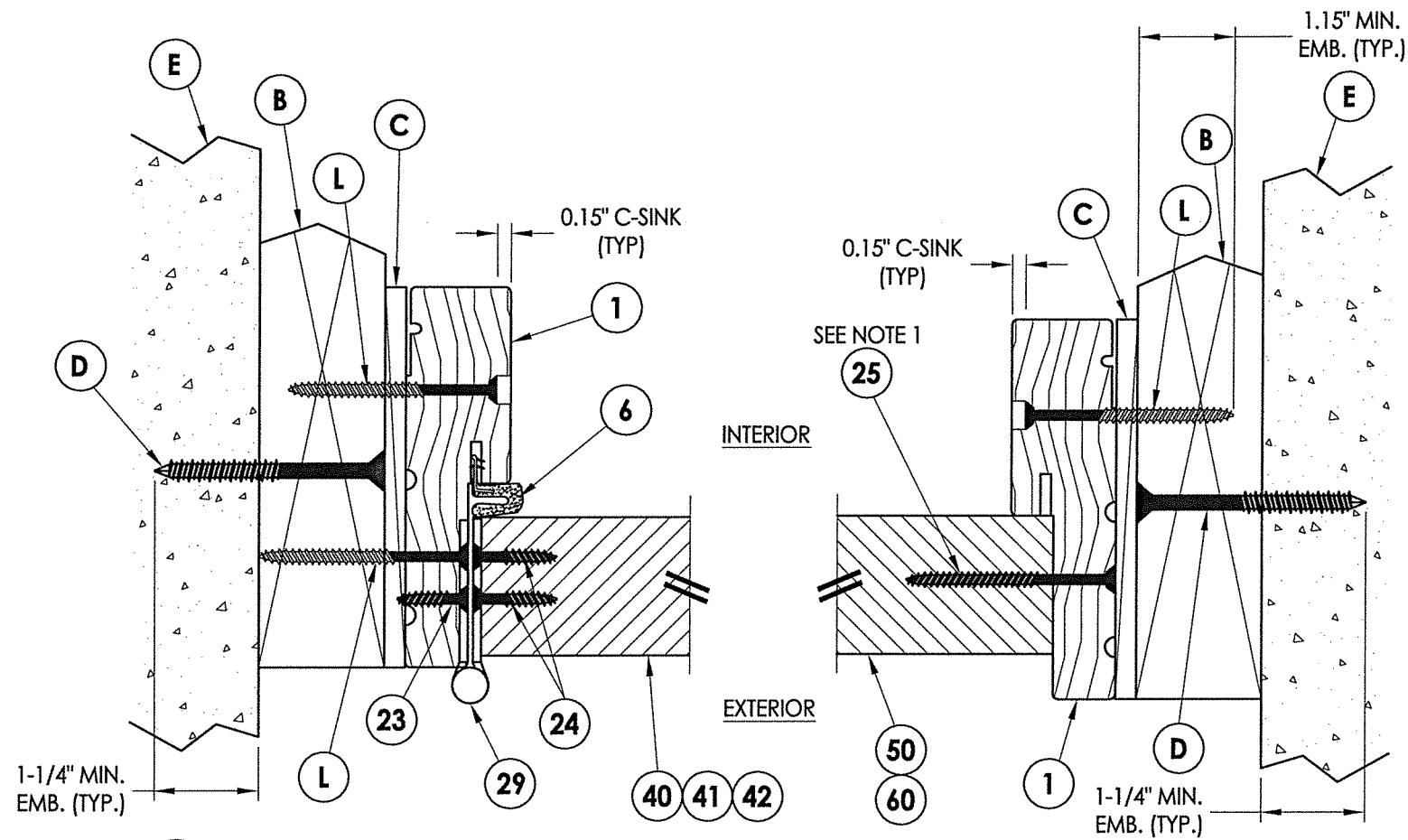

1 HORIZONTAL CROSS SECTION
5 Shown w/ 2X Buck
 Outswing shown (Inswing similar)

2 HORIZONTAL CROSS SECTION
5 Shown w/ 2X Buck
 Outswing shown (Inswing similar)

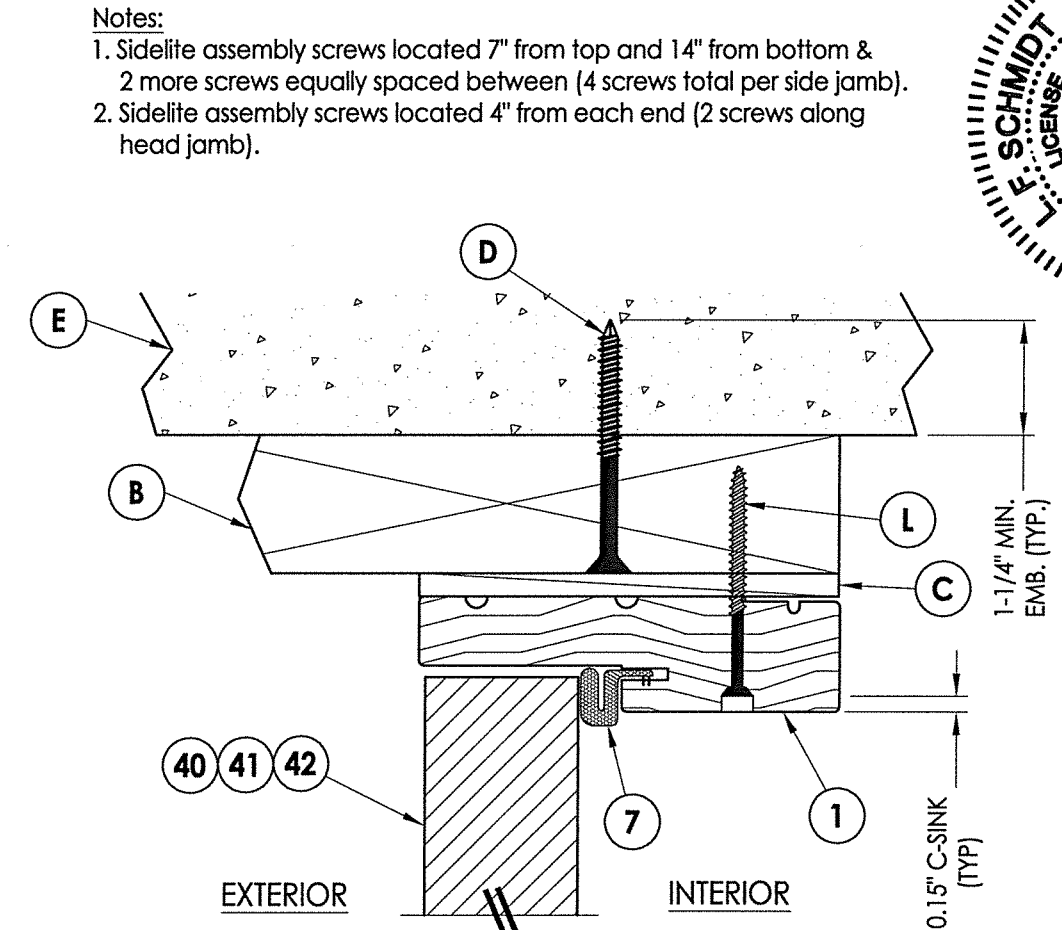

3 VERTICAL CROSS SECTION
5 Shown w/ 2X Buck
 Outswing shown (Inswing similar)

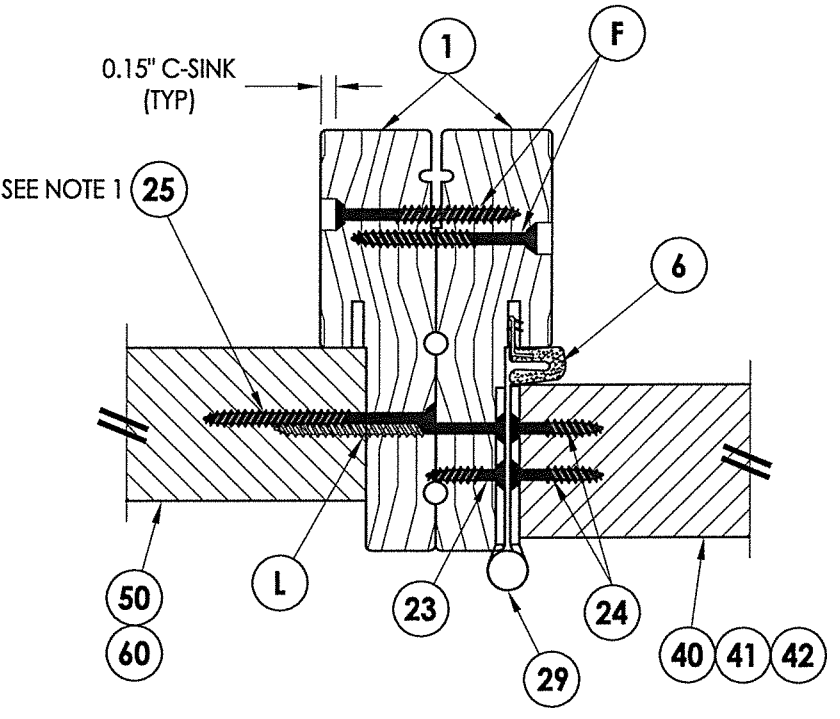

5 HORIZONTAL CROSS SECTION
5 Outswing shown (Inswing similar)

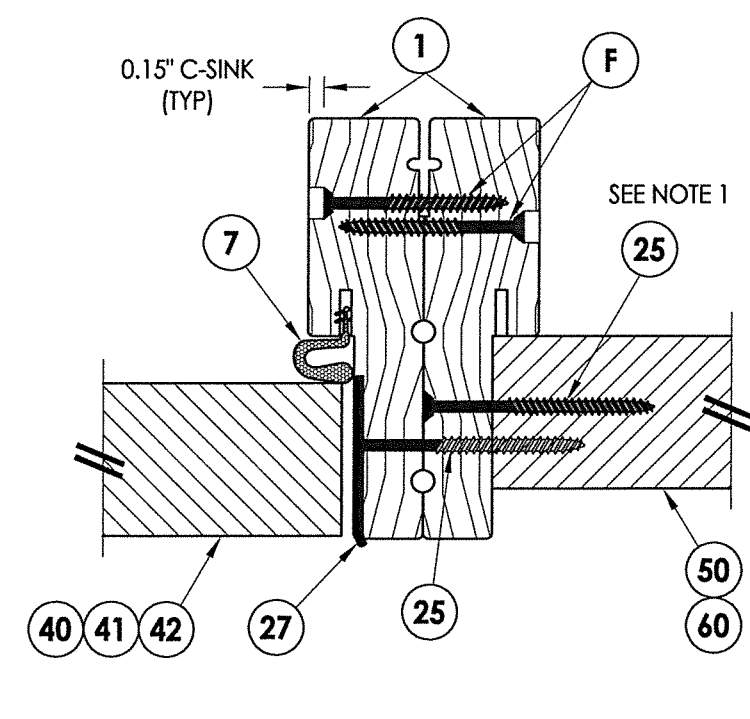

6 HORIZONTAL CROSS SECTION
5 Outswing shown (Inswing similar)

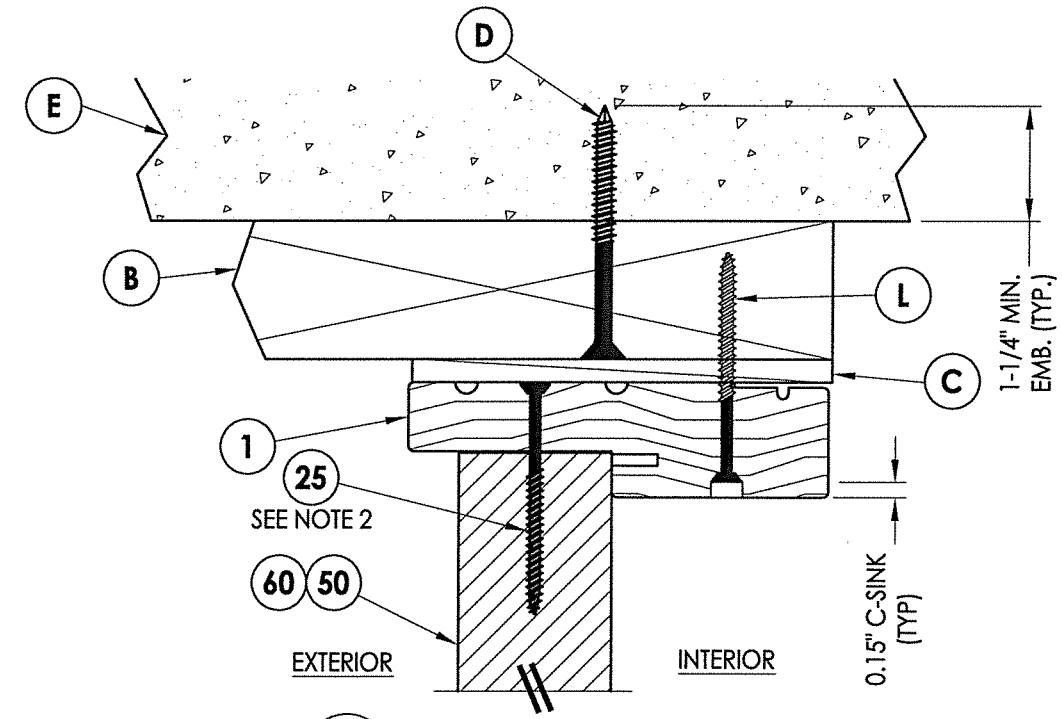

4 VERTICAL CROSS SECTION
5 Shown w/ 2X Buck
 Outswing shown (Inswing similar)

- Notes:
- Sidelite assembly screws located 7" from top and 14" from bottom & 2 more screws equally spaced between (4 screws total per side jamb).
 - Sidelite assembly screws located 4" from each end (2 screws along head jamb).

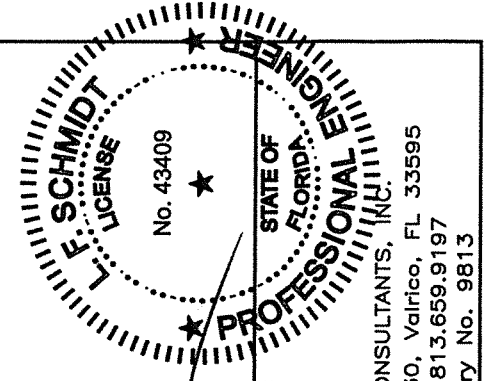

July 22, 2020
 Documents Prepared By:
 Lyndon F. Schmidt
 P.E. No. 43409
 R.W. BUILDING CONSULTANTS, INC.
 P.O. Box 230, Valrico, FL 33595
 Phone No.: 813.659.9197
 FBPE Registry No. 9813

PRODUCT:	THERMA-TRU FIBERGLASS DOOR
PART OR ASSEMBLY:	HORIZONTAL & VERTICAL CROSS SECTIONS (2X BUCK)

NO.	DATE	REVISIONS
4	7/21/20	UPDATE TO 7th ED (2020) FBC
3	10/09/18	REV. DOOR PANEL OPTION NOTE
2	11/15/17	RECESSED PANEL NOTATION
1	7/7/17	UPDATE TO 6th ED (2017) FBC

DATE:	8/10/16
SCALE:	N.T.S.
DWG. BY:	JK
CHK. BY:	LFS
DRAWING NO.:	FL-20461.2
SHEET	5 OF 14

Notes:

1. Sidelite assembly screws located 7" from top and 14" from bottom & 2 more screws equally spaced between (4 screws total per side jamb).
2. Sidelite assembly screws located 4" from each end (2 screws along head jamb).

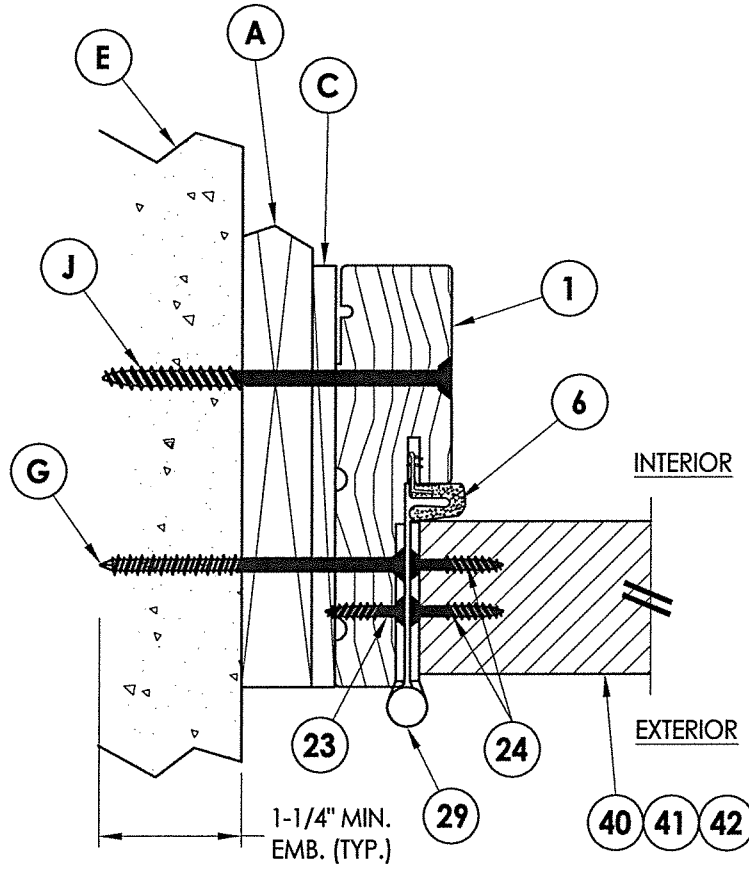

1 **HORIZONTAL CROSS SECTION**
6 Shown w/ 1X sub-buck
 Outswing shown (Inswing similar)

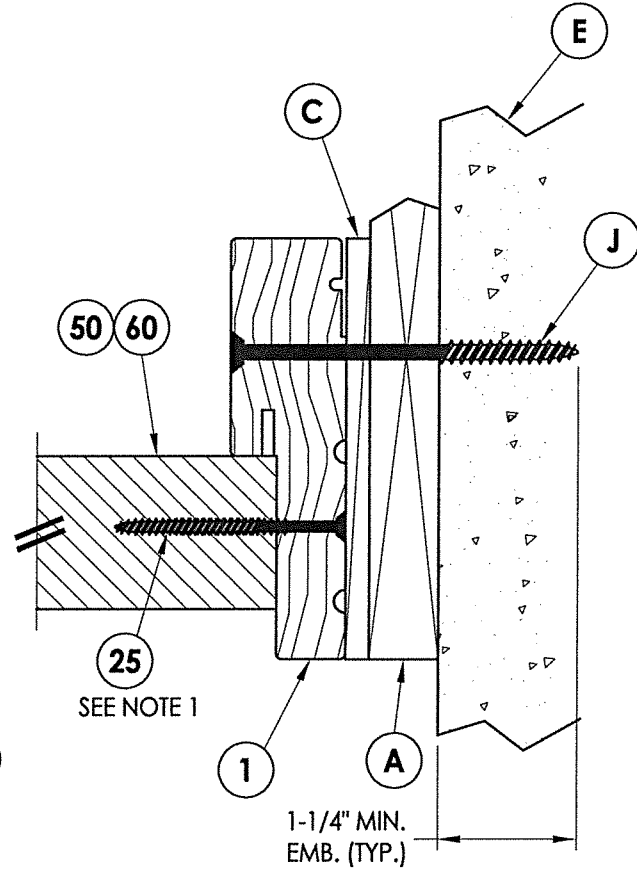

2 **HORIZONTAL CROSS SECTION**
6 Shown w/ 1X sub-buck
 Outswing shown (Inswing similar)

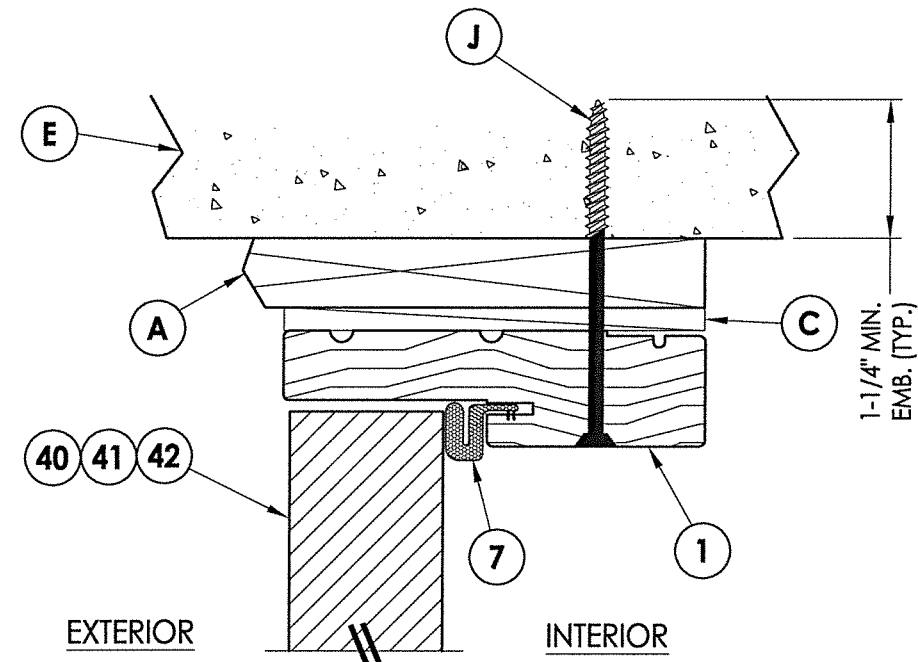

3 **VERTICAL CROSS SECTION**
6 Shown w/ 1X sub-buck
 Outswing shown (Inswing similar)

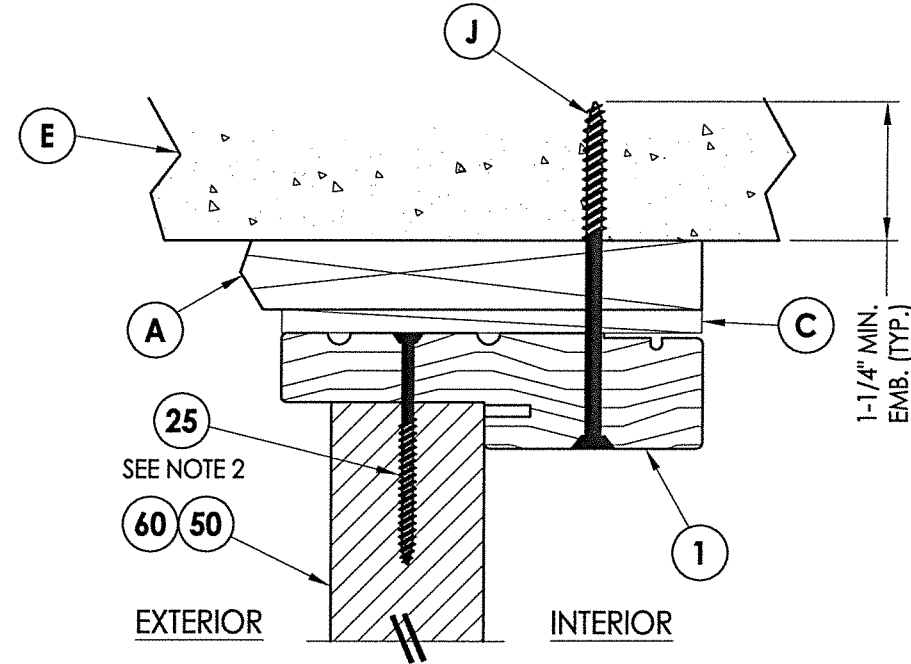

4 **VERTICAL CROSS SECTION**
6 Shown w/ 1X sub-buck
 Outswing shown (Inswing similar)

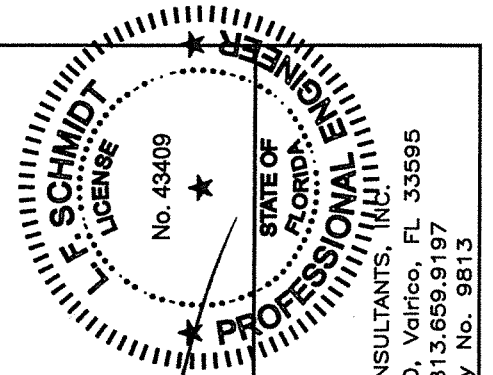

July 22, 2020

Documents Prepared By:
 Lyndon F. Schmidt
 P.E. No. 43409

RW BUILDING CONSULTANTS, INC.
 P.O. Box 230, Valrico, FL 33595
 Phone No.: 813.659.9197
 FBPE Registry No. 9813

PRODUCT: THERMA-TRU FIBERGLASS DOOR
 PART OR ASSEMBLY: HORIZONTAL & VERTICAL CROSS SECTIONS (1X BUCK)

NO.	DATE	REVISIONS	BY
4	7/21/20	UPDATE TO 7th ED (2020) FBC	LFS
3	10/09/18	REV. DOOR PANEL OPTION NOTE	MT
2	11/15/17	RECESSED PANEL NOTATION	JK
1	7/7/17	UPDATE TO 6th ED (2017) FBC	JK

DATE: 8/10/16
 SCALE: N.T.S.
 DWG. BY: JK
 CHK. BY: LFS
 DRAWING NO.: FL-20461.2
 SHEET 6 OF 14

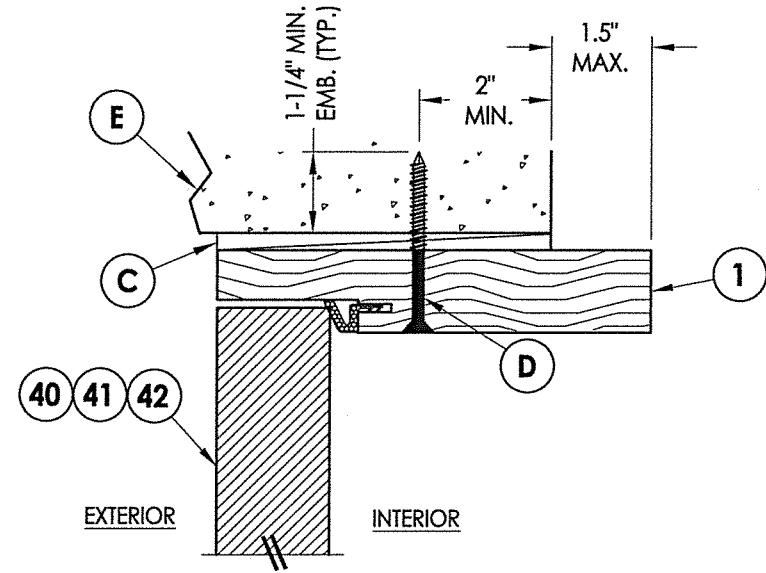

3 HORIZONTAL CROSS SECTION
7 Shown Direct to Masonry
 Outswing only w/ 6-9/16" jamb

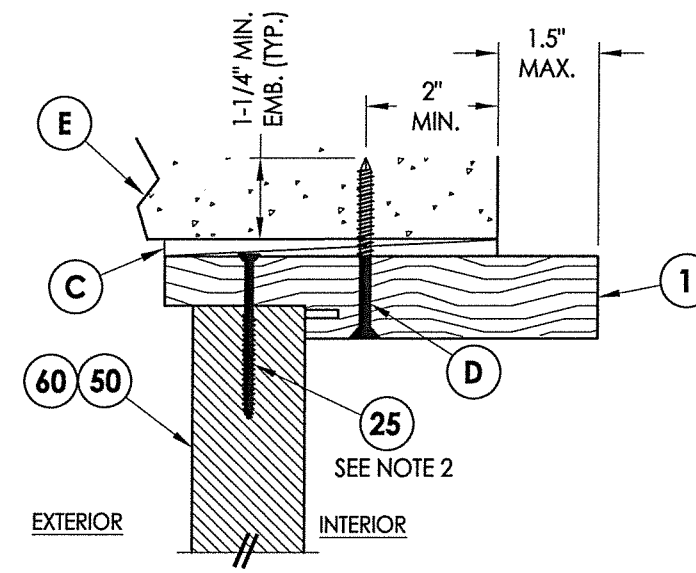

4 VERTICAL CROSS SECTION
7 Shown Direct to Masonry
 Outswing only w/ 6-9/16" jamb

Notes:

- Sidelite assembly screws located 7" from top and 14" from bottom & 2 more screws equally spaced between (4 screws total per side jamb).
- Sidelite assembly screws located 4" from each end (2 screws along head jamb).

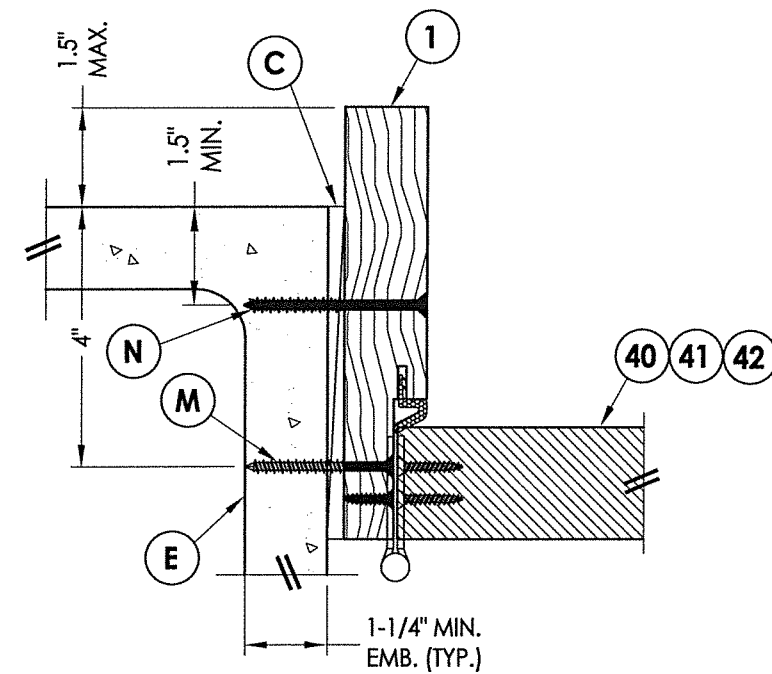

1 HORIZONTAL CROSS SECTION
7 Shown Direct to Masonry
 Outswing only w/ 6-9/16" jamb

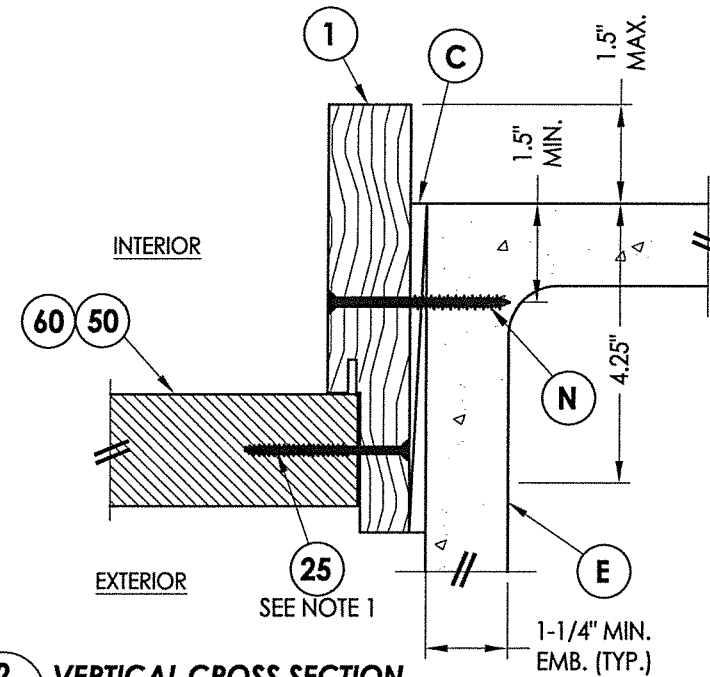

2 VERTICAL CROSS SECTION
7 Shown Direct to Masonry
 Outswing only w/ 6-9/16" jamb

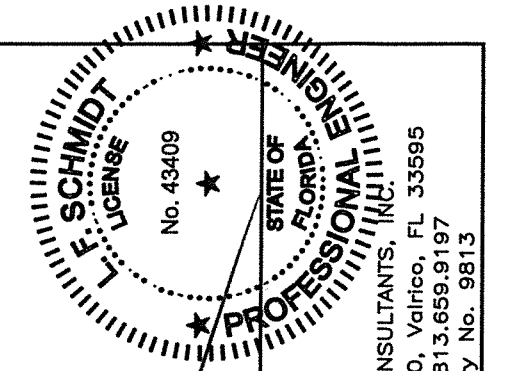

July 22, 2020
 Documents Prepared By:
 Lyndon F. Schmidt
 P.E. No. 43409
 R.W. BUILDING CONSULTANTS, INC.
 P.O. Box 230, Valrico, FL 33595
 Phone No.: 813.659.9197
 FBPE Registry No. 9813

PRODUCT: THERMA-TRU FIBERGLASS DOOR
 PART OR ASSEMBLY: HORIZONTAL & VERTICAL SECTIONS (DIRECT TO MASONRY)

NO.	DATE	BY	REVISIONS
4	7/21/20	LFS	UPDATE TO 7th ED (2020) FBC
3	10/09/18	MT	REV. DOOR PANEL OPTION NOTE
2	11/15/17	JK	RECESSED PANEL NOTATION
1	7/7/17	JK	UPDATE TO 6th ED (2017) FBC

DATE: 8/10/16
 SCALE: N.T.S.
 DWG. BY: JK
 CHK. BY: LFS
 DRAWING NO.: FL-20461.2
 SHEET 7 OF 14

Notes:

- Sill Item #'s 17, 18, 32, 34, 35, 36, 37, 38 & 39 are attached to jambs w/ (3) #8 X 2-1/2" pph screws at each end.
Sill Item #'s 16 & 33 are attached to jambs w/ (2) #8 X 2-1/2" pph screws at each end.
Sill Item #15 is attached to jambs utilizing (2) #10 X 2" pph SMS at each end.
- Sidelite assembly screws located 4" from each end (2 screws along sill).

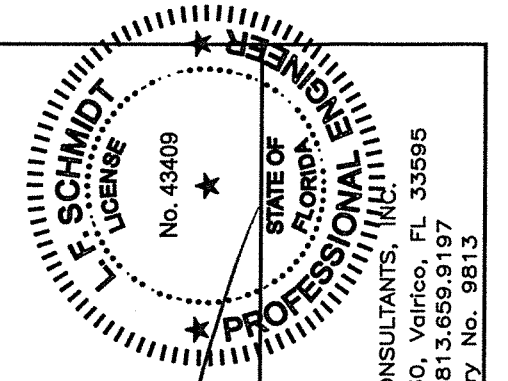

Documents Prepared By:
Lyndon F. Schmidt
P.E. No. 43409

RW BUILDING CONSULTANTS, INC.
P.O. Box 230, Valrico, FL 33595
Phone No.: 813.659.9197
FBPE Registry No. 9813

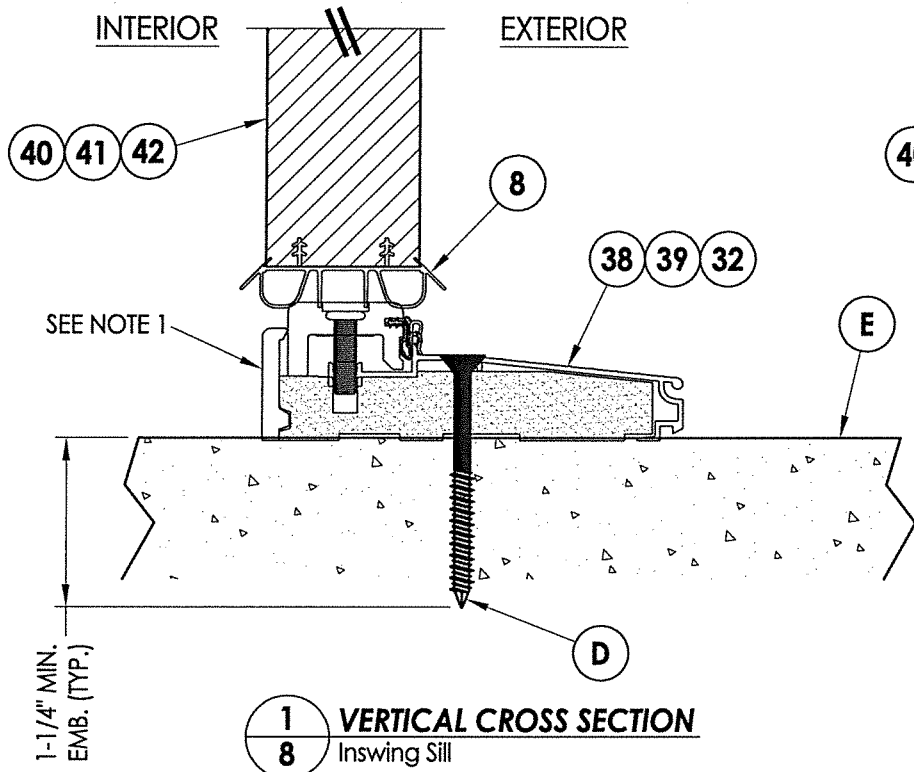

1 VERTICAL CROSS SECTION
8 Inswing Sill

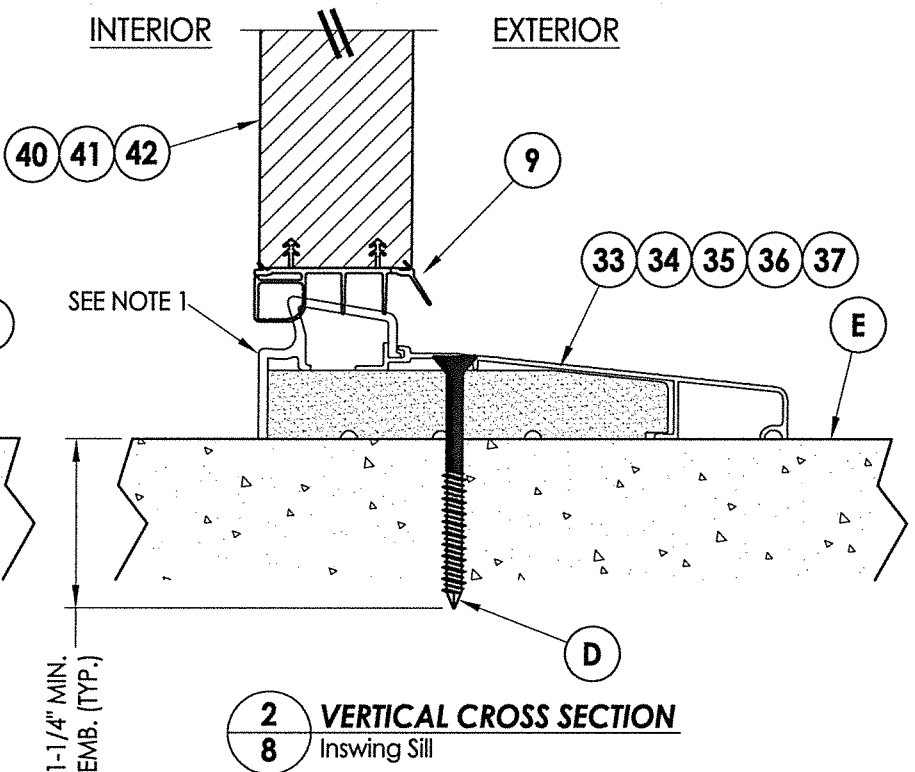

2 VERTICAL CROSS SECTION
8 Inswing Sill

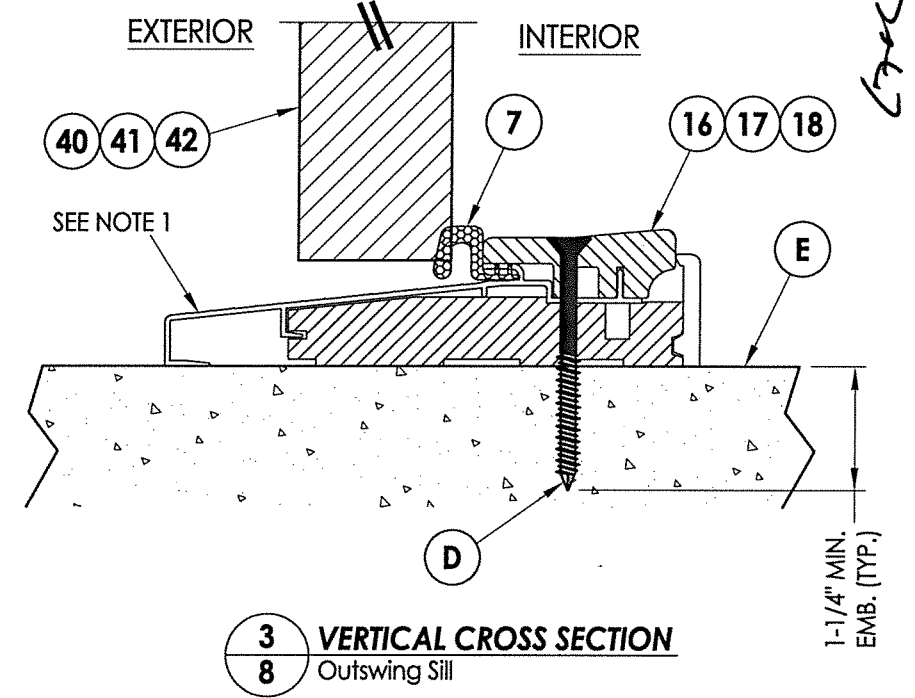

3 VERTICAL CROSS SECTION
8 Outswing Sill

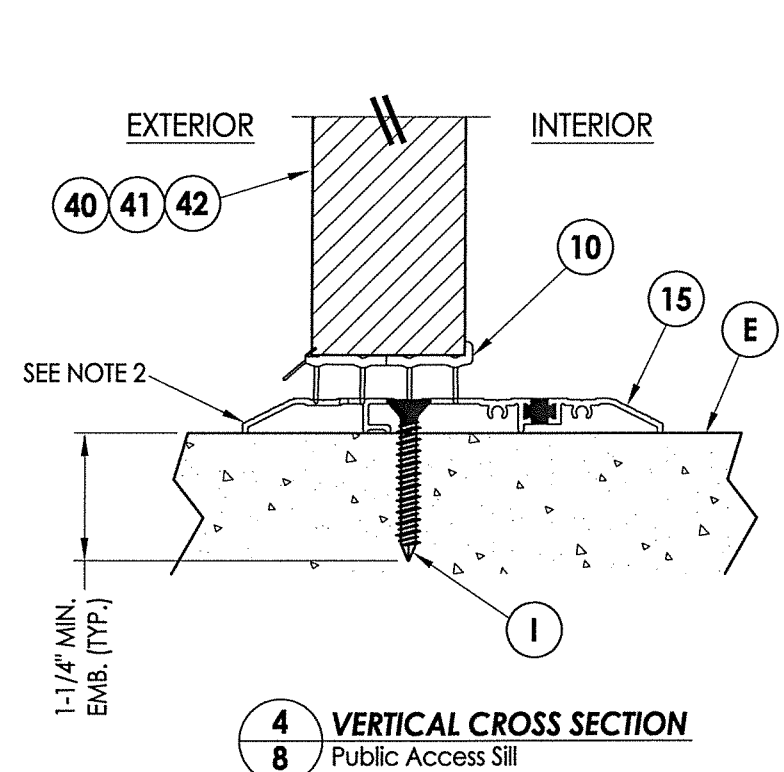

4 VERTICAL CROSS SECTION
8 Public Access Sill

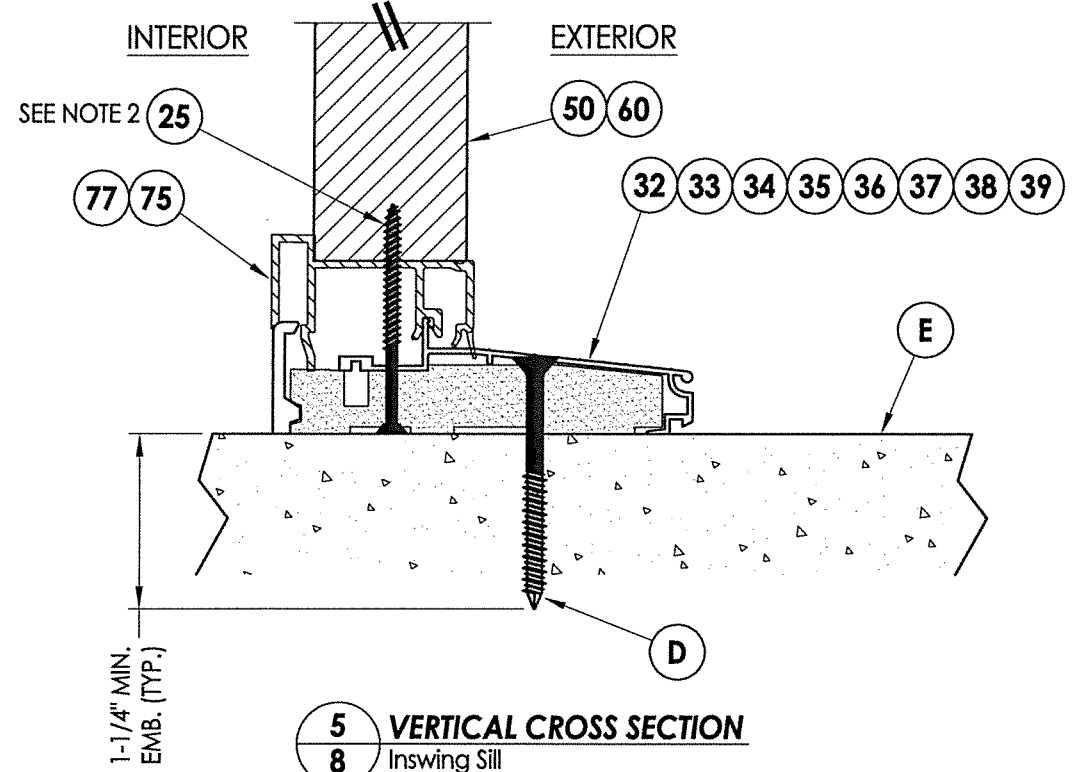

5 VERTICAL CROSS SECTION
8 Inswing Sill

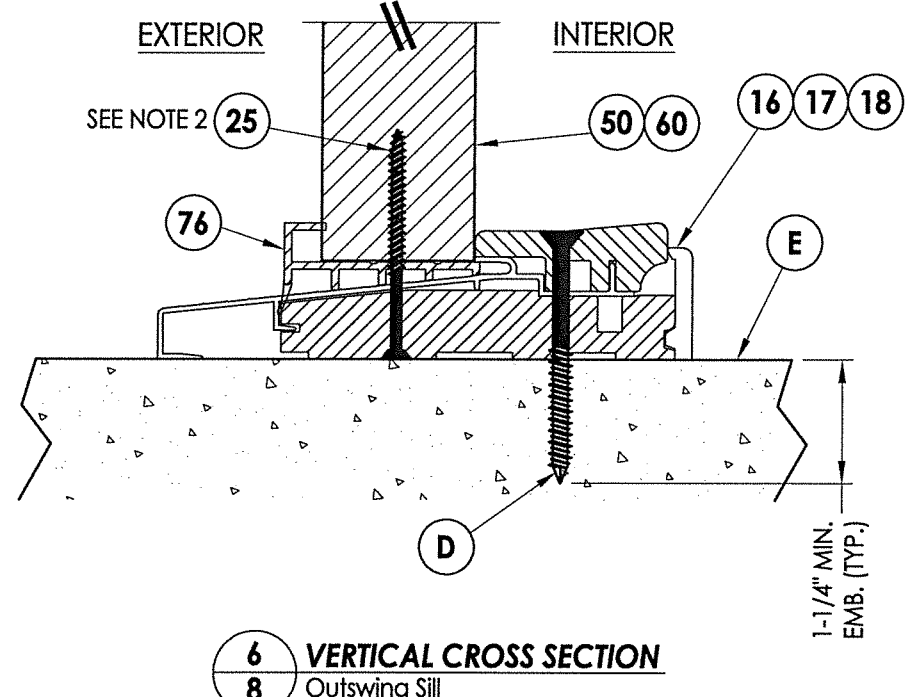

6 VERTICAL CROSS SECTION
8 Outswing Sill

PRODUCT:		THERMA-TRU FIBERGLASS DOOR	
PART OR ASSEMBLY:		VERTICAL CROSS SECTIONS (THRESHOLDS)	
NO.	DATE	JK	BY
4	7/21/20	UPDATE TO 7th ED (2020) FBC	LFS
3	10/09/18	REV. DOOR PANEL OPTION NOTE	MT
2	11/15/17	RECESSED PANEL NOTATION	JK
1	7/7/17	UPDATE TO 6th ED (2017) FBC	JK
REVISIONS			
DATE:		8/10/16	
SCALE:		N.T.S.	
DWG. BY:		JK	
CHK. BY:		LFS	
DRAWING NO.:		FL-20461.2	
SHEET		8 OF 14	

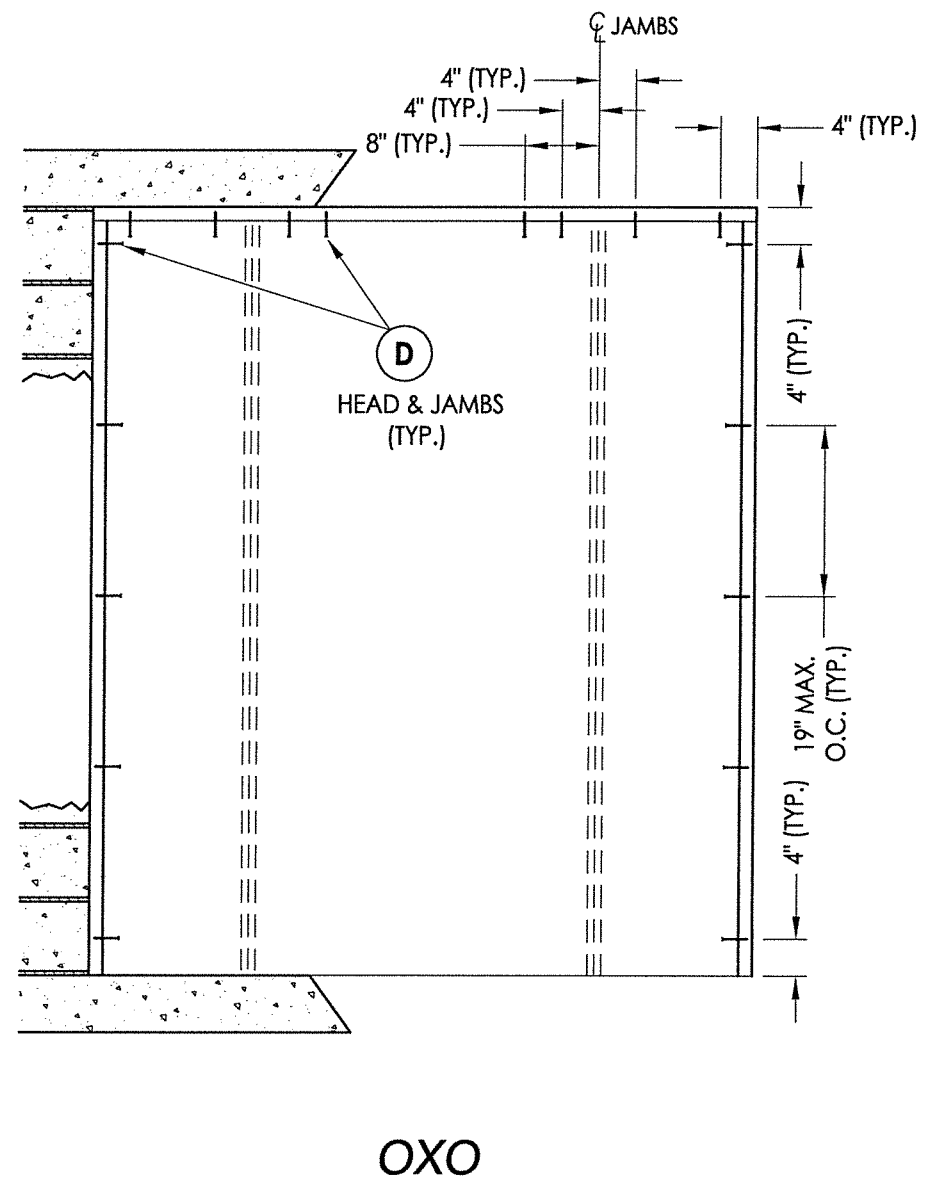
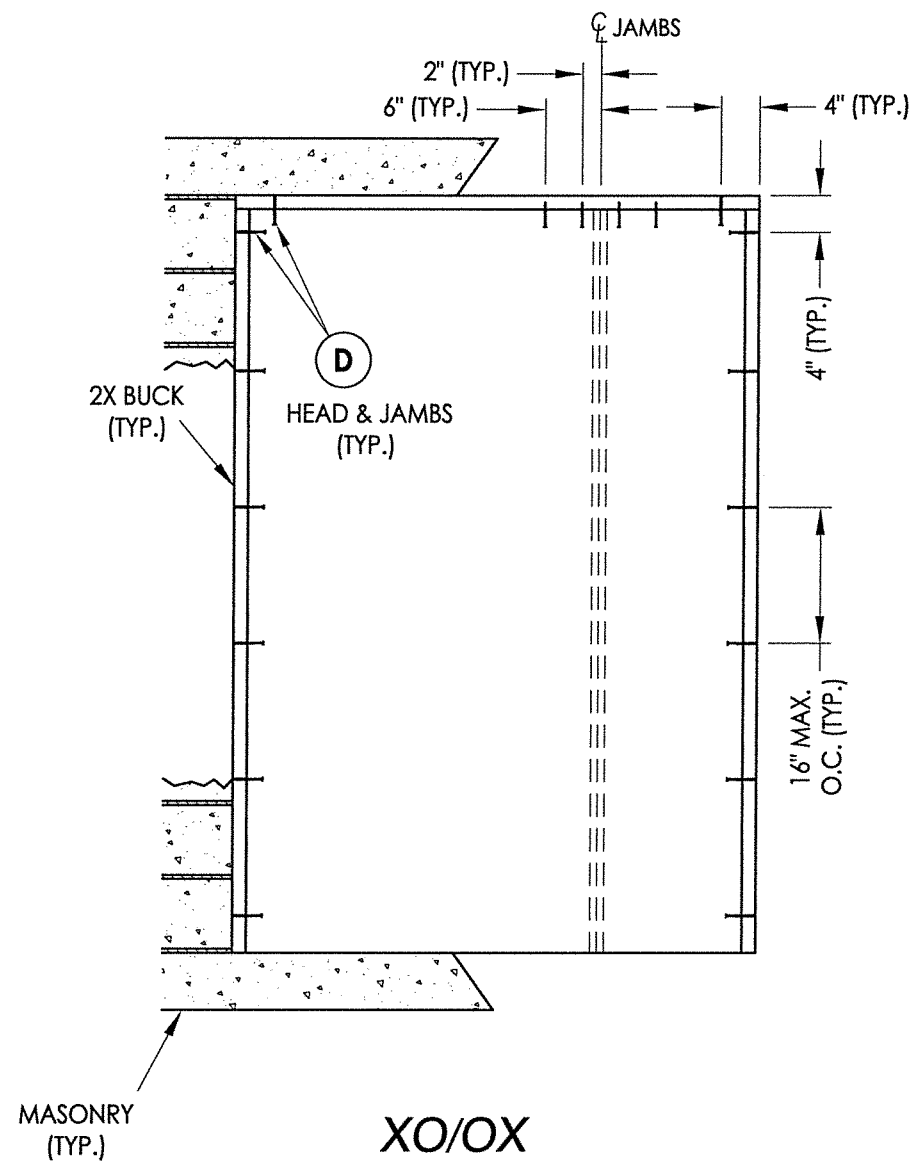

2X BUCK ANCHORING

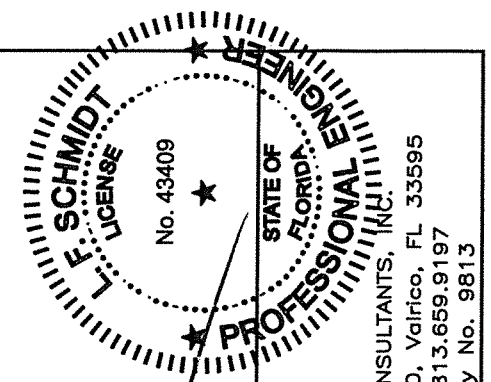

July 22, 2020
 Documents Prepared By:
 Lyndon F. Schmidt
 P.E. No. 43409
 R.W. BUILDING CONSULTANTS, INC.
 P.O. Box 230, Valrico, FL 33595
 Phone No.: 813.659.9197
 FBPE Registry No. 9813

PRODUCT:		THERMA-TRU FIBERGLASS DOOR	
PART OR ASSEMBLY:		BUCK ANCHORING	
NO.	DATE	BY	REVISIONS
4	7/21/20	LFS	UPDATE TO 7th ED (2020) FBC
3	10/09/18	MT	REV. DOOR PANEL OPTION NOTE
2	11/15/17	JK	RECESSED PANEL NOTATION
1	7/7/17	JK	UPDATE TO 6th ED (2017) FBC

DATE: 8/10/16
 SCALE: N.T.S.
 DWG. BY: JK
 CHK. BY: LFS
 DRAWING NO.:
 FL-20461.2
 SHEET 9 OF 14

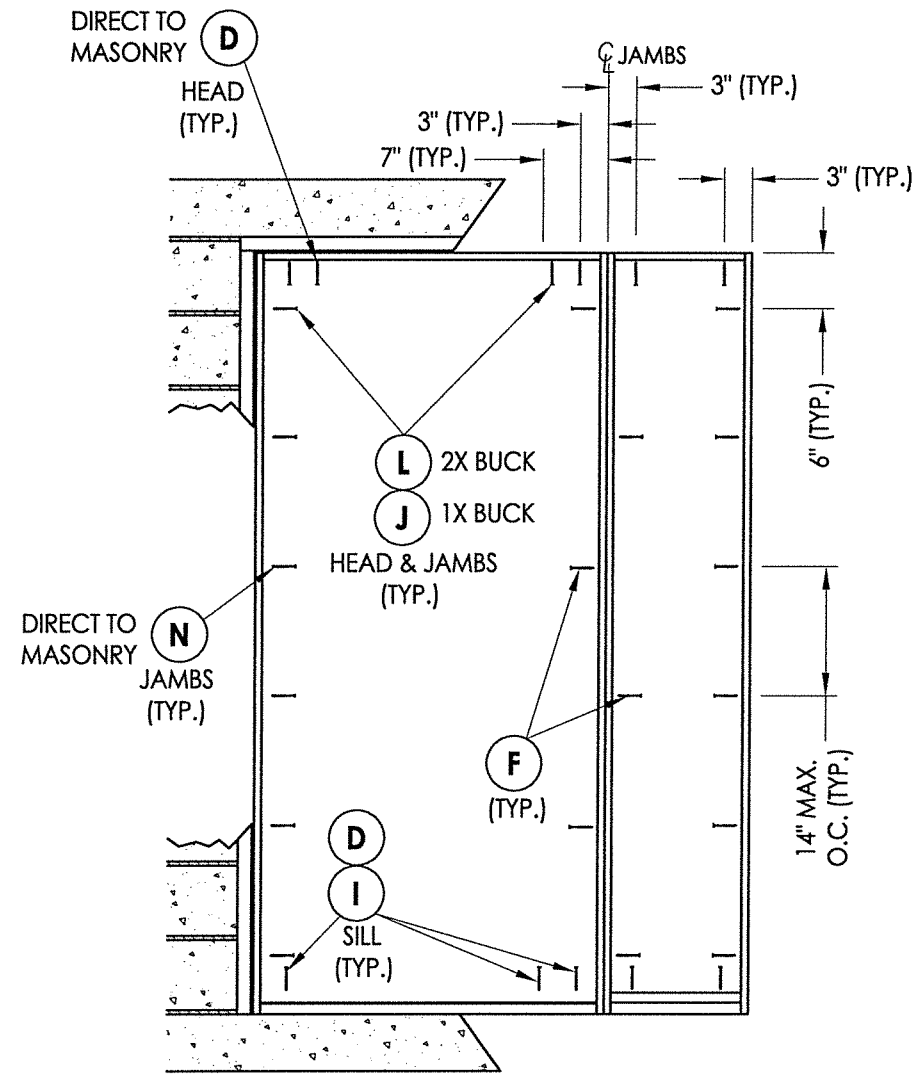

XO/OX

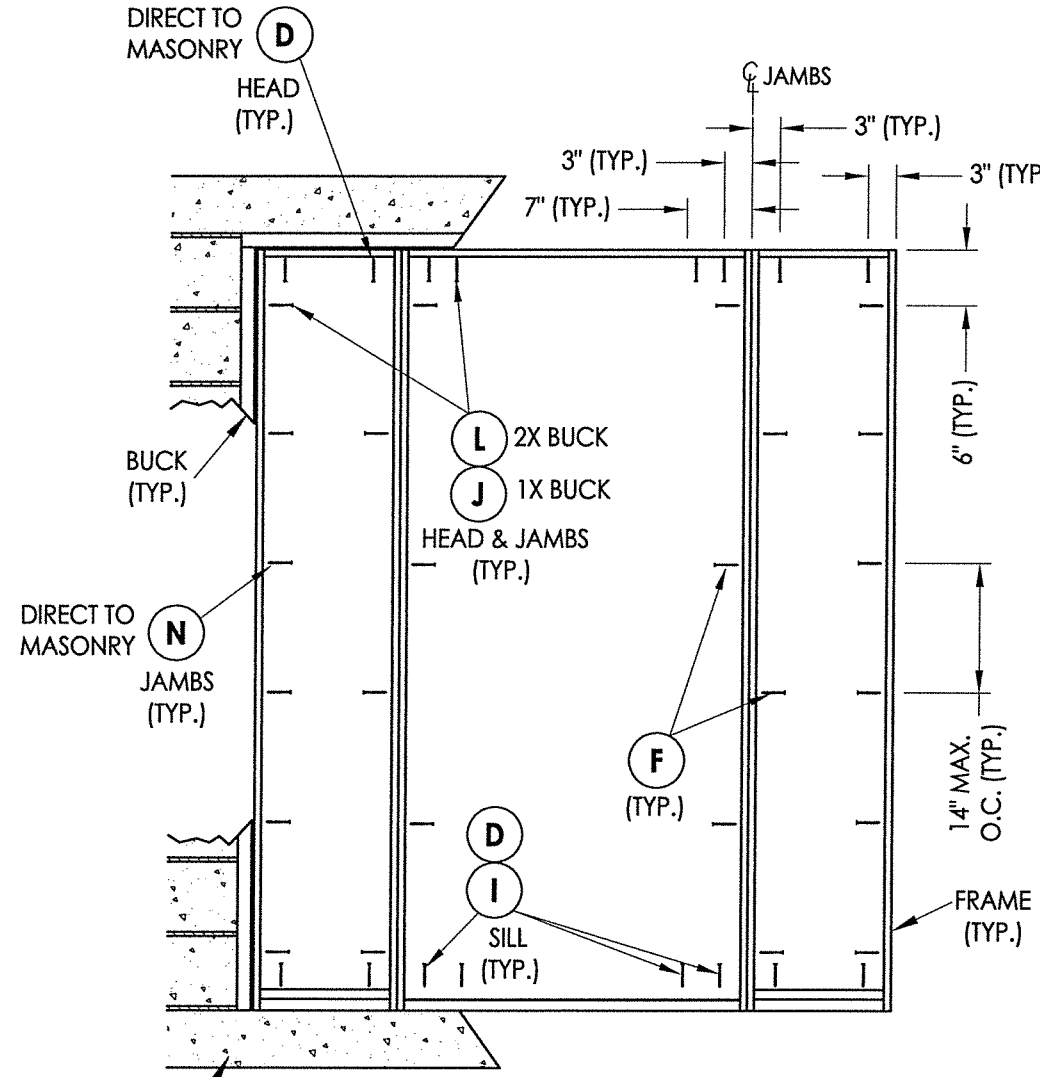

OXO

FRAME ANCHORING

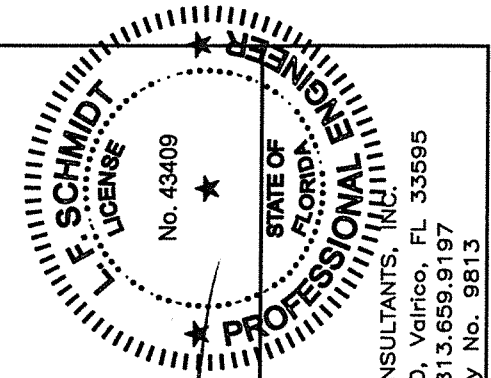
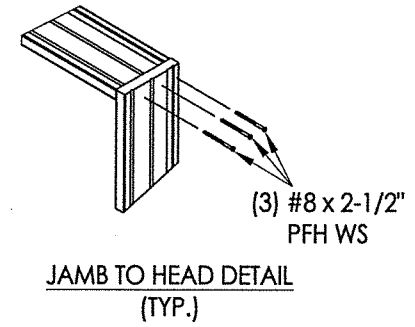

July 22, 2020
 Documents Prepared By:
 Lyndon F. Schmidt
 P.E. No. 43409
 R.W. BUILDING CONSULTANTS, INC.
 P.O. Box 230, Vairico, FL 33595
 Phone No.: 813.659.9197
 FBPE Registry No. 9813

PRODUCT:
 THERMA-TRU
 FIBERGLASS DOOR
 PART OR ASSEMBLY:
 FRAME ANCHORING

NO.	DATE	REVISIONS
4	7/21/20	UPDATE TO 7th ED (2020) FBC
3	10/09/18	REV. DOOR PANEL OPTION NOTE
2	11/15/17	RECESSED PANEL NOTATION
1	7/7/17	UPDATE TO 6th ED (2017) FBC

DATE: 8/10/16
 SCALE: N.T.S.
 DWG. BY: JK
 CHK. BY: LFS
 DRAWING NO.: FL-20461.2
 SHEET 10 OF 14

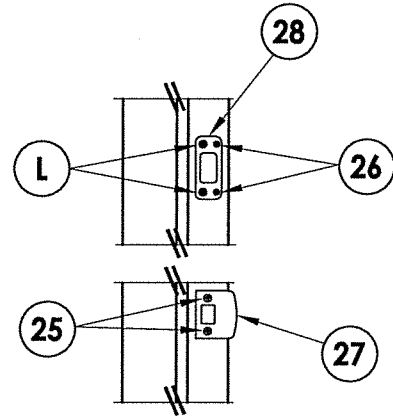

LATCH & DEADBOLT DETAIL
Kwikset

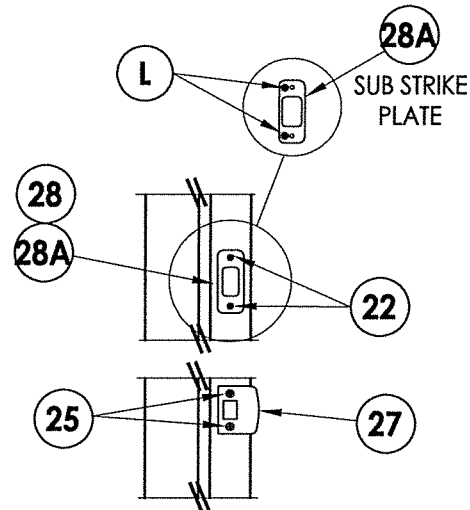

LATCH & DEADBOLT DETAIL
Schlage

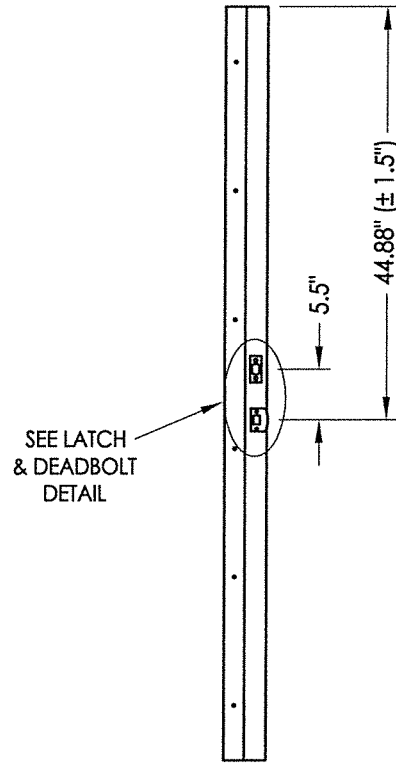

STRIKE JAMB
Latch and Deadbolt

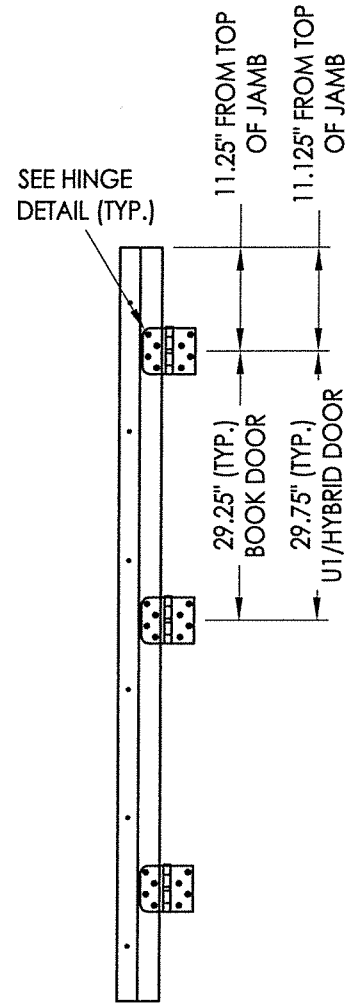

HINGE JAMB

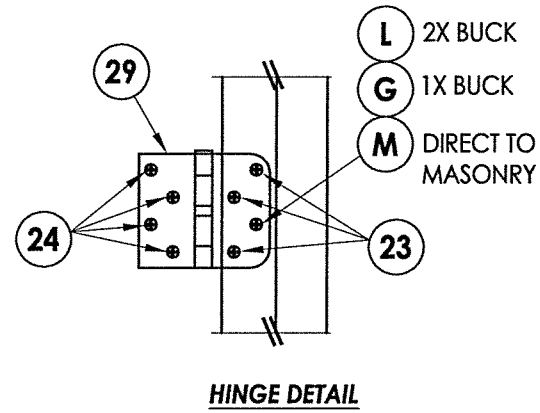

HINGE DETAIL

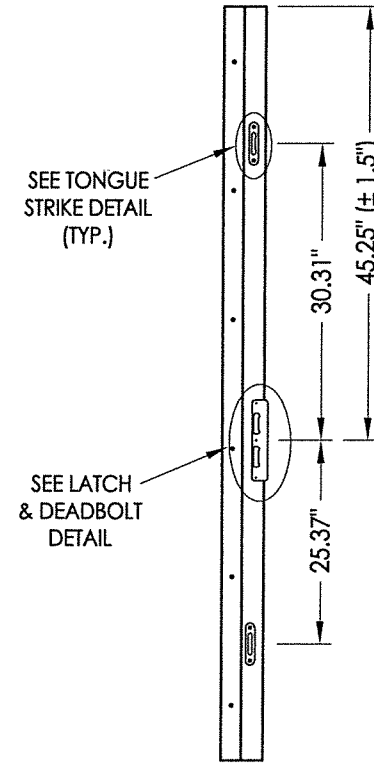

STRIKE JAMB
Multipoint Lock

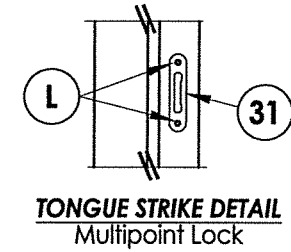

TONGUE STRIKE DETAIL
Multipoint Lock

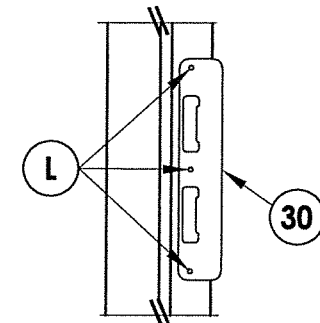

LATCH & DEADBOLT DETAIL
Multipoint Lock

MULTIPOINT LOCK STRIKE DETAILS

July 22, 2020
 Documents Prepared By:
 Lyndon F. Schmidt
 P.E. No. 43409

PROFESSIONAL ENGINEER
 STATE OF FLORIDA
 R.W. BUILDING CONSULTANTS, INC.
 P.O. Box 230, Valrico, FL 33595
 Phone No.: 813.659.9197
 FBPE Registry No. 9813

PRODUCT:		THERMA-TRU FIBERGLASS DOOR	
PART OR ASSEMBLY:		HARDWARE DETAILS	
NO.	DATE	BY	REVISIONS
4	7/21/20	LFS	UPDATE TO 7th ED (2020) FBC
3	10/09/18	MT	REV. DOOR PANEL OPTION NOTE
2	11/15/17	JK	RECESSED PANEL NOTATION
1	7/7/17	JK	UPDATE TO 6th ED (2017) FBC

DATE: 5/26/16
 SCALE: N.T.S.
 DWG. BY: JK
 CHK. BY: LFS
 DRAWING NO.: FL-20461.2
 SHEET 11 OF 14

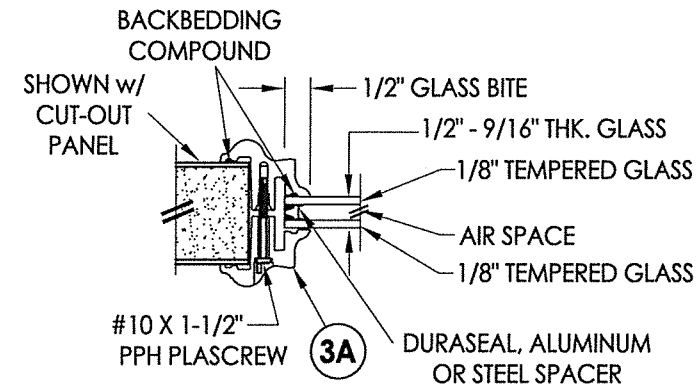

G1 GLAZING DETAIL
BTS Lite Frame
Sidelites

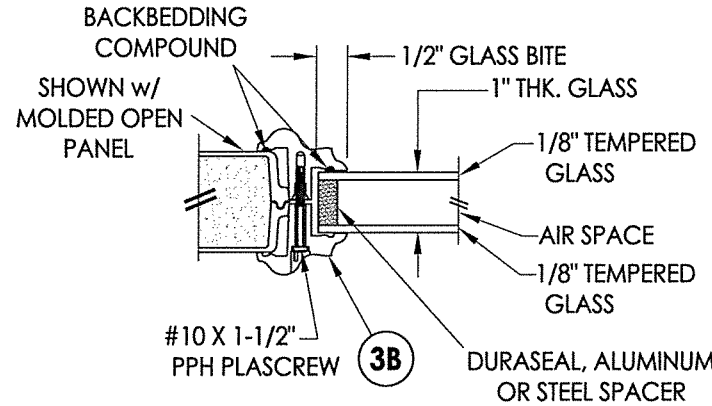

G2 GLAZING DETAIL
BTS Lite Frame
Sidelites

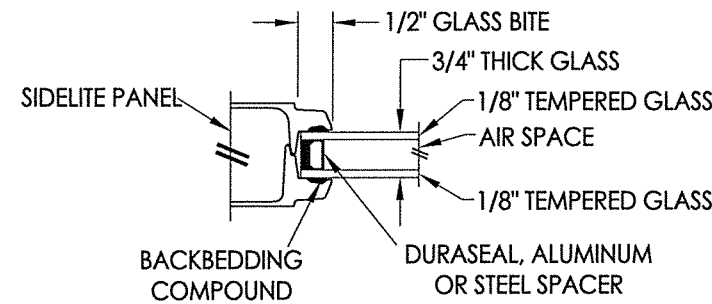

G3 GLAZING DETAIL
Flush Glazing
Sidelites

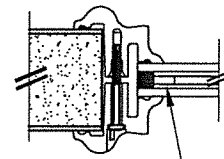

INTERNAL GRID (GBG)

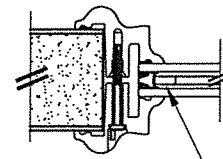

INTERNAL GRID (GBG)
(Optional Aluminum Spacer)

9/16" INSULATED GLASS INSERT OPTIONS

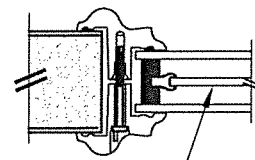

DECORATIVE INSERT

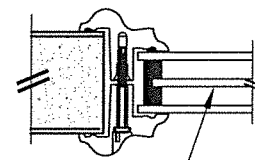

PRIVACY INSERT

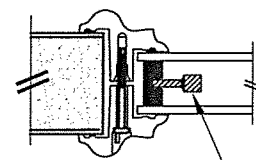

WROUGHT IRON INSERT

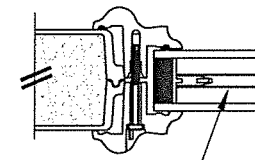

INTERNAL GRID (GBG)

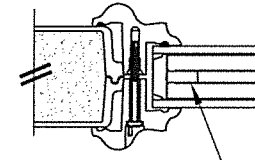

INTERNAL GRID (GBG)
(Optional Aluminum Spacer)

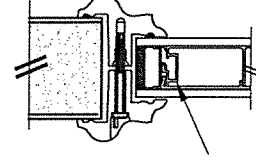

MINI BLIND
(Aluminum Spacer)

1" INSULATED GLASS INSERT OPTIONS

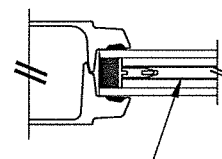

INTERNAL GRID (GBG)

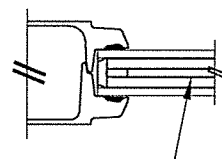

INTERNAL GRID (GBG)

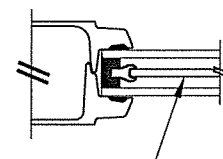

DECORATIVE INSERT

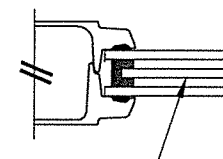

PRIVACY INSERT

3/4" INSULATED GLASS INSERT OPTIONS

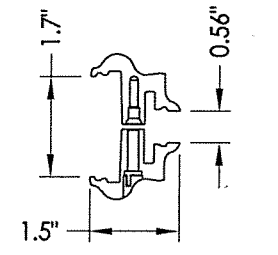

3A BTS LITE FRAME
1/2" & 9/16" Glazing

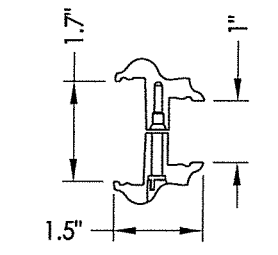

3B BTS LITE FRAME
1" Glazing

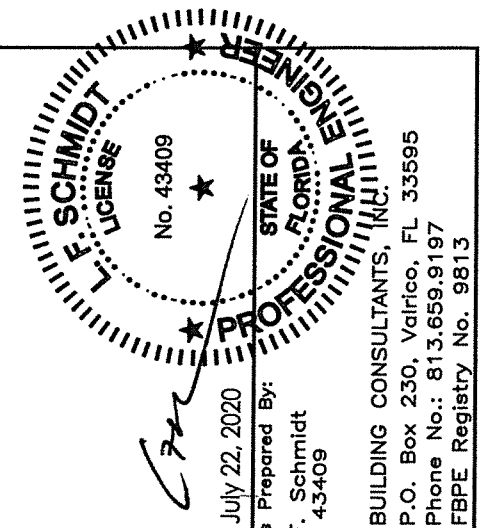

Documents Prepared By:
Lyndon F. Schmidt
P.E. No. 43409

R.W. BUILDING CONSULTANTS, INC.
P.O. Box 230, Valrico, FL 33595
Phone No.: 813.659.9197
FBPE Registry No. 9813

PRODUCT:	Therma-TRU FIBERGLASS DOOR
PART OR ASSEMBLY:	GLAZING DETAILS

NO.	DATE	REVISIONS
4	7/21/20	UPDATE TO 7th ED (2020) FBC
3	10/09/18	REV. DOOR PANEL OPTION NOTE
2	11/15/17	RECESSED PANEL NOTATION
1	7/7/17	UPDATE TO 6th ED (2017) FBC

DATE:	8/10/16
SCALE:	N.T.S.
DWG. BY:	JK
CHK. BY:	LFS
DRAWING NO.:	FL-20461.2
SHEET	12 OF 14

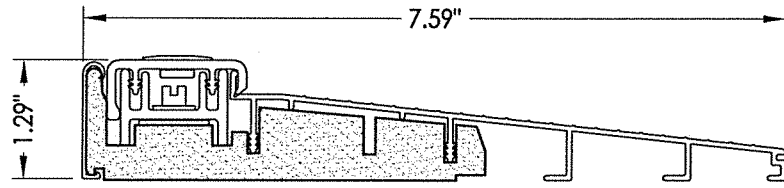

32 INSWING THRESHOLD
Inswing Basic Composite Adjustable Sill 7-1/2"

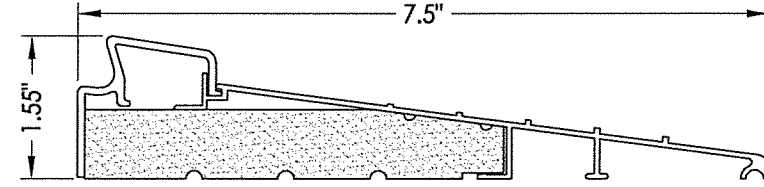

37 INSWING THRESHOLD
Inswing Basic Fixed 7-1/2" Sill

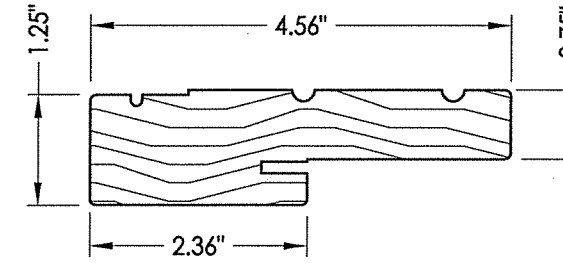

1 WOOD JAMB

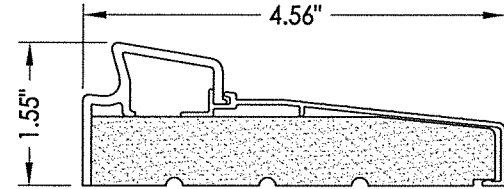

33 INSWING THRESHOLD
Inswing Basic Fixed Sill

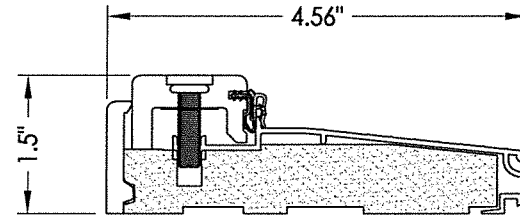

38 INSWING THRESHOLD
Inswing Composite Adjustable Sill

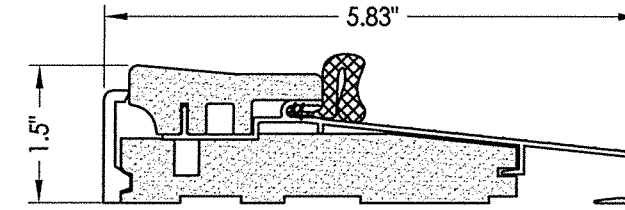

16 OUTSWING THRESHOLD
Composite Sill

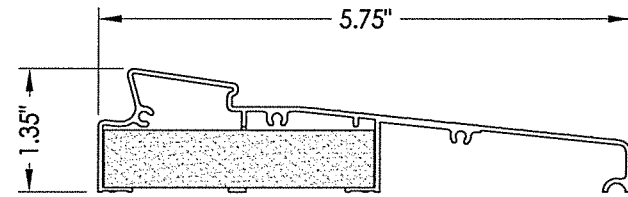

34 INSWING THRESHOLD
Inswing Moderate Climate Sill 1-3/8"

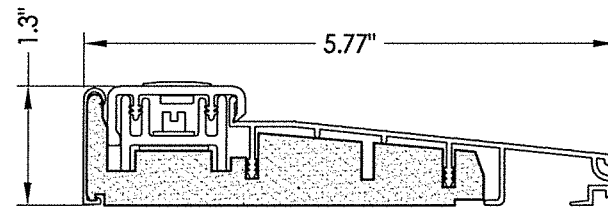

39 INSWING THRESHOLD
Inswing Basic Composite Adjustable Sill

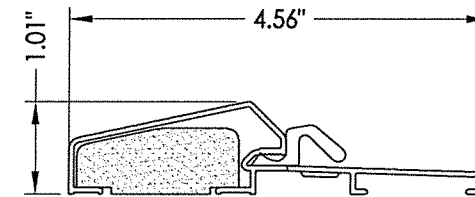

17 OUTSWING THRESHOLD
Composite / Aluminum Sill

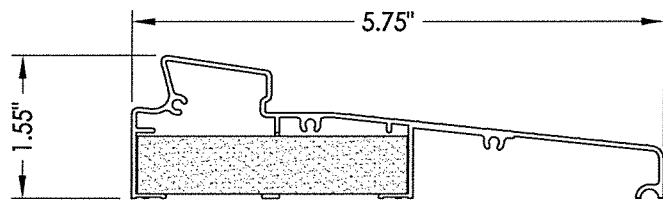

35 INSWING THRESHOLD
Inswing Moderate Climate Sill

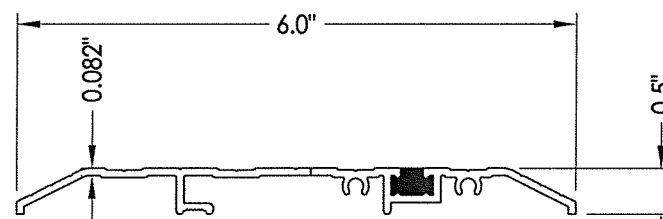

15 PUBLIC ACCESS THRESHOLD

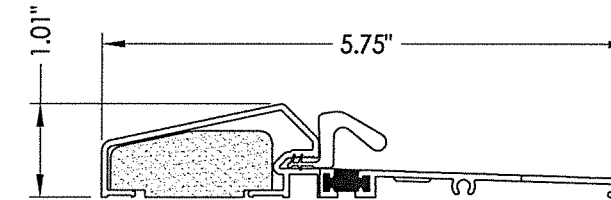

18 OUTSWING THRESHOLD
Composite / Aluminum Sill
(Thermal Break)

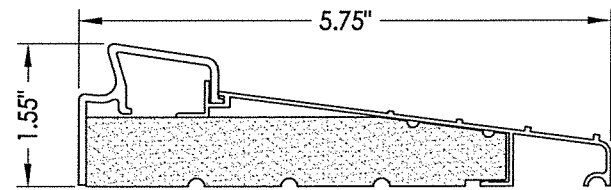

36 INSWING THRESHOLD
Inswing Basic Fixed 5-3/4" Sill

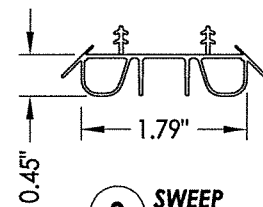

8 SWEEP

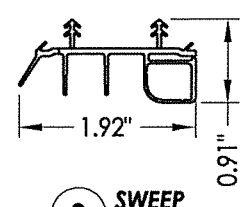

9 SWEEP

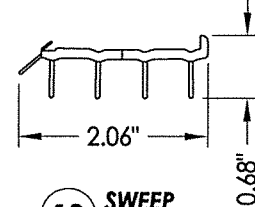

10 SWEEP

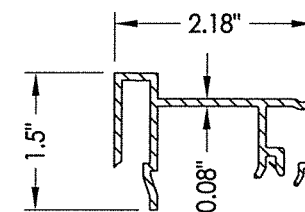

75 SIDELITE SPACER
Inswing

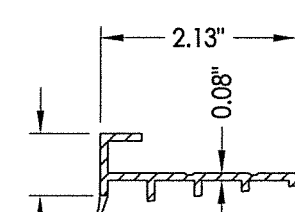

76 SIDELITE SPACER
Outswing

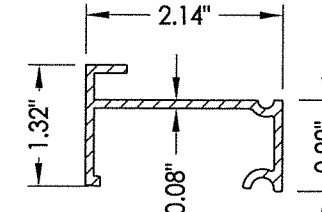

77 SIDELITE SPACER
Inswing
Moderate Climate Threshold

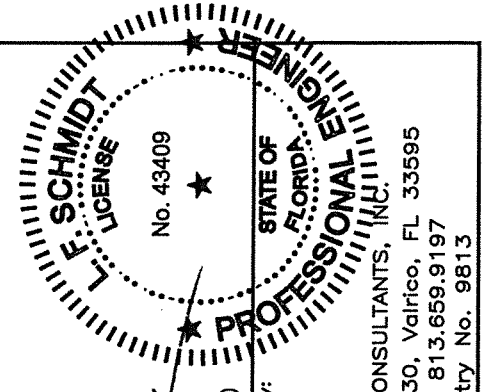

July 22, 2020
Documents Prepared By:
Lyndon F. Schmidt
P.E. No. 43409
RW BUILDING CONSULTANTS, INC.
P.O. Box 230, Valrico, FL 33595
Phone No.: 813.659.9197
FBPE Registry No. 9813

PRODUCT:	THERMA-TRU FIBERGLASS DOOR
PART OR ASSEMBLY:	COMPONENTS

NO.	DATE	BY	REVISIONS
4	7/21/20	LFS	UPDATE TO 7th ED (2020) FBC
3	10/09/18	MT	REV. DOOR PANEL OPTION NOTE
2	11/15/17	JK	RECESSED PANEL NOTATION
1	7/7/17	JK	UPDATE TO 6th ED (2017) FBC

DATE:	8/10/16
SCALE:	N.T.S.
DWG. BY:	JK
CHK. BY:	LFS
DRAWING NO.:	FL-20461.2
SHEET	13 OF 14

BILL OF MATERIALS			BILL OF MATERIALS		
ITEM #	DESCRIPTION	MATERIAL	ITEM #	DESCRIPTION	MATERIAL
A	1X BUCK (SG >= 0.42)	WOOD	25	#8 x 2-1/2" PFH WOOD SCREW	STEEL
B	2X BUCK (SG >= 0.42)	WOOD	26	#8 x 5/8" PFH WOOD SCREW	STEEL
C	1/4" MAX. SHIM SPACE	-	27	LATCH STRIKE PLATE	STEEL
D	1/4" X 2-3/4" PFH ELCO OR ITW CONCRETE SCREW	STEEL	28	DEADBOLT STRIKE PLATE	STEEL
E	MASONRY - 3,000 PSI MIN. CONCRETE CONFORMING TO ACI 301 OR HOLLOW BLOCK CONFORMING TO ASTM C90	CONCRETE	28A	DEADBOLT SUB STRIKE PLATE	STEEL
			29	4" X 4" HINGE	STEEL
F	#10 X 2" PFH WOOD SCREW	STEEL	30	LATCH & DEADBOLT STRIKE PLATE (TONGUE SYSTEM)	ALUM/COMP
G	3/16" X 3-1/4" ITW CONCRETE SCREW	STEEL	31	MULTIPOINT STRIKE PLATE (TONGUE SYSTEM)	ALUM/COMP
I	1/4" X 1-3/4" PFH ELCO OR ITW CONCRETE SCREW	STEEL	32	INSWING THRESHOLD	ALUM/COMP
J	1/4" X 3-3/4" PFH ELCO OR ITW CONCRETE SCREW	STEEL	33	INSWING THRESHOLD	ALUM/COMP
L	#10 X 2-1/2" PFH WOOD SCREW (1.15" MIN. EMBEDMENT)	STEEL	34	INSWING THRESHOLD	ALUM/COMP
M	3/16" X 2-1/4" ITW CONCRETE SCREW	STEEL	35	INSWING THRESHOLD	ALUM/COMP
N	3/16" X 2-3/4" ITW CONCRETE SCREW	STEEL	36	INSWING THRESHOLD	ALUM/COMP
1	JAMB (FINGER JOINT PINE)	WOOD	37	INSWING THRESHOLD	ALUM/COMP
6	WEATHERSTRIP (MEDIUM REACH)	FOAM	38	INSWING THRESHOLD	ALUM/COMP
7	WEATHERSTRIP (LONG REACH)	FOAM	39	INSWING THRESHOLD	ALUM/COMP
8	SWEEP	VINYL	40	DOOR PANEL (BOOK)	-
9	SWEEP (USE w/ MODERATE CLIMATE THRESHOLD)	VINYL	41	DOOR PANEL (HYBRID)	-
10	SWEEP (USE w/ PUBLIC ACCESS THRESHOLD)	VINYL	42	DOOR PANEL (U1)	-
15	PUBLIC ACCESS THRESHOLD	ALUM	50	SIDELITE (FULL LITE)	-
16	OUTSWING THRESHOLD	ALUM/COMP	60	SIDELITE (FLUSH GLAZED)	-
17	OUTSWING THRESHOLD	ALUM/COMP	75	SIDELITE SPACER (INSWING)	-
18	OUTSWING THRESHOLD	ALUM/COMP	76	SIDELITE SPACER (OUTSWING)	-
22	#8 x 3/4" PFH WOOD SCREW	STEEL	77	SIDELITE SPACER (INSWING) - MODERATE CLIMATE SILL	-
23	#10 x 3/4" PFH WOOD SCREW	STEEL			
24	#10 x 1" PFH WOOD SCREW	STEEL			

CONCRETE ANCHOR NOTES:

- Concrete anchor locations at the corners may be adjusted to maintain the min. edge distance to mortar joints.
- Concrete anchor locations noted as "MAX. ON CENTER" must be adjusted to maintain the min. edge distance to mortar joints, additional concrete anchors may be required to ensure the "MAX. ON CENTER" dimension are not exceeded.
- Concrete anchor table:

ANCHOR TYPE	ANCHOR SIZE	MIN. EMBEDMENT	MIN. CLEARANCE TO MASONRY EDGE	MIN. CLEARANCE TO ADJACENT ANCHOR
ITW TAPCON®	1/4"	1-1/4"	2"	4"
ELCO ULTRACON®	1/4"	1-1/4"	1"	4"
ITW TAPCON®	3/16"	1-1/4"	AS SHOWN	1-1/2"

WOOD SCREW INSTALLATION NOTES:

- Maintain a minimum 5/8" edge distance, 1" end distance, & 1" o.c. spacing of wood screws to prevent the splitting of wood.

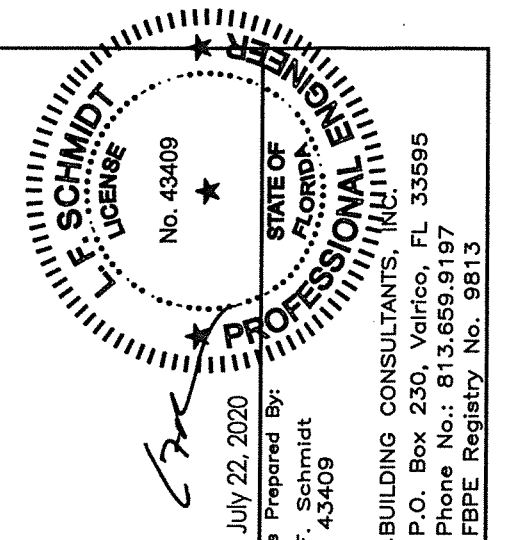

July 22, 2020

Documents Prepared By:
Lyndon F. Schmidt
P.E. No. 43409

R.W. BUILDING CONSULTANTS, INC.
P.O. Box 230, Valrico, FL 33595
Phone No.: 813.659.9197
FBPE Registry No. 9813

PRODUCT:
THERMA-TRU
FIBERGLASS DOOR

PART OR ASSEMBLY:
BILL OF MATERIALS

			LFS	MT	JK	JK	BY
4	7/21/20	UPDATE TO 7th ED (2020)	FBC				
3	10/09/18	REV. DOOR PANEL OPTION NOTE					
2	11/15/17	RECESSED PANEL NOTATION					
1	7/7/17	UPDATE TO 6th ED (2017)	FBC				
	NO.	DATE					

DATE: 8/10/16

SCALE: N.T.S.

DWG. BY: JK

CHK. BY: LFS

DRAWING NO.:

FL-20461.2

SHEET 14 of 14