

Columbia County Property Appraiser

Jeff Hampton

Retrieve Tax Record

Tax Estimator

2024 TRIM (pdf)

Property Card

Parcel List Generator

Show

Parcel: << 20-3S-17-05320-001 (25310) >>

Owner & Property Info

<< Result: 61 of 71 >>

Owner	DAVIS JAY S P O BOX 1508 LAKE CITY, FL 32056		
Site	234 NE MEEKS ST, LAKE CITY		
Description*	LOTS 3, 4 & 5 & THE E 15 FT OF LOT 6, BICKEL'S SURVEY UNR 748-1974-1975, 768-1217,		
Area	1.517 AC	S/T/R	20-3S-17
Use Code**	MOBILE HOME (0200)	Tax District	2

*The Description above is not to be used as the Legal Description for this parcel in any legal transaction

**The Use Code is a FL Dept. of Revenue (DOR) code and is not maintained by the Property Appraiser's office. Please contact your city or county Planning & Zoning office for specific zoning information

Property & Assessment Values

2024 Certified Values		2025 Working Values	
Mkt Land	\$16,531	Mkt Land	\$16,531
Ag Land	\$0	Ag Land	\$0
Building	\$76,581	Building	\$95,485
XFOB	\$1,200	XFOB	\$1,200
Just	\$94,312	Just	\$113,216
Class	\$0	Class	\$0
Appraised	\$94,312	Appraised	\$113,216
SOH/10% Cap	\$9,545	SOH/10% Cap	\$19,972
Assessed	\$94,312	Assessed	\$113,216
Exempt	\$0	Exempt	\$0
Total Taxable	county:\$84,767 city:\$0 other:\$0 school:\$94,312	Total Taxable	county:\$93,244 city:\$0 other:\$0 school:\$113,216

NOTE: Property ownership changes can cause the Assessed value of the property to reset to full Market value, which could result in higher property taxes.

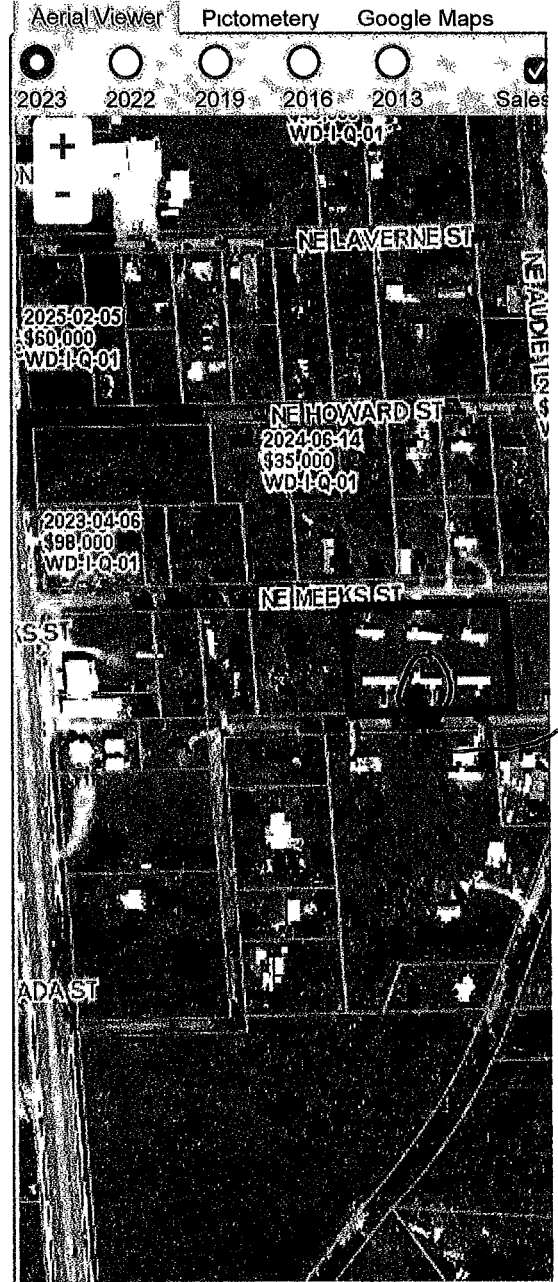

Sales History

Show Similar Sales within 1/2 mile

Sale Date	Sale Price	Book/Page	Deed	V/I	Qualification (Codes)
12/3/1992	\$5,000	768 / 1217	WD	V	Q
7/24/1991	\$3,500	748 / 1974	WD	V	U

Building Characteristics

Bldg Sketch	Description*	Year Blt	Base SF	Actual SF
-------------	--------------	----------	---------	-----------