

As required by Florida Statute 553.842 and Florida Administrative Code 9B-72, please provide the information and approval numbers on the building components listed below if they will be utilized on the construction project for which you are applying for a building permit. We recommend you contact your local product supplier should you not know the product approval number for any of the applicable listed products. Statewide approved products are listed online @ www.floridabuilding.org

Category/Subcategory	Manufacturer	Product Description	Approval Number(s)
1. EXTERIOR DOORS			
A. SWINGING	ThermaTru	Composite Edge fiberglass single door	20461.9
B. SLIDING			
C. SECTIONAL/ROLL UP			
D. OTHER			
2. WINDOWS			
A. SINGLE/DOUBLE HUNG	Simonton	vinyl window	5167.15
B. HORIZONTAL SLIDER			
C. CASEMENT			
D. FIXED			
E. MULLION			
F. SKYLIGHTS			
G. OTHER			
3. PANEL WALL			
A. SIDING			
B. SOFFITS			
C. STOREFRONTS			
D. GLASS BLOCK			
E. OTHER			
4. ROOFING PRODUCTS			
A. ASPHALT SHINGLES			
B. NON-STRUCT METAL			
C. ROOFING TILES			
D. SINGLE PLY ROOF			
E. OTHER			
5. STRUCT COMPONENTS			
A. WOOD CONNECTORS			
B. WOOD ANCHORS			
C. TRUSS PLATES			
D. INSULATION FORMS			
E. LINTELS			
F. OTHERS			
6. NEW EXTERIOR ENVELOPE PRODUCTS			

The products listed below did not demonstrate product approval at plan review. I understand that at the time of inspection of these products, the following information must be available to the inspector on the jobsite; 1) copy of the product approval, 2) performance characteristics which the product was tested and certified to comply with, 3) copy of the applicable manufacturers installation requirements.

Further, I understand these products may have to be removed if approval cannot be demonstrated during inspection.

NOTES: _____

MODEL DESIGNATION: Simonton Double Hung Series 75-75 / 75-09 / 07-75 / 07-09 / 07-10 / 07-20 Vinyl Window

MAXIMUM OVERALL NOMINAL SIZE: See Size Chart

DESIGN PRESSURE RATING: See Size Chart

USABLE CONFIGURATIONS: X
X

GENERAL DESCRIPTION: The head, sill, and side jambs are extruded PVC. The wall thickness through which the anchor screw penetrates is a minimum of 0.070".

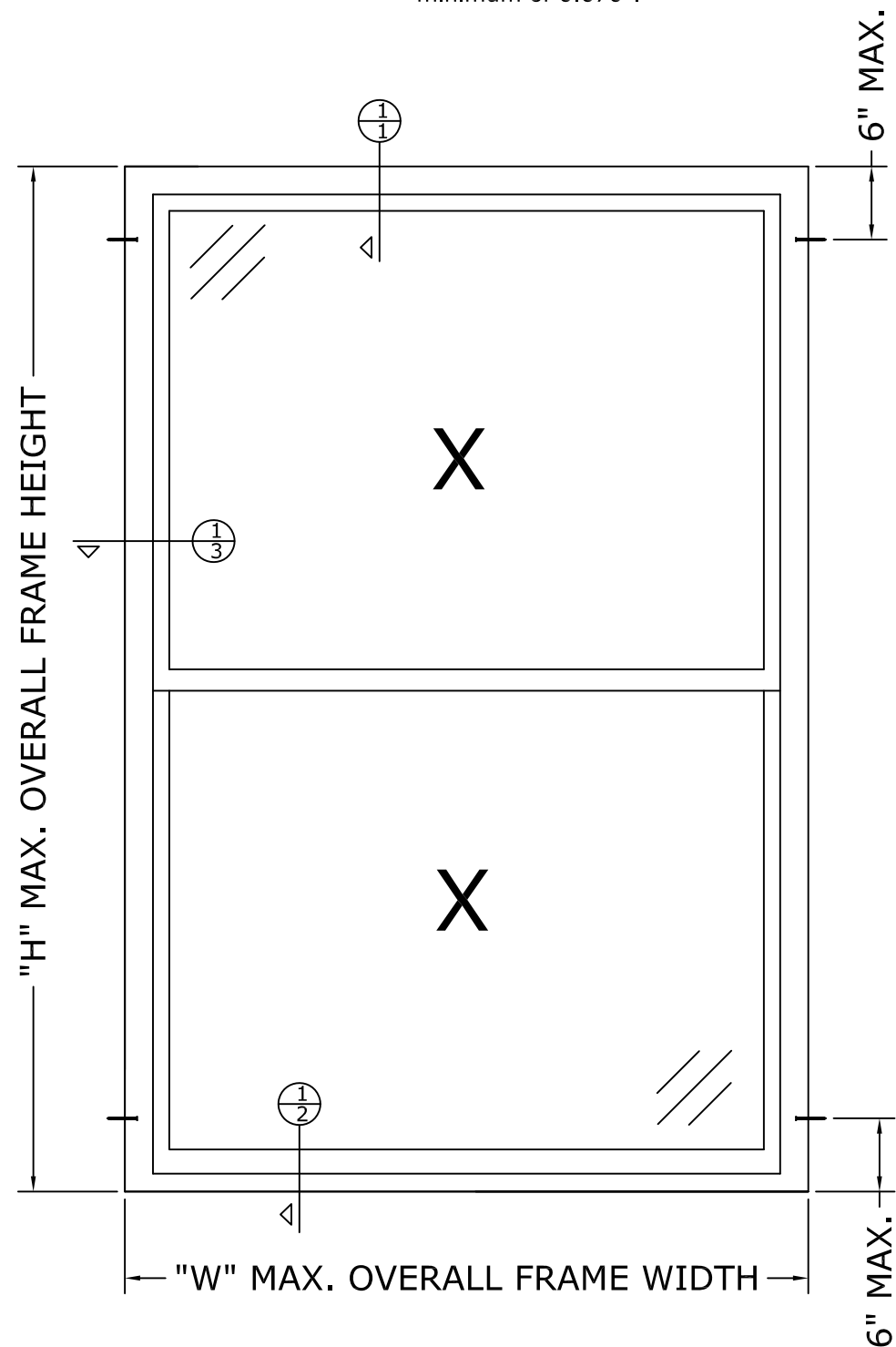

SIZE CHART		
OVERALL SIZE		DP RATING
WIDTH "W"	HEIGHT "H"	
48"	80"	±25 PSF
53"	74"	±30 PSF
48"	80"	±35 PSF
52"	71"	
53"	80"	±40 PSF
36"	63"	±50 PSF
36"	74"	
36"	72"	±55 PSF

**NO P.E. SEAL REQUIRED
INSTALLATION SUPPORTED
BY AAMA TEST REPORTS**

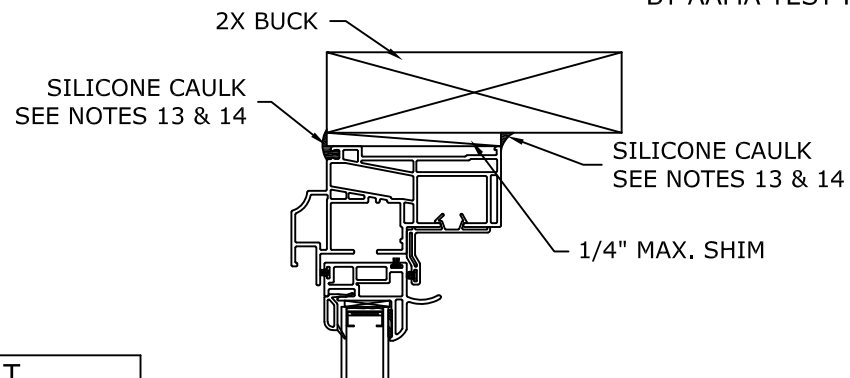

1
1 HEAD

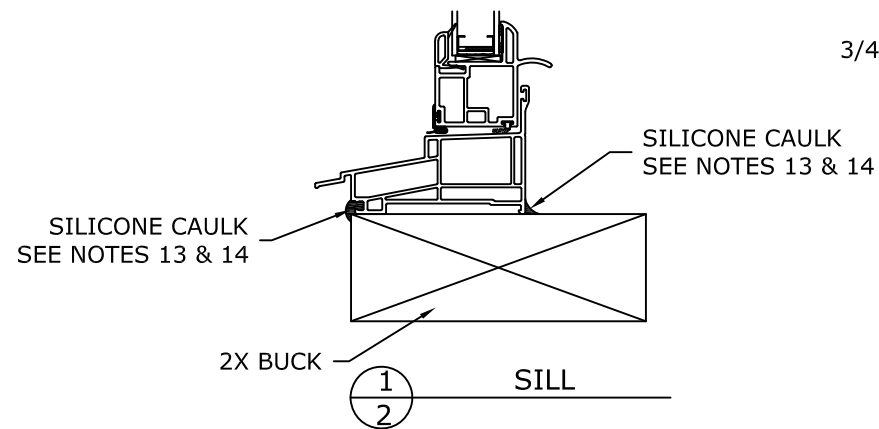

1
2 SILL

REV. #:	REVISIONS:	REVISED BY:	DATE:
10	UPDATED SIZES PER NEW TESTING.	T.D.D.	01/29/14
11	ADDED MIN. EDGE DISTANCE NOTES	GJM	06/16/15
12	ADDED NEW SIZE TO CHART	LMH	07/10/15
13	ADDED NOTES 12 & 13 - AAMA 800	LMH	08/18/16
14	UPDATED SIZES PER NEW TESTING.	LMH	04/11/18

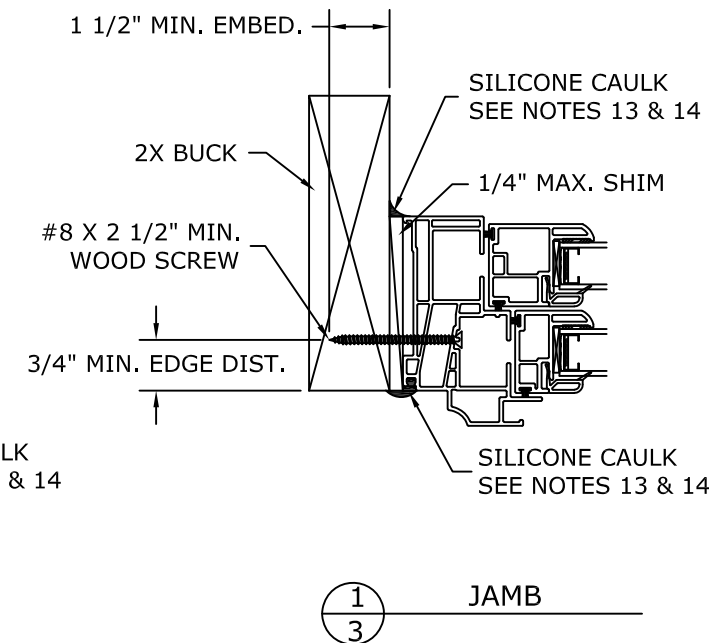

1
3 JAMB

NOTES:

- This installation has been evaluated for use in locations adhering to the Florida Building Codes and where pressure requirements as determined by ASCE 7 Minimum Design Loads for Buildings and Other Structures do not exceed the design pressure ratings herein, for use outside the H.V.H.Z.
- All exterior perimeter surfaces of the window must be caulked. Interior caulking is optional unless noted otherwise.
- Anchors shall be as specified and spaced as shown. Anchor embedment to base material shall be beyond wall dressing or stucco and into wood.
- The responsibility for selection of Simonton products to meet any applicable local laws, building codes, ordinances, or other safety requirements rests solely with the architect, building owner, or contractor.
- Shims are optional. Max. shim stack is 1/4".
- Wood bucks (by others) must be engineered and anchored properly to transfer loads to the structure.
- When used in areas requiring impact protection this product **REQUIRES** the use of approved impact resistant shutters or other external protection.
- Flashing should be applied using the ASTM E 2112 method appropriate for the opening into which the window is being installed.
- Installation screws must be at least 3/4" from the edge of the wood.
- Installation screws may be placed in the interior or exterior track of the jamb. Screws should be flush with the vinyl.
- This product complies with ASTM E 1300.
- Designation "X" and "O" stand for the following: X: Operable Panel - O: Fixed Panel.
- Use 100% pure silicone caulk compliant with AAMA 800 Section 1 - Sealant Specifications for use with Architectural Fenestration Products. For more details visit Simonton.com.
- Use a backer rod on all joints >3/4" deep and/or wider than 1/4". Finished caulk joint should be a minimum of 3/8" deep.

<p>DISCLOSURE STATEMENT This document is the property of Simonton Windows, which retains all proprietary and other rights to its subject matter. This document is provided to the recipient on the expressed condition that it is not to be disclosed, reproduced in whole or part, nor used in conjunction with the design, manufacture or repair of goods for anyone other than Simonton Windows without its consent. This restriction does not limit the recipient's rights to utilize information contained in this document which is properly obtained from another source.</p>	<p>MATERIAL:</p>	<p>Dimensional Tolerances Unless Otherwise Specified</p>	<p>SIMONTON WINDOWS 1 Cochrane Avenue Pennsboro, WV 26415</p>	<p>SIZE: B</p>	<p>DRAWING NO.: IN0113</p>	<p>REV. 14</p>	
	<p>RMS FINISH: EXCEPT AS NOTED</p>			<p>Decimals Angles</p>	<p>DRAWN BY: T.D.D.</p>	<p>DATE: 03/02/07</p>	
<p>ALLOY & TEMPER:</p>	<p>WEIGHT: VOLUME:</p>	<p>.X ± .03 .XX ± .01 .XXX ± .005</p>	<p>1 Cochrane Avenue Pennsboro, WV 26415</p>	<p>CHECKED BY:</p>	<p>DATE:</p>	<p>APPRV'D BY:</p>	<p>DATE:</p>
<p>SURFACE AREA: PERIMETER:</p>	<p>FINISH TREATMENT:</p>	<p>FILE: FL 5176.15</p>	<p>SCALE: FIT SHEET: 1 of 1</p>	<p>SERIES: 75-75 / 75-09 / 07-75 / 07-09 / 07-10 / 07-20 DOUBLE HUNG</p>			
<p>TITLE: 2X BUCK INSTALLATION (AS TESTED)</p>							

THERMA-TRU® DOORS

Fiber-Classic® & Smooth-Star®

COMPOSITE EDGE GLAZED FIBERGLASS SINGLE DOOR IN SWING/OUT SWING "NON-IMPACT"

GENERAL NOTES

- This product has been evaluated and is in compliance with the 6th Edition (2017) Florida Building Code (FBC) structural requirements excluding the "High Velocity Hurricane Zone" (HVHZ).
- Product anchors shall be as listed and spaced as shown on details. Anchor embedment to base material shall be beyond wall dressing or stucco.
- When used in areas requiring wind borne debris protection, this product is required to be protected with an impact resistant covering that complies with FBC Sections 1609.1.2 & R301.2.1.2.
- For 2x stud framing construction, anchoring of these units shall be the same as that shown for 2x buck masonry construction.
- Site conditions that deviate from the details of this drawing require further engineering analysis by a licensed engineer or registered architect.
- Fiber-Classic & Smooth-Star Door panels require the use of "J" part numbers and must be stained or painted within six months of installation.

TABLE OF CONTENTS	
SHEET #	DESCRIPTION
1	Typical Elevations, Design Pressures & General Notes
2	Door Panel Details
3	Door Panel Details
4	Elevations
5	Horizontal & Vertical Cross Sections (2X Buck)
6	Horizontal & Vertical Cross Sections (1X Buck)
7	Horizontal & Vertical Cross Sections (Direct to Masonry)
8	Vertical Cross Sections (Thresholds)
9	Buck & Frame Anchoring
10	Hardware Details
11	Glazing Details
12	Components
13	Bill of Materials

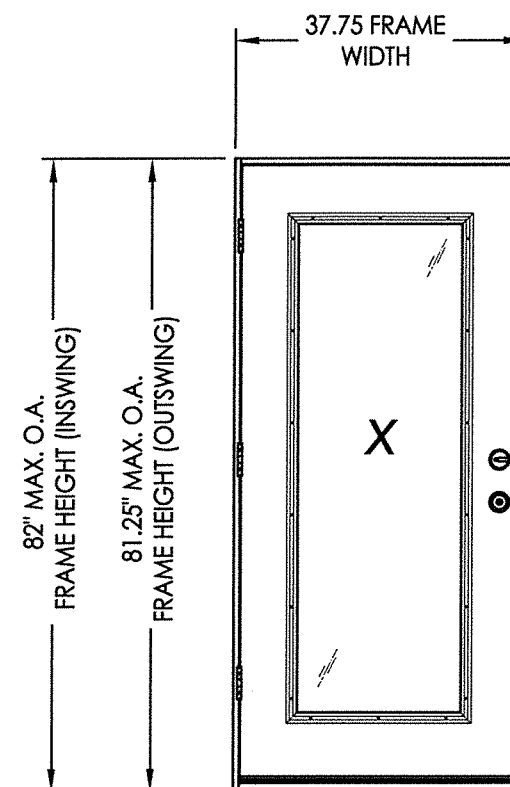

CONFIG.	LITE INSERT	DOOR GLAZING MAX. D.L.O.	LOCK HARDWARE	DESIGN PRESSURE (PSF) IN SWING		DESIGN PRESSURE (PSF) OUT SWING	
				POSITIVE	NEGATIVE	POSITIVE	NEGATIVE
X	Lip Lite	21.12" X 63.12"	Latch & Deadbolt	+50.0	-50.0	+50.0	-50.0
X			Multipoint	+50.0	-50.0	+50.0	-50.0
X	Molded Open	21.12" X 63.12"	Latch & Deadbolt	+50.0	-50.0	+50.0	-50.0
X			Multipoint	+55.0	-55.0	+60.0	-60.0
X	Flush Glazed	24.12" X 63.38"	Latch & Deadbolt	+55.0	-65.0	+55.0	-55.0
X			Multipoint	+55.0	-65.0	+55.0	-55.0
X	Flush Glazed	26.0" X 63.38"	Latch & Deadbolt	+55.0	-65.0	+55.0	-55.0
X			Multipoint	+50.0	-50.0	+50.0	-50.0

See Sheet 4 for Hardware Specifications

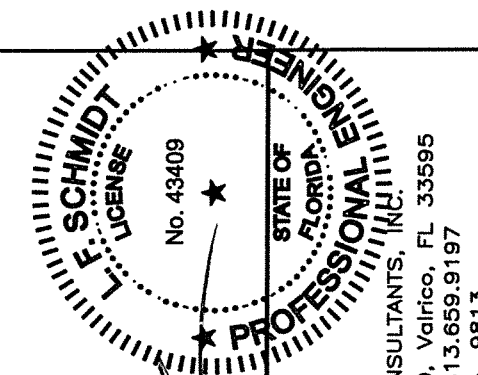

10/09/18
 Documents Prepared By:
 Lyndon F. Schmidt
 P.E. No. 43409
 R.W. BUILDING CONSULTANTS, INC.
 P.O. Box 230, Vairico, FL 33595
 Phone No.: 813.659.9197
 FBPE C.A. No. 9813

PRODUCT: THERMA-TRU FIBERGLASS DOOR
 PART OR ASSEMBLY: TYPICAL ELEVATION, DESIGN PRESSURES & GENERAL NOTES

NO.	DATE	REVISIONS
3	10/09/18	REV. DOOR PANEL OPTION NOTE
2	7/7/17	UPDATE TO 6th ED (2017) FBC
1	3/22/17	REVISE FLUSH GLAZING
		BY

DATE: 6/1/16
 SCALE: N.T.S.
 DWG. BY: JK
 CHK. BY: LFS
 DRAWING NO.: FL-20461.9
 SHEET 1 OF 13

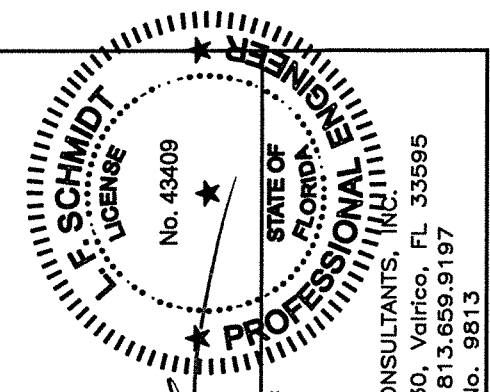
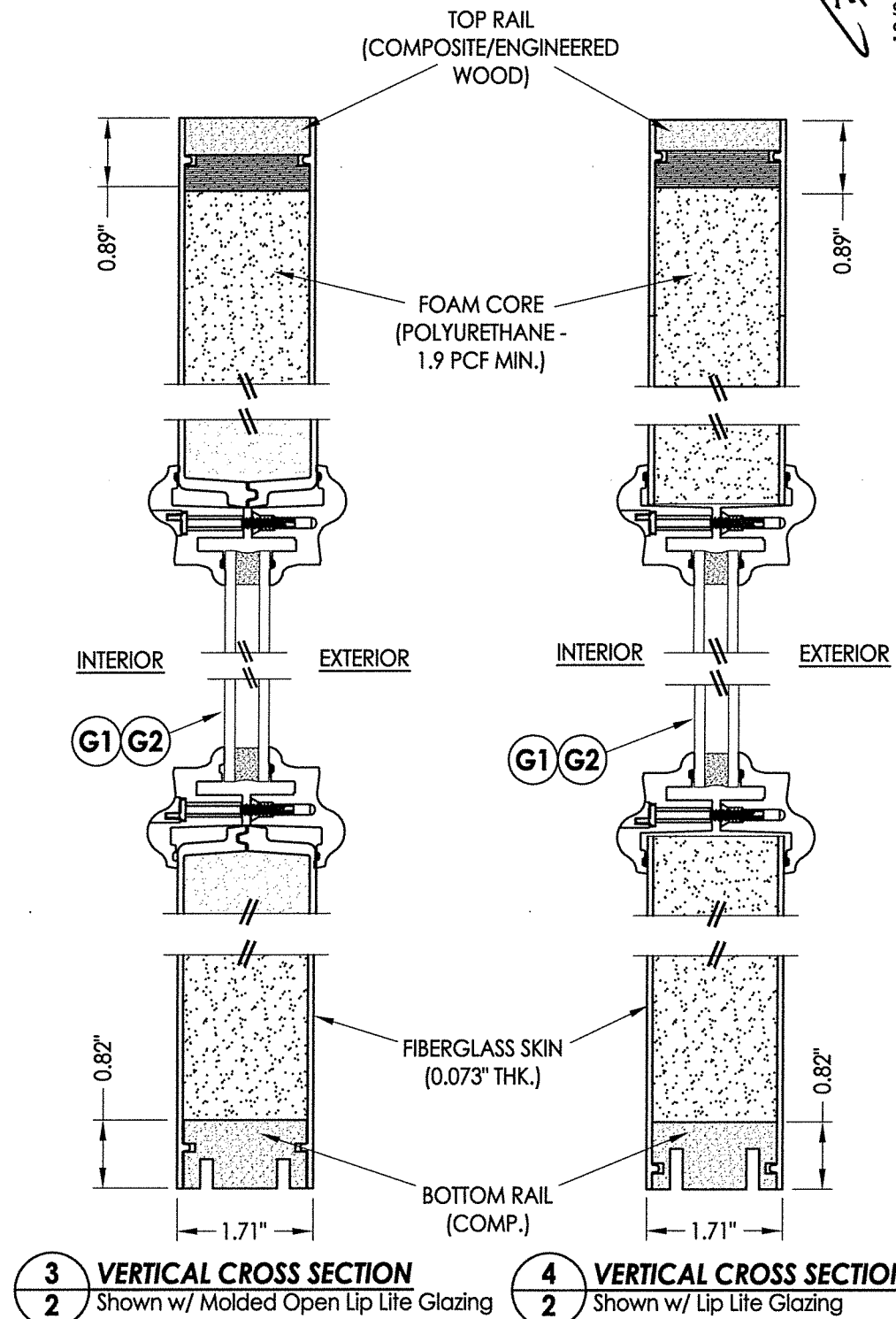
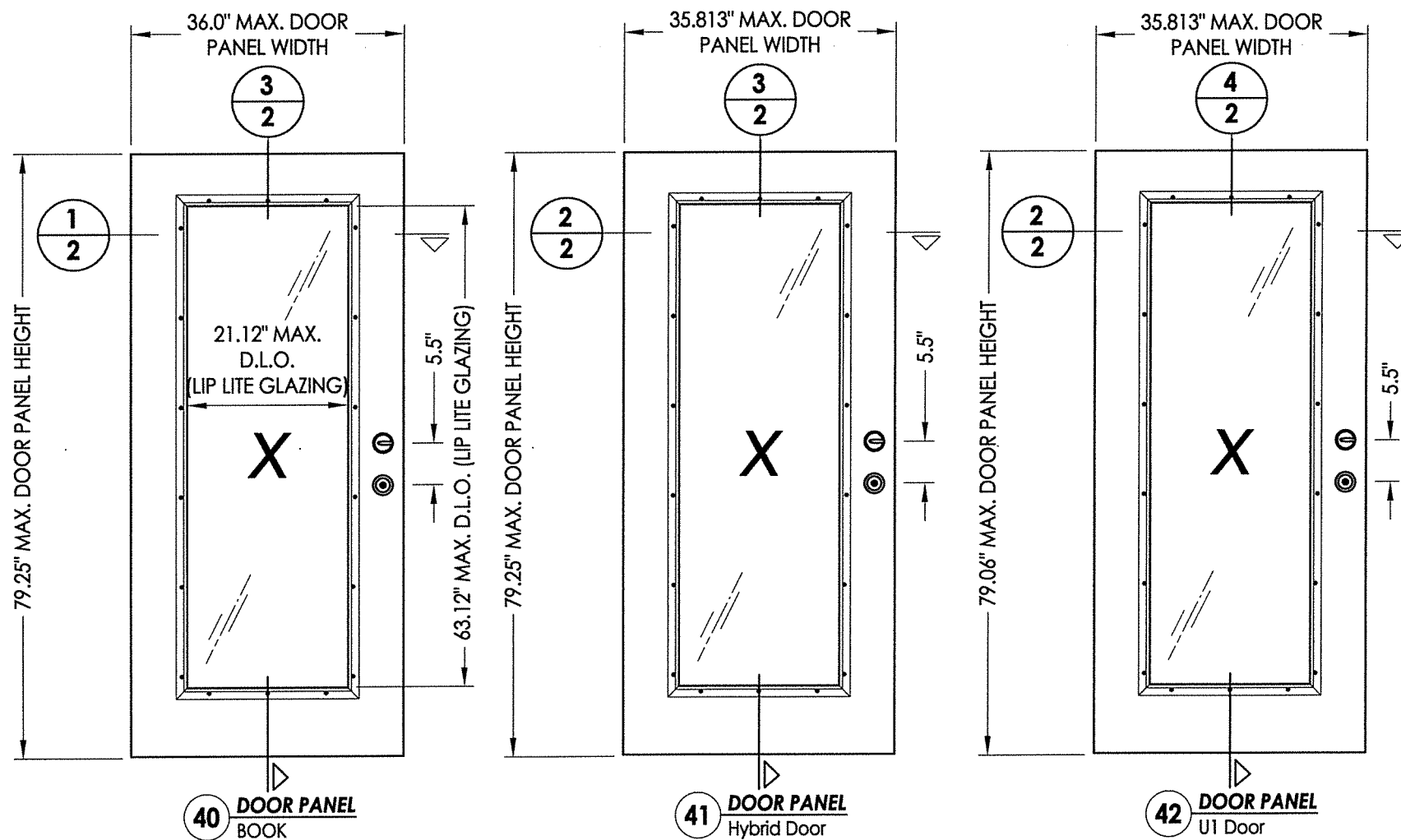
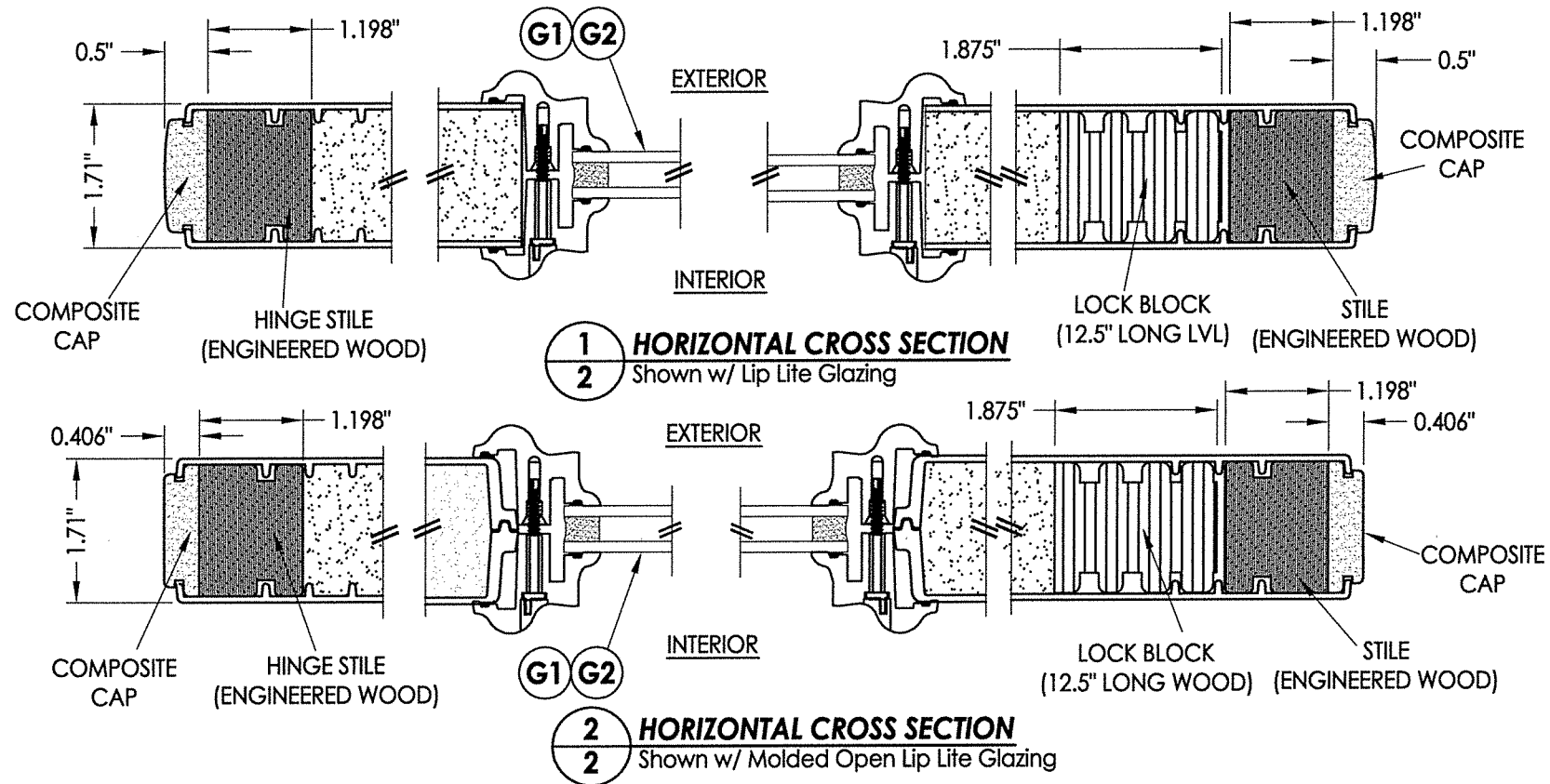

10/09/18
Documents Prepared By:
Lyndon F. Schmidt
P.E. No. 43409
R.W. BUILDING CONSULTANTS, INC.
P.O. Box 230, Valrico, FL 33595
Phone No.: 813.659.9197
FBPE C.A. No. 9813

PRODUCT:		THERMA-TRU FIBERGLASS DOOR	
PART OR ASSEMBLY:		DOOR PANEL DETAILS	
NO.	DATE	BY	REVISIONS
3	10/09/18	JK	REV. DOOR PANEL OPTION NOTE
2	7/7/17	JK	UPDATE TO 6th ED (2017) FBC
1	3/22/17	LFS	REVISE FLUSH GLAZING
DATE:	6/1/16		
SCALE:	N.T.S.		
DWG. BY:	JK		
CHK. BY:	LFS		
DRAWING NO.:	FL-20461.9		
SHEET	2 OF 13		

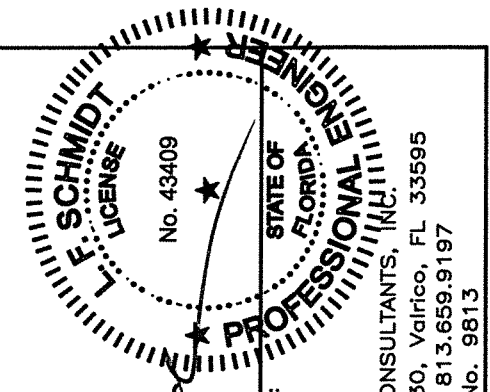
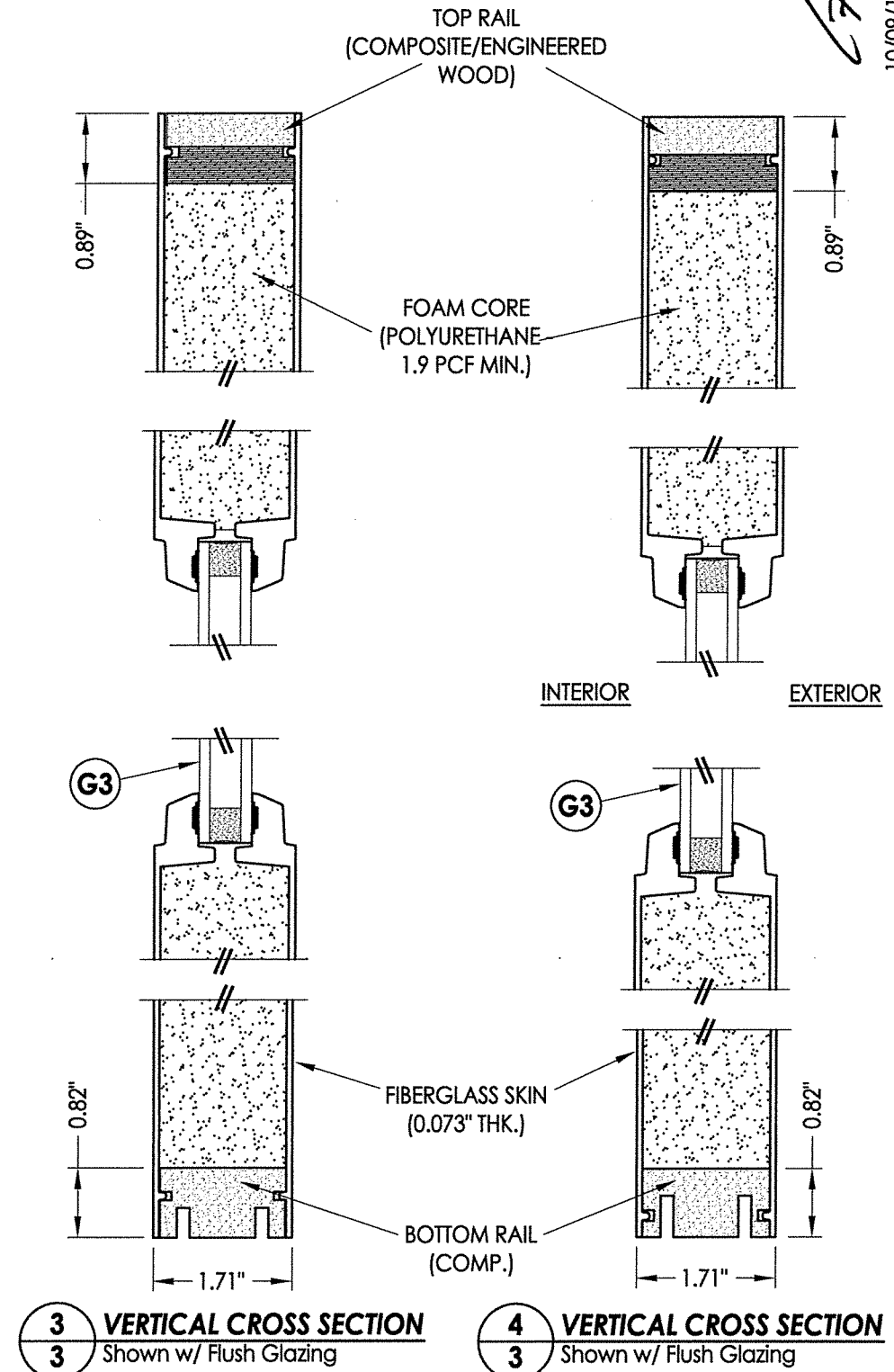
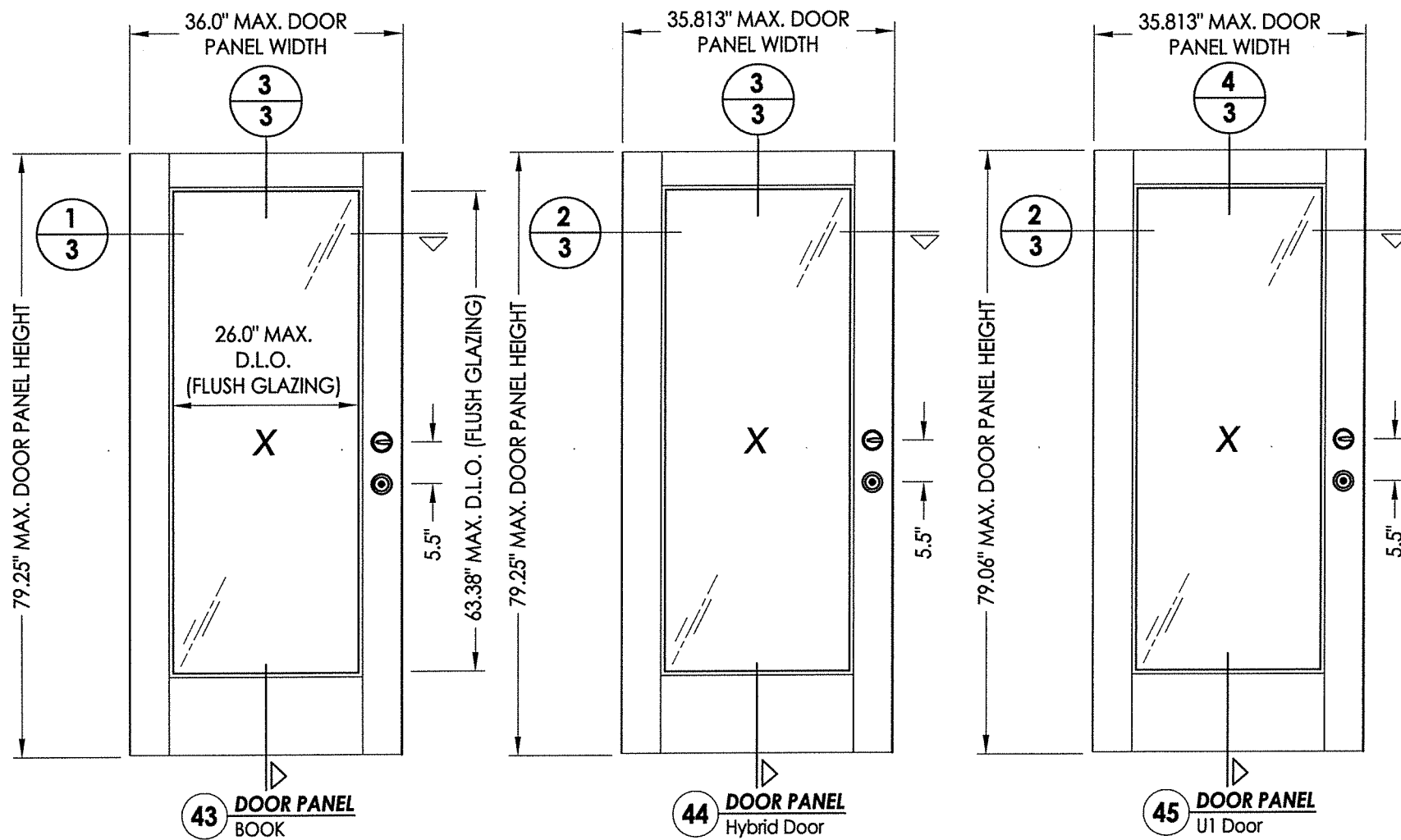
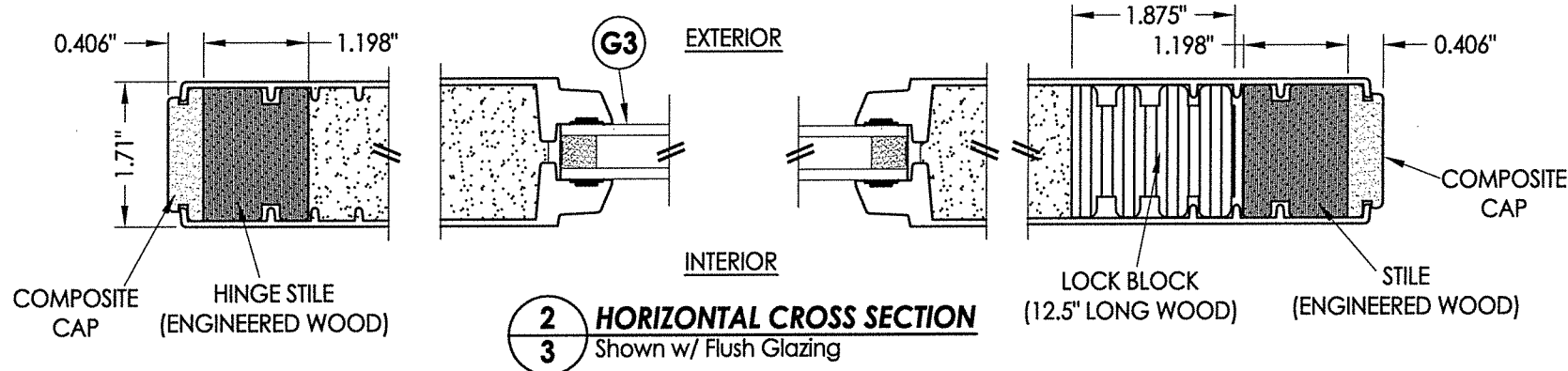
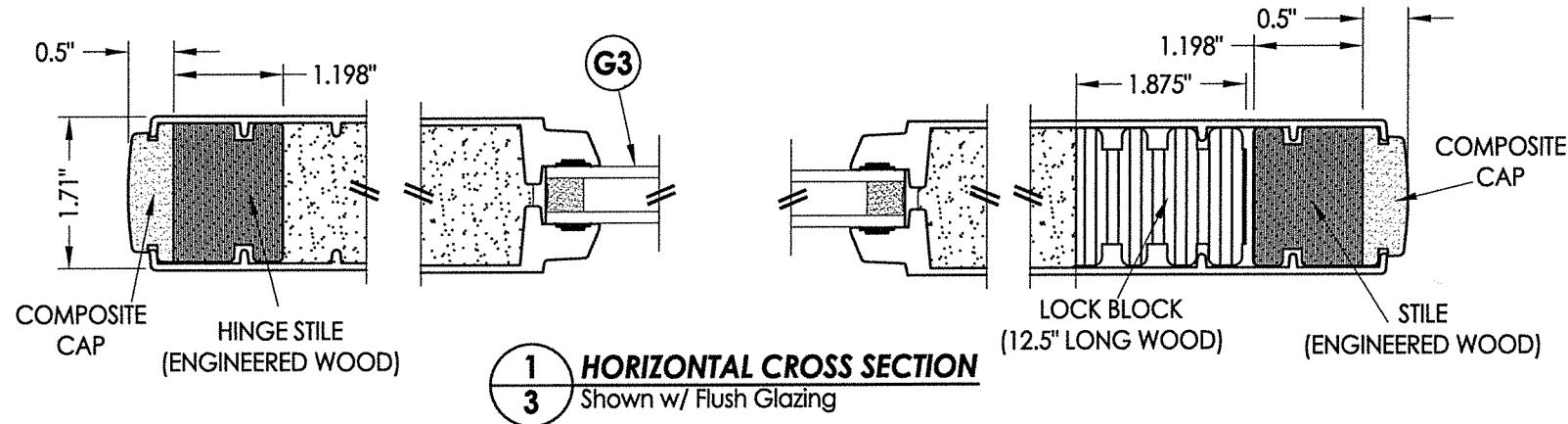

10/09/18
 Documents Prepared By:
 Lyndon F. Schmidt
 P.E. No. 43409
 R.W. BUILDING CONSULTANTS, INC.
 P.O. Box 230, Vairico, FL 33595
 Phone No.: 813.659.9197
 FBPE C.A. No. 9813

PRODUCT:		THERMA-TRU FIBERGLASS DOOR	
PART OR ASSEMBLY:		DOOR PANEL DETAILS	
REV.	DATE	BY	REVISIONS
3	10/09/18	MT	REV. DOOR PANEL OPTION NOTE
2	7/7/17	JK	UPDATE TO 6th ED (2017) FBC
1	3/22/17	LFS	REVISE FLUSH GLAZING
NO.	DATE	BY	
DATE:		6/1/16	
SCALE:		N.T.S.	
DWG. BY:		JK	
CHK. BY:		LFS	
DRAWING NO.:		FL-20461.9	
SHEET		3 OF 13	

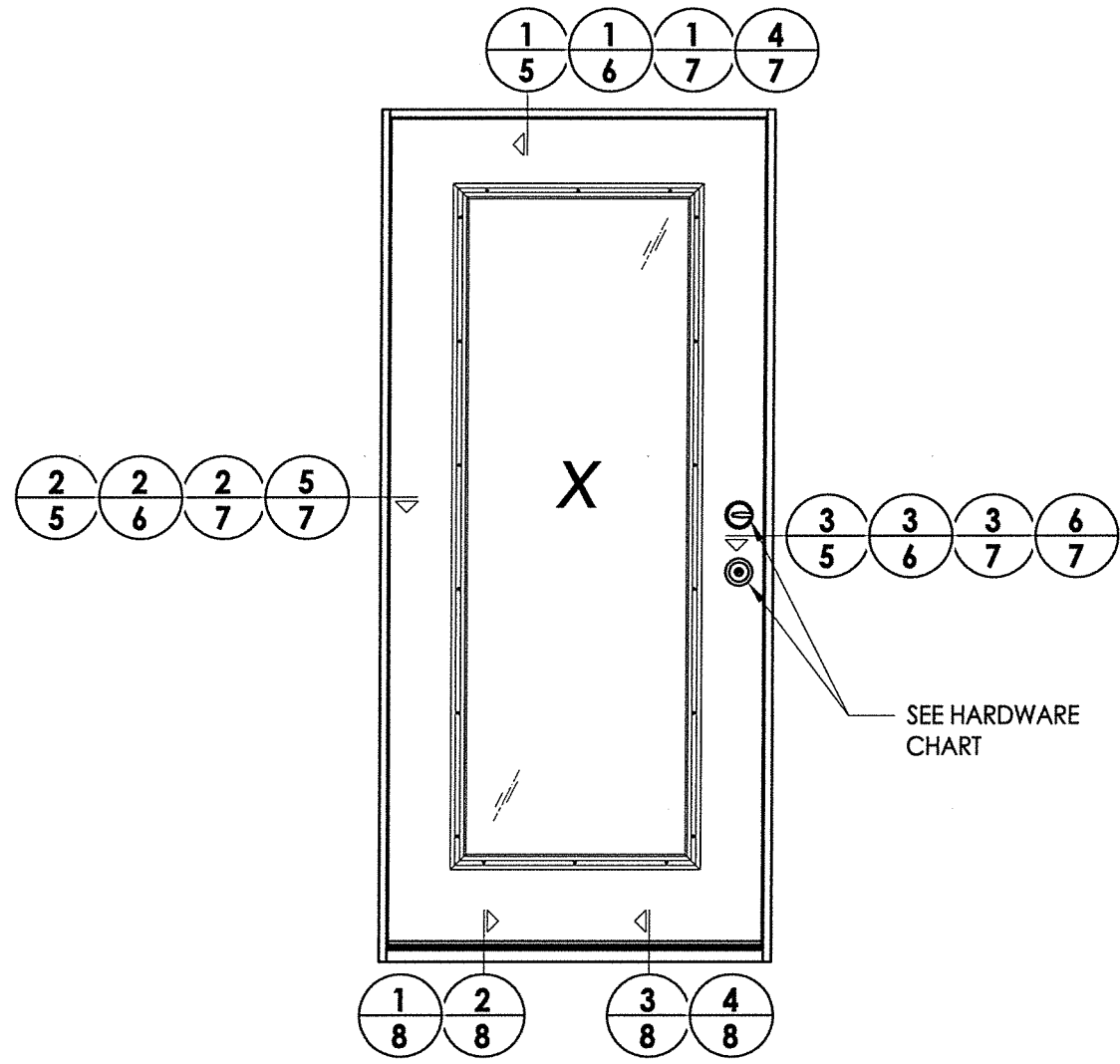

HARDWARE TABLE	
MANUFACTURER	MODEL
SCHLAGE	KNOB: F51 DEADBOLT: B60
KWIKSET	KNOB: SIGNATURE SERIES DEADBOLT: SIGNATURE SERIES (980)
HOPPE	MULTIPOINT: HLS 9000 SERIES (3 pt. Manual Tongue)

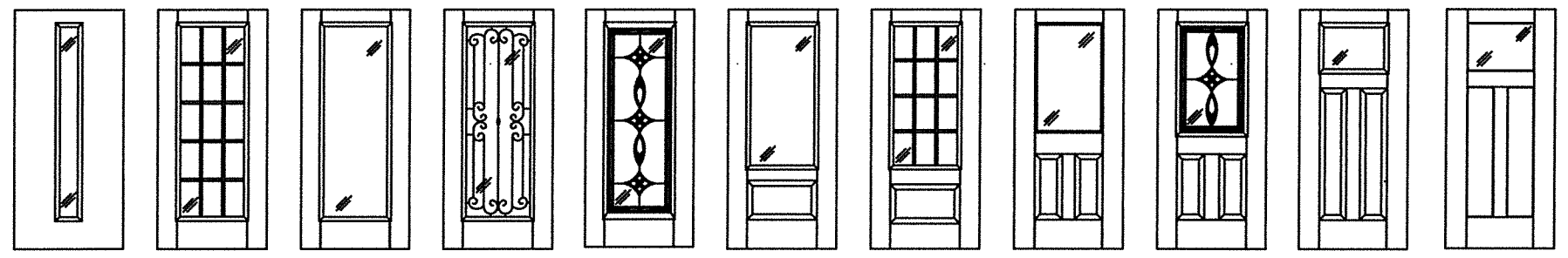

Fiber-Classic/Smooth-Star Door Panel Options

Products approved include all embossed and recessed panel doors.
 Similar glazed panel configurations are allowed.
 Panels shown are for illustration and are representative only.

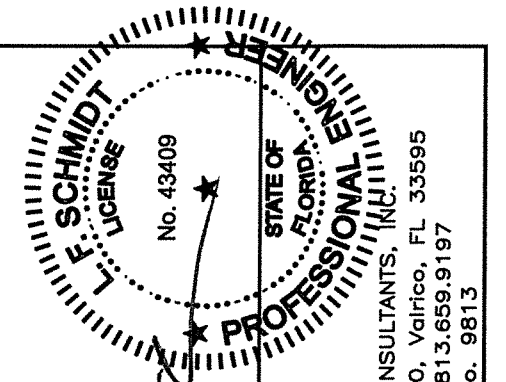

10/09/18
 Documents Prepared By:
 Lyndon F. Schmidt
 P.E. No. 43409
 R.W. BUILDING CONSULTANTS, INC.
 P.O. Box 230, Valrico, FL 33595
 Phone No.: 813.659.9197
 FBPE C.A. No. 9813

PRODUCT:		THERMA-TRU FIBERGLASS DOOR	
PART OR ASSEMBLY:		ELEVATIONS	
NO.	DATE	REVISIONS	
3	10/09/18	REV. DOOR PANEL OPTION NOTE	MT
2	7/7/17	UPDATE TO 6th ED (2017) FBC	JK
1	3/22/17	REVISE FLUSH GLAZING	LFS
DATE: 6/1/16			
SCALE: N.T.S.			
DWG. BY: JK			
CHK. BY: LFS			
DRAWING NO.: FL-20461.9			
SHEET 4 OF 13			

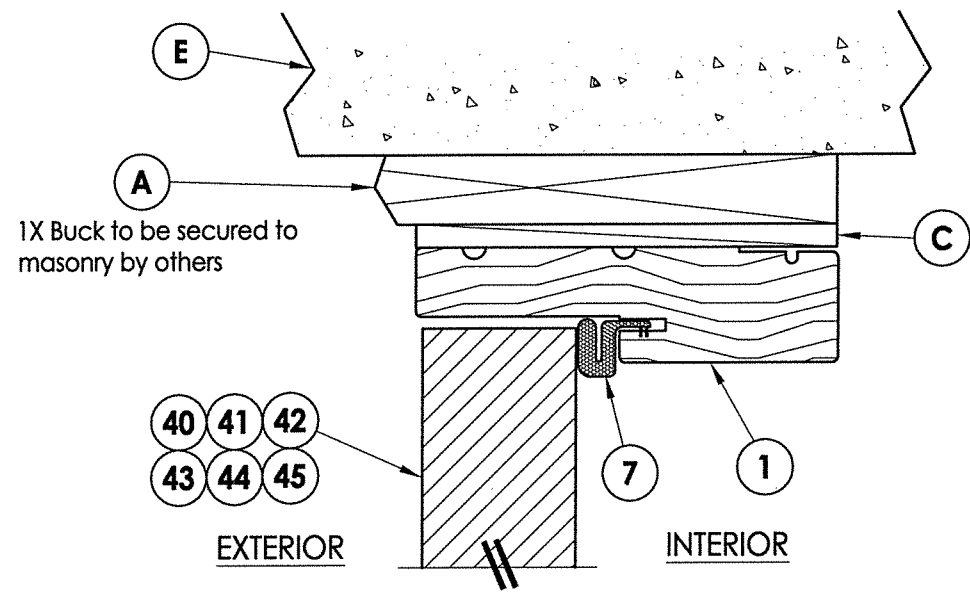

1 VERTICAL CROSS SECTION
6 Shown w/ 1X sub-buck
Outswing shown (Inswing similar)

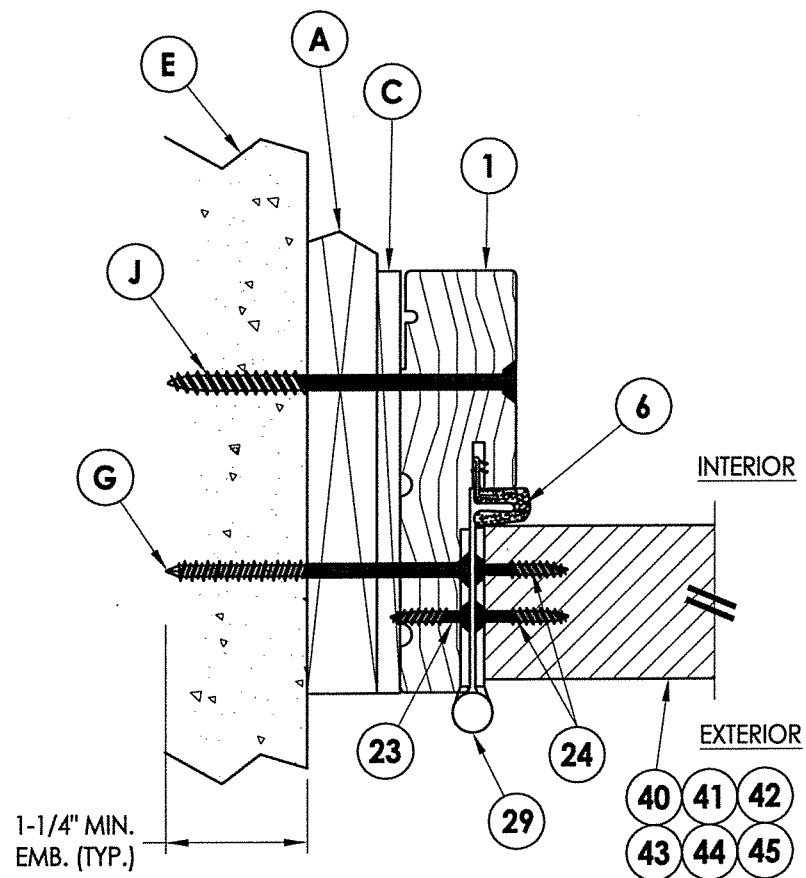

2 HORIZONTAL CROSS SECTION
6 Shown w/ 1X sub-buck
Outswing shown (Inswing similar)

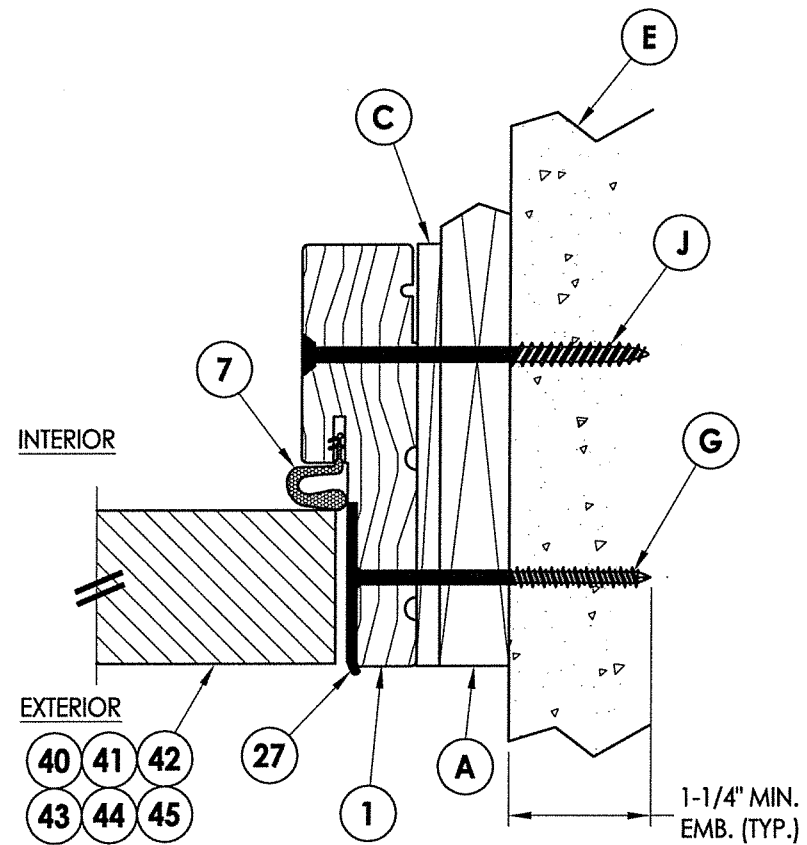

3 HORIZONTAL CROSS SECTION
6 Shown w/ 1X sub-buck
Outswing shown (Inswing similar)

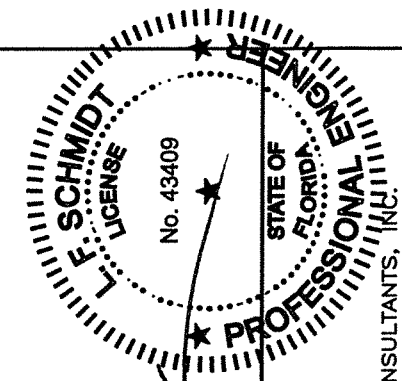

10/09/18
Documents Prepared By:
Lyndon F. Schmidt
P.E. No. 43409
R.W. BUILDING CONSULTANTS, INC.
P.O. Box 230, Valrico, FL 33595
Phone No.: 813.659.9197
FBPE C.A. No. 9813

PRODUCT:		THERMA-TRU FIBERGLASS DOOR	
PART OR ASSEMBLY:		HORIZONTAL & VERTICAL CROSS SECTIONS (1X BUCK)	
NO.	DATE	BY	REVISIONS
3	10/09/18	MT	REV. DOOR PANEL OPTION NOTE
2	7/7/17	JK	UPDATE TO 6th ED (2017) FBC
1	3/22/17	LFS	REVISE FLUSH GLAZING
DATE: 6/1/16			
SCALE: N.T.S.			
DWG. BY: JK			
CHK. BY: LFS			
DRAWING NO.: FL-20461.9			
SHEET 6 OF 13			

R:\Clients\Therma Tru PERMANENTA - Florida Product Approvals\FL-20461 Structural TT SS\C - Drawings\FL-20461 (2017) - CURRENT\FL-20461.9-13.dwg, 6.1

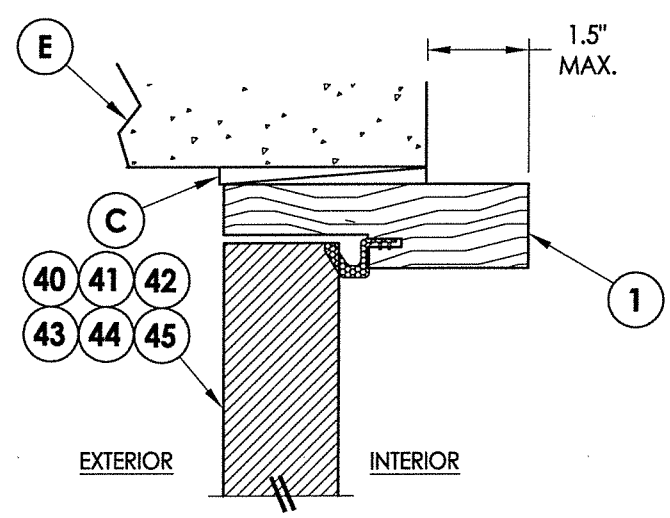

1 **VERTICAL CROSS SECTION**
7 Shown Direct to Masonry
 Outswing only w/ 4-9/16" jamb

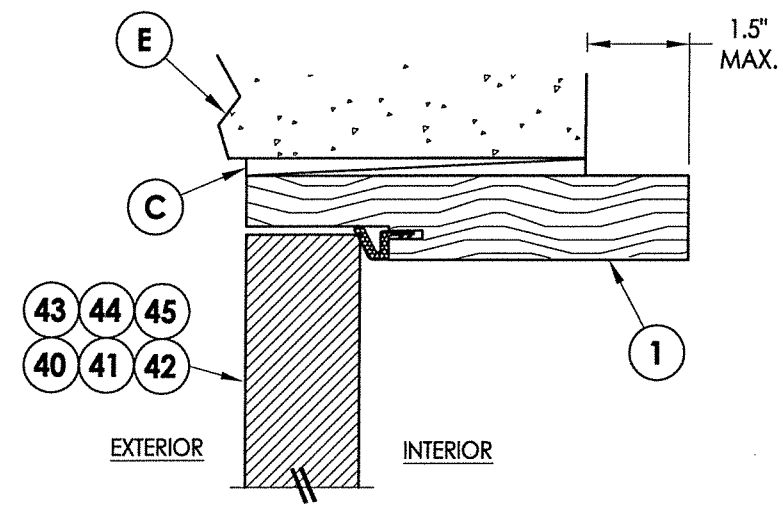

4 **VERTICAL CROSS SECTION**
7 Shown Direct to Masonry
 Outswing only w/ 6-9/16" jamb

DIRECT TO MASONRY MAX. DESIGN PRESSURE:
 w/ STANDARD STRIKE = ± 55 PSF
 w/ SECURITY STRIKE = ± 60 PSF

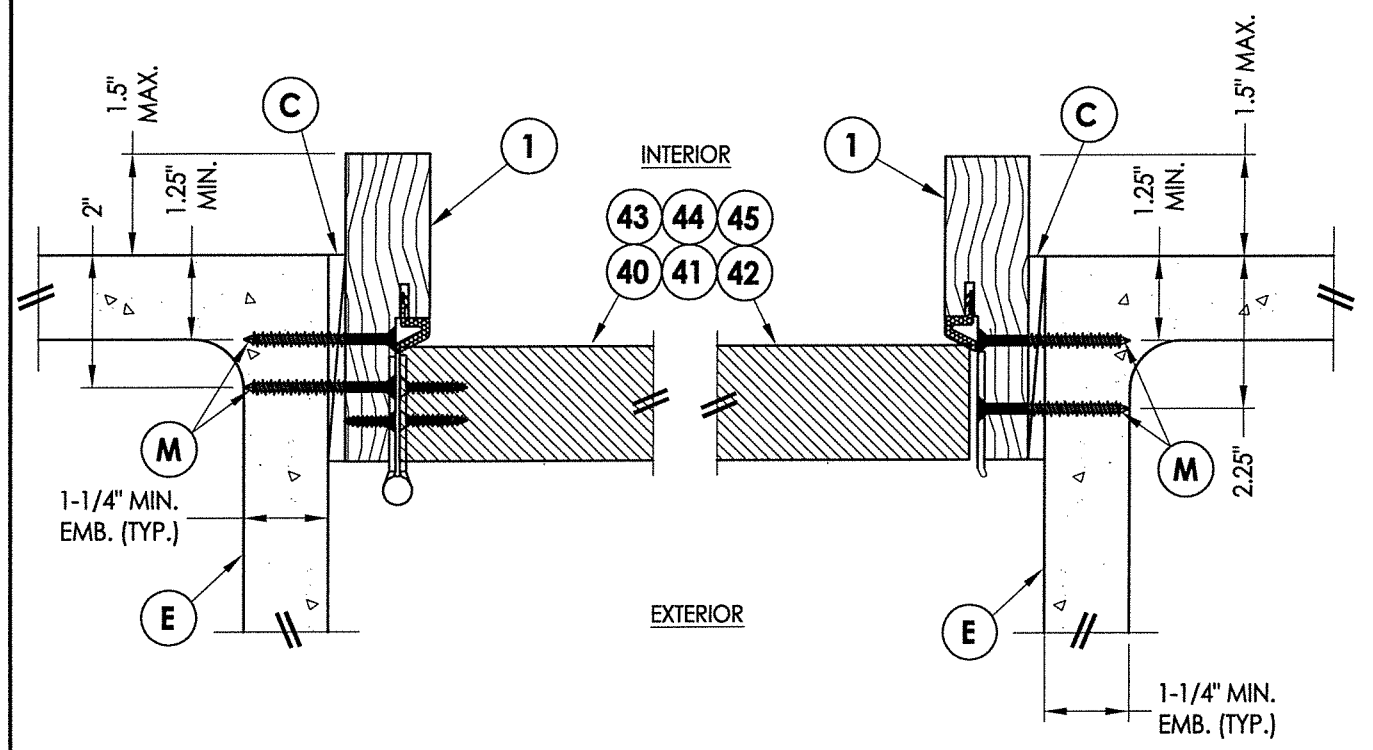

2 **HORIZONTAL CROSS SECTION**
7 Shown Direct to Masonry
 Outswing only w/ 4-9/16" jamb

3 **HORIZONTAL CROSS SECTION**
7 Shown Direct to Masonry
 Outswing only w/ 4-9/16" jamb

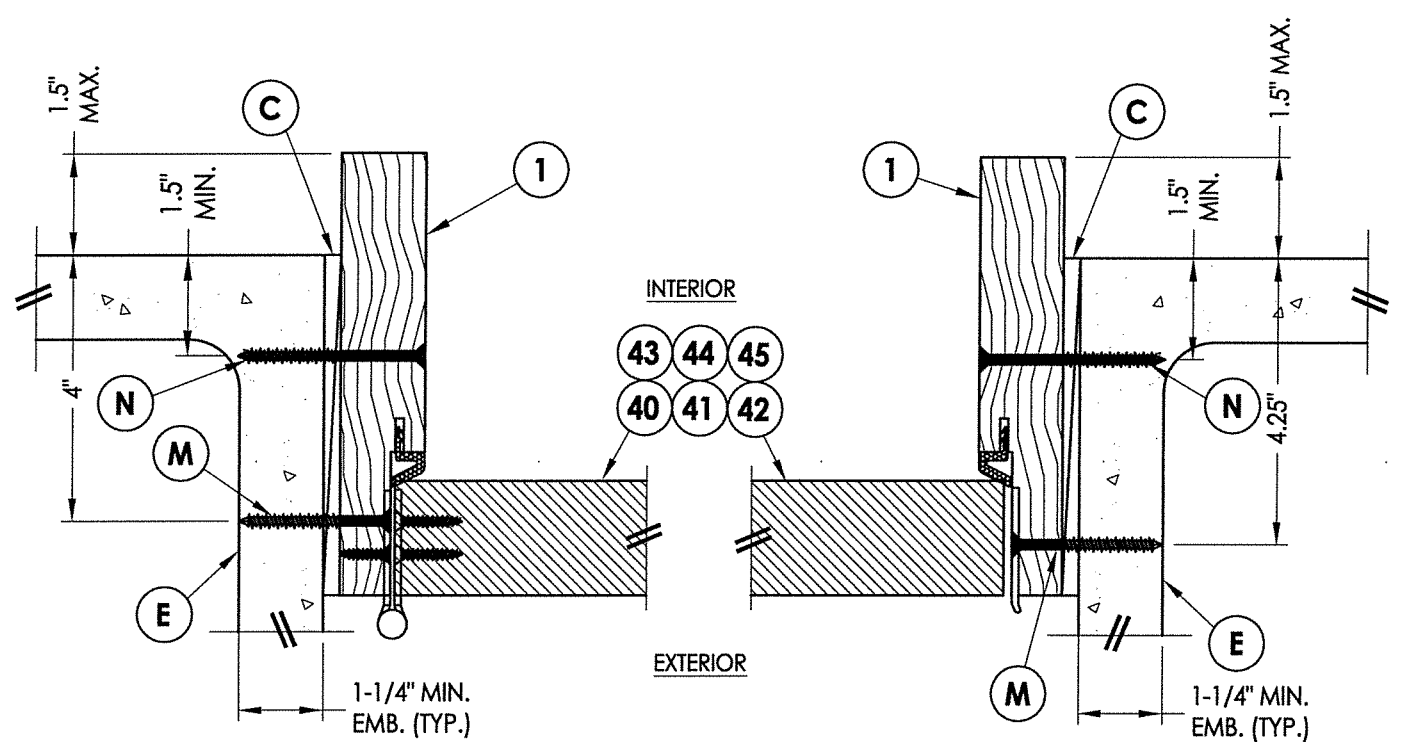

5 **HORIZONTAL CROSS SECTION**
7 Shown Direct to Masonry
 Outswing only w/ 6-9/16" jamb

6 **HORIZONTAL CROSS SECTION**
7 Shown Direct to Masonry
 Outswing only w/ 6-9/16" jamb

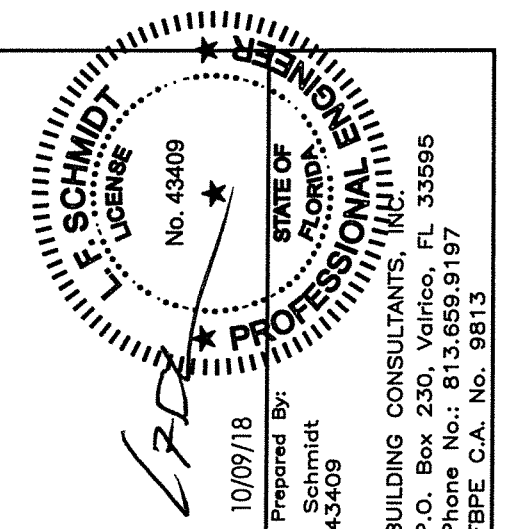

Documents Prepared By:
 Lyndon F. Schmidt
 P.E. No. 43409
 10/09/18
RW BUILDING CONSULTANTS, INC.
 P.O. Box 230, Vairico, FL 33595
 Phone No.: 813.659.9197
 FBPE C.A. No. 9813

PRODUCT: THERMA-TRU FIBERGLASS DOOR
 PART OR ASSEMBLY: HORIZONTAL & VERTICAL SECTIONS (DIRECT TO MASONRY)

NO.	DATE	REVISIONS
3	10/09/18	REV. DOOR PANEL OPTION NOTE
2	7/7/17	UPDATE TO 6th ED (2017) FBC
1	3/22/17	REVISE FLUSH GLAZING

DATE: 6/1/16
 SCALE: N.T.S.
 DWG. BY: JK
 CHK. BY: LFS
 DRAWING NO.: FL-20461.9
 SHEET 7 OF 13

© 2016 R.W. BUILDING CONSULTANTS INC.

Notes:
 1. Sill Item #'s 17, 18, 32, 34, 35, 36, 37, 38 & 39 are attached to jambs w/ (3) #8 X 2-1/2" pfh screws at each end.
 Sill Item #'s 16 & 33 are attached to jambs w/ (2) #8 X 2-1/2" pfh screws at each end.
 Sill Item #15 is attached to jambs utilizing (2) #10 X 2" pph SMS at each end.

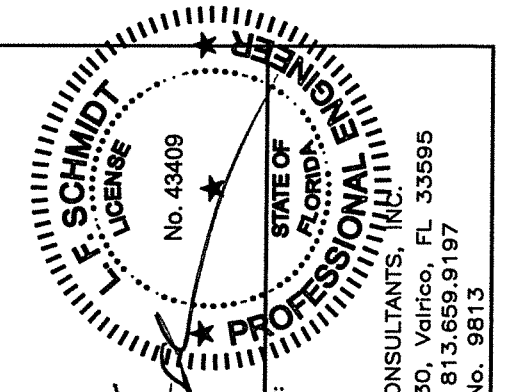

10/09/18
 Documents Prepared By:
 Lyndon F. Schmidt
 P.E. No. 43409
 R.W. BUILDING CONSULTANTS, INC.
 P.O. Box 230, Valrico, FL 33595
 Phone No.: 813.659.9197
 FBPE C.A. No. 9813

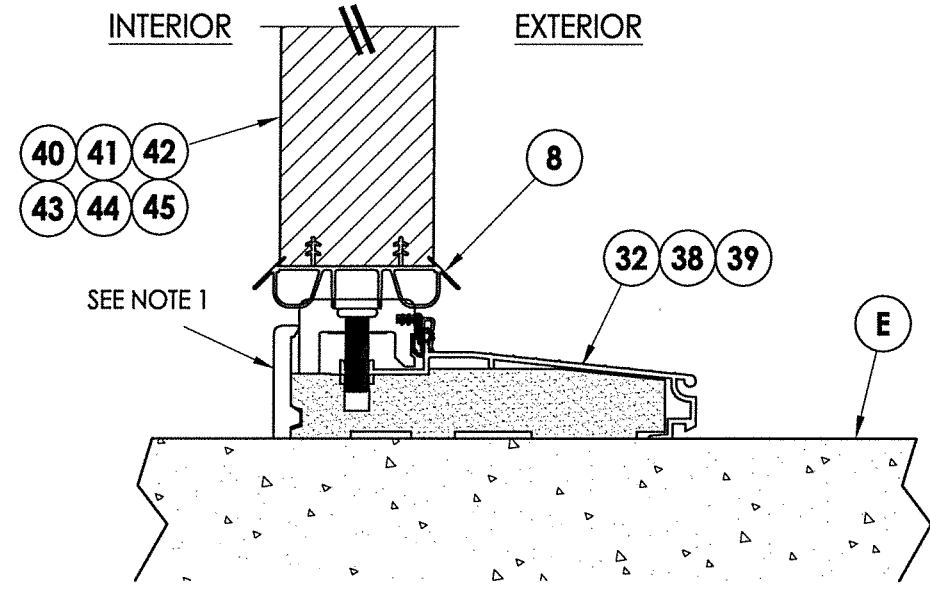

1 VERTICAL CROSS SECTION
8 Inswing Sill

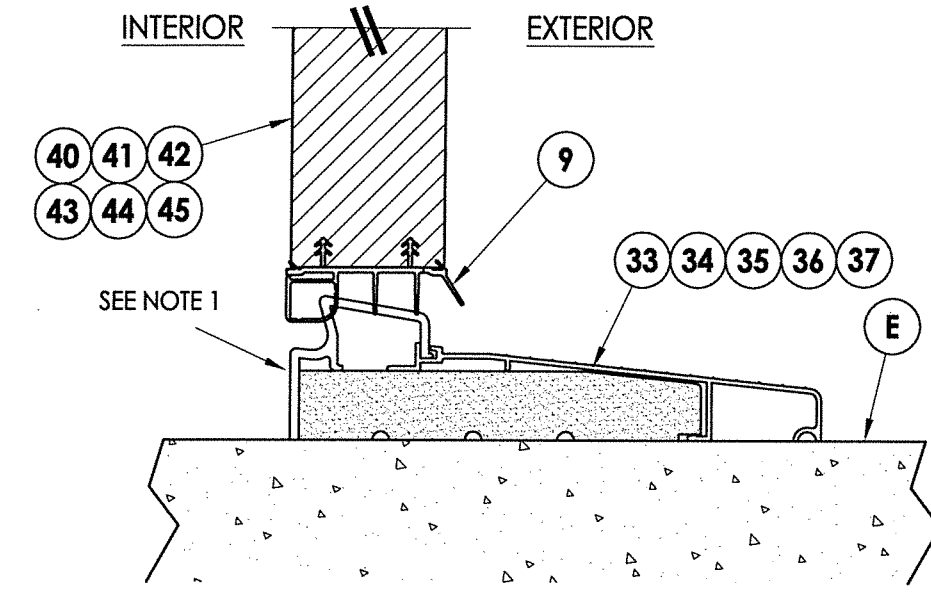

2 VERTICAL CROSS SECTION
8 Inswing Sill

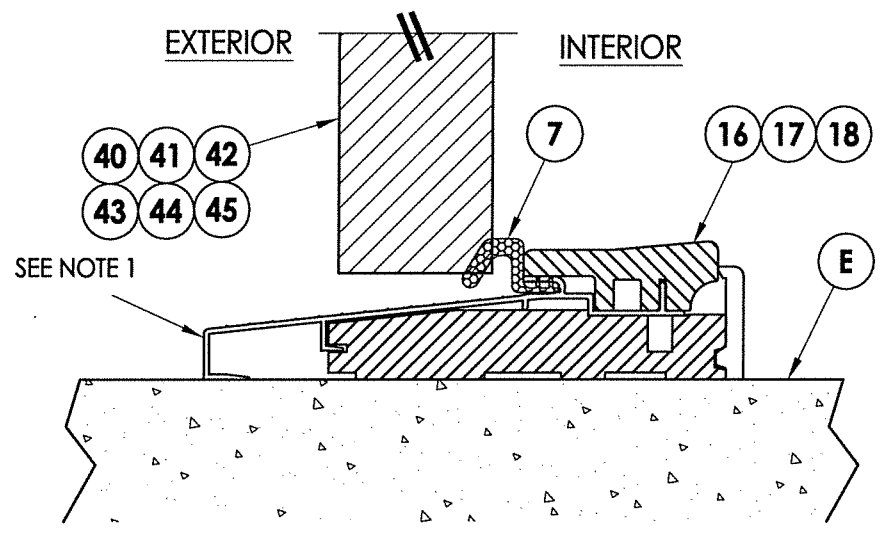

3 VERTICAL CROSS SECTION
8 Outswing Sill

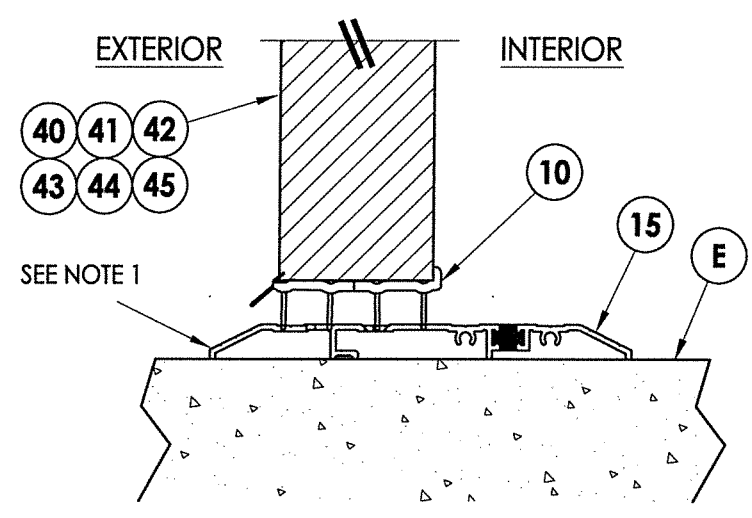

4 VERTICAL CROSS SECTION
8 Public Access Sill

PRODUCT: THERMA-TRU FIBERGLASS DOOR
 PART OR ASSEMBLY: VERTICAL CROSS SECTIONS (THRESHOLDS)

NO.	DATE	REVISIONS
3	10/09/18	REV. DOOR PANEL OPTION NOTE
2	7/7/17	UPDATE TO 6th ED (2017) FBC
1	3/22/17	REVISE FLUSH GLAZING

DATE: 6/1/16
 SCALE: N.T.S.
 DWG. BY: JK
 CHK. BY: LFS
 DRAWING NO.: FL-20461.9
 SHEET 8 OF 13

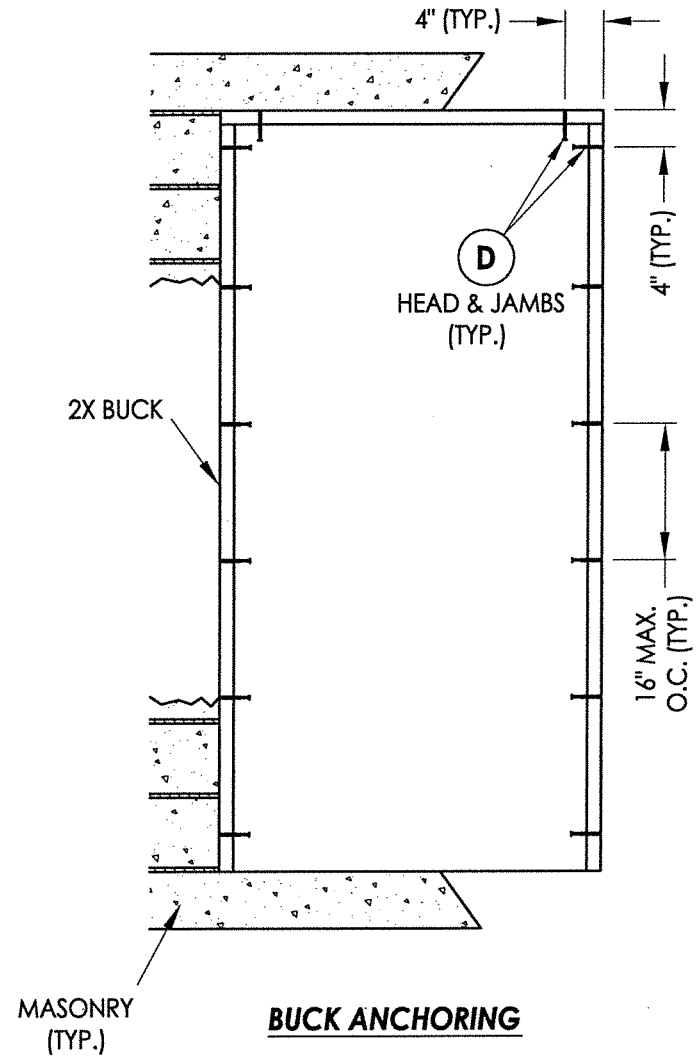

BUCK ANCHORING

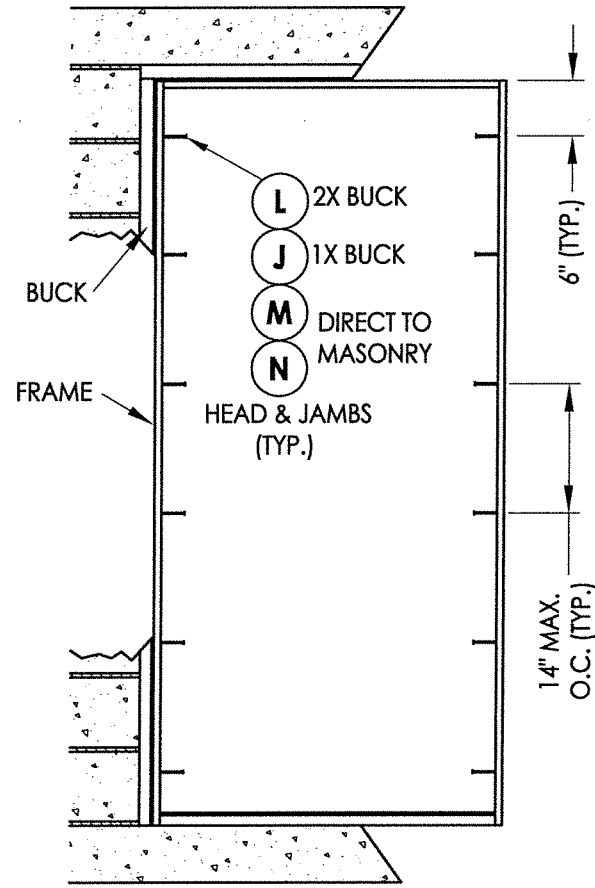

FRAME ANCHORING

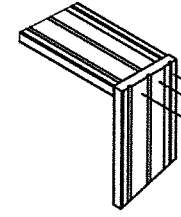

(3) #8 x 2-1/2" PFH WS

JAMB TO HEAD DETAIL (TYP.)

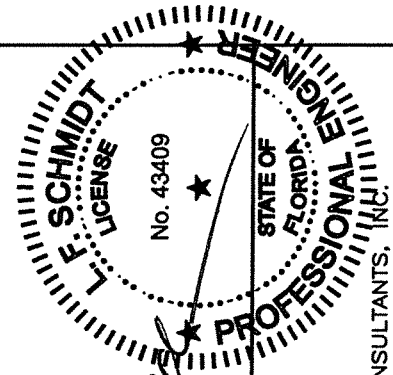

10/09/18
 Documents Prepared By:
 Lyndon F. Schmidt
 P.E. No. 43409

RW BUILDING CONSULTANTS, INC.
 P.O. Box 230, Valrico, FL 33595
 Phone No.: 813.659.9197
 FBPE C.A. No. 9813

PRODUCT:	THERMA-TRU FIBERGLASS DOOR
PART OR ASSEMBLY:	BUCK AND FRAME ANCHORING

NO.	DATE	REVISIONS
3	10/09/18	REV. DOOR PANEL OPTION NOTE
2	7/7/17	UPDATE TO 6th ED (2017) FBC
1	3/22/17	REVISE FLUSH GLAZING

DATE:	6/1/16
SCALE:	N.T.S.
DWG. BY:	JK
CHK. BY:	LFS
DRAWING NO.:	FL-20461.9
SHEET	9 OF 13

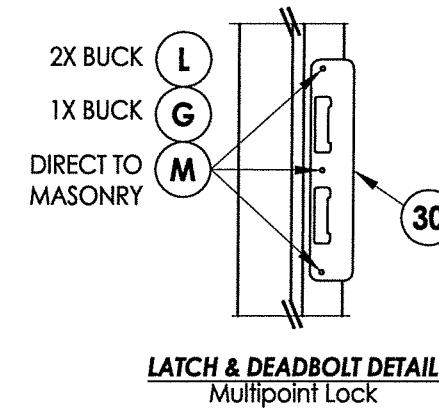
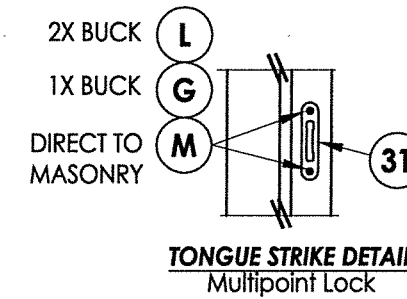
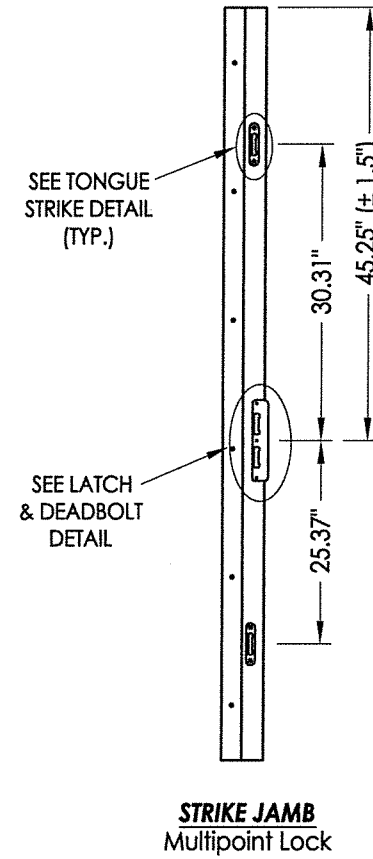
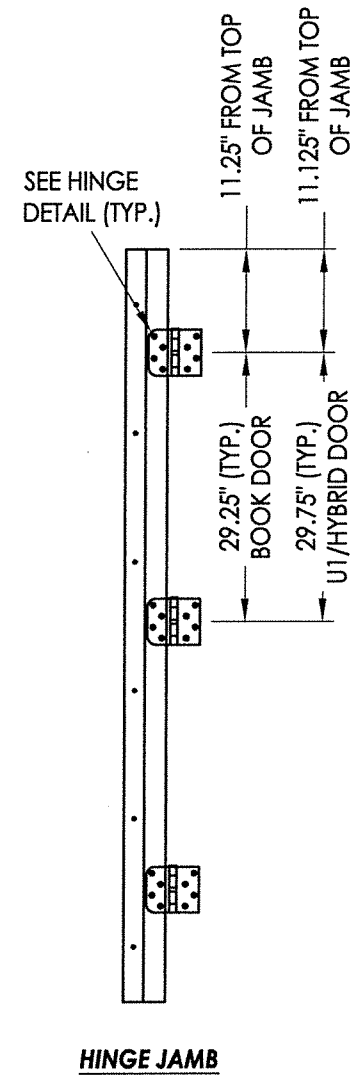
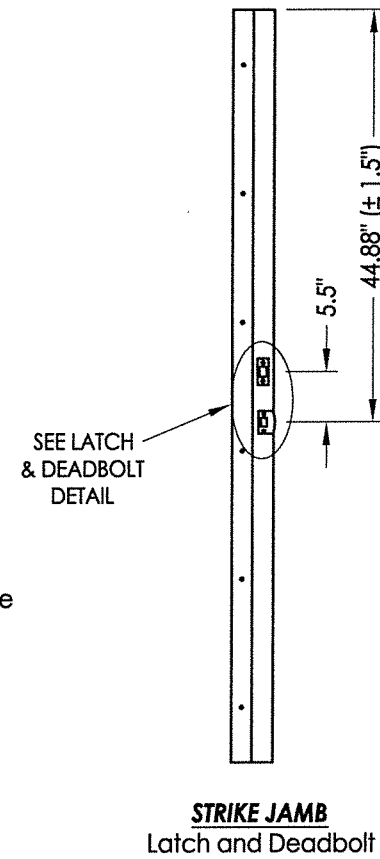
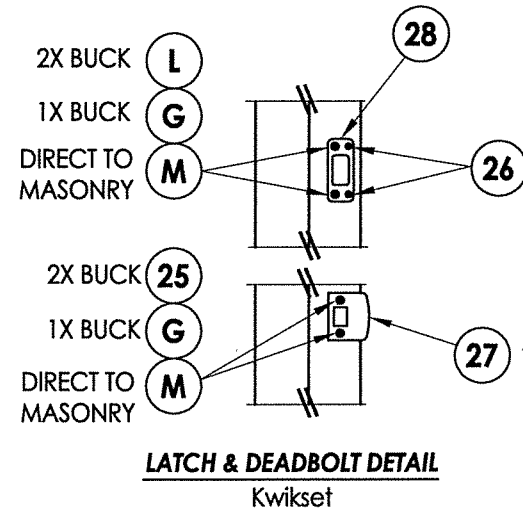

MULTIPOINT LOCK STRIKE DETAILS

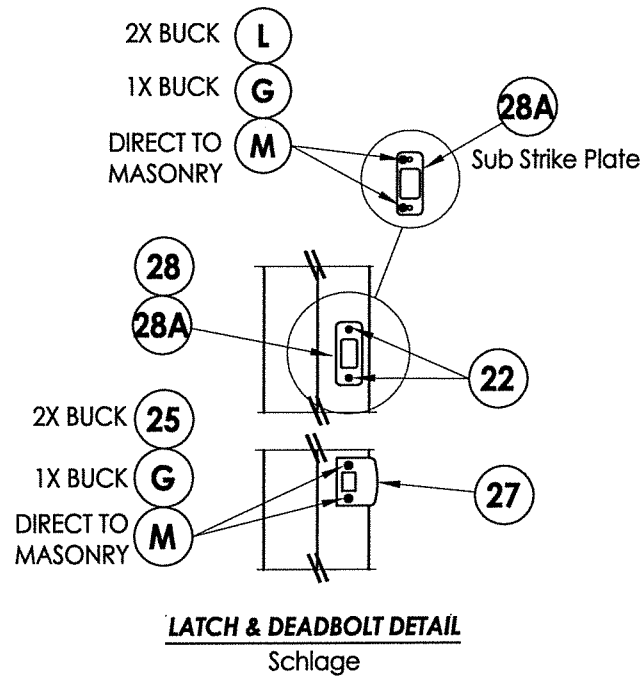

LATCH & DEADBOLT STRIKE DETAILS
(Standard Deadbolt Strike Plate)

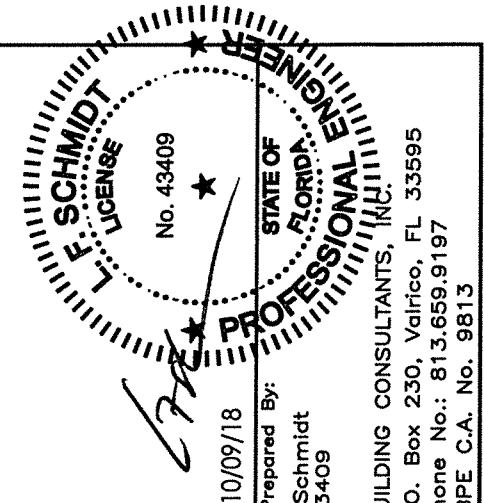
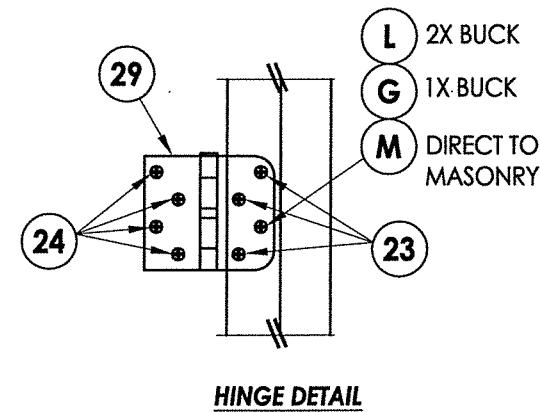
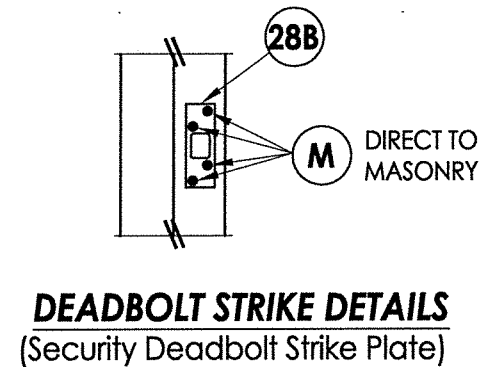

Documents Prepared By:
Lyndon F. Schmidt
P.E. No. 43409

R.W. BUILDING CONSULTANTS, INC.
P.O. Box 230, Vairico, FL 33595
Phone No.: 813.659.9197
FBPE C.A. No. 9813

PRODUCT: THERMA-TRU FIBERGLASS DOOR
PART OR ASSEMBLY: HARDWARE DETAILS

NO.	DATE	REVISIONS
3	10/09/18	REV. DOOR PANEL OPTION NOTE MT
2	7/7/17	UPDATE TO 6th ED (2017) FBC JK
1	3/22/17	REVISE FLUSH GLAZING LFS

DATE: 6/1/16
SCALE: N.T.S.
DWG. BY: JK
CHK. BY: LFS
DRAWING NO.: FL-20461.9
SHEET 10 OF 13

R:\Clients\Therma Tru Permanent\A - Florida Product Approvals\FL-20461 Structural TT-SS\C - Drawings\FL-20461 (2017) - CURRENT\FL-20461.9-13.dwg, 10.1

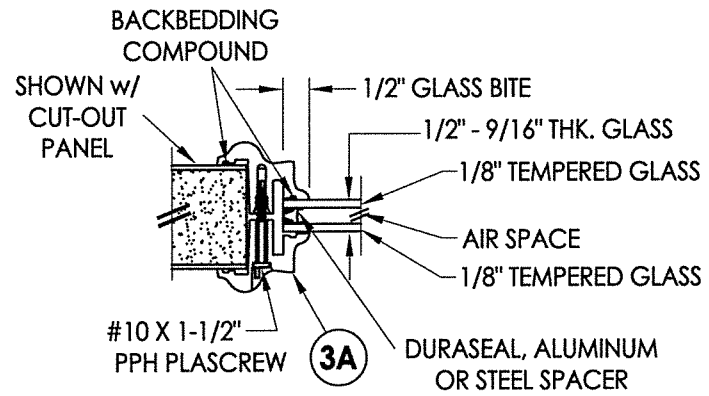

G1 GLAZING DETAIL
BTS Lite Frame
Door Panels

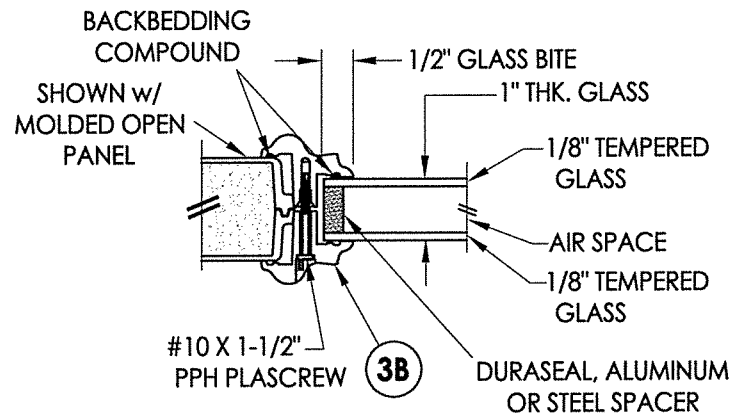

G2 GLAZING DETAIL
BTS Lite Frame
Door Panels

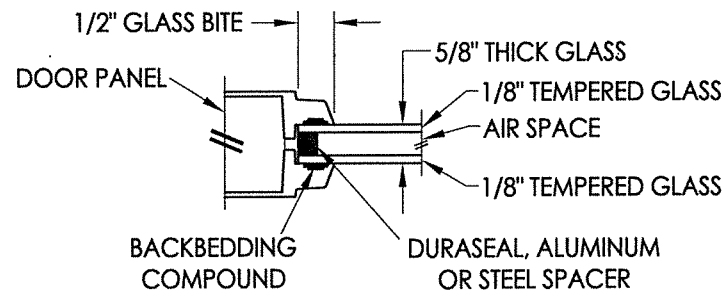

G3 GLAZING DETAIL
Flush Glazing
Door Panels

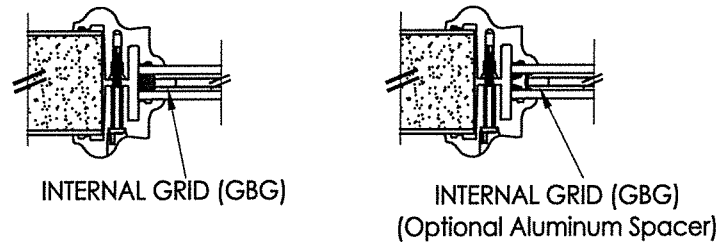

9/16" INSULATED GLASS INSERT OPTIONS

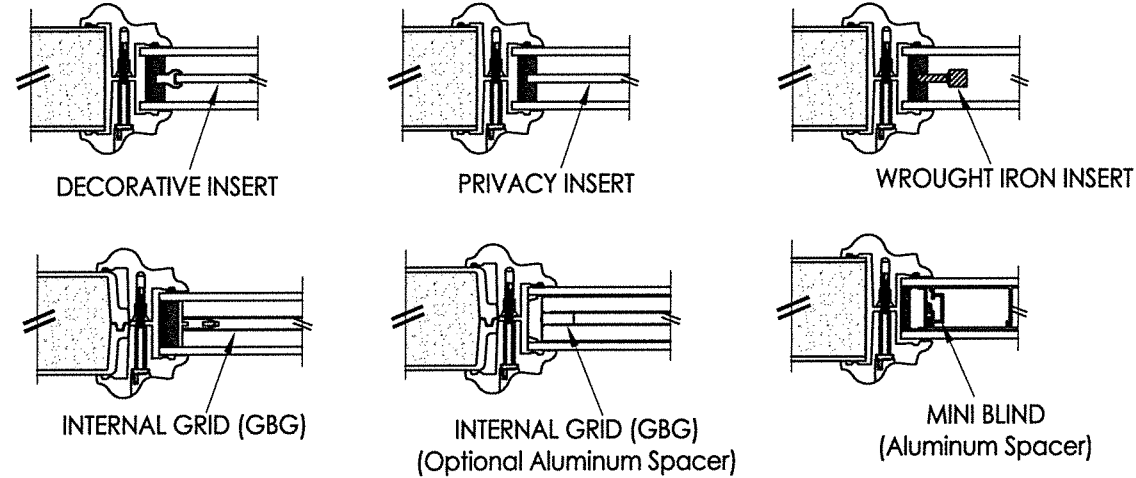

1" INSULATED GLASS INSERT OPTIONS

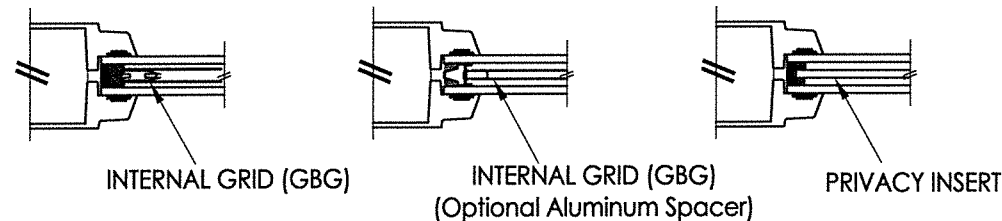

5/8" INSULATED GLASS INSERT OPTIONS

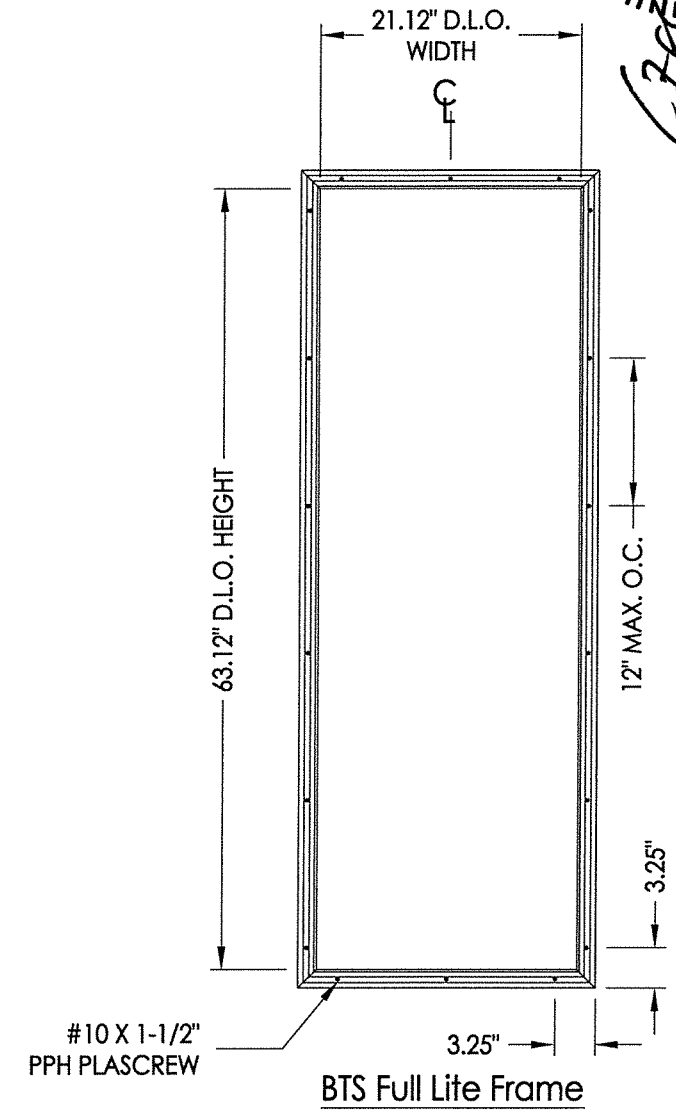

3A BTS LITE FRAME
1/2" & 9/16" Glazing

3B BTS LITE FRAME
1" Glazing

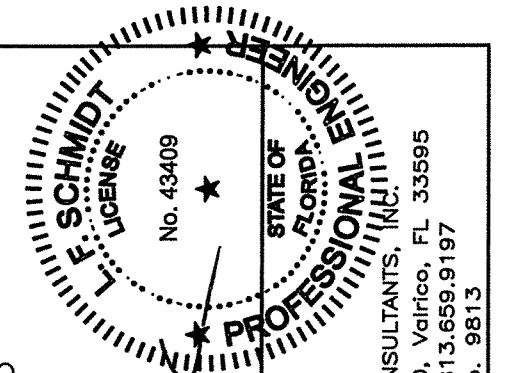

10/09/18
Documents Prepared By:
Lyndon F. Schmidt
P.E. No. 43409
R.W. BUILDING CONSULTANTS, INC.
P.O. Box 230, Valrico, FL 33595
Phone No.: 813.659.9197
FBPE C.A. No. 9813

PRODUCT: THERMA-TRU FIBERGLASS DOOR	
PART OR ASSEMBLY: GLAZING DETAILS	
NO.	DATE
3	10/09/18
2	7/7/17
1	3/22/17
REV.	DESCRIPTION
3	DOOR PANEL OPTION NOTE
2	UPDATE TO 6th ED (2017) FBC
1	REVISE FLUSH GLAZING
DATE	BY
6/1/16	JK
DATE: 6/1/16	
SCALE: N.T.S.	
DWG. BY: JK	
CHK. BY: LFS	
DRAWING NO.: FL-20461.9	
SHEET 11 OF 13	

© 2016 R.W. BUILDING CONSULTANTS INC.

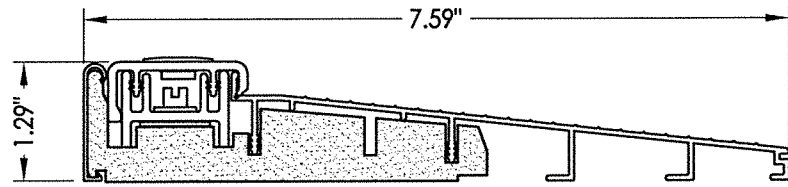

32 INSWING THRESHOLD
Inswing Basic Composite Adjustable Sill 7-1/2"

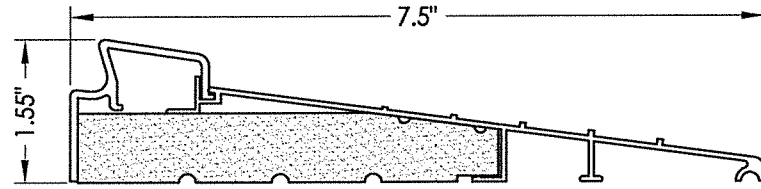

37 INSWING THRESHOLD
Inswing Basic Fixed 7-1/2" Sill

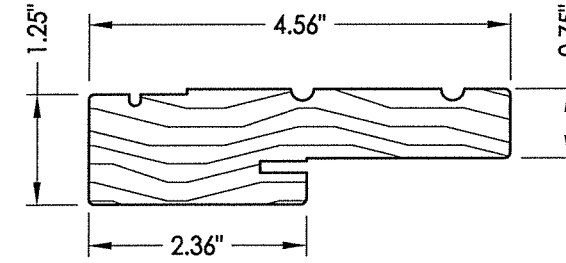

1 WOOD JAMB

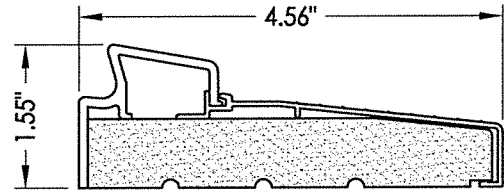

33 INSWING THRESHOLD
Inswing Basic Fixed Sill

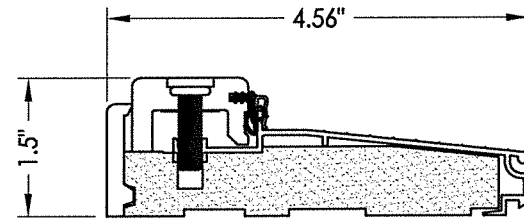

38 INSWING THRESHOLD
Inswing Composite Adjustable Sill

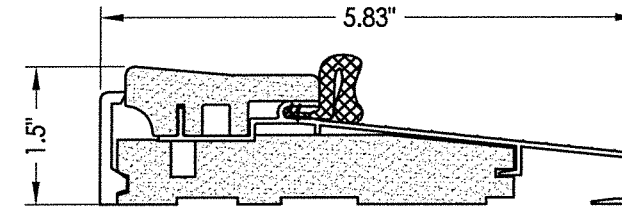

16 OUTSWING THRESHOLD
Composite Sill

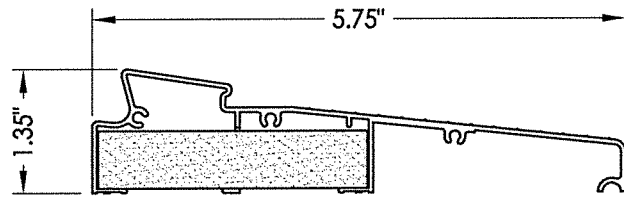

34 INSWING THRESHOLD
Inswing Moderate Climate Sill 1-3/8"

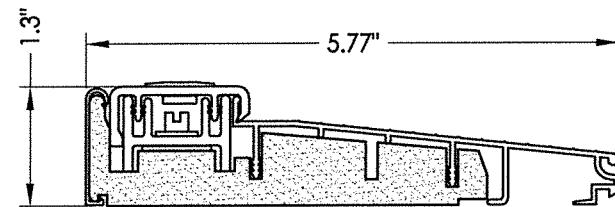

39 INSWING THRESHOLD
Inswing Basic Composite Adjustable Sill

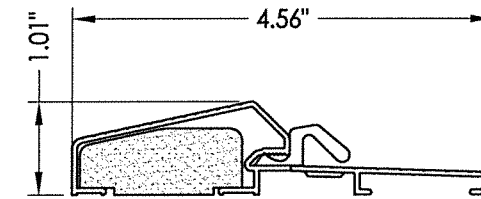

17 OUTSWING THRESHOLD
Composite / Aluminum Sill

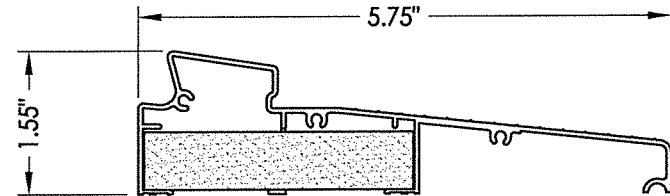

35 INSWING THRESHOLD
Inswing Moderate Climate Sill

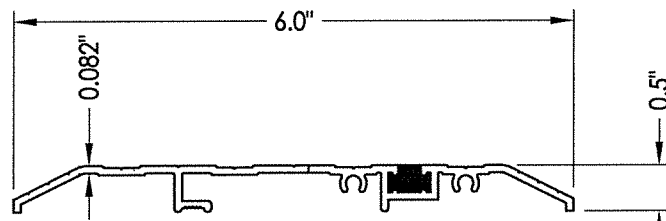

15 PUBLIC ACCESS THRESHOLD

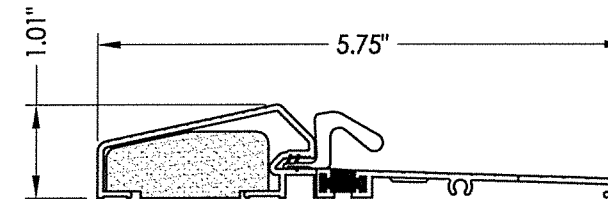

18 OUTSWING THRESHOLD
Composite / Aluminum Sill
(Thermal Break)

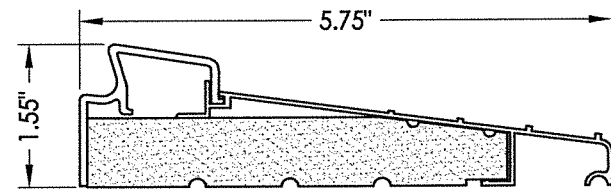

36 INSWING THRESHOLD
Inswing Basic Fixed 5-3/4" Sill

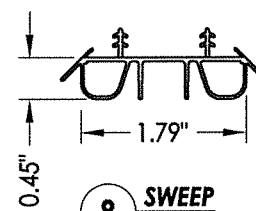

8 SWEEP

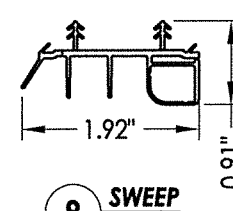

9 SWEEP

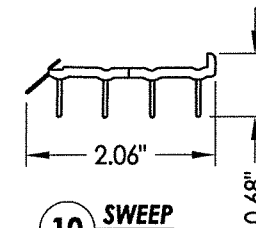

10 SWEEP

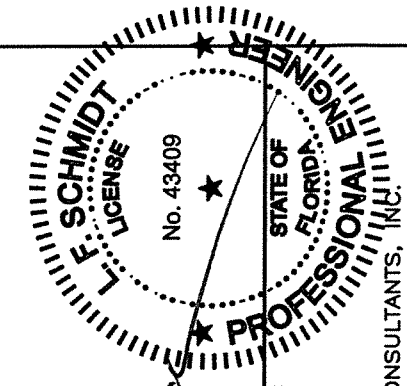

10/09/18
Documents Prepared By:
Lyndon F. Schmidt
P.E. No. 43409

R.W. BUILDING CONSULTANTS, INC.
P.O. Box 230, Vairico, FL 33595
Phone No.: 813.659.9197
FBPE C.A. No. 9813

PRODUCT:		THERMA-TRU FIBERGLASS DOOR	
PART OR ASSEMBLY:		COMPONENTS	
NO.	DATE	BY	REVISIONS
3	10/09/18	JK	REV. DOOR PANEL OPTION NOTE
2	7/7/17	JK	UPDATE TO 6th ED (2017) FBC
1	3/22/17	LFS	REVISE FLUSH GLAZING
DATE:	6/1/16		
SCALE:	N.T.S.		
DWG. BY:	JK		
CHK. BY:	LFS		
DRAWING NO.:	FL-20461.9		
SHEET	12	OF	13

BILL OF MATERIALS			BILL OF MATERIALS		
ITEM #	DESCRIPTION	MATERIAL	ITEM #	DESCRIPTION	MATERIAL
A	1X BUCK (SG >= 0.42)	WOOD	25	#8 x 2-1/2" PFH WOOD SCREW	STEEL
B	2X BUCK (SG >= 0.42)	WOOD	26	#8 x 5/8" PFH WOOD SCREW	STEEL
C	1/4" MAX. SHIM SPACE	-	27	LATCH STRIKE PLATE	STEEL
D	1/4" X 2-3/4" PFH ELCO OR ITW CONCRETE SCREW	STEEL	28	DEADBOLT STRIKE PLATE	STEEL
E	MASONRY - 3,000 PSI MIN. CONCRETE CONFORMING TO ACI 301 OR HOLLOW BLOCK CONFORMING TO ASTM C90	CONCRETE	28A	DEADBOLT SUB STRIKE PLATE	STEEL
			28B	DEADBOLT STRIKE PLATE (SECURITY)	STEEL
G	3/16" X 3-1/4" ITW CONCRETE SCREW	STEEL	29	4" X 4" HINGE	STEEL
J	1/4" X 3-3/4" PFH ELCO OR ITW CONCRETE SCREW	STEEL	30	LATCH & DEADBOLT STRIKE PLATE (TONGUE SYSTEM)	ALUM/COMP
L	#10 X 2-1/2" PFH WOOD SCREW (1.15" MIN. EMBEDMENT)	STEEL	31	MULTIPOINT STRIKE PLATE (TONGUE SYSTEM)	ALUM/COMP
M	3/16" X 2-1/4" ITW CONCRETE SCREW	STEEL	32	INSWING THRESHOLD	ALUM/COMP
N	3/16" X 2-3/4" ITW CONCRETE SCREW	STEEL	33	INSWING THRESHOLD	ALUM/COMP
1	JAMB (FINGER JOINT PINE)	WOOD	34	INSWING THRESHOLD	ALUM/COMP
6	WEATHERSTRIP (MEDIUM REACH)	FOAM	35	INSWING THRESHOLD	ALUM/COMP
7	WEATHERSTRIP (LONG REACH)	FOAM	36	INSWING THRESHOLD	ALUM/COMP
8	SWEEP	VINYL	37	INSWING THRESHOLD	ALUM/COMP
9	SWEEP (USE w/ MODERATE CLIMATE THRESHOLD)	VINYL	38	INSWING THRESHOLD	ALUM/COMP
10	SWEEP (USE w/ PUBLIC ACCESS THRESHOLD)	VINYL	39	INSWING THRESHOLD	ALUM/COMP
15	ADA THRESHOLD	ALUM	40	DOOR PANEL (BOOK)	-
16	OUTSWING THRESHOLD	ALUM/COMP	41	DOOR PANEL (HYBRID)	-
17	OUTSWING THRESHOLD	ALUM/COMP	42	DOOR PANEL (U1)	-
18	OUTSWING THRESHOLD	ALUM/COMP	43	FLUSH GLAZED DOOR PANEL (BOOK)	-
22	#8 x 3/4" PFH WOOD SCREW	STEEL	44	FLUSH GLAZED DOOR PANEL (HYBRID)	-
23	#10 x 3/4" PFH WOOD SCREW	STEEL	45	FLUSH GLAZED DOOR PANEL (U1)	-
24	#10 x 1" PFH WOOD SCREW	STEEL			

CONCRETE ANCHOR NOTES:

- Concrete anchor locations at the corners may be adjusted to maintain the min. edge distance to mortar joints.
- Concrete anchor locations noted as "MAX. ON CENTER" must be adjusted to maintain the min. edge distance to mortar joints, additional concrete anchors may be required to ensure the "MAX. ON CENTER" dimension are not exceeded.
- Concrete anchor table:

ANCHOR TYPE	ANCHOR SIZE	MIN. EMBEDMENT	MIN. CLEARANCE TO MASONRY EDGE	MIN. CLEARANCE TO ADJACENT ANCHOR
ITW TAPCON®	1/4"	1-1/4"	2"	4"
ELCO ULTRACON®	1/4"	1-1/4"	1"	4"
ITW TAPCON®	3/16"	1-1/4"	AS SHOWN	1-1/2"

WOOD SCREW INSTALLATION NOTES:

- Maintain a minimum 5/8" edge distance, 1" end distance, & 1" o.c. spacing of wood screws to prevent the splitting of wood.

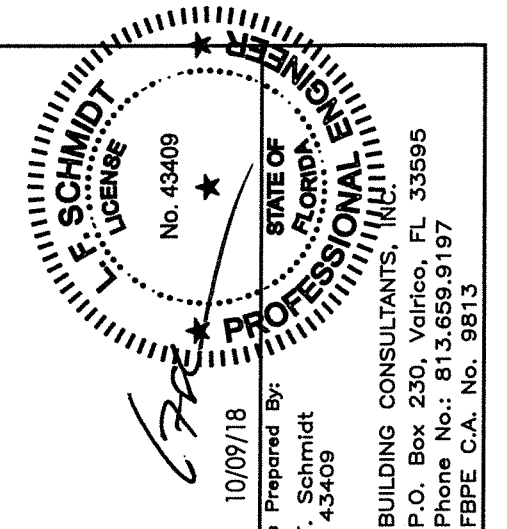

10/09/18
 Documents Prepared By:
 Lyndon F. Schmidt
 P.E. No. 43409

PRODUCT: THERMA-TRU FIBERGLASS DOOR
 PART OR ASSEMBLY: BILL OF MATERIALS

NO.	DATE	REVISIONS
3	10/09/18	REV. DOOR PANEL OPTION NOTE
2	7/7/17	UPDATE TO 6th ED (2017) FBC
1	3/22/17	REVISE FLUSH GLAZING
		NO. DATE

DATE: 6/1/16
 SCALE: N.T.S.
 DWG. BY: JK
 CHK. BY: LFS
 DRAWING NO.: FL-20461.9
 SHEET 13 OF 13

R.W. BUILDING CONSULTANTS, INC.
 P.O. Box 230, Vairico, FL 33595
 Phone No.: 813.659.9197
 FBPE C.A. No. 9813