



STATE OF FLORIDA
DEPARTMENT OF ENVIRONMENTAL PROTECTION
ON-SITE SEWAGE TREATMENT AND DISPOSAL
SYSTEM (OSTDS)

PERMIT NO. 25-0427
DATE PAID: 5/14/25
FEE PAID: 185.00
RECEIPT #: 2220308
3/1/26 12/1/23 3/1/26 EV

APPLICATION FOR CONSTRUCTION PERMIT

APPLICATION FOR:

New System Existing System Holding Tank Innovative
 Repair Abandonment Temporary

APPLICANT: J&J Florida Development LLC EMAIL: rockyford@

AGENT: A&B Construction Windstream.net
TELEPHONE: 386-497-2311

MAILING ADDRESS: 546 SW DORTCH ST, FT. WHITE, FL. 32038

TO BE COMPLETED BY APPLICANT OR APPLICANT'S AUTHORIZED AGENT. SYSTEMS MUST BE CONSTRUCTED BY A PERSON LICENSED PURSUANT TO 489.105(3)(a) OR 489.552, FLORIDA STATUTES. IT IS THE APPLICANT'S RESPONSIBILITY TO PROVIDE DOCUMENTATION OF THE DATE THE LOT WAS CREATED OR PLATTED (MM/DD/YY) IF REQUESTING CONSIDERATION OF STATUTORY GRANDFATHER PROVISIONS.

PROPERTY INFORMATION

OSTDS REMEDIATION PLAN? [Y / N]

LOT NA BLOCK NA SUBDIVISION NA PLATTED _____

PROPERTY ID # 12-3S-110-02069-000 ZONING _____ I/M OR EQUIVALENT: [Y / N]

PROPERTY SIZE: 22.31 ACRES WATER SUPPLY: PRIVATE PUBLIC [] <=2000GPD [] >2000GPD

IS SEWER AVAILABLE AS PER 381 0065, FS? [Y / N] DISTANCE TO SEWER NA FT

PROPERTY ADDRESS: NW Falling Creek Rd, Lake City, FL

DIRECTIONS TO PROPERTY: TR onto NW main Blvd, take exit onto US Hwy 41 N, TR onto NW Falling Creek Rd.

BUILDING INFORMATION

[] RESIDENTIAL COMMERCIAL

Unit No	Type of Establishment	No. of Bedrooms	Building Area Sqft	Commercial/Institutional System Design Table 1, Chapter 62-6, FAC
---------	-----------------------	-----------------	--------------------	-------------------------------------------------------------------

1	<u>Campsites</u>	<u>5</u>	<u>480 total</u>	<u>5 Campsites</u>
2				
3				
4				

[] Floor/Equipment Drains [] Other (Specify) _____

SIGNATURE: Rocky D. Ford DATE: 5-12-25

STATE OF FLORIDA
DEPARTMENT OF ENVIRONMENTAL PROTECTION
APPLICATION FOR CONSTRUCTION PERMIT

Permit Application Number 25-0427

J&J Florida Development

PART II - SITEPLAN

Scale: Each block represents 10 feet and 1 inch = 40 feet

See
attached

Notes _____

Site Plan submitted by [Signature] master contracto
Plan Approved Not Approved Date 5/29/25
By [Signature] [Signature] County Health Department

ALL CHANGES MUST BE APPROVED BY THE COUNTY HEALTH DEPARTMENT

DEP 4015, 06-21-2022 (Obsoletes previous editions which may not be used)

↑N

25-2427

V&J HONDA
Development LLC

lin. = 40 ft.

5-12-25

1 acre of 22.51

not actual
prop. line

210'
210'

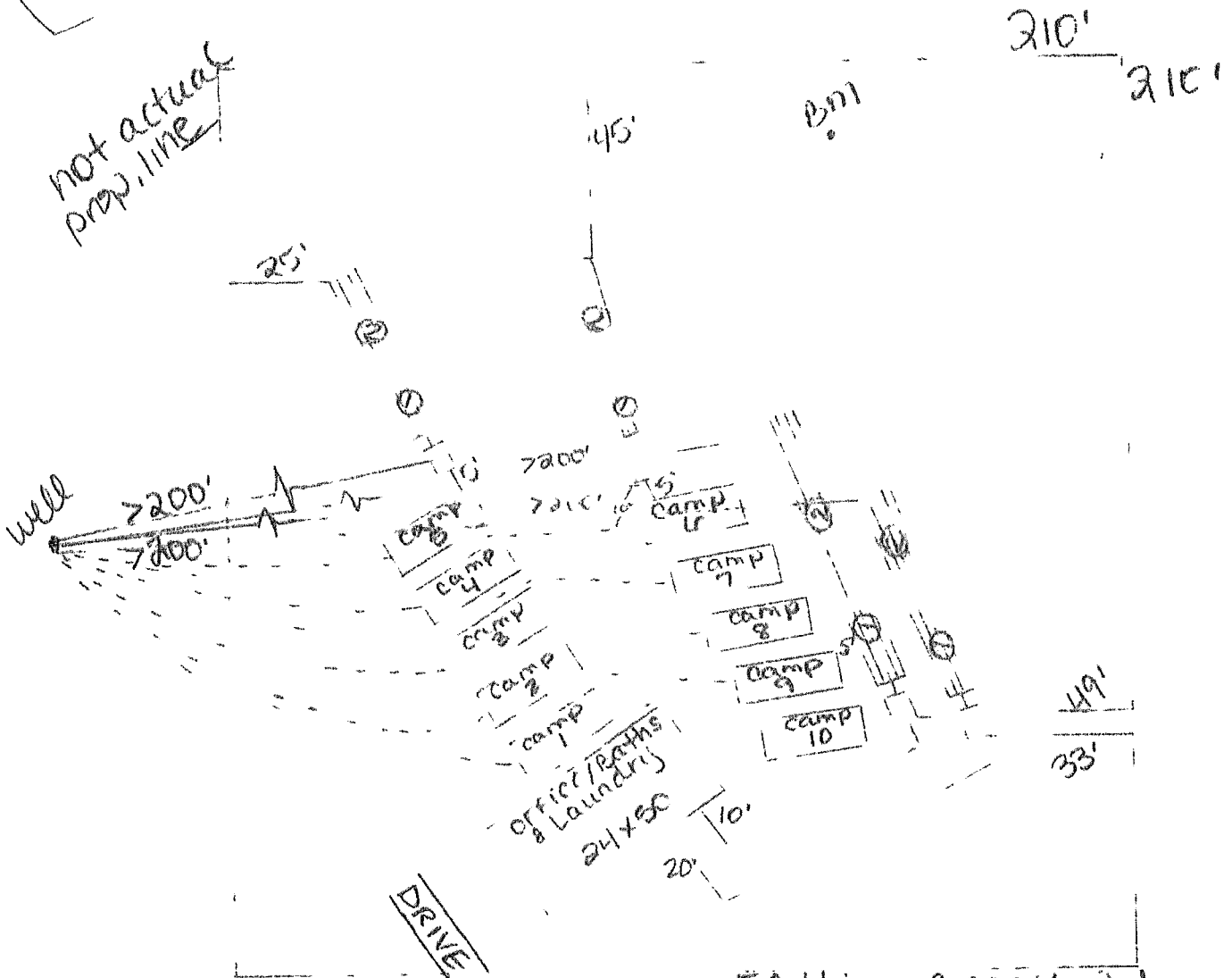

NW Falling Creek Rd.

Road 10 + 10'

REVISOR
5/14/25

Highlighted
5 campsites
for this
permit



STATE OF FLORIDA
DEPARTMENT OF ENVIRONMENTAL PROTECTION
ONSITE SEWAGE TREATMENT AND DISPOSAL
SYSTEM (OSTDS)

PERMIT NO: 25-04-28
DATE PAID: 5/14/25
FEE PAID: 185.00
RECEIPT #: 200206
2433 05/11/25
(3) site fee

APPLICATION FOR CONSTRUCTION PERMIT

APPLICATION FOR:

- New System Existing System Holding Tank Innovative
 Repair Abandonment Temporary

APPLICANT: J&J Florida Development LLC EMAIL: rockyford@windstream.net
AGENT: A&B Construction TELEPHONE: 386-497-2311
MAILING ADDRESS: 546 SW Dartch St, Ft. White, FL 32038

TO BE COMPLETED BY APPLICANT OR APPLICANT'S AUTHORIZED AGENT. SYSTEMS MUST BE CONSTRUCTED BY A PERSON LICENSED PURSUANT TO 489.105(3)(m) OR 489.552, FLORIDA STATUTES IT IS THE APPLICANT'S RESPONSIBILITY TO PROVIDE DOCUMENTATION OF THE DATE THE LOT WAS CREATED OR PLATTED (MM/DD/YY) IF REQUESTING CONSIDERATION OF STATUTORY GRANDFATHER PROVISIONS.

PROPERTY INFORMATION

OSTDS REMEDIATION PLAN? [Y / N]

LOT NA BLOCK NA SUBDIVISION NA PLATTED: _____

PROPERTY ID # 12-38-116-020109-000 ZONING _____ I/M OR EQUIVALENT [Y / N]

PROPERTY SIZE 22.31 ACRES WATER SUPPLY PRIVATE PUBLIC [] ≤2000GPD [] >2000GPD

IS SEWER AVAILABLE AS PER 381.0065, FS? [Y / N] DISTANCE TO SEWER NA FT

PROPERTY ADDRESS: NW Falling Creek Rd, Lake City, FL

DIRECTIONS TO PROPERTY: TR onto NW Main Blvd, take exit onto US Hwy 41N, TR onto NW Falling Creek Rd.

BUILDING INFORMATION

[] RESIDENTIAL COMMERCIAL

Unit No	Type of Establishment	No. of Bedrooms	Building Area Sqft	Commercial/Institutional System Design Table I, Chapter 62-6, FAC
---------	-----------------------	-----------------	--------------------	-------------------------------------------------------------------

1	<u>Campsites</u>	<u>5</u>	<u>480 total</u>	<u>5 campsites</u>
2				
3				
4				

[] Floor/Equipment Drains [] Other (Specify) _____

SIGNATURE Rocky Ford DATE: 5-12-25

11.

25-0428

J&J Florida
Development LLC

110 = 40 ft

5-12-25

1 acre (S 2) 1



NOT actual
MEASURE

300

110

210

400
200
200

71

200

100

TRAIL

Kelly

1000

REVISED
5/14/25

Highlighted
5 campsites
on this
permit



STATE OF FLORIDA
DEPARTMENT OF ENVIRONMENTAL PROTECTION
ONSITE SEWAGE TREATMENT AND DISPOSAL
SYSTEM (OSTDS)

PERMIT NO 25-2429
DATE PAID 5/14/25
FEE PAID 185.25
RECEIPT # 2250000
3/12/26 240.00 3/12/26
OSite

APPLICATION FOR CONSTRUCTION PERMIT

APPLICATION FOR:

New System Existing System Holding Tank Innovative
 Repair Abandonment Temporary

APPLICANT J&J Florida Development LLC EMAIL rockyford@windstream.net
AGENT A&B Construction TELEPHONE 384-497-2311
MAILING ADDRESS 546 SW Dartch St, Ft. White, FL 32038

TO BE COMPLETED BY APPLICANT OR APPLICANT'S AUTHORIZED AGENT SYSTEMS MUST BE CONSTRUCTED BY A PERSON LICENSED PURSUANT TO 489 105(3) (b) OR 489 552, FLORIDA STATUTES IT IS THE APPLICANT'S RESPONSIBILITY TO PROVIDE DOCUMENTATION OF THE DATE THE LOT WAS CREATED OR PLATTED (MM/DD/YY) IF REQUESTING CONSIDERATION OF STATUTORY GRANDFATHER PROVISIONS

PROPERTY INFORMATION

OSTDS REMEDIATION PLAN? [Y / N]

LOT NA BLOCK NA SUBDIVISION NA PLATTED _____

PROPERTY ID # 12-35-16-020109-000 ZONING _____ I/M OR EQUIVALENT [Y / N]

PROPERTY SIZE 22.31 ACRES WATER SUPPLY PRIVATE PUBLIC [] $\leq 2000\text{GPD}$ | $> 2000\text{GPD}$

IS SEWER AVAILABLE AS PER 381 0065, FS? [Y / N] DISTANCE TO SEWER NA FT

PROPERTY ADDRESS NW Falling Creek Rd, Lake City, FL
DIRECTIONS TO PROPERTY: TR onto NW Main Blvd, take exit onto US Hwy 41N, TR onto NW Falling Creek Rd.

BUILDING INFORMATION

RESIDENTIAL COMMERCIAL

Unit No	Type of Establishment	No of Bedrooms	Building Area Sqft	Commercial/Institutional System Design Table I, Chapter 62-6, FAC
1	Office/bathhouse	0	750	(Office 200 gallons per day)
2				(Bath 400 gal. per day)
3				(10 gal. per person @
4				40 people)

Floor/Equipment Drains Other (Specify) _____

SIGNATURE Rocky Ford DATE 5-12-25

STATE OF FLORIDA
DEPARTMENT OF ENVIRONMENTAL PROTECTION
APPLICATION FOR CONSTRUCTION PERMIT

Permit Application Number 25-0429

J&J Florida Development

PART II - SITEPLAN

Scale: Each block represents 10 feet and 1 inch = 40 feet

See
attached

Notes

Site Plan submitted by [Signature]

master contractor

Plan Approved

Not Approved

Date 5/29/25

By [Signature]

Columbia

County Health Department

ALL CHANGES MUST BE APPROVED BY THE COUNTY HEALTH DEPARTMENT

DEP 4015, 06-21-2022 (Obsoletes previous editions which may not be used)

Incorporated 02 6 004 F A C

Page 2 of 4

25-0429 J&J Florida
Development, LLC
" - 40 ft
5-12-25

111

10000 of 20 1



NET actual
WORTHLINE

1111
2200
7300

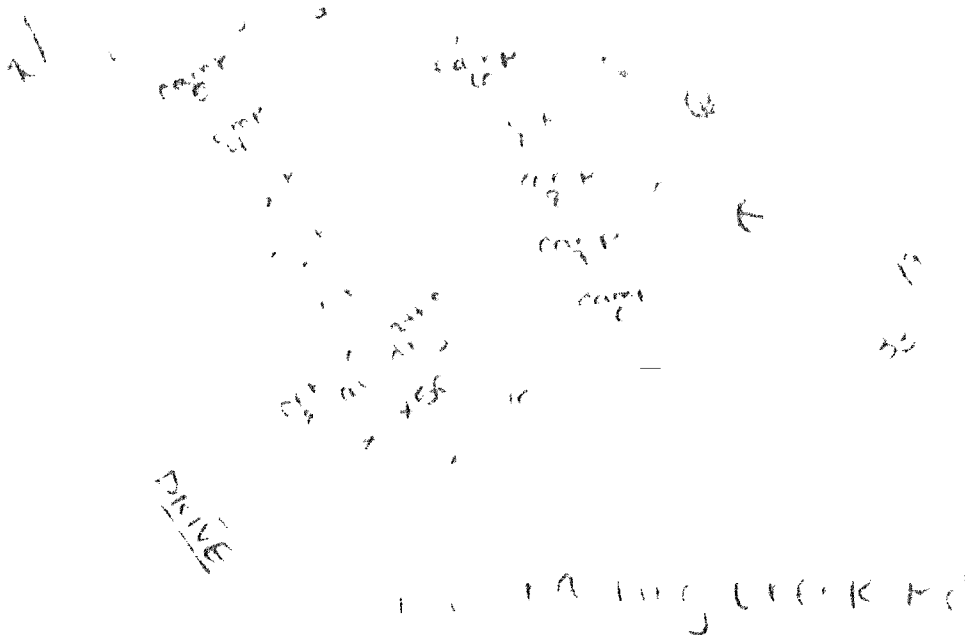

1111

1111



STATE OF FLORIDA
DEPARTMENT OF ENVIRONMENTAL PROTECTION
ONSITE SEWAGE TREATMENT AND DISPOSAL
SYSTEM (OSTDS)

PERMIT NO 25-8430
DATE PAID: 5/14/25
FEE PAID 185.00
RECEIPT # 22202220
3/18/20 240.00 S/A New
@ Site Eval

APPLICATION FOR CONSTRUCTION PERMIT

APPLICATION FOR:

- New System Existing System Holding Tank Innovative
 Repair Abandonment Temporary

APPLICANT: J&J Florida Development LLC EMAIL: rockyford@windstream.net

AGENT: A&B Construction TELEPHONE: 386-497-2311

MAILING ADDRESS: 546 SW Darton St, Ft. White, FL 32038

TO BE COMPLETED BY APPLICANT OR APPLICANT'S AUTHORIZED AGENT. SYSTEMS MUST BE CONSTRUCTED BY A PERSON LICENSED PURSUANT TO 489.105(3)(a) OR 489.552, FLORIDA STATUTES. IT IS THE APPLICANT'S RESPONSIBILITY TO PROVIDE DOCUMENTATION OF THE DATE THE LOT WAS CREATED OR PLATTED (MM/DD/YY) IF REQUESTING CONSIDERATION OF STATUTORY GRANDFATHER PROVISIONS.

PROPERTY INFORMATION

OSTDS REMEDIATION PLAN? [Y / N]

LOT NA LOCK: NA SUBDIVISION: NA PLATTED: _____

PROPERTY ID # 12-35-11-020109-000 ZONING: _____ I/M OR EQUIVALENT: [Y / N]

PROPERTY SIZE: 22.31 ACRES WATER SUPPLY PRIVATE PUBLIC <=2000GPD >2000GPD

IS SEWER AVAILABLE AS PER 381.0065, FS? [Y / N] DISTANCE TO SEWER: NA FT

PROPERTY ADDRESS: NW Falling Creek Rd, Lake City, FL

DIRECTIONS TO PROPERTY: TR onto NW main Blvd, take exit onto US Hwy 41 N, TR onto NW Falling Creek Rd.

BUILDING INFORMATION

RESIDENTIAL COMMERCIAL

Unit No	Type of Establishment	No of Bedrooms	Building Area Sqft	Commercial/Institutional System Design Table I, Chapter 62-6, FAC
1	<u>Laundry</u>	<u>0</u>	<u>15x10</u>	<u>1 washer</u>
2				
3				
4				

Floor/Equipment Drains Other (Specify) _____

SIGNATURE: Rocky Ford DATE: 5-12-25

STATE OF FLORIDA
DEPARTMENT OF ENVIRONMENTAL PROTECTION
APPLICATION FOR CONSTRUCTION PERMIT

Permit Application Number 25-0420

J&J Florida Development

PART II - SITEPLAN

Scale Each block represents 10 feet and 1 inch = 40 feet

See
attached

Notes _____

Site Plan submitted by Archie T. D. master contractor
Plan Approved Not Approved _____ Date 5/29/25
By [Signature] [Signature] County Health Department

ALL CHANGES MUST BE APPROVED BY THE COUNTY HEALTH DEPARTMENT

11

4, 15, 17

J&J Florida
Development LLC

110 = 40 ft

5-28-25

1100, 1100

104 actual
102.111

210'
210'

200
200

200
200

CAMP 1
CAMP 2

CAMP 1
CAMP 2

CAMP 1
CAMP 2

CAMP 1
CAMP 2

CAMP 1
CAMP 2

CAMP 1
CAMP 2

2

2
2

Falling Creek Rd



STATE OF FLORIDA
DEPARTMENT OF ENVIRONMENTAL PROTECTION
ONSITE SEWAGE TREATMENT AND DISPOSAL
SYSTEM (OSTDS)

PERMIT NO 25-0482
DATE PAID: 6/6/25
FEE PAID \$ 310.00
RECEIPT # 2223826
11/3/25 3:15 PM

APPLICATION FOR CONSTRUCTION PERMIT

APPLICATION FOR:

New System Existing System Holding Tank Innovative
 Repair Abandonment Temporary

APPLICANT: J&J Florida Development LLC EMAIL: rockyford@windstream.net
AGENT: A&B Construction TELEPHONE: 386-497-2311

MAILING ADDRESS: 546 SW Dertch St, Ft. White, FL 32038

TO BE COMPLETED BY APPLICANT OR APPLICANT'S AUTHORIZED AGENT. SYSTEMS MUST BE CONSTRUCTED BY A PERSON LICENSED PURSUANT TO 489.105(3) (m) OR 489 552, FLORIDA STATUTES IT IS THE APPLICANT'S RESPONSIBILITY TO PROVIDE DOCUMENTATION OF THE DATE THE LOT WAS CREATED OR PLATTED (MM/DD/YY) IF REQUESTING CONSIDERATION OF STATUTORY GRANDFATHER PROVISIONS.

PROPERTY INFORMATION

OSTDS REMEDIATION PLAN? [Y / N]

LOT NA BLOCK: NA SUBDIVISION: NA PLATTED: _____

PROPERTY ID # 12-38-110-020109-000 ZONING: _____ I/M OR EQUIVALENT: [Y / N]

PROPERTY SIZE: 22.31 ACRES WATER SUPPLY: PRIVATE PUBLIC [] <=2000GPD [] >2000GPD

IS SEWER AVAILABLE AS PER 381.0065, FS? [Y / N] DISTANCE TO SEWER: NA FT

PROPERTY ADDRESS: NW Falling Creek Rd, Lake City, FL

DIRECTIONS TO PROPERTY: TR onto NW Main Blvd, take exit onto US Hwy 41N, TR onto NW Falling Creek Rd.

BUILDING INFORMATION

[] RESIDENTIAL COMMERCIAL

Unit No	Type of Establishment	No of Bedrooms	Building Area Sqft	Commercial/Institutional System Design Table I, Chapter 62-6, FAC
1	<u>Campsites</u>	<u>5</u>	<u>480 total</u>	<u>5 campsites</u>
2				
3				
4				

[] Floor/Equipment Drains [] Other (Specify) _____
SIGNATURE: Rocky D... DATE: 5-28-25

STATE OF FLORIDA
DEPARTMENT OF ENVIRONMENTAL PROTECTION
APPLICATION FOR CONSTRUCTION PERMIT

Permit Application Number 25-0482

J&T Florida Development

PART II - SITEPLAN

Scale: Each block represents 10 feet and 1 inch = 40 feet.

See
attached

Notes _____

Site Plan submitted by [Signature] master contractor

Plan Approved Not Approved _____ Date 6/16/25

By [Signature] Columbia County Health Department

ALL CHANGES MUST BE APPROVED BY THE COUNTY HEALTH DEPARTMENT

↑ N

J & J Florida Developme

lin = 40 ft.

5-28-25

25-0482

1 acre of 22.31

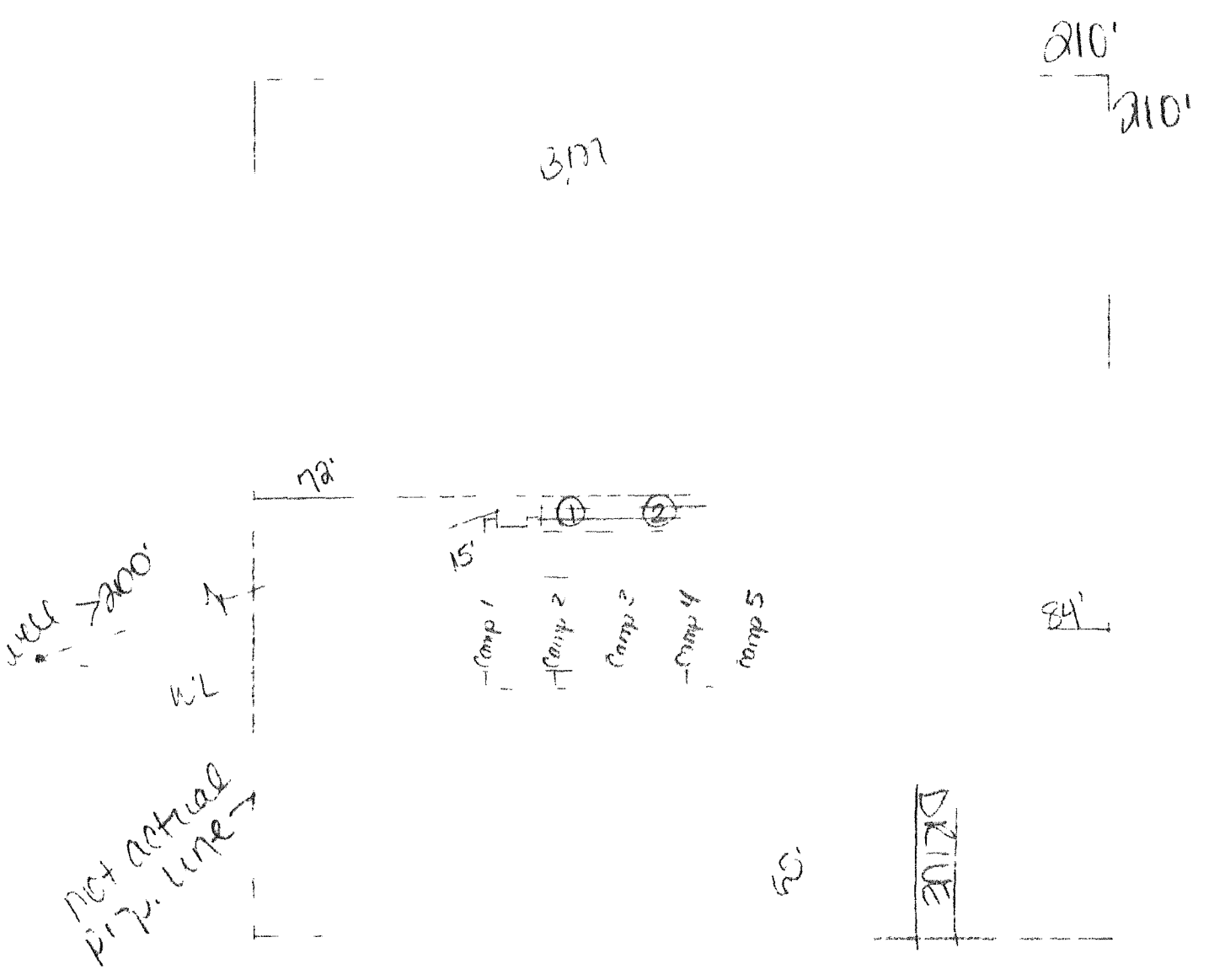

William A. Bishop II



STATE OF FLORIDA
DEPARTMENT OF ENVIRONMENTAL PROTECTION
ONSITE SEWAGE TREATMENT AND DISPOSAL
SYSTEM (OSTDS)

PERMIT NO. 25-0483
DATE PAID: 6/16/25
FEE PAID: 310.00
RECEIPT # 2223783
31436 \$115.1
El.1

APPLICATION FOR CONSTRUCTION PERMIT

APPLICATION FOR:

- New System Existing System Holding Tank Innovative
 Repair Abandonment Temporary

APPLICANT J&J Florida Development LLC EMAIL: rockyford@windstream.net

AGENT A&B Construction TELEPHONE: 381-497-2311

MAILING ADDRESS: 546 SW Dartch St, Ft. White, FL 32038

TO BE COMPLETED BY APPLICANT OR APPLICANT'S AUTHORIZED AGENT. SYSTEMS MUST BE CONSTRUCTED BY A PERSON LICENSED PURSUANT TO 489.105(3) (m) OR 489 552, FLORIDA STATUTES. IT IS THE APPLICANT'S RESPONSIBILITY TO PROVIDE DOCUMENTATION OF THE DATE THE LOT WAS CREATED OR PLATTED (MM/DD/YY) IF REQUESTING CONSIDERATION OF STATUTORY GRANDFATHER PROVISIONS.

PROPERTY INFORMATION

OSTDS REMEDIATION PLAN? [Y / N]

LOT NA BLOCK NA SUBDIVISION: NA PLATTED: _____

PROPERTY ID # 12-3S-16-02069-000 ZONING: _____ I/M OR EQUIVALENT: [Y / N]

PROPERTY SIZE 20.31 ACRES WATER SUPPLY: PRIVATE PUBLIC [] ≤2000GPD [] >2000GPD

IS SEWER AVAILABLE AS PER 381 0065, FS? [Y / N] DISTANCE TO SEWER: NA FT

PROPERTY ADDRESS: NW Falling Creek Rd, Lake City, FL

DIRECTIONS TO PROPERTY: TR onto NW main Blvd, take exit onto US Hwy 41 N, TR onto NW Falling Creek Rd.

BUILDING INFORMATION

[] RESIDENTIAL COMMERCIAL

Unit No	Type of Establishment	No. of Bedrooms	Building Area Sqft	Commercial/Institutional System Design Table I, Chapter 62-6, FAC
---------	-----------------------	-----------------	--------------------	-------------------------------------------------------------------

1	<u>Campsites</u>	<u>5</u>	<u>480 total</u>	<u>5 Campsites</u>
2				
3				
4				

[] Floor/Equipment Drains [] Other (Specify) _____

SIGNATURE: Rocky D. T. DATE: 5-28-25

STATE OF FLORIDA
DEPARTMENT OF ENVIRONMENTAL PROTECTION
APPLICATION FOR CONSTRUCTION PERMIT

Permit Application Number 25-0483

J&J Florida Development

PART II - SITEPLAN

Scale Each block represents 10 feet and 1 inch = 40 feet.

*See
attached*

Notes _____

Site Plan submitted by *[Signature]* master contractor
Plan Approved Not Approved _____ Date 6/10/25
By *[Signature]* Columbia County Health Department

ALL CHANGES MUST BE APPROVED BY THE COUNTY HEALTH DEPARTMENT

DEP 4015, 06-21-2022 (Obsoletes previous editions which may not be used)

Incorporated 62-0 004 F A C

↑ N

J&J Honda Developme

lin = 40 ft.

5-28-25

25-0483

1 acre of 2d = 1

210'
1210'

BM 96'

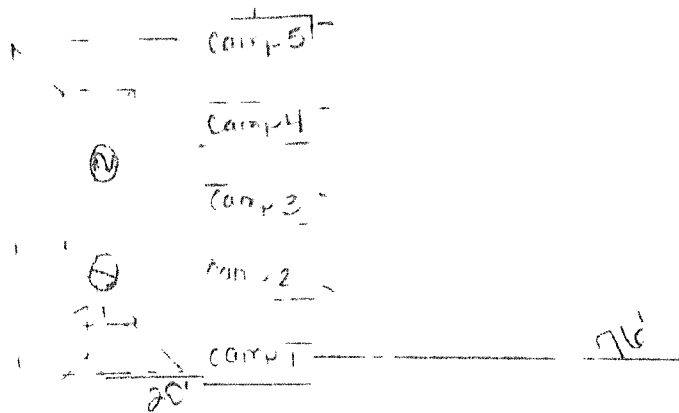

54'

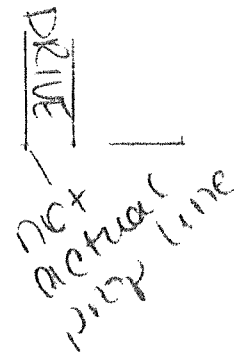
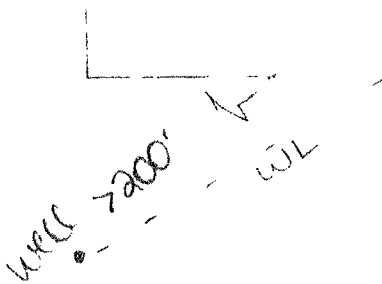

William D. Bishop II