

FINAL PLACEMENT OF RECEPTACLES AND SMOKE DETECTORS TO BE DETERMINED ON SITE BY ELECTRICIAN TO MEET CURRENT CODES.  
 AIR HANDLER IS LOCATED IN ATTIC, NEAR PULldOWN STAIR.  
 ALL CIRCUITS SUPPLYING OUTLETS HAVE ARC FAULT PROTECTION.  
 UTILITY COMPANY SERVICE ENTRANCE CABLE IS UNDERGROUND

# ELECTRICAL PLAN

## ELECTRICAL SYMBOLS

- |   |                            |   |                        |
|---|----------------------------|---|------------------------|
| ⊥ | WALL SWITCH                | ⊙ | RECESSED LIGHT         |
| ⊕ | DIMMER SWITCH              | ⊖ | EXHAUST FAN            |
| ⊗ | SMOKE / CO2 COMBO          | ⊙ | EYEBALL LIGHT          |
| ⊕ | DUPLEX OUTLET              | ⊙ | CAN LIGHT W/ FAN       |
| ⊕ | 240 OUTLET                 | ⊗ | CEILING FAN W/ LIGHT   |
| ⊕ | QUAD OUTLET                | ⊙ | CABLE TV OUTLET        |
| ⊕ | WEATHERPROOF OUTLET        | — | BAR MOUNT VANITY LIGHT |
| ⊕ | GROUND FAULT OUTLET        | ⊙ | DOOR CHIME             |
| ⊗ | SMOKE ALARM                |   |                        |
| ⊕ | TELEPHONE OUTLET           |   |                        |
| ⊕ | INCAND. LIGHT - CLG. MTD.  |   |                        |
| ⊕ | INCAND. LIGHT. - WALL MTD. |   |                        |

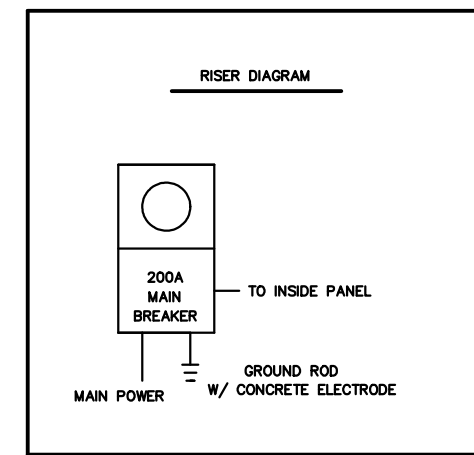
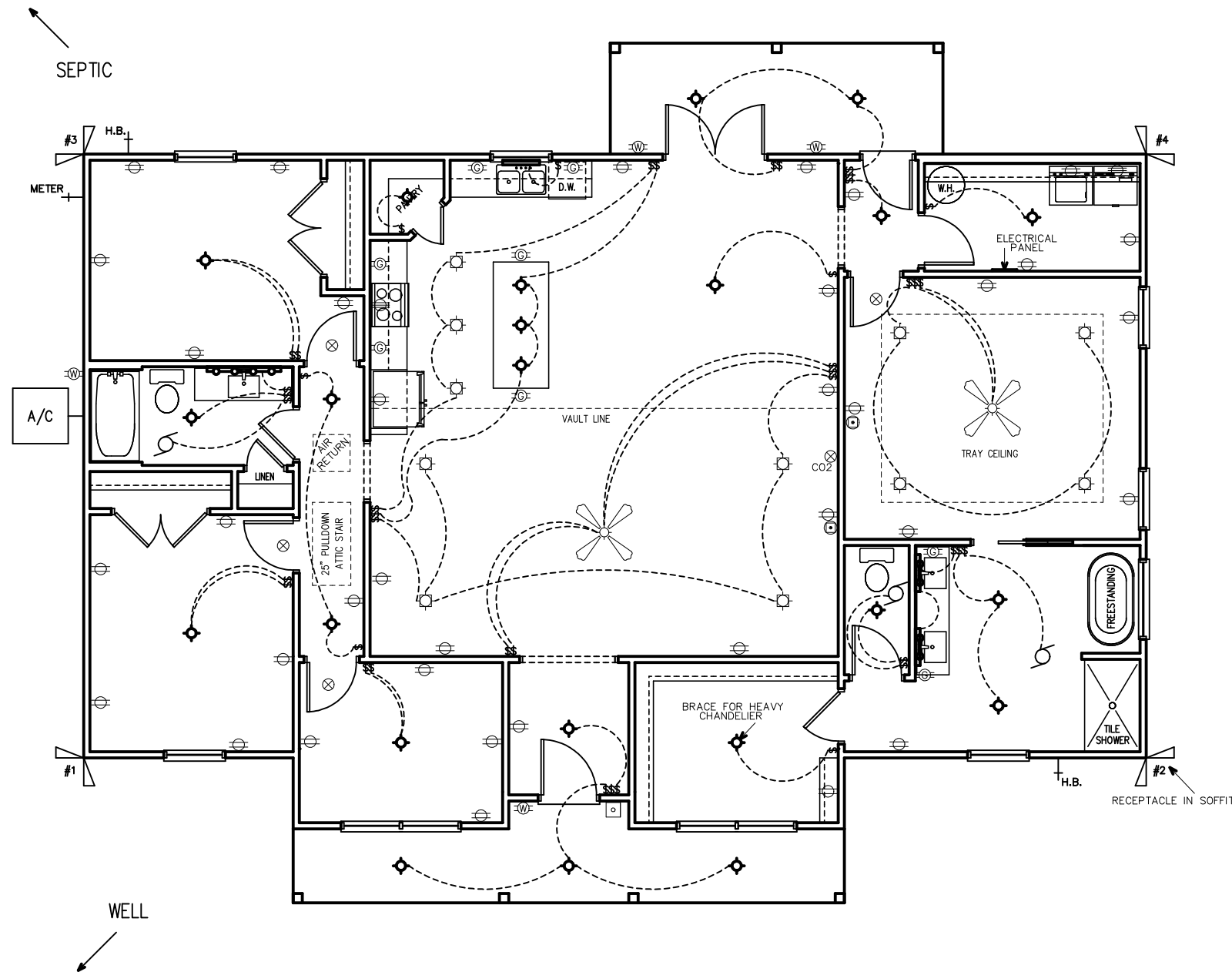

DATE: 01-08-2026  
 PAGE 6 OF 8

SQUARE FOOTAGE	1983 S.F.	237 S.F.	2220 S.F.
HEATED			
PORCH			
TOTAL			

Josh Wilson & Nicole Dempsey  
 White Springs, Florida

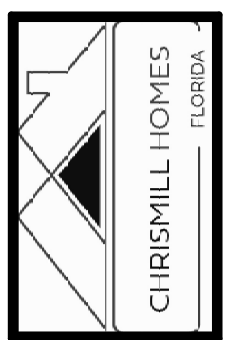

John K. Gentry, P.E.#16990  
 P.O. Box 1034  
 Perry, FL 32348  
 (850) 672-0145

These plans comply with 2023 Florida Building Code, 120 mph wind speed (3 sec. gust)