

Columbia County, FLA - Building & Zoning Property Map

Printed: Mon Jan 05 2026 16:08:33 GMT-0500 (Eastern Standard Time)

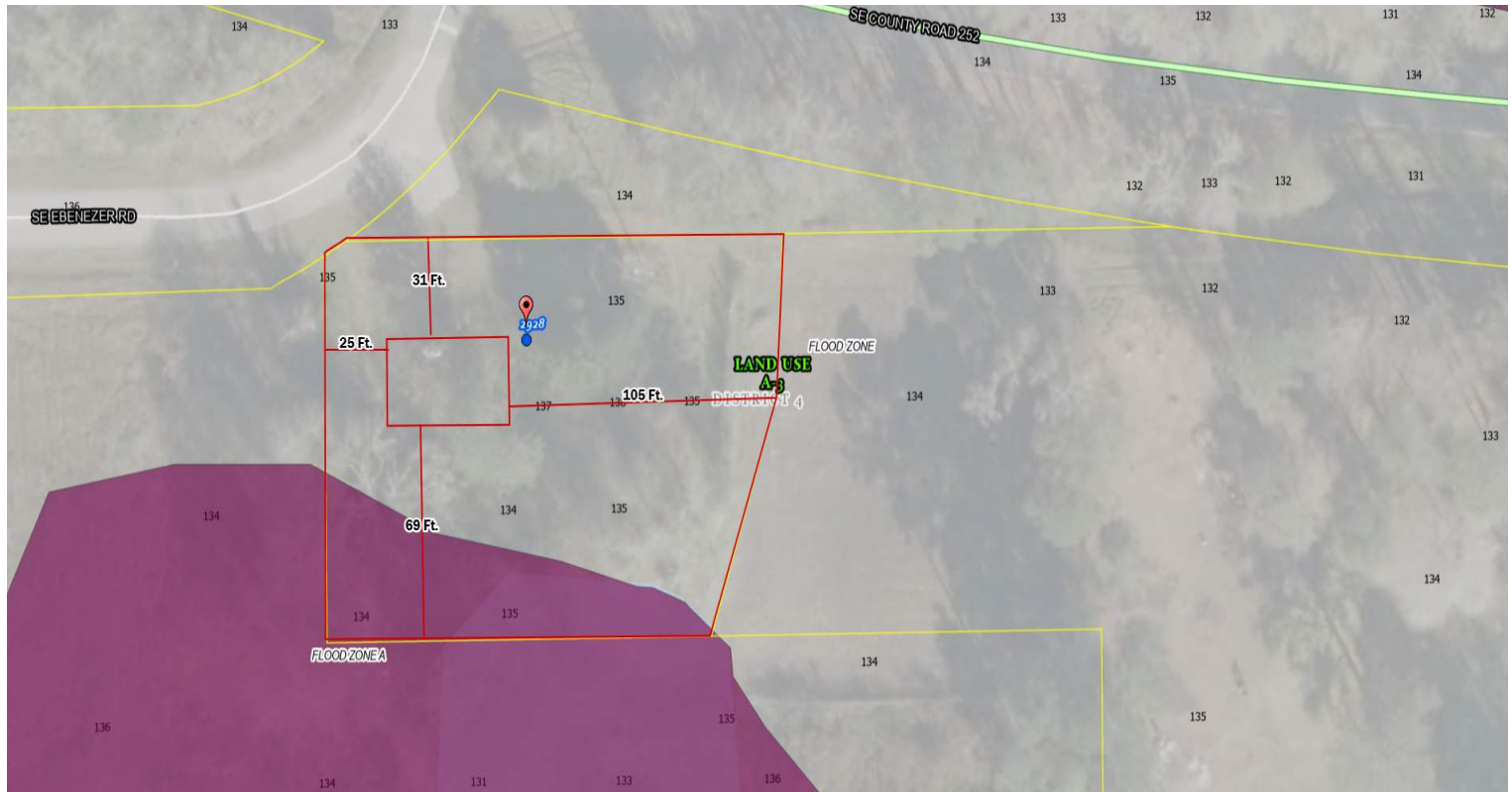

Parcel No: 32-4S-18-10524-003
Owner: REALE DEVELOPMENT LLC,
Subdivision:
Lot:
Acres: 0.5090898
Deed Acres:
District: District 4 Everett Phillips
Future Land Uses: Agriculture - 3
Flood Zones: A,
Official Zoning Atlas: A-3

All data, information, and maps are provided "as is" without warranty or any representation of accuracy, timeliness of completeness. Columbia County, FL makes no warranties, express or implied, as to the use of the information obtained here. There are no implied warranties of merchantability or fitness for a particular purpose. The requester acknowledges and accepts all limitations, including the fact that the data, information, and maps are dynamic and in a constant state of maintenance, and update.