

23-0204

Frank Hines
2849 SW Birley Ave.
Lake City 32024

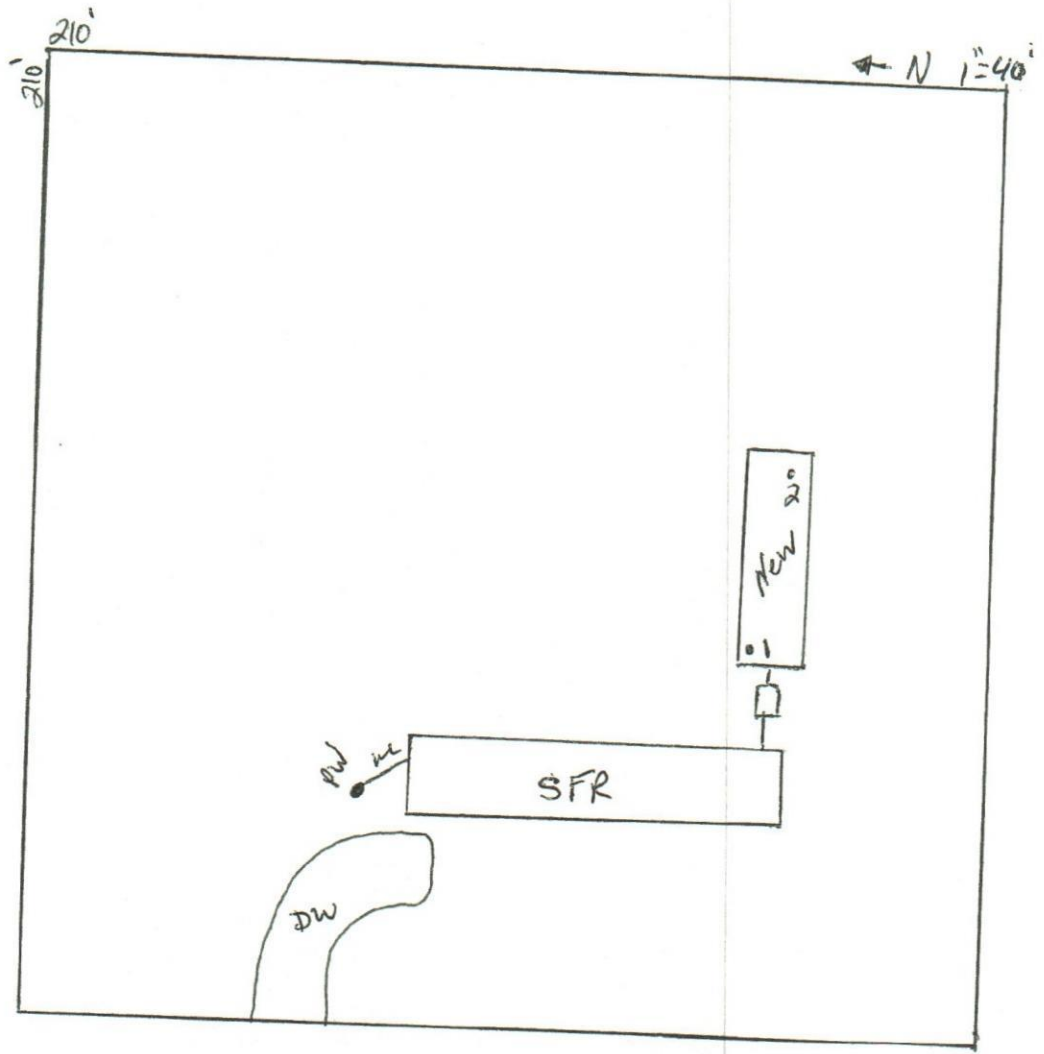

Kameron Keen
21-2064
3-9-23

STATE OF FLORIDA
DEPARTMENT OF HEALTH
APPLICATION FOR CONSTRUCTION PERMIT

Permit Application Number 23 0206

----- PART II - SITEPLAN -----

Scale: Each block represents 10 feet and 1 inch = 40 feet.

Lines

See Attached

Notes: _____

Site Plan submitted by: *K. Koon* Agent: Owner: _____ Date: _____

Plan Approved Not Approved _____ Date *3/17/23*

By *Camille Bonds* *ESI* COLUMBIA County Health Department

ALL CHANGES MUST BE APPROVED BY THE COUNTY HEALTH DEPARTMENT



STATE OF FLORIDA
DEPARTMENT OF ENVIRONMENTAL PROTECTION
ON-SITE SEWAGE TREATMENT AND DISPOSAL
SYSTEM (OSTDS)

PERMIT NO. 23-0206
DATE PAID: 3/14/23
FEE PAID: 310.50
RECEIPT #: 1952449

APPLICATION FOR CONSTRUCTION PERMIT

APPLICATION FOR:

New System Existing System Holding Tank Innovative
 Repair Abandonment Temporary

APPLICANT: Frank Hines EMAIL: _____

AGENT: Kameron Keen TELEPHONE: _____

MAILING ADDRESS: 474 NE 628th St Old Town, 32680

TO BE COMPLETED BY APPLICANT OR APPLICANT'S AUTHORIZED AGENT. SYSTEMS MUST BE CONSTRUCTED BY A PERSON LICENSED PURSUANT TO 489.105(3) (m) OR 489.552, FLORIDA STATUTES. IT IS THE APPLICANT'S RESPONSIBILITY TO PROVIDE DOCUMENTATION OF THE DATE THE LOT WAS CREATED OR PLATTED (MM/DD/YY) IF REQUESTING CONSIDERATION OF STATUTORY GRANDFATHER PROVISIONS.

PROPERTY INFORMATION

OSTDS REMEDIATION PLAN? [Y /]

LOT: _____ BLOCK: _____ SUBDIVISION: _____ PLATTED: _____

PROPERTY ID #: 08-45-16-02812-000 ZONING: _____ I/M OR EQUIVALENT: [Y /]

PROPERTY SIZE: 63.89 ACRES WATER SUPPLY: PRIVATE PUBLIC [] <=2000GPD [] >2000GPD

IS SEWER AVAILABLE AS PER 381.0065, FS? [Y /] DISTANCE TO SEWER: _____ FT

PROPERTY ADDRESS: 2849 SW Birley Ave Lake City 32024

DIRECTIONS TO PROPERTY: US-90W, (L) CR 252B, (L) Pitremount Rd, (L) SW Birley Parcel on (L)

BUILDING INFORMATION

RESIDENTIAL COMMERCIAL

Unit No.	Type of Establishment	No. of Bedrooms	Building Area Sqft	Commercial/Institutional System Design Table I, Chapter 62-6, FAC
1	<u>SFR-MH</u>	<u>2</u>	<u>1130</u>	
2				
3				
4				

[] Floor/Equipment Drains [] Other (Specify) _____

SIGNATURE: Kameron Keen 212064 DATE: 3/9/23



STATE OF FLORIDA
DEPARTMENT OF HEALTH
ON-SITE SEWAGE TREATMENT AND DISPOSAL
SYSTEM

PERMIT #: 12-SC-2668632
APPLICATION #: AP1952969
DATE PAID: 3-14-23
FEE PAID: 310.00
RECEIPT #: _____
DOCUMENT #: PR1908295

CONSTRUCTION PERMIT FOR: OSTDS New
APPLICANT: FRANK**23-0206 HINES
PROPERTY ADDRESS: 2849 SW BIRLEY Lake City, FL 32024
LOT: _____ BLOCK: _____ SUBDIVISION: _____
PROPERTY ID #: 02812-000 [SECTION, TOWNSHIP, RANGE, PARCEL NUMBER]
[OR TAX ID NUMBER]

SYSTEM MUST BE CONSTRUCTED IN ACCORDANCE WITH SPECIFICATIONS AND STANDARDS OF SECTION 381.0065, F.S., AND CHAPTER 64E-6, F.A.C. DEPARTMENT APPROVAL OF SYSTEM DOES NOT GUARANTEE SATISFACTORY PERFORMANCE FOR ANY SPECIFIC PERIOD OF TIME. ANY CHANGE IN MATERIAL FACTS, WHICH SERVED AS A BASIS FOR ISSUANCE OF THIS PERMIT, REQUIRE THE APPLICANT TO MODIFY THE PERMIT APPLICATION. SUCH MODIFICATIONS MAY RESULT IN THIS PERMIT BEING MADE NULL AND VOID. ISSUANCE OF THIS PERMIT DOES NOT EXEMPT THE APPLICANT FROM COMPLIANCE WITH OTHER FEDERAL, STATE, OR LOCAL PERMITTING REQUIRED FOR DEVELOPMENT OF THIS PROPERTY.

SYSTEM DESIGN AND SPECIFICATIONS

T [900] GALLONS / GPD Septic Tank CAPACITY
A [] GALLONS / GPD N/A CAPACITY
N [] GALLONS GREASE INTERCEPTOR CAPACITY [MAXIMUM CAPACITY SINGLE TANK:1250 GALLONS]
K [] GALLONS DOSING TANK CAPACITY [] GALLONS @ [] DOSES PER 24 HRS #Pumps []

D [250] SQUARE FEET Drainfield SYSTEM
R [] SQUARE FEET N/A SYSTEM

A TYPE SYSTEM: [x] STANDARD [] FILLED [] MOUND [] _____

I CONFIGURATION: [x] TRENCH [] BED [] _____

F LOCATION OF BENCHMARK: Nail with pink ribbon in oak S of site

I ELEVATION OF PROPOSED SYSTEM SITE [10.00] [INCHES] / FT [] [ABOVE / BELOW] BENCHMARK/REFERENCE POINT

E BOTTOM OF DRAINFIELD TO BE [40.00] [INCHES] / FT [] [ABOVE / BELOW] BENCHMARK/REFERENCE POINT

D FILL REQUIRED: [0.00] INCHES EXCAVATION REQUIRED: [0.00] INCHES

O The system is sized for 2 bedrooms with a maximum occupancy of 4 persons (2 per bedroom), for a total estimated flow of 200 gpd.
T
H
E
R

SPECIFICATIONS BY: (Joshua) Kameron Keen TITLE: CEHP

APPROVED BY: Cassandra Bonds TITLE: Environmental Specialist I Columbia CHD

DATE ISSUED: 03/17/2023 EXPIRATION DATE: 09/17/2024

DH 4016, 08/09 (Obsoletes all previous editions which may not be used)
Incorporated: 64E-6.003, FAC Page 1 of 3

Handwritten initials 'SF' in blue ink.