



STATE OF FLORIDA
DEPARTMENT OF ENVIRONMENTAL PROTECTION
ONSITE SEWAGE TREATMENT AND DISPOSAL
SYSTEM (OSTDS)

PERMIT NO. 230478
DATE PAID: 6/30/23
FEE PAID: 610.00
RECEIPT #: 1975485

APPLICATION FOR CONSTRUCTION PERMIT

APPLICATION FOR:

- New System Existing System Holding Tank Innovative
 Repair Abandonment Temporary

APPLICANT: Marian Drotos EMAIL: mariahd22@windstream.net

AGENT: _____ TELEPHONE: 904-368-4777

MAILING ADDRESS: 800 N Thompson St. Starke, FL 32091

TO BE COMPLETED BY APPLICANT OR APPLICANT'S AUTHORIZED AGENT. SYSTEMS MUST BE CONSTRUCTED BY A PERSON LICENSED PURSUANT TO 489.105(3) (m) OR 489.552, FLORIDA STATUTES. IT IS THE APPLICANT'S RESPONSIBILITY TO PROVIDE DOCUMENTATION OF THE DATE THE LOT WAS CREATED OR PLATTED (MM/DD/YY) IF REQUESTING CONSIDERATION OF STATUTORY GRANDFATHER PROVISIONS.

PROPERTY INFORMATION

OSTDS REMEDIATION PLAN? [Y / N]

LOT: 2 BLOCK: _____ SUBDIVISION: Hermitage PLATTED: _____

PROPERTY ID #: 21-78-17-10039-102 (37602) ZONING: _____ I/M OR EQUIVALENT: [Y / N]

PROPERTY SIZE: 5 ACRES WATER SUPPLY: PRIVATE PUBLIC [] <=2000GPD [] >2000GPD

IS SEWER AVAILABLE AS PER 381.0065, FS? [Y / N] DISTANCE TO SEWER: _____ FT

PROPERTY ADDRESS: 254 Hermitage Glen High Springs, FL 32643

DIRECTIONS TO PROPERTY: _____

BUILDING INFORMATION

RESIDENTIAL COMMERCIAL

Unit No	Type of Establishment	No. of Bedrooms	Building Area Sqft	Commercial/Institutional System Design Table I, Chapter 62-6, FAC
1	Inground Pool (Fiberglass)		416 Sqft	22-0192
2				
3				
4				

Floor/Equipment Drains Other (Specify) _____

SIGNATURE: Dylan Horn DATE: 6-28-23

STATE OF FLORIDA
DEPARTMENT OF ENVIRONMENTAL PROTECTION
APPLICATION FOR CONSTRUCTION PERMIT

Permit Application Number 23-0478

----- PART II - SITEPLAN -----

Scale: Each block represents 10 feet and 1 inch = 40 feet.

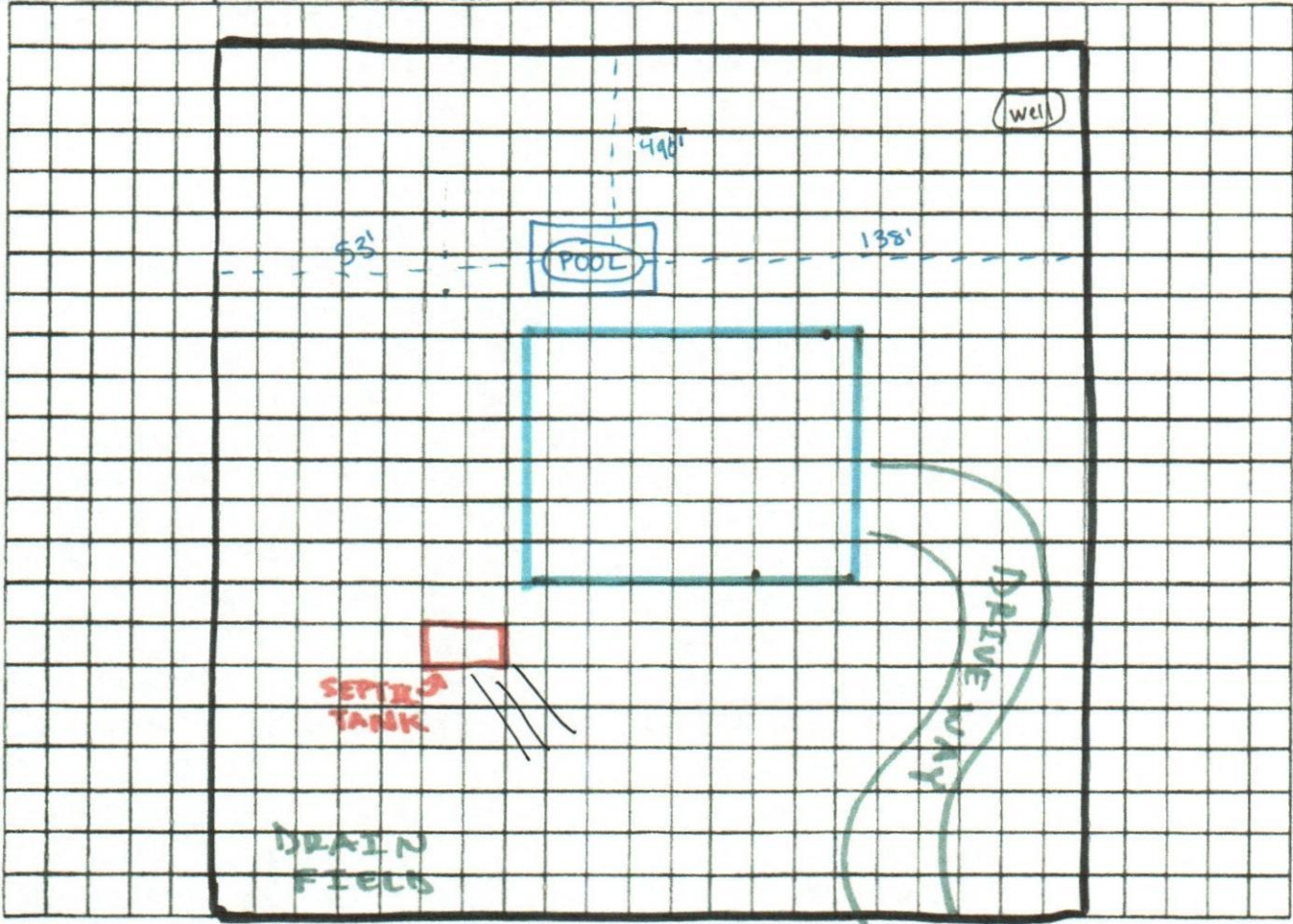

Notes: _____

Site Plan submitted by: Dylan Harrison

Plan Approved Not Approved _____ Date 7/6/23
By Camelia Bonds ESI Columbia County Health Department

ALL CHANGES MUST BE APPROVED BY THE COUNTY HEALTH DEPARTMENT