

# COLUMBIA COUNTY Property Appraiser

## Parcel 34-3S-17-07230-000

### Owners

HETRICK RONALD P  
HETRICK JUDY A  
324 SE GOLF CLUB AVE  
LAKE CITY, FL 32025

GIS

Pictometry

### Parcel Summary

Location	324 SE GOLF CLUB AVE
Use Code	0100: SINGLE FAMILY
Tax District	2: COUNTY
Acreage	0.227
Township	3S
Range	17
Subdivision	CNTRY CLUB
Exemptions	01: HOMESTEAD (196.031a&b) (100%)

### Legal Description

LOT 7 BLOCK 12 COUNTRY CLUB ESTATES REPLAT S/D.

673-19, LE 1316-621, DC 1441-96,

### Working Values

	2026
Total Building	\$149,278
Total Extra Features	\$3,300
Total Market Land	\$18,500
Total Ag Land	\$0

	2026
Total Market	\$171,078
Total Assessed	\$149,232
Total Exempt	\$101,411
Total Taxable	\$47,821
SOH Diff	\$21,846

## Value History

	2025	2024	2023	2022	2021	2020
Total Building	\$148,725	\$141,366	\$131,020	\$114,808	\$61,996	\$56,681
Total Extra Features	\$3,300	\$3,300	\$3,300	\$3,300	\$700	\$700
Total Market Land	\$18,500	\$18,500	\$18,500	\$15,000	\$10,800	\$10,720
Total Ag Land	\$0	\$0	\$0	\$0	\$0	\$0
Total Market	\$170,525	\$163,166	\$152,820	\$133,108	\$73,496	\$68,101
Total Assessed	\$145,309	\$141,214	\$137,101	\$133,108	\$73,496	\$43,315
Total Exempt	\$100,722	\$100,000	\$100,000	\$50,000	\$0	\$25,000
Total Taxable	\$44,587	\$41,214	\$37,101	\$83,108	\$73,496	\$18,315
SOH Diff	\$25,216	\$21,952	\$15,719	\$0	\$0	\$24,786

## Document/Transfer/Sales History

Instrument / Official Record	Date	Q/U	Reason	Type	V/I	Sale Price	Ownership
<u>WD</u> 1441/98	2021-06-25	<u>Q</u>	<u>01</u>	WARRANTY DEED	Improved	\$165,000	Grantor: CREWS RODNEY L Grantee: HETRICK RONALD P
<u>LE</u> 1316/0621	2016-05-27	<u>U</u>	<u>14</u>	LIFE ESTATE DEED	Improved	\$100	Grantor: MARY E CREWS Grantee: MARY E CREWS (LIFE ESTATE)

## Buildings

### Building # 1, Section # 1, 56681, SFR

Type	Style	Heated Sq Ft	Repl Cost New	YrBlt	Year Eff	Gross Area	Other % Dpr	Normal % Dpr	% Cond	Value
<u>0100</u>	<u>01</u>	1161	\$168,201	1962	2016	1,539	0.00%	11.25%	88.75%	\$149,278

## Structural Elements

## Sub Areas

Type	Description	Code	Details
EW	Exterior Wall	15	CONC BLOCK
RS	Roof Structure	03	GABLE/HIP
RC	Roof Cover	03	COMP SHNGL
IW	Interior Wall	05	DRYWALL
IF	Interior Flooring	13	LAM/VNLPLK
AC	Air Conditioning	03	CENTRAL
HT	Heating Type	03	FORCED AIR
BDR	Bedrooms	3.00	
BTH	Bathrooms	2.00	
FR	Frame	01	NONE
STR	Stories	1.	1.
AR	Architectual Type	05	CONV
COND	Condition Adjustment	03	03
KTCH	Kitchen Adjustment	01	01

Type	Gross Area	Percent of Base	Adjusted Area
<u>BAS</u>	1,161	100%	1,161
<u>FCP</u>	240	25%	60
<u>FOP</u>	54	30%	16
<u>FST</u>	84	55%	46

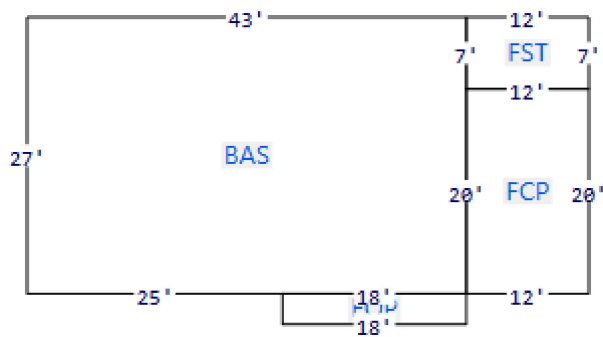

## Extra Features

Code	Description	Length	Width	Units	Unit Price	AYB	% Good Condition	Final Value
0166	CONC,PAVMT			1.00	\$2,600.00	0	100%	\$300
0258	PATIO			1.00	\$0.00	0	100%	\$100
0120	CLFENCE 4			1.00	\$0.00	1993	100%	\$300
0294	SHED WOOD/VINYL			1.00	\$2,600.00	2021	100%	\$2,600

## Land Lines

Code	Description	Zone	Front	Depth	Units	Rate/Unit	Acreage	Total Adj	Value
0100	SFR	<u>RSF-2</u>	82.00	121.00	1.00	\$18,500.00/ <u>LT</u>	0.23	1.00	\$18,500

## Personal Property

None

## Permits

Date	Permit	Type	Status	Description
May 8, 2023	000047102	REMODEL	COMPLETED	Remodel
Feb 21, 2022	000043714	REMODEL	COMPLETED	Remodel
Sep 27, 2021	000042813	STORAGE	COMPLETED	Storage Building
May 27, 2021	000041988	ELECTRICAL	COMPLETED	Electrical Service
Sep 9, 2009	27831	MAINT/ALTR	COMPLETED	MAINT/ALTR
Apr 25, 2007	25690	MAINT/ALTR	COMPLETED	MAINT/ALTR

## TRIM Notices

2025  
2024  
2023

## Disclaimer

All parcel data on this page is for use by the Columbia County Assessor for assessment purposes only. The summary data on this page may not be a complete representation of the parcel or of the improvements thereon. Building information, including unit counts and number of permitted units, should be verified with the appropriate building and planning agencies. Zoning information should be verified with the appropriate planning agency. All parcels are reappraised each year. This is a true and accurate copy of the records of the Columbia County Assessor's Office as of May 11, 2026.