



2609 W. US Hwy 90
Lake City, FL 32055
03/01/22

Allen Industries

YOUR BRAND AT ITS BEST™

1-800-967-2553
www.allenindustries.com

Customer Approval / Signature

Signature: _____ Date: _____

Site Plan

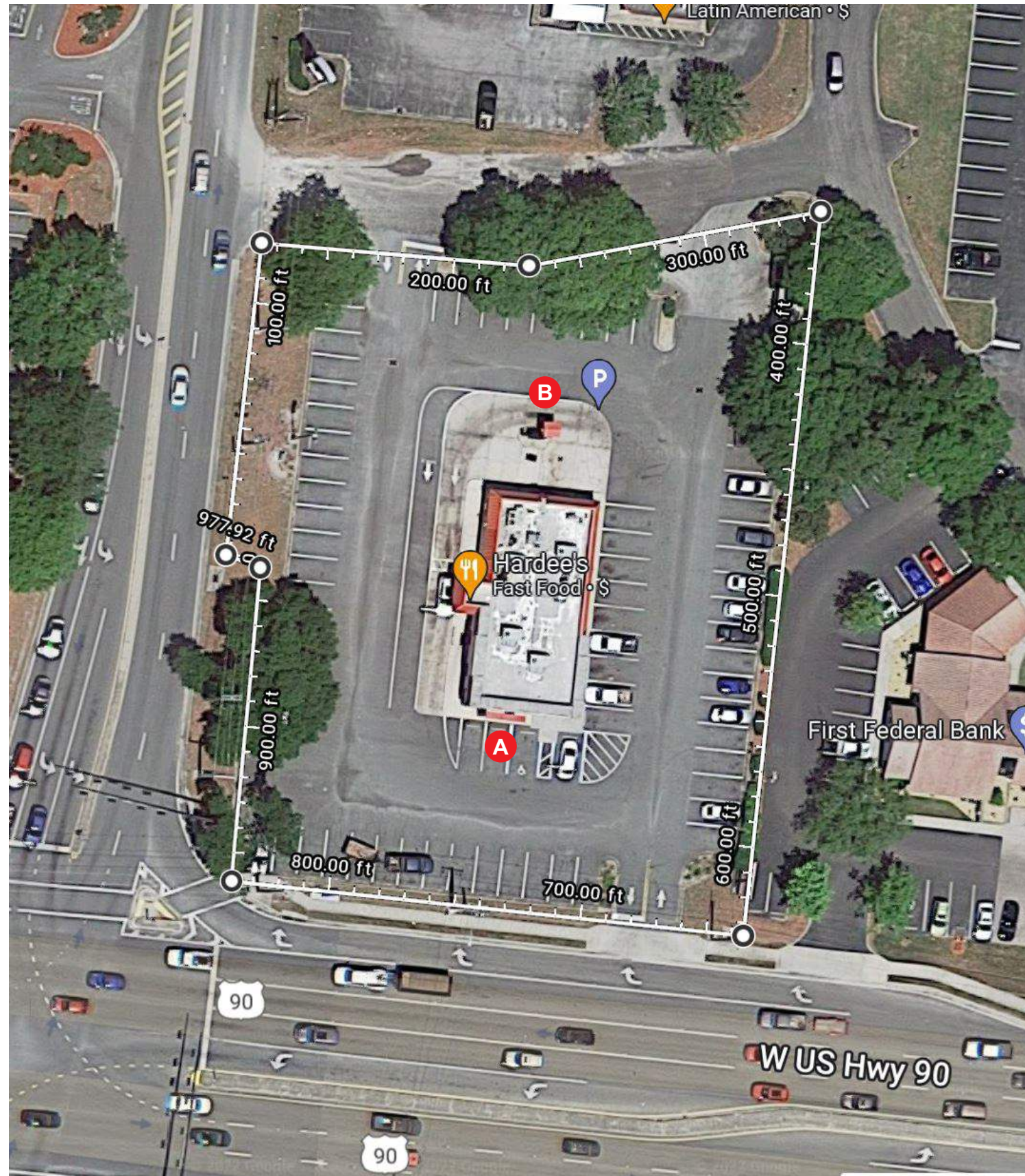

- A** Stacked Logo and Backer
- B** DT OCU

Client Review Status
 Allen Industries, Inc. requires that an approved drawing be obtained from the client prior to any production release or production release revision.

Client Signature: _____ Approval Date: _____

Notes:

#	Date	Description	Initial
1	07/08/22	-	BH
2	-	-	-
3	-	-	-
4	-	-	-
5	-	-	-
6	-	-	-
7	-	-	-
8	-	-	-
9	-	-	-
10	-	-	-
11	-	-	-
12	-	-	-
13	-	-	-
14	-	-	-
15	-	-	-
16	-	-	-
17	-	-	-
18	-	-	-
19	-	-	-
20	-	-	-

Date: 03/01/22 Page #: 2

File Name: CKE-H-F.46_Lake City, FL_301

Sales: TA Design: BH PM: CR

Client: Hardee's

Address: 2609 W. US Hwy 90
 Lake City, FL 32055

Copyright © 2022 Allen Industries, Inc.
 This is an original, unpublished drawing, created by Allen Industries, Inc. This drawing is submitted to you in confidence for your use solely in connection with the project being planned for you by Allen Industries, Inc. and is not to be shown to anyone outside your organization, nor used, reproduced, copied or exhibited in any fashion whatsoever. The designs shown on the drawing (except for any registered trademarks that may belong to a client of Allen Industries, Inc.) remain the property of Allen Industries, Inc.



Right Elevation



Existing



Proposed

Elevation Frontage:	750 sq ft	(200"H x 540"W) / 144 = 750 sq ft
Allowable Signage:	75 sq ft	750 sq ft x 10% = 75 sq ft
Proposed sq ft:	53 sq ft	(89.25" x 84.625"W)/144 = 53 sq ft

Client Review Status
 Allen Industries, Inc. requires that an approved drawing be obtained from the client prior to any production release or production release revision.

Client Signature:	Approval Date:
-------------------	----------------

Notes:

#	Date	Description	Initial
1	07/08/22	-	BH
2	-	-	-
3	-	-	-
4	-	-	-
5	-	-	-
6	-	-	-
7	-	-	-
8	-	-	-
9	-	-	-
10	-	-	-
11	-	-	-
12	-	-	-
13	-	-	-
14	-	-	-
15	-	-	-
16	-	-	-
17	-	-	-
18	-	-	-
19	-	-	-
20	-	-	-

Date:	Page #:
03/01/22	5

File Name:
CKE-H-F.46_Lake City, FL_301

Sales:	Design:	PM:
TA	BH	CR

Client:
Hardee's

Address:
**2609 W. US Hwy 90
 Lake City, FL 32055**

Copyright © 2022 Allen Industries, Inc.
 This is an original, unpublished drawing, created by Allen Industries, Inc. This drawing is submitted to you in confidence for your use solely in connection with the project being planned for you by Allen Industries, Inc. and is not to be shown to anyone outside your organization, nor used, reproduced, copied or exhibited in any fashion whatsoever. The designs shown on the drawing (except for any registered trademarks that may belong to a client of Allen Industries, Inc.) remain the property of Allen Industries, Inc.



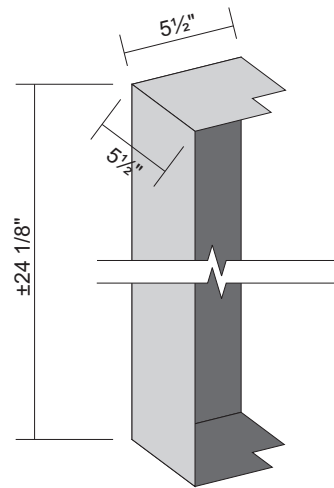

CORNER CAP

.040" fabricated aluminum painted black; to cap over corner joins of band

Specifications:

Mansard wrap band to be ACM cladding on 2" angle framework. Corners of band to be brought to square terminations with prefab caps.

- ACM to be 4mm BLX PE Black (62x196).
- Sheets to have routed returns to cap over install frame. All sheets to have 1" routed returns @ butt-joint locations.
- Mansard wash lighting (up) to be installed along upper length of band.

QTY: -

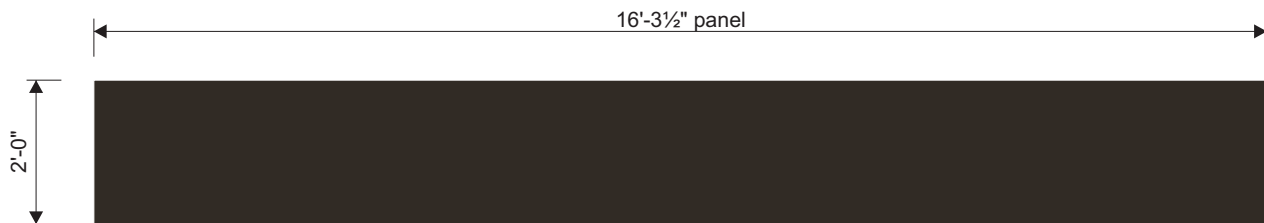

GEN. ELEVATION - Flat Panel Runs

Scale: 3/8" = 1'-0"

QTY: - Sheets will be field cut as necessary

FRAME SECTIONS MAY BE SLIGHTLY DIFFERNT

COLOR SPECIFICATIONS

BLX Black ACM

ROOF FASTENER SCHEDULE (ALL FASTENERS TO BE NON-COROSIVE)		
	3/8" Ø GRADE 36 THREADED ROD WITH BLOCKING BEHIND WALL	FOR ALL FRAMING TYPES
	3/8" Ø GRADE 36 LAG SCREW	FOR WOOD FRAMING. 2-1/2" MIN. EMBEDMENT IN 2x FRAMING / BLOCKING

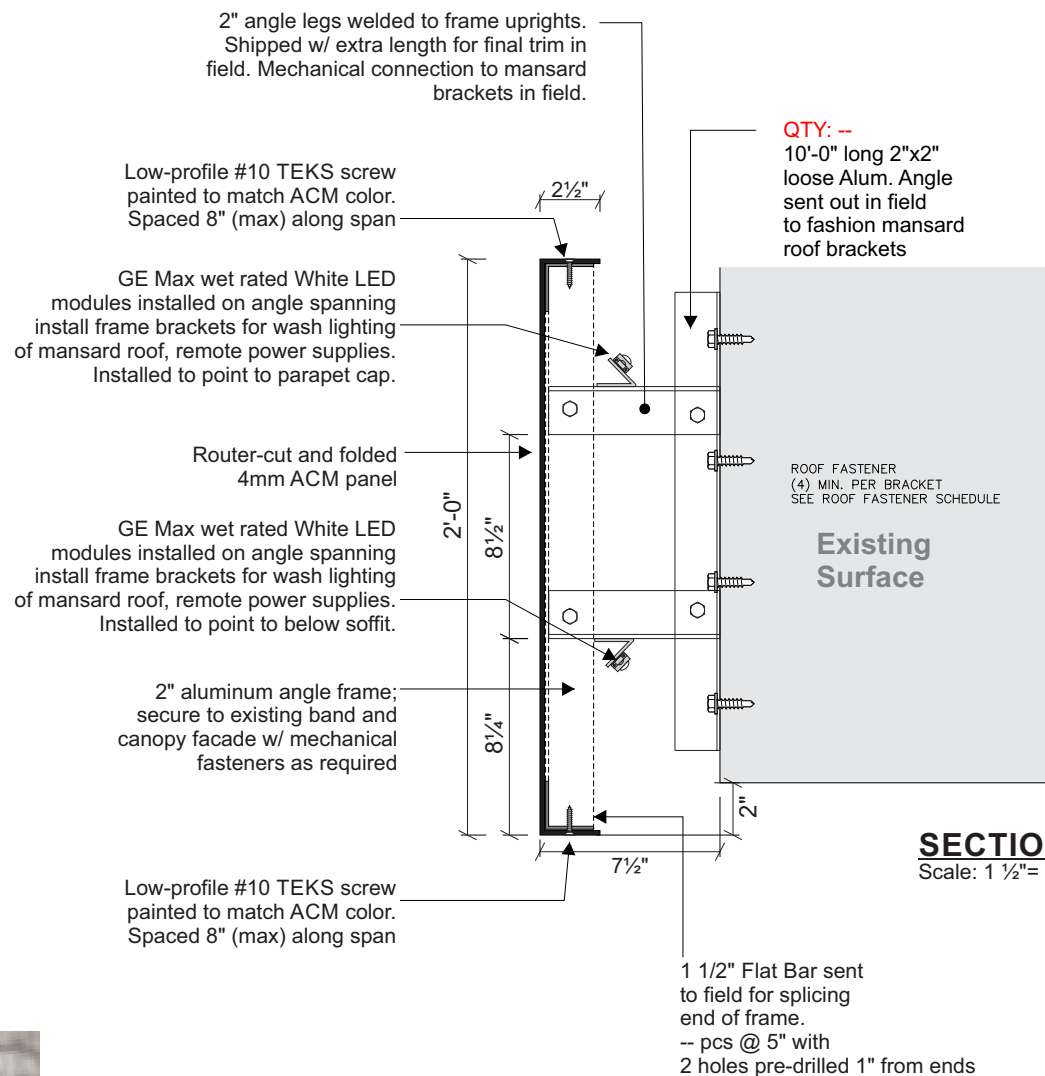

ACM Surface Wrap

Blank & Corners

Client Review Status

Allen Industries, Inc. requires that an approved drawing be obtained from the client prior to any production release or production release revision.

Client Signature:

Approval Date:

Notes:

#	Date	Description	Initial
1	07/08/22	-	BH
2	-	-	-
3	-	-	-
4	-	-	-
5	-	-	-
6	-	-	-
7	-	-	-
8	-	-	-
9	-	-	-
10	-	-	-
11	-	-	-
12	-	-	-
13	-	-	-
14	-	-	-
15	-	-	-
16	-	-	-
17	-	-	-
18	-	-	-
19	-	-	-
20	-	-	-

Date: 03/01/22	Page #: 6
--------------------------	---------------------

File Name:
CKE-H-F.46_Lake City, FL_301

Sales: TA	Design: BH	PM: CR
---------------------	----------------------	------------------

Client:
Hardee's

Address:
**2609 W. US Hwy 90
Lake City, FL 32055**

Copyright © 2022 Allen Industries, Inc. This is an original, unpublished drawing, created by Allen Industries, Inc. This drawing is submitted to you in confidence for your use solely in connection with the project being planned for you by Allen Industries, Inc. and is not to be shown to anyone outside your organization, nor used, reproduced, copied or exhibited in any fashion whatsoever. The designs shown on the drawing (except for any registered trademarks that may belong to a client of Allen Industries, Inc.) remain the property of Allen Industries, Inc.



Proposed Mansard Wrap Locations

GENERAL NOTES:

- All design, detailing, fabricating and construction shall conform to the following codes and specifications:
 - The Florida Building Code 7th Edition (2020) & (ASCE 7-16).
 - American Society of Testing and Materials (ASTM) specifications.
 - Building Code Requirements for Reinforced concrete (ACI 318-Current Edition).
 - Code for Welding in Building Construction of the American Welding Society.
 - Specification for the Design, Fabrication and Erection of Structural Steel for Buildings by The American Institute of Steel Construction (AISC) (Current Edition).
 - Aluminum Association Aluminum Design Manual (2010 Edition).
- Structural Material Specifications:
 - Aluminum shapes shall be extruded from 6061-T6 alloy. Welding filler alloy shall be 5183, 5356, 5556 or approved alternative.
 - Structural Steel and Plates shall be ASTM A-36 (F_y=36 ksi)
 - W-Shape beams shall be ASTM A-992 (F_y=50 ksi) Minimum
 - Structural tubing shall be ASTM A-500, Grade B, (F_y=46 ksi)
 - Structural piping shall be ASTM A-53, Grade B, Type E or S, (F_y=35 ksi), ASTM A572 Grade 42 (F_y=42 ksi) or ASTM A572 Grade 50 (F_y=50 ksi). (see drawing for individual member specifications).
- Threaded rods shall be Galvanized or Zinc plated F-1554 Grade 36, A307 Grade A, A307 Grade B, A307 Grade C, SAE J429 Grade 1 or SAE J429 Grade 2, unless otherwise noted.
- Welding electrodes shall comply with AWS D1.1-(Current Edition), E70XX. (All welding to be done by welder certified for specified weld type.)

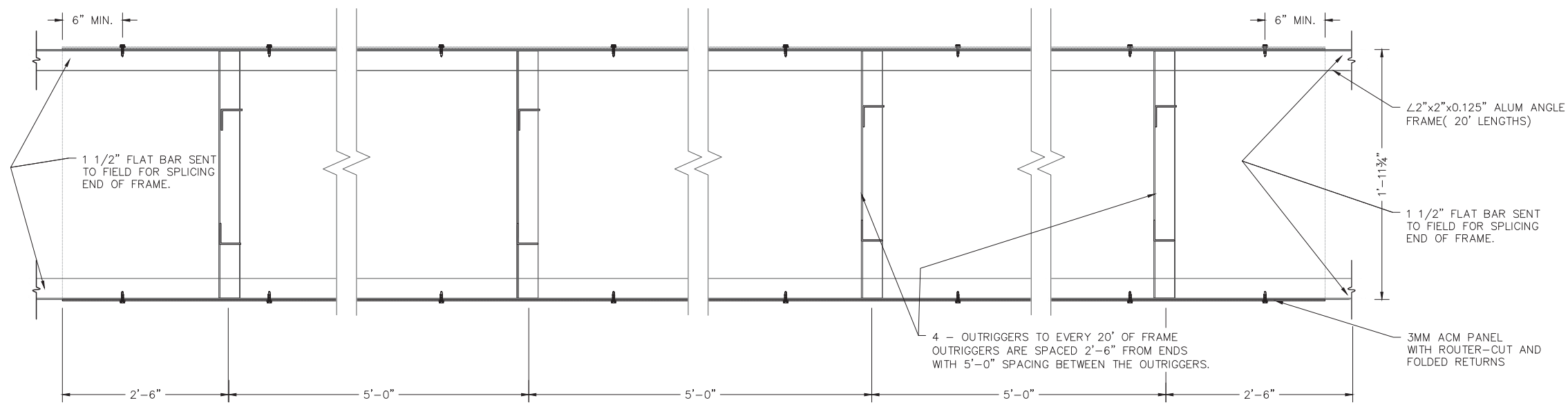

ANGLE INSTALLATION FRAME ELEVATION (TYP.)
 NOT TO SCALE

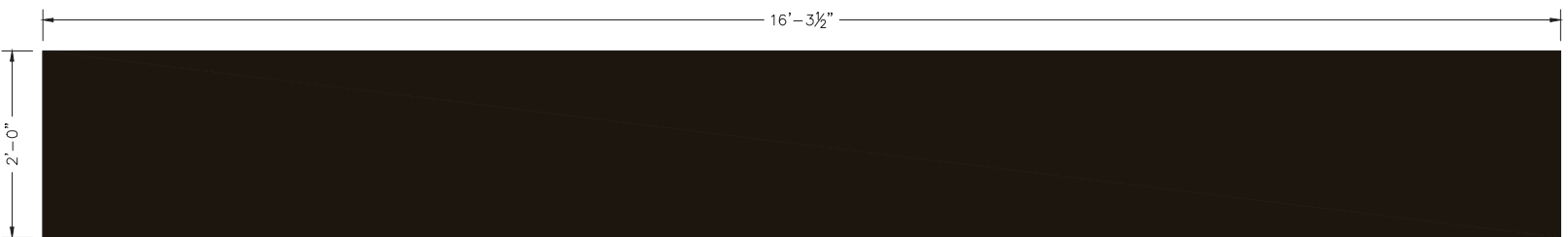

GEN. ELEVATION - FLAT PANEL RUNS
 SHEETS WILL BE FIELD CUT AS NECESSARY
 QTY: 7

COLOR SPECIFICATIONS

BLX Black ACM

ROOF FASTENER SCHEDULE
 (ALL FASTENERS TO BE NON-CORROSIVE)

	3/8" Ø GRADE 36 THREADED ROD WITH BLOCKING BEHIND WALL	FOR ALL FRAMING TYPES
	3/8" Ø GRADE 36 LAG SCREW	FOR WOOD FRAMING. 2-1/2" MIN. EMBEDMENT IN 2x FRAMING / BLOCKING

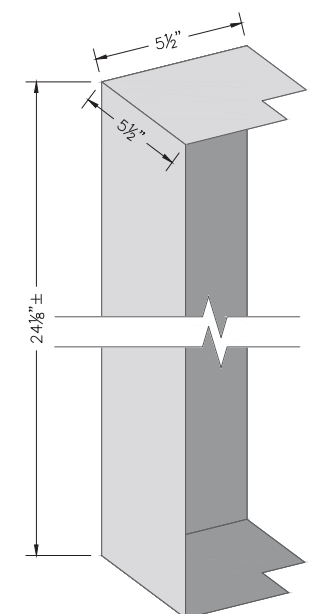

SPECIFICATIONS:
 MANSARD WRAP BAND TO BE ACM CLADDING ON 2" ANGLE FRAMEWORK.
 CORNERS OF BAND TO BE BROUGHT TO SQUARE TERMINATIONS WITH PREFAB CAPS.
 ACM TO BE 4MM BLX PE BLACK (62X196).
 SHEETS TO HAVE ROUTED RETURNS TO CAP OVER INSTALL FRAME.
 ALL SHEETS TO HAVE 1" ROUTED RETURNS @ BUTT-JOINT LOCATIONS.
 MANSARD WASH LIGHTING (UP) TO BE INSTALLED ALONG UPPER LENGTH OF BAND.
 QTY: 2

CORNER CAP
 .040" FABRICATED ALUMINUM PAINTED BLACK; TO CAP OVER CORNER JOINS OF BAND

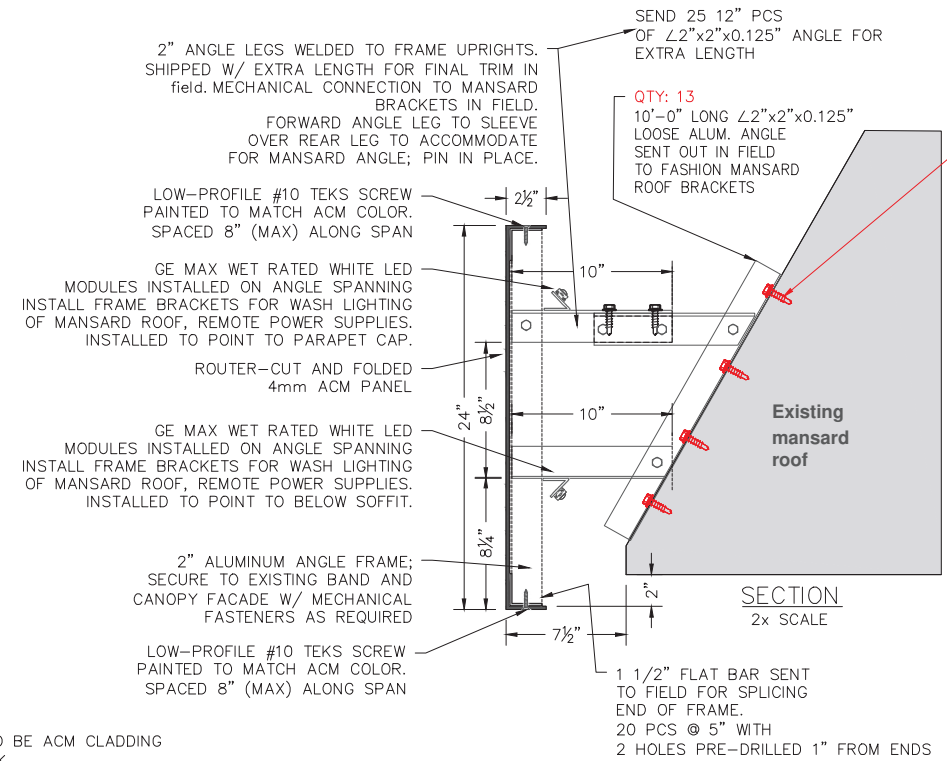

Notice:
 YJ Inc is responsible for ACM Mansard Wrap Framing & roof attachment design only.

TONY JACOB
 LICENSE
 No. 85008
 Exp: 02/28/2023
 STATE OF FLORIDA
 PROFESSIONAL ENGINEER
 07/11/2022

This item has been electronically signed and sealed by Tony Jacob using a digital signature and date. Printed copies of this document are not considered signed and sealed and the signature must be verified on any electronic copies.

HAR-OC32X8-FRIL-STAR

Order Canopy, Flat Roof Production Details

Client Review Status
 Allen Industries, Inc. requires that an approved drawing be obtained from the client prior to any production release or production release revision.

Client Signature: _____ Approval Date: _____

Notes:

#	Date	Description	Initial
1	04/11/22	-	BH
2	-	-	-
3	-	-	-
4	-	-	-
5	-	-	-
6	-	-	-
7	-	-	-
8	-	-	-
9	-	-	-
10	-	-	-
11	-	-	-
12	-	-	-
13	-	-	-
14	-	-	-
15	-	-	-
16	-	-	-
17	-	-	-
18	-	-	-
19	-	-	-
20	-	-	-

Date: **03/02/22** Page #: **11**

File Name: _____

Sales: **TA** Design: **BH** PM: **CR**

Client: **Hardee's**

Address: **2609 W. US HWY 90
LAKE CITY, FL**

Copyright © 2022 Allen Industries, Inc.
 This is an original, unpublished drawing, created by Allen Industries, Inc. This drawing is submitted to you in confidence for your use solely in connection with the project being planned for you by Allen Industries, Inc. and is not to be shown to anyone outside your organization, nor used, reproduced, copied or exhibited in any fashion whatsoever. The designs shown on the drawing (except for any registered trademarks that may belong to a client of Allen Industries, Inc.) remain the property of Allen Industries, Inc.

Allen Industries
 YOUR BRAND AT ITS BEST™
1-800-967-2553
www.allenindustries.com

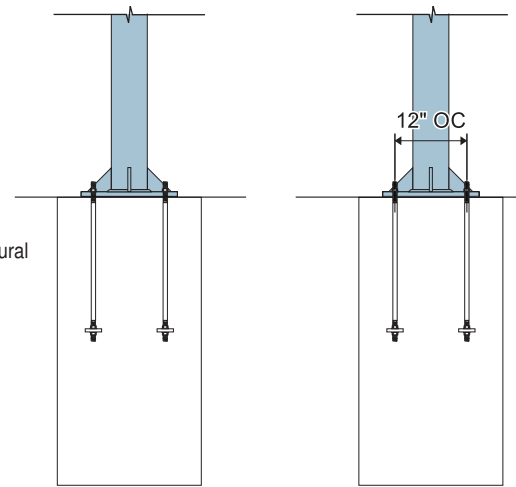
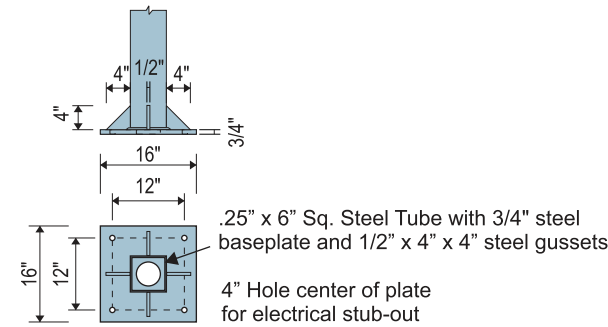
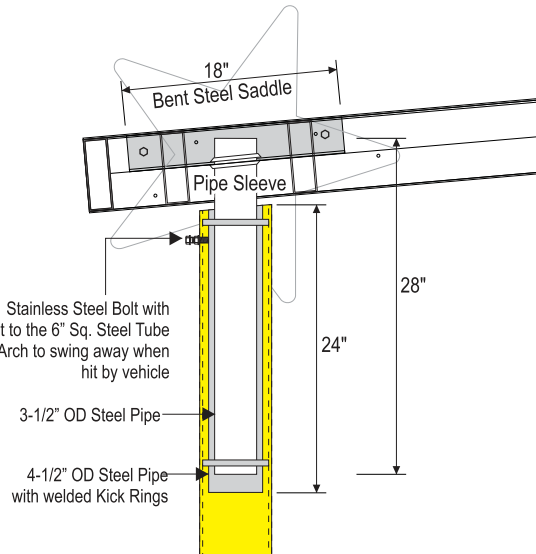
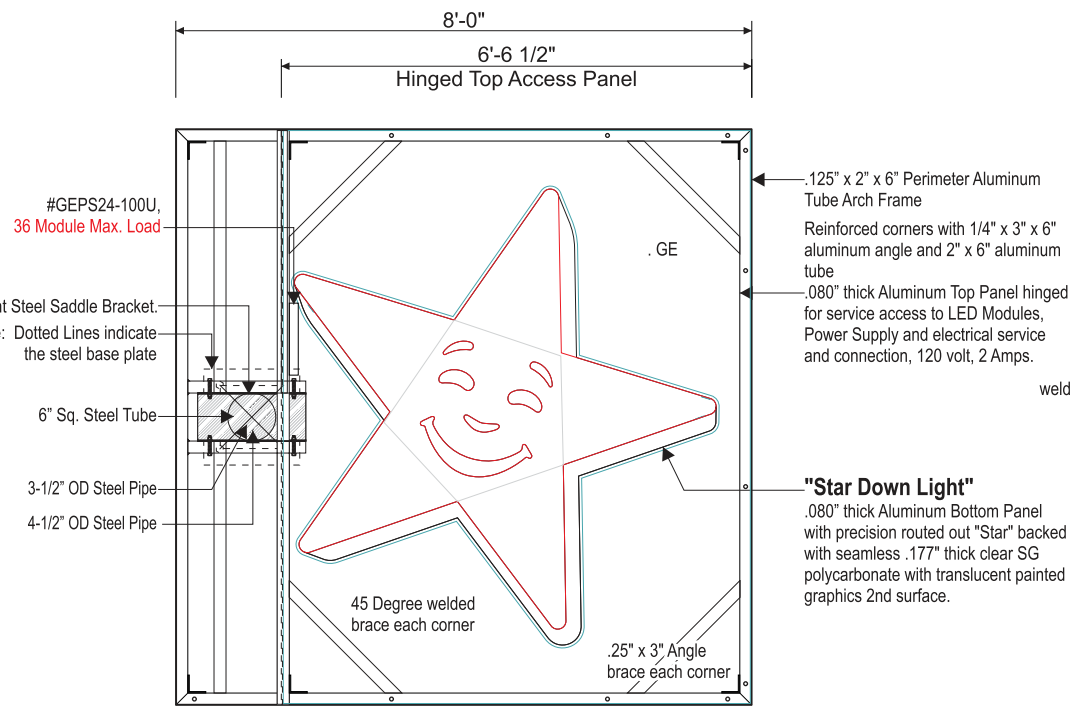

See Engineering Drawings for Structural Specifications

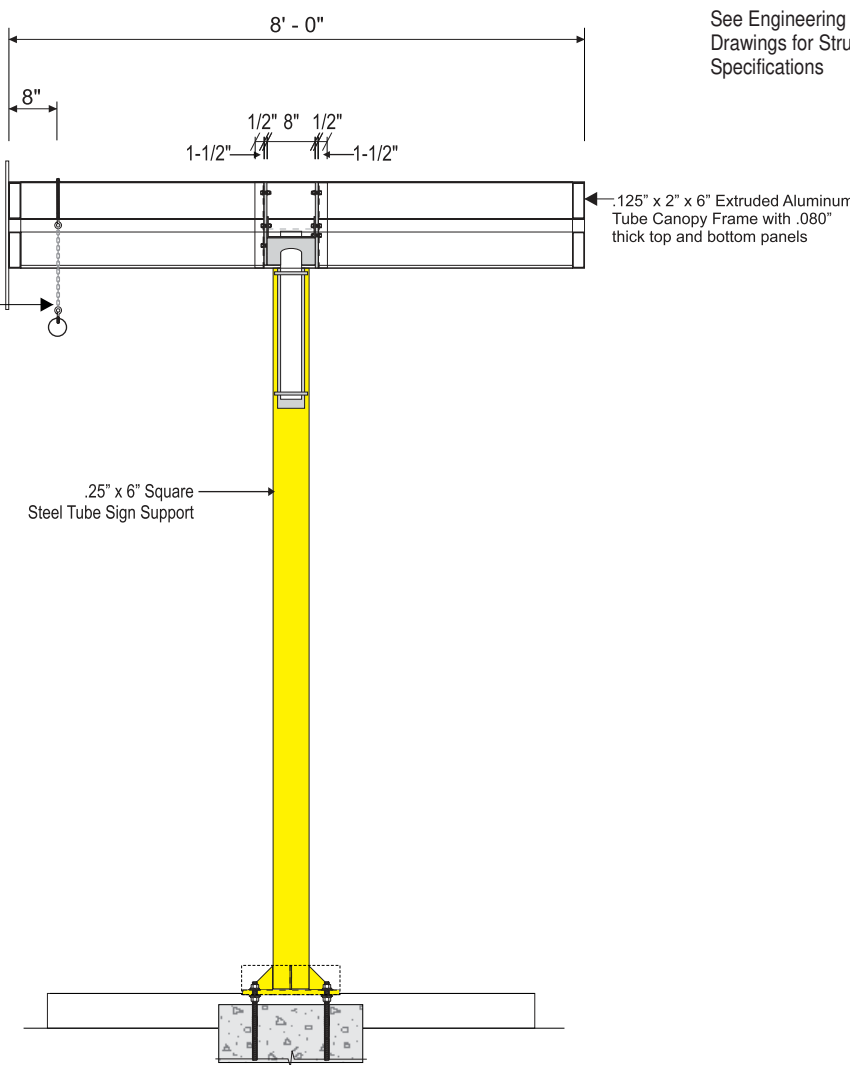
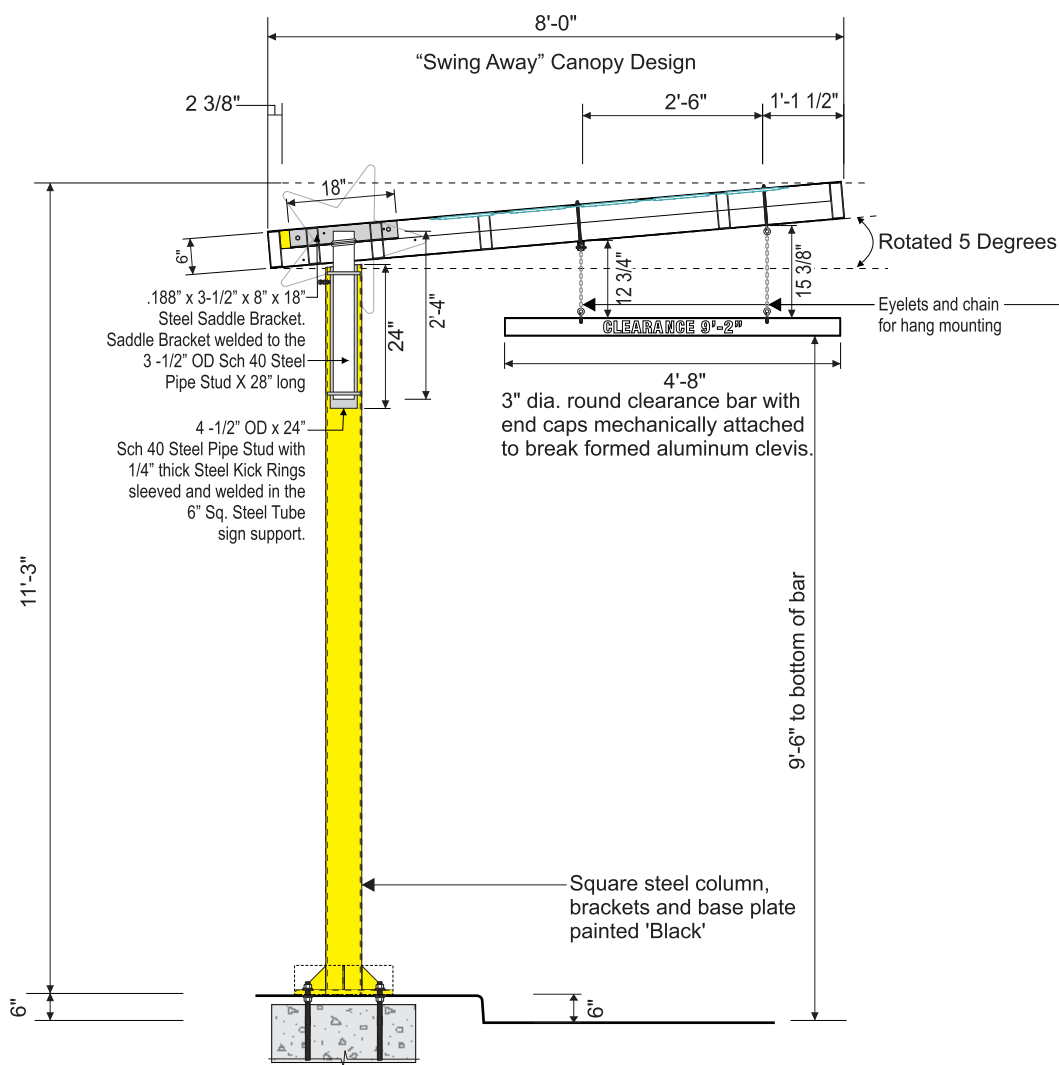

Notice:
 YJ Inc is responsible for column, base plate, anchor bolt & foundation design only.

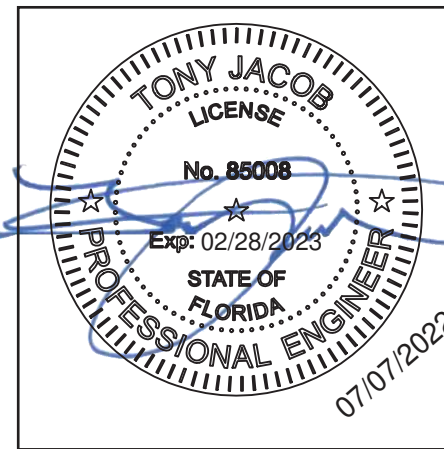

Allen Industries
 FILE NUMBER: E212503
 MET E212503
 Electric Sign Complies with UL48 CSA C22.2 No.207
 GROUNDED ELECTRICAL CONNECTIONS

THIS SIGN IS INTENDED TO BE INSTALLED IN ACCORDANCE WITH THE REQUIREMENTS OF ARTICLE 600 OF THE NATIONAL ELECTRICAL CODE AND/OR OTHER APPLICABLE LOCAL CODES. THIS INCLUDES PROPER GROUNDING AND BONDING OF THE SIGN.

HAR-OC32X8-FRIL-STAR

Order Canopy, Flat Roof

Notice:
YJ Inc is responsible for column, base plate,
anchor bolt & foundation design only.

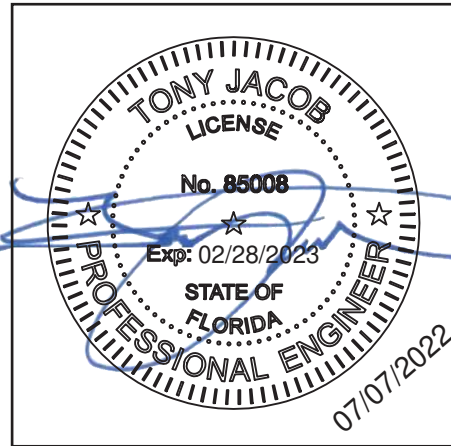

GENERAL SPECIFICATION:

CABINET HOUSING MIC. AND SPEAKER UNIT TO BE FABRICATED FROM .125" THICK ALUMINUM WITH ALUMINUM FRAME STRUCTURE AS SHOWN. ALL EXPOSED CORNERS OF CABINET TO BE EASED.
CABINET TO HINGE OPEN FROM ONE SIDE FOR ACCESS FOR INSTALLATION OF AUDIO AND ELECTRICAL CONNECTIONS. ALL RETAINING FASTENERS TO BE NON-CORROSIVE, FLAT HEAD, AND COUNTER SUNK TO BE SMOOTH WITH CABINET.
ALL EXPOSED ALUMINUM TO BE SANDED, ACID ETCHED, PRIMED AND FINISHED IN ENAMEL.
CABINET TO BE MOUNTED TO 6" SCHEDULE 40 PIPE IN THE FIELD WITH 1/4" DIA., HEX HEAD, SELF-TAPING SM SCREWS PAINTED TO MATCH CABINET COLOR.

Client Review Status

Allen Industries, Inc. requires that an approved drawing be obtained from the client prior to any production release or production release revision.

Client Signature: _____

Approval Date: _____

Notes:

#	Date	Description	Initial
1	04/11/22	-	BH
2	-	-	-
3	-	-	-
4	-	-	-
5	-	-	-
6	-	-	-
7	-	-	-
8	-	-	-
9	-	-	-
10	-	-	-
11	-	-	-
12	-	-	-
13	-	-	-
14	-	-	-
15	-	-	-
16	-	-	-
17	-	-	-
18	-	-	-
19	-	-	-
20	-	-	-

Date: **03/02/22** Page #: **13**

File Name: _____

Sales: **TA** Design: **BH** PM: **CR**

Client: **Hardee's**

Address: **2609 W. US HWY 90
LAKE CITY, FL**

Copyright © 2022 Allen Industries, Inc.
This is an original, unpublished drawing, created by Allen Industries, Inc. This drawing is submitted to you in confidence for your use solely in connection with the project being planned for you by Allen Industries, Inc. and is not to be shown to anyone outside your organization, nor used, reproduced, copied or exhibited in any fashion whatsoever. The designs shown on the drawing (except for any registered trademarks that may belong to a client of Allen Industries, Inc.) remain the property of Allen Industries, Inc.

Allen Industries
YOUR BRAND AT ITS BEST™
1-800-967-2553
www.allenindustries.com

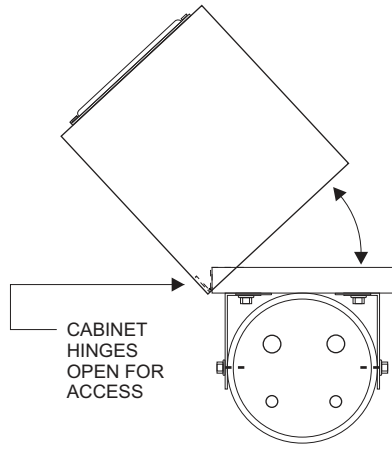

Top View
Scale: N.T.S.

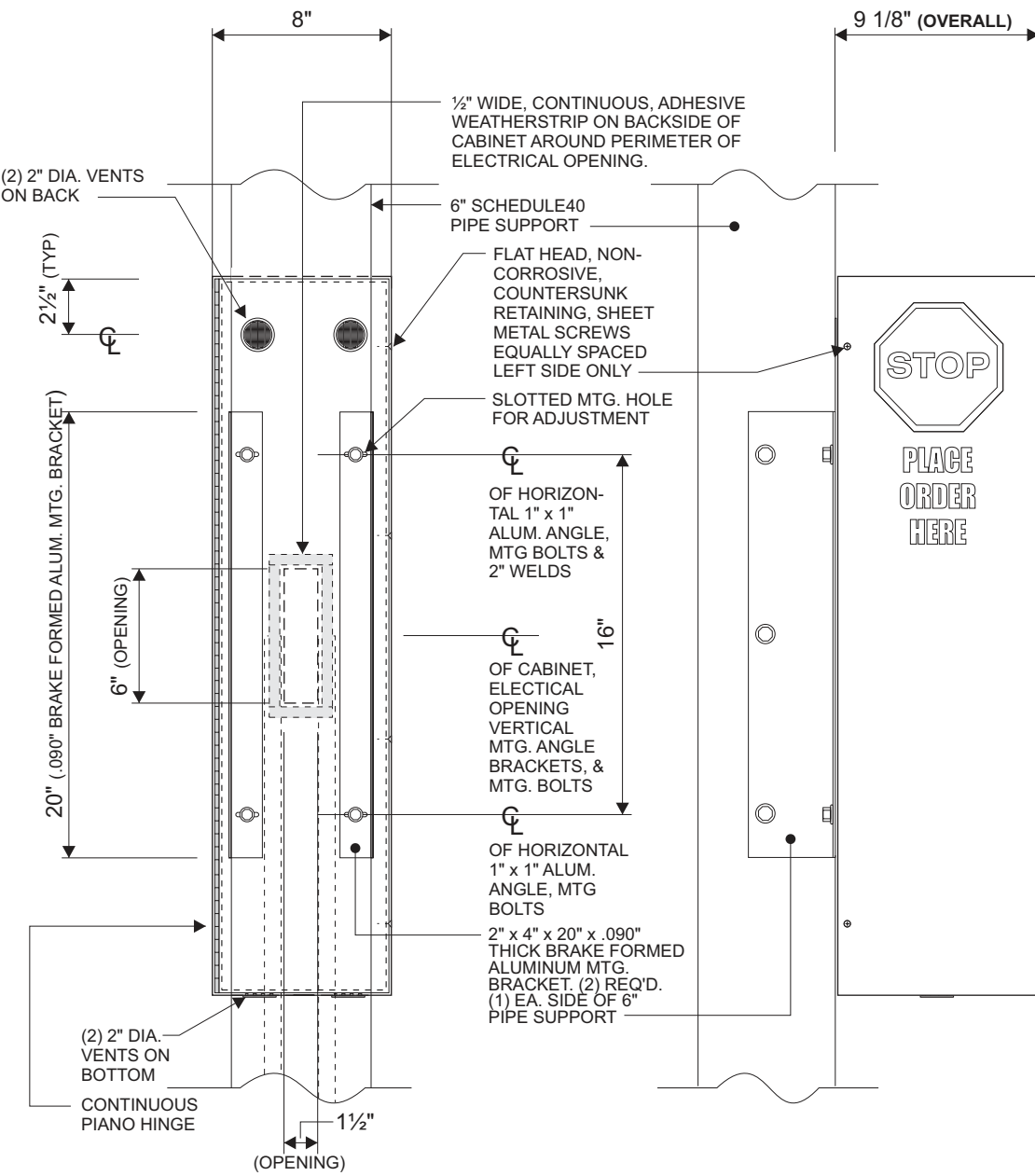

Rear View

Left Side View

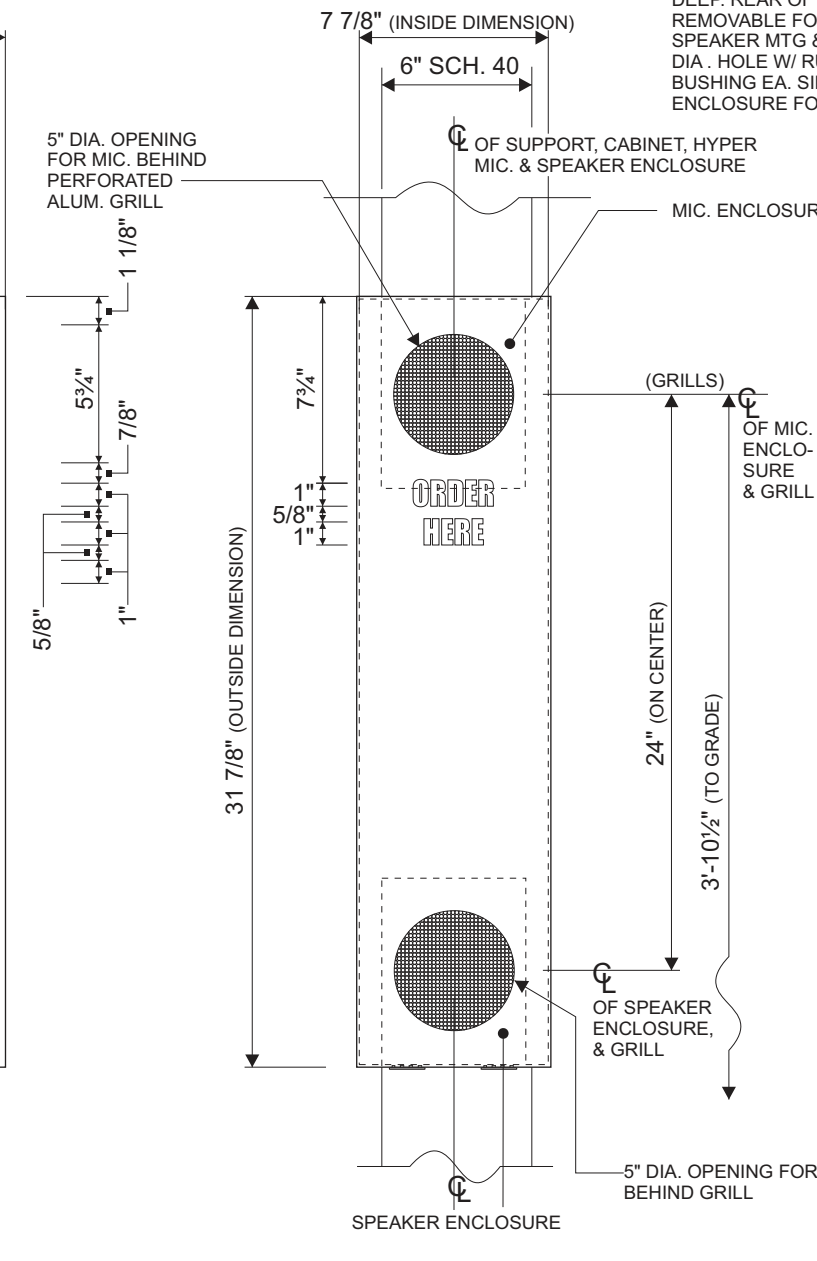

Front Side - Detailed View

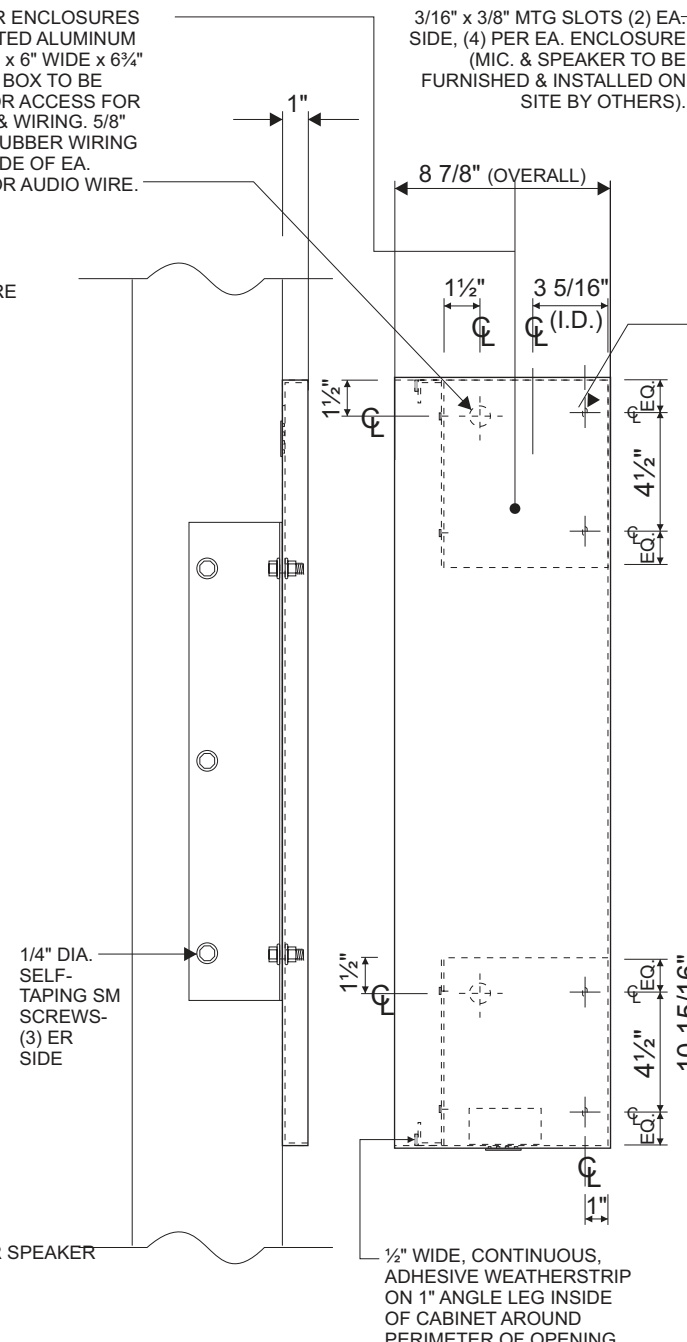

Left Side - Detailed View

MIC. & SPEAKER ENCLOSURES TO BE FABRICATED ALUMINUM BOXES- 7" HIGH x 6" WIDE x 6 1/4" DEEP. REAR OF BOX TO BE REMOVABLE FOR ACCESS FOR SPEAKER MTG & WIRING. 5/8" DIA. HOLE W/ RUBBER WIRING BUSHING EA. SIDE OF EA. ENCLOSURE FOR AUDIO WIRE.

3/16" x 3/8" MTG SLOTS (2) EA. SIDE, (4) PER EA. ENCLOSURE (MIC. & SPEAKER TO BE FURNISHED & INSTALLED ON SITE BY OTHERS).

1/2" WIDE, CONTINUOUS, ADHESIVE WEATHERSTRIP ON 1" ANGLE LEG INSIDE OF CABINET AROUND PERIMETER OF OPENING FOR SERVICE ACCESS