

# ROOF PLAN

SCALE: 1/8" = 1'-0"

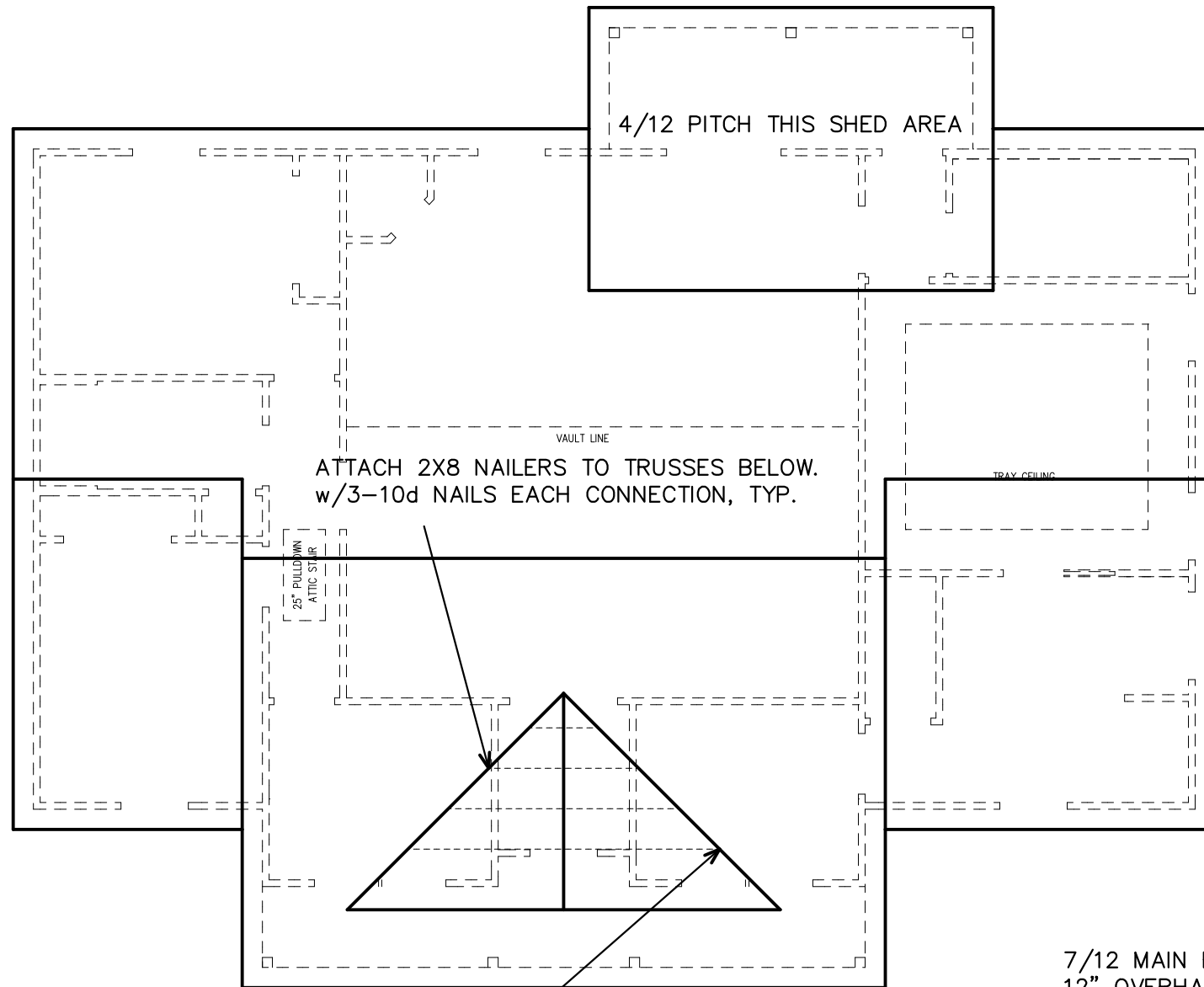

4/12 PITCH THIS SHED AREA

ATTACH 2X8 NAILERS TO TRUSSES BELOW.  
w/3-10d NAILS EACH CONNECTION, TYP.

25" PULLDOWN  
ATTIC STAIR

VAULT LINE

TRAY CEILING

ATTACH 2X6 RAFTERS TO NAILER  
w/SIMPSON H2.5A CLIP AND 10d  
TOE NAILS EACH CONNECTION, TYP.

7/12 MAIN ROOF PITCH, 4/12 SHED OVER REAR PORCH AREA ONLY  
12" OVERHANGS  
ARCHITECTURAL SHINGLES OVER SYNTHETIC UNDERLAYMENT  
CONTINUOUS RIDGE VENTS  
15/32" OSB ROOF DECKING - SEE PAGE 8 FOR NAILING PATTERNS  
ENGINEERED TRUSSES 24" O.C.  
SEE MANUFACTURER PROVIDED TRUSS DRAWINGS FOR BRACING DETAILS  
TRUSSES TO BE MANUFACTURED PER TPI-95 AND CHAPTER 16 OF SBC



These plans comply with 2023 Florida Building Code, 120 mph wind speed (3 sec. gust)

John K. Gentry, P.E.#16990  
P.O. Box 1034  
Perry, FL 32348  
(850) 672-0145

DATE: 01-08-2026  
PAGE 5 OF 8

SQUARE FOOTAGE	HEATED	PORCH	TOTAL
	1983 S.F.	237 S.F.	2220 S.F.

Josh Wilson & Nicole Dempsey  
White Springs, Florida

