

DATE 10/16/2008

Columbia County Building Permit

PERMIT

This Permit Must Be Prominently Posted on Premises During Construction

000027428

APPLICANT MICHAELS S. BYRD PHONE 407.832.1687
 ADDRESS 336 SW BONIFAY GLEN FT. WHITE FL 32038
 OWNER MICHAEL S. BYRD PHONE 407.832.1687
 ADDRESS 336 SW BONIFAY GLEN FT. WHITE FL 32038
 CONTRACTOR _____ PHONE _____

LOCATION OF PROPERTY 47-S TO US 27, TL TO BONIFAY GLN, TR TO LONG PAVED DRIVEWAY AND THE LOT IS ON THE R.

TYPE DEVELOPMENT RV/UTILITY ESTIMATED COST OF CONSTRUCTION 0.00

HEATED FLOOR AREA _____ TOTAL AREA _____ HEIGHT _____ STORIES _____

FOUNDATION _____ WALLS _____ ROOF PITCH _____ FLOOR _____

LAND USE & ZONING A-3 MAX. HEIGHT _____

Minimum Set Back Requirments: STREET-FRONT 30.00 REAR 25.00 SIDE 25.00

NO. EX.D.U. 1 FLOOD ZONE _____ DEVELOPMENT PERMIT NO. _____

PARCEL ID 19-7S-16-10026-022 SUBDIVISION _____

LOT _____ BLOCK _____ PHASE _____ UNIT _____ TOTAL ACRES 1.01

Culvert Permit No. _____ Culvert Waiver _____ Contractor's License Number _____ Applicant/Owner/Contractor _____

EXISTING 07-0448 BLK LH N

Driveway Connection _____ Septic Tank Number _____ LU & Zoning checked by _____ Approved for Issuance _____ New Resident _____

COMMENTS: RV STUP 12 MOS. 0810-49

Check # or Cash 3065

FOR BUILDING & ZONING DEPARTMENT ONLY

(footer/Slab)

Temporary Power _____ Foundation _____ Monolithic _____
date/app. by _____ date/app. by _____ date/app. by _____

Under slab rough-in plumbing _____ Slab _____ Sheathing/Nailing _____
date/app. by _____ date/app. by _____ date/app. by _____

Framing _____ Rough-in plumbing above slab and below wood floor _____
date/app. by _____ date/app. by _____

Electrical rough-in _____ Heat & Air Duct _____ Peri. beam (Lintel) _____
date/app. by _____ date/app. by _____ date/app. by _____

Permanent power _____ C.O. Final _____ Culvert _____
date/app. by _____ date/app. by _____ date/app. by _____

M/H tie downs, blocking, electricity and plumbing _____ Pool _____
date/app. by _____ date/app. by _____

Reconnection _____ Pump pole _____ Utility Pole _____
date/app. by _____ date/app. by _____ date/app. by _____

M/H Pole _____ Travel Trailer _____ Re-roof _____
date/app. by _____ date/app. by _____ date/app. by _____

BUILDING PERMIT FEE \$ 0.00 CERTIFICATION FEE \$ 0.00 SURCHARGE FEE \$ 0.00

MISC. FEES \$ 0.00 ZONING CERT. FEE \$ _____ FIRE FEE \$ 38.50 WASTE FEE \$ 100.50

FLOOD DEVELOPMENT FEE \$ _____ FLOOD ZONE FEE \$ _____ CULVERT FEE \$ _____ **TOTAL FEE** 139.00

INSPECTORS OFFICE _____ CLERKS OFFICE CH

NOTICE: IN ADDITION TO THE REQUIREMENTS OF THIS PERMIT, THERE MAY BE ADDITIONAL RESTRICTIONS APPLICABLE TO THIS PROPERTY THAT MAY BE FOUND IN THE PUBLIC RECORDS OF THIS COUNTY. AND THERE MAY BE ADDITIONAL PERMITS REQUIRED FROM OTHER GOVERNMENTAL ENTITIES SUCH AS WATER MANAGEMENT DISTRICTS, STATE AGENCIES, OR FEDERAL AGENCIES.

"WARNING TO OWNER: YOUR FAILURE TO RECORD A NOTICE OF COMMENCEMENT MAY RESULT IN YOUR PAYING TWICE FOR IMPROVEMENTS TO YOUR PROPERTY. IF YOU INTEND TO OBTAIN FINANCING, CONSULT WITH YOUR LENDER OR AN ATTORNEY BEFORE RECORDING YOUR NOTICE OF COMMENCEMENT."

EVERY PERMIT ISSUED SHALL BECOME INVALID UNLESS THE WORK AUTHORIZED BY SUCH PERMIT IS COMMENCED WITHIN 180 DAYS AFTER ITS ISSUANCE, OR IF THE WORK AUTHORIZED BY SUCH PERMIT IS SUSPENDED OR ABANDONED FOR A PERIOD OF 180 DAYS AFTER THE TIME THE WORK IS COMMENCED. A VALID PERMIT RECIEVES AN APPROVED INSPECTION EVERY 180 DAYS. WORK SHALL BE CONSIDERED TO BE IN ACTIVE PROGRESS WHEN THE PERMIT HAS RECIEVED AN APPROVED INSPECTION WITHIN 180 DAYS.

The Issuance of this Permit Does Not Waive Compliance by Permittee with Deed Restrictions.

COLUMBIA COUNTY, FLORIDA
LAND DEVELOPMENT REGULATION ADMINISTRATOR
SPECIAL PERMIT FOR TEMPORARY USE
APPLICATION

Permit No. STUP - 0810-49 Date 10.16.08
Fee 0.00 Receipt No. Building Permit No. 26067
27428

Name of Title Holder(s) MICHAEL S. BYRD
Address 336 SW BONIFAY CIRCLE City FOOT WHITE
Zip Code 32037
Phone (407) 832-1687

NOTE: If the title holder(s) of the subject property are appointing an agent to represent them, a letter from the title holder(s) addressed to the Land Development Regulation Administrator MUST be attached to this application at the time of submittal stating such appointment.

Title Holder(s) Representative Agent(s) MICHAEL S. BYRD
Address 336 SW BONIFAY CIRCLE City FOOT WHITE
Zip Code 32038
Phone ()

Paragraph Number Applying for # 5
Proposed Temporary Use of Property RV WHILE BUILDING
Proposed Duration of Temporary Use 12 MONTHS # 5
Tax Parcel ID# 19-75-17-10026-021²
Provide a copy of your Deed of the property
Size of Property
Present Land Use Classification A-3
Present Zoning District A-3

Certain uses are of short duration and do not create excessive incompatibility during the course of the use. Therefore, the Land Development Regulation Administrator is authorized to issue temporary use permits for the following activities, after a showing that any nuisance or hazardous feature involved is suitably separated from adjacent uses; excessive vehicular traffic will not be generated on minor residential streets; and a vehicular parking problem will not be created:

1. In any zoning district: special events operated by non-profit, eleemosynary organizations.
2. In any zoning district: Christmas tree sales lots operated by non-profit, eleemosynary organizations.
3. In any zoning district: other uses which are similar to (1) and (2) above and which are of a temporary nature where the period of use will not extend beyond thirty (30) days.
4. In any zoning district: mobile homes or RV's used for temporary purposes by any agency of municipal, County, State, or Federal government; provided such uses shall not be or include a residential use.
5. In any zoning district: mobile homes or RV's used as a residence, temporary office, security shelter, or shelter for materials of goods incident to construction on or development of the premises upon which the mobile home or travel trailer is located. Such use shall be strictly limited to the time construction or development is actively underway. In no event shall the use continue more than twelve (12) months without the approval of the Board of County Commissioners and the Board of County Commissioners shall give such approval only upon finding that actual construction is continuing.
6. In agricultural, commercial, and industrial districts: temporary religious or revival activities in tents.
7. In agricultural districts: In addition to the principal residential dwelling, two (2) additional mobile homes may be used as an accessory residence, provided that such mobile homes are occupied by persons related by the grandparent, parent, step-parent, adopted parent, sibling, child, stepchild, adopted child or grandchild of the family occupying the principal residential use. Such mobile homes are exempt from lot area requirements. A temporary use permit for such mobile homes may be granted for a time period up to five (5) years. The permit is valid for occupancy of the specified family member as indicated on Family Relationship Affidavit and Agreement which shall be recorded in the Clerk of the Courts by the applicant.

The Family Relationship Affidavit and Agreement shall include but not be limited to:

- a. Specify the family member to reside in the additional mobile home;
- b. Length of time permit is valid;
- c. Site location of mobile home on property and compliance with all other conditions not conflicting with this section for permitting as set forth in these land development regulations. Mobile homes shall not be located within required yard setback areas and shall not be located within twenty (20) feet of any other building;
- d. Responsibility for non ad-valorem assessments;
- e. Inspection with right of entry onto the property, but not into the mobile home by the County to verify compliance with this section. The Land Development Regulation Administrator, and other authorized representatives are hereby authorized to make such inspections and take such actions as may be required to enforce the provisions of this Section and;
- f. Shall be hooked up to appropriate electrical service, potable well and sanitary sewer facilities (bathroom and septic tank) that have been installed pursuant to permits issued by the Health Department and County Building and Zoning Department, where required.
- g. Recreational vehicles (RV's) as defined by these land development regulations are not allowed under this provision (see Section 14.10.2#10).
- h. Requirements upon expiration of permit. Unless extended as herein provided, once a permit expires the mobile home shall be removed from the property within six (6) months of the date of expiration.

The property owner may apply for one or more extensions for up to two (2) years by submitting a new application, appropriate fees and family relationship residence affidavit agreement to be approved by the Land Development Regulation Administrator.

Previously approved temporary use permits would be eligible for extensions as amended in this section.

- 8. In shopping centers within Commercial Intensive districts only: mobile recycling collection units. These units shall operate only between the hours of 7:30 a.m. and 8:30 p.m. and shall be subject to the review of the Land Development Regulation Administrator. Application for permits shall include

written confirmation of the permission of the shopping center owner and a site plan which includes distances from buildings, roads, and property lines. No permit shall be valid for more than thirty (30) days within a twelve (12) month period, and the mobile unit must not remain on site more than seven (7) consecutive days. Once the unit is moved off-site, it must be off-site for six (6) consecutive days.

9. In agriculture and environmentally sensitive area districts: a single recreational vehicle as described on permit for living, sleeping, or housekeeping purposes for one-hundred eighty (180) consecutive days from date that permit is issued, subject to the following conditions:
 - a. Demonstrate a permanent residence in another location.
 - b. Meet setback requirements.
 - c. Shall be hooked up to or have access to appropriate electrical service, potable well and sanitary sewer facilities (bathroom and septic tank) that have been installed pursuant to permits issued by the Health Department and County Building and Zoning Department, where required.
 - d. Upon expiration of the permit the recreational vehicle shall not remain on property parked or stored and shall be removed from the property for 180 consecutive days.
 - e. Temporary RV permits are renewable only after one (1) year from issuance date of any prior temporary permit.

Temporary RV permits existing at the effective date of this amendment may be renewed for one (1) additional temporary permit in compliance with these land development regulations, as amended. Recreational vehicles as permitted in this section are not to include RV parks.

Appropriate conditions and safeguards may include, but are not limited to, reasonable time limits within which the action for which temporary use permit is requested shall be begun or completed, or both. Violation of such conditions and safeguards, when made a part of the terms under which the special permit is granted, shall be deemed a violation of these land development regulations and punishable as provided in Article 15 of these land development regulations.

I (we) hereby certify that all of the above statements and the statements contained in any papers or plans submitted herewith are true and correct to the best of my (our) knowledge and belief.

MICHAEL S. BYRD
Applicants Name (Print or Type)

[Signature]
Applicant Signature

10/16/08
Date

OFFICIAL USE

Approved 10.10.08
Denied BLK

Reason for Denial _____

Conditions (if any) _____



APPLICATION FOR ONSITE SEWAGE DISPOSAL SYSTEM CONSTRUCTION PERMIT

Permit Application Number 07-0442

PART II - SITE PLAN

Scale: Each block represents 5 feet and 1 inch = 50 feet.

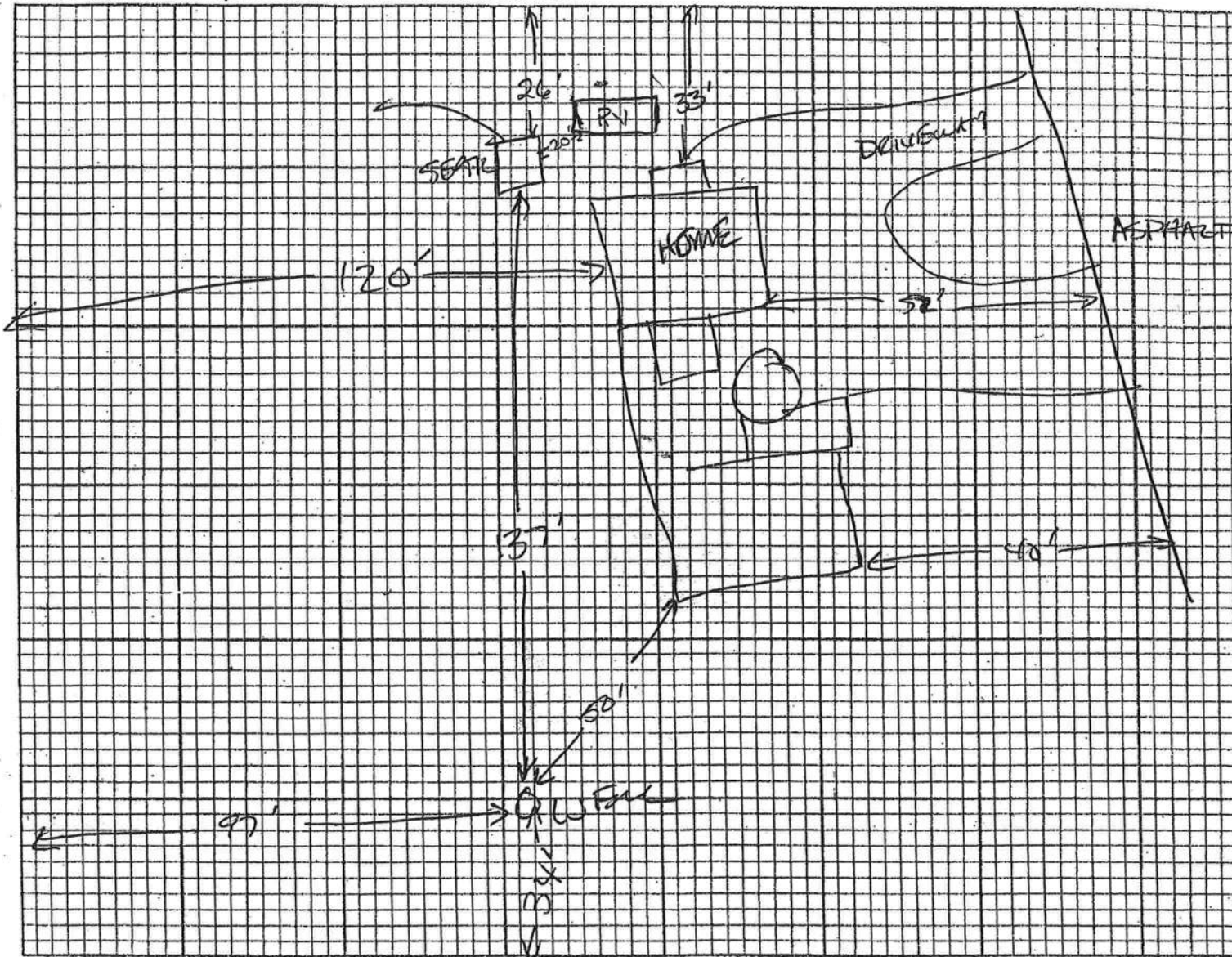

Notes: SEPTIC IS 137' FROM WELL, CLOSEST PROPERTY LINE TO SEPTIC IS 26'

-SEE ATTACHED

RV USE ONLY

REVISED
10-15-88

Site Plan submitted by: [Signature]

Signature

OWNER

Title

Plan Approved: [Signature]

Not Approved _____

Date 10/16/88

By [Signature]

Columbia CHD

County Health Department

ALL CHANGES MUST BE APPROVED BY THE COUNTY HEALTH DEPARTMENT